

**MACCHINA DA CAFFÈ**  
**COFFEE MAKER**  
**MACHINE À CAFÉ**  
**KAFFEE-/ESPRESSO-VOLLAUTOMAT**  
**KOFFIEZETAPPARAAT**  
**CAFETERA**  
**MÁQUINA DE CAFÉ**  
**KÁVOVAR**

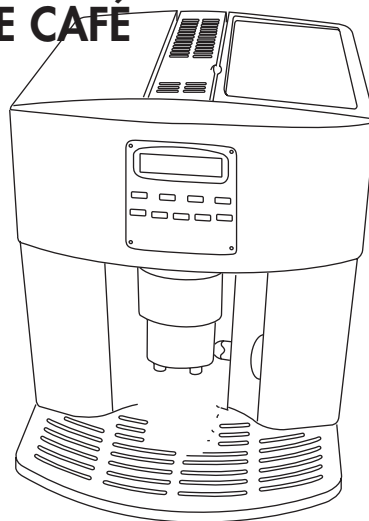

**Istruzioni per l'uso**  
**Instructions**  
**Mode d'emploi**  
**Bedienungsanleitung**  
**Gebruiksaanwijzingen**  
**Instrucciones para el uso**  
**Instruções de utilização**  
**Návod k použití**

**De'Longhi**

De'Longhi S.p.A.  
via Seitz, 47  
31100 Treviso Italia

## ELECTRICAL CONNECTION (UK ONLY)

A) If your appliance comes fitted with a plug, it will incorporate a 13 Amp fuse. If it does not fit your socket, the plug should be cut off from the mains lead, and an appropriate plug fitted, as below.

**WARNING:** Very carefully dispose of the cut off plug after removing the fuse: do not insert in a 13 Amp socket elsewhere in the house as this could cause a shock hazard.

With alternative plugs not incorporating a fuse, the circuit must be protected by a 15 Amp fuse.

### **WARNING - THIS APPLIANCE MUST BE EARTHED** **IMPORTANT**

The wires in the mains lead are coloured in accordance with the following code:

Green and yellow:	Earth
Blue:	Neutral
Brown:	Live



If the plug is a moulded-on type, the fuse cover must be re-fitted when changing the fuse using a 13 Amp Asta approved fuse to BS 1362. In the event of losing the fuse cover, the plug must NOT be used until a replacement fuse cover can be obtained from your nearest electrical dealer. The colour of the correct replacement fuse cover is that as marked on the base of the plug.

As the colours of the wires in the mains lead may not correspond with the coloured markings identifying the terminals in your plug, proceed as follows:

The green and yellow wire must be connected to the terminal in the plug marked with the letter E or the earth symbol  or coloured green or green and yellow.

The blue wire must be connected to the terminal marked with the letter N or coloured black.

The brown wire must be connected to the terminal marked with the letter L or coloured red.

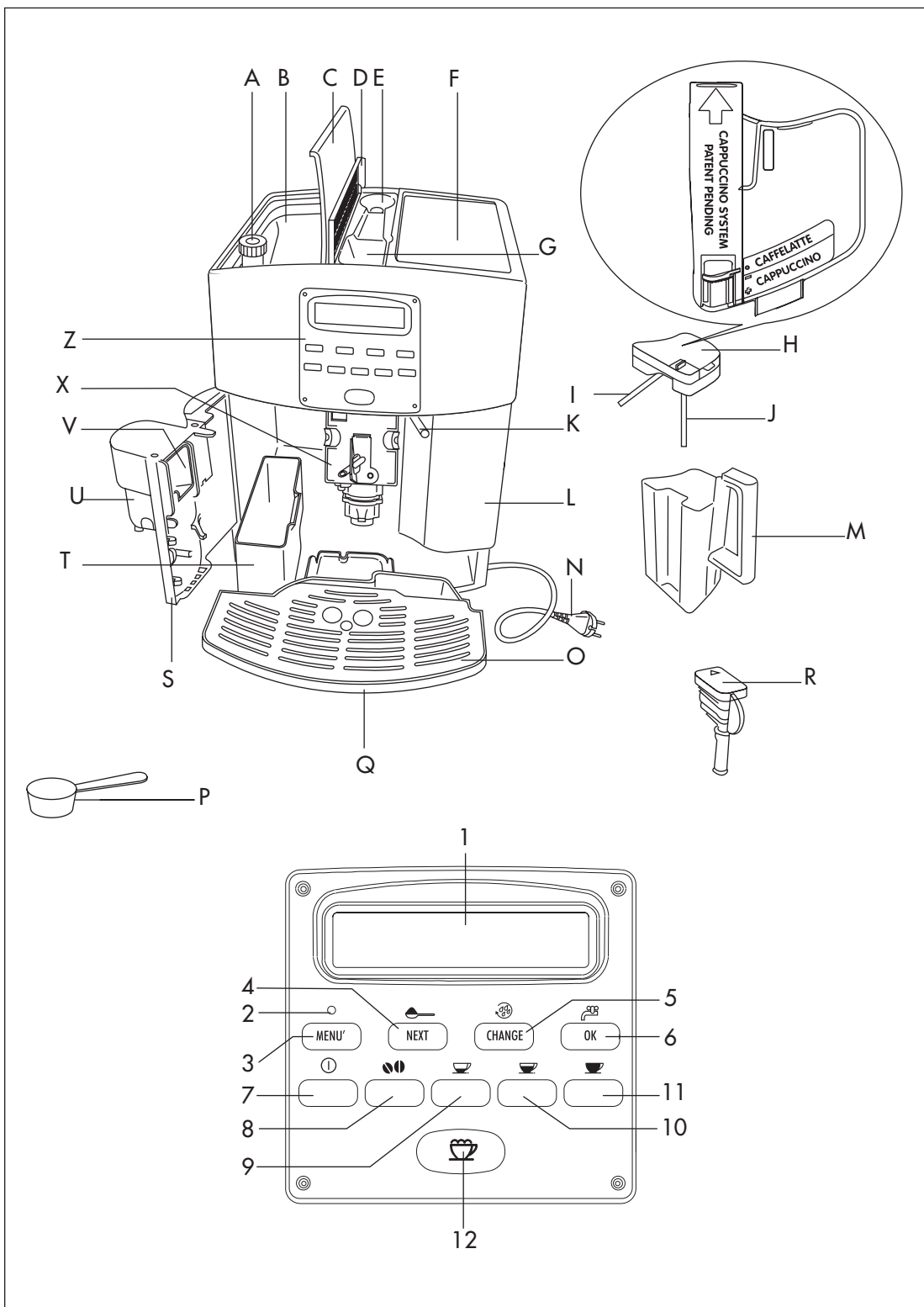

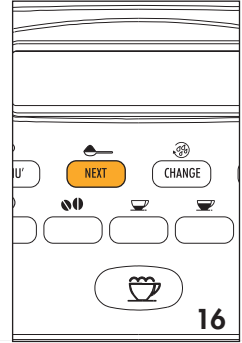
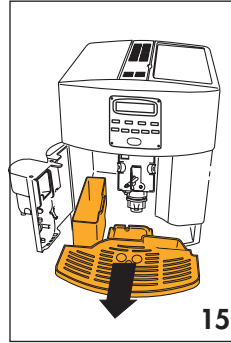
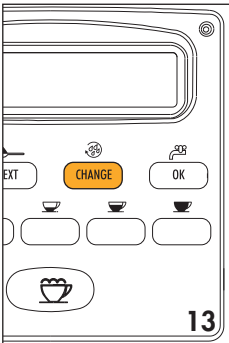
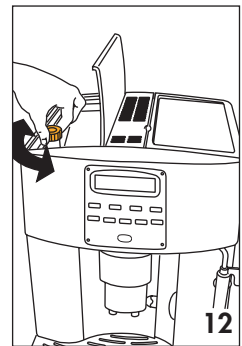
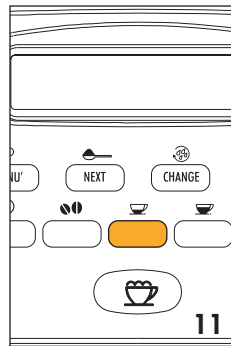
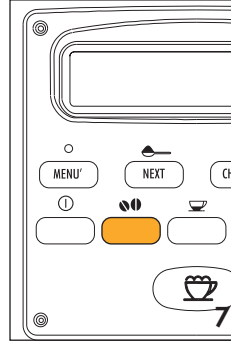
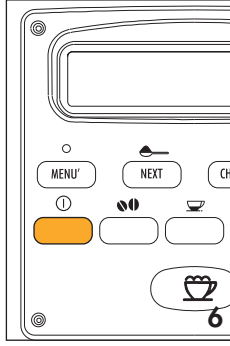
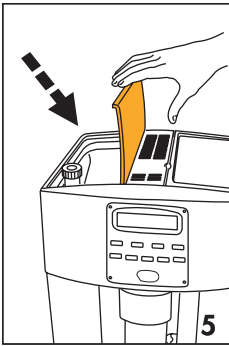
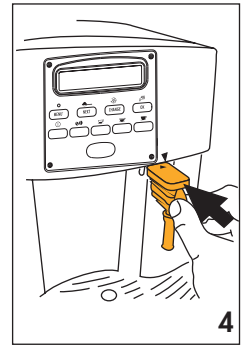
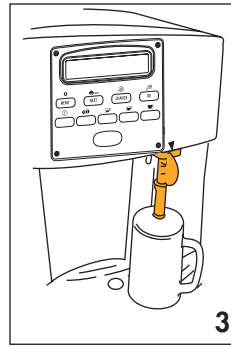
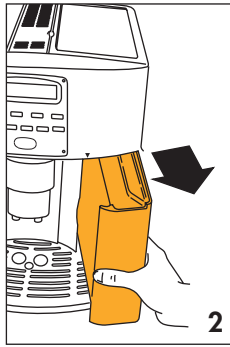
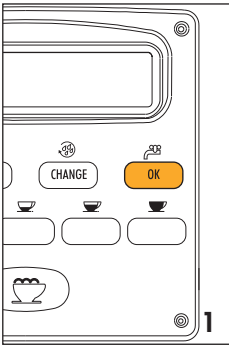

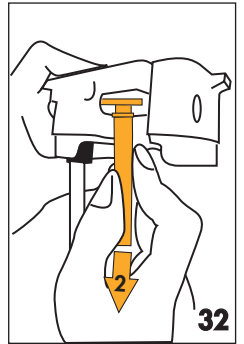
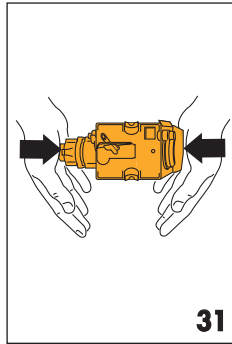
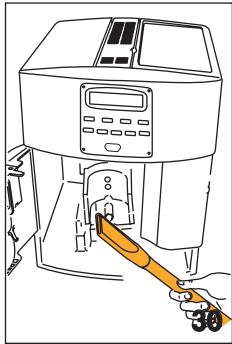
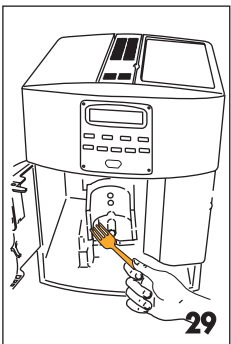
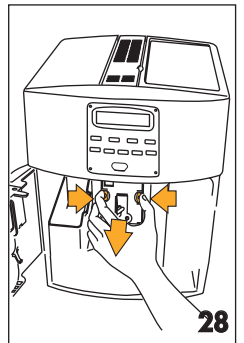
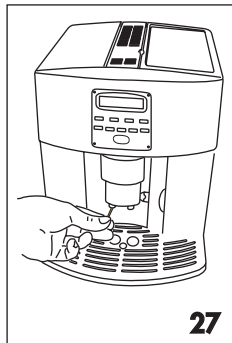
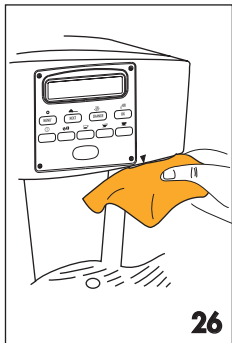
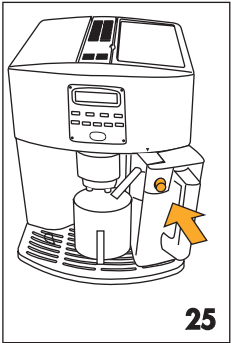
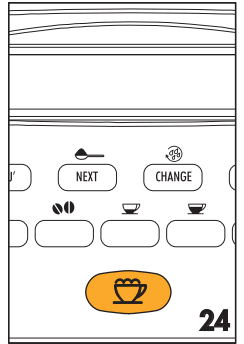
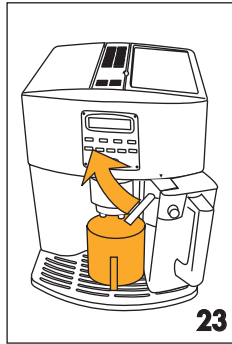
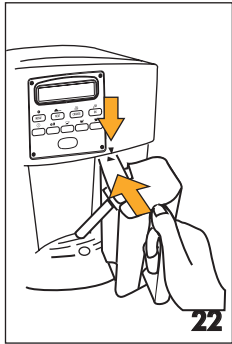
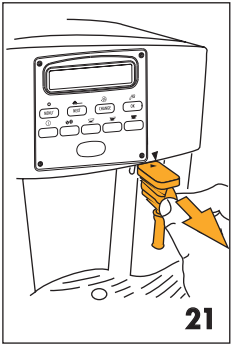
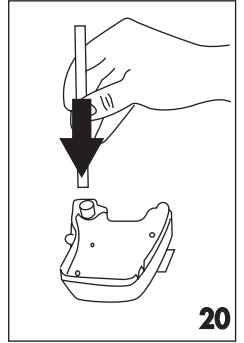
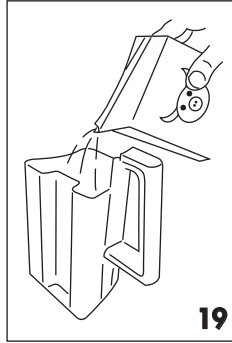
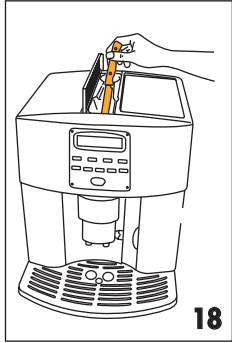
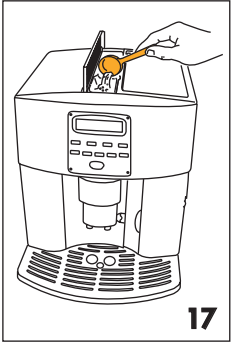

## INDEX

---

1 DESCRIPTION OF THE APPLIANCE (see page 3)	.24
2 SAFETY WARNINGS	.24
3 INSTALLATION	.25
4 USING FOR THE FIRST TIME	.25
5 TURNING ON AND PREHEATING	.26
6 PREPARING COFFEE (USING COFFEE BEANS)	.26
7 CHANGING THE QUANTITY OF COFFEE IN THE CUP	.28
8 REGULATING THE COFFEE MILL	.28
9 PREPARING ESPRESSO COFFEE WITH PRE-GROUND COFFEE (INSTEAD OF BEANS)	.29
10 RUNNING OFF HOT WATER	.29
11 CHANGING THE QUANTITY OF HOT WATER	.30
12 PREPARING CAPPUCCINOS (FROTHED MILK AND COFFEE)	.30
13 PREPARING FROTHED MILK (WITHOUT COFFEE)	.31
14 CHANGING THE QUANTITY OF COFFEE AND MILK FOR CAPPUCCINOS	.31
15 CLEANING AND MAINTENANCE	.31
15.1 CLEANING THE COFFEE MAKER	.31
15.2 CLEANING THE INFUSER	.31
15.3 CLEANING THE MILK CONTAINER	.33
16 CHANGING AND SETTING THE MENU PARAMETERS	.33
16.1 SETTING THE CLOCK	.33
16.2 SETTING AUTO-START TIME	.33
16.3 DESCALING	.34
16.4 CHANGING COFFEE TEMPERATURE	.35
16.5 CHANGING THE LENGTH OF TIME THE APPLIANCE REMAINS ON	.35
16.6 SETTING WATER HARDNESS	.35
16.7 RESETTING FACTORY DEFAULT SETTINGS	.36
16.8 WASHING PROCESS	.36
17 CHANGING THE LANGUAGE	.36
18 MEANING OF MESSAGES AND WHAT TO DO	.36
19 PROBLEMS THAT CAN BE RESOLVED BEFORE CALLING THE SERVICE CENTRE	.37

### IMPORTANT INFORMATION FOR CORRECT DISPOSAL OF THE PRODUCT IN ACCORDANCE WITH EC DIRECTIVE 2002/96/EC.

---

At the end of its working life, the product must not be disposed of as urban waste.

It must be taken to a special local authority differentiated waste collection centre or to a dealer providing this service.

Disposing of a household appliance separately avoids possible negative consequences for the environment and health deriving from inappropriate disposal and enables the constituent materials to be recovered to obtain significant savings in energy and resources. As a reminder of the need to dispose of household appliances separately, the product is marked with a crossed-out wheeled dustbin.

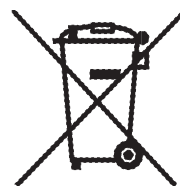

## 1 DESCRIPTION OF THE APPLIANCE (SEE PAGE 3)

---

- A. Grinding coarseness regulator
- B. Coffee beans container
- C. Bean container lid
- D. Central lid for ground coffee
- E. Compartment for measure
- F. Cup warmer tray
- G. Ground coffee funnel
- H. Milk container lid/milk frother
- I. Frothed milk spout
- J. Milk intake tube
- K. Nozzle
- L. Water tank (removable)
- M. Milk container
- N. Power cable
- O. Cup tray
- P. Measure for pre-ground coffee
- Q. Drip tray (removable)
- R. Hot water spout
- S. Service door
- T. Coffee grounds container (removable)
- U. Coffee spout (adjustable in height)
- V. Mobile drawer
- X. Infuser
- Z. Control panel

### Control Panel

- 1. Display
- 2. MENU light.
- 3. Button to activate or deactivate menu parameter setting mode
- 4. Button to select ground coffee or, if the MENU light is on, to display the next parameter on the menu
- 5. Button to rinse the appliance or, if the MENU light is on, to confirm the menu parameters
- 6. Button to select hot water or, if the MENU light is on, to confirm the menu parameters
- 7. Appliance ON/OFF button
- 8. Coffee taste selection button
- 9. One or two cups short coffee button
- 10. One or two cups normal coffee button
- 11. One or two cups long coffee button
- 12. Cappuccino or frothed milk button

## 2 SAFETY WARNINGS

---

READ THESE INSTRUCTIONS CAREFULLY AND KEEP FOR FUTURE CONSULTATION!

- This appliance is designed to "make espresso coffee" and "heat drinks". Use with care to avoid scalds from the water and steam jets or through incorrect use.
- This appliance is intended for domestic use only. Any other use is considered improper and thus dangerous.
- The manufacturer cannot be held responsible for any damage caused through incorrect, wrong or unreasonable use.
- When using the appliance, do not touch the hot surfaces. Use the knobs or handles.
- Never touch the appliance with wet or damp hands or feet.
- The appliance is not intended for use by persons (including children) with reduced physical, sensory or mental capabilities, or lack of experience and knowledge, unless they have been given supervision or instruction concerning use of the appliance by a person responsible for their safety. Children should be supervised to ensure that they do not play with the appliance.
- In the event of failure or malfunction, unplug the appliance from the mains and do not tamper with it in any way. If it requires repair, contact an authorised service centre only and ask for original spare parts to be used. Failure to respect the above could reduce the safety of the appliance.
- Materials and accessories coming into contact with food conform to EC regulation 1935/2004.

### 3 INSTALLATION

---

- After unpacking, make sure the appliance is complete and undamaged. If in doubt, do not use it. Contact professionally qualified personnel.
  - The packing elements (plastic bags, polystyrene foam, etc.) should be kept out of the reach of children as they are a safety hazard.
  - Place the appliance on a work surface far away from water taps, basins and sources of heat.
  - After positioning the appliance on the work top, leave a space of at least 5 cm between the surfaces of the appliance and the side and rear walls and at least 20 cm above the coffee maker.
  - Never install the appliance in environments where the temperature may reach 0 or lower (the appliance may be damaged if the water freezes).
  - Make sure the mains voltage corresponds to the voltage indicated on the appliance rating plate. Connect the appliance to an efficiently earthed socket with a minimum current rating of 10A only. The manufacturer may not be considered liable for possible incidents caused by the failure to adequately earth the mains.
  - If the power socket does not match the plug on the appliance, have the socket replaced with a suitable type by a qualified professional.
  - The power cable on this appliance must not be replaced by the user as this operation requires the use of special tools.  
If the cable is damaged or requires replacing, contact an authorised service centre only to avoid all risks.
  - You should personalise water hardness as soon as possible following the instructions in section 16.6.
- To correctly learn how to use the appliance, when starting it for the first time, carefully follow the step-by-step instructions described in the following paragraphs.

### 4 USING FOR THE FIRST TIME

---

1. The first time you use the appliance, select the language.  
To set English, plug the appliance into the mains socket and wait for the following message to be displayed:

*PRESS OK TO INSTALL ENGLISH*

While the message is displayed, press the **OK** button (fig. 1) for at least three seconds until the display shows:

*ENGLISH INSTALLED*

The appliance then displays the setting message in English. If you select the wrong language by mistake, follow the instructions in section 17 to choose the right one.

2. After 5 seconds, the appliance displays:

*FILL TANK*

To refill the tank, remove (fig. 2), rinse and fill it with fresh water. Never exceed the MAX line. Put the tank back and push as far as it will go.

3. Place a cup under the hot water spout (fig. 3). (If the water spout is not in place, INSERT WATER SPOUT is displayed. Attach it as shown in figure 4, making sure the arrow on the spout is lined up with the arrow on the control panel of the appliance, fig. 4). The appliance now displays:

*PRESS OK*

4. Press the OK button (fig. 1) and after a few seconds, a little water is run off from the spout. (Run off stops automatically).



5. The appliance displays:

*TURNING OFF PLEASE WAIT*

and it goes off.

6. Fill the container with coffee beans (fig. 5).

**IMPORTANT:** to prevent malfunction, never fill with ground coffee, freeze dried coffee, caramelised beans or anything else which could damage the appliance.

## 5 TURNING ON AND PREHEATING

1. Press the  button (fig. 6). The appliance displays:

*HEATING UP PLEASE WAIT...*

to indicate preheating is underway.

2. Once preheating is completed, the appliance displays

*RINSING PLEASE WAIT...*

and performs an automatic rinse cycle (a little hot water is run off from the spouts and is collected in the drip tray below).

**Tip:** if you want short coffee (less than 60 cc), to make it hotter, fill the cup with this hot rinsing water first. Leave it for a few seconds then empty it to preheat the cup.



8. The appliance now displays the ready message:

*READY STANDARD TASTE*

## 6 PREPARING COFFEE (USING COFFEE BEANS)

1. The appliance is preset to make coffee with a normal taste. You can also choose coffee with an extra-light, light, strong or extra-strong taste. To choose the required taste, press the  button (fig. 7). The selected coffee taste will be displayed.

2. Place 1 cup under the spouts to make 1 coffee (fig. 8) or 2 cups for 2 coffees (fig. 9). For a creamier coffee, lower the spouts to bring them as close to the cups as possible (Fig. 10).

3. Press the  button to make a short coffee (fig. 11), the  button for a normal coffee or the  button for a long coffee.

**To make 2 coffees, press the button twice (within 2 seconds).**

**To change the quantity of coffee delivered automatically into the cup, follow the instructions in section 7.**

(The appliance now grinds the beans and starts running off the coffee into the cup.

Once the desired quantity has been reached, the appliance automatically stops delivering the coffee and ejects the grounds into the special container).

4. After a few seconds, the ready message is displayed again and you can make another coffee.

5. To turn the appliance off, press the  button.

Before going off, the appliance performs an automatic rinse cycle (a little hot water runs out from the spouts and is collected in the drip tray beneath. Take care to avoid scalds).

**NOTE 1:** If the coffee is delivered a drop at a time or not at all, turn the grinding coarseness regulator (fig. 12) one click clockwise (see section 8).

Turn one click at a time until the coffee is delivered satisfactorily.



**NOTE 2:** If the coffee is delivered too fast and is not creamy enough, turn the grinding coarseness regulator (fig. 12) one click anticlockwise (see section 8).

Avoid turning the grinding coarseness regulator excessively otherwise when you select 2 cups, the coffee may run out in drips.

**NOTE 3:** *Tips to make hotter coffee:*

- When you turn the appliance on, if you want to make a short coffee (less than 60 cc), use the hot rinse-through water to preheat the cups.  
If 2/3 minutes have passed since you last made coffee, before making coffee again you must preheat the infuser by pressing the  button (fig. 13).  
Run off the water into the underlying drip tray or alternatively use this water to fill (and then empty) the cup to be used for the coffee, so as to preheat it.
- Unless preheated, do not use cups that are too thick, as they will absorb too much heat.
- Use cups that have been preheated by rinsing them with hot water or by leaving them for at least 20 minutes on the cup warmer tray on top of the appliance with the appliance on.

**NOTE 4:** while the appliance is making the coffee, delivery can be stopped at any time by pressing the ,  or  button as previously selected.

**NOTE 5:** as soon as delivery is complete, to increase the quantity of coffee, simply press and hold the ,  or  button as previously selected, until the desired quantity is reached (this operation must be performed within 3 seconds from when coffee delivery from the spouts ceases).

**NOTE 6:** *when the appliance displays:*

#### FILL TANK

the water tank must be refilled or the appliance will not make coffee.

(It is normal for there to be a little water left in the tank when the message is displayed).

**NOTE 7:** every 14 single coffees (or 7 doubles) the appliance displays:

#### EMPTY GROUNDS CONTAINER

indicating that the grounds container is full and must be emptied and cleaned.

Until the grounds container has been cleaned, the appliance continues to display the message and cannot make coffee.

To clean, open the service door at the front by pulling the handle (fig. 14), remove the drip tray (fig. 15), empty and clean.

Empty the grounds container and clean thoroughly, making sure all residues deposited on the bottom are removed.

**IMPORTANT:** *when removing the drip tray, the grounds container MUST be emptied, even if it is not completely full. If this is not done, when next making coffee the grounds in the container may exceed the maximum level and block the appliance.*

**NOTE 8:** while the appliance is running off coffee, never remove the water tank. If it is removed, it will not be possible to make the coffee and the appliance will display:

#### GROUND TOO FINE ADJUST MILL AND

#### INSERT WATER SPOUT AND PRESS OK

To turn the appliance on again, you must insert the water spout (fig. 4), press the **OK** button and run off water from the spout for a few seconds.

**When using the appliance for the first time, 4-5 cups of coffee need to be made before the appliance starts to give satisfying results.**

**If the appliance malfunctions**, do not contact the service centre straight away.

The problem can almost always be resolved by following the instructions indicated in paragraphs 18 and 19. If this is not the case, or for further explanations, contact the customer service by calling the number listed on the sheet enclosed on page pag.2.

If your country is not listed on the sheet, call the number indicated on the warranty.

## 7 CHANGING THE QUANTITY OF COFFEE IN THE CUP

The appliance is factory preset to automatically deliver the following quantities of coffee:

- short coffee (40 ml) (when the ☕ button is pressed);
- normal coffee (80 ml) (when the ☕ button is pressed);
- long coffee (120 ml) (when the ☕ button is pressed);

To change these quantities, proceed as follows:

- press the button corresponding to the quantity you want to change ( ☕ , ☕ or ☕ ) for at least 8 seconds then release until the message "PROGRAM QUANTITY" is displayed and coffee is delivered;
- when the coffee in the cup reaches the required level, press the same button again to memorise the new amount.

The appliance is now re-programmed with the new settings and displays: READY.

## 8 REGULATING THE COFFEE MILL

The coffee grinder is preset in the factory to prepare coffee correctly and should not require regulating initially.

However, after making the first coffees, if you find that coffee delivery is either too fast or too slow (in drips), the grinding coarseness regulator can be adjusted (fig. 12).

Turning it 1 click (1 number) clockwise speeds up coffee delivery (without drips).

Turning 1 click anticlockwise slows down delivery giving a creamier appearance to the coffee.

These adjustments will only be evident after at least 2 cups of coffee have been run off.

The grinding coarseness regulator must only be turned when the coffee mill is on.

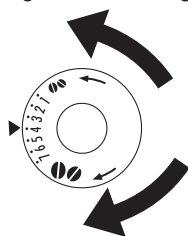

*Turn one click anticlockwise to obtain slower delivery and a creamier appearance (finer ground coffee).*





*Turn one click clockwise for faster delivery (not a drop at a time) (coarser ground coffee).*

(Coffee has been used to factory test the appliance and it is therefore completely normal for there to be traces of coffee in the mill. This appliance is however guaranteed to be new).

## 9 PREPARING ESPRESSO COFFEE WITH PRE-GROUND COFFEE (INSTEAD OF BEANS)

- Press the  button (fig. 16) to select the ground coffee function. This disables the coffee mill function. The appliance displays:

*READY PRE-GROUND*

- Lift the lid in the centre, place one measure of ground coffee in the funnel (see fig. 17) and proceed as described in section 6. NB: You can make just one coffee at a time by pressing the ,  or  button once only.
- After using the appliance with pre-ground coffee, to go back to making coffee using beans, deactivate the ground coffee function by repressing the  button to prepare the grinder for operation again.

**NOTE 1:** Never add the ground coffee when the appliance is off to avoid it from being dispersed inside the appliance.

**NOTE 2:** Never add more than 1 measure, otherwise either the appliance will not make the coffee and the ground coffee will be lost inside the appliance, dirtying it, or the coffee will run off in drips.



**NOTE 3:** When dosing the quantity of coffee to be added, use the measure supplied only.

**NOTE 4:** Use ground coffee for espresso coffee makers only. Do not use coffee beans, freeze-dried coffee or other materials that could damage the appliance.

**NOTE 5:** If you add more than one measure of ground coffee and the funnel blocks, use a knife to push the coffee down (fig. 18), then remove and clean the infuser and appliance as described in section 15.2 "Cleaning the infuser".

## 10 PRODUCING HOT WATER

- Always make sure the appliance is ready.
- Make sure the water spout is attached to the nozzle (fig. 4);
- Position a container under the spout (fig. 3).
- Press the  button (fig. 1).

The appliance displays:

*HOT WATER*

and hot water is run off from the water spout into the container below (you should not run off hot water for more than two minutes at a time). To stop the flow, press the  button. Once the set quantity of hot water has been reached, run-off stops automatically.

## 11 CHANGING THE QUANTITY OF HOT WATER

The appliance is factory preset to automatically deliver 250 ml of hot water.

To change these quantities, proceed as follows:

- Attach the water spout (fig. 4).
- Position a container under the spout (fig. 3).
- Press the  button for at least 8 seconds then release. The appliance displays:

*HOT WATER PROGRAM QUANTITY*

and hot water is run off from the water spout.

- When the hot water in the cup reaches the required level, press the  button to memorise the new amount. (You should not run off hot water for more than two minutes at a time).

## 12 PREPARING CAPPUCCINOS (FROTHED MILK AND COFFEE)

- Select the taste of the coffee you want to use to make the cappuccino by pressing the  button
- Remove the lid of the milk container.
- Fill the container with about 100 grams of milk for each cappuccino to be prepared (fig. 19). **Never exceed the MAX level (corresponding to about 750 ml) marked on the container.** You are recommended to use skimmed or semi-skimmed milk at refrigerator temperature (about 5° C).
- Make sure the intake tube is well inserted into the rubber washer (fig. 20), then replace the milk container lid.
- Remove the hot water spout (fig 21) and attach the milk container to the nozzle, making sure the arrow on the container lid is lined up with the arrow on the control panel of the appliance (fig. 22).
- Position the milk tube as shown in fig. 23 and then place a sufficiently large cup under the coffee and milk spouts (fig. 23).
- If you want to make cappuccino (frothed milk + coffee), place the froth regulator on the word "CAPPUCCINO" between the "-" and "+" symbols marked on the milk container lid.. To obtain a cappuccino with little froth, position the froth regulator near the "-" symbol. To obtain a cappuccino with a large amount of froth, position the froth regulator near the "+" symbol.
- If on the other hand you want to prepare a caffelatte (hot milk + coffee), position the froth regulator on CAFFELATTE

NOTE: You can adjust the quantity of milk froth by moving the regulator to an intermediate position..

- Press the  button (fig. 24). The appliance displays:

*CAPPUCCINO*

and after a few seconds, the frothed milk is run off from the milk spout into the cup below. (Run off stops automatically).

- The appliance then grinds the beans, delivers the coffee and displays the "ready" message again.
- The cappuccino is ready. Sweeten to taste and, if desired, sprinkle the froth with a little cocoa powder.

**NOTE 1:** While preparing the cappuccino, frothed milk or coffee run off can be interrupted by pressing button .

**NOTE 2:** If you run out of milk while delivering frothed milk, remove the container and refill it. Then put it back in place and press the  button to request a cappuccino again.

**NOTE 3:** To ensure the milk frother is absolutely clean and hygienic, after making cappuccinos, clean the channels inside the milk container lid:

- Place a recipient under the milk spout;
- Press the **CLEAN** button on the milk container lid down and hold down for at least 8 seconds (fig. 25). The appliance displays:

## CLEANING

After cleaning is complete, remove the milk container and place in the refrigerator. You should not leave the milk outside the refrigerator for more than 15 minutes.

**NOTE 4:** To change the quantity of coffee or frothed milk delivered automatically into the cup, follow the instructions in section 14.

### 13 PREPARING FROTHED MILK (WITHOUT COFFEE)

- Remove the lid of the milk container.
- Fill the container with the quantity of milk you want to prepare (fig. 19).
- Replace the milk container lid.
- Attach the milk container to the appliance (fig. 22).
- Place a sufficiently large cup under the milk spout (fig. 23).
- Press the  button twice (within 2 seconds). The appliance displays:

#### MILK FROTHING

and after a few seconds, the frothed milk is run off from the milk spout into the cup below.

- After run off, clean the channels inside the milk container by pressing the **CLEAN** button as described in the previous section (note 3).

### 14 CHANGING THE QUANTITY OF COFFEE AND MILK FOR CAPPUCCINOS

The appliance is factory preset to automatically a standard cappuccino. To change these quantities, proceed as follows:

- Fill the container with milk up to the maximum level indicated on the container.
- Press the  button for at least 8 seconds until the appliance displays:

#### MILK FOR CAPPUCCINO PROGRAM QUANTITY

Now release the button. The appliance starts to run off milk.

- Once the required quantity of milk has been run off, press the  button again. Milk delivery stops and the quantity is memorised. You should not run off frothed milk for more than 3 minutes at a time.
- After a few seconds, the appliance runs off coffee into the cup and displays:

#### COFFEE FOR CAPPUCCINO PROGRAM QUANTITY

- Once the required quantity of coffee has been run off, press the  button again. Coffee delivery stops and the quantity is memorised.

The appliance is now re-programmed with the new settings and displays: *READY*.

### 15 CLEANING AND MAINTENANCE

Before performing any cleaning operations, the appliance must have cooled down and must be disconnected from the mains power supply.

Never immerse the appliance in the water: it is an electrical appliance.

Do not use solvents or abrasive cleaning products to clean the appliance. A soft damp cloth will suffice.

NEVER wash ANY of the components of the appliance in a dishwasher.

#### 15.1 Cleaning the coffee maker

Clean the grounds container (as described in section 6, note 7) whenever it requires emptying.

The water tank should also be cleaned regularly.

The drip tray is fitted with a level indicator (red) showing the level of water it contains.

When the indicator starts to become visible (a few millimetres under the drip tray), the drip tray must be emptied and cleaned.

Check that the holes in the coffee spout are not blocked.

To unblock them, scrape the dry coffee residues away with a needle (fig. 27). Clean the nozzle regularly with a sponge as shown in fig. 26.

### 15.2 Cleaning the infuser

The infuser must be cleaned regularly to avoid the build-up of coffee encrustations which could cause mal-function. Proceed as follows:

- turn the appliance off by pressing the ① button (fig. 6) (do not unplug) and wait for the display to go off;
- open the service door (Fig. 14);
- remove the drip tray and the grounds container (Fig. 15) and clean them;
- press the two red release buttons on the infuser sideways and towards the centre (Fig. 28) and pull it out;
- **IMPORTANT: THE INFUSER CAN ONLY BE REMOVED IF THE APPLIANCE IS OFF.. ATTEMPTING TO REMOVE THE INFUSER WITH THE APPLIANCE ON MAY CAUSE SERIOUS DAMAGE.**
- wash the infuser under running water, without using detergents. Never wash the infuser in the dishwasher;
- carefully clean the inside of the appliance. To remove the coffee stuck to the parts inside the appliance, scrape it with a plastic or wooden fork (Fig. 29) and then pick up all the residues using a vacuum cleaner (Fig. 30);
- replace the infuser by sliding it onto the supports and pin at the bottom, then push the PUSH symbol fully in until it clicks into place.

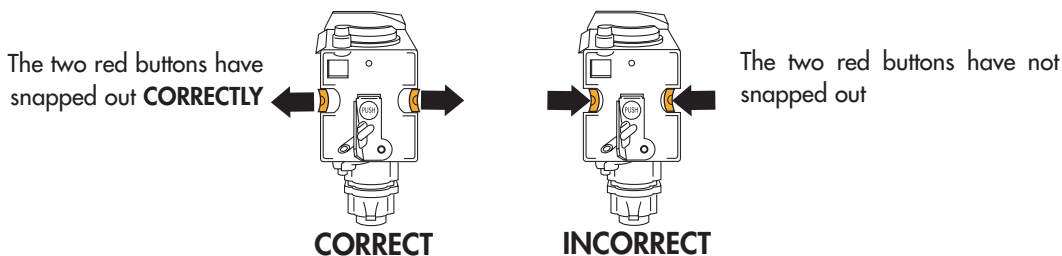
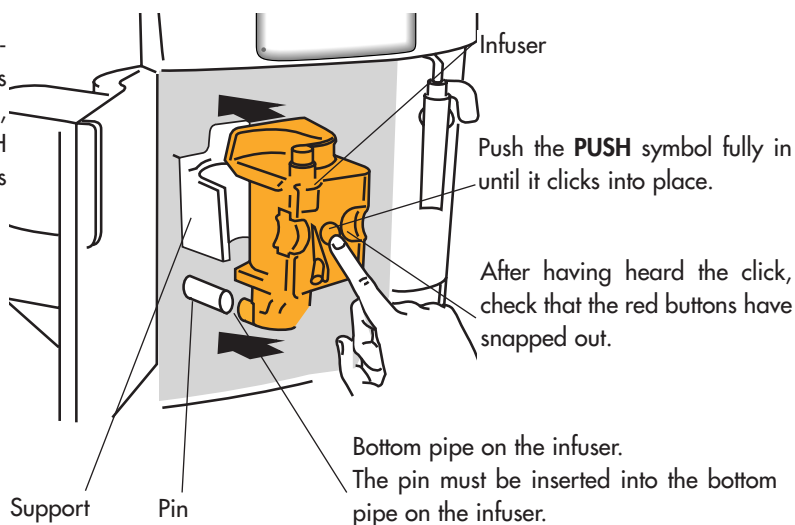

Check that the two red buttons have snapped out, otherwise the door cannot be closed.

- replace the drip tray, complete with the grounds container;
- close the service door.

**NOTE 1:** If the infuser is not inserted correctly until it clicks into place and the two red buttons have not snapped out, the service door cannot be closed.

**NOTE 2:** if it is hard to insert the infuser, before inserting it, squeeze to size by pressing it vigorously from above and below at the same time, as shown in Figure 31.

**NOTE 3:** If it is still hard to insert the infuser, leave it out of the appliance, close the service door, unplug from the mains, then plug in again. Wait for all the lights to go off after the self-diagnosis, then open the door and replace the infuser.

### 15.3 Cleaning the milk container

Proceed as follows:

- Remove the milk spout (fig. 32) and intake tube.
- Remove the froth regulator by pulling it outwards.

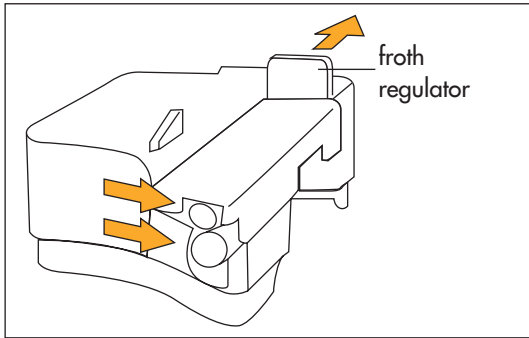

- Wash the container and lid in a dishwasher or in hot soapy water. Make sure there are no milk residues inside the two holes in the lid of the milk container indicated by the arrows in the figure.
- Put the froth regulator, intake tube and milk spout back in the milk container lid.

## 16 CHANGING AND SETTING THE MENU PARAMETERS

After pressing the **①** button, when the appliance is ready, you can use the internal menu to modify the following parameters and functions:

- Clock
- Auto-start time.
- Descaling process
- Coffee temperature
- Length of time the appliance remains on
- Water hardness
- Factory default values
- Washing process

### 16.1 Setting the clock

To set the clock, proceed as follows:

- Press the **MENU'** button (the light over the button comes on) then press the **NEXT** button repeatedly until the appliance displays:

*CLOCK 00:00*

- Press the **CHANGE** button to set the clock. (If you hold the **CHANGE** button down, the time is changed rapidly).
- Press the **OK** button to confirm the value;
- Press the **MENU'** button to exit programming mode or **NEXT** to change other parameters.

### 16.2 Setting auto-start time

This enables the time the appliance will come on automatically and be ready for use to be programmed.

- Make sure the clock on the appliance is set as described above.
- Press the **MENU'** button then press the **NEXT** button repeatedly until the appliance displays:

*START TIME 00:00*



- Press the **CHANGE** button to set the auto-start time. (If you hold the **CHANGE** button down, the time is changed rapidly).
- Press the **OK** button to confirm the value;
- Press **NEXT** once and the appliance displays the message:

*AUTO-START NO*

Press the **CHANGE** button to modify the function (the appliance displays: *AUTO-START YES*)

- Press the **OK** button to activate auto-start;

**NOTE:** when the appliance is turned off and auto-start time is set, the symbol  appears alongside the time on the unlit display.

- Press the **MENU'** button to exit programming mode or **NEXT** to change other parameters.

### 16.3 Descale

Over time, the continuous heating up of the water used to make the coffee leads to lime scale building up in the inner circuits of the appliance.

When the appliance displays the message:

*DESCALE*

you should perform the descale cycle.

Proceed as follows:

- make sure the appliance is ready.
- press the **MENU'** button (the light over the button comes on) then press the **NEXT** button repeatedly until the appliance displays:

*DESCALE NO*

- Press **CHANGE** and the appliance displays the message:

*DESCALE YES*

- Press the **OK** button to start the descale programme.
- Empty the water tank and add the contents of one bottle (125 ml) of DURGOL descaler plus **one litre of water**. For subsequent descaling, use descaler of the same type and brand as supplied (available from technical service centres authorised by the manufacturer).
- attach the water spout to the nozzle;
- place a container with a minimum capacity of 1.5 litres under the hot water spout (Fig. 3);
- press the **OK** button. Descaler runs off from the hot water spout into the container below. The appliance displays:

*APPLIANCE IN DESCALING*

- the descale programme automatically performs a series of run offs and pauses to remove lime scale deposits from inside the coffee maker.
- After about 30 minutes, the appliance displays:

*RINSING FILL TANK*

The appliance must now be rinsed through to eliminate residues of descaling solution from inside the appliance. Proceed as follows:

- empty the water tank, rinse and fill with clean water.
- Reposition the tank.
- Empty the full container and then put it back under the hot water spout.
- Press the **OK** button. Hot water is run off from the spout into the container below and the appliance displays:

## RINSING

- When the water tank is empty, the appliance displays the message:

*RISRINSING COMPLETE PRESS OK*

- Press the OK button and refill the water tank with clean water.
- The descale programme is now terminated and the appliance is ready to make coffee again.

**NOTE:** if the descaling cycle is interrupted before completion, the appliance continues to display the descale message and the programme must be started again from the beginning. Empty the water tank, rinse, fill with clean water and run off a cup of hot water.

**IMPORTANT:** FAILURE TO DESCALE THE APPLIANCE REGULARLY INVALIDATES THE GUARANTEE.

### 16.4 Changing coffee temperature

To change the temperature of the coffee, proceed as follows:

- Press the **MENU'** button (the light over the button comes on) then press the **NEXT** button repeatedly until the appliance displays:

*HIGH TEMPERATURE.*

- Press the **CHANGE** button until the appliance displays the required coffee temperature.
- Press the **OK** button to confirm the temperature selected;
- Press the **MENU'** button to exit programming mode or **NEXT** to change other parameters.

### 16.5 Changing the length of time the appliance remains on

The appliance is factory preset to go off automatically one hour after the last coffee has been made.

The number of hours the appliance remains on (max. 3) can be increased as follows:

- Press the **MENU'** button (the light over the button comes on) then press the **NEXT** button repeatedly until the appliance displays: OFF AFTER 1 HOUR.
- Press the **CHANGE** button to change the number of hours the appliance remains on.
- Press the **OK** button to confirm the value;
- Press the **MENU'** button to exit programming mode or **NEXT** to change other parameters.

### 16.6 Setting water hardness

The descale message is displayed after the appliance has been operated for a factory set period of time calculated on the basis of the maximum quantity of lime scale which may be contained in the water used.

If necessary, this period of operation can be extended, making descaling less frequent, by programming the appliance based on the actual lime content in the water used.

Proceed as follows:

- remove the "Total Hardness Test" strip (enclosed on page 2) from its packaging then dip it fully in the water for a few seconds. Remove it and wait around 30 seconds (until it changes colour and a number of red dots are formed);
- Turn the appliance on by pressing the **ⓘ** button (fig. 6).
- Press the **MENU'** button then press the **NEXT** button repeatedly until the appliance displays:

*WATER HARDNESS 4*

- Press the **CHANGE** button repeatedly until the number coincides with the number of red squares on the test strip (for example, if there are 3 red squares on the test strip, press the button until WATER HARDNESS 3 is displayed).
- Press the **OK** button to confirm the value; The coffee maker is now programmed to provide the descaling warning when necessary, based on the actual hardness of the water.

## 16.7 Resetting factory default settings (reset)

If you change the original values, the factory default values can be reset as follows:

- Press the **MENU'** button then press **NEXT** repeatedly until the appliance displays:

**RESET TO DEFAULT NO**

- Press the **CHANGE** button and the appliance displays "RESET TO DEFAULT YES:
- Press the **OK** button to reset the factory default values;
- The appliance is now reset to the factory default settings and the **READY** message is displayed.

## 16.8 Washing process

This function can be used by technical service personnel only.

## 17 CHANGING THE LANGUAGE

To change the language, press the **CHANGE** button for at least 5 seconds until the appliance displays the installation message in various languages. To select the required language, follow the instructions in section 4.1 :

## 18 MEANING OF MESSAGE DISPLAYED AND WHAT TO DO

MESSAGE	MEANING	WHAT TO DO
<i>FILL TANK</i>	<ul style="list-style-type: none"> <li>• The water tank is empty or is positioned incorrectly.</li> <li>• The tank is dirty or encrusted with lime scale.</li> </ul>	<ul style="list-style-type: none"> <li>• Fill the water tank as described in section 6, note 6 and insert it fully.</li> <li>• Rinse or descale the tank.</li> </ul>
<i>GROUND TOO FINE ADJUST MILL AND INSERT WATER SPOUT AND PRESS OK</i>	<ul style="list-style-type: none"> <li>• The appliance cannot make coffee</li> <li>• The coffee runs off too slowly.</li> </ul>	<ul style="list-style-type: none"> <li>• Insert the hot water spout, press the  button and run off water from the spout for a few seconds.</li> <li>• Turn the grinding regulator (fig. 12) one click clockwise (see section 8).</li> </ul>
<i>EMPTY GROUNDS CONTAINER</i>	<ul style="list-style-type: none"> <li>• The grounds container is full or missing.</li> </ul>	<ul style="list-style-type: none"> <li>• Empty the grounds container and clean as described in section 6, note 7, then replace.</li> </ul>
<i>INSERT GROUNDS CONTAINER</i>	<ul style="list-style-type: none"> <li>• After cleaning, the grounds container has not been replaced.</li> </ul>	<ul style="list-style-type: none"> <li>• Open the service door and insert the grounds container.</li> </ul>
<i>ADD PRE-GROUND COFFEE</i>	<ul style="list-style-type: none"> <li>• With the function selected, the pre-ground coffee has not been poured into the funnel.</li> </ul>	<ul style="list-style-type: none"> <li>• Add the ground coffee as described in section 9.</li> </ul>
<i>FILL BEANS CONTAINER</i>	<ul style="list-style-type: none"> <li>• The coffee beans have run out.</li> <li>• If the coffee grinder is very noisy, this means a small stone in the coffee beans has blocked the mill.</li> </ul>	<ul style="list-style-type: none"> <li>• Fill bean container</li> <li>• Contact an authorised De' Longhi service centre</li> </ul>
<i>DESCALE</i>	<ul style="list-style-type: none"> <li>• This indicates the presence of lime scale in the appliance.</li> </ul>	<ul style="list-style-type: none"> <li>• The descaling procedure, described in section 16.3, needs to be performed as soon as possible.</li> </ul>

MESSAGE	MEANING	WHAT TO DO
<i>PRESSNEXT CHANGE</i>	<ul style="list-style-type: none"> <li>After cleaning, the infuser has probably been left out of the coffee maker.</li> </ul>	<ul style="list-style-type: none"> <li>Leave the service door closed and the infuser out of the appliance, then follow the instructions displayed.</li> </ul>
<i>CLOSE DOOR</i>	<ul style="list-style-type: none"> <li>The service door is open</li> </ul>	<ul style="list-style-type: none"> <li>If the service door cannot be closed, check that the infuser is inserted correctly (section 15.2 - note 1)</li> </ul>
<i>INSERT INFUSER ASSEMBLY</i>	<ul style="list-style-type: none"> <li>After cleaning, the infuser has probably been left out of the coffee maker.</li> </ul>	<ul style="list-style-type: none"> <li>Insert the infuser, see section 15.2</li> </ul>
<i>LESS COFFEE</i>	<ul style="list-style-type: none"> <li>The ground coffee funnel is clogged.</li> <li>Too many coffee beans or too much ground coffee has been added.</li> </ul>	<ul style="list-style-type: none"> <li>Empty the funnel with the help of a knife, as described in section 9 note 5 (Fig.18).</li> <li>Select a milder taste or reduce the quantity of ground coffee, then run off the coffee again.</li> </ul>
<i>GENERIC ALARM</i>	<ul style="list-style-type: none"> <li>The inside of the appliance is very dirty.</li> </ul>	<ul style="list-style-type: none"> <li>Clean the inside of the appliance thoroughly, as described in section 15.2. If the message is still displayed after cleaning, contact a service centre.</li> </ul>

## 19 PROBLEMS TO BE RESOLVED BEFORE CALLING THE SERVICE CENTRE

If the appliance is not working and an alarm light is on, the causes of the malfunction can be identified and resolved by referring to section 18.

If, on the other hand, no alarm light is on, run the following checks before calling the service centre.

PROBLEM	CAUSE	SOLUTION
The coffee is not hot	<ul style="list-style-type: none"> <li>The cups have not been preheated..</li> <li>The infuser is too cold</li> </ul>	<ul style="list-style-type: none"> <li>Heat the cups by rinsing them in hot water or leaving them to rest for at least 20 minutes on the cup warmer tray on the lid (see section 6, note 3).</li> <li>Heat the infuser by pressing the  button (fig. 13) before making the coffee (see section 6, note 3).</li> </ul>
The coffee is not creamy enough	<ul style="list-style-type: none"> <li>The coffee is ground too coarsely</li> <li>Wrong type of coffee</li> </ul>	<ul style="list-style-type: none"> <li>Turn the grinding adjustment knob one click anticlockwise (see section 8).</li> <li>Use a type of coffee for espresso coffee makers.</li> </ul>
The coffee runs out too slowly.	<ul style="list-style-type: none"> <li>The coffee is ground too finely.</li> </ul>	<ul style="list-style-type: none"> <li>Turn the grinding adjustment knob one click anticlockwise (see section 8).</li> </ul>
The coffee runs out too quickly.	<ul style="list-style-type: none"> <li>The coffee is ground too coarsely.</li> </ul>	<ul style="list-style-type: none"> <li>Turn the grinding adjustment knob one click anticlockwise (see section 8).</li> </ul>
The coffee does not come out of one of the spouts.	<ul style="list-style-type: none"> <li>The spout holes are blocked.</li> </ul>	<ul style="list-style-type: none"> <li>Scrape the remains of dry coffee accumulated with a needle (Fig. 27).</li> </ul>

PROBLEM	CAUSE	SOLUTION
When the ☕, ☕ and ☕ buttons are pressed, the appliance does not deliver coffee, but only water.	<ul style="list-style-type: none"> <li>The ground coffee may be blocked in the funnel.</li> </ul>	<ul style="list-style-type: none"> <li>Remove the ground coffee inside the funnel using a knife (see note 5, section 9). Then clean the infuser and the inside of the appliance (see description in section 11.2)</li> </ul>
When the ① button is pressed, the appliance does not come on.	<ul style="list-style-type: none"> <li>The appliance is not plugged in.</li> </ul>	<ul style="list-style-type: none"> <li>Check that the power cable is plugged into the mains socket</li> </ul>
The infuser cannot be removed for cleaning.	<ul style="list-style-type: none"> <li>The appliance is on. The infuser can only be removed if the appliance is off</li> </ul>	<ul style="list-style-type: none"> <li>Turn the appliance off and remove the infuser (see section 15.2). <b>IMPORTANT:</b> the infuser can only be removed if the appliance is off. Attempting to remove the infuser with the appliance on will risk causing damage.</li> </ul>
Pre-ground coffee is being used (not beans) and the appliance does not deliver coffee.	<ul style="list-style-type: none"> <li>Too much ground coffee has been added.</li> <li>The ☕ button has not been pressed and the appliance has used both the ground coffee added and the coffee ground by the grinder.</li> <li>Ground coffee has been added when the appliance is off.</li> </ul>	<ul style="list-style-type: none"> <li>Remove the infuser and thoroughly clean the inside of the appliance, as described in section 15.2. Repeat the operation using a maximum of 1 measure of ground coffee.</li> <li>Thoroughly clean the inside of the appliance, as described in section 15.2. Repeat the operation, first pressing the ☕ button as described in section 9.</li> <li>Remove the infuser and thoroughly clean the inside of the appliance, as described in section 15.2. Repeat the operation, but switch the appliance on first.</li> </ul>
The coffee does not come out of the spouts, but rather around the service door.	<ul style="list-style-type: none"> <li>The holes in the spouts are clogged with dry coffee.</li> <li>The mobile drawer inside the service door is blocked and cannot swing.</li> </ul>	<ul style="list-style-type: none"> <li>Scrape the holes with a needle (see section 15.1, Fig. 27).</li> <li>Thoroughly clean the mobile drawer, particularly near the hinges to ensure they are free to swing smoothly.</li> </ul>
The milk does not run out of the milk spout.	<ul style="list-style-type: none"> <li>The intake tube is not inserted or is inserted incorrectly.</li> </ul>	<ul style="list-style-type: none"> <li>Insert the intake tube in the rubber washer in the milk container lid (fig. 20).</li> </ul>
The milk is not well frothed.	<ul style="list-style-type: none"> <li>The milk container lid is dirty.</li> </ul>	<ul style="list-style-type: none"> <li>Clean the milk lid as described in section 15.3.</li> </ul>
The milk contains bubbles or squirts out of the milk spout.	<ul style="list-style-type: none"> <li>The milk is not cold enough or is not skimmed or semi-skimmed.</li> </ul>	<ul style="list-style-type: none"> <li>Use skimmed or semi-skimmed milk at refrigerator temperature. If you are still not getting the required results, try changing brand of milk.</li> </ul>