

# Maxi-Cosi CabrioFix

www.maxi-cosi.com



- GB** Instructions for use/Warranty
- F** Mode d'emploi/Garantie
- D** Gebrauchsanweisung/Garantie
- NL** Gebruiksaanwijzing/Garantie
- E** Modo de empleo/Garantía
- I** Istruzioni per l'uso/Garanzia
- P** Modo de emprego/Garantia
- PL** Instrukcja obsługi/Gwarancja

The safe world of Maxi-Cosi



# Maxi-Cosi CabrioFix

<b>GB</b>	<b>Instructions for use / warranty</b>	<b>7 - 19</b>
<b>F</b>	<b>Mode d'emploi / garantie</b>	<b>20 - 33</b>
<b>D</b>	<b>Gebrauchsanweisung / Garantie</b>	<b>34 - 47</b>
<b>NL</b>	<b>Gebruiksaanwijzing / garantie</b>	<b>48 - 61</b>
<b>E</b>	<b>Modo de empleo / garantía</b>	<b>62 - 75</b>
<b>I</b>	<b>Istruzioni per l'uso / garanzia</b>	<b>76 - 88</b>
<b>P</b>	<b>Modo de emprego / garantia</b>	<b>89 - 102</b>
<b>PL</b>	<b>Instrukcja obsługi/Gwarancja</b>	<b>103 - 116</b>

## Contents

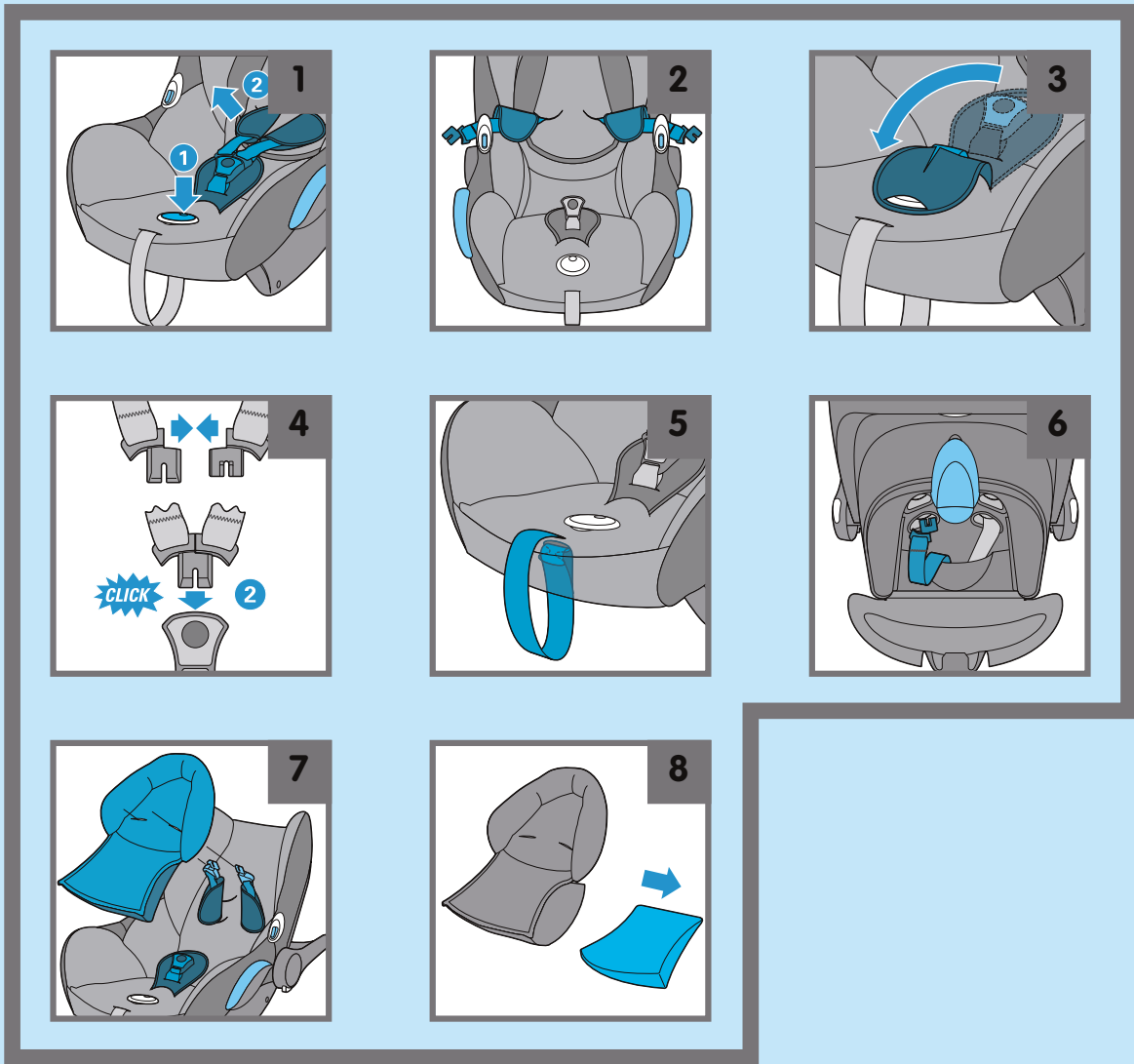

# Illustrations

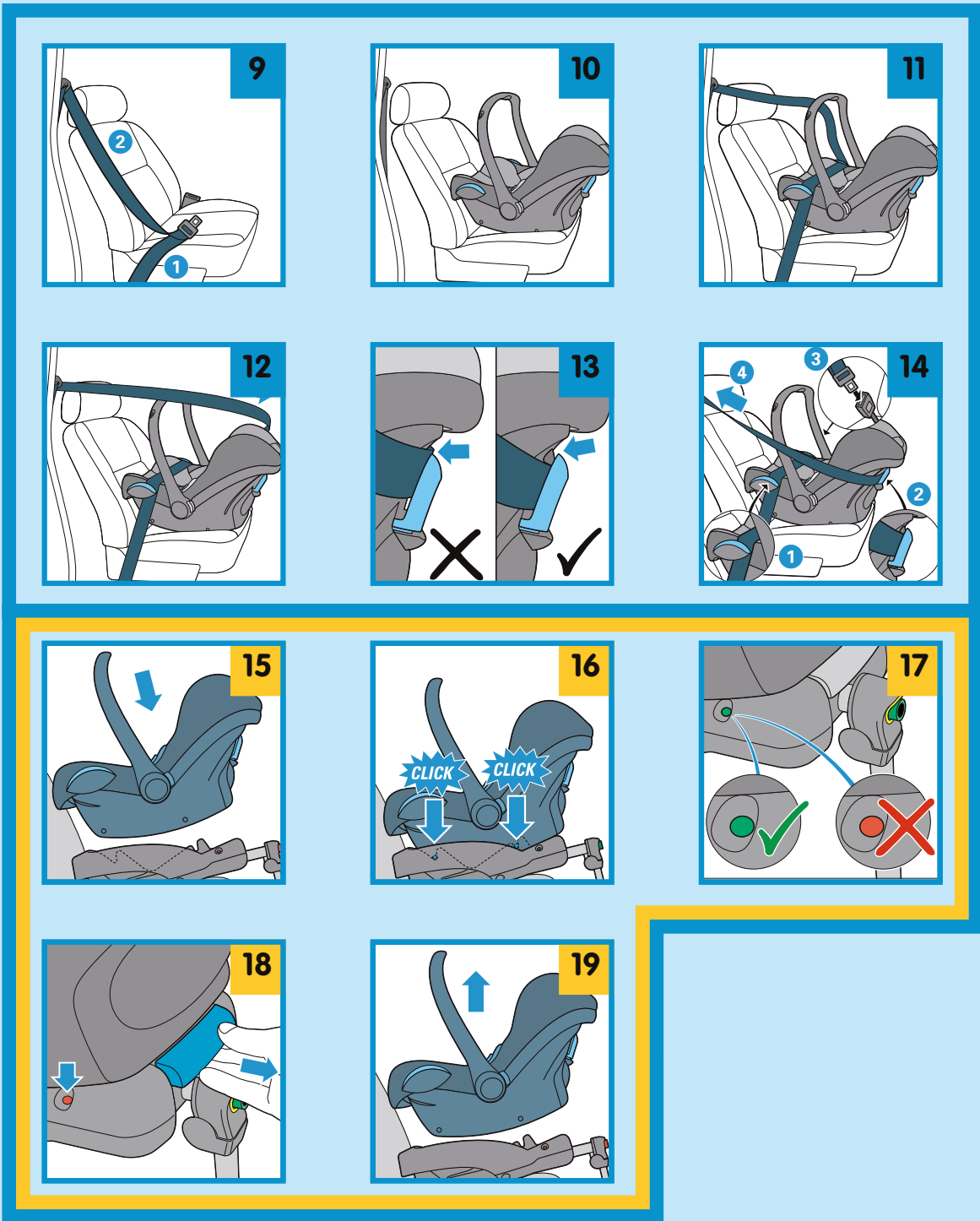

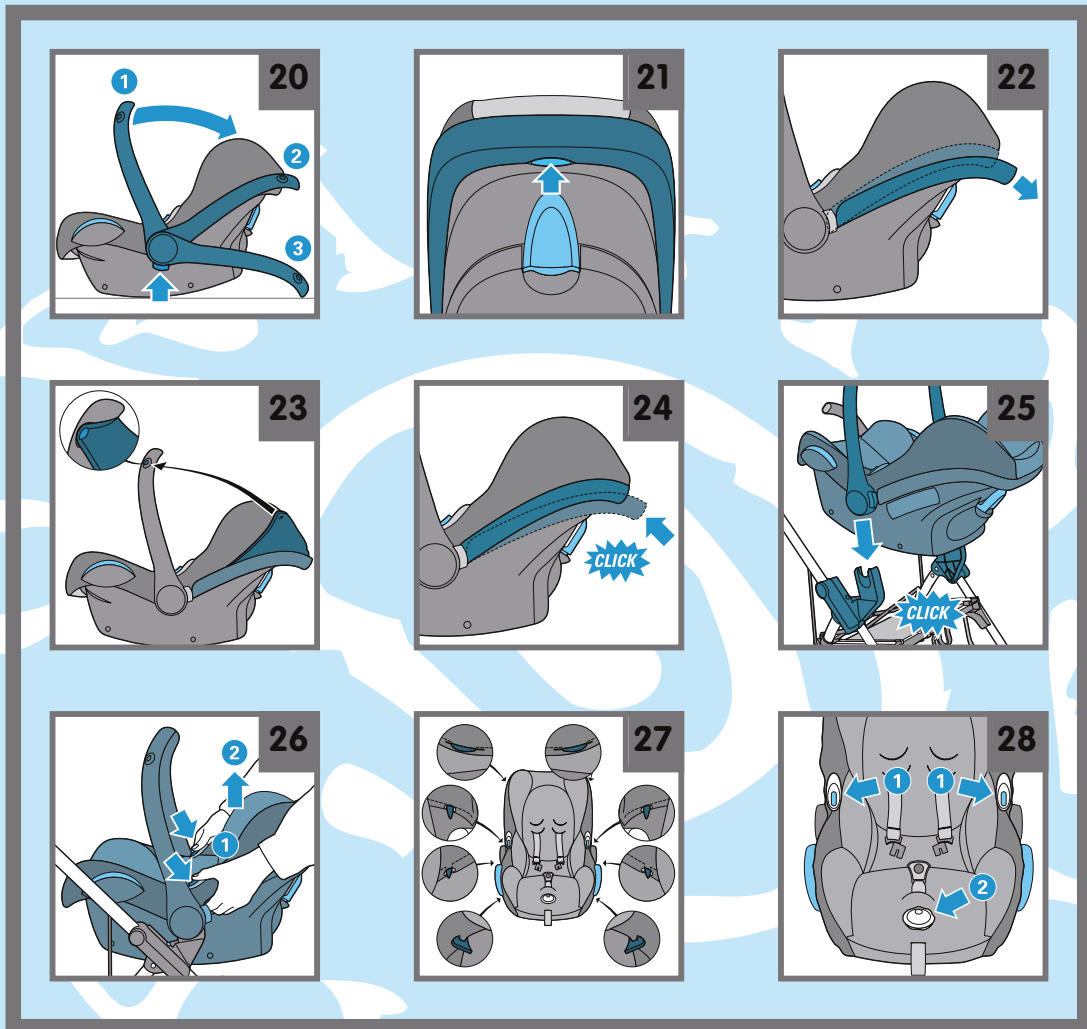

# Illustrations

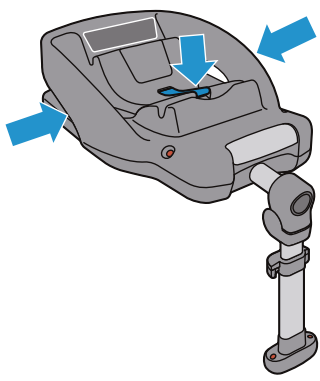
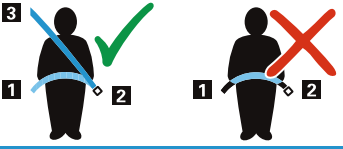
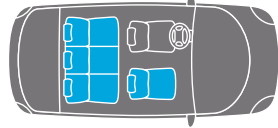

# Illustrations

 <p><i>IsoFix class E</i></p>		<ul style="list-style-type: none"> <li>Installed on seats fitted with Isofix anchor points (located between seat and seat back) &amp; with room for the support leg</li> </ul>	Yes
		<ul style="list-style-type: none"> <li>Isofix installation marking</li> </ul>	Yellow
		<ul style="list-style-type: none"> <li>Frontal airbag</li> <li>Side airbag</li> </ul>	No Yes

		<ul style="list-style-type: none"> <li>Installation with 3-point safety belt</li> <li>Installation with 2-point safety belt</li> </ul>	Yes No
		<ul style="list-style-type: none"> <li>On passenger seat</li> <li>On left/right side of back seat</li> <li>In middle position of back seat</li> </ul>	Yes Yes Yes
		<ul style="list-style-type: none"> <li>Belt routing marking</li> </ul>	Blue
		<ul style="list-style-type: none"> <li>Frontal airbag</li> <li>Side airbag</li> </ul>	No Yes

[www.maxi-cosi.com](http://www.maxi-cosi.com)

## Dear parents

Congratulations on the purchase of the Maxi-Cosi CabrioFix.

Safety, comfort and user-friendliness played an important role in developing the Maxi-Cosi CabrioFix. This product meets the most stringent safety requirements.

Studies have shown that a large percentage of car seats are not installed correctly. Your child's safety can only be guaranteed if this product is used according to these instructions. Therefore, please take time to read through this manual carefully.

Continuous research by our product development team, supported by intensive contract and consultation with test persons and consumers ensure that we kept full up-to-date in the field of child safety. If you have any questions or comments on the use of the Maxi-Cosi CabrioFix, please do not hesitate to contact us.

Dorel (see the back of the instruction manual for address and telephone number)

GB

# English

7

1. Shell
2. Belt buckle
3. A Crotch strap with belt pad
3. B Shoulder belts with belt pads
4. Slots to adjust shoulder belts
5. Support pillow
6. Carrying handle
7. Push button for adjusting carrying handle
8. Belt hook for lap section of safety belt
9. Rear belt hook for shoulder section of safety belt
10. Belt strap for adjusting shoulder belts easily with one
11. Control button of the quick adjuster
12. Control button for attaching car seat to Maxi-Cosi or Quinny frame
13. Belt hooks to hang up shoulder belts
14. Instructions and airbag warning sticker
15. Rim (for storing sun canopy)
16. Sun canopy (built-in)
17. Instruction manual
18. Storage compartment
19. Attachment rods

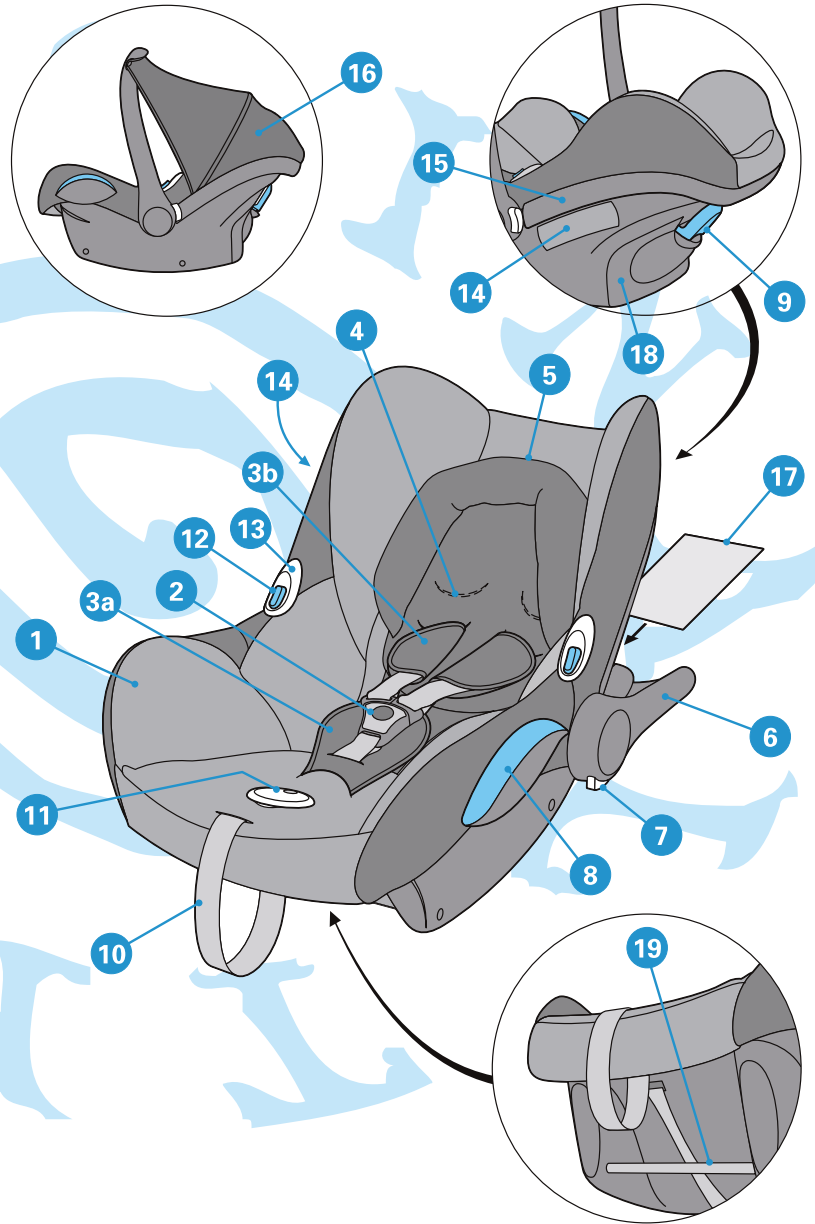



## CONTENTS

1.	IMPORTANT: READ FIRST! .....	9
2.	INSTRUCTIONS FOR USE IN THE CAR .....	11
3.	PLACING YOUR BABY IN THE MAXI-COSI CABRIOFIX .....	12
4.	INSTALLING THE MAXI-COSI CABRIOFIX IN YOUR CAR .....	13
4.1	Installing the Maxi-Cosi CabrioFix with a safety belt .....	13
4.2	Installing and removing the Maxi-Cosi CabrioFix when used with Maxi-Cosi EasyFix or Maxi-Cosi EasyBase .....	14
5.	GENERAL .....	15
5.1	Carrying handle positions .....	15
5.2	Sun canopy .....	15
5.3	Attaching the Maxi-Cosi CabrioFix to the Maxi-Cosi or Quinny frame .....	15
5.4	Removing the Maxi-Cosi CabrioFix from the Maxi-Cosi or Quinny frame .....	15
6.	MAINTENANCE .....	16
6.1	General .....	16
6.2	Removing the cover .....	16
6.3	Refitting the cover .....	16
7.	WASTE SEPARATION .....	16
8.	CAR SEATS .....	17
9.	WARRANTY .....	18
10.	QUESTIONS .....	19

### 1. IMPORTANT: READ FIRST!

- **WARNING** Read this instruction manual carefully. Study the illustrations in this manual closely before and during installation. The Maxi-Cosi CabrioFix is a safety product that is only safe when used according to the instructions given in this manual.
- To prevent your child from falling out of the seat, always check to make sure the carrying handle is "clicked" into the carrying position before lifting the seat. Also make sure your child is always strapped in securely with the harness belt!
- **WARNING** For the future use of the car seat, it is important that you store this instruction manual in the space provided.
- **WARNING Never** leave a child unattended in the car seat while in the car or elsewhere.

# Instructions for use

- **WARNING** The correct rooting of the seat belt, along the blue markings on the Maxi-Cosi CabrioFix, is essential for your child's safety. Please see the Installation section and / or the sticker on the side of the Maxi-Cosi CabrioFix. Never thread the belt in any other way.
- **WARNING Never use the Maxi-Cosi CabrioFix on a seat equipped with a front airbag**, as this can result in the death or injury of the baby. This does not apply to so-called side airbags.
- When installing with the seat belt only use the Maxi-Cosi CabrioFix on a front-facing seat that has been provided with an automatic or static 3-point belt, provided it has been approved according to the ECE R16 standard or similar.
- The Maxi-Cosi CabrioFix may be used in the front seat and in the back seat. Always place the Maxi-Cosi CabrioFix rearward facing. Lock rear seats that fold down.
- **WARNING** Do not leave the Maxi-Cosi CabrioFix with a child in it on a raised surface, such as a table, work top, bed, or shopping trolley, due to the risk of falling.
- **Always** secure your child with the harness belt, even when the seat is not fitted in the car.
- Do not leave your baby in the Maxi-Cosi CabrioFix for more than a few hours at a time. It is important for proper motor and muscle development that you place your baby on his stomach or back regularly.
- The seat may become unsafe after an accident due to damage that is not immediately noticeable. It should therefore be replaced.
- The manufacturer can only guarantee the safety of the seat if it is used by the original owner.
- We strongly advise against using a second-hand product, as you can never be sure of its history.
- We recommend that car seats not be used longer than 5 years after the date of purchase. The properties of the product may deteriorate due to, for example, ageing of the plastic (as a result of sunlight, for instance) and this may not be visible.
- The moving parts of the Maxi-Cosi CabrioFix should not be lubricated in any way.
- No alterations may be made to the Maxi-Cosi CabrioFix, as this could affect part or the overall safety of the seat.
- The Maxi-Cosi CabrioFix must not be used without its cover. Always use an original Maxi-Cosi CabrioFix cover, as the cover contributes to the safety of the seat.
- In order to prevent damage to the cover, do not remove the logos or airbag sticker.
- The Maxi-Cosi CabrioFix has been approved according to the most recent guidelines of the **ECE R 44/04: June 2005**, the European standard for car safety seats. The Maxi-Cosi CabrioFix can be used alone or in combination with the Maxi-Cosi EasyFix or the Maxi-Cosi EasyBase and is suitable for children from birth to approximately 12 months (group 0+: 0 to 13 kg).

	Suitability according to ECE R 44/04			
	Group	Body weight of child	Age	
<b>Maxi-Cosi CabrioFix</b>	0+	0 – 13 kg	0 – approx. 12 months	Universal
<b>Maxi-Cosi CabrioFix + Maxi-Cosi EasyFix</b>	0+	0 – 13 kg	0 – approx. 12 months	Semi-universal*
<b>Maxi-Cosi CabrioFix + Maxi-Cosi EasyBase</b>	0+	0 – 13 kg	0 – approx. 12 months	Semi-universal*

\* A base is used that has a support leg and / or IsoFix, which ensure optimum safety and easy installation Important! These bases, Maxi-Cosi EasyFix and Maxi-Cosi EasyBase, are not suitable for all types of cars. The Maxi-Cosi EasyFix / Maxi-Cosi EasyBase are designated as “**semi-universal**” and therefore suitable for installation on the seats of certain cars as stated on the car fitting list at [www.maxi-cosi.com](http://www.maxi-cosi.com)

## 2. INSTRUCTIONS FOR USE IN THE CAR

- Always check to make sure the seat fits in your car properly before purchasing it.
- The seat must always be secured, even when not in use. An unsecured seat can injure other passengers in the car in the event of an emergency stop.
- If the seat belt is height adjustable, adjust it to the lowest position.
- When installing the Maxi-Cosi CabrioFix on the passenger seat, position the car seat in the rearmost position. The backrest must be in a fully upright position and the headrest down. When not using the Maxi-Cosi CabrioFix, the passenger seat (and headrest) may be adjusted as required.
- Prevent damage to the seat by not wedging it between or underneath heavy luggage, adjustable seats or slamming the car door etc.
- Make sure that you properly secure all luggage and other objects likely to cause injury in the event of an accident.
- Always cover the seat when the car is parked in the sun, as plastic and metal parts can become very hot and the cover may become discoloured.
- Always use a car seat, even for short trips, as this is when most accidents occur.
- **NEVER** hold a baby on your lap while driving. Due to the enormous forces released in an accident, it will be impossible to hold onto the baby.
- Never use the same seat belt to secure yourself and the child.

# Instructions for use

### 3. PLACING YOUR BABY IN THE MAXI-COSI CABRIOFIX

- 1 • Loosen the shoulder belts by pressing the quick adjuster button (1,1) and pulling the shoulder belts towards you (1,2).
- 2 3 • Release the belt buckle and drape the belts with the tongue sections over the hooks (2) and pull the buckle forward, attach the loop of the belt pad over the edge of the quick adjuster button (3).
  - Make sure there are no toys or other hard objects in the shell.
  - Position your baby comfortably in the Maxi-Cosi CabrioFix.
- 4 • Join the buckle tongue sections together and insert them into the buckle (until it clicks) (4).
- 5 • Pull the shoulder belts tight using the quick adjuster belt strap on the front. The loop can be secured under the shell rim (5).

#### A. Adjusting the height of the shoulder belts

The shoulder belts should run through the slots located directly above the baby's shoulders.

- 6 • Open the door of the storage compartment (6).
- Pull the shoulder belts through the slots in the shell and cover.
- Place the shoulder belts back, at the required height and use the same slots in both the shell and the cover.
- Check to make sure the belts can be used properly and that they are not twisted.

#### IMPORTANT!

- The more tightly the belts are fastened around the child, the better the protection. You should be able to fit no more than one finger between the belts and your child.
- The belts should never be twisted or damaged.
- When positioning the baby make sure that he/she does not sit on the belts by hanging them to the side behind the belt hooks. Hook the belt pad of the belt that goes between the legs behind the edge of the quick adjuster.
- If you are unable to fasten the harness belts properly or pull them tightly, contact your supplier immediately. Do not use the Maxi-Cosi CabrioFix under any circumstances!

#### B. Removable seat insert

- 7 8 • The Maxi-Cosi CabrioFix has a removable seat insert (7) to create a flatter lying position for newborn babies and support the head in a sideways direction. When the baby is (approx 4 or 5 months) remove the filling block (8) to make the seat deeper, then you can still use the head support.

## 4. INSTALLING THE MAXI-COSI CABRIOFIX IN YOUR CAR

### 4.1 Installing the Maxi-Cosi CabrioFix with a safety belt

The Maxi-Cosi CabrioFix can be fitted safely on almost all forward-facing seats in the car using the existing seat belts. However, the belts are fitted so far forward on some seats that proper installation is not possible. If this is the case, try another seat.

In some cases, the buckle of the safety belt may be too long and therefore sits too high against the base of the Maxi-Cosi CabrioFix, making it difficult to install the Maxi-Cosi CabrioFix securely. If this is the case, choose another position in the car. Contact your supplier with any questions.

		<ul style="list-style-type: none"> <li>• Installation with 3-point safety belt</li> <li>• Installation with 2-point safety belt</li> </ul>	<p>Yes No</p>
		<ul style="list-style-type: none"> <li>• On passenger seat</li> <li>• On left/right side of back seat</li> <li>• In middle position of back seat</li> </ul>	<p>Yes Yes Yes*</p>
		<ul style="list-style-type: none"> <li>• Belt routing marking</li> </ul>	<p>Blue</p>
		<ul style="list-style-type: none"> <li>• Frontal airbag</li> <li>• Side airbag</li> </ul>	<p>No Yes</p>

\*if there is a seat belt present in the middle position of the back seat.

- 9 Important!** Do not mix up hip (9,1) and shoulder part (9,2)!
- 10** • Place the Maxi-Cosi CabrioFix in a rearward-facing position on the seat, therefore with the back forward facing. The carrying handle must be locked in an upright position (10).
- 11** • Thread the lap section of the seat belt across the front (foot end) between the shell and two blue belt hooks (11).

# Instructions for use

- 12 13 • Place the shoulder section of the seat belt around the Maxi-Cosi CabrioFix and slide it into the blue belt hook on the back (12). The retaining hook holds the seat belt in place (13). Insert the tongue section into the buckle (14,3).
- 14 • Make sure the seat belt is not twisted. Tighten it as much as possible.
- Check again to make sure the seat belt is threaded through all three blue belt hooks.

#### 4.2 Installing and removing the Maxi-Cosi CabrioFix when used with the Maxi-Cosi EasyFix or Maxi-Cosi EasyBase

The “click-and-go” installation on the Maxi-Cosi EasyFix and on the Maxi-Cosi EasyBase reduces the likelihood of incorrect installation in the car.

The Maxi-Cosi EasyFix or Maxi-Cosi EasyBase should be installed first of all.

**WARNING:** To install or to remove the Maxi-Cosi EasyFix and Maxi-Cosi EasyBase see the instruction manual of the Maxi-Cosi EasyFix and Maxi-Cosi EasyBase. The safety of your child is only guaranteed if the seat is used correctly. It is therefore important that you take the time to read these instructions through carefully. However, if you do not have the above mentioned instructions, contact our service point in your country or download the necessary information from our internet site: [www.maxi-cosi.com](http://www.maxi-cosi.com).

##### A. Installing the Maxi-Cosi CabrioFix

- 15 • Position the Maxi-Cosi CabrioFix facing backwards (rearward-facing) on the Maxi-Cosi EasyFix / Maxi-Cosi EasyBase (15). The carrying handle should be in the upright position.
- 16 • Click the Maxi-Cosi CabrioFix with its 2 attachment rods onto the Maxi-Cosi EasyFix / Maxi-Cosi EasyBase (16).
- 17 • **NOTE!** A clear click should be audible and the indicators on the side of the base should now be completely on **green** (17).
- **NOTE!** Under no circumstances should this product be used if the indicator remains on red. Carry out the above actions again. In case of doubt or if you have any questions, contact the supplier.
- Check that the Maxi-Cosi CabrioFix has been installed correctly by pulling on it.

##### B. Removing the Maxi-Cosi CabrioFix

- 18 • Unlock the Maxi-Cosi CabrioFix by pulling the release lever upwards and at the same time forwards (18).
- 19 • The Maxi-Cosi CabrioFix can now be taken out of the Maxi-Cosi EasyFix / Maxi-Cosi EasyBase (19).

## 5. GENERAL

### 5.1 Carrying handle positions

- The carrying handle can be adjusted into 3 positions.
- 20 • Press the buttons on both sides of the carrying handle at the same time and then adjust the carrying handle to the desired position (20). The buttons will pop up again once the handle is in place.
  1. Carrying position/driving position
  2. Sleeping position/rocking position
  3. Sitting position

### 5.2 Sun canopy

The sun canopy is located in the rim of the shell.

- Place the carrying handle in the carrying position.
- 21 • Open the rim by pushing the button at the back under the rim (21) and releasing it.
- 22 • The sun canopy is now visible in the opening (22).
- 23 • Pull it out and place the ends of the sun canopy with the buttonholes over the hooks on the carrying handle (23).
- 24 • When storing the sun canopy, make sure you place it in the rim carefully and close the rim properly (click) (24).

**Important!** The Maxi-Cosi CabrioFix is sometimes carried by the rim, therefore check that it is closed properly.

### 5.3 Attaching the Maxi-Cosi CabrioFix to the Maxi-Cosi or Quinny frame

- 25 • Unfold the frame and place the Maxi-Cosi CabrioFix with the upper section in the direction of traffic on the adapters of the unfolded frame until the Maxi-Cosi CabrioFix clicks into place (25).
- Check to make sure the Maxi-Cosi CabrioFix is attached securely.

### 5.4 Removing the Maxi-Cosi CabrioFix from the Maxi-Cosi or Quinny frame

- Place your thumbs on the control buttons on both sides of the Maxi-Cosi CabrioFix.
- 26 • Push in the buttons while lifting the Maxi-Cosi CabrioFix from the frame (26).

## **6. MAINTENANCE**

### **6.1 General**

Remove the car seat from the car before carrying out any maintenance work.

- The seat can be cleaned with soap and lukewarm water. Do not use any abrasive detergents.
- The belt buckle can be cleaned using warm water. Do not lubricate.
- The cover must be washed by hand (maximum 30°C). Do not use a dryer (also see washing instructions).
- **Important!** Never remove the energy absorbing foam.

**Tip:** It is advisable to buy an extra cover when purchasing the Maxi-Cosi CabrioFix, so that you can continue using it even when the cover is being washed or dried.

### **6.2 Removing the cover**

- First remove the belt pads.
- 21** **22** • Open the rim at the sun canopy as far as possible (21 & 22).
- 27** • Remove the cover from the hooks (8x) (27).
- 28** • Remove the cover then from under the hooks and quick adjuster button (28).
- Pull the buckle tongue sections and adjustment strap through the openings.

### **6.3 Refitting the cover**

- To refit the cover, carry out the above instructions in reverse order.
- Make sure that the lower section of the cover flaps over the uppersection.
- When closing the rim, make sure the sun canopy is stored properly in the rim.
- Fasten the adjustment strap under the shell again.

## **7. WASTE SEPARATION**

To ensure optimum and safe use of car safety seats, they should not be used for longer than 5 years after the date of purchase. Ageing of the plastic, for instance under the influence of sunlight (UV), may quite unnoticeably reduce the qualities of the product.

Once the child has grown out of the seat, we therefore advise you to no longer use the car seat and to dispose of it in the proper way.

As we care for the environment we request the user to separate the waste produced at the start (packaging) and end (product parts) of the life of the Maxi-Cosi CabrioFix.





**WARNING:** Make sure to keep plastic wrapping material out of reach of your child in order to avoid the risk of suffocation.

<b>Packaging</b>	Cardboard box	Paper waste
	Plastic bag	Residual waste
<b>Product parts</b>	Fabric cover	Residual waste
	Plastic parts	In accordance with the typification of the appropriate container
	Metal parts	Container for metal
	Tether	Container for polyester
	Belt buckle	Residual waste

GB

## 8. CAR SEATS

	Approved according to ECE R 44/04		
	Type of car seat		
			
	Maxi-Cosi Tobii	Maxi-Cosi PrioriFix	Maxi-Cosi Rodi XR
<b>Group</b>	1	1	2 + 3
<b>Body Weight of child</b>	9 - 18 kg	9 - 18 kg	15 - 36 kg
<b>Age</b>	9 months - 3,5 years	9 months - 3,5 years	3,5 - 12 years

# Instructions for use

## **9. WARRANTY**

We guarantee that this product was manufactured in accordance with the current European safety requirements and quality standards which are applicable to this product, and that this product is free from defects in workmanship and material at the time of purchase. During the production process the product was subjected to various quality checks. If this product, despite our efforts, shows a material/manufacturing fault within the warranty period of 24 months, (with normal use as described in the user instructions) we will comply with the warranty terms and conditions. In this case please contact your dealer. For extensive information on applying the warranty terms and conditions, you can contact the dealer or look on our website: [www.maxi-cosi.com](http://www.maxi-cosi.com).

### **The warranty is not valid in the following cases:**

- In case of a use or purpose other than described in the manual.
- If the product is submitted for repair through a dealer that is not authorized by us.
- If the product is not supplied to the manufacturer with the original purchase receipt (via the retailer and/or importer).
- If repairs were carried out by third parties or a dealer that is not authorized by us.
- If the defect is the result of improper or careless use or maintenance, negligence or impact damage to the fabric cover and/or frame.
- If the parts show normal wear and tear that may be expected from daily use of a product (wheels, rotating and moving parts etc.)

### **Date of effect**

The warranty becomes effective on the date the product is purchased.

### **Warranty term:**

The warranty period applies for a period of 24 consecutive months. The warranty only applies for the first owner and is not transferable.

### **What to do in case of defects:**

After purchasing the product, keep the purchase receipt. The date of purchase must be clearly visible on the receipt. Should problems or defects arise please contact your retailer. Exchanging or taking back the product cannot be requested. Repairs do not give entitlement to extension of the warranty. Products that are returned directly to the manufacturer are not eligible for warranty.

This Warranty Clause conforms to European Directive 99/44/EG of 25 May 1999.

### **10. QUESTIONS**

If you have any questions, call your retailer (see back of instruction manual). Please have the following information on hand when calling:

- Serial number (located on the bottom of the orange ECE sticker).
- Car make and model and the seat on which the Maxi-Cosi CabrioFix is being used.
- Your child's age, height and weight.