

SNACK COLLECTION

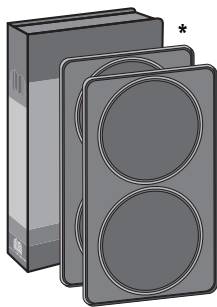

FR
NL
DE
EN
IT
ES
PT
EL
TR
DA
NO
SV
FI
RU
UK
JA
KO
AR
FA

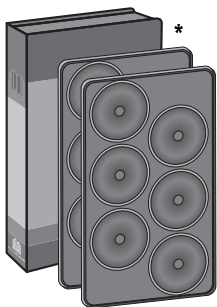

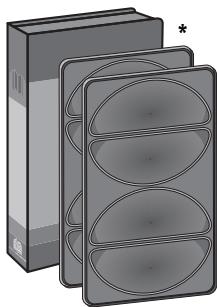
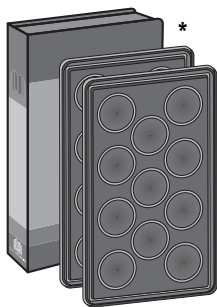
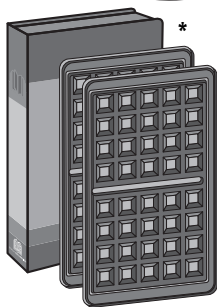
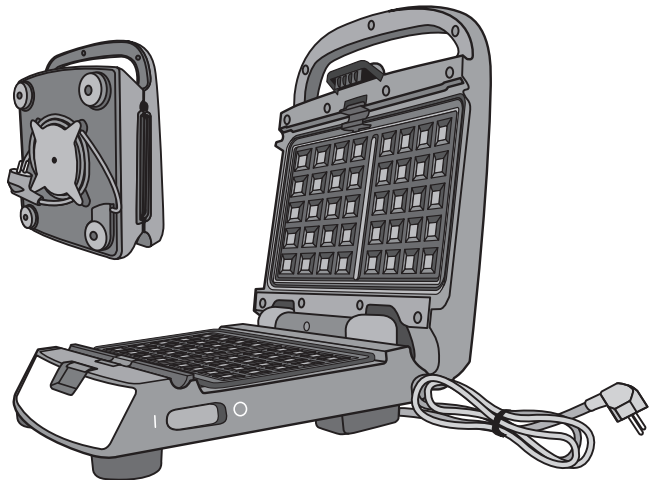
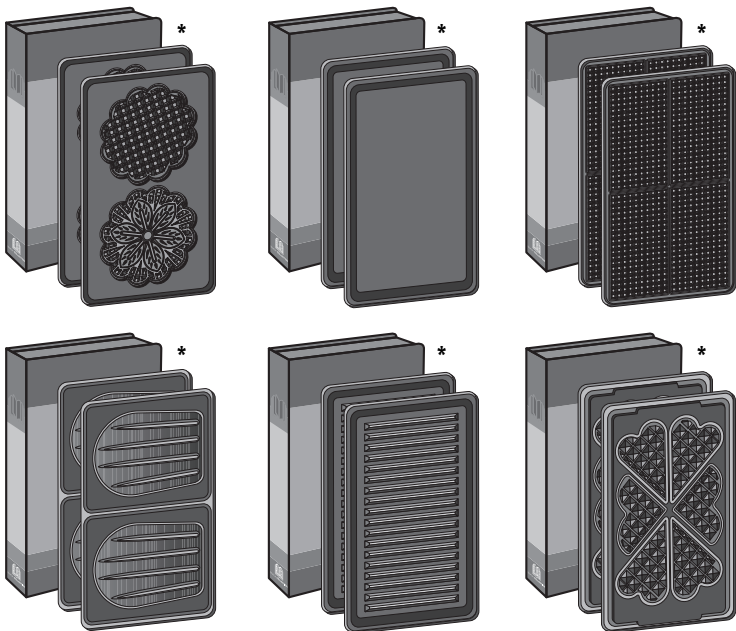

- * FR : Selon modèles et/ou disponibles en magasin ou internet.
 NL : Afhankelijk van het model en/of de beschikbaarheid in de winkel of online.
 DE : Je nach Modell und / oder im Geschäft oder online erhältlich.
 EN : Depending on the model and/or available in store or online.
 IT : A seconda del modello e/o disponibile in negozio o online.
 ES : Dependiendo del modelo y / o disponibles en la tienda o en línea.
 PT : Dependendo do modelo e / ou disponível na loja ou online.
 EL : Ανάλογα με το μοντέλο και/ή διατίθενται στα καταστήματα ή το Διαδίκτυο.
 TR : Modele ve/veya mağazada ya da çevrimiçi olarak bulunabilirliğe bağlıdır.
 DA : Afhængig af model og/eller rådighed i butikken eller online.
 NO : Avhengig av modell og / eller tilgjengelig i butikken eller på nettet.
 SV : Beroende på modell och/eller tillgänglighet i butik eller online.
 FI : Riippuen mallista ja/tai saatavilla liikkeessä tai verkossa.
 RU : Зависит от модели и/или от наличия в продаже.
 UK : Залежно від моделі та/або наявності в магазинах чи інтернет-магазинах.
 JA : モデルおよび/もしくは店やオンラインで利用可能なものに応じて
 KO : 모델에 따라 다름, 매장 또는 온라인에서 구입 가능.
 AR : بحسب الطراز و/أو التوفر في المتجر أو عبر الإنترنت
 FA : بسته به مدل و یا موجودی در فروشگاه یا به صورت آنلاین

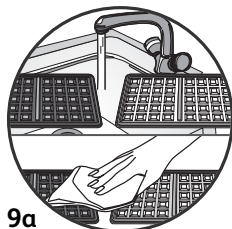
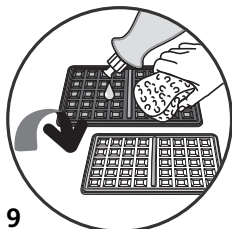
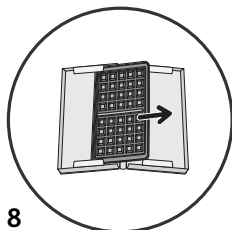
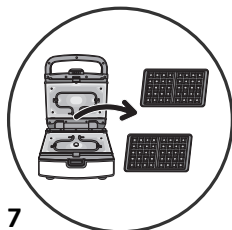
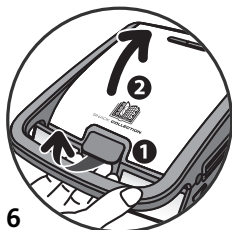
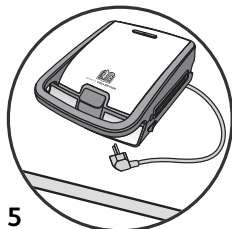
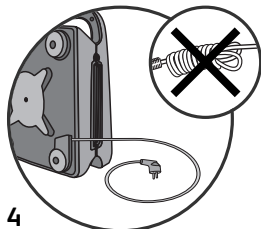
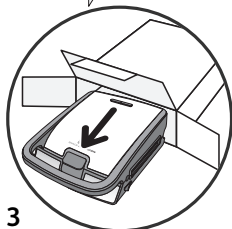
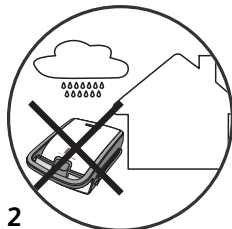

C

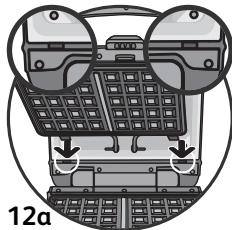
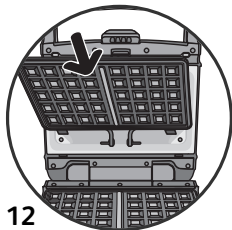
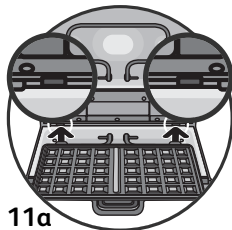
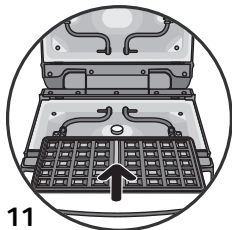
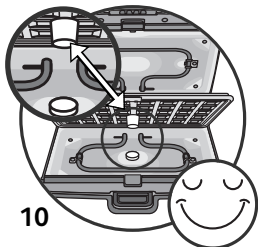

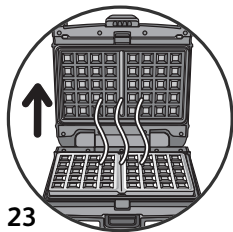
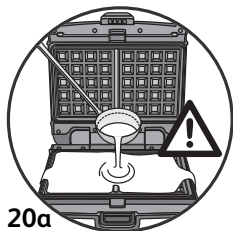
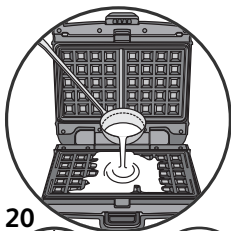
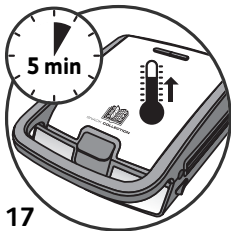
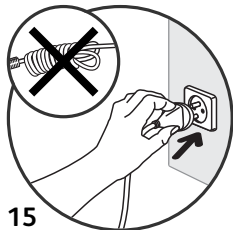
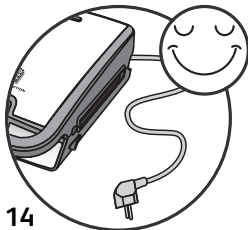

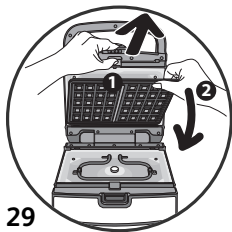
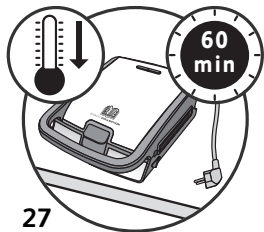
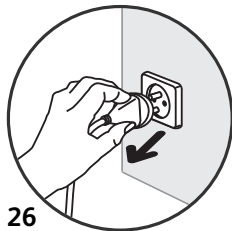
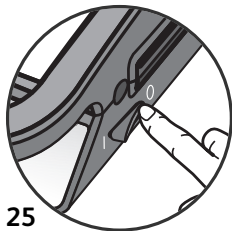
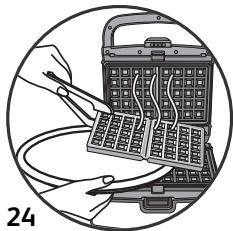

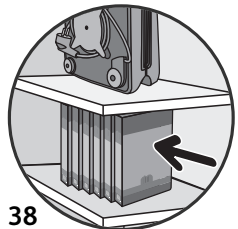
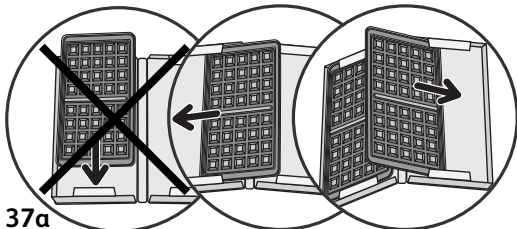
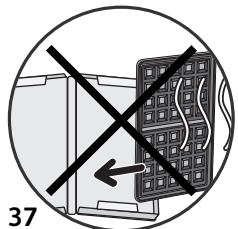
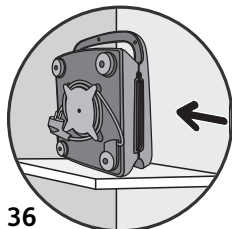
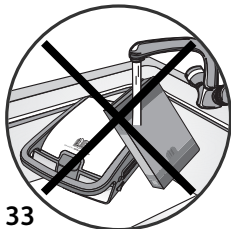
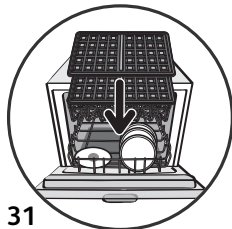
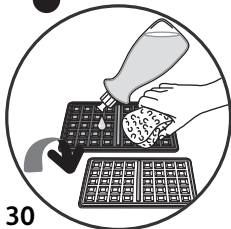

INTERNATIONAL GUARANTEE : COUNTRY LIST

			
الجزائر ALGERIA	CIJA 9 rue Puvis de Chavannes - Saint Euquene - Oran	(0)41 28 18 53	1 an 1 year
ARGENTINA	GRUPE SEB ARGENTINA S.A. Billinghurst 1833 3° - C1425DTK - Capital Federal - Buenos Aires	0800-122-2732	2 años 2 years
ՀԱՅԱՍՏԱՆ ARMENIA	ՓԲԸ Գրառույթ ՍՆԲ-Վ, 125171 Մասիկա, Լենինգրադյան - խեռույի, 16A, շին.3	(010) 55-76-07	2 տարի/ 2 years
AUSTRALIA	GRUPE SEB AUSTRALIA PO Box 7535, - Silverwater NSW 2128	02 97487944	1 year
ÖSTERREICH AUSTRIA	SEB ÖSTERREICH GmbH Campus 21 - Businesspark Wien Süd - Liebermannstr. A02 702 - 2345 Brunn am Gebirge	01 8903476	2 Jahre 2 years
BELGIQUE / BELGIE BELGIUM	GRUPE SEB BELGIUM SA NV 25 avenue de l'Espérance - ZI - 6220 Fleurus	070 23 31 59	2 ans 2 years
БЕЛАРУСЬ / BELARUS	ЗАО «Група СЕБ-Восток», 125171 Москва, Ленинградское - шоссе, д. 16А, стр. 3	017 2239290	2 года 2 years
BOSNA I HERCEGOVINA	SEB Développement Predstavništvo u BiH - Vrazova 8/II - 71000 Sarajevo	Info-linija za potrošače 033 551 220	2 godine 2 years
BRASIL BRAZIL	SEB COMERCIAL DE PRODUTOS DOMESTICOS LTDA Rua Venâncio Aires, 433/437/447, Pompéia, São Paulo/SP	0800-119933	1 ano 1 year
БЪЛГАРИЯ / BULGARIA	ГРУП СЕБ БЪЛГАРИЯ ЕООД Ул. Борово 52 Г, ет. 1, офис 1, - 1680 София	0700 10 330	2 години 2 years
CANADA	GRUPE SEB CANADA 345 Passmore Avenue - Toronto, ON M1V 3N8	800-418-3325	1 an 1 year
CHILE	GRUPE SEB CHILE Comercial Ltda - Av. Providencia, 2331, piso 5, oficina 501 Santiago	12300 209207	2 años 2 years
COLOMBIA	GRUPE SEB COLOMBIA Apartado Aereo 172, Kilometro 1 - Via Zipaquirá - Cajica Cundinamarca	18000919288	2 años 2 years
HRVATSKA CROATIA	SEB Développement S.A.S. Vodnjanska 26 - 10000 Zagreb	01 30 15 294	2 godine 2 years
ČESKÁ REPUBLIK / CZECH REPUBLIC	GRUPE SEB ČR spol. s r. o. Jankovcova 1569/2c - 170 00 Praha 7	731 010 111	2 roky 2 years
DANMARK	GRUPE SEB NORDIC AS Tempovej 27 - 2750 Ballerup	44 663 155	2 år 2 years
DEUTSCHLAND GERMANY	GRUPE SEB DEUTSCHLAND GmbH / KRUPS GmbH Herrnrainweg 5 - 63067 Offenbach	0212 387 400	2 Jahre 2 years
EESTI / ESTONIA	GRUPE SEB POLSKA SP Z O.O. ul. Bukowińska 22b 02-703 Warszawa	5 800 3777	2 aastat 2 years
SUOMI / FINLAND	Groupe SEB Finland Kutojantie 7 - 02630 Espoo	09 622 94 20	2 Vuotta 2 years
FRANCE - Incluant uniquement Martinique, Guadeloupe, Réunion & St. Martin	GRUPE SEB FRANCE Service Consommateur Tefal BP 15 - 69131 ECULLY CEDEX	09 74 50 47 74	1 an 1 year
ΕΛΛΑΔΑ / GREECE	SEB GROUPE ΕΛΛΑΔΟΣ Α.Ε. Οδός Καβαλεράτου 7 Τ.Κ. 145 64 Ν. Κηφισιά	2106371251	2 χρόνια 2 years
香港 / HONG KONG	SEB ASIA Ltd. Room 903, 9/F, North Block, Skyway House - 3 Sham Mong Road, Tai Kok Tsui, Kowloon - Hong-Kong	852 8130 8998	1 year
MAGYARORSZÁG / HUNGARY	GRUPE SEB CENTRAL-EUROPE Kft. Táviró köz 4 2040 Budaörs	06 1 801 8434	2 év 2 years
INDONESIA	Groupe SEB Indonesia (Representative office) Sudirman Plaza, Plaza Marein 8th Floor JL Jendral Sudirman Kav 76-78, Jakarta 12910, Indonesia	+62 21 5793 6881	1 year
ITALIA ITALY	GRUPE SEB ITALIA S.p.A. Via Montefeltro, 4 - 20156 Milano	199207354	2 anni 2 years
JAPAN	GRUPE SEB JAPAN Co. Ltd. 1F Takanawa Muse Building, 3-14-13, Higashi Gotanda, - Shinagawa-Ku, Tokyo 141-0022	0570-07772	1 year
ҚАЗАҚСТАН KAZAKHSTAN	ЖАҚ «Група СЕБ-Восток» 115171 Мәскеу, Ленинградское шоссе, 16А, 3 үйі	727 378 39 39	2 жыл 2 years
KOREA	(유)그룹 세브 코리아 서울시 종로구 서린동 88 서린빌딩 3층 - 110-790	1588-1588	1 year
LATVIA / LATVIA	GRUPE SEB POLSKA SP Z O.O. ul. Bukowińska 22b 02-703 Warszawa	6 716 2007	2 gadi 2 years

INTERNATIONAL GUARANTEE : COUNTRY LIST

			
LIETUVA / LITHUANIA	GRUPE SEB POLSKA SP Z O.O. ul. Bukowińska 22b 02-703 Warszawa	6 470 8888	2 metai 2 years
LUXEMBOURG	GRUPE SEB BELGIUM SA NV 25 avenue de l'Espérance - ZI - 6220 Fleurus	0032 70 23 31 59	2 ans 2 years
MACEDONIA	Groupe SEB Bulgaria EOOD - Office 1, floor 1, 52G Borovo St, 1680 Sofia - Bulgaria ГРУП СЕБ БЪЛГАРИЯ ДООЕЛ - Ул. Борово 52 Г, ет. 1, офис 1, 1680 София - България	(0)2 20 50 022	2 ГОДИНИ 2 years
MALAYSIA	GRUPE SEB MALAYSIA SDN. BHD Unit No. 402-403, Level 4, Uptown 2, No. 2, Jalan SS21/37, Damansara Uptown, 47400, Petaling Jaya, Selangor D.E. Malaysia	65 6550 8900	1 year
MEXICO	G.S.E.B. MEXICANA, S.A. de C.V. Goldsmith 38 Desp. 401, Col. Polanco - Delegacion Miguel Hidalgo - 11 560 Mexico D.F.	(01800) 112 8325	1 años 1 year
MOLDOVA	ТОВ «Груп СЕБ Україна» 02121, Харківське шосе, 201-203, 3 поверх, Київ, Україна	(22) 929249	2 ani 2 years
NEderland The Netherlands	GRUPE SEB NEDERLAND BV Generatorstraat 6 - 3903 LJ Veenendaal	0318 58 24 24	2 jaar 2 years
NEW ZEALAND	GRUPE SEB NEW ZEALAND Unit E, Building 3, 195 Main Highway, Ellerslie, - Auckland	0800 700 711	1 year
NORGE NORWAY	GRUPE SEB NORDIC AS Tempovej 27 - 2750 Ballerup DANMARK	815 09 567	2 år 2 years
PERU	GRUPE SEB Perú Av. Camino Real N° 111 of. 805 B - San Isidro - Lima - Perú	441 4455	1 años 1 year
POLSKA / POLAND	GRUPE SEB POLSKA SP Z O.O. ul. Bukowińska 22b 02-703 Warszawa	0801 300 421 koszt jak za połączenie lokalne	2 lata 2 years
PORTUGAL	GRUPE SEB IBÉRICA SA Urb. da Matinha - Rua Projectada à Rua 3 - Bloco1 - 3° B/D 1950 - 327 Lisboa	808 284 735	2 anos 2 years
REPUBLIC OF IRELAND	GRUPE SEB IRELAND Unit B3 Aerodrome Business Park, College Road, Rathcoole, Co. Dublin	01 677 4003	1 year
ROMÂNIA / ROMANIA	GRUPE SEB ROMÂNIA Str. Daniel Constantin nr. 8 - 010632 București	0 21 316 87 84	2 ani 2 years
РОССИЯ / RUSSIA	ЗАО «Группа СЕБ-Восток», 119180 Москва, 125171, Москва, Ленинградское шоссе, д. 16А, стр. 3	495 213 32 30	2 года 2 years
SRBIJA / SERBIA	SEB Developement Đorđa Stanojevića 11b 11070 Novi Beograd	060 0 732 000	2 godine 2 years
SINGAPORE	GRUPE SEB SINGAPORE Pty Ltd. 59 Jalan Pemimpin, #04-01/02 L&Y Building - Singapore 577218	65 6550 8900	1 year
SLOVENSKO / SLOVAKIA	GRUPE SEB SLOVENSKO s.r.o. Rybničná 40 - 831 07 Bratislava	233 595 224	2 roky 2 years
SLOVENIJA SLOVENIA	SEB d.o.o Gregorčičeva ulica 6 - 2000 MARIBOR	02 234 94 90	2 leti 2 years
ESPAÑA SPAIN	GRUPE SEB IBÉRICA S.A. Almogàvers, 119-123, Complejo Ecorurban - 08018 Barcelona	902 31 24 00	2 años 2 years
SVERIGE SWEDEN	TEFAL SVERIGE SUBSIDIARY OF GROUP SEB NORDIC Truckvägen 14 A, 194 52 Upplands Väsby	08 594 213 30	2 ans / Jahrre
TAIWAN	SEB ASIA Ltd. Taiwan Branch 4F., No. 37 Dexing W. Rd., Shilin Dist., Taipei City 11158, Taiwan (R.O.C.)	886-2-2833 3716	1 year
THAILAND	GRUPE SEB THAILAND 2034/66 Italthai Tower, 14th Floor, n° 14-02, - New Petchburi Road, Bangkapi, Huaykwang, Bangkok, 10320	662 351 8911	2 years
TÜRKIYE TURKEY	GRUPE SEB ISTANBUL AS Beybi Giz Plaza Dereboyu Cad. - Meydan Sok. - No: 28 K.12 Maslak	216 444 40 50	2 YIL 2 years
U.S.A.	GRUPE SEB USA 2121 Eden Road - Millville, NJ 08332	800-395-8325	1 year
УКРАЇНА / UKRAINE	ТОВ «Груп СЕБ Україна» 02121, Харківське шосе, 201-203, 3 поверх, Київ, Україна	044 492 06 59	2 роки 2 years
UNITED KINGDOM	GRUPE SEB UK Ltd. Riverside House, Riverside Walk Windsor, Berkshire, SL4 1NA	0845 602 1454	1 year
VENEZUELA	GRUPE SEB VENEZUELA Av Eugenio Mendoza, Centro Letonia, Torre - ING Bank, Piso 15, Ofc 155 Urb. La Castellana, Caracas	0800-7268724	2 años
VIETNAM	Vietnam Fan Joint Stock Company 25 Nguyen Thi Nho Str, Ward 9, Tan Binh Dist, HCM city	+84-8 38644037 +84-8 38645830	1 year

INTERNATIONAL GUARANTEE

Date of purchase: / Date d'achat / Fecha de compra /
Data da compra / Data d'acquisto / Kaufdatum / Aankoopdatum / Købsdato / Inköpsdatum /
Kjøpsdato / Ostopäivä / Data zakupu / Data vânzării / [sigijimo data/ Ostukuupäev / Datum
nakupa / Sorozatszám / Dátum nákupu / Pirkuma datums / Datum Kupovine / Datum kupnje /
Data cumpărării / Datum nákupu / Tarikh pembelian / Tanggal pembelian / Ngày mua hàng/
Satin alma tarihi / Дата прџдажи / Дата прџдажу / Дата на закупуване / Датум на купување /
Сатылган мерзими / Ημερομηνία αγοράς / Ψ ημερομηνία Ψ ημερομηνία Ψ ημερομηνία Ψ ημερομηνία / วันที่ซื้อ / 購買日期 / 購入日 / 구입일자 /
خريد تاريخ / تاريخ الشراء

Product reference: / Référence du produit / Referencia del
producto / Referência do produto / tipo de prodotto / Typnummer des Gerätes / Artikelnummer
van het apparaat / Referencenummer / Produktreferens / Artikelnummer / Tuotenumero /
referenja produktu / Model / Gaminio numeris / Toote viitenumber / Tip aparata / Vásárlás
kelte / Typ výroby / Produkta atsauces numurs / Model proizvoda / Oznaka proizvoda / Cod
produs / Produk rujukan / Referensi produk / Mã sản phẩm/ Ürün kodu / Мпдель / Мпдель /
Мпдел на уреда / Мпдели / Κωδικός προϊόντος / Ψ ημερομηνία Ψ ημερομηνία Ψ ημερομηνία / รุ่นผลิตภัณฑ์ / 產品模型 / 製品レファレン
ス番 / 제품명 / مرجع كامل محصول / مرجع المنتج الكامل

Retailer name & address: /
Nom et adresse du vendeur / Nombre y dirección del minorista / Nome e endereço do revendedor /
Nome e indirizzo delnegozio / Name und Anschrift des Händlers / Naam en adres van de dealer /
Forhandler navn & adresse / Återförsäljarens namn och adress / Forhandler navn og adresse /
Jälleenmyyjän nimi ja osoite / Nazwa i adres sprzedawcy / Numele și adresa vânzătorului /
Parduotuvės pavadinimas ir adresas / Müüja kauplus ja aadress / Naziv in naslov trgovine /
Típuszám / Názov a adresa predajcu / Veikala nosaukums un adrese / Naziv i adresa maloprodaje /
Naziv i adresa prodavca / Naziv i adresa prodajnog mjesta / Nume și adresă vânzător / Název a
adresa prodejce / Nama dan alamat peruncit / Nama Toko Penjual dan alamat / Tên và địa chỉ
cửa hàng bán/ Saticı firmanın adı ve adresi / Название и адрес прџдавца / Назва i adresa
прџдавца / Търговки пбект / Назив и адреса на прџдавницата / Сатушының аты және
мекен-жайы / Επωνυμία και διεύθυνση καταζητήματος / Ψ ημερομηνία Ψ ημερομηνία Ψ ημερομηνία Ψ ημερομηνία /
ชื่อและที่อยู่ของห้าง/ร้านที่ซื้อ / 零售商的店名和地址/販売店の名前、住所/소매점 이름과 주소/
نام و آدرس خرده فروش / اسم وعنوان بائع التجزئة

Distributor stamp Cachet distributeur /Sello del distribuidor /
Carimbo do revendedor / Timbro del negozio / Händlerstempel / Stempel van de dealer /
Forhandler stempel / Återförsäljarens stämpel / Forhandler stempel / Jälleenmyyjän leima /
pieczęć sprzedawcy / Ştampila vânzătorului / Antspaudas / Tempel / Žig trgovine / Eladó neve,
címe/ Razítko predajcu / Zímogs / Pečat maloprodaje/ Pečat prodavca / Pečat prodajnog
mjesta / Ştampila vânzătorului/ Razítko prodejce/ Cap peruncit / Cap dari Toko Penjual / Cửa
hàng bán đồng dấu/ Saticı Firmanın Kaşesi / Печать прџдавца / Печатка прџдавца / Печат на
търговския пбект / Печат на прџдавницата / Сатушының мөри / Σθραγίδα καταζητήματος /
 Ψ ημερομηνία Ψ ημερομηνία Ψ ημερομηνία / ตราประทับของห้าง/ร้านที่ซื้อ / 零售商的蓋印 / 販売店印 / 소매점 직인 /
فروش مهر خرده / ختم بائع التجزئة

