

# 1 Checking the Accessories Supplied

# 3 Connecting the Display Unit to the Media Receiver Unit

# 4 Connecting the AC Cable, Aerial and VCR

Thank you for purchasing this Sony product.

After following this step by step guide you will be able to:

Insert Batteries into the Remote Control.

Connect the Display Unit to the Media Receiver Unit.

Connect the AC Cable, Aerial and VCR to your TV.

Select the language of the menu screens.

Select the country in which you wish to operate the set.

Set the current time.

Tune your TV.

Change the broadcast channels into a different order.

View TV Programmes.

1 Remote control (RM-Y1012):



1 "Notes on Plasma" book.

1 Display Interface Cable:



2 Mains Leads (Type C-4):



Do not remove ferrite cores.

⚠ Use these mains leads (with safety earth) if you use the set outside the United Kingdom and Ireland.

1 Mains Plug holder:



2 Batteries (AA size):



Only for KE-P61MRX1: (supplied with the display unit: PDM-6110)

- 2 Frame Bars
- 4 Screws

One Cleaning Cloth:



2 Mains Leads (Type BF):



Do not remove ferrite cores.

⚠ Use these mains leads (with safety earth) if you use the set in the United Kingdom. See "NOTICE FOR CUSTOMERS IN THE UNITED KINGDOM and IRELAND" on page 2 GB of the instruction manual when using these mains leads. These mains leads may not be supplied depending on the country.

1 Coaxial Cable:



Only for KLV-L42MRX1: (supplied with the display unit: LDM:4210)

- 2 Speaker jack covers

One AV Mouse:



2 Mains Leads (Type C-5):



Do not remove ferrite cores.

⚠ Use these mains leads (with safety earth) if you use the set in the Swiss Confederation. These mains leads may not be supplied depending on the country.

1 PC Input Cable



## 2 Inserting Batteries into the Remote Control

⚠ Make sure you insert the supplied batteries using the correct polarities. Always remember to dispose of used batteries in an environmentally friendly way.

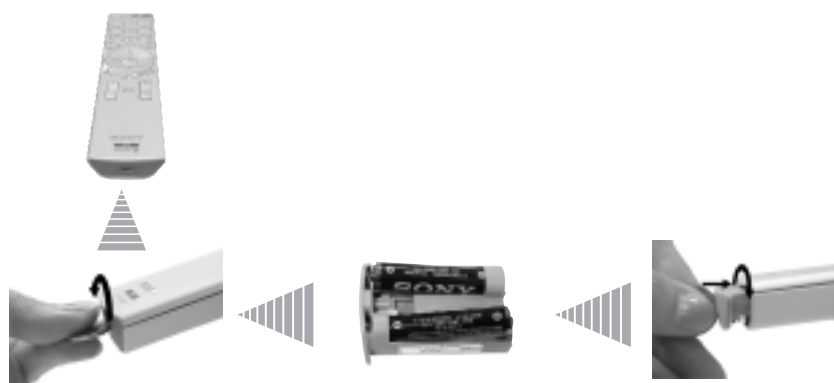

- ① Use the supplied display interface cable.
- ① Use the supplied mains lead for the display unit (Type C-4, Type BF or Type C-5, see step 1).

1 Connect the supplied interface cable to the display unit and to the media receiver unit.

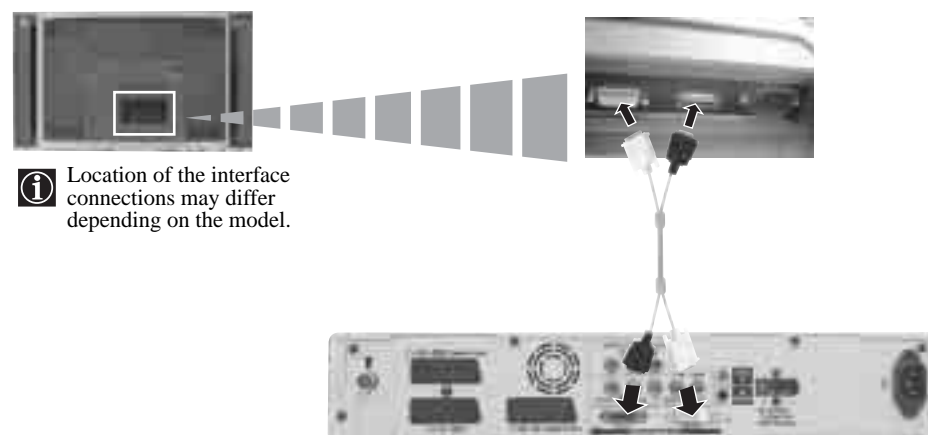

① Location of the interface connections may differ depending on the model.

2 Connect the supplied mains lead to the display unit.

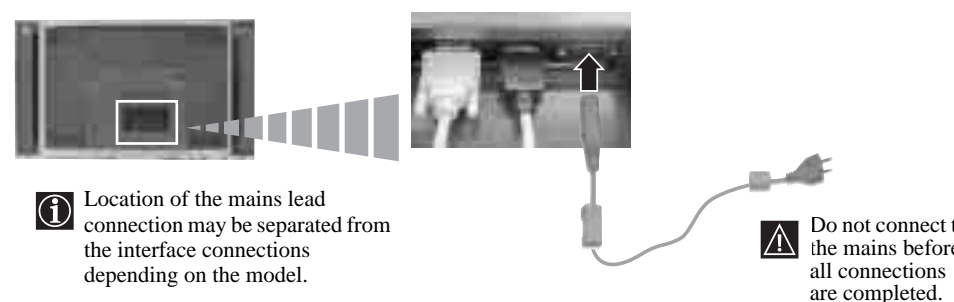

① Location of the mains lead connection may be separated from the interface connections depending on the model.

⚠ Do not connect to the mains before all connections are completed.

3 Only for KE-P42MRX1, KE-P50MRX1 and KE-P61MRX1:

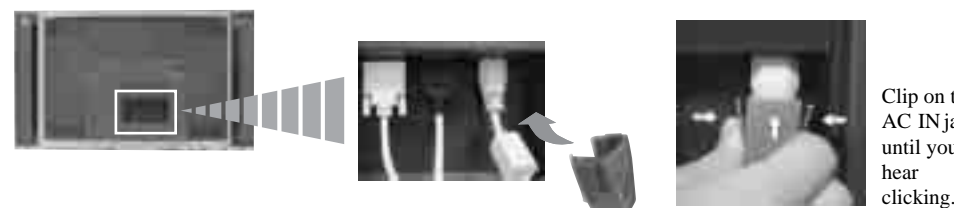

Attach the mains plug holder (supplied) to the mains lead.

Clip on the AC IN jack until you hear clicking.

① To unplug the mains lead pull down the mains plug holder by pushing in both sides of the holder, then pull out the plug.

4 Install the display unit using the specified wall-mount bracket or stand.

⚠ Before installing the display unit, check the installation instructions of your wall-mount bracket or stand.

- ① Use the supplied mains lead for the media receiver unit (Type C-4, Type BF or Type C-5, see step 1).
- Use the supplied coaxial cable for aerial connection.

### Connecting an aerial

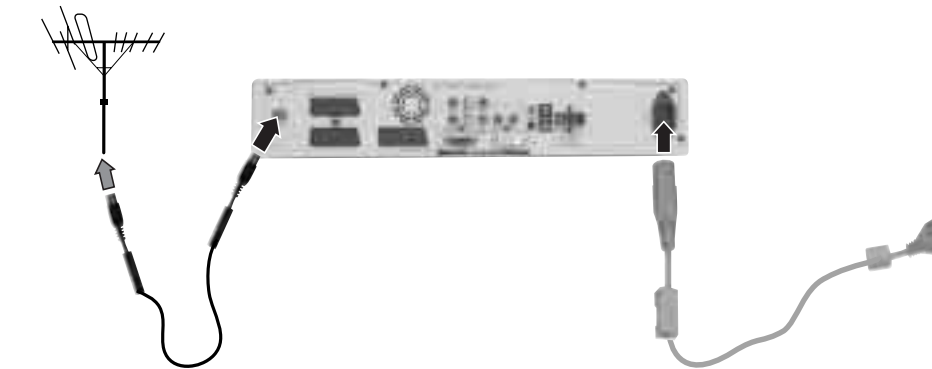

⚠ Do not connect to the mains before all connections are complete.

### Connecting a VCR with an aerial

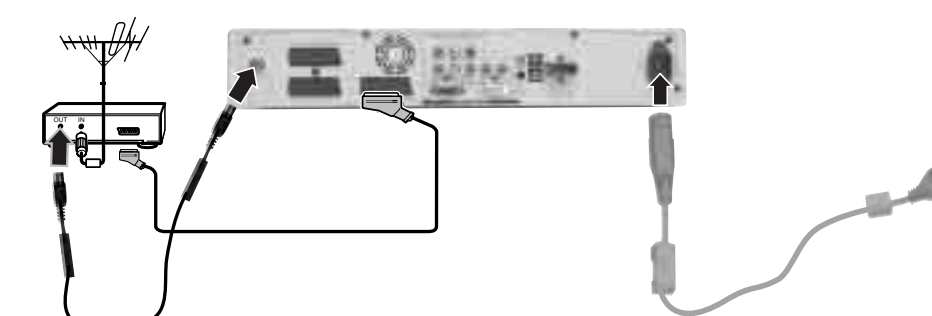

① For more details regarding VCR connection, refer to "Connecting Optional Equipment to the TV" on page 50 of the instruction manual.

⚠ Do not connect to the mains before all connections are complete.

- ① The Scart lead is optional, however if you use a Scart lead to connect your VCR it can improve picture and sound quality when using it.
- For more details of VCR connection, please refer to the section "Connecting Optional Equipment" on page 50 of the instruction manual.

⚠ If you do not have a Scart lead, after automatically tuning the TV, tune in the VCR test signal to the TV programme number "0" by using the "Manual Programme Preset" option. (for details of how to manually programme these presets, see page 35, step A of the instruction manual). Refer to your VCR instruction manual to find out how to find the output channel of your VCR.

# Switching on the set

## 5

# Selecting the language of the menu screens, the country and setting the current time

This TV set works with menu screens. By following the instructions below, you can select the desired language of the menu screens, the country in which you wish to operate the TV set and set the current time.

**1** It is important that you connect the Media Receiver Unit and the Display Unit to the mains socket (220-240V AC, 50/60Hz) in the following order:

- First: Media Receiver Unit **1**
- Second: Display Unit **2**

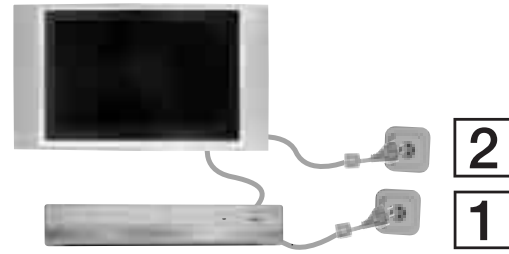

**2** The first time that the TV set is connected, it is usually turned on. If the TV is off, press the **Power** switch on the media receiver unit to turn on the TV.

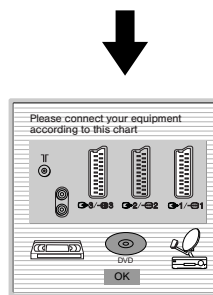
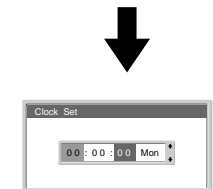
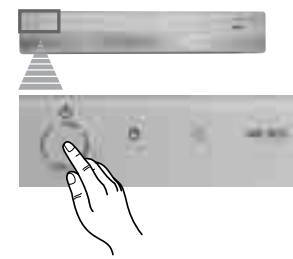

The first time you press the **Power** switch, a **Language** menu displays automatically on the TV screen.

**1** Press the **Left**, **Right**, **Up**, or **Down** button on the remote control to select the language, then press the **OK** button to confirm your selection. From now on all the menus will appear in the selected language.

**2** The **Country** menu appears automatically on the TV screen. Press the **Left** or **Right** button to select the country in which you will operate the TV set, then press the **OK** button to confirm your selection.

**i** If the country in which you want to use the TV set does not appear in the list, select "off" instead of a country.

**3** The **Clock Set** menu appears on the TV screen.  
**a)** Press **Down** or **Up** to set the hour, then press **Right**.  
**b)** Press **Down** or **Up** to set the minutes, then press **Right**.  
**c)** Press **Down** or **Up** to set the day of a week, then press **OK** at the time signal. The clock starts.

A diagram showing you how to connect equipment to your TV set appears on the TV screen. Follow the instructions and finally press the **OK** button to remove the picture and continue the automatic tuning process.

**⚠** The connection diagram should be used as a guide only as most equipment can be connected to more than one type of TV socket. Once the TV has completed the automatic tuning process, refer to the 'Connection Guide' section on page 27 of the instruction manual for further information on getting the best set up for your equipment.

## 6

# Automatically Tune the TV

You need to tune the TV to receive channels (TV Broadcast). By following the instructions below, this set automatically searches and stores all available channels for you.

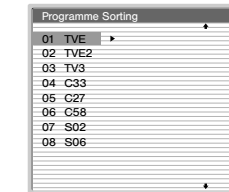
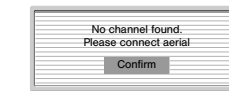
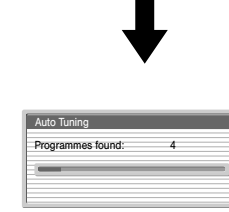
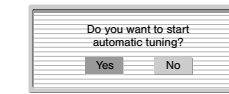

**1** Press the **OK** button on the remote control to select **Yes**.

**2** The TV starts to automatically search and store all available broadcast channels for you.

**⚠** This procedure could take some minutes. Please be patient and do not press any buttons while the auto tuning is in progress, otherwise the auto tuning will not be completed.

**⚠** If no channels were found during the auto tuning process then a new menu appears automatically on the screen asking you to connect the aerial. Please connect the aerial (refer to the step 4) and press **OK**. The auto tuning process will start again.

When the auto tuning is finished, the **Programme Sorting** menu appears on the screen.

## 7

# Changing the Programme Order of the broadcast channels

By following the instructions below, you can rearrange the order in which the broadcast channels appear on the screen.

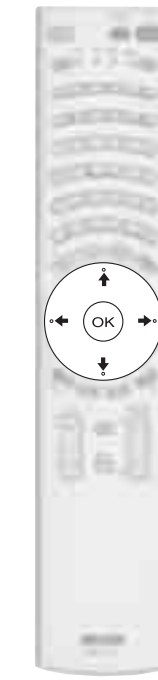

**a)** If you wish to keep the broadcast channels in the tuned order:

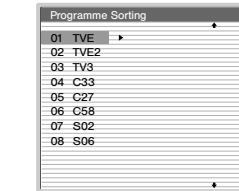

Press the **MENU** button on the remote control to exit and return to the normal TV screen.

**👍 Your set is now ready for use.**

**b)** If you wish to store the broadcast channels in a different order:

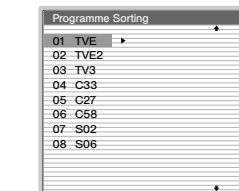

**1** Press the **Down** or **Up** button to select the programme number with the channel (TV Broadcast) you wish to rearrange, then press the **Right** button.

**2** Press the **Down** or **Up** button to select the new programme number position for your selected channel (TV Broadcast), then press **Left**.

**i** The selected broadcast channel now moves to its new programme position and the other broadcast channels move accordingly.

**3** Repeat steps 1) and 2) if you wish to change the order of the other channels.

**4** Press the **MENU** button on the remote control to exit and return to the normal TV screen.

**👍 The TV set is now ready for use.**

## 8

*Your television stations are now stored in your television's memory.*