

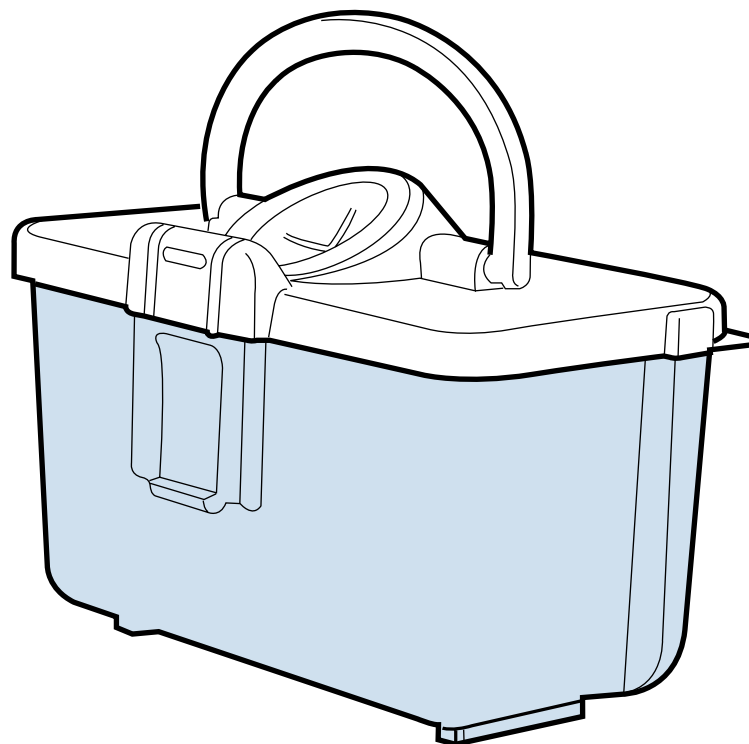

# SENSORY ECOBOX SYSTEM

GENERATION FUTURE



ENGLISH  
FRANÇAIS  
DEUTSCH  
ITALIANO  
ESPAÑOL  
PORTUGUÊS  
VLAAMS/NEDERLANDS  
DANSK

GB SUOMI  
FR Česky  
DE POLSKI  
IT Русский  
ES SVENSKA  
PT NORSK  
BE/NL Türkçe  
DK Ελληνικά

FI  
CZ  
PL  
RU  
SE  
NO  
TR  
GR

1



2

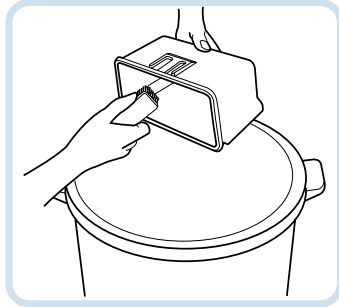

3

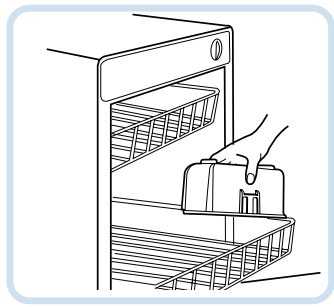

4

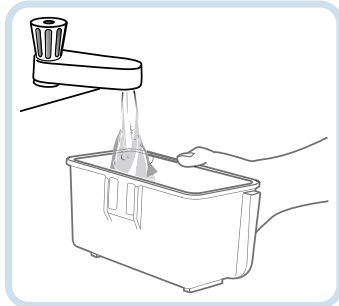

5

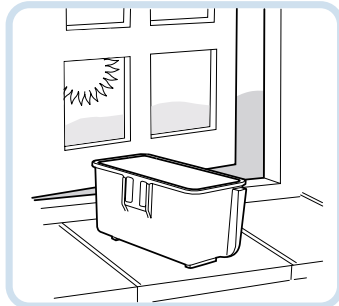

6



A

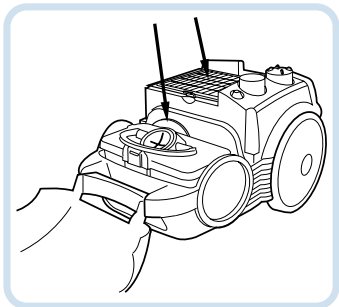

B

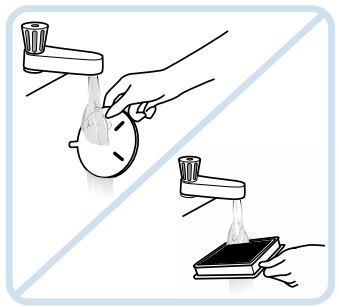

C

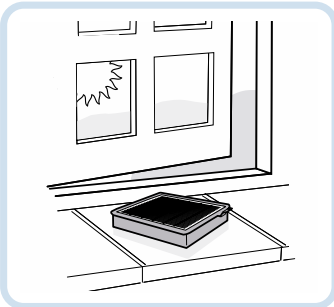



To maintain optimum performance we recommend that you follow these simple instructions.

## CLEANING THE ECOBOX

To maintain the best performance, we would recommend that you **wash the Ecobox every month** removing even the finest dust retained in it. To wash and optimise the performance the following simple steps should be taken:

- 1 Shake out the Ecobox to remove large dirt and debris as described in "Emptying the Ecobox".
- 2 Brush the inside of the Ecobox to remove the fine dust that may have formed on the walls of the container.
- 3 Wash the inside and outside of the Ecobox thoroughly using warm water and washing up liquid. At this point if desired, the Ecobox can be placed in a dishwasher and washed on a full wash and dry cycle at up to 75°C.
- 4 If not placed in a dishwasher rinse thoroughly inside and outside making sure no detergent is left on the Ecobox.
- 5 Remove excess water with a dry cloth and leave to air dry for 24 hours or until fully dry.
- 6 After completing the washing and drying operations, locate the cover rear guides into the container recess then close firmly. Return the Ecobox to its original position in the cleaner.

## FILTERS MAINTENANCE

To maintain best performance we recommend that you wash the filters **every month**.

- A Remove filters.
- B Rinse both filters under hand warm water. Do not scrub the filters, use washing up liquid or place in a dishwasher.
- C Remove excess water with a dry cloth and leave to air dry for 24 hours or until fully dry.

After completing the washing and drying operations, return the filters to their original positions in the cleaner.

Pour le maintien de performances optimales, nous vous recommandons de suivre les instructions ci-dessous :

## NETTOYER L'ECOBX

Pour conserver toutes les performances du système, nous vous recommandons de **laver l'Ecobox une fois par mois** afin d'éliminer le moindre résidu de poussière. Pour laver l'Ecobox et conserver ses performances, suivez cette procédure :

- 1 Videz l'Ecobox en le secouant pour éliminer les débris et la poussière comme indiqué dans « Vider l'Ecobox ».
- 2 Brossez l'intérieur de l'Ecobox pour éliminer la poussière fine susceptible de s'être collée aux parois du contenant.
- 3 Lavez soigneusement l'intérieur et l'extérieur de l'Ecobox à l'eau tiède avec du liquide vaisselle. Si vous le voulez, vous pouvez ensuite mettre l'Ecobox au lave-vaisselle pour un cycle complet de lavage et de séchage jusqu'à 75°C.
- 4 Si vous ne mettez pas l'Ecobox au lave-vaisselle, rincez complètement l'intérieur et l'extérieur en éliminant toutes traces de détergent.
- 5 Éliminez l'excès d'eau avec un chiffon sec et laissez sécher à l'air libre pendant 24 heures ou jusqu'à ce que l'Ecobox soit complètement sec.
- 6 Une fois la procédure de nettoyage et de séchage terminée, insérez les guides arrière du couvercle dans l'évidement du contenant et refermez bien le couvercle. Remettez l'Ecobox à son emplacement d'origine dans l'aspirateur.

## MAINTENANCE DES FILTRES

Pour que les filtres restent performants, nous vous recommandons de les laver **une fois par mois**.

- A Retirez les filtres.
- B Rincez les deux filtres sous l'eau tiède. Vous ne devez pas broser les filtres, utiliser de liquide vaisselle ni mettre les filtres au lave-vaisselle.
- C Éliminez l'excès d'eau avec un chiffon sec et laissez sécher à l'air libre pendant 24 heures ou jusqu'à ce que les filtres soient complètement secs.

Une fois la procédure de nettoyage et de séchage des filtres terminée, remettez-les à leurs emplacements d'origine dans l'aspirateur.

Zur Aufrechterhaltung der optimalen Leistung Ihres Geräts befolgen Sie bitte diese einfachen Schritte.

## REINIGUNG DER ECOBOX

Zur Aufrechterhaltung der optimalen Leistung des Produkts empfehlen wir, die Ecobox monatlich einmal zu waschen, um den feinen Staub, den das Gerät in die Ecobox gesaugt hat, zu entfernen. So waschen Sie die Ecobox und optimieren damit die Leistung Ihres Geräts:

- 1 Schütten Sie den groben Schmutz so, wie in „Leeren der Ecobox“ erläutert, aus der Ecobox heraus.
- 2 Bürsten Sie die Innenseite der Ecobox aus, um den feinen Staub, der sich an den Wänden abgesetzt hat, zu entfernen.
- 3 Waschen Sie die Innen- und Außenseite der Ecobox mit warmem Wasser, dem ein Geschirrspülmittel beigegeben wurde, gründlich sauber. Anschließend kann die Ecobox in einem Geschirrspüler in einem kompletten Wasch- und Trockenzyklus bei bis zu 75°C gereinigt werden.
- 4 Wird kein Geschirrspüler verwendet, so spülen Sie die Ecobox innen und außen gründlich ab, damit kein Spülmittel an der Ecobox zurückbleibt.
- 5 Trocknen Sie die Ecobox mit einem trockenen Tuch ab und lassen Sie diese 24 Stunden lang, oder bis sie vollständig trocken ist, an der Luft trocknen.
- 6 Setzen Sie, nachdem die Ecobox gewaschen und getrocknet wurde, die Deckelführungen in die Behälterausparung und schließen Sie den Deckel fest. Setzen Sie die Ecobox wieder richtig in den Staubsauger ein.

## WARTUNG DER FILTER

Zur Aufrechterhaltung der optimalen Leistungsfähigkeit Ihres Geräts empfehlen wir Ihnen, die Filter monatlich einmal zu waschen.

- A Nehmen Sie die Filter aus dem Gerät heraus.
- B Spülen Sie beide Filter mit lauwarmem Wasser ab. Verwenden Sie zur Reinigung der Filter keine Bürste, sondern waschen Sie diese mit warmem Wasser, dem ein Geschirrspülmittel beigegeben wurde, oder im Geschirrspüler.
- C Trocknen Sie die Filter mit einem trockenen Tuch ab und lassen Sie diese 24 Stunden lang, oder bis sie vollständig trocken sind, an der Luft trocknen.

Setzen Sie die Filter nach ihrer Reinigung und dem Trocknen wieder korrekt in den Staubsauger ein.

Per garantire sempre le migliori prestazioni, consigliamo di seguire queste semplici istruzioni.

## PULIZIA DELL'ECOBX

Per assicurare sempre le migliori prestazioni del sistema, è consigliabile lavare l'Ecobox ogni mese per rimuovere le polveri fini trattenute nel contenitore. Per lavare e, in tal modo, ottimizzare le prestazioni, è necessario seguire i semplici passaggi indicati di seguito:

- 1 Scuotere l'Ecobox per rimuovere lo sporco e i detriti di grandi dimensioni come descritto nel capitolo "Svuotamento dell'Ecobox".
- 2 Pulire l'interno dell'Ecobox con una spazzola per rimuovere le polveri fini che si sono depositate sulle pareti del contenitore.
- 3 Lavare con cura l'interno e l'esterno dell'Ecobox con acqua tiepida e un detergente. E' anche possibile lavare l'Ecobox in lavastoviglie eseguendo un ciclo completo di lavaggio e asciugatura a una temperatura massima di 75°C.
- 4 Se non viene lavato in lavastoviglie, risciacquare con cura l'interno e l'esterno del contenitore assicurandosi che nessun residuo di detergente rimanga sull'Ecobox.
- 5 Rimuovere l'acqua in eccesso con un panno asciutto e lasciare asciugare all'aria per 24 ore o fino a quando il contenitore non è completamente asciutto.
- 6 Al termine delle operazioni di lavaggio ed asciugatura, posizionare le guide posteriori del coperchio nella rientranza del contenitore e poi chiudere fermamente. Riportare l'Ecobox nella posizione iniziale all'interno dell'apparecchio.

## MANUTENZIONE DEI FILTRI

Per assicurare sempre le migliori prestazioni del sistema, è consigliabile lavare i filtri ogni mese.

- A Togliere i filtri
- B Risciacquare ambo i filtri in acqua tiepida. Non sfregare i filtri, usare detergente o metterli in lavastoviglie.
- C Asportare l'acqua in eccesso con un panno asciutto e lasciare asciugare i filtri all'aria per 24 ore o finché non saranno completamente asciutti.

Una volta ultimate le operazioni di lavaggio ed asciugatura, rimettere i filtri nell'apparecchio, nelle loro posizioni originali.

Para mantener un rendimiento óptimo, recomendamos que siga estas sencillas instrucciones.

## LIMPIEZA DEL ECOBOX

Para mantener un rendimiento óptimo, recomendamos que el **Ecobox se lave cada mes** eliminando incluso el polvo más fino que esté retenido en el mismo. Para lavar y optimar el rendimiento deben llevarse a cabo los siguientes pasos sencillos:

- 1 Sacuda el Ecobox para eliminar la suciedad de gran tamaño y los grandes fragmentos como se describe en "Vaciado del Ecobox".
- 2 Cepille el interior del Ecobox para eliminar el polvo fino que pueda haberse acumulado en las paredes del Ecobox.
- 3 Lave el interior y el exterior del Ecobox en profundidad utilizando agua caliente y un limpiador líquido. A continuación, si lo desea, el Ecobox puede introducirse en un lavavajillas y lavarse en un ciclo completo de lavado y secado de hasta 75° C.
- 4 Si no lo ha colocado en un lavavajillas, enjuague cuidadosamente el interior y el exterior asegurándose de que no queda detergente en el Ecobox.
- 5 Elimine el agua sobrante con un trapo seco y deje secar al aire libre durante 24 horas o hasta que esté totalmente seco.
- 6 Tras realizar las operaciones de lavado y secado, sitúe las guías de la tapa trasera en las muescas del contenedor y después cierre con firmeza. Devuelva el Ecobox a su posición original en el aspirador.

## MANTENIMIENTO DE LOS FILTROS

Para mantener el mejor rendimiento, recomendamos que lave los filtros **cada mes**.

- A Retire los filtros
- B Enjuague ambos filtros a mano en agua caliente. No friegue los filtros, no utilice líquido limpiador ni los introduzca en un lavavajillas
- C Elimine el exceso de agua con un trapo seco y deje secar al aire libre durante 24 horas o hasta que esté totalmente seco (X).

Tras realizar las operaciones de lavado y secado, devuelva los filtros a sus posiciones originales en el aspirador.

Para garantir o melhor desempenho, recomendamos que siga as seguintes instruções.

## LIMPEZA DO ECOBOX

Para manter o melhor desempenho possível, recomendamos que lave o Ecobox todos os meses, para remover até à mais pequena partícula de pó acumulado no mesmo. Para lavar e otimizar o seu desempenho, siga as instruções que se seguem:

- 1 Agite o Ecobox para eliminar a sujidade maior e os detritos, conforme indicado na secção "Esvaziamento do Ecobox".
- 2 Escove o interior do Ecobox para remover a poeira mais fina que se pode ter acumulado nas paredes do Ecobox.
- 3 Lave o interior e exterior do Ecobox com água morna e detergente. Nesta altura, se preferir, pode colocar o Ecobox na máquina de lavar louça, utilizando o programa completo de lavagem e ciclo de secagem a 75° C.
- 4 Se não utilizar máquina de lavar louça, enxagúe bem o interior e o exterior tendo o cuidado para não deixar detergente no Ecobox.
- 5 Remova a água em excesso com um pano seco e deixe secar ao ar livre durante 24 horas ou até estar totalmente seco.
- 6 Depois de concluídas as operações de lavagem e secagem, introduza as guias posteriores da tampa nas ranhuras do contentor e feche bem. Recoloque o Ecobox na sua posição original no aspirador.

## MANUTENÇÃO DOS FILTROS

Para garantir o melhor desempenho, recomendamos a lavagem dos filtros todos os meses.

- A Remova os filtros.
- B Lave ambos os filtros com água morna. Não esfregue os filtros, não utilize detergente ou coloque na máquina de lavar louça.
- C Remova a água em excesso com um pano seco e deixe secar ao ar livre durante 24 horas ou até estar totalmente seco.

Depois de concluídas as operações de lavagem e secagem, recoloque os filtros nas suas posições iniciais no aspirador.



Om uw stofzuiger in optimale staat te houden, raden wij u aan om de eenvoudige instructies hieronder op te volgen.

## DE ECOBOX REINIGEN

Voor de beste prestaties, raden wij u aan om de Ecobox elke maand te reinigen, zodat zelfs het fijnste stof wordt verwijderd. Om de Ecobox te reinigen en dus de prestaties van uw stofzuiger te optimaliseren, volgt u de eenvoudige stappen hieronder:

- 1 Klop de Ecobox uit om grof vuil te verwijderen, zoals beschreven in "De Ecobox legen".
- 2 Borstel de binnenkant van de Ecobox schoon om fijn stof te verwijderen, dat zich aan de wanden van de Ecobox kan hebben opgehoopt.
- 3 Was de binnen- en buitenkant van de Ecobox grondig schoon met warm water en afwasmiddel. Indien gewenst kunt u de Ecobox ook in de vaatwasser reinigen door middel van een volledige was- en droogcyclus op max. 75°C.
- 4 Als u geen vaatwasser gebruikt, spoel dan de binnen- en buitenkant van de Ecobox grondig af met water, zodat er geen afwasmiddel achterblijft.
- 5 Verwijder overtollig water met een droge doek en laat de Ecobox 24 uur lang volledig drogen.
- 6 Nadat u de Ecobox heeft schoongemaakt en laten drogen, haakt u het deksel in de achterzijde van de Ecobox en drukt het stevig dicht. Breng dan de Ecobox weer op zijn plaats in de stofzuiger.

## ONDERHOUD FILTERS

Voor de beste prestaties, raden wij u aan om de filters elke maand te reinigen.

- A Verwijder de filters.
- B Spoel beide filters af onder lauwwarm water. Schuur de filters niet schoon en gebruik geen afwasmiddel of vaatwasser.
- C Verwijder overtollig water met een droge doek en laat de filters 24 uur lang volledig drogen.

Nadat u de filters heeft schoongemaakt en laten drogen, plaatst u ze weer in hun oorspronkelijke positie in de stofzuiger.

For at opnå optimal ydelse anbefaler vi, at du følger følgende enkle instruktioner.

## RENGØRING AF ECOBOX

For at opnå den bedste ydelse anbefaler vi, at du **vasker Ecobox hver måned**, så selv det mest fine støv fjernes. Følg nedenstående enkle trin for at vaske boksen og optimere ydelsen:

- 1 Ryst Ecobox for at tømme den for snavs som beskrevet i "Tømning af Ecobox".
- 2 Børst indersiden af Ecobox for at fjerne det fine støv, som har lagt sig på boksens sider.
- 3 Vask indersiden og ydersiden af Ecobox grundigt med varmt vand og opvaskemiddel. Sæt eventuelt Ecobox i opvaskemaskinen, og vask den med et fuldt vaskeprogram og tørring ved op til 75° C.
- 4 Hvis du ikke bruger opvaskemaskine, skal du skylle den omhyggeligt både ind- og udvendigt for at sikre, at der ikke efterlades vaskemiddel på Ecobox.
- 5 Fjern overskydende vand med en tør klud, og lad den lufttørre 24 timer, eller indtil den er helt tør.
- 6 Når du er færdig med at vaske og tørre Ecobox, skal du placere lågets bagerste tapper i beholderens indhak og derefter skubbe låget ordentligt på plads. Sæt Ecobox tilbage i støvsugeren.

## FILTERVEDLIGEHOLDELSE

For at opnå den bedste ydelse anbefaler vi, at du vasker filtrene **en gang om måneden**.

- A Tag filtrene ud.
- B Skyl begge filtre i lunkent vand. De må ikke skrubbes. Brug opvaskemiddel eller opvaskemaskine.
- C Fjern overskydende vand med en tør klud, og lad dem lufttørre i 24 timer, eller indtil de er helt tørre.

Når du har fulgt anvisningerne til vask, skal du placere filtrene på deres oprindelige position i støvsugeren.

Jotta järjestelmä toimisi parhaalla mahdollisella tavalla, suosittelemme seuraavien yksinkertaisten ohjeiden noudattamista.

## ECOBX-SÄILIÖN PUHDISTUS

Jotta järjestelmä toimisi parhaalla mahdollisella tavalla, suosittelemme seuraavien yksinkertaisten ohjeiden noudattamista:

- 1 Ravitele EcoBox-säiliöstä pois suuremmat roskat ja lika kohdassa "Ecobox-säiliön tyhjennys" kuvatulla tavalla.
- 2 Poista harjaamalla EcoBox-säiliön sisäpinnan seiniin kertynyt hieno pöly.
- 3 Pese Ecobox-säiliön sisä- ja ulkopuoli perusteellisesti lämpimällä vedellä ja astianpesuaineella. Haluttaessa EcoBox-säiliö voidaan tässä vaiheessa pestä astianpesukoneessa täydellä pesu- ja kuivausohjelmalla korkeintaan 75 °C:n lämpötilassa.
- 4 Jos säiliötä ei pestä astianpesukoneessa, huuhto huolellisesti sisä- ja ulkopuolelta varmistaen, ettei EcoBox-säiliöön jää yhtään pesuainetta.
- 5 Kuivaa liika vesi kuivalla liinalla ja jätä kuivumaan vuorokaudeksi tai kunnes säiliö on täysin kuiva.
- 6 Kun Ecobox-säiliö on puhdas ja kuiva, aseta kannen takaosan ohjaimet astian syvennyksiin. Sulje lujasti ja palauta Ecobox-säiliö takaisin alkuperäiseen paikkaansa imurissa.

## SUODATTIMIEN HUOLTO

Suodattimet kannattaa pestä **joka kuukausi**, jotta laitteen suorituskyky pysyisi mahdollisimman hyvänä.

- A Irrota suodattimet.
- B Huuhtelee molemmat suodattimet juoksevalla, kädenlämpoisellä vedellä. Älä hankaa suodattimia, älä käytä astianpesuainetta äläkä pese astianpesukoneessa.
- C Kuivaa liika vesi kuivalla liinalla ja anna kuivua vuorokauden ajan tai kunnes suodatin on täysin kuiva.

Kun suodattimet ovat puhtaat ja kuivat, asenna ne takaisin paikoilleen imuriin.

**Chcete-li zaručit optimální funkci systému, postupujte podle následujících jednoduchých pokynů.**

## ČIŠTĚNÍ NÁDRŽE ECOBOX

Chcete-li zaručit optimální funkci systému, doporučujeme vám **jednou za měsíc nádrž EcoBox umýt** a odstranit tak i nejmenější prach, který se zde shromáždil. Při umývání a optimalizaci funkce vysavače postupujte, prosím, podle následujících jednoduchých pokynů:

- 1** Vyklepejte z nádrže Ecobox velké nečistoty a úlomky. Viz oddíl „Vyprázdnění nádrže Ecobox“.
- 2** Jemný prach z vnitřních stěn nádrže Ecobox odstraňte pomocí kartáče.
- 3** Teplou vodou a v případě potřeby i prostředkem na mytí nádobí pečlivě umyjte vnější a vnitřní stěny nádrže Ecobox. Nádrž Ecobox lze umýt též v myčce nádobí v nastavení na úplný mycí a sušící cyklus při teplotě 75°C.
- 4** Pokud nádrž EcoBox neumýváte v myčce nádobí, pečlivě opláchněte její vnitřní a vnější stěny, aby na nich nezůstal saponát.
- 5** Nádrž otřete suchým hadříkem a nechte ji 24 hodin schnout, dokud nebude zcela suchá.
- 6** Do západek umyté a vyschlé nádrže Ecobox nasadte úchyty krytu a pevně uzavřete. Vraťte nádrž na své původní místo.

## ÚDRŽBA FILTRŮ

Pro zajištění optimálního výkonu je třeba filtry **každý měsíc** umýt.

- A** Vyjměte filtry.
- B** Filtry opláchněte pod teplou vodou. Nečistěte filtry mechanicky, použijte prostředek na mytí nádobí nebo myčku.
- C** Vodu jemně otřete suchým hadříkem a filtry nechte schnout 24 hodin nebo dokud nebudou zcela suché.

Umyté a vyschlé filtry vraťte do vysavače na své původní místo.

**W celu utrzymania najlepszych parametrów eksploatacyjnych urządzenia zaleca się przestrzeganie poniższych, prostych instrukcji.**

## MYCIE POJEMNIKA ECOBOX

W celu utrzymania najlepszych parametrów eksploatacyjnych urządzenia zaleca się **mycie pojemnika Ecobox co miesiąc**, z usunięciem nawet najdrobniejszych pozostających w nim cząsteczek kurzu. Aby umyć pojemnik i zoptymalizować jego funkcjonowanie należy wykonać następujące, proste czynności:

- 1 Wytrzep pojemnik Ecobox, aby usunąć pozostające w nim większe zanieczyszczenia jak opisano w punkcie „Opróżnianie pojemnika Ecobox”.
- 2 Wymieć wnętrze pojemnika Ecobox, aby usunąć drobinki kurzu, które mogły zebrać się na ściankach pojemnika.
- 3 Dokładnie umyj pojemnik Ecobox od wewnątrz i z zewnątrz ciepłą wodą i płynem do zmywania naczyń. Można teraz, w razie potrzeby, włożyć pojemnik Ecobox do zmywarki i umyć go w pełnym cyklu mycia i suszenia w temperaturze do 75°C.
- 4 Jeżeli pojemnik nie jest myty w zmywarce, należy go dokładnie wypukać od wewnątrz i z zewnątrz, aby upewnić się, że nie pozostały na nim resztki detergentu.
- 5 Wytrzyj pojemnik suchą szmatką i pozostaw do wyschnięcia przez 24 godziny lub do chwili całkowitego wysuszenia.
- 6 Po umyciu i wysuszeniu pojemnika włóż tylne zaczepy pokrywy do wgłębień na pojemniku i zdecydowanie zamknij. Włóż pojemnik Ecobox na właściwe miejsce w odkurzaczu.

## KONSERWACJA FILTRÓW

W celu utrzymania najlepszych parametrów eksploatacyjnych urządzenia zaleca się mycie filtrów raz na miesiąc.

- A Wymij filtry z odkurzacza.
- B Wypłucz obydwa filtry w ciepłej wodzie. Nie myj filtrów szczoteczką, używaj płynu do mycia naczyń lub umieść filtry w zmywarce do naczyń.
- C Wytrzyj filtry suchą szmatką i pozostaw do wyschnięcia przez 24 godziny lub do całkowitego wysuszenia.

Po umyciu i osuszeniu filtrów – włóż je we właściwe miejsca w odkurzaczu.

**Для поддержания пылесоса в хорошем рабочем состоянии рекомендуется выполнять описанные ниже простые операции.**

## **ОЧИСТКА ПЫЛЕСБОРНИКА ЕСОВОХ**

Для поддержания пылесоса в хорошем рабочем состоянии рекомендуется ежемесячно промывать пылесборник Ecobox для удаления задержанной в нем мельчайших частиц пыли. Для выполнения промывки пылесборника Ecobox с целью улучшения эксплуатационных характеристик пылесоса нужно выполнить следующие простые операции:

- 1 Встряхните Ecobox для удаления из него крупной грязи и пыли, как описано в разделе «Опорожнение пылесборника Ecobox».
- 2 Очистите Ecobox изнутри с помощью щетки, чтобы удалить мелкую пыль, которая может оседать на стенках пылесборника Ecobox.
- 3 Тщательно промойте внешние и внутренние поверхности Ecobox теплой водой с жидким моющим средством. При желании промывка Ecobox может выполняться в посудомоечной машине с использованием полного цикла мойки и сушки с температурой до 75°C.
- 4 Если для промывки Ecobox не используется посудомоечная машина, тщательно сполосните внутренние и внешние поверхности контейнера, чтобы на них не осталось следов моющего средства.
- 5 Удалите лишнюю воду с помощью сухой ткани и просушите на воздухе в течение 24 часов или до полного высыхания.
- 6 После выполнения промывки и сушки вставьте задние направляющие крышки в пазы на пылесборнике, а затем плотно закройте крышку. Установите пылесборник Ecobox на штатное место в пылесос.

## **УХОД ЗА ФИЛЬТРАМИ**

**Для поддержания пылесоса в хорошем рабочем состоянии рекомендуется ежемесячно промывать фильтры.**

- A Снимите фильтры.
- B Промойте оба фильтра под струей теплой воды. Не мойте фильтры щеткой, не пользуйтесь моющими средствами и посудомоечной машиной.
- C Удалите лишнюю воду с помощью сухой ткани и просушите фильтры в течение 24 часов или до полного высыхания.

После выполнения промывки и сушки установите фильтры на штатные места в пылесос.



Vi rekommenderar att du följer dessa enkla instruktioner för att upprätthålla optimal prestanda.

## RENGÖRA SYSTEMETS ECOBOX

Vi rekommenderar att du **tvättar Ecobox varje månad** och tar bort även det finaste dammet som samlats i den, för att upprätthålla optimal prestanda. Utför följande enkla steg för att tvätta dammsugaren och optimera prestandan:

- 1 Skaka ur Ecobox för att avlägsna större smuts och skräp, som det beskrivs i "Tömma systemets Ecobox".
- 2 Borsta av insidan av Ecobox för att avlägsna fint damm som kan ha fastnat på behållarens väggar.
- 3 Tvätta insidan och utsidan av Ecobox ordentligt med varmt vatten och diskmedel. Ecobox kan nu, om så önskas, placeras i en diskmaskin och tvättas med ett fullständigt tvättprogram med torkning vid upp till 75 °C.
- 4 Om Ecobox inte tvättas i en diskmaskin, ska insidan och utsidan sköljas noga så att inget diskmedel finns kvar på Ecobox.
- 5 Avlägsna överflödigt vatten med en torr trasa och låt Ecobox lufttorka i 24 timmar, eller tills den är helt torr.
- 6 När tvättnings- och torkningsprocedurerna är slutförda ska du föra in guiderna som finns baktill på behållarens lock i behållarens fördjupningar, och sedan stänga ordentligt. Sätt tillbaka Ecobox på sin ursprungliga plats i dammsugaren.

## FILTERUNDERHÅLL

Vi rekommenderar att du tvättar filtren **varje månad** för att upprätthålla bästa prestanda.

- A Avlägsna filtren.
- B Skölj båda filtren i ljummet vatten. Filtren får inte skrubbas, tvättas med diskmedel eller tvättas i diskmaskin.
- C Avlägsna överflödigt vatten med en torr trasa och låt dem lufttorka i 24 timmar, eller tills de är helt torra.

När tvättnings- och torkningsprocedurerna är slutförda ska du sätta tillbaka filtren på dess ursprungliga plats i dammsugaren.

For at støvsugeren skal fortsette å yte maksimalt, anbefaler vi at du følger disse enkle instruksene:

## RENGJØRE ECOBOXEN

For best mulig ytelse anbefaler vi at du **vasker Ecoboxen hver måned**, og fjerner selv det fineste støvet. Ved vasking må du huske på følgende, dersom du vil ha best mulig resultat:

- 1 Rist Ecoboxen for å få ut grovt rusk, som beskrevet i "Tømme Ecoboxen".
- 2 Fjern støv som har lagt seg på innsiden av Ecoboxen, med en børste.
- 3 Vask Ecoboxen grundig inn- og utvendig med varmt vann og oppvaskmiddel. Hvis du ønsker, kan du nå vaske Ecoboxen i oppvaskmaskinen, på full vaske- og tørkesyklus ved opp til 75 °C.
- 4 Hvis ikke du bruker oppvaskmaskin, skyller du grundig inn- og utvendig. Pass på at det ikke blir igjen noe rensmiddel på Ecoboxen.
- 5 Ta bort vann med en tørr klut, og la Ecoboxen lufttørke i 24 timer eller til den er helt tørr.
- 6 Etter at du er ferdig med å vaske og tørke den, fører du tappene bak på lokket inn i sporet på beholderen, før du lukker godt igjen. Sett Ecoboxen tilbake på plass i støvsugeren.

## FILTERVEDLIKEHOLD

For best mulig ytelse anbefaler vi at du vasker filterne **hver måned**.

- A Ta av filterne.
- B Skyll begge filterne i lunkent vann. Ikke skrubbe filterne. Bruk oppvaskmiddel, eller ha dem i oppvaskmaskin.
- C Ta bort vann med en tørr klut, og la filterne lufttørke i 24 timer eller til de er helt tørre.

Etter at du er ferdig med å vaske og tørke dem, setter du filterne tilbake på plass i støvsugeren.



En iyi performansı sağlamak için aşağıdaki basit talimatları uygulamanızı öneririz.

## ECOBAX'IN TEMİZLENMESİ

En iyi performansı sağlamak için, içindeki en ince tozları bile temizlemek için her ay yıkamanızı öneririz. Ecobox'ı yıkamak ve performansın her zaman iyi kalmasını sağlamak için, aşağıdaki bir kaç basit işlem uygulanmalıdır:

- 1 "Ecobox'ın Boşaltılması" bölümünde açıklandığı gibi Ecobox'ı sallayarak içindeki iri toz ve pislikleri temizleyin.
- 2 Ecobox'ın içini fırçalayarak duvarlarına yapışmış olabilecek diğer ince tozları temizleyin.
- 3 Ilık su ve temizleme sıvısı kullanarak Ecobox'ın içini ve dışını iyice yıkayın. Bu noktada, Ecobox'ı isterseniz bulaşık makinesine yerleştirebilir ve en fazla 75 C derecede tam yıkama ve kurutma işlemine tabi tutabilirsiniz.
- 4 Bulaşık makinesine yerleştirmeden önce, Ecobox'ın üzerinde deterjan kalmadığından emin olana kadar içini ve dışını durulayın.
- 5 Kuru bir bezle üzerindeki kalan su damlacıklarını silin ve 24 saat ya da tam kuruyana kadar açıkta kurumaya bırakın.
- 6 Yıkama ve kurutma işlemleri tamamlandıktan sonra kapak arka kılavuzlarını kabın girintisine yerleştirin ve sıkıca kapatın. Ecobox'ı yeniden süpürgeye konumuna takın.

## FİLTRELERİN BAKIMI

En iyi performansın korunması için **her ay** filtreleri yıkamanızı tavsiye ederiz.

- A Filtreleri çıkartın.
- B Filtrelerin ikisini de ılık suyla durulayın. Filtreleri çitilemeyin, yıkama sıvısı kullanın ya da bulaşık makinesine yerleştirin.
- C Kuru bir bezle fazla sularını alın ve 24 saat ya da tamamen kuruyuncaya kadar havayla kurumaya bırakın.

Yıkama işlemleri bitince, filtreleri tekrar süpürgeye içindeki ilk yerlerine yerleştirin.

Για να διατηρήσετε την καλύτερη δυνατή απόδοση, σάς συνιστούμε να ακολουθήσετε αυτές τις απλές οδηγίες.

## ΚΑΘΑΡΙΣΜΑ ΤΟΥ ΔΟΧΕΙΟΥ ECOBOX

Προκειμένου να διατηρήσετε την καλύτερη δυνατή απόδοση, συνιστάται **να πλένετε το δοχείο Ecobox μια φορά το μήνα** αφαιρώντας κάθε ίχνος σκόνης που περιέχει. Για να πλύνετε το δοχείο και να αυξήσετε την αποδοτικότητα της συσκευής, πρέπει να ακολουθήσετε τις παρακάτω οδηγίες:

- 1 Αδειάστε το δοχείο Ecobox, ανακινώντας το, προκειμένου να αφαιρέσετε τις ακαθαρσίες και τα υπολείμματα, όπως περιγράφεται στο κεφάλαιο «Άδειασμα του δοχείου Ecobox».
- 2 Βουρτσίστε το εσωτερικό του δοχείου Ecobox για να αφαιρέσετε κάθε ίχνος σκόνης που ίσως υπάρχει στα τοιχώματα του δοχείου.
- 3 Πλύνετε καλά το δοχείο Ecobox, εσωτερικά και εξωτερικά, χρησιμοποιώντας ζεστό νερό και καθαριστικό υγρό πιάτων. Στη συνέχεια, εάν επιθυμείτε τοποθετήστε το δοχείο Ecobox στο πλυντήριο πιάτων, στο πρόγραμμα πλήρους πλύσης και στεγνώματος, σε θερμοκρασία μέχρι 75 °C.
- 4 Εάν δεν τοποθετήσετε το δοχείο στο πλυντήριο πιάτων, ξεπλύνετε το δοχείο καλά, εσωτερικά και εξωτερικά, φροντίζοντας να αφαιρέσετε όλο το απορρυπαντικό.
- 5 Αφαιρέστε το επιπλέον νερό με ένα στεγνό πανί και αφήστε το δοχείο να στεγνώσει επί 24 ώρες ή για όσο χρειαστεί για να στεγνώσει καλά.
- 6 Αφού ολοκληρωθεί η διαδικασία πλύσης και στεγνώματος, τοποθετήστε τους οδηγούς που υπάρχουν στο πίσω μέρος του καπακιού στην εγκοπή του δοχείου και έπειτα κλείστε καλά το καπάκι. Επανατοποθετήστε το δοχείο Ecobox στη σκούπα, στην αρχική του θέση.

## ΣΥΝΤΗΡΗΣΗ ΤΩΝ ΦΙΛΤΡΩΝ

Για να διατηρήσετε την καλύτερη δυνατή απόδοση, σάς συνιστούμε **να πλένετε τα φίλτρα κάθε μήνα**.

- A Αφαιρέστε τα φίλτρα.
- B Ξεπλύνετε τα φίλτρα με χλιαρό νερό. Μην τρίβετε τα φίλτρα. Χρησιμοποιήστε καθαριστικό υγρό πιάτων ή τοποθετήστε τα στο πλυντήριο πιάτων.
- C Αφαιρέστε το επιπλέον νερό με ένα στεγνό πανί και αφήστε τα φίλτρα επί 24 ώρες ή για όσο χρειαστεί για να στεγνώσουν καλά.

Αφού ολοκληρώσετε τη διαδικασία πλύσης και στεγνώματος, επανατοποθετήστε τα φίλτρα στη σκούπα, στην αρχική τους θέση.



# SENSORY ECOBOX SYSTEM

GENERATION FUTURE



ENGLISH	GB
FRANÇAIS	FR
DEUTSCH	DE
ITALIANO	IT
ESPAÑOL	ES
PORTUGUÊS	PT
VLAAMS/NEDERLANDS	BE/NL
DANSK	DK
SUOMI	FI
Česky	CZ
POLSKI	PL
Русский	RU
SVENSKA	SE
NORSK	NO
Türkçe	TR
Ελληνικά	GR

## USER INSTRUCTIONS

**A**

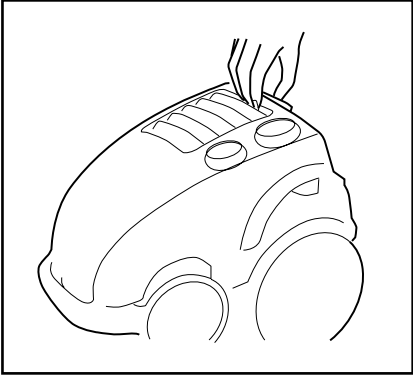

**B**

**(1,2,3)**

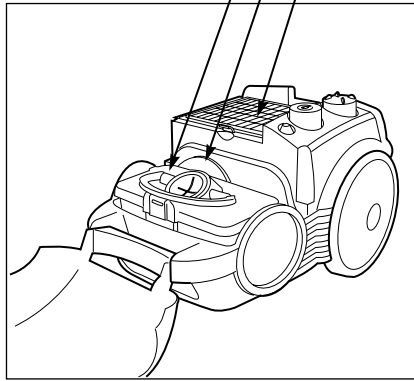

**C**

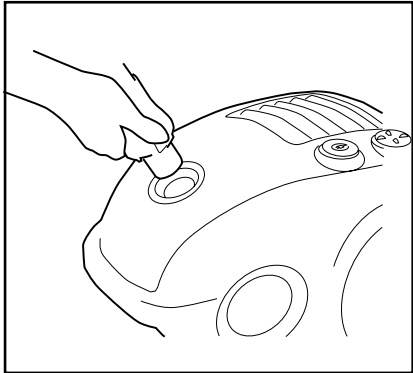

**D**

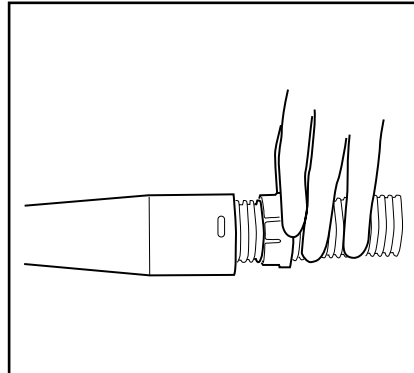

**E1**

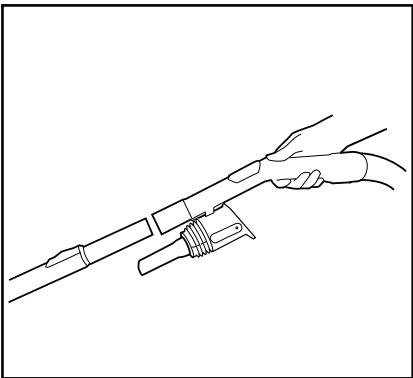

**E2**

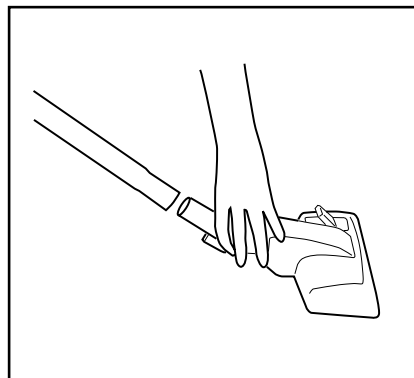

**F**

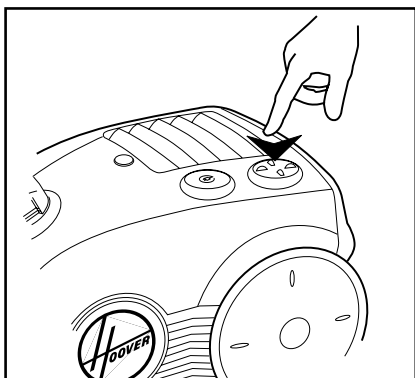

**G**

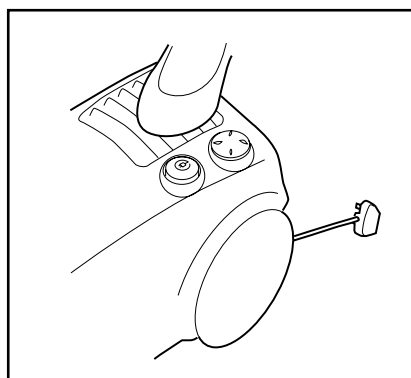

**H**

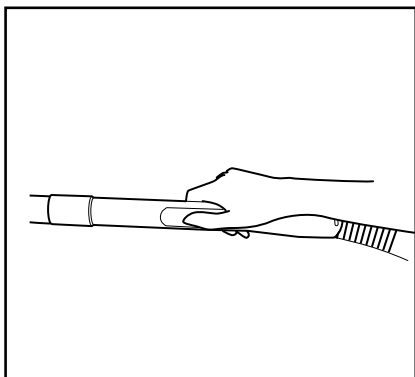

**I**

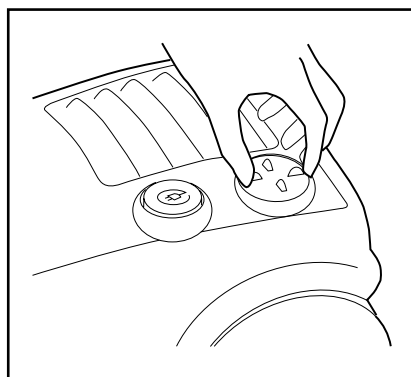

**J**

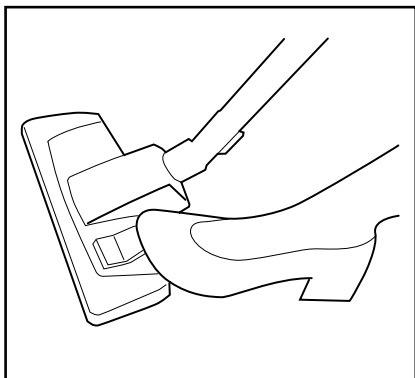

**K1**

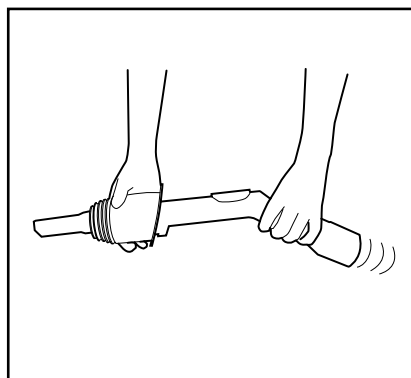

**K2**

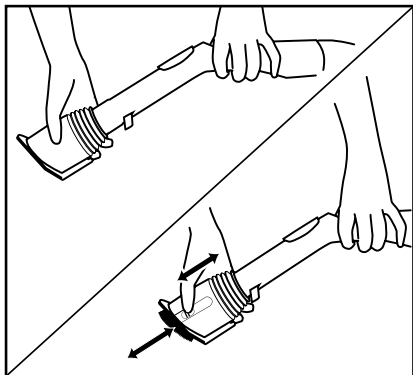

**L**

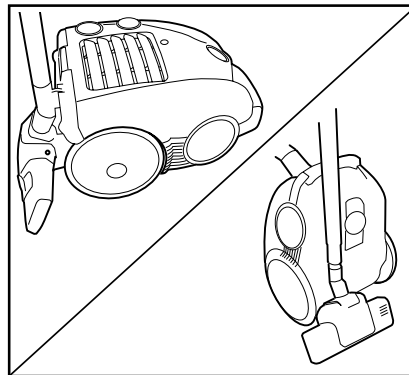

**M**

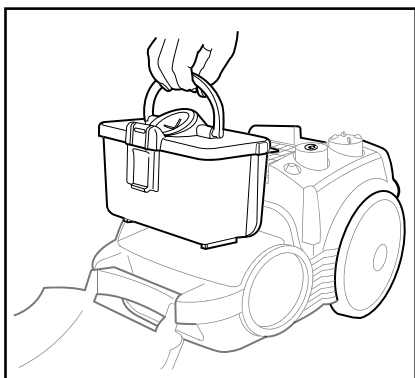

**N**

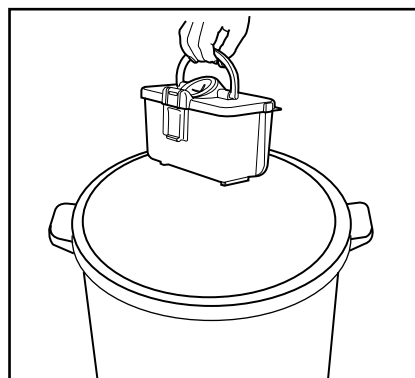

**O**



**P**

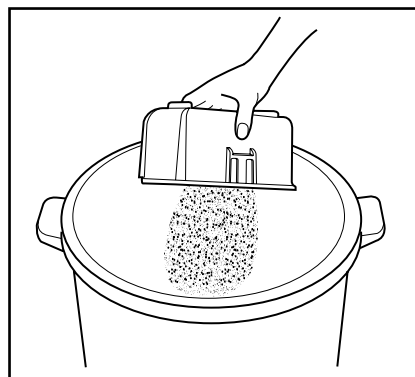

**Q**

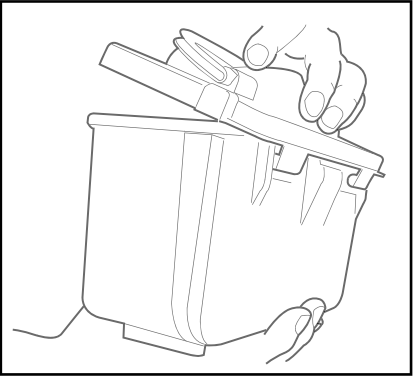

**R**

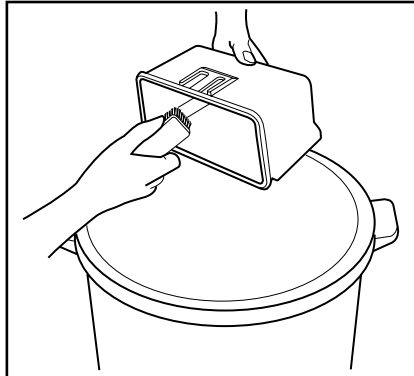

**S**

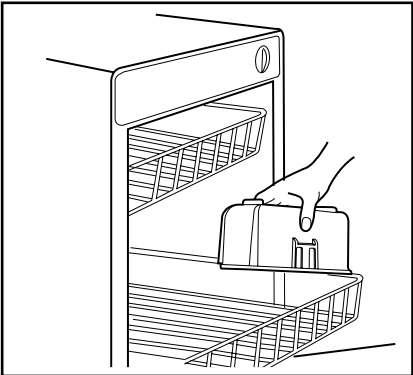

**T**

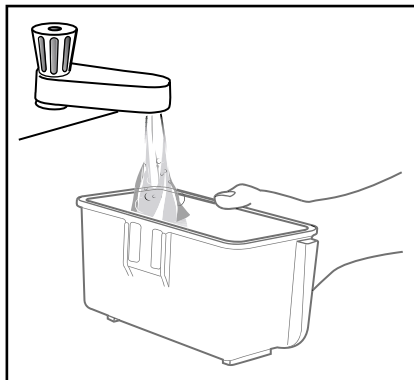

**U**

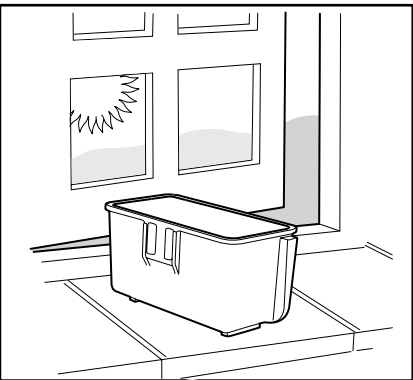

**V**

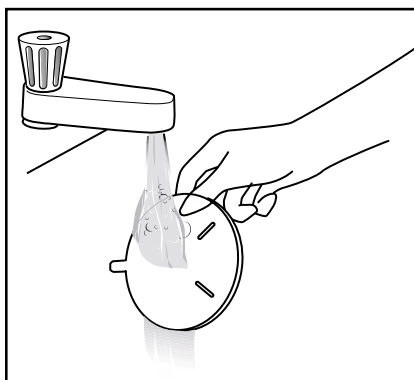

**W**

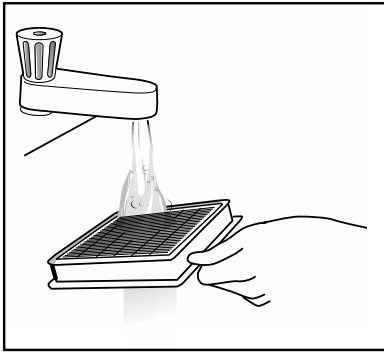

**X**

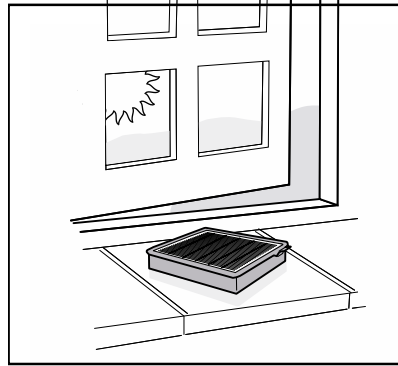





## IMPORTANT SAFETY REMINDERS

This cleaner should only be used for domestic cleaning as described in these instructions. Please ensure that these are fully understood before operating the appliance. This product is double insulated and must not be earthed.

**Important:** The wires in the power cord are coloured in accordance with the following code:

**Blue - Neutral      Brown - Live**

13 Amp fused plug on UK versions only.

## GETTING STARTED

By following this step-by-step guide your new Sensory Ecobox system will be ready for use:

- Remove cleaner and accessories from packaging. Please dispose of the packaging in a safe and environmentally conscientious way.
- Open the top cover (A) ensuring that the Ecobox, Ecobox lid (B1), pre-motor filter (B2) and exhaust filter (B3) are fitted correctly. Close the top cover.
- Insert the hose end into the top cover, ensuring it clips and locks into position (C). To release simply press in the two hose end latches and pull.
- Fix the free end of the hose into the handle using the lock ring (D).
- Fit extension tubes (E1), floor nozzle (E2), or other accessories as required for use.
- Your Sensory Ecobox is now ready for use. Extract the plug and pull out all of the cord. Plug in and switch on.

## FEATURES - DEPENDING ON MODEL,

- Hoovers unique Ecobox is made from a special porous plastic material which allows air to pass through whilst retaining most of the dirt and fine dust.
- **On/Off button (F).** Once plugged in, press this button to start the cleaner. Press it again to stop the cleaner before removing the plug after use.
- **Cord rewind button (G).** Remove the plug from the power supply. Press this button to wind the power cord back into the cleaner.
- **Overheating Protection.** Cleaner automatically switches off. In this event extract the plug from the socket and allow cleaner to cool for 30 minutes. Check if the Ecobox needs cleaning or if there is a blockage in the system (see chapter: "Cleaning The Ecobox" and "Removing A Blockage From The System").
- **Fixed power control (depending on model).** Adjust the suction by moving the handle valve (H): suction will decrease when opening the valve. Use low suction for delicate fabrics.
- **Variable power control (I) (depending on model).** Rotate the on/off button to increase or decrease suction. Use low suction for delicate fabrics.
- **Carpet and floor nozzle (J).** Press pedal on the nozzle to lower the brushes when cleaning hard floors. Press the pedal again to lift the brushes when cleaning carpets.



- **Turbo nozzle (depending on model).** Use the Turbo nozzle for deep cleaning on carpets. **IMPORTANT:** do not use Turbo nozzle on rugs with long fringes, animal hide and over carpet piles with a depth exceeding 15 mm. Do not keep the nozzle stationary while the brush is rotating. Also available as an additional accessory. Order Pack No. J19 0484 5046.
- **Caresse nozzle (depending on model).** Designed for use on wooden or any delicate floors. Also available as an additional accessory. Order Pack No. G50 0484 5044.
- **Multi function tool.** Tool is stored on the handle (E1). Remove tool and use as:
  - a) Crevice tool: for corners and hard to reach areas (K1).
  - b) Furniture nozzle: for soft furnishings and fabrics (K2).
  - c) Dusting brush (depending on model): for bookshelves, frames, keyboards etc. (K2).
- **Tube Parking and Storage (L).** The tubes can be parked at the rear of the cleaner or stored into the storage slot underneath the cleaner.

## EMPTYING THE ECOBOX

Check and empty the Ecobox regularly, best after each use.

- Extract the Ecobox (M).
- Use the handle to carry the Ecobox to the dustbin (N).
- Press the latch to remove the cover from the Ecobox as shown (O).
- Grip the Ecobox firmly and tip the contents into the dustbin. Shake the Ecobox if required or use a brush to remove any of the remaining dust or debris (P).
- Wash the Ecobox regularly. See chapter "Cleaning The Ecobox".
- To close the Ecobox locate the cover rear guides into the container recess then close firmly (Q).
- Return the Ecobox back to its original position in the cleaner.

## CLEANING THE ECOBOX

To maintain the best performance, we would recommend that you **wash the Ecobox every month** removing even the finest dust retained in it. To wash and optimise the performance the following simple steps should be taken:

- Shake out the Ecobox to remove large dirt and debris (P) as described in "Emptying The Ecobox".
- Brush the inside of the Ecobox to remove the fine dust that may have formed on the walls of the Ecobox (R).
- Wash the inside and outside of the Ecobox thoroughly using warm water and washing up liquid. At this point if desired, the Ecobox can be placed in a dishwasher and washed on a full wash and dry cycle at up to 75°C (S).
- If not placed in a dishwasher rinse thoroughly inside and outside making sure no detergent is left on the Ecobox (T).



- Remove excess water with a dry cloth and leave to air dry for 24 hours or until fully dry (U).
- After completing the washing and drying operations, locate the cover rear guides into the container recess then close firmly. Return the Ecobox to its original position in the cleaner. (Q)

## **FILTERS MAINTENANCE**

- To maintain best performance we recommend that you wash the filters every month.
- To access the filters please refer to diagram (B1, 2, 3).
- Rinse both filters under hand warm water (V and W).
- Do not scrub the filters, use washing up liquid or place in a dishwasher.
- Remove excess water with a dry cloth and leave to air dry for 24 hours or until fully dry (X).
- After completing the washing and drying operations, return the filters to their original positions in the cleaner.

## **REMOVING A BLOCKAGE FROM THE SYSTEM**

If there is a noticeable drop in performance see the following 2 points:

- 1) Check if the Ecobox is full (If so refer to chapter "Emptying The Ecobox").
- 2) If not full then:
  - a) Have you cleaned the Ecobox and filters recently? If not please refer to the chapters "Cleaning The Ecobox" and "Filters Maintenance".
  - b) Check if there is any other blockage in the system.
    - Use a rod or pole to remove any blockage from the tubes and flexible hose.
    - It may also be possible to remove an obstruction in the flexible hose by lightly squeezing or bending it.
    - Check and clean if required the underside of the nozzle by using the crevice tool.

## **SIMPLE USER CHECK LIST BEFORE CALLING FOR SERVICE**

- 1) Is there a working electricity supply to the cleaner? Check with another appliance.
- 2) Is there a restriction?
  - a) Is the Ecobox full? Please refer to chapter "Emptying The Ecobox".
  - b) Are the filters or Ecobox blocked? Please refer to chapter "Filters Maintenance" or "Cleaning The Ecobox".
  - c) Is the hose or nozzle blocked? Please refer to chapter "Removing A Blockage from The System".
- 3) Has the cleaner automatically switched off? In this case the Overheating Protection has been activated. Please refer to chapter "Features", paragraph "Overheating Protection".



Please remember that:

- 1) Some carpets can cause a small build up of static electricity. Any static discharge is not hazardous to health or the product.
- 2) A service charge will be made if the cleaner is examined and found in working order, has not been assembled in accordance with these instructions, or has been misused.

## Do

- Call Hoover Customer Help Line 08705 400 600 in the event of dissatisfaction
- Ensure that all service and repairs are carried out by an authorised Hoover Service Engineer
- Only use genuine Hoover parts
- Empty the Ecobox regularly. Best after each use
- Always switch off and remove the power plug from the electricity supply after use and before cleaning the appliance or attempting user maintenance as described in these instructions

Remember: Electricity can be dangerous

## DO NOT

- Position the cleaner above you when cleaning stairs
- Use cleaner without the Ecobox correctly fitted
- Use your cleaner out of doors, on wet surfaces or for wet pick up
- Pick up matches, hot ash, cigarette ends or anything that may damage the product
- Spray with or pick up flammable liquids, cleaning fluids, aerosols or their vapours as this may cause risk of fire/explosion
- Run over, stand on, or wrap the power cord around arms or legs when using your cleaner
- Continue to use your cleaner if it or the plug/power cord appears to be faulty or damaged. To avoid safety hazards the cleaner must only be repaired by an authorised Hoover Service Engineer
- Recharge batteries, dispose of in fire or dissect - danger of explosion

ACCESSORIES: For accessories please quote the following pack numbers

- Turbo Nozzle pack No. J19 0484 5046
- Caresse Nozzle pack No. G50 0484 5044

### Guarantee Statement

The guarantee conditions for this appliance are as defined by our representative in the country in which it is sold. Details regarding these conditions can be obtained from the dealer from whom the appliance was purchased.

The bill of sale or receipt must be produced when making any claim under the terms of this guarantee.

Subject to change without notice.

GIAS Customer service 08705 400500

Hoover spares 01204 556111

BSI

ISO9002

BEAB Approved

**Quality:** Our UK factories meet the strict quality standards of the British Standards Institution (BSI).

**Safety:** We gain independent approval from BEAB to demonstrate that our domestic electrical appliances are safe.

BEAB - the British Electrotechnical Approvals Board - ensures that European safety standards are met and maintained throughout the production life of an appliance.



Hoover Limited  
Pentrebach  
Merthyr Tydfil  
Mid-Glamorgan  
CF48 4TU

**Part No: 05655118**

## REMARQUES IMPORTANTES CONCERNANT LA SÉCURITÉ

N'utilisez cet aspirateur que pour les usages domestiques, comme prévu dans cette notice. S'assurer que ces instructions sont bien comprises avant d'utiliser l'appareil. Cet appareil est équipé d'une double isolation et ne doit pas être relié à la terre.

**Important** : Les fils du cordon d'alimentation sont colorés selon le code suivant :

**Bleu – Neutre    Marron – Phase**

Prise avec fusible de 13 ampères montée uniquement sur les modèles pour le Royaume-Uni.

## PREMIÈRE UTILISATION

Suivez ces instructions détaillées et votre nouveau Sensory Ecobox System sera prêt à être utilisé :

- Sortez l'aspirateur et ses accessoires de l'emballage. Merci de mettre l'emballage à la poubelle sans danger et en respectant l'environnement.
- Ouvrez le couvercle supérieur (A) en vérifiant que l'Ecobox, le couvercle de l'Ecobox (B1), le filtre pré-moteur (B2) et le filtre de sortie moteur (B3) sont correctement montés. Refermez le couvercle supérieur.
- Enfoncez le bout du flexible dans le couvercle supérieur jusqu'à ce que vous entendiez un déclic et qu'il soit fixé en place (C). Pour le dégager, il suffit d'appuyer sur les deux taquets du bout du flexible et de tirer.
- Fixez l'autre bout du flexible dans le manche en utilisant l'anneau de verrouillage (D).
- Montez les rallonges (E1), le suceur pour sol dur (E2) ou d'autres accessoires selon les besoins.
- Votre Sensory Ecobox System est prêt à l'emploi. Sortez la prise électrique et tirez le cordon jusqu'au bout. Branchez la prise au secteur et mettez l'aspirateur en marche.

## CARACTÉRISTIQUES - VARIENT SELON LE MODÈLE.

- L'Ecobox est un produit Hoover unique en son genre. Il est fabriqué dans un matériau plastique poreux spécial qui laisse passer l'air tout en retenant les débris et la poussière.
- **Bouton marche/arrêt (F)**. Une fois que l'aspirateur est branché, appuyez sur ce bouton pour le mettre en marche. Appuyez de nouveau pour arrêter l'aspirateur puis débranchez-le après utilisation.
- **Bouton d'enrouleur (G)**. Débranchez la prise d'alimentation secteur. Appuyez sur ce bouton pour enrouler automatiquement le cordon d'alimentation dans l'aspirateur.
- **Commutateur de protection thermique**. L'aspirateur s'arrête automatiquement. Si cela se produit, débranchez l'appareil du secteur et laissez-le refroidir pendant 30 minutes. Vérifiez si l'Ecobox a besoin d'être nettoyé ou s'il y a un blocage dans le système (voir les chapitres « Nettoyer l'Ecobox » et « Supprimer un blocage de l'aspirateur »)
- **Puissance fixe (selon le modèle)**. Réglez la puissance d'aspiration en déplaçant la glissière qui se trouve sur le manche du flexible (H) : l'aspiration est moins puissante quand la glissière est ouverte. Utilisez une aspiration faible pour les tissus délicats.
- **Puissance variable (I) (selon le modèle)**. Faites tourner le bouton marche/arrêt pour augmenter ou diminuer l'aspiration. Utilisez une aspiration faible pour les tissus délicats.
- **Suceur pour sol dur/moquette (J)**. Appuyez sur la pédale du suceur pour faire sortir les brosses lorsque vous nettoyez des sols durs. Appuyez à nouveau sur la pédale pour rétracter les brosses pour les moquettes.

- **Suceur turbo (selon le modèle).** Le suceur turbo est idéal pour nettoyer les moquettes en profondeur. **IMPORTANT :** Ne pas utiliser le suceur turbo sur les tapis à longues franges, les peaux d'animaux et les moquettes à brins de plus de 15 mm de longueur. Ne pas laisser le suceur immobile lorsque la brosse tourne. Également disponible en tant qu'accessoire supplémentaire. Référence de commande J19 0484 5046.
- **Suceur Caresse (selon le modèle).** S'utilise sur les parquets ou sur tout sol délicat. Également disponible en tant qu'accessoire supplémentaire. Référence de commande G50 0484 5044.
- **Accessoire polyvalent.** Cet accessoire est rangé sur le manche (E1). Retirez-le pour vous en servir comme :
  - a) Suceur en pointe : pour les recoins et les endroits difficiles à atteindre (K1).
  - b) Suceur pour meuble : pour les tissus d'ameublement (K2).
  - c) Brosse à poussière (selon le modèle) : pour les bibliothèques, les cadres, les claviers, etc. (K2)
- **Porte-accessoires et rangement à accessoires (L).** Vous pouvez placer les tubes à l'arrière de l'aspirateur ou bien les ranger dans le logement qui se trouve sous l'aspirateur.

## VIDER L'ECOBX

Vérifiez et videz régulièrement l'Ecobox, de préférence après chaque utilisation.

- Retirez l'Ecobox (M).
- Transportez l'Ecobox jusqu'à la poubelle en le tenant par la poignée (N).
- Appuyez sur le verrou pour retirer le couvercle de l'Ecobox comme indiqué (O).
- Saisissez fermement l'Ecobox et videz son contenu dans la poubelle. Le cas échéant, secouez l'Ecobox ou servez-vous d'une brosse pour retirer les résidus de débris ou de poussière (P).
- Lavez régulièrement le contenant Ecobox. Consultez le chapitre « Nettoyer l'Ecobox ».
- Pour refermer l'Ecobox, insérez les guides arrière du couvercle dans l'évidement du contenant et fermez bien le couvercle (Q).
- Remettez l'Ecobox à son emplacement d'origine dans l'aspirateur.

## NETTOYER L'ECOBX

Pour conserver toutes les performances du système, nous vous recommandons de **laver l'Ecobox une fois par mois** afin d'éliminer le moindre résidu de poussière. Pour laver l'Ecobox et optimiser ses performances, suivez cette procédure :

- Videz l'Ecobox en le secouant pour éliminer les débris et la poussière (P) comme indiqué dans « Vider l'Ecobox ».
- Brossez l'intérieur de l'Ecobox pour éliminer la poussière fine susceptible de s'être collée aux parois de l'Ecobox (R).
- Lavez soigneusement l'intérieur et l'extérieur de l'Ecobox à l'eau tiède avec du liquide vaisselle. Si vous le voulez, vous pouvez ensuite mettre l'Ecobox au lave-vaisselle pour un cycle complet de lavage et de séchage jusqu'à 75°C (S).
- Si vous ne mettez pas l'Ecobox au lave-vaisselle, rincez complètement l'intérieur et l'extérieur en éliminant toutes traces de détergent (T).
- Éliminez l'excès d'eau avec un chiffon sec et laissez sécher à l'air libre pendant 24 heures ou jusqu'à ce que l'Ecobox soit complètement sec (U).
- Une fois la procédure de nettoyage et de séchage terminée, insérez les guides arrière du couvercle dans l'évidement du contenant et refermez bien le couvercle. Remettez l'Ecobox à son emplacement d'origine dans l'aspirateur (Q).

## MAINTENANCE DES FILTRES

- Pour que les filtres restent performants, nous vous recommandons de les laver une fois par mois.
- Pour l'accès aux filtres, veuillez consulter l'illustration (B1, 2, 3).
- Rincez les deux filtres sous l'eau tiède (V et W).
- Vous ne devez pas brosser les filtres, utiliser de liquide vaisselle ni mettre les filtres au lave-vaisselle.
- Éliminez l'excès d'eau avec un chiffon sec et laissez sécher à l'air libre pendant 24 heures ou jusqu'à ce que les filtres soient complètement secs (X).
- Une fois la procédure de nettoyage et de séchage des filtres terminée, remettez-les à leurs emplacements d'origine dans l'aspirateur.

## SUPPRIMER UN BLOCAGE DE L'ASPIRATEUR

Si vous constatez une diminution de performance sensible, vérifiez les 2 points ci-dessous :

- 1) Vérifiez si l'Ecobox est plein (dans l'affirmative, consultez le chapitre « Vider l'Ecobox »).
- 2) S'il n'est pas plein :
  - a) Avez-vous nettoyé l'Ecobox et les filtres récemment ? Dans la négative, consultez les chapitres « Nettoyer l'Ecobox » et « Maintenance des filtres ».
  - b) Vérifiez pour voir si l'aspirateur n'est pas bloqué.
    - Utilisez une tige pour supprimer un blocage éventuel dans les tubes ou dans le flexible.
    - Vous pouvez également supprimer un blocage dans le flexible en le pressant ou en le pliant légèrement.
    - Vérifiez le dessous du suceur et, le cas échéant, nettoyez-le au moyen du suceur en pointe.

## LISTE DES VÉRIFICATIONS AVANT D'APPELER UN TECHNICIEN

- 1) L'aspirateur est-il alimenté en électricité ? Essayez de brancher un autre appareil à la même prise.
- 2) Y-a-t-il un blocage ?
  - a) L'Ecobox est-il plein ? Consultez le chapitre « Vider l'Ecobox ».
  - b) Les filtres de l'Ecobox sont-ils bloqués ? Consultez le chapitre « Maintenance des filtres » ou « Nettoyer l'Ecobox ».
  - c) Le flexible ou le suceur est-il bloqué ? Consultez le chapitre « Supprimer un blocage de l'aspirateur ».
- 3) L'aspirateur s'est-il arrêté automatiquement ? Dans ce cas, le commutateur de protection thermique a été activé. Consultez le paragraphe « Commutateur de protection thermique » du chapitre « Caractéristiques ».

N'oubliez pas :

- 1) Certains tapis peuvent provoquer une petite accumulation d'électricité statique. Une décharge statique n'est pas dangereuse, ni pour la santé ni pour l'appareil.
- 2) Si vous appelez un technicien qui examine l'aspirateur mais le déclare en état de marche, ou si ce dernier se rend compte qu'il n'a pas été monté conformément à ces instructions ou qu'il n'a pas été utilisé correctement, des frais vous seront facturés.

**À FAIRE :**

- Si vous avez la moindre réclamation, appelez le service d'assistance à la clientèle Hoover au +44 8705 400 600.
  - Veillez à ce que l'entretien et les réparations soient réalisés par un technicien Hoover agréé
  - Utilisez uniquement des pièces Hoover d'origine
  - Videz régulièrement l'Ecobox, de préférence après chaque utilisation
  - Arrêtez toujours l'aspirateur et débranchez-le du secteur après emploi et avant de le nettoyer ou de réaliser une opération de maintenance décrite dans cette notice
- Attention : l'électricité peut être dangereuse

**À NE PAS FAIRE :**

- Ne pas mettre l'aspirateur au-dessus de vous lorsque vous nettoyez des escaliers
- Utiliser l'aspirateur si l'Ecobox n'est pas correctement installé
- Ne pas utiliser votre aspirateur à l'extérieur, sur des surfaces humides ou pour aspirer des liquides
- Ne pas aspirer des allumettes, des cendres chaudes, des mégots de cigarettes ou tout objet susceptible d'endommager l'aspirateur
- Ne pas aspirer un liquide inflammable, des fluides de nettoyage, des aérosols ou leurs vapeurs car cela présente des risques d'incendie ou d'explosion
- Ne pas faire passer l'aspirateur sur le cordon d'alimentation, marcher sur celui-ci ou l'enrouler sur vos bras ou vos jambes pendant que vous utilisez l'aspirateur
- Ne pas continuer à utiliser votre aspirateur si la prise/le cordon d'alimentation ou l'aspirateur lui-même ne fonctionne pas correctement ou est endommagé. Pour éviter les situations dangereuses, l'aspirateur doit être réparé uniquement par un technicien agréé Hoover
- Ne pas recharger les piles, les jeter dans un feu ou les ouvrir – danger d'explosion

ACCESSOIRES : Pour les accessoires, citez les références suivantes :

- Suceur turbo – référence J19 0484 5046
- Suceur caresse – référence G50 0484 5044



Groupe Rosières SAS  
13, rue Auger  
93697 Pantin Cedex  
Tel. : 01-49159200

Candy Hoover Belgium  
Haaschtsesteenweg 162B  
1820 melsbroek  
Tel. : 02-752 94 11

Candy Hoover AG  
Boesch 21  
CH-6331 Huenenberg  
Tél. : 041-7854040

**Garantie**

Les conditions de garantie de cet appareil sont définies par notre représentant dans le pays où il est vendu et peuvent être obtenues auprès de votre revendeur. La facture d'achat ou le reçu doit être présenté pour toutes réclamations relevant directement des conditions de cette garantie. Ces conditions peuvent être modifiées sans préavis.

Ligne Service Consommateurs (France) 02.48.55.69.67

Gias Customer Service (Belgique) 0903/99109

Gias Customer Service (Suisse) 0848/780 780

BSI

ISO9002

BEAB Approved

**Qualité** : nos unités de production au Royaume-Uni sont en totale conformité avec les normes de qualité rigoureuses fixées par le BSI (British Standards Institution).

**Sécurité** : la sécurité de nos appareils électroménagers est certifiée par le BEAB (British Electrotechnical Approval Board), organisme d'homologation indépendant. Celui-ci veille à ce que les normes de sécurité européennes soient respectées et tenues tout au long du cycle de production de l'appareil.



## WICHTIGE SICHERHEITSHINWEISE

Dieser Bodenstaubsauger darf nur zur Reinigung im Haushalt gemäß dieser Anleitung verwendet werden. Vor dem Gebrauch des Geräts muss die vorliegende Bedienungsanleitung gelesen und vollständig verstanden worden sein. Dieses Produkt ist doppelt isoliert und darf nicht geerdet werden.

**Wichtig:** Die einzelnen Drähte des Netzkabels sind wie folgt farbig codiert:

**Blau - Nullleiter Braun - Spannungsführend**

Mit 13-Ampere-Sicherung versehene Netzstecker nur bei den Modellen für den britischen Markt

## INBETRIEBNAHME

Bitte befolgen Sie die nachstehenden Schritte zur Inbetriebnahme Ihres neuen Sensory Ecobox Systems:

- Nehmen Sie das Gerät und sämtliches Zubehör aus der Verpackung. Bitte entsorgen Sie das Verpackungsmaterial auf sichere und umweltfreundliche Weise.
- Öffnen Sie den Gehäusedeckel (A) und überzeugen Sie sich davon, dass die Ecobox, der Ecobox-Deckel (B1), der Motorschutzfilter (B2) und der Abluftfilter (B3) korrekt installiert sind. Schließen Sie den Gehäusedeckel.
- Setzen Sie das Ende des Saugschlauches in den Gehäusedeckel ein, wobei darauf zu achten ist, dass das Schlauchende einrastet und in seiner Stellung arretiert ist (C). Zur Freigabe drücken Sie die zwei Sperren und ziehen den Schlauch heraus.
- Befestigen Sie das andere Ende des Schlauches unter Verwendung des Sicherungsringes im Griff (D).
- Bringen Sie die Verlängerungsrohre (E1), die Bodendüse (E2) und das andere zur Verwendung gewünschte Zubehör an.
- Damit ist der Bodenstaubsauger einsatzbereit. Ziehen Sie den Gerätestecker und das Netzkabel heraus. Schließen Sie den Gerätestecker an einer Netzsteckdose an und schalten Sie das Gerät ein.

## GERÄTEAUSSTATTUNG - VOM JEWELIGEN MODELL ABHÄNGIG

- Hoovers einzigartige Ecobox ist aus einem speziellen, porösen Kunststoff hergestellt, der luftdurchlässig ist, doch zugleich den meisten Schmutz und feinen Staub zurückhält.
- **Ein-/Ausschalter (F).** Nachdem das Gerät an der Netzsteckdose angeschlossen wurde, drücken Sie den Schalter zum Einschalten des Staubsaugers. Drücken Sie den Schalter erneut zum Ausschalten des Gerätes und ziehen Sie den Netzstecker nach Gebrauch des Gerätes aus der Dose.
- **Kabelaufwicklung (G).** Ziehen Sie den Gerätestecker aus der Netzsteckdose. Drücken Sie den Schalter „Kabelaufwicklung“, wodurch das Netzkabel in den Staubsauger eingezogen wird.
- **Überhitzungsschutz.** Das Gerät schaltet sich automatisch aus. Ziehen Sie in diesem Fall den Gerätestecker aus der Steckdose und lassen Sie den Staubsauger 30 Minuten abkühlen. Prüfen Sie, ob die Ecobox gereinigt werden muss oder ob der Saugtrakt verstopft ist (siehe Abschnitt: „Reinigung der Ecobox“ und „Verstopfung des Saugtrakts beheben“).
- **Nicht variable Saugkraftregulierung (je nach Modell).** Stellen Sie die Saugstärke durch Bewegen des Schlauchgriff-Ventils (H) ein: Bei geöffnetem Ventil sinkt die Saugleistung. Eine niedrige Saugleistung sollte beim Reinigen empfindlicher Stoffe verwendet werden.

- **Variable Saugkraftregulierung (I) (je nach Modell).** Drehen Sie den Ein-/Ausschalter zur Erhöhung bzw. Senkung der Saugleistung. Eine niedrige Saugleistung sollte beim Reinigen empfindlicher Stoffe verwendet werden.
- **Teppich-/Bodendüse (J).** Zur Reinigung von Hartböden drücken Sie das Pedal an der Düse, wodurch die Bürsten gesenkt werden. Drücken Sie das Pedal noch einmal, um die Bürsten zum Reinigen von Teppichen zu heben.
- **Turbodüse (je nach Modell).** Verwenden Sie die Turbodüse zur Tiefenreinigung von Teppichen. WICHTIG: Benutzen Sie die Turbodüse nicht auf Teppichen und Vorlegern mit langen Fransen, auf Tierellen und auf über 15 mm tiefem Teppichflor. Halten Sie die Düse bei drehender Bürste nicht still. Ist auch als zusätzliches Zubehör erhältlich. Packungs-Nr. J19 0484 5046.
- **Bodendüse mit Polierschuh (je nach Modell).** Zur Reinigung von Holz- oder anderen empfindlichen Böden. Ist auch als zusätzliches Zubehör erhältlich. Packungs-Nr. G50 0484 5044.
- **Saugzubehör. Befindet sich am Griff (E1).** Dieses Zubehör dient als:
  - a) Fugendüse: Für Ecken und schwer erreichbare Bereiche (K1).
  - b) Möbelpinsel: Für Polster und Stoffe (K2).
  - c) Staubbürste (je nach Modell): Für Bücherregale, Rahmen, Tastaturen usw. (K2).
- **(Kurzzeit-) Aufbewahrung der Saugschläuche (L).** Das Saugrohr kann zur vorübergehenden Unterbringung während des Arbeitsvorgangs am Staubsauger befestigt werden. Zur längeren Aufbewahrung verwenden Sie bitte die Verstaufhilfeposition am Geräteboden.

## LEEREN DER ECOBOX

Prüfen und leeren Sie die Ecobox regelmäßig, am besten nach jedem Gebrauch.

- Nehmen Sie die Ecobox aus dem Staubsauger heraus (M).
- Tragen Sie die Ecobox am Griff zu einem Mülleimer (N).
- Drücken Sie die Sperre und nehmen Sie den Deckel der Ecobox ab (O).
- Halten Sie die Ecobox gut fest und schütten Sie den Inhalt in den Mülleimer. Schütteln Sie ggf. die Ecobox oder entfernen Sie übrigen Staub oder Schmutz mit einer Bürste (P).
- Waschen Sie den Ecobox-Behälter regelmäßig aus (siehe Abschnitt „Reinigung der Ecobox“).
- Setzen Sie die Deckelführungen in die Behälteraussparung und schließen Sie den Deckel der Ecobox fest (Q).
- Setzen Sie die Ecobox wieder richtig in den Staubsauger ein.

## REINIGUNG DER ECOBOX

Zur Aufrechterhaltung der optimalen Leistung des Produkts empfehlen wir, die Ecobox monatlich einmal zu waschen, um den feinen Staub, den das Gerät in die Ecobox gesaugt hat, zu entfernen. So waschen Sie die Ecobox und optimieren damit die Leistung Ihres Geräts:

- Schütten Sie den groben Schmutz so, wie in „Leeren der Ecobox“ erläutert, aus der Ecobox heraus (P).
- Bürsten Sie die Innenseite der Ecobox aus, um den feinen Staub, der sich an den Wänden des Behälters abgesetzt hat, zu entfernen (R).
- Waschen Sie die Innen- und Außenseite der Ecobox mit warmem Wasser, dem ein Geschirrspülmittel beigegeben wurde, gründlich sauber. Anschließend kann die Ecobox in einem Geschirrspüler in einem kompletten Wasch- und Trockenzyklus bei bis zu 75°C gereinigt werden (S).
- Wird kein Geschirrspüler verwendet, so spülen Sie die Ecobox innen und außen gründlich ab, damit kein Spülmittel an der Ecobox zurückbleibt (T).

- Trocknen Sie die Ecobox mit einem trockenen Tuch ab und lassen Sie diese 24 Stunden lang, oder bis sie vollständig trocken ist, an der Luft trocknen (U).
- Setzen Sie, nachdem die Ecobox gewaschen und getrocknet wurde, die Deckelführungen in die Behälterausparung und schließen Sie den Deckel fest. Setzen Sie die Ecobox wieder richtig in den Staubsauger ein (Q).

### **WARTUNG DER FILTER**

- Zur Aufrechterhaltung der optimalen Leistungsfähigkeit Ihres Geräts empfehlen wir Ihnen, die Filter monatlich einmal zu waschen.
- Die Anordnung der Filter entnehmen Sie bitte den Abbildungen B1, 2, 3.
- Spülen Sie beide Filter unter handwarmem Wasser gründlich ab (V und W).
- Verwenden Sie zur Reinigung der Filter keine Bürste, sondern waschen Sie diese mit warmem Wasser, dem ein Geschirrspülmittel beigegeben wurde, oder im Geschirrspüler.
- Trocknen Sie die Filter mit einem trockenen Tuch ab und lassen Sie diese 24 Stunden lang, oder bis sie vollständig trocken sind, an der Luft trocknen (X).
- Setzen Sie die Filter nach ihrer Reinigung und dem Trocknen wieder korrekt in den Staubsauger ein.

### **VERSTOPFUNG DES SAUGTRAKTS BEHEBEN**

Falls Sie ein Nachlassen der Leistung Ihres Geräts feststellen, befolgen Sie bitte diese zwei Punkte:

- 1) Prüfen Sie, ob die Ecobox voll ist (falls ja, siehe Abschnitt „Leeren der Ecobox“).
- 2) Ist sie nicht voll:
  - a) Haben Sie die Ecobox und die Filter vor nicht allzu langer Zeit gereinigt? Falls nicht, befolgen Sie bitte die Schritte in den Abschnitten „Reinigung der Ecobox“ und „Wartung der Filter“.
  - b) Prüfen Sie, ob der Saugtrakt an einer anderen Stelle verstopft ist.
    - Entfernen Sie Verstopfungen in den Saugrohren oder im Saugschlauch mit einem Stab.
    - Eine Verstopfung im Saugschlauch kann auch entfernt werden, indem dieser geringfügig gedrückt oder gebogen wird.
    - Reinigen Sie die Unterseite der Teppich- und Bodendüse häufig unter Verwendung der Fugendüse.

### **BITTE PRÜFEN SIE DIE FOLGENDEN PUNKTE, BEVOR SIE SICH AN DEN KUNDENDIENST WENDEN:**

- 1) Ist die Stromversorgung in Ordnung? Prüfen Sie dies mit einem anderem elektrischen Gerät.
- 2) Ist der Saugtrakt verstopft?
  - a) Ist die Ecobox voll? Siehe Abschnitt „Leeren der Ecobox“.
  - b) Sind die Filter oder die Ecobox verstopft? Siehe Abschnitte „Wartung der Filter“ oder „Reinigung der Ecobox“.
  - c) Sind der Saugschlauch oder die Düse verstopft? Siehe Abschnitt „Verstopfung des Saugtrakts beheben“.
- 3) Hat sich der Staubsauger selbständig ausgeschaltet? In diesem Fall ist der Überhitzungsschutz aktiviert. Siehe Abschnitt „Geräteausstattung“, Absatz „Überhitzungsschutz“.

Bitte denken Sie daran, dass:

- 1) bestimmte Teppiche die Bildung statischer Elektrizität verursachen können. Statische Entladungen sind weder gesundheitsgefährdend noch verursachen sie die Beschädigung des Produkts.
- 2) eine Gebühr erhoben wird, wenn sich das Gerät als funktionstüchtig herausstellt, nicht gemäß dieser Anleitung zusammengesetzt oder missbräuchlich benutzt wurde.

**WICHTIG**

- Rufen Sie Ihr zuständiges Hoover Kundendienstzentrum an, falls Sie mit Ihrem Produkt nicht zufrieden sind.
- Lassen Sie alle Wartungen und Reparaturen nur von einem Hoover Kundendiensttechniker ausführen.
- Verwenden Sie nur Hoover Original-Ersatzteile.
- Leeren Sie die Ecobox regelmäßig, am besten nach jedem Gebrauch.
- Trennen Sie das Gerät durch Abziehen des Netzsteckers aus der Dose stets vom Netz, bevor Sie das Gerät reinigen oder gemäß dieser Anleitung warten.  
Denken Sie stets daran: Elektrizität kann gefährlich sein!

**SICHERHEITSHINWEISE**

- Positionieren Sie den Staubsauger bei der Reinigung von Treppen nicht oberhalb Ihres Standorts!
- Benutzen Sie das Gerät nicht ohne richtig eingesetzte Ecobox.
- Verwenden Sie das Gerät nicht im Freien, auf nassen Flächen oder zur Aufnahme von nassen Gegenständen!
- Saugen Sie keine Streichhölzer, heiße Asche, Zigarettenkippen oder andere Gegenstände auf, die den Staubsauger beschädigen könnten.
- Sprühen Sie keine entzündlichen Flüssigkeiten, Reinigungsmittel, Aerosole oder ihre Dämpfe auf den Staubsauger, und saugen Sie solche Flüssigkeiten nicht auf – Feuer- bzw. Explosionsgefahr!
- Fahren Sie beim Gebrauch des Staubsaugers nicht über das Netzkabel, stellen Sie sich nicht darauf und wickeln Sie es nicht um Arme oder Beine!
- Fahren Sie nicht mit dem Saugen fort, wenn das Gerät nicht einwandfrei arbeitet oder der Netzstecker bzw. das Netzkabel beschädigt ist. Um den sicheren und wirksamen Betrieb dieses Geräts zu gewährleisten, dürfen Reparaturarbeiten nur von einem Hoover Kundendiensttechniker ausgeführt werden.
- Versuchen Sie nicht, Batterien nachzuladen, entsorgen Sie diese nicht durch Verbrennen und öffnen Sie die Batterien nicht – Explosionsgefahr!

ZUBEHÖR: Zur Bestellung von Zubehör geben Sie bitte die folgenden Packungsnummern an

- Turbodüse, Packungs-Nr. J19 0484 5046
- Bodendüse mit Polierschuh, Packungs-Nr. G50 0484 5044

**Garantieerklärung**

Die Garantiebestimmungen für Geräte entsprechen den Richtlinien des Landes, in dem Sie das Gerät erworben haben. Detailinformationen erhalten Sie von dem Händler, bei dem Sie das Gerät erworben haben. Bitte bewahren Sie den Kaufbeleg sorgfältig auf, denn er wird dringend für eventuell auftretende Garantiesprüche benötigt.

Gias Customer service (Kundendienst) Deutschland 01805 62 55 62

Gias Customer service (Kundendienst) Schweiz 0848/780 780

Gias Customer service (Kundendienst) Österreich 01805 62 55 62

Candy-Hoover GmbH  
Kaiserswerther Str. 83  
D-40878 Ratingen  
Hoover Kundendienst  
hotline: 01805-62 55 62  
www.candy-hoover.de

Candy Hoover AG  
Boesch 21  
CH-6331 Huenenberg  
Tel: 041-7854040  
Fax: 01-897 33 00 99

Candy Hoover Austria GmbH  
Mariahilferstrasse 176/2/6  
A-1150 Wien  
Tel: 01-897 33 00  
Kundendienst: 0820-220 224  
(0,15 Euro/min)

E-Mail: verkauf@candy.at  
www.hoover.at



BSI

ISO9002

BEAB Approved

**Qualität:** Unsere Produktionsstätten in Großbritannien erfüllen die strengen Qualitätsstandards des britischen staatlichen Normenverbands (BSI).

**Sicherheit:** Die Sicherheit unserer elektrischen Haushaltsgeräte wird durch die unabhängige Genehmigung der britischen Zulassungsbehörde für Elektrotechnik (BEAB) bestätigt.

Die BEAB stellt sicher, dass europäische Sicherheitsnormen eingehalten und über die gesamte Lebensspanne eines Geräts aufrechterhalten bleiben.

## AVVERTENZA IMPORTANTE

Questo aspirapolvere deve essere utilizzato esclusivamente in ambito domestico, secondo le istruzioni contenute nel presente libretto. Accertarsi di aver ben compreso le istruzioni prima di mettere in funzione l'apparecchio. Questo apparecchio è dotato di doppio isolamento e non richiede la messa a terra.

**Importante!** I fili contenuti nel cavo di alimentazione sono colorati secondo il seguente codice:

**blu – neutro                      marrone – fase**

Spina con fusibili da 13 amp. solo nelle versioni UK.

## GUIDA INTRODUTTIVA

Seguendo questa guida passo a passo il vostro nuovo Sensory Ecobox sarà pronto per l'uso:

- Disimballare l'apparecchio e i relativi accessori, avendo cura di smaltire l'imballo in modo sicuro e nel rispetto dell'ambiente.
- Aprire il coperchio superiore (A) assicurandosi che l'Ecobox, il coperchio dell'Ecobox (B1), il filtro premotore (B2) e il microfiltro (B3) siano montati correttamente. Chiudere il coperchio superiore.
- Inserire l'estremità del tubo flessibile nel coperchio superiore, assicurandosi che si agganci e blocchi in posizione (C). Per disinserire il tubo basta premere i due pulsanti di blocco ed estrarre il tubo tirandolo.
- Fissare l'estremità libera del tubo flessibile all'impugnatura utilizzando la ghiera (D).
- Montare i tubi di prolunga (E1), la spazzola per la pulizia dei pavimenti (E2) o gli altri accessori secondo le modalità richieste per l'uso.
- Il vostro Sensory Ecobox System è pronto per l'uso. Estrarre la spina e l'intero cavo dall'apparecchio. Inserire la spina nella presa e accendere l'apparecchio.

## CARATTERISTICHE - A SECONDA DEL MODELLO

- L'Ecobox, dalle caratteristiche uniche, di Hoover è realizzato con un materiale plastico poroso speciale che consente il passaggio dell'aria, trattenendo però la maggior parte dello sporco e delle polveri fini.
- **Pulsante di acceso/spento (F).** Dopo aver inserito la spina nella presa di corrente, premere questo pulsante per accendere l'apparecchio. Premere nuovamente il pulsante per spegnere l'apparecchio prima di staccare la spina dalla presa di corrente dopo l'uso.
- **Pulsante di riavvolgimento del cavo (G).** Staccare la spina dalla presa di corrente. Premere questo pulsante per riavvolgere il cavo di alimentazione nell'apparecchio.
- **Interruttore termico.** L'apparecchio si spegne automaticamente. In questo caso estrarre la spina dalla presa e fare raffreddare l'apparecchio per 30 minuti. Verificare la presenza di eventuali ostruzioni nel sistema, quindi rimuoverle (Leggere i capitoli "Pulizia dell'Ecobox" e "Rimozione di un'ostruzione dal sistema").
- **Dispositivo di controllo manuale della potenza (a seconda del modello).** Regolare la forza aspirante spostando la valvola dell'impugnatura (H): aprendo la valvola la forza aspirante diminuirà. Impostare una forza aspirante bassa per la pulizia di tessuti delicati.
- **Dispositivo di controllo elettronico della potenza (I) (a seconda del modello).** Ruotare il pulsante di acceso/spento per aumentare o diminuire la forza aspirante. Impostare una forza aspirante bassa per la pulizia di tessuti delicati.
- **Spazzola tappeti/pavimenti (J).** Premere il pedale sulla spazzola per abbassare le setole in caso di pulizia di pavimentazioni dure. Premere nuovamente il pedale per sollevare le setole in caso di pulizia di superfici tessili.

- **Turbospazzola (a seconda del modello).** Utilizzare la turbospazzola per la pulizia accurata di superfici tessili. **IMPORTANTE:** Non utilizzare la turbospazzola su tappetini a frange lunghe, pellicce e su peli di tappeti di oltre 15 mm. Non tenere ferma la spazzola sul tappeto con il rullo in rotazione. Disponibile anche come accessorio aggiuntivo. No. confezione per l'ordine J19 0484 5046.
- **Spazzola Caresse (a seconda del modello).** Utilizzare su pavimenti in legno o pavimenti delicati. Disponibile anche come accessorio aggiuntivo. No. confezione per l'ordine G50 0484 5044.
- **Accessorio multiuso.** L'accessorio è alloggiato sull'impugnatura (E1). Estrarre l'accessorio, che può essere utilizzato come:
  - a) Bocchetta per fessure: per angoli e punti difficili da raggiungere (K1).
  - b) Bocchetta tutti gli usi: per tende e tessuti per l'arredamento e tappezzerie (K2).
  - c) Spazzola a pennello (a seconda del modello): per librerie, telai, tastiere ecc. (K2).
- **Sistema parcheggio tubi (L).** I tubi possono essere parcheggiati nella parte posteriore dell'apparecchio o agganciati alla base dell'apparecchio.

## SVUOTAMENTO DELL'ECOBEX

Controllare e svuotare regolarmente Ecobox, preferibilmente dopo ogni uso.

- Estrarre l'Ecobox (M).
- Portare l'Ecobox sul cestino della spazzatura afferrandolo per l'impugnatura (N).
- Premere il pulsante di blocco per togliere il coperchio dall'Ecobox come illustrato (O).
- Afferrare saldamente l'Ecobox e versare il contenuto nel cestino. Se necessario, agitare l'Ecobox oppure usare una spazzola per togliere l'eventuale polvere o sporcizia residua (P).
- Lavare regolarmente il contenitore dell'Ecobox. Vedi il capitolo "Pulizia dell'Ecobox".
- Per chiudere l'Ecobox, posizionare le guide posteriori del coperchio nella rientranza del contenitore e chiudere fermamente (Q).
- Riportare l'Ecobox nella posizione iniziale all'interno dell'apparecchio.

## PULIZIA DELL'ECOBEX

Per avere sempre prestazioni ottimali, si consiglia di lavare l'Ecobox ogni mese eliminando anche la polvere più fine che vi si annida. Per lavare l'apparecchio ed ottimizzare le prestazioni, procedere nel modo seguente:

- Agitare l'Ecobox per rimuovere sporcizia e detriti di grandi dimensioni (P) come descritto al capitolo "Svuotamento dell'Ecobox".
- Spazzolare l'interno dell'Ecobox per rimuovere la polvere fine che si può essere depositata sulle sue pareti (R).
- Lavare accuratamente l'interno e l'esterno dell'Ecobox usando acqua calda e un detergente. A questo punto, se lo si desidera, è possibile collocare l'Ecobox in una lavastoviglie e lavarlo con ciclo di lavaggio ed asciugatura completo fino ad un massimo di 75°C (S).
- Se non viene lavato in lavastoviglie, pulirlo accuratamente all'interno e all'esterno accertandosi che non resti del detergente nell'Ecobox (T).
- Togliere l'acqua in eccesso con un panno asciutto e lasciare asciugare per 24 ore o fino ad asciugatura completa (U).
- Al termine delle operazioni di lavaggio e di asciugatura, posizionare le guide posteriori del coperchio nella rientranza del contenitore e chiudere fermamente. Riportare l'Ecobox nella posizione iniziale all'interno dell'apparecchio (Q).

## MANUTENZIONE DEI FILTRI

- Per garantire sempre le migliori prestazioni, consigliamo di lavare i filtri una volta al mese.
- Le illustrazioni (B1, 2, 3) mostrano come accedere ai filtri.
- Risciacquare ambo i filtri in acqua tiepida (V e W).
- Non sfregare i filtri, usare del detergente oppure lavarli in lavastoviglie.
- Asportare l'acqua in eccesso con un panno asciutto e lasciare asciugare i filtri all'aria per 24 ore o finché non saranno completamente asciutti (X).
- Una volta ultimate le operazioni di lavaggio e di asciugatura, rimettere i filtri nell'apparecchio, nelle loro posizioni originali.

## RIMOZIONE DI UN'OSTRUZIONE DAL SISTEMA

In caso di riduzione considerevole della performance, effettuare i due controlli seguenti:

- 1) Controllare se l'Ecobox è pieno. (In tal caso, leggere il capitolo "Svuotamento dell'Ecobox").
- 2) In caso contrario:
  - a) Avete pulito recentemente l'Ecobox e i filtri? Se così non fosse, leggere i capitoli "Pulizia dell'Ecobox" e "Manutenzione filtri".
  - b) Controllare che non vi siano ostruzioni nel sistema.
    - Utilizzare un'asta o un paletto per rimuovere qualsiasi ostruzione dai tubi e dal flessibile.
    - E' altresì possibile rimuovere un'ostruzione nel tubo flessibile stringendolo o piegandolo leggermente.
    - Controllare e pulire, se necessario, la parte sottostante della spazzola usando la bocchetta per fessure.

## SEMPLICE LISTA DI CONTROLLO PER L'UTENTE DA SCORRERE PRIMA DI RIVOLGERSI AL SERVIZIO ASSISTENZA

- 1) La presa elettrica a cui è collegato l'apparecchio è funzionante? Verificare collegando un altro apparecchio alla presa di corrente.
- 2) Sussiste una limitazione?
  - a) L'Ecobox è pieno? Leggere il capitolo "Svuotamento dell'Ecobox".
  - b) I filtri dell'Ecobox sono ostruiti? Leggere il capitolo "Manutenzione filtri" oppure "Pulizia dell'Ecobox".
  - c) Il tubo flessibile o la bocchetta sono ostruiti? Leggere il capitolo "Rimozione di un'ostruzione dal sistema".
- 3) L'apparecchio si è spento automaticamente? In questo caso, è stata attivata la Protezione da Surriscaldamento. Leggere il capitolo "Caratteristiche", paragrafo "Protezione da surriscaldamento."

Ricordarsi che:

- 1) Su alcune superfici tessili si può determinare un lieve accumulo di elettricità statica. Le scariche di elettricità statica non sono pericolose né per la salute umana né per l'apparecchio.
- 2) Verrà addebitato un intervento di assistenza se si esamina l'apparecchio e si riscontra che non si trova nelle corrette condizioni operative, non è stato montato secondo quanto riportato nel presente libretto di istruzioni o è stato oggetto di uso improprio.

## COSA FARE

- Rivolgersi all'assistenza clienti Hoover al numero 08705 400 600 nel caso in cui non si sia soddisfatti dell'apparecchio.
- Assicurarsi che tutti gli interventi di assistenza e di riparazione siano svolti soltanto da un tecnico autorizzato Hoover.
- Utilizzare esclusivamente ricambi originali Hoover.
- Vuotare regolarmente l'Ecobox. Preferibilmente, dopo ogni uso.
- Spegnerne sempre l'apparecchio e staccare la spina dalla presa di corrente prima di pulire l'apparecchio o effettuare interventi di manutenzione a cura dell'utente, secondo quanto riportato nel presente libretto di istruzioni.
- Nota: L'elettricità può essere pericolosa.

## COSA NON FARE

- Posizionare l'apparecchio in una posizione più alta rispetto alla propria quando si puliscono scale.
- Usare l'apparecchio senza che l'Ecobox sia montato correttamente.
- Utilizzare l'apparecchio all'aperto, su superfici bagnate o per aspirare liquidi.
- Raccogliere fiammiferi, ceneri calde, mozziconi di sigaretta o qualsiasi altro oggetto che possa danneggiare l'apparecchio.
- Vaporizzare o aspirare liquidi infiammabili, liquidi detergenti, aerosol o i loro vapori poiché ne può derivare un rischio di incendio/esplosione.
- Calpestare il cavo di alimentazione, restarvi sopra o avvolgerlo intorno alle braccia o alle gambe mentre si usa l'apparecchio.
- Continuare ad utilizzare l'apparecchio se questo o la spina/cavo di alimentazione sembrano essere difettosi o danneggiati. Per evitare pericoli, l'apparecchio deve essere riparato esclusivamente da un tecnico autorizzato Hoover.
- Ricaricare le batterie, gettarle nel fuoco o sezionarle - pericolo di esplosione.

ACCESSORI: Per quanto riguarda gli accessori, indicare i seguenti codici di imballo:

- Turbospazzola, confezione No. J19 0484 5046
- Bocchetta Caresse, confezione No. G50 0484 5044

### Regolamento Per La Garanzia

Le condizioni di garanzia di questo prodotto seguono le norme previste per il paese nel quale è stato venduto. I dettagli delle suddette condizioni possono essere richiesti al distributore presso il quale il prodotto è stato acquistato. Per ogni contestazione nei termini della garanzia è necessaria l'esibizione della fattura o di documento equipollente.

Gias Customer service (Italia) 199.123.123

Gias Customer service (Svizzera) 0848/780 780



Zerowatt.Hoover S.p.A. Candy Hoover AG  
 Sede commerciale: Boesch 21  
 via Privata E.Fumagalli, CH-6331 Huenenberg  
 20047 Brugherio (MI) Tel: 041-7854040  
 Tel: +39 039 208655

BSI

ISO9002

BEAB Approved

**Qualità:** I nostri stabilimenti in Gran Bretagna soddisfano i più rigorosi standard di qualità del British Standard Institution (BSI).  
**Sicurezza:** Abbiamo ottenuto la certificazione indipendente BEAB per dimostrare che gli apparecchi elettrici domestici sono sicuri BEAB: British Electrical Approval Board, l'istituto di certificazione indipendente britannico garantisce l'osservanza iniziale continua delle norme di sicurezza attraverso l'intero ciclo di vita di un apparecchio.



## ADVERTENCIAS DE SEGURIDAD IMPORTANTES

Este aspirador debería utilizarse sólo para la limpieza doméstica tal y como se describe en estas instrucciones. Asegúrese de que se han entendido totalmente antes de poner en funcionamiento el aparato. Este producto dispone de doble aislamiento y no debe conectarse a tierra.

**Importante:** Los hilos del cable de alimentación están coloreados de acuerdo con el siguiente código:

**Azul - Neutro      Marrón - Con corriente**

Enchufe de 13 Amperios con fusible, sólo en las versiones del Reino Unido.

## PUESTA EN MARCHA

Siguiendo esta guía paso a paso su nuevo Sistema Sensory Ecobox estará listo para su uso:

- Extraiga el aspirador y los accesorios del embalaje. Deshágase del embalaje de una forma segura y consciente con el medioambiente.
- Abra la tapa superior (A) asegurándose de que el Ecobox, la tapa del Ecobox (B1), el filtro previo al motor (B2) y el filtro de salida de aire (B3) están colocados correctamente. Cierre la tapa superior.
- Introduzca el extremo de la manguera en la tapa superior, asegurándose de que quede sujeto y bloqueado en su posición (C). Para soltarla, simplemente presione los dos cierres del extremo de la manguera y tire de la misma.
- Fije el extremo libre de la manguera en el mango utilizando el anillo de bloqueo (D).
- Coloque los tubos de extensión (E1), la tobera de suelo (E2), o los otros accesorios según se requiera para su uso.
- Su Sistema Sensory Ecobox está ahora listo para su uso. Extraiga el enchufe y saque todo el cable. Enchúfelo y conecte el aparato.

## CARACTERÍSTICAS - SEGÚN MODELO

- Los aspiradores exclusivos Ecobox están fabricados con un material plástico poroso especial que permite el paso del aire mientras retiene la mayoría de la suciedad y del polvo fino.
- **Botón On/Off (F).** Una vez enchufado el aparato, pulse este botón para poner en marcha el aspirador. Púlselo de nuevo para parar el aspirador antes de desenchufarlo después de su uso.
- **Botón recogecable (G).** Saque el enchufe del suministro eléctrico. Pulse este botón para recoger el cordón eléctrico en el aspirador.
- **Protección contra recalentamiento.** El aspirador se para automáticamente. En este caso saque el enchufe de la toma y deje que el aspirador se enfríe durante 30 minutos. Compruebe si el Ecobox debe limpiarse o si hay una obstrucción en el sistema (véase el capítulo: "Limpieza del Ecobox" y "Eliminación de una obstrucción del sistema").
- **Regulador de potencia fijo (según modelo).** Ajuste la aspiración moviendo la válvula del mango (H); la aspiración disminuirá al abrir la válvula. Utilice una aspiración baja para tejidos delicados.
- **Regulador de potencia variable (según modelo).** Gire el botón on/off para aumentar o disminuir la aspiración. Utilice una aspiración baja para tejidos delicados.

- **Tobera para alfombras y suelos (J).** Pulse el pedal de la tobera para hacer bajar los cepillos al limpiar suelos duros. Pulse el pedal de nuevo para levantar los cepillos al limpiar alfombras.
- **Tobera turbo (según modelo).** Utilice la tobera Turbo para llevar a cabo limpiezas en profundidad de alfombras. **IMPORTANTE:** no utilice la tobera turbo en alfombras con flecos largos, de pieles de animales y en alfombras con pelo de un grosor superior a 15 mm. No mantenga la tobera fija mientras el cepillo está girando. También disponible como accesorio adicional. N° de código de pedido J19 0484 5046.
- **Tobera para parquet (según modelo).** Diseñada para ser utilizada en madera o cualquier suelo delicado. También disponible como accesorio adicional. N° de código de pedido G50 0484 5044.
- **Accesorio multi-función.** El accesorio está guardado en el mango (E1). Retire el accesorio y utilícelo como:
  - a) Accesorio para rincones: para esquinas y zonas de difícil acceso (K1)
  - b) Tobera para muebles: para tapicerías y tejidos delicados (K2)
  - c) Cepillo para el polvo (según modelo): para estanterías, marcos, teclados etc. (K2)
- **Almacenamiento y colocación de los tubos (L).** Los tubos pueden colocarse en la parte trasera del aspirador o guardarse en la ranura de almacenamiento debajo del aspirador.

## VACIADO DEL ECOBOX

Compruebe y vacíe el Ecobox regularmente, mejor después de cada utilización.

- Extraiga el Ecobox (M).
- Utilice el mango para llevar el Ecobox hasta el cubo de basura (N).
- Pulse el cierre para retirar la tapa del Ecobox como se muestra (O).
- Sujete firmemente el Ecobox y vacíe el contenido en el cubo de basura. Sacuda el Ecobox si es necesario o utilice un cepillo para eliminar cualquier resto de polvo o fragmentos (P).
- Lave el contenedor del Ecobox regularmente. Véase el capítulo "Limpieza del Ecobox".
- Para cerrar el Ecobox coloque las guías traseras de la tapa en las muescas del contenedor y después cierre con firmeza (Q).
- Devuelva el Ecobox a su posición original en el aspirador.

## LIMPIEZA DEL ECOBOX

Para mantener el mejor rendimiento, recomendamos que el Ecobox se lave cada mes eliminando incluso el polvo más fino que esté retenido en el mismo. Para lavar y optimar el rendimiento deben llevarse a cabo los siguientes pasos sencillos:

- Sacuda el Ecobox para eliminar la suciedad de gran tamaño y los grandes fragmentos (P) como se describe en "Vacío del Ecobox".
- Cepille el interior del Ecobox para eliminar el polvo fino que pueda haberse formado en las paredes del Ecobox (R).
- Lave el interior y el exterior del Ecobox en profundidad utilizando agua caliente y un limpiador líquido. A continuación, si lo desea, puede introducir el Ecobox en un lavavajillas y lavar en un ciclo completo de lavado y secado de hasta 75° C (S).
- Si no lo ha introducido en un lavavajillas, enjuague cuidadosamente el interior y el exterior asegurándose de que no queda detergente en el Ecobox (T).

- Elimine el agua sobrante con un trapo seco y deje secar al aire libre durante 24 horas o hasta que esté totalmente seco (U).
- Después de completar las operaciones de lavado y secado, sitúe las guías de la tapa trasera en las muescas del contenedor y después cierre con firmeza. Devuelva el Ecobox a su posición original en el aspirador.

## **MANTENIMIENTO DE LOS FILTROS**

- Para mantener el mejor rendimiento, recomendamos que lave los filtros cada mes.
- Para acceder a los filtros, remítase al diagrama (B1, 2, 3).
- Enjuague ambos filtros en agua caliente a mano (V y W).
- No friegue los filtros, no utilice líquido limpiador ni los introduzca en un lavavajillas.
- Elimine el exceso de agua con un trapo seco y deje secar al aire libre durante 24 horas o hasta que esté totalmente seco (X).
- Después de completar las operaciones de lavado y secado, devuelva los filtros a sus posiciones originales en el aspirador.

## **ELIMINACIÓN DE UNA OBSTRUCCIÓN DEL SISTEMA**

Si se produce una caída notable del rendimiento véase los siguientes 2 puntos:

- 1) Compruebe si el Ecobox está lleno (si es así, remítase al capítulo "Vaciado del Ecobox").
  - 2) Si no está completamente lleno:
    - a) ¿Ha limpiado el Ecobox y los filtros recientemente? Si no es así, remítase a los capítulos "Limpieza del Ecobox" y "Mantenimiento de los Filtros".
    - b) Compruebe si hay alguna otra obstrucción en el sistema.
- Utilice una varilla o un poste para eliminar cualquier obstrucción de los tubos y de la manguera flexible.
  - Puede ser posible también eliminar una obstrucción en la manguera flexible apretándola o doblándola ligeramente.
  - Compruebe y limpie si es necesario la parte inferior de la tobera utilizando el accesorio para rincones.

## **GUÍA PRÁCTICA PARA EL USUARIO ANTES DE LLAMAR AL SERVICIO TÉCNICO**

- 1) ¿Hay suministro eléctrico para el aspirador? Compruébelo con otro aparato.
- 2) ¿Hay alguna obstrucción?
  - a) ¿Está lleno el Ecobox? Remítase al capítulo "Vaciado del Ecobox"
  - b) ¿Están los filtros o el Ecobox obstruidos? Remítase al capítulo "Mantenimiento de los Filtros" o al capítulo "Limpieza del Ecobox".
  - c) ¿Está obstruida la manguera o la tobera? Remítase al capítulo "Eliminación de una Obstrucción del Sistema".
- 3) ¿Se ha desconectado automáticamente el aspirador? En este caso se ha activado la Protección contra recalentamiento. Remítase al capítulo "Características", párrafo "Protección contra recalentamiento".

Por favor, recuerde que:

- 1) Algunas alfombras pueden provocar una pequeña acumulación de electricidad estática. Ninguna descarga de electricidad estática es peligrosa para la salud o para el producto.

- 2) Se aplicará un cargo de servicio si después de examinar el aspirador, resulta que éste funciona correctamente, que no ha sido montado de acuerdo con estas instrucciones, o si ha sido utilizado incorrectamente.

### USTED DEBE

- Llamar a la Línea de Atención al Cliente 08705 400 600 en caso de no estar satisfecho
  - Asegurarse de que todo el servicio y las reparaciones sean realizadas por un Técnico de Servicio de Hoover autorizado
  - Utilizar sólo piezas originales de Hoover
  - Vaciar el Ecobox regularmente. Mejor después de cada utilización
  - Desconectar y desenchufar siempre el aparato del suministro eléctrico después de su utilización y antes de limpiar el aparato o de intentar el mantenimiento de usuario tal y como se ha descrito en estas instrucciones
- Recuerde: la electricidad puede ser peligrosa

### USTED NO DEBE

- Colocar el aspirador por encima suyo al limpiar escaleras
- Utilizar el aspirador sin que el Ecobox esté correctamente montado
- Utilizar el aspirador en el exterior, en superficies húmedas o para recoger agua
- Recoger cerillas, cenizas calientes, colillas o cualquier cosa que pueda dañar al producto
- Pulverizar el aparato con líquidos inflamables, líquidos limpiadores, aerosoles o sus vapores, o recoger los anteriores ya que pueden causar un riesgo de incendio/explosión
- Pasar por encima, quedarse sobre, o enrollar el cable de alimentación alrededor de brazos o piernas al utilizar su aspirador.
- Seguir utilizando su aspirador si éste o el enchufe/cordón de alimentación parecen estar defectuosos o dañados. Para evitar peligros para su seguridad, el aspirador sólo debe ser reparado por un Técnico de Servicio de Hoover autorizado
- Recargar las baterías, tirarlas al fuego o abrirlas - peligro de explosión.

ACCESORIOS: Para pedir accesorios, indique los siguientes números de código

- Tobera Turbo, Nº de código J19 0484 5046
- Tobera de Parquet, Nº de código G50 0484 5044

#### Declaración de garantía

Las condiciones de garantía para este aparato están definidas en el país que se ha comprado. Para poder beneficiarse de esta garantía puede ser obtenida por el vendedor donde se ha realizado la compra. La factura de compra o el recibo debe ser mostrada cuando se hace alguna reclamación bajo términos de garantía.

Gias Customer Service (Servicio de Asistencia Técnica) 902 100 150

BSI

ISO9002

Aprobado por  
BEAB

**Calidad:** Nuestras fábricas en Reino Unido cumplen las rigurosas normas de calidad establecidas por la British Standards Institution (BSI).

**Seguridad:** Obtenemos la aprobación independiente de BEAB para demostrar que nuestros electrodomésticos son seguros. BEAB - la British Electrotechnical Approvals Board - se certifica de que se cumplan y se mantengan las normas de seguridad europeas durante la vida útil del electrodoméstico.



Candy Hoover  
Electrodomésticos S.A.  
Ahumategi Bide s/n  
20570 Bergara  
(Guipúzcoa)

## ADVERTÊNCIAS SOBRE SEGURANÇA

Este aspirador só deve ser utilizado para limpezas domésticas, tal como descrito nestas instruções. Certifique-se de que as entende perfeitamente antes de utilizar o aparelho. Este produto tem isolamento duplo e não deve ser provido de ligação à terra.

**Importante:** Os fios do cabo de alimentação são coloridos de acordo com o código seguinte:

**Azul - Neutro Castanho - Positivo**

Ficha protegida por fusível de 13 Amp, apenas nas versões para o Reino Unido.

## PRIMEIRA UTILIZAÇÃO

Siga este manual de instruções minuciosamente e o seu novo sistema Sensory Ecobox estará pronto a ser utilizado:

- Retire o aspirador e acessórios da embalagem. Deite fora a embalagem respeitando as regras de segurança e defesa do ambiente.
- Abra a tampa superior (A) e verifique se o Ecobox, a tampa do Ecobox (B1), o filtro do pré-motor (B2) e o filtro de escape (B3) estão bem colocados. Feche a tampa superior.
- Insira a extremidade da mangueira na tampa superior, certificando-se de que encaixa na perfeição (C). Para a desprender, carregue nas duas patilhas e puxe.
- Encaixe a extremidade livre da mangueira na pega, utilizando o fecho (D).
- Encaixe os tubos telescópicos (E1), a escova (E2) ou outros acessórios necessários à sua utilização.
- O seu Sensory Ecobox System está pronto a ser utilizado. Retire a ficha e puxe o cabo para fora. Ligue a ficha à corrente e carregue no botão para o pôr a funcionar.

## CARACTERÍSTICAS - DEPENDENDO DO MODELO

- O Ecobox exclusivo da Hoover é fabricado num material especial em plástico poroso, que permite a passagem de ar ao mesmo tempo que retém grande parte da sujidade e poeira mais fina.
- **Botão de Ligar/Desligar (F).** Uma vez ligado à corrente, carregue neste botão para ligar o aspirador. Volte a carregar para desligar o aspirador, antes de retirar a ficha da tomada após a utilização.
- **Botão da bobina do fio eléctrico (G).** Retire a ficha da tomada eléctrica. Carregue neste botão para enrolar o fio no interior do aspirador.
- **Protecção contra o Sobreaquecimento.** O aspirador desliga-se automaticamente. Neste caso, retire a ficha da tomada e deixe o aspirador arrefecer durante 30 minutos. Verifique se o Ecobox necessita de ser limpo ou se existe alguma obstrução no sistema (consulte o capítulo: "Limpeza do Ecobox" e "Remoção de uma Obstrução do Sistema").
- **Controlo de potência fixa (dependendo do modelo).** Ajuste a sucção, deslocando a válvula da pega (H): a sucção diminui quando se abre a válvula. Utilize uma sucção mais baixa para tecidos delicados.
- **Controlo de potência variável (I) (dependendo do modelo).** Rode o botão de ligar/desligar para aumentar ou diminuir a sucção. Utilize uma sucção mais baixa para tecidos delicados.
- **Escova para carpetes e soalhos (J).** Prima o pedal da escova para baixar as escovas na limpeza de soalhos. Prima o pedal novamente para recolher as escovas na limpeza de carpetes.

- **Escova Turbo (dependendo do modelo).** Utilize a escova turbo para uma limpeza mais profunda de carpetes. **IMPORTANTE:** não utilize a escova turbo para limpar tapetes com franjas compridas, peles de animais ou outras carpetes com uma altura de pêlo superior a 15 mm. Não mantenha a escova parada com esta em rotação. Também disponível como acessório adicional. Conjunto para encomenda n.º J19 0484 5046.
- **Escova Caresse (dependendo do modelo).** Concebida para ser usada em pavimentos de madeira ou outros pavimentos delicados. Também disponível como acessório adicional. Conjunto para encomenda n.º G50 0484 5044.
- **Acessório multi-usos.** Este acessório está armazenado na pega (E1). Remova o acessório e utilize-o como:
  - a) Bico: para cantos e zonas de difícil acesso (K1).
  - b) Escova para móveis: para mobiliário e tecidos (K2).
  - c) Escova para o pó (dependendo do modelo): para estantes, molduras, teclados, etc. (K3).
- **Estacionamento e arrumação dos tubos (L).** Os tubos podem ser estacionados na parte de trás do aspirador ou arrumados na ranhura de arrumação na parte inferior do aspirador.

## ESVAZIAMENTO DO ECOBOX

Verifique e esvazie o Ecobox regularmente, se possível depois de cada utilização.

- Retire o Ecobox (M).
- Utilize a pega para transportar o Ecobox para o caixote do lixo (N).
- Prima o fecho para remover a tampa do Ecobox, conforme ilustrado (O).
- Segure bem no Ecobox e despeje o seu conteúdo para o caixote do lixo. Agite o Ecobox, se necessário, ou utilize uma escova para eliminar qualquer tipo de poeira ou detritos (P).
- Lave o contentor do Ecobox regularmente. Consulte o capítulo "Limpeza do Ecobox".
- Para fechar o Ecobox introduza as guias posteriores da tampa nas ranhuras do contentor e feche bem (Q).
- Recoloque o Ecobox na sua posição original no aspirador.

## LIMPEZA DO ECOBOX

Para manter o melhor desempenho possível, recomendamos que lave o Ecobox todos os meses, para remover até à mais pequena partícula de pó acumulado no mesmo. Para lavar e otimizar o seu desempenho, siga as instruções que se seguem:

- Agite bem o Ecobox para eliminar a sujidade maior e os detritos (P), conforme indicado na secção "Esvaziamento do Ecobox".
- Escove o interior do Ecobox para remover a poeira mais fina que se pode ter acumulado nas paredes do Ecobox (R).
- Lave o interior e exterior do Ecobox com água morna e detergente. Nesta altura, se preferir, pode colocar o Ecobox na máquina de lavar louça, utilizando o programa completo de lavagem e ciclo de secagem a 75° C (S).
- Se não utilizar máquina de lavar louça, enxagúe bem o interior e o exterior tendo o cuidado para não deixar detergente no Ecobox (T).
- Remova a água em excesso com um pano seco e deixe secar ao ar livre durante 24 horas ou até estar totalmente seco (U).

- Depois de concluídas as operações de lavagem e secagem, introduza as guias posteriores da tampa nas ranhuras do contentor e feche bem. Recoloque o Ecobox na sua posição original no aspirador (Q).

## **MANUTENÇÃO DOS FILTROS**

- Para garantir o melhor desempenho, recomendamos a lavagem dos filtros todos os meses.
- Para aceder aos filtros, consulte o diagrama (B1, 2, 3).
- Lave ambos os filtros com água morna (V e W).
- Não esfregue os filtros, não utilize detergente ou coloque na máquina de lavar louça.
- Remova a água em excesso com um pano seco e deixe secar ao ar livre durante 24 horas ou até estar totalmente seco (X).
- Depois de concluídas as operações de lavagem e secagem, recoloque os filtros nas suas posições iniciais no aspirador.

## **REMOÇÃO DE UMA OBSTRUÇÃO NO SISTEMA**

Se detectar uma diminuição brusca do rendimento do aspirador verifique os dois pontos que se seguem:

- 1) Verifique se o Ecobox está cheio (Se for esse o caso, consulte o capítulo "Esvaziamento do Ecobox").
  - 2) Se não estiver cheio:
    - a) Lavou o Ecobox ou os filtros recentemente? (Se não for o caso, consulte os capítulos "Limpeza do Ecobox" e "Manutenção dos Filtros").
    - b) Verifique se existe outro tipo de obstrução no sistema.
- Utilize uma haste ou uma vara para remover qualquer obstrução nos tubos e na mangueira flexível.
  - Também é possível remover uma obstrução da mangueira flexível apertando-a ou dobrando-a ligeiramente.
  - Verifique e limpe, se necessário, a parte inferior da escova utilizando o bico do aspirador.

## **ANTES DE CHAMAR UM TÉCNICO, PROCEDA ÀS SEGUINTE VERIFICAÇÕES:**

- 1) O fornecimento de electricidade ao aspirador está a funcionar devidamente? Verifique com outro aparelho eléctrico.
- 2) Existe alguma obstrução?
  - a) O Ecobox está cheio? Consulte o capítulo "Esvaziamento do Ecobox".
  - b) Os filtros ou o Ecobox estão obstruídos? Consulte o capítulo "Manutenção dos Filtros" ou "Limpeza do Ecobox".
  - c) A mangueira ou a escova estão obstruídas? Consulte o capítulo "Remoção de uma Obstrução do Sistema".
- 3) O aspirador desligou-se automaticamente? Neste caso a Protecção contra o Sobreaquecimento foi activada. Consulte o capítulo "Características", secção "Protecção contra o Sobreaquecimento".

Não esqueça que:

- 1) Algumas carpetes podem provocar uma pequena acumulação de electricidade estática. Qualquer eventual descarga estática não é prejudicial para a saúde nem para o aparelho.

- 2) A assistência técnica será paga se o aspirador se encontrar a funcionar em perfeitas condições, se ele não tiver sido montado de acordo com estas instruções ou se não tiver sido utilizado correctamente.

## DEVE

- Contactar a Linha de Assistência Técnica da Hoover 08705 400 600, caso não esteja satisfeito com o produto.
- Verificar se todos os serviços e reparações são efectuados por um técnico autorizado da Hoover.
- Utilizar apenas peças originais da Hoover
- Esvaziar regularmente o Ecobox, se possível depois de cada utilização.
- Desligar sempre o aspirador e retirar a ficha da tomada depois de ser utilizado e antes de limpar o aparelho ou de tentar efectuar uma manutenção, tal como se descreve nestas instruções.

Lembre-se: a electricidade pode ser perigosa.

## NÃO DEVE

- Colocar o aspirador numa posição superior quando limpar escadas.
- Utilizar o aspirador sem o Ecobox devidamente instalado.
- Utilizar o aspirador no exterior, em qualquer superfície molhada ou para aspiração de líquidos.
- Aspirar fósforos, cinzas quentes, pontas de cigarro ou algo que possa danificar o aparelho.
- Vaporizar ou aspirar líquidos inflamáveis, líquidos de limpeza, aerossóis ou seus vapores, uma vez que há o risco de incêndio/explosão.
- Passar por cima, pisar ou enrolar o fio de alimentação à volta dos braços ou das pernas quando estiver a utilizar o aspirador.
- Continuar a utilizar o aspirador se este ou a ficha/cabo de alimentação estiverem danificados. Para evitar riscos desnecessários, o aspirador só deve ser reparado por um técnico autorizado da Hoover.
- Recarregar pilhas, eliminá-las no fogo ou desmontá-las - perigo de explosão.

ACESSÓRIOS: Para adquirir acessórios, indique os seguintes números de embalagem

- Conjunto de Escova Turbo N.º J19 0484 5046
- Conjunto de Escova Caresse N.º G50 0484 5044

### Declaração de Garantia

As condições de concessão de garantia relativamente a este aparelho são as que tiverem sido definidas pelo nosso representante no país em que o aspirador tiver sido vendido. Para obter informações mais detalhadas sobre estas condições deverá dirigir-se ao agente da especialidade a quem adquiriu o seu aspirador. Sempre que pretender apresentar qualquer reclamação ou solicitar qualquer assistência ao serviço ac abrigo da garantia concedida a este aparelho, deverá mostiar a factura ou o recibo de compra do aparelho, pelo que a (o) deversa guardar durante o período de vigência da garantia. O fabricante reserva se o direito de introduzir alterações nos seus produtos sem qualquer aviso prévio.



Candy Hoover Portugal, Lda.  
Rua D. Estefânia 90A  
1049-050 Lisboa  
Tel: 021 318 97 00

BSI

ISO9002

BEAB Approved

**Qualidade:** As nossas fábricas no Reino Unido possuem os estritos standard de qualidade do british Standard Institution (BSI)  
**Segurança:** O British Electrotechnical Approvals Board – Assegura que os standards Europeus de segurança são atingidos e que se mantém ao longo da vida do aparelho.



## IMPORTANT SAFETY REMINDERS

This cleaner should only be used for domestic cleaning as described in these instructions. Please ensure that these are fully understood before operating the appliance. This product is double insulated and must not be earthed.

**Important:** The wires in the power cord are coloured in accordance with the following code:

**Blue - Neutral      Brown - Live**

13 Amp fused plug on UK versions only.

## GETTING STARTED

By following this step-by-step guide your new Sensory Ecobox system will be ready for use:

- Remove cleaner and accessories from packaging. Please dispose of the packaging in a safe and environmentally conscientious way.
- Open the top cover (A) ensuring that the Ecobox, Ecobox lid (B1), pre-motor filter (B2) and exhaust filter (B3) are fitted correctly. Close the top cover.
- Insert the hose end into the top cover, ensuring it clips and locks into position (C). To release simply press in the two hose end latches and pull.
- Fix the free end of the hose into the handle using the lock ring (D).
- Fit extension tubes (E1), floor nozzle (E2), or other accessories as required for use.
- Your Sensory Ecobox is now ready for use. Extract the plug and pull out all of the cord. Plug in and switch on.

## FEATURES - DEPENDING ON MODEL,

- Hoovers unique Ecobox is made from a special porous plastic material which allows air to pass through whilst retaining most of the dirt and fine dust.
- **On/Off button (F).** Once plugged in, press this button to start the cleaner. Press it again to stop the cleaner before removing the plug after use.
- **Cord rewind button (G).** Remove the plug from the power supply. Press this button to wind the power cord back into the cleaner.
- **Overheating Protection.** Cleaner automatically switches off. In this event extract the plug from the socket and allow cleaner to cool for 30 minutes. Check if the Ecobox needs cleaning or if there is a blockage in the system (see chapter: "Cleaning The Ecobox" and "Removing A Blockage From The System").
- **Fixed power control (depending on model).** Adjust the suction by moving the handle valve (H): suction will decrease when opening the valve. Use low suction for delicate fabrics.
- **Variable power control (I) (depending on model).** Rotate the on/off button to increase or decrease suction. Use low suction for delicate fabrics.
- **Carpet and floor nozzle (J).** Press pedal on the nozzle to lower the brushes when cleaning hard floors. Press the pedal again to lift the brushes when cleaning carpets.

- **Turbo nozzle (depending on model).** Use the Turbo nozzle for deep cleaning on carpets. **IMPORTANT:** do not use Turbo nozzle on rugs with long fringes, animal hide and over carpet piles with a depth exceeding 15 mm. Do not keep the nozzle stationary while the brush is rotating. Also available as an additional accessory. Order Pack No. J19 0484 5046.
- **Caresse nozzle (depending on model).** Designed for use on wooden or any delicate floors. Also available as an additional accessory. Order Pack No. G50 0484 5044.
- **Multi function tool.** Tool is stored on the handle (E1). Remove tool and use as:
  - a) Crevice tool: for corners and hard to reach areas (K1).
  - b) Furniture nozzle: for soft furnishings and fabrics (K2).
  - c) Dusting brush (depending on model): for bookshelves, frames, keyboards etc. (K2).
- **Tube Parking and Storage (L).** The tubes can be parked at the rear of the cleaner or stored into the storage slot underneath the cleaner.

## **EMPTYING THE ECOBOX**

Check and empty the Ecobox regularly, best after each use.

- Extract the Ecobox (M).
- Use the handle to carry the Ecobox to the dustbin (N).
- Press the latch to remove the cover from the Ecobox as shown (O).
- Grip the Ecobox firmly and tip the contents into the dustbin. Shake the Ecobox if required or use a brush to remove any of the remaining dust or debris (P).
- Wash the Ecobox regularly. See chapter "Cleaning The Ecobox".
- To close the Ecobox locate the cover rear guides into the container recess then close firmly (Q).
- Return the Ecobox back to its original position in the cleaner.

## **CLEANING THE ECOBOX**

To maintain the best performance, we would recommend that you **wash the Ecobox every month** removing even the finest dust retained in it. To wash and optimise the performance the following simple steps should be taken:

- Shake out the Ecobox to remove large dirt and debris (P) as described in "Emptying The Ecobox".
- Brush the inside of the Ecobox to remove the fine dust that may have formed on the walls of the Ecobox (R).
- Wash the inside and outside of the Ecobox thoroughly using warm water and washing up liquid. At this point if desired, the Ecobox can be placed in a dishwasher and washed on a full wash and dry cycle at up to 75°C (S).
- If not placed in a dishwasher rinse thoroughly inside and outside making sure no detergent is left on the Ecobox (T).

- Remove excess water with a dry cloth and leave to air dry for 24 hours or until fully dry (U).
- After completing the washing and drying operations, locate the cover rear guides into the container recess then close firmly. Return the Ecobox to its original position in the cleaner. (Q)

## **FILTERS MAINTENANCE**

- To maintain best performance we recommend that you wash the filters every month.
- To access the filters please refer to diagram (B1, 2, 3).
- Rinse both filters under hand warm water (V and W).
- Do not scrub the filters, use washing up liquid or place in a dishwasher.
- Remove excess water with a dry cloth and leave to air dry for 24 hours or until fully dry (X).
- After completing the washing and drying operations, return the filters to their original positions in the cleaner.

## **REMOVING A BLOCKAGE FROM THE SYSTEM**

If there is a noticeable drop in performance see the following 2 points:

- 1) Check if the Ecobox is full (If so refer to chapter "Emptying The Ecobox").
- 2) If not full then:
  - a) Have you cleaned the Ecobox and filters recently? If not please refer to the chapters "Cleaning The Ecobox" and "Filters Maintenance".
  - b) Check if there is any other blockage in the system.
    - Use a rod or pole to remove any blockage from the tubes and flexible hose.
    - It may also be possible to remove an obstruction in the flexible hose by lightly squeezing or bending it.
    - Check and clean if required the underside of the nozzle by using the crevice tool.

## **SIMPLE USER CHECK LIST BEFORE CALLING FOR SERVICE**

- 1) Is there a working electricity supply to the cleaner? Check with another appliance.
- 2) Is there a restriction?
  - a) Is the Ecobox full? Please refer to chapter "Emptying The Ecobox".
  - b) Are the filters or Ecobox blocked? Please refer to chapter "Filters Maintenance" or "Cleaning The Ecobox".
  - c) Is the hose or nozzle blocked? Please refer to chapter "Removing A Blockage from The System".
- 3) Has the cleaner automatically switched off? In this case the Overheating Protection has been activated. Please refer to chapter "Features", paragraph "Overheating Protection".

Please remember that:

- 1) Some carpets can cause a small build up of static electricity. Any static discharge is not hazardous to health or the product.
- 2) A service charge will be made if the cleaner is examined and found in working order, has not been assembled in accordance with these instructions, or has been misused.

## Do

- Call Hoover Customer Help Line 08705 400 600 in the event of dissatisfaction
- Ensure that all service and repairs are carried out by an authorised Hoover Service Engineer
- Only use genuine Hoover parts
- Empty the Ecobox regularly. Best after each use
- Always switch off and remove the power plug from the electricity supply after use and before cleaning the appliance or attempting user maintenance as described in these instructions

Remember: Electricity can be dangerous

## DO NOT

- Position the cleaner above you when cleaning stairs
- Use cleaner without the Ecobox correctly fitted
- Use your cleaner out of doors, on wet surfaces or for wet pick up
- Pick up matches, hot ash, cigarette ends or anything that may damage the product
- Spray with or pick up flammable liquids, cleaning fluids, aerosols or their vapours as this may cause risk of fire/explosion
- Run over, stand on, or wrap the power cord around arms or legs when using your cleaner
- Continue to use your cleaner if it or the plug/power cord appears to be faulty or damaged. To avoid safety hazards the cleaner must only be repaired by an authorised Hoover Service Engineer
- Recharge batteries, dispose of in fire or dissect - danger of explosion

**ACCESSORIES:** For accessories please quote the following pack numbers

- Turbo Nozzle pack No. J19 0484 5046
- Caresse Nozzle pack No. G50 0484 5044

### Guarantee Statement

The guarantee conditions for this appliance are as defined by our representative in the country in which it is sold. Details regarding these conditions can be obtained from the dealer from whom the appliance was purchased.

The bill of sale or receipt must be produced when making any claim under the terms of this guarantee.

Subject to change without notice.

GIAS Customer service 08705 400500

Hoover spares 01204 556111

**BSI**

**ISO9002**

**BEAB Approved**

**Quality:** Our UK factories meet the strict quality standards of the British Standards Institution (BSI).

**Safety:** We gain independent approval from BEAB to demonstrate that our domestic electrical appliances are safe.

BEAB - the British Electrotechnical Approvals Board - ensures that European safety standards are met and maintained throughout the production life of an appliance.



Hoover Limited  
Pentrebach  
Merthyr Tydfil  
Mid-Glamorgan  
CF48 4TU

**Part No: 05655118**

## IMPORTANT SAFETY REMINDERS

This cleaner should only be used for domestic cleaning as described in these instructions. Please ensure that these are fully understood before operating the appliance. This product is double insulated and must not be earthed.

**Important:** The wires in the power cord are coloured in accordance with the following code:

**Blue - Neutral**      **Brown - Live**

13 Amp fused plug on UK versions only.

## GETTING STARTED

By following this step-by-step guide your new Sensory Ecobox system will be ready for use:

- Remove cleaner and accessories from packaging. Please dispose of the packaging in a safe and environmentally conscientious way.
- Open the top cover (A) ensuring that the Ecobox, Ecobox lid (B1), pre-motor filter (B2) and exhaust filter (B3) are fitted correctly. Close the top cover.
- Insert the hose end into the top cover, ensuring it clips and locks into position (C). To release simply press in the two hose end latches and pull.
- Fix the free end of the hose into the handle using the lock ring (D).
- Fit extension tubes (E1), floor nozzle (E2), or other accessories as required for use.
- Your Sensory Ecobox is now ready for use. Extract the plug and pull out all of the cord. Plug in and switch on.

## FEATURES - DEPENDING ON MODEL,

- Hoovers unique Ecobox is made from a special porous plastic material which allows air to pass through whilst retaining most of the dirt and fine dust.
- **On/Off button (F).** Once plugged in, press this button to start the cleaner. Press it again to stop the cleaner before removing the plug after use.
- **Cord rewind button (G).** Remove the plug from the power supply. Press this button to wind the power cord back into the cleaner.
- **Overheating Protection.** Cleaner automatically switches off. In this event extract the plug from the socket and allow cleaner to cool for 30 minutes. Check if the Ecobox needs cleaning or if there is a blockage in the system (see chapter: "Cleaning The Ecobox" and "Removing A Blockage From The System").
- **Fixed power control (depending on model).** Adjust the suction by moving the handle valve (H): suction will decrease when opening the valve. Use low suction for delicate fabrics.
- **Variable power control (I) (depending on model).** Rotate the on/off button to increase or decrease suction. Use low suction for delicate fabrics.
- **Carpet and floor nozzle (J).** Press pedal on the nozzle to lower the brushes when cleaning hard floors. Press the pedal again to lift the brushes when cleaning carpets.

- **Turbo nozzle (depending on model).** Use the Turbo nozzle for deep cleaning on carpets. **IMPORTANT:** do not use Turbo nozzle on rugs with long fringes, animal hide and over carpet piles with a depth exceeding 15 mm. Do not keep the nozzle stationary while the brush is rotating. Also available as an additional accessory. Order Pack No. J19 0484 5046.
- **Caresse nozzle (depending on model).** Designed for use on wooden or any delicate floors. Also available as an additional accessory. Order Pack No. G50 0484 5044.
- **Multi function tool.** Tool is stored on the handle (E1). Remove tool and use as:
  - a) Crevice tool: for corners and hard to reach areas (K1).
  - b) Furniture nozzle: for soft furnishings and fabrics (K2).
  - c) Dusting brush (depending on model): for bookshelves, frames, keyboards etc. (K2).
- **Tube Parking and Storage (L).** The tubes can be parked at the rear of the cleaner or stored into the storage slot underneath the cleaner.

## EMPTYING THE ECOBOX

Check and empty the Ecobox regularly, best after each use.

- Extract the Ecobox (M).
- Use the handle to carry the Ecobox to the dustbin (N).
- Press the latch to remove the cover from the Ecobox as shown (O).
- Grip the Ecobox firmly and tip the contents into the dustbin. Shake the Ecobox if required or use a brush to remove any of the remaining dust or debris (P).
- Wash the Ecobox regularly. See chapter "Cleaning The Ecobox".
- To close the Ecobox locate the cover rear guides into the container recess then close firmly (Q).
- Return the Ecobox back to its original position in the cleaner.

## CLEANING THE ECOBOX

To maintain the best performance, we would recommend that you **wash the Ecobox every month** removing even the finest dust retained in it. To wash and optimise the performance the following simple steps should be taken:

- Shake out the Ecobox to remove large dirt and debris (P) as described in "Emptying The Ecobox".
- Brush the inside of the Ecobox to remove the fine dust that may have formed on the walls of the Ecobox (R).
- Wash the inside and outside of the Ecobox thoroughly using warm water and washing up liquid. At this point if desired, the Ecobox can be placed in a dishwasher and washed on a full wash and dry cycle at up to 75°C (S).
- If not placed in a dishwasher rinse thoroughly inside and outside making sure no detergent is left on the Ecobox (T).

- Remove excess water with a dry cloth and leave to air dry for 24 hours or until fully dry (U).
- After completing the washing and drying operations, locate the cover rear guides into the container recess then close firmly. Return the Ecobox to its original position in the cleaner. (Q)

## **FILTERS MAINTENANCE**

- To maintain best performance we recommend that you wash the filters every month.
- To access the filters please refer to diagram (B1, 2, 3).
- Rinse both filters under hand warm water (V and W).
- Do not scrub the filters, use washing up liquid or place in a dishwasher.
- Remove excess water with a dry cloth and leave to air dry for 24 hours or until fully dry (X).
- After completing the washing and drying operations, return the filters to their original positions in the cleaner.

## **REMOVING A BLOCKAGE FROM THE SYSTEM**

If there is a noticeable drop in performance see the following 2 points:

- 1) Check if the Ecobox is full (If so refer to chapter "Emptying The Ecobox").
- 2) If not full then:
  - a) Have you cleaned the Ecobox and filters recently? If not please refer to the chapters "Cleaning The Ecobox" and "Filters Maintenance".
  - b) Check if there is any other blockage in the system.
    - Use a rod or pole to remove any blockage from the tubes and flexible hose.
    - It may also be possible to remove an obstruction in the flexible hose by lightly squeezing or bending it.
    - Check and clean if required the underside of the nozzle by using the crevice tool.

## **SIMPLE USER CHECK LIST BEFORE CALLING FOR SERVICE**

- 1) Is there a working electricity supply to the cleaner? Check with another appliance.
- 2) Is there a restriction?
  - a) Is the Ecobox full? Please refer to chapter "Emptying The Ecobox".
  - b) Are the filters or Ecobox blocked? Please refer to chapter "Filters Maintenance" or "Cleaning The Ecobox".
  - c) Is the hose or nozzle blocked? Please refer to chapter "Removing A Blockage from The System".
- 3) Has the cleaner automatically switched off? In this case the Overheating Protection has been activated. Please refer to chapter "Features", paragraph "Overheating Protection".

**DK**

Please remember that:

- 1) Some carpets can cause a small build up of static electricity. Any static discharge is not hazardous to health or the product.
- 2) A service charge will be made if the cleaner is examined and found in working order, has not been assembled in accordance with these instructions, or has been misused.

## Do

- Call Hoover Customer Help Line 08705 400 600 in the event of dissatisfaction
- Ensure that all service and repairs are carried out by an authorised Hoover Service Engineer
- Only use genuine Hoover parts
- Empty the Ecobox regularly. Best after each use
- Always switch off and remove the power plug from the electricity supply after use and before cleaning the appliance or attempting user maintenance as described in these instructions

Remember: Electricity can be dangerous

## DO NOT

- Position the cleaner above you when cleaning stairs
- Use cleaner without the Ecobox correctly fitted
- Use your cleaner out of doors, on wet surfaces or for wet pick up
- Pick up matches, hot ash, cigarette ends or anything that may damage the product
- Spray with or pick up flammable liquids, cleaning fluids, aerosols or their vapours as this may cause risk of fire/explosion
- Run over, stand on, or wrap the power cord around arms or legs when using your cleaner
- Continue to use your cleaner if it or the plug/power cord appears to be faulty or damaged. To avoid safety hazards the cleaner must only be repaired by an authorised Hoover Service Engineer
- Recharge batteries, dispose of in fire or dissect - danger of explosion

**ACCESSORIES:** For accessories please quote the following pack numbers

- Turbo Nozzle pack No. J19 0484 5046
- Caresse Nozzle pack No. G50 0484 5044

### Guarantee Statement

The guarantee conditions for this appliance are as defined by our representative in the country in which it is sold. Details regarding these conditions can be obtained from the dealer from whom the appliance was purchased.

The bill of sale or receipt must be produced when making any claim under the terms of this guarantee.

Subject to change without notice.

GIAS Customer service 08705 400500

Hoover spares 01204 556111

**BSI**

**ISO9002**

**BEAB Approved**

**Quality:** Our UK factories meet the strict quality standards of the British Standards Institution (BSI).

**Safety:** We gain independent approval from BEAB to demonstrate that our domestic electrical appliances are safe.

BEAB - the British Electrotechnical Approvals Board - ensures that European safety standards are met and maintained throughout the production life of an appliance.



Hoover Limited  
Pentrebach  
Merthyr Tydfil  
Mid-Glamorgan  
CF48 4TU

**Part No: 05655118**



## IMPORTANT SAFETY REMINDERS

This cleaner should only be used for domestic cleaning as described in these instructions. Please ensure that these are fully understood before operating the appliance. This product is double insulated and must not be earthed.

**Important:** The wires in the power cord are coloured in accordance with the following code:

**Blue - Neutral**      **Brown - Live**  
13 Amp fused plug on UK versions only.

## GETTING STARTED

By following this step-by-step guide your new Sensory Ecobox system will be ready for use:

- Remove cleaner and accessories from packaging. Please dispose of the packaging in a safe and environmentally conscientious way.
- Open the top cover (A) ensuring that the Ecobox, Ecobox lid (B1), pre-motor filter (B2) and exhaust filter (B3) are fitted correctly. Close the top cover.
- Insert the hose end into the top cover, ensuring it clips and locks into position (C). To release simply press in the two hose end latches and pull.
- Fix the free end of the hose into the handle using the lock ring (D).
- Fit extension tubes (E1), floor nozzle (E2), or other accessories as required for use.
- Your Sensory Ecobox is now ready for use. Extract the plug and pull out all of the cord. Plug in and switch on.

## FEATURES - DEPENDING ON MODEL,

- Hoovers unique Ecobox is made from a special porous plastic material which allows air to pass through whilst retaining most of the dirt and fine dust.
- **On/Off button (F).** Once plugged in, press this button to start the cleaner. Press it again to stop the cleaner before removing the plug after use.
- **Cord rewind button (G).** Remove the plug from the power supply. Press this button to wind the power cord back into the cleaner.
- **Overheating Protection.** Cleaner automatically switches off. In this event extract the plug from the socket and allow cleaner to cool for 30 minutes. Check if the Ecobox needs cleaning or if there is a blockage in the system (see chapter: "Cleaning The Ecobox" and "Removing A Blockage From The System").
- **Fixed power control (depending on model).** Adjust the suction by moving the handle valve (H): suction will decrease when opening the valve. Use low suction for delicate fabrics.
- **Variable power control (I) (depending on model).** Rotate the on/off button to increase or decrease suction. Use low suction for delicate fabrics.
- **Carpet and floor nozzle (J).** Press pedal on the nozzle to lower the brushes when cleaning hard floors. Press the pedal again to lift the brushes when cleaning carpets.

- **Turbo nozzle (depending on model).** Use the Turbo nozzle for deep cleaning on carpets. **IMPORTANT:** do not use Turbo nozzle on rugs with long fringes, animal hide and over carpet piles with a depth exceeding 15 mm. Do not keep the nozzle stationary while the brush is rotating. Also available as an additional accessory. Order Pack No. J19 0484 5046.
- **Caresse nozzle (depending on model).** Designed for use on wooden or any delicate floors. Also available as an additional accessory. Order Pack No. G50 0484 5044.
- **Multi function tool.** Tool is stored on the handle (E1). Remove tool and use as:
  - a) Crevice tool: for corners and hard to reach areas (K1).
  - b) Furniture nozzle: for soft furnishings and fabrics (K2).
  - c) Dusting brush (depending on model): for bookshelves, frames, keyboards etc. (K2).
- **Tube Parking and Storage (L).** The tubes can be parked at the rear of the cleaner or stored into the storage slot underneath the cleaner.

## EMPTYING THE ECOBOX

Check and empty the Ecobox regularly, best after each use.

- Extract the Ecobox (M).
- Use the handle to carry the Ecobox to the dustbin (N).
- Press the latch to remove the cover from the Ecobox as shown (O).
- Grip the Ecobox firmly and tip the contents into the dustbin. Shake the Ecobox if required or use a brush to remove any of the remaining dust or debris (P).
- Wash the Ecobox regularly. See chapter "Cleaning The Ecobox".
- To close the Ecobox locate the cover rear guides into the container recess then close firmly (Q).
- Return the Ecobox back to its original position in the cleaner.

## CLEANING THE ECOBOX

To maintain the best performance, we would recommend that you **wash the Ecobox every month** removing even the finest dust retained in it. To wash and optimise the performance the following simple steps should be taken:

- Shake out the Ecobox to remove large dirt and debris (P) as described in "Emptying The Ecobox".
- Brush the inside of the Ecobox to remove the fine dust that may have formed on the walls of the Ecobox (R).
- Wash the inside and outside of the Ecobox thoroughly using warm water and washing up liquid. At this point if desired, the Ecobox can be placed in a dishwasher and washed on a full wash and dry cycle at up to 75°C (S).
- If not placed in a dishwasher rinse thoroughly inside and outside making sure no detergent is left on the Ecobox (T).

- Remove excess water with a dry cloth and leave to air dry for 24 hours or until fully dry (U).
- After completing the washing and drying operations, locate the cover rear guides into the container recess then close firmly. Return the Ecobox to its original position in the cleaner. (Q)

## **FILTERS MAINTENANCE**

- To maintain best performance we recommend that you wash the filters every month.
- To access the filters please refer to diagram (B1, 2, 3).
- Rinse both filters under hand warm water (V and W).
- Do not scrub the filters, use washing up liquid or place in a dishwasher.
- Remove excess water with a dry cloth and leave to air dry for 24 hours or until fully dry (X).
- After completing the washing and drying operations, return the filters to their original positions in the cleaner.

## **REMOVING A BLOCKAGE FROM THE SYSTEM**

If there is a noticeable drop in performance see the following 2 points:

- 1) Check if the Ecobox is full (If so refer to chapter "Emptying The Ecobox").
- 2) If not full then:
  - a) Have you cleaned the Ecobox and filters recently? If not please refer to the chapters "Cleaning The Ecobox" and "Filters Maintenance".
  - b) Check if there is any other blockage in the system.
    - Use a rod or pole to remove any blockage from the tubes and flexible hose.
    - It may also be possible to remove an obstruction in the flexible hose by lightly squeezing or bending it.
    - Check and clean if required the underside of the nozzle by using the crevice tool.

## **SIMPLE USER CHECK LIST BEFORE CALLING FOR SERVICE**

- 1) Is there a working electricity supply to the cleaner? Check with another appliance.
- 2) Is there a restriction?
  - a) Is the Ecobox full? Please refer to chapter "Emptying The Ecobox".
  - b) Are the filters or Ecobox blocked? Please refer to chapter "Filters Maintenance" or "Cleaning The Ecobox".
  - c) Is the hose or nozzle blocked? Please refer to chapter "Removing A Blockage from The System".
- 3) Has the cleaner automatically switched off? In this case the Overheating Protection has been activated. Please refer to chapter "Features", paragraph "Overheating Protection".

Please remember that:

- 1) Some carpets can cause a small build up of static electricity. Any static discharge is not hazardous to health or the product.
- 2) A service charge will be made if the cleaner is examined and found in working order, has not been assembled in accordance with these instructions, or has been misused.

## Do

- Call Hoover Customer Help Line 08705 400 600 in the event of dissatisfaction
- Ensure that all service and repairs are carried out by an authorised Hoover Service Engineer
- Only use genuine Hoover parts
- Empty the Ecobox regularly. Best after each use
- Always switch off and remove the power plug from the electricity supply after use and before cleaning the appliance or attempting user maintenance as described in these instructions

Remember: Electricity can be dangerous

## DO NOT

- Position the cleaner above you when cleaning stairs
- Use cleaner without the Ecobox correctly fitted
- Use your cleaner out of doors, on wet surfaces or for wet pick up
- Pick up matches, hot ash, cigarette ends or anything that may damage the product
- Spray with or pick up flammable liquids, cleaning fluids, aerosols or their vapours as this may cause risk of fire/explosion
- Run over, stand on, or wrap the power cord around arms or legs when using your cleaner
- Continue to use your cleaner if it or the plug/power cord appears to be faulty or damaged. To avoid safety hazards the cleaner must only be repaired by an authorised Hoover Service Engineer
- Recharge batteries, dispose of in fire or dissect - danger of explosion

**ACCESSORIES:** For accessories please quote the following pack numbers

- Turbo Nozzle pack No. J19 0484 5046
- Caresse Nozzle pack No. G50 0484 5044

### Guarantee Statement

The guarantee conditions for this appliance are as defined by our representative in the country in which it is sold. Details regarding these conditions can be obtained from the dealer from whom the appliance was purchased.

The bill of sale or receipt must be produced when making any claim under the terms of this guarantee.

Subject to change without notice.

GIAS Customer service 08705 400500

Hoover spares 01204 556111

BSI

ISO9002

BEAB Approved

**Quality:** Our UK factories meet the strict quality standards of the British Standards Institution (BSI).

**Safety:** We gain independent approval from BEAB to demonstrate that our domestic electrical appliances are safe.

BEAB - the British Electrotechnical Approvals Board - ensures that European safety standards are met and maintained throughout the production life of an appliance.



Hoover Limited  
Pentrebach  
Merthyr Tydfil  
Mid-Glamorgan  
CF48 4TU

**Part No: 05655118**

## IMPORTANT SAFETY REMINDERS

This cleaner should only be used for domestic cleaning as described in these instructions. Please ensure that these are fully understood before operating the appliance. This product is double insulated and must not be earthed.

**Important:** The wires in the power cord are coloured in accordance with the following code:

**Blue - Neutral      Brown - Live**

13 Amp fused plug on UK versions only.

## GETTING STARTED

By following this step-by-step guide your new Sensory Ecobox system will be ready for use:

- Remove cleaner and accessories from packaging. Please dispose of the packaging in a safe and environmentally conscientious way.
- Open the top cover (A) ensuring that the Ecobox, Ecobox lid (B1), pre-motor filter (B2) and exhaust filter (B3) are fitted correctly. Close the top cover.
- Insert the hose end into the top cover, ensuring it clips and locks into position (C). To release simply press in the two hose end latches and pull.
- Fix the free end of the hose into the handle using the lock ring (D).
- Fit extension tubes (E1), floor nozzle (E2), or other accessories as required for use.
- Your Sensory Ecobox is now ready for use. Extract the plug and pull out all of the cord. Plug in and switch on.

## FEATURES - DEPENDING ON MODEL,

- Hoovers unique Ecobox is made from a special porous plastic material which allows air to pass through whilst retaining most of the dirt and fine dust.
- **On/Off button (F).** Once plugged in, press this button to start the cleaner. Press it again to stop the cleaner before removing the plug after use.
- **Cord rewind button (G).** Remove the plug from the power supply. Press this button to wind the power cord back into the cleaner.
- **Overheating Protection.** Cleaner automatically switches off. In this event extract the plug from the socket and allow cleaner to cool for 30 minutes. Check if the Ecobox needs cleaning or if there is a blockage in the system (see chapter: "Cleaning The Ecobox" and "Removing A Blockage From The System").
- **Fixed power control (depending on model).** Adjust the suction by moving the handle valve (H): suction will decrease when opening the valve. Use low suction for delicate fabrics.
- **Variable power control (I) (depending on model).** Rotate the on/off button to increase or decrease suction. Use low suction for delicate fabrics.
- **Carpet and floor nozzle (J).** Press pedal on the nozzle to lower the brushes when cleaning hard floors. Press the pedal again to lift the brushes when cleaning carpets.

- **Turbo nozzle (depending on model).** Use the Turbo nozzle for deep cleaning on carpets. **IMPORTANT:** do not use Turbo nozzle on rugs with long fringes, animal hide and over carpet piles with a depth exceeding 15 mm. Do not keep the nozzle stationary while the brush is rotating. Also available as an additional accessory. Order Pack No. J19 0484 5046.
- **Caresse nozzle (depending on model).** Designed for use on wooden or any delicate floors. Also available as an additional accessory. Order Pack No. G50 0484 5044.
- **Multi function tool.** Tool is stored on the handle (E1). Remove tool and use as:
  - a) Crevice tool: for corners and hard to reach areas (K1).
  - b) Furniture nozzle: for soft furnishings and fabrics (K2).
  - c) Dusting brush (depending on model): for bookshelves, frames, keyboards etc. (K2).
- **Tube Parking and Storage (L).** The tubes can be parked at the rear of the cleaner or stored into the storage slot underneath the cleaner.

## **EMPTYING THE ECOBOX**

Check and empty the Ecobox regularly, best after each use.

- Extract the Ecobox (M).
- Use the handle to carry the Ecobox to the dustbin (N).
- Press the latch to remove the cover from the Ecobox as shown (O).
- Grip the Ecobox firmly and tip the contents into the dustbin. Shake the Ecobox if required or use a brush to remove any of the remaining dust or debris (P).
- Wash the Ecobox regularly. See chapter "Cleaning The Ecobox".
- To close the Ecobox locate the cover rear guides into the container recess then close firmly (Q).
- Return the Ecobox back to its original position in the cleaner.

## **CLEANING THE ECOBOX**

To maintain the best performance, we would recommend that you **wash the Ecobox every month** removing even the finest dust retained in it. To wash and optimise the performance the following simple steps should be taken:

- Shake out the Ecobox to remove large dirt and debris (P) as described in "Emptying The Ecobox".
- Brush the inside of the Ecobox to remove the fine dust that may have formed on the walls of the Ecobox (R).
- Wash the inside and outside of the Ecobox thoroughly using warm water and washing up liquid. At this point if desired, the Ecobox can be placed in a dishwasher and washed on a full wash and dry cycle at up to 75°C (S).
- If not placed in a dishwasher rinse thoroughly inside and outside making sure no detergent is left on the Ecobox (T).

- Remove excess water with a dry cloth and leave to air dry for 24 hours or until fully dry (U).
- After completing the washing and drying operations, locate the cover rear guides into the container recess then close firmly. Return the Ecobox to its original position in the cleaner. (Q)

## **FILTERS MAINTENANCE**

- To maintain best performance we recommend that you wash the filters every month.
- To access the filters please refer to diagram (B1, 2, 3).
- Rinse both filters under hand warm water (V and W).
- Do not scrub the filters, use washing up liquid or place in a dishwasher.
- Remove excess water with a dry cloth and leave to air dry for 24 hours or until fully dry (X).
- After completing the washing and drying operations, return the filters to their original positions in the cleaner.

## **REMOVING A BLOCKAGE FROM THE SYSTEM**

If there is a noticeable drop in performance see the following 2 points:

- 1) Check if the Ecobox is full (If so refer to chapter "Emptying The Ecobox").
- 2) If not full then:
  - a) Have you cleaned the Ecobox and filters recently? If not please refer to the chapters "Cleaning The Ecobox" and "Filters Maintenance".
  - b) Check if there is any other blockage in the system.
    - Use a rod or pole to remove any blockage from the tubes and flexible hose.
    - It may also be possible to remove an obstruction in the flexible hose by lightly squeezing or bending it.
    - Check and clean if required the underside of the nozzle by using the crevice tool.

## **SIMPLE USER CHECK LIST BEFORE CALLING FOR SERVICE**

- 1) Is there a working electricity supply to the cleaner? Check with another appliance.
- 2) Is there a restriction?
  - a) Is the Ecobox full? Please refer to chapter "Emptying The Ecobox".
  - b) Are the filters or Ecobox blocked? Please refer to chapter "Filters Maintenance" or "Cleaning The Ecobox".
  - c) Is the hose or nozzle blocked? Please refer to chapter "Removing A Blockage from The System".
- 3) Has the cleaner automatically switched off? In this case the Overheating Protection has been activated. Please refer to chapter "Features", paragraph "Overheating Protection".

Please remember that:

- 1) Some carpets can cause a small build up of static electricity. Any static discharge is not hazardous to health or the product.
- 2) A service charge will be made if the cleaner is examined and found in working order, has not been assembled in accordance with these instructions, or has been misused.

## Do

- Call Hoover Customer Help Line 08705 400 600 in the event of dissatisfaction
- Ensure that all service and repairs are carried out by an authorised Hoover Service Engineer
- Only use genuine Hoover parts
- Empty the Ecobox regularly. Best after each use
- Always switch off and remove the power plug from the electricity supply after use and before cleaning the appliance or attempting user maintenance as described in these instructions

Remember: Electricity can be dangerous

## DO NOT

- Position the cleaner above you when cleaning stairs
- Use cleaner without the Ecobox correctly fitted
- Use your cleaner out of doors, on wet surfaces or for wet pick up
- Pick up matches, hot ash, cigarette ends or anything that may damage the product
- Spray with or pick up flammable liquids, cleaning fluids, aerosols or their vapours as this may cause risk of fire/explosion
- Run over, stand on, or wrap the power cord around arms or legs when using your cleaner
- Continue to use your cleaner if it or the plug/power cord appears to be faulty or damaged. To avoid safety hazards the cleaner must only be repaired by an authorised Hoover Service Engineer
- Recharge batteries, dispose of in fire or dissect - danger of explosion

ACCESSORIES: For accessories please quote the following pack numbers

- Turbo Nozzle pack No. J19 0484 5046
- Caresse Nozzle pack No. G50 0484 5044

### Guarantee Statement

The guarantee conditions for this appliance are as defined by our representative in the country in which it is sold. Details regarding these conditions can be obtained from the dealer from whom the appliance was purchased.

The bill of sale or receipt must be produced when making any claim under the terms of this guarantee.

Subject to change without notice.

GIAS Customer service 08705 400500

Hoover spares 01204 556111

BSI

ISO9002

BEAB Approved

**Quality:** Our UK factories meet the strict quality standards of the British Standards Institution (BSI).

**Safety:** We gain independent approval from BEAB to demonstrate that our domestic electrical appliances are safe.

BEAB - the British Electrotechnical Approvals Board - ensures that European safety standards are met and maintained throughout the production life of an appliance.



Hoover Limited  
Pentrebach  
Merthyr Tydfil  
Mid-Glamorgan  
CF48 4TU

**Part No: 05655118**



## IMPORTANT SAFETY REMINDERS

This cleaner should only be used for domestic cleaning as described in these instructions. Please ensure that these are fully understood before operating the appliance. This product is double insulated and must not be earthed.

**Important:** The wires in the power cord are coloured in accordance with the following code:

**Blue - Neutral**      **Brown - Live**  
13 Amp fused plug on UK versions only.

## GETTING STARTED

By following this step-by-step guide your new Sensory Ecobox system will be ready for use:

- Remove cleaner and accessories from packaging. Please dispose of the packaging in a safe and environmentally conscientious way.
- Open the top cover (A) ensuring that the Ecobox, Ecobox lid (B1), pre-motor filter (B2) and exhaust filter (B3) are fitted correctly. Close the top cover.
- Insert the hose end into the top cover, ensuring it clips and locks into position (C). To release simply press in the two hose end latches and pull.
- Fix the free end of the hose into the handle using the lock ring (D).
- Fit extension tubes (E1), floor nozzle (E2), or other accessories as required for use.
- Your Sensory Ecobox is now ready for use. Extract the plug and pull out all of the cord. Plug in and switch on.

## FEATURES - DEPENDING ON MODEL,

- Hoovers unique Ecobox is made from a special porous plastic material which allows air to pass through whilst retaining most of the dirt and fine dust.
- **On/Off button (F).** Once plugged in, press this button to start the cleaner. Press it again to stop the cleaner before removing the plug after use.
- **Cord rewind button (G).** Remove the plug from the power supply. Press this button to wind the power cord back into the cleaner.
- **Overheating Protection.** Cleaner automatically switches off. In this event extract the plug from the socket and allow cleaner to cool for 30 minutes. Check if the Ecobox needs cleaning or if there is a blockage in the system (see chapter: "Cleaning The Ecobox" and "Removing A Blockage From The System").
- **Fixed power control (depending on model).** Adjust the suction by moving the handle valve (H): suction will decrease when opening the valve. Use low suction for delicate fabrics.
- **Variable power control (I) (depending on model).** Rotate the on/off button to increase or decrease suction. Use low suction for delicate fabrics.
- **Carpet and floor nozzle (J).** Press pedal on the nozzle to lower the brushes when cleaning hard floors. Press the pedal again to lift the brushes when cleaning carpets.

- **Turbo nozzle (depending on model).** Use the Turbo nozzle for deep cleaning on carpets. **IMPORTANT:** do not use Turbo nozzle on rugs with long fringes, animal hide and over carpet piles with a depth exceeding 15 mm. Do not keep the nozzle stationary while the brush is rotating. Also available as an additional accessory. Order Pack No. J19 0484 5046.
- **Caresse nozzle (depending on model).** Designed for use on wooden or any delicate floors. Also available as an additional accessory. Order Pack No. G50 0484 5044.
- **Multi function tool.** Tool is stored on the handle (E1). Remove tool and use as:
  - a) Crevice tool: for corners and hard to reach areas (K1).
  - b) Furniture nozzle: for soft furnishings and fabrics (K2).
  - c) Dusting brush (depending on model): for bookshelves, frames, keyboards etc. (K2).
- **Tube Parking and Storage (L).** The tubes can be parked at the rear of the cleaner or stored into the storage slot underneath the cleaner.

## EMPTYING THE ECOBOX

Check and empty the Ecobox regularly, best after each use.

- Extract the Ecobox (M).
- Use the handle to carry the Ecobox to the dustbin (N).
- Press the latch to remove the cover from the Ecobox as shown (O).
- Grip the Ecobox firmly and tip the contents into the dustbin. Shake the Ecobox if required or use a brush to remove any of the remaining dust or debris (P).
- Wash the Ecobox regularly. See chapter "Cleaning The Ecobox".
- To close the Ecobox locate the cover rear guides into the container recess then close firmly (Q).
- Return the Ecobox back to its original position in the cleaner.

## CLEANING THE ECOBOX

To maintain the best performance, we would recommend that you **wash the Ecobox every month** removing even the finest dust retained in it. To wash and optimise the performance the following simple steps should be taken:

- Shake out the Ecobox to remove large dirt and debris (P) as described in "Emptying The Ecobox".
- Brush the inside of the Ecobox to remove the fine dust that may have formed on the walls of the Ecobox (R).
- Wash the inside and outside of the Ecobox thoroughly using warm water and washing up liquid. At this point if desired, the Ecobox can be placed in a dishwasher and washed on a full wash and dry cycle at up to 75°C (S).
- If not placed in a dishwasher rinse thoroughly inside and outside making sure no detergent is left on the Ecobox (T).

- Remove excess water with a dry cloth and leave to air dry for 24 hours or until fully dry (U).
- After completing the washing and drying operations, locate the cover rear guides into the container recess then close firmly. Return the Ecobox to its original position in the cleaner. (Q)

## **FILTERS MAINTENANCE**

- To maintain best performance we recommend that you wash the filters every month.
- To access the filters please refer to diagram (B1, 2, 3).
- Rinse both filters under hand warm water (V and W).
- Do not scrub the filters, use washing up liquid or place in a dishwasher.
- Remove excess water with a dry cloth and leave to air dry for 24 hours or until fully dry (X).
- After completing the washing and drying operations, return the filters to their original positions in the cleaner.

## **REMOVING A BLOCKAGE FROM THE SYSTEM**

If there is a noticeable drop in performance see the following 2 points:

- 1) Check if the Ecobox is full (If so refer to chapter "Emptying The Ecobox").
- 2) If not full then:
  - a) Have you cleaned the Ecobox and filters recently? If not please refer to the chapters "Cleaning The Ecobox" and "Filters Maintenance".
  - b) Check if there is any other blockage in the system.
    - Use a rod or pole to remove any blockage from the tubes and flexible hose.
    - It may also be possible to remove an obstruction in the flexible hose by lightly squeezing or bending it.
    - Check and clean if required the underside of the nozzle by using the crevice tool.

## **SIMPLE USER CHECK LIST BEFORE CALLING FOR SERVICE**

- 1) Is there a working electricity supply to the cleaner? Check with another appliance.
- 2) Is there a restriction?
  - a) Is the Ecobox full? Please refer to chapter "Emptying The Ecobox".
  - b) Are the filters or Ecobox blocked? Please refer to chapter "Filters Maintenance" or "Cleaning The Ecobox".
  - c) Is the hose or nozzle blocked? Please refer to chapter "Removing A Blockage from The System".
- 3) Has the cleaner automatically switched off? In this case the Overheating Protection has been activated. Please refer to chapter "Features", paragraph "Overheating Protection".

Please remember that:

- 1) Some carpets can cause a small build up of static electricity. Any static discharge is not hazardous to health or the product.
- 2) A service charge will be made if the cleaner is examined and found in working order, has not been assembled in accordance with these instructions, or has been misused.

## Do

- Call Hoover Customer Help Line 08705 400 600 in the event of dissatisfaction
- Ensure that all service and repairs are carried out by an authorised Hoover Service Engineer
- Only use genuine Hoover parts
- Empty the Ecobox regularly. Best after each use
- Always switch off and remove the power plug from the electricity supply after use and before cleaning the appliance or attempting user maintenance as described in these instructions

Remember: Electricity can be dangerous

## DO NOT

- Position the cleaner above you when cleaning stairs
- Use cleaner without the Ecobox correctly fitted
- Use your cleaner out of doors, on wet surfaces or for wet pick up
- Pick up matches, hot ash, cigarette ends or anything that may damage the product
- Spray with or pick up flammable liquids, cleaning fluids, aerosols or their vapours as this may cause risk of fire/explosion
- Run over, stand on, or wrap the power cord around arms or legs when using your cleaner
- Continue to use your cleaner if it or the plug/power cord appears to be faulty or damaged. To avoid safety hazards the cleaner must only be repaired by an authorised Hoover Service Engineer
- Recharge batteries, dispose of in fire or dissect - danger of explosion

ACCESSORIES: For accessories please quote the following pack numbers

- Turbo Nozzle pack No. J19 0484 5046
- Caresse Nozzle pack No. G50 0484 5044

### Guarantee Statement

The guarantee conditions for this appliance are as defined by our representative in the country in which it is sold. Details regarding these conditions can be obtained from the dealer from whom the appliance was purchased.

The bill of sale or receipt must be produced when making any claim under the terms of this guarantee.

Subject to change without notice.

GIAS Customer service 08705 400500

Hoover spares 01204 556111

BSI

ISO9002

BEAB Approved

**Quality:** Our UK factories meet the strict quality standards of the British Standards Institution (BSI).

**Safety:** We gain independent approval from BEAB to demonstrate that our domestic electrical appliances are safe.

BEAB - the British Electrotechnical Approvals Board - ensures that European safety standards are met and maintained throughout the production life of an appliance.



Hoover Limited  
Pentrebach  
Merthyr Tydfil  
Mid-Glamorgan  
CF48 4TU

**Part No: 05655118**

## IMPORTANT SAFETY REMINDERS

This cleaner should only be used for domestic cleaning as described in these instructions. Please ensure that these are fully understood before operating the appliance. This product is double insulated and must not be earthed.

**Important:** The wires in the power cord are coloured in accordance with the following code:

**Blue - Neutral**      **Brown - Live**  
13 Amp fused plug on UK versions only.

## GETTING STARTED

By following this step-by-step guide your new Sensory Ecobox system will be ready for use:

- Remove cleaner and accessories from packaging. Please dispose of the packaging in a safe and environmentally conscientious way.
- Open the top cover (A) ensuring that the Ecobox, Ecobox lid (B1), pre-motor filter (B2) and exhaust filter (B3) are fitted correctly. Close the top cover.
- Insert the hose end into the top cover, ensuring it clips and locks into position (C). To release simply press in the two hose end latches and pull.
- Fix the free end of the hose into the handle using the lock ring (D).
- Fit extension tubes (E1), floor nozzle (E2), or other accessories as required for use.
- Your Sensory Ecobox is now ready for use. Extract the plug and pull out all of the cord. Plug in and switch on.

## FEATURES - DEPENDING ON MODEL,

- Hoovers unique Ecobox is made from a special porous plastic material which allows air to pass through whilst retaining most of the dirt and fine dust.
- **On/Off button (F).** Once plugged in, press this button to start the cleaner. Press it again to stop the cleaner before removing the plug after use.
- **Cord rewind button (G).** Remove the plug from the power supply. Press this button to wind the power cord back into the cleaner.
- **Overheating Protection.** Cleaner automatically switches off. In this event extract the plug from the socket and allow cleaner to cool for 30 minutes. Check if the Ecobox needs cleaning or if there is a blockage in the system (see chapter: "Cleaning The Ecobox" and "Removing A Blockage From The System").
- **Fixed power control (depending on model).** Adjust the suction by moving the handle valve (H): suction will decrease when opening the valve. Use low suction for delicate fabrics.
- **Variable power control (I) (depending on model).** Rotate the on/off button to increase or decrease suction. Use low suction for delicate fabrics.
- **Carpet and floor nozzle (J).** Press pedal on the nozzle to lower the brushes when cleaning hard floors. Press the pedal again to lift the brushes when cleaning carpets.

- **Turbo nozzle (depending on model).** Use the Turbo nozzle for deep cleaning on carpets. **IMPORTANT:** do not use Turbo nozzle on rugs with long fringes, animal hide and over carpet piles with a depth exceeding 15 mm. Do not keep the nozzle stationary while the brush is rotating. Also available as an additional accessory. Order Pack No. J19 0484 5046.
- **Caresse nozzle (depending on model).** Designed for use on wooden or any delicate floors. Also available as an additional accessory. Order Pack No. G50 0484 5044.
- **Multi function tool.** Tool is stored on the handle (E1). Remove tool and use as:
  - a) Crevice tool: for corners and hard to reach areas (K1).
  - b) Furniture nozzle: for soft furnishings and fabrics (K2).
  - c) Dusting brush (depending on model): for bookshelves, frames, keyboards etc. (K2).
- **Tube Parking and Storage (L).** The tubes can be parked at the rear of the cleaner or stored into the storage slot underneath the cleaner.

## EMPTYING THE ECOBOX

Check and empty the Ecobox regularly, best after each use.

- Extract the Ecobox (M).
- Use the handle to carry the Ecobox to the dustbin (N).
- Press the latch to remove the cover from the Ecobox as shown (O).
- Grip the Ecobox firmly and tip the contents into the dustbin. Shake the Ecobox if required or use a brush to remove any of the remaining dust or debris (P).
- Wash the Ecobox regularly. See chapter "Cleaning The Ecobox".
- To close the Ecobox locate the cover rear guides into the container recess then close firmly (Q).
- Return the Ecobox back to its original position in the cleaner.

## CLEANING THE ECOBOX

To maintain the best performance, we would recommend that you **wash the Ecobox every month** removing even the finest dust retained in it. To wash and optimise the performance the following simple steps should be taken:

- Shake out the Ecobox to remove large dirt and debris (P) as described in "Emptying The Ecobox".
- Brush the inside of the Ecobox to remove the fine dust that may have formed on the walls of the Ecobox (R).
- Wash the inside and outside of the Ecobox thoroughly using warm water and washing up liquid. At this point if desired, the Ecobox can be placed in a dishwasher and washed on a full wash and dry cycle at up to 75°C (S).
- If not placed in a dishwasher rinse thoroughly inside and outside making sure no detergent is left on the Ecobox (T).

- Remove excess water with a dry cloth and leave to air dry for 24 hours or until fully dry (U).
- After completing the washing and drying operations, locate the cover rear guides into the container recess then close firmly. Return the Ecobox to its original position in the cleaner. (Q)

## **FILTERS MAINTENANCE**

- To maintain best performance we recommend that you wash the filters every month.
- To access the filters please refer to diagram (B1, 2, 3).
- Rinse both filters under hand warm water (V and W).
- Do not scrub the filters, use washing up liquid or place in a dishwasher.
- Remove excess water with a dry cloth and leave to air dry for 24 hours or until fully dry (X).
- After completing the washing and drying operations, return the filters to their original positions in the cleaner.

## **REMOVING A BLOCKAGE FROM THE SYSTEM**

If there is a noticeable drop in performance see the following 2 points:

- 1) Check if the Ecobox is full (If so refer to chapter "Emptying The Ecobox").
- 2) If not full then:
  - a) Have you cleaned the Ecobox and filters recently? If not please refer to the chapters "Cleaning The Ecobox" and "Filters Maintenance".
  - b) Check if there is any other blockage in the system.
    - Use a rod or pole to remove any blockage from the tubes and flexible hose.
    - It may also be possible to remove an obstruction in the flexible hose by lightly squeezing or bending it.
    - Check and clean if required the underside of the nozzle by using the crevice tool.

## **SIMPLE USER CHECK LIST BEFORE CALLING FOR SERVICE**

- 1) Is there a working electricity supply to the cleaner? Check with another appliance.
- 2) Is there a restriction?
  - a) Is the Ecobox full? Please refer to chapter "Emptying The Ecobox".
  - b) Are the filters or Ecobox blocked? Please refer to chapter "Filters Maintenance" or "Cleaning The Ecobox".
  - c) Is the hose or nozzle blocked? Please refer to chapter "Removing A Blockage from The System".
- 3) Has the cleaner automatically switched off? In this case the Overheating Protection has been activated. Please refer to chapter "Features", paragraph "Overheating Protection".

Please remember that:

- 1) Some carpets can cause a small build up of static electricity. Any static discharge is not hazardous to health or the product.
- 2) A service charge will be made if the cleaner is examined and found in working order, has not been assembled in accordance with these instructions, or has been misused.

## Do

- Call Hoover Customer Help Line 08705 400 600 in the event of dissatisfaction
- Ensure that all service and repairs are carried out by an authorised Hoover Service Engineer
- Only use genuine Hoover parts
- Empty the Ecobox regularly. Best after each use
- Always switch off and remove the power plug from the electricity supply after use and before cleaning the appliance or attempting user maintenance as described in these instructions

Remember: Electricity can be dangerous

## DO NOT

- Position the cleaner above you when cleaning stairs
- Use cleaner without the Ecobox correctly fitted
- Use your cleaner out of doors, on wet surfaces or for wet pick up
- Pick up matches, hot ash, cigarette ends or anything that may damage the product
- Spray with or pick up flammable liquids, cleaning fluids, aerosols or their vapours as this may cause risk of fire/explosion
- Run over, stand on, or wrap the power cord around arms or legs when using your cleaner
- Continue to use your cleaner if it or the plug/power cord appears to be faulty or damaged. To avoid safety hazards the cleaner must only be repaired by an authorised Hoover Service Engineer
- Recharge batteries, dispose of in fire or dissect - danger of explosion

ACCESSORIES: For accessories please quote the following pack numbers

- Turbo Nozzle pack No. J19 0484 5046
- Caresse Nozzle pack No. G50 0484 5044

### Guarantee Statement

The guarantee conditions for this appliance are as defined by our representative in the country in which it is sold. Details regarding these conditions can be obtained from the dealer from whom the appliance was purchased.

The bill of sale or receipt must be produced when making any claim under the terms of this guarantee.

Subject to change without notice.

GIAS Customer service 08705 400500

Hoover spares 01204 556111





**Quality:** Our UK factories meet the strict quality standards of the British Standards Institution (BSI).

**Safety:** We gain independent approval from BEAB to demonstrate that our domestic electrical appliances are safe.

BEAB - the British Electrotechnical Approvals Board - ensures that European safety standards are met and maintained throughout the production life of an appliance.



Hoover Limited  
Pentrebach  
Merthyr Tydfil  
Mid-Glamorgan  
CF48 4TU

**Part No: 05655118**



## IMPORTANT SAFETY REMINDERS

This cleaner should only be used for domestic cleaning as described in these instructions. Please ensure that these are fully understood before operating the appliance. This product is double insulated and must not be earthed.

**Important:** The wires in the power cord are coloured in accordance with the following code:

**Blue - Neutral**      **Brown - Live**

13 Amp fused plug on UK versions only.

## GETTING STARTED

By following this step-by-step guide your new Sensory Ecobox system will be ready for use:

- Remove cleaner and accessories from packaging. Please dispose of the packaging in a safe and environmentally conscientious way.
- Open the top cover (A) ensuring that the Ecobox, Ecobox lid (B1), pre-motor filter (B2) and exhaust filter (B3) are fitted correctly. Close the top cover.
- Insert the hose end into the top cover, ensuring it clips and locks into position (C). To release simply press in the two hose end latches and pull.
- Fix the free end of the hose into the handle using the lock ring (D).
- Fit extension tubes (E1), floor nozzle (E2), or other accessories as required for use.
- Your Sensory Ecobox is now ready for use. Extract the plug and pull out all of the cord. Plug in and switch on.

## FEATURES - DEPENDING ON MODEL,

- Hoovers unique Ecobox is made from a special porous plastic material which allows air to pass through whilst retaining most of the dirt and fine dust.
- **On/Off button (F).** Once plugged in, press this button to start the cleaner. Press it again to stop the cleaner before removing the plug after use.
- **Cord rewind button (G).** Remove the plug from the power supply. Press this button to wind the power cord back into the cleaner.
- **Overheating Protection.** Cleaner automatically switches off. In this event extract the plug from the socket and allow cleaner to cool for 30 minutes. Check if the Ecobox needs cleaning or if there is a blockage in the system (see chapter: "Cleaning The Ecobox" and "Removing A Blockage From The System").
- **Fixed power control (depending on model).** Adjust the suction by moving the handle valve (H): suction will decrease when opening the valve. Use low suction for delicate fabrics.
- **Variable power control (I) (depending on model).** Rotate the on/off button to increase or decrease suction. Use low suction for delicate fabrics.
- **Carpet and floor nozzle (J).** Press pedal on the nozzle to lower the brushes when cleaning hard floors. Press the pedal again to lift the brushes when cleaning carpets.

- **Turbo nozzle (depending on model).** Use the Turbo nozzle for deep cleaning on carpets. **IMPORTANT:** do not use Turbo nozzle on rugs with long fringes, animal hide and over carpet piles with a depth exceeding 15 mm. Do not keep the nozzle stationary while the brush is rotating. Also available as an additional accessory. Order Pack No. J19 0484 5046.
- **Caresse nozzle (depending on model).** Designed for use on wooden or any delicate floors. Also available as an additional accessory. Order Pack No. G50 0484 5044.
- **Multi function tool.** Tool is stored on the handle (E1). Remove tool and use as:
  - a) Crevice tool: for corners and hard to reach areas (K1).
  - b) Furniture nozzle: for soft furnishings and fabrics (K2).
  - c) Dusting brush (depending on model): for bookshelves, frames, keyboards etc. (K2).
- **Tube Parking and Storage (L).** The tubes can be parked at the rear of the cleaner or stored into the storage slot underneath the cleaner.

## EMPTYING THE ECOBOX

Check and empty the Ecobox regularly, best after each use.

- Extract the Ecobox (M).
- Use the handle to carry the Ecobox to the dustbin (N).
- Press the latch to remove the cover from the Ecobox as shown (O).
- Grip the Ecobox firmly and tip the contents into the dustbin. Shake the Ecobox if required or use a brush to remove any of the remaining dust or debris (P).
- Wash the Ecobox regularly. See chapter "Cleaning The Ecobox".
- To close the Ecobox locate the cover rear guides into the container recess then close firmly (Q).
- Return the Ecobox back to its original position in the cleaner.

## CLEANING THE ECOBOX

To maintain the best performance, we would recommend that you **wash the Ecobox every month** removing even the finest dust retained in it. To wash and optimise the performance the following simple steps should be taken:

- Shake out the Ecobox to remove large dirt and debris (P) as described in "Emptying The Ecobox".
- Brush the inside of the Ecobox to remove the fine dust that may have formed on the walls of the Ecobox (R).
- Wash the inside and outside of the Ecobox thoroughly using warm water and washing up liquid. At this point if desired, the Ecobox can be placed in a dishwasher and washed on a full wash and dry cycle at up to 75°C (S).
- If not placed in a dishwasher rinse thoroughly inside and outside making sure no detergent is left on the Ecobox (T).

- Remove excess water with a dry cloth and leave to air dry for 24 hours or until fully dry (U).
- After completing the washing and drying operations, locate the cover rear guides into the container recess then close firmly. Return the Ecobox to its original position in the cleaner. (Q)

## **FILTERS MAINTENANCE**

- To maintain best performance we recommend that you wash the filters every month.
- To access the filters please refer to diagram (B1, 2, 3).
- Rinse both filters under hand warm water (V and W).
- Do not scrub the filters, use washing up liquid or place in a dishwasher.
- Remove excess water with a dry cloth and leave to air dry for 24 hours or until fully dry (X).
- After completing the washing and drying operations, return the filters to their original positions in the cleaner.

## **REMOVING A BLOCKAGE FROM THE SYSTEM**

If there is a noticeable drop in performance see the following 2 points:

- 1) Check if the Ecobox is full (If so refer to chapter "Emptying The Ecobox").
- 2) If not full then:
  - a) Have you cleaned the Ecobox and filters recently? If not please refer to the chapters "Cleaning The Ecobox" and "Filters Maintenance".
  - b) Check if there is any other blockage in the system.
    - Use a rod or pole to remove any blockage from the tubes and flexible hose.
    - It may also be possible to remove an obstruction in the flexible hose by lightly squeezing or bending it.
    - Check and clean if required the underside of the nozzle by using the crevice tool.

## **SIMPLE USER CHECK LIST BEFORE CALLING FOR SERVICE**

- 1) Is there a working electricity supply to the cleaner? Check with another appliance.
- 2) Is there a restriction?
  - a) Is the Ecobox full? Please refer to chapter "Emptying The Ecobox".
  - b) Are the filters or Ecobox blocked? Please refer to chapter "Filters Maintenance" or "Cleaning The Ecobox".
  - c) Is the hose or nozzle blocked? Please refer to chapter "Removing A Blockage from The System".
- 3) Has the cleaner automatically switched off? In this case the Overheating Protection has been activated. Please refer to chapter "Features", paragraph "Overheating Protection".

Please remember that:

- 1) Some carpets can cause a small build up of static electricity. Any static discharge is not hazardous to health or the product.
- 2) A service charge will be made if the cleaner is examined and found in working order, has not been assembled in accordance with these instructions, or has been misused.

## Do

- Call Hoover Customer Help Line 08705 400 600 in the event of dissatisfaction
- Ensure that all service and repairs are carried out by an authorised Hoover Service Engineer
- Only use genuine Hoover parts
- Empty the Ecobox regularly. Best after each use
- Always switch off and remove the power plug from the electricity supply after use and before cleaning the appliance or attempting user maintenance as described in these instructions

Remember: Electricity can be dangerous

## DO NOT

- Position the cleaner above you when cleaning stairs
- Use cleaner without the Ecobox correctly fitted
- Use your cleaner out of doors, on wet surfaces or for wet pick up
- Pick up matches, hot ash, cigarette ends or anything that may damage the product
- Spray with or pick up flammable liquids, cleaning fluids, aerosols or their vapours as this may cause risk of fire/explosion
- Run over, stand on, or wrap the power cord around arms or legs when using your cleaner
- Continue to use your cleaner if it or the plug/power cord appears to be faulty or damaged. To avoid safety hazards the cleaner must only be repaired by an authorised Hoover Service Engineer
- Recharge batteries, dispose of in fire or dissect - danger of explosion

**ACCESSORIES:** For accessories please quote the following pack numbers

- Turbo Nozzle pack No. J19 0484 5046
- Caresse Nozzle pack No. G50 0484 5044

### Guarantee Statement

The guarantee conditions for this appliance are as defined by our representative in the country in which it is sold. Details regarding these conditions can be obtained from the dealer from whom the appliance was purchased.

The bill of sale or receipt must be produced when making any claim under the terms of this guarantee.

Subject to change without notice.

GIAS Customer service 08705 400500

Hoover spares 01204 556111

BSI

ISO9002

BEAB Approved

**Quality:** Our UK factories meet the strict quality standards of the British Standards Institution (BSI).

**Safety:** We gain independent approval from BEAB to demonstrate that our domestic electrical appliances are safe.

BEAB - the British Electrotechnical Approvals Board - ensures that European safety standards are met and maintained throughout the production life of an appliance.



Hoover Limited  
Pentrebach  
Merthyr Tydfil  
Mid-Glamorgan  
CF48 4TU

**Part No: 05655118**

## IMPORTANT SAFETY REMINDERS

This cleaner should only be used for domestic cleaning as described in these instructions. Please ensure that these are fully understood before operating the appliance. This product is double insulated and must not be earthed.

**Important:** The wires in the power cord are coloured in accordance with the following code:

**Blue - Neutral      Brown - Live**

13 Amp fused plug on UK versions only.

## GETTING STARTED

By following this step-by-step guide your new Sensory Ecobox system will be ready for use:

- Remove cleaner and accessories from packaging. Please dispose of the packaging in a safe and environmentally conscientious way.
- Open the top cover (A) ensuring that the Ecobox, Ecobox lid (B1), pre-motor filter (B2) and exhaust filter (B3) are fitted correctly. Close the top cover.
- Insert the hose end into the top cover, ensuring it clips and locks into position (C). To release simply press in the two hose end latches and pull.
- Fix the free end of the hose into the handle using the lock ring (D).
- Fit extension tubes (E1), floor nozzle (E2), or other accessories as required for use.
- Your Sensory Ecobox is now ready for use. Extract the plug and pull out all of the cord. Plug in and switch on.

## FEATURES - DEPENDING ON MODEL,

- Hoovers unique Ecobox is made from a special porous plastic material which allows air to pass through whilst retaining most of the dirt and fine dust.
- **On/Off button (F).** Once plugged in, press this button to start the cleaner. Press it again to stop the cleaner before removing the plug after use.
- **Cord rewind button (G).** Remove the plug from the power supply. Press this button to wind the power cord back into the cleaner.
- **Overheating Protection.** Cleaner automatically switches off. In this event extract the plug from the socket and allow cleaner to cool for 30 minutes. Check if the Ecobox needs cleaning or if there is a blockage in the system (see chapter: "Cleaning The Ecobox" and "Removing A Blockage From The System").
- **Fixed power control (depending on model).** Adjust the suction by moving the handle valve (H): suction will decrease when opening the valve. Use low suction for delicate fabrics.
- **Variable power control (I) (depending on model).** Rotate the on/off button to increase or decrease suction. Use low suction for delicate fabrics.
- **Carpet and floor nozzle (J).** Press pedal on the nozzle to lower the brushes when cleaning hard floors. Press the pedal again to lift the brushes when cleaning carpets.

**NO**

- **Turbo nozzle (depending on model).** Use the Turbo nozzle for deep cleaning on carpets. **IMPORTANT:** do not use Turbo nozzle on rugs with long fringes, animal hide and over carpet piles with a depth exceeding 15 mm. Do not keep the nozzle stationary while the brush is rotating. Also available as an additional accessory. Order Pack No. J19 0484 5046.
- **Caresse nozzle (depending on model).** Designed for use on wooden or any delicate floors. Also available as an additional accessory. Order Pack No. G50 0484 5044.
- **Multi function tool.** Tool is stored on the handle (E1). Remove tool and use as:
  - a) Crevice tool: for corners and hard to reach areas (K1).
  - b) Furniture nozzle: for soft furnishings and fabrics (K2).
  - c) Dusting brush (depending on model): for bookshelves, frames, keyboards etc. (K2).
- **Tube Parking and Storage (L).** The tubes can be parked at the rear of the cleaner or stored into the storage slot underneath the cleaner.

## EMPTYING THE ECOBOX

Check and empty the Ecobox regularly, best after each use.

- Extract the Ecobox (M).
- Use the handle to carry the Ecobox to the dustbin (N).
- Press the latch to remove the cover from the Ecobox as shown (O).
- Grip the Ecobox firmly and tip the contents into the dustbin. Shake the Ecobox if required or use a brush to remove any of the remaining dust or debris (P).
- Wash the Ecobox regularly. See chapter "Cleaning The Ecobox".
- To close the Ecobox locate the cover rear guides into the container recess then close firmly (Q).
- Return the Ecobox back to its original position in the cleaner.

## CLEANING THE ECOBOX

To maintain the best performance, we would recommend that you **wash the Ecobox every month** removing even the finest dust retained in it. To wash and optimise the performance the following simple steps should be taken:

- Shake out the Ecobox to remove large dirt and debris (P) as described in "Emptying The Ecobox".
- Brush the inside of the Ecobox to remove the fine dust that may have formed on the walls of the Ecobox (R).
- Wash the inside and outside of the Ecobox thoroughly using warm water and washing up liquid. At this point if desired, the Ecobox can be placed in a dishwasher and washed on a full wash and dry cycle at up to 75°C (S).
- If not placed in a dishwasher rinse thoroughly inside and outside making sure no detergent is left on the Ecobox (T).

**NO**

- Remove excess water with a dry cloth and leave to air dry for 24 hours or until fully dry (U).
- After completing the washing and drying operations, locate the cover rear guides into the container recess then close firmly. Return the Ecobox to its original position in the cleaner. (Q)

## **FILTERS MAINTENANCE**

- To maintain best performance we recommend that you wash the filters every month.
- To access the filters please refer to diagram (B1, 2, 3).
- Rinse both filters under hand warm water (V and W).
- Do not scrub the filters, use washing up liquid or place in a dishwasher.
- Remove excess water with a dry cloth and leave to air dry for 24 hours or until fully dry (X).
- After completing the washing and drying operations, return the filters to their original positions in the cleaner.

## **REMOVING A BLOCKAGE FROM THE SYSTEM**

If there is a noticeable drop in performance see the following 2 points:

- 1) Check if the Ecobox is full (If so refer to chapter "Emptying The Ecobox").
- 2) If not full then:
  - a) Have you cleaned the Ecobox and filters recently? If not please refer to the chapters "Cleaning The Ecobox" and "Filters Maintenance".
  - b) Check if there is any other blockage in the system.
    - Use a rod or pole to remove any blockage from the tubes and flexible hose.
    - It may also be possible to remove an obstruction in the flexible hose by lightly squeezing or bending it.
    - Check and clean if required the underside of the nozzle by using the crevice tool.

## **SIMPLE USER CHECK LIST BEFORE CALLING FOR SERVICE**

- 1) Is there a working electricity supply to the cleaner? Check with another appliance.
- 2) Is there a restriction?
  - a) Is the Ecobox full? Please refer to chapter "Emptying The Ecobox".
  - b) Are the filters or Ecobox blocked? Please refer to chapter "Filters Maintenance" or "Cleaning The Ecobox".
  - c) Is the hose or nozzle blocked? Please refer to chapter "Removing A Blockage from The System".
- 3) Has the cleaner automatically switched off? In this case the Overheating Protection has been activated. Please refer to chapter "Features", paragraph "Overheating Protection".

**NO**

Please remember that:

- 1) Some carpets can cause a small build up of static electricity. Any static discharge is not hazardous to health or the product.
- 2) A service charge will be made if the cleaner is examined and found in working order, has not been assembled in accordance with these instructions, or has been misused.

**Do**

- Call Hoover Customer Help Line 08705 400 600 in the event of dissatisfaction
- Ensure that all service and repairs are carried out by an authorised Hoover Service Engineer
- Only use genuine Hoover parts
- Empty the Ecobox regularly. Best after each use
- Always switch off and remove the power plug from the electricity supply after use and before cleaning the appliance or attempting user maintenance as described in these instructions

Remember: Electricity can be dangerous

**DO NOT**

- Position the cleaner above you when cleaning stairs
- Use cleaner without the Ecobox correctly fitted
- Use your cleaner out of doors, on wet surfaces or for wet pick up
- Pick up matches, hot ash, cigarette ends or anything that may damage the product
- Spray with or pick up flammable liquids, cleaning fluids, aerosols or their vapours as this may cause risk of fire/explosion
- Run over, stand on, or wrap the power cord around arms or legs when using your cleaner
- Continue to use your cleaner if it or the plug/power cord appears to be faulty or damaged. To avoid safety hazards the cleaner must only be repaired by an authorised Hoover Service Engineer
- Recharge batteries, dispose of in fire or dissect - danger of explosion

**ACCESSORIES:** For accessories please quote the following pack numbers

- Turbo Nozzle pack No. J19 0484 5046
- Caresse Nozzle pack No. G50 0484 5044

**Guarantee Statement**

The guarantee conditions for this appliance are as defined by our representative in the country in which it is sold. Details regarding these conditions can be obtained from the dealer from whom the appliance was purchased.

The bill of sale or receipt must be produced when making any claim under the terms of this guarantee.

Subject to change without notice.

GIAS Customer service 08705 400500

Hoover spares 01204 556111

**BSI****ISO9002****BEAB Approved**

Hoover Limited  
Pentrebach  
Merthyr Tydfil  
Mid-Glamorgan  
CF48 4TU

**Quality:** Our UK factories meet the strict quality standards of the British Standards Institution (BSI).

**Safety:** We gain independent approval from BEAB to demonstrate that our domestic electrical appliances are safe.

BEAB - the British Electrotechnical Approvals Board - ensures that European safety standards are met and maintained throughout the production life of an appliance.

**Part No: 05655118**



## IMPORTANT SAFETY REMINDERS

This cleaner should only be used for domestic cleaning as described in these instructions. Please ensure that these are fully understood before operating the appliance. This product is double insulated and must not be earthed.

**Important:** The wires in the power cord are coloured in accordance with the following code:

**Blue - Neutral**      **Brown - Live**  
13 Amp fused plug on UK versions only.

## GETTING STARTED

By following this step-by-step guide your new Sensory Ecobox system will be ready for use:

- Remove cleaner and accessories from packaging. Please dispose of the packaging in a safe and environmentally conscientious way.
- Open the top cover (A) ensuring that the Ecobox, Ecobox lid (B1), pre-motor filter (B2) and exhaust filter (B3) are fitted correctly. Close the top cover.
- Insert the hose end into the top cover, ensuring it clips and locks into position (C). To release simply press in the two hose end latches and pull.
- Fix the free end of the hose into the handle using the lock ring (D).
- Fit extension tubes (E1), floor nozzle (E2), or other accessories as required for use.
- Your Sensory Ecobox is now ready for use. Extract the plug and pull out all of the cord. Plug in and switch on.

## FEATURES - DEPENDING ON MODEL,

- Hoovers unique Ecobox is made from a special porous plastic material which allows air to pass through whilst retaining most of the dirt and fine dust.
- **On/Off button (F).** Once plugged in, press this button to start the cleaner. Press it again to stop the cleaner before removing the plug after use.
- **Cord rewind button (G).** Remove the plug from the power supply. Press this button to wind the power cord back into the cleaner.
- **Overheating Protection.** Cleaner automatically switches off. In this event extract the plug from the socket and allow cleaner to cool for 30 minutes. Check if the Ecobox needs cleaning or if there is a blockage in the system (see chapter: "Cleaning The Ecobox" and "Removing A Blockage From The System").
- **Fixed power control (depending on model).** Adjust the suction by moving the handle valve (H): suction will decrease when opening the valve. Use low suction for delicate fabrics.
- **Variable power control (I) (depending on model).** Rotate the on/off button to increase or decrease suction. Use low suction for delicate fabrics.
- **Carpet and floor nozzle (J).** Press pedal on the nozzle to lower the brushes when cleaning hard floors. Press the pedal again to lift the brushes when cleaning carpets.

- **Turbo nozzle (depending on model).** Use the Turbo nozzle for deep cleaning on carpets. **IMPORTANT:** do not use Turbo nozzle on rugs with long fringes, animal hide and over carpet piles with a depth exceeding 15 mm. Do not keep the nozzle stationary while the brush is rotating. Also available as an additional accessory. Order Pack No. J19 0484 5046.
- **Caresse nozzle (depending on model).** Designed for use on wooden or any delicate floors. Also available as an additional accessory. Order Pack No. G50 0484 5044.
- **Multi function tool.** Tool is stored on the handle (E1). Remove tool and use as:
  - a) Crevice tool: for corners and hard to reach areas (K1).
  - b) Furniture nozzle: for soft furnishings and fabrics (K2).
  - c) Dusting brush (depending on model): for bookshelves, frames, keyboards etc. (K2).
- **Tube Parking and Storage (L).** The tubes can be parked at the rear of the cleaner or stored into the storage slot underneath the cleaner.

## EMPTYING THE ECOBOX

Check and empty the Ecobox regularly, best after each use.

- Extract the Ecobox (M).
- Use the handle to carry the Ecobox to the dustbin (N).
- Press the latch to remove the cover from the Ecobox as shown (O).
- Grip the Ecobox firmly and tip the contents into the dustbin. Shake the Ecobox if required or use a brush to remove any of the remaining dust or debris (P).
- Wash the Ecobox regularly. See chapter "Cleaning The Ecobox".
- To close the Ecobox locate the cover rear guides into the container recess then close firmly (Q).
- Return the Ecobox back to its original position in the cleaner.

## CLEANING THE ECOBOX

To maintain the best performance, we would recommend that you **wash the Ecobox every month** removing even the finest dust retained in it. To wash and optimise the performance the following simple steps should be taken:

- Shake out the Ecobox to remove large dirt and debris (P) as described in "Emptying The Ecobox".
- Brush the inside of the Ecobox to remove the fine dust that may have formed on the walls of the Ecobox (R).
- Wash the inside and outside of the Ecobox thoroughly using warm water and washing up liquid. At this point if desired, the Ecobox can be placed in a dishwasher and washed on a full wash and dry cycle at up to 75°C (S).
- If not placed in a dishwasher rinse thoroughly inside and outside making sure no detergent is left on the Ecobox (T).

- Remove excess water with a dry cloth and leave to air dry for 24 hours or until fully dry (U).
- After completing the washing and drying operations, locate the cover rear guides into the container recess then close firmly. Return the Ecobox to its original position in the cleaner. (Q)

## **FILTERS MAINTENANCE**

- To maintain best performance we recommend that you wash the filters every month.
- To access the filters please refer to diagram (B1, 2, 3).
- Rinse both filters under hand warm water (V and W).
- Do not scrub the filters, use washing up liquid or place in a dishwasher.
- Remove excess water with a dry cloth and leave to air dry for 24 hours or until fully dry (X).
- After completing the washing and drying operations, return the filters to their original positions in the cleaner.

## **REMOVING A BLOCKAGE FROM THE SYSTEM**

If there is a noticeable drop in performance see the following 2 points:

- 1) Check if the Ecobox is full (If so refer to chapter "Emptying The Ecobox").
- 2) If not full then:
  - a) Have you cleaned the Ecobox and filters recently? If not please refer to the chapters "Cleaning The Ecobox" and "Filters Maintenance".
  - b) Check if there is any other blockage in the system.
    - Use a rod or pole to remove any blockage from the tubes and flexible hose.
    - It may also be possible to remove an obstruction in the flexible hose by lightly squeezing or bending it.
    - Check and clean if required the underside of the nozzle by using the crevice tool.

## **SIMPLE USER CHECK LIST BEFORE CALLING FOR SERVICE**

- 1) Is there a working electricity supply to the cleaner? Check with another appliance.
- 2) Is there a restriction?
  - a) Is the Ecobox full? Please refer to chapter "Emptying The Ecobox".
  - b) Are the filters or Ecobox blocked? Please refer to chapter "Filters Maintenance" or "Cleaning The Ecobox".
  - c) Is the hose or nozzle blocked? Please refer to chapter "Removing A Blockage from The System".
- 3) Has the cleaner automatically switched off? In this case the Overheating Protection has been activated. Please refer to chapter "Features", paragraph "Overheating Protection".



Please remember that:

- 1) Some carpets can cause a small build up of static electricity. Any static discharge is not hazardous to health or the product.
- 2) A service charge will be made if the cleaner is examined and found in working order, has not been assembled in accordance with these instructions, or has been misused.

## Do

- Call Hoover Customer Help Line 08705 400 600 in the event of dissatisfaction
- Ensure that all service and repairs are carried out by an authorised Hoover Service Engineer
- Only use genuine Hoover parts
- Empty the Ecobox regularly. Best after each use
- Always switch off and remove the power plug from the electricity supply after use and before cleaning the appliance or attempting user maintenance as described in these instructions

Remember: Electricity can be dangerous

## DO NOT

- Position the cleaner above you when cleaning stairs
- Use cleaner without the Ecobox correctly fitted
- Use your cleaner out of doors, on wet surfaces or for wet pick up
- Pick up matches, hot ash, cigarette ends or anything that may damage the product
- Spray with or pick up flammable liquids, cleaning fluids, aerosols or their vapours as this may cause risk of fire/explosion
- Run over, stand on, or wrap the power cord around arms or legs when using your cleaner
- Continue to use your cleaner if it or the plug/power cord appears to be faulty or damaged. To avoid safety hazards the cleaner must only be repaired by an authorised Hoover Service Engineer
- Recharge batteries, dispose of in fire or dissect - danger of explosion

**ACCESSORIES:** For accessories please quote the following pack numbers

- Turbo Nozzle pack No. J19 0484 5046
- Caresse Nozzle pack No. G50 0484 5044

### Guarantee Statement

The guarantee conditions for this appliance are as defined by our representative in the country in which it is sold. Details regarding these conditions can be obtained from the dealer from whom the appliance was purchased.

The bill of sale or receipt must be produced when making any claim under the terms of this guarantee.

Subject to change without notice.

GIAS Customer service 08705 400500

Hoover spares 01204 556111

BSI

ISO9002

BEAB Approved

**Quality:** Our UK factories meet the strict quality standards of the British Standards Institution (BSI).

**Safety:** We gain independent approval from BEAB to demonstrate that our domestic electrical appliances are safe.

BEAB - the British Electrotechnical Approvals Board - ensures that European safety standards are met and maintained throughout the production life of an appliance.



Hoover Limited  
Pentrebach  
Merthyr Tydfil  
Mid-Glamorgan  
CF48 4TU

**Part No: 05655118**

## IMPORTANT SAFETY REMINDERS

This cleaner should only be used for domestic cleaning as described in these instructions. Please ensure that these are fully understood before operating the appliance. This product is double insulated and must not be earthed.

**Important:** The wires in the power cord are coloured in accordance with the following code:

**Blue - Neutral**      **Brown - Live**

13 Amp fused plug on UK versions only.

## GETTING STARTED

By following this step-by-step guide your new Sensory Ecobox system will be ready for use:

- Remove cleaner and accessories from packaging. Please dispose of the packaging in a safe and environmentally conscientious way.
- Open the top cover (A) ensuring that the Ecobox, Ecobox lid (B1), pre-motor filter (B2) and exhaust filter (B3) are fitted correctly. Close the top cover.
- Insert the hose end into the top cover, ensuring it clips and locks into position (C). To release simply press in the two hose end latches and pull.
- Fix the free end of the hose into the handle using the lock ring (D).
- Fit extension tubes (E1), floor nozzle (E2), or other accessories as required for use.
- Your Sensory Ecobox is now ready for use. Extract the plug and pull out all of the cord. Plug in and switch on.

## FEATURES - DEPENDING ON MODEL,

- Hoovers unique Ecobox is made from a special porous plastic material which allows air to pass through whilst retaining most of the dirt and fine dust.
- **On/Off button (F).** Once plugged in, press this button to start the cleaner. Press it again to stop the cleaner before removing the plug after use.
- **Cord rewind button (G).** Remove the plug from the power supply. Press this button to wind the power cord back into the cleaner.
- **Overheating Protection.** Cleaner automatically switches off. In this event extract the plug from the socket and allow cleaner to cool for 30 minutes. Check if the Ecobox needs cleaning or if there is a blockage in the system (see chapter: "Cleaning The Ecobox" and "Removing A Blockage From The System").
- **Fixed power control (depending on model).** Adjust the suction by moving the handle valve (H): suction will decrease when opening the valve. Use low suction for delicate fabrics.
- **Variable power control (I) (depending on model).** Rotate the on/off button to increase or decrease suction. Use low suction for delicate fabrics.
- **Carpet and floor nozzle (J).** Press pedal on the nozzle to lower the brushes when cleaning hard floors. Press the pedal again to lift the brushes when cleaning carpets.

- **Turbo nozzle (depending on model).** Use the Turbo nozzle for deep cleaning on carpets. **IMPORTANT:** do not use Turbo nozzle on rugs with long fringes, animal hide and over carpet piles with a depth exceeding 15 mm. Do not keep the nozzle stationary while the brush is rotating. Also available as an additional accessory. Order Pack No. J19 0484 5046.
- **Caresse nozzle (depending on model).** Designed for use on wooden or any delicate floors. Also available as an additional accessory. Order Pack No. G50 0484 5044.
- **Multi function tool.** Tool is stored on the handle (E1). Remove tool and use as:
  - a) Crevice tool: for corners and hard to reach areas (K1).
  - b) Furniture nozzle: for soft furnishings and fabrics (K2).
  - c) Dusting brush (depending on model): for bookshelves, frames, keyboards etc. (K2).
- **Tube Parking and Storage (L).** The tubes can be parked at the rear of the cleaner or stored into the storage slot underneath the cleaner.

## EMPTYING THE ECOBOX

Check and empty the Ecobox regularly, best after each use.

- Extract the Ecobox (M).
- Use the handle to carry the Ecobox to the dustbin (N).
- Press the latch to remove the cover from the Ecobox as shown (O).
- Grip the Ecobox firmly and tip the contents into the dustbin. Shake the Ecobox if required or use a brush to remove any of the remaining dust or debris (P).
- Wash the Ecobox regularly. See chapter "Cleaning The Ecobox".
- To close the Ecobox locate the cover rear guides into the container recess then close firmly (Q).
- Return the Ecobox back to its original position in the cleaner.

## CLEANING THE ECOBOX

To maintain the best performance, we would recommend that you **wash the Ecobox every month** removing even the finest dust retained in it. To wash and optimise the performance the following simple steps should be taken:

- Shake out the Ecobox to remove large dirt and debris (P) as described in "Emptying The Ecobox".
- Brush the inside of the Ecobox to remove the fine dust that may have formed on the walls of the Ecobox (R).
- Wash the inside and outside of the Ecobox thoroughly using warm water and washing up liquid. At this point if desired, the Ecobox can be placed in a dishwasher and washed on a full wash and dry cycle at up to 75°C (S).
- If not placed in a dishwasher rinse thoroughly inside and outside making sure no detergent is left on the Ecobox (T).

- Remove excess water with a dry cloth and leave to air dry for 24 hours or until fully dry (U).
- After completing the washing and drying operations, locate the cover rear guides into the container recess then close firmly. Return the Ecobox to its original position in the cleaner. (Q)

## **FILTERS MAINTENANCE**

- To maintain best performance we recommend that you wash the filters every month.
- To access the filters please refer to diagram (B1, 2, 3).
- Rinse both filters under hand warm water (V and W).
- Do not scrub the filters, use washing up liquid or place in a dishwasher.
- Remove excess water with a dry cloth and leave to air dry for 24 hours or until fully dry (X).
- After completing the washing and drying operations, return the filters to their original positions in the cleaner.

## **REMOVING A BLOCKAGE FROM THE SYSTEM**

If there is a noticeable drop in performance see the following 2 points:

- 1) Check if the Ecobox is full (If so refer to chapter "Emptying The Ecobox").
- 2) If not full then:
  - a) Have you cleaned the Ecobox and filters recently? If not please refer to the chapters "Cleaning The Ecobox" and "Filters Maintenance".
  - b) Check if there is any other blockage in the system.
    - Use a rod or pole to remove any blockage from the tubes and flexible hose.
    - It may also be possible to remove an obstruction in the flexible hose by lightly squeezing or bending it.
    - Check and clean if required the underside of the nozzle by using the crevice tool.

## **SIMPLE USER CHECK LIST BEFORE CALLING FOR SERVICE**

- 1) Is there a working electricity supply to the cleaner? Check with another appliance.
- 2) Is there a restriction?
  - a) Is the Ecobox full? Please refer to chapter "Emptying The Ecobox".
  - b) Are the filters or Ecobox blocked? Please refer to chapter "Filters Maintenance" or "Cleaning The Ecobox".
  - c) Is the hose or nozzle blocked? Please refer to chapter "Removing A Blockage from The System".
- 3) Has the cleaner automatically switched off? In this case the Overheating Protection has been activated. Please refer to chapter "Features", paragraph "Overheating Protection".

Please remember that:

- 1) Some carpets can cause a small build up of static electricity. Any static discharge is not hazardous to health or the product.
- 2) A service charge will be made if the cleaner is examined and found in working order, has not been assembled in accordance with these instructions, or has been misused.

## Do

- Call Hoover Customer Help Line 08705 400 600 in the event of dissatisfaction
- Ensure that all service and repairs are carried out by an authorised Hoover Service Engineer
- Only use genuine Hoover parts
- Empty the Ecobox regularly. Best after each use
- Always switch off and remove the power plug from the electricity supply after use and before cleaning the appliance or attempting user maintenance as described in these instructions

Remember: Electricity can be dangerous

## DO NOT

- Position the cleaner above you when cleaning stairs
- Use cleaner without the Ecobox correctly fitted
- Use your cleaner out of doors, on wet surfaces or for wet pick up
- Pick up matches, hot ash, cigarette ends or anything that may damage the product
- Spray with or pick up flammable liquids, cleaning fluids, aerosols or their vapours as this may cause risk of fire/explosion
- Run over, stand on, or wrap the power cord around arms or legs when using your cleaner
- Continue to use your cleaner if it or the plug/power cord appears to be faulty or damaged. To avoid safety hazards the cleaner must only be repaired by an authorised Hoover Service Engineer
- Recharge batteries, dispose of in fire or dissect - danger of explosion

ACCESSORIES: For accessories please quote the following pack numbers

- Turbo Nozzle pack No. J19 0484 5046
- Caresse Nozzle pack No. G50 0484 5044

### Guarantee Statement

The guarantee conditions for this appliance are as defined by our representative in the country in which it is sold. Details regarding these conditions can be obtained from the dealer from whom the appliance was purchased.

The bill of sale or receipt must be produced when making any claim under the terms of this guarantee.

Subject to change without notice.

GIAS Customer service 08705 400500

Hoover spares 01204 556111





**Quality:** Our UK factories meet the strict quality standards of the British Standards Institution (BSI).

**Safety:** We gain independent approval from BEAB to demonstrate that our domestic electrical appliances are safe.

BEAB - the British Electrotechnical Approvals Board - ensures that European safety standards are met and maintained throughout the production life of an appliance.



Hoover Limited  
Pentrebach  
Merthyr Tydfil  
Mid-Glamorgan  
CF48 4TU

**Part No: 05655118**