

DOPPIA PORTA	da pag.1 a pag.2	IT
DOUBLE DOOR	page 3 to page 4	GB
DOUBLE PORTE	pages 5 à 6	FR
DOPPELTÜR KÜHLGERÄTE	Seite 7 bis Seite 8	DE
DOS PUERTAS	de pág.9 a pág.10	ES
DUAS PORTAS	da pág. 11 à pág.12	PT
ΔΙΠΛΗ ΠΟΡΤΑ	από σελ. 13 έως σελ. 14	EL
DWUDRZWIOWA	od str. 15 do str.16	PL
KOMBINOVANÁ CHLADNIČKA	od strany 17 do strany 18	CZ
DUBBELE DEUR	pag. 19 t/m pag. 20	NL
KAKSIOVINEN	sivut 21-22	FI
DOBBEL DØR	fra side 23 til side 24	NO
DUBBELDÖRR	från sida 25 till sida 26	SV
TO DØRE	fra s. 27 til s.28	DA

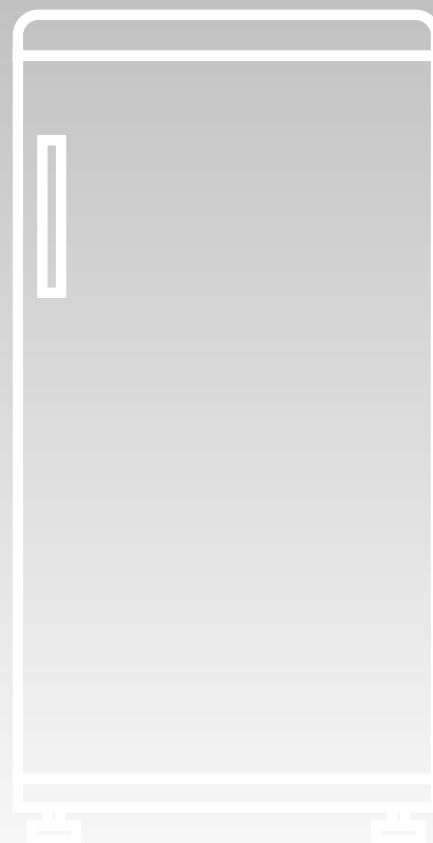

DOPPIA PORTA

QUADRO COMANDI

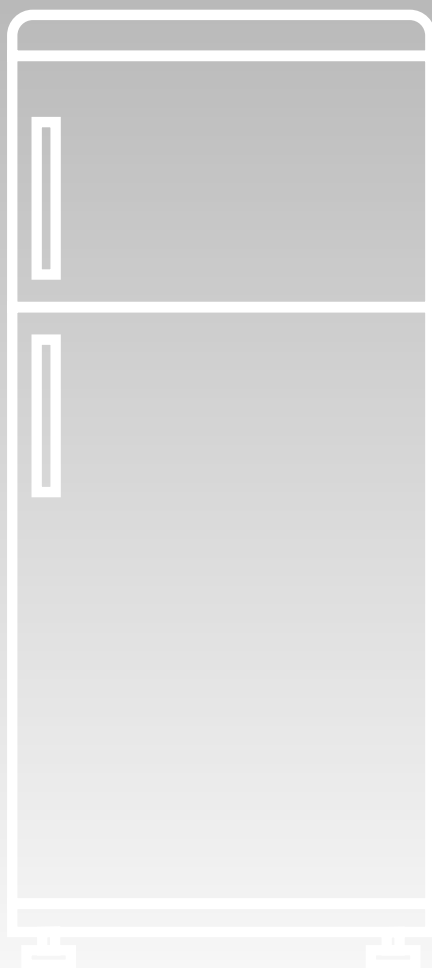
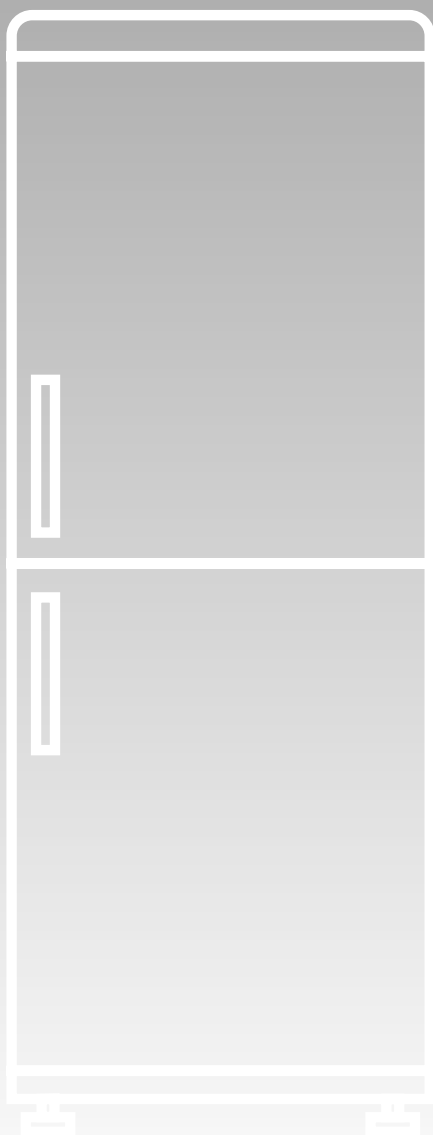
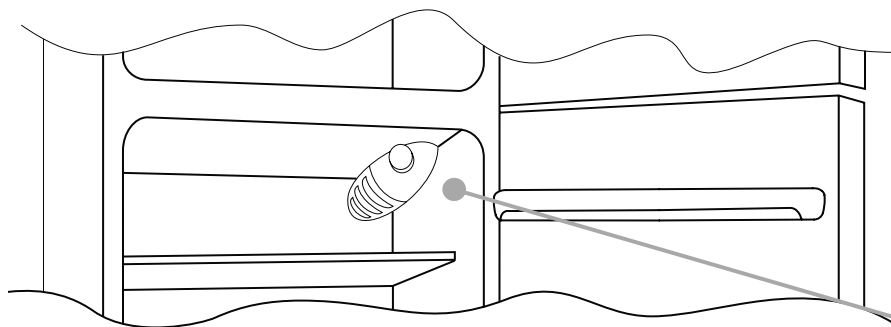

La scatola termostato per il controllo dell'apparecchio è collocata all'interno della cella frigo in alto a destra. Per essere certi che l'apparecchio stia funzionando accertarsi che la manopola termostato non sia sulla posizione „0“.

LO SBRINAMENTO e CONGELAZIONE

La quantità massima di alimenti che è possibile congelare è indicata nella targhetta matricola, (vedi figura 2)

La congelazione è garantita in qualsiasi posizione della manopola.

(Figura 2)

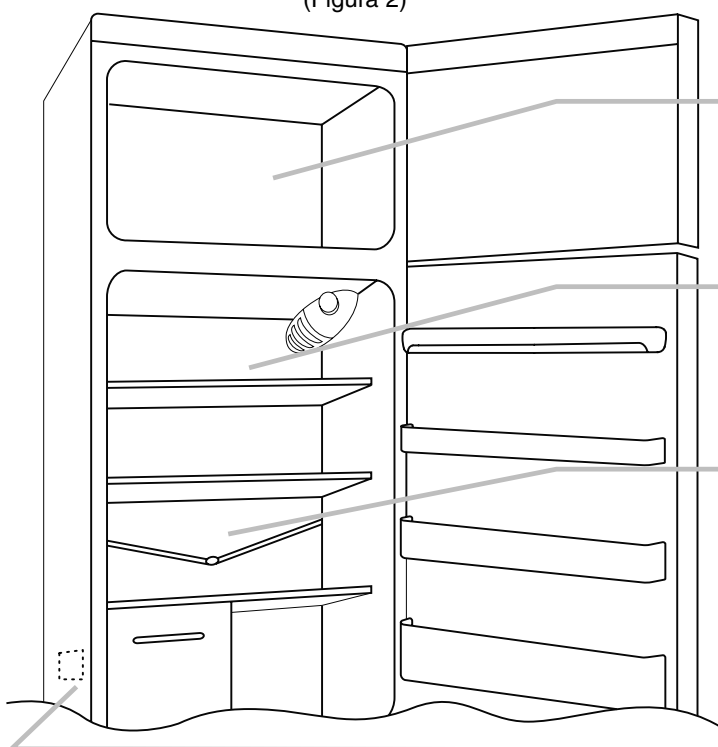

In questo prodotto lo sbrinamento della cella frigo avviene automaticamente

E' consigliabile sbrinare la zona congelatore quando lo strato di ghiaccio supera i 3 mm di spessore

La presenza di un lieve strato di brina o di gocce d'acqua durante il funzionamento è da considerarsi normale

E' importante mantenere sempre pulito il condotto di scarico ed evitare di porre i cibi a contatto con la parete della cella

NB. In questa posizione è possibile trovare la targa matricola, contenente i dati da comunicare all' Assistenza Tecnica qualora si verificasse un guasto.

Importante: In presenza di temperatura ambiente molto calda, l'apparecchio potrebbe funzionare in continuo, con conseguente formazione anomala di brina sulla parete di fondo della cella frigo. In questi casi è necessario ruotare la manopola frigo su numeri più bassi (1-2).

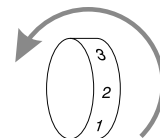

INVERSIONE DEL SENSO DI APERTURA DELLE PORTE

Per invertire il senso di apertura delle porte seguire le indicazioni in relazione al tipo di testata e di cerniera di cui il vostro prodotto è costituito.

A

Sdraiare o inclinare di 45° il frigorifero, per facilitare le operazioni nella parte inferiore dello stesso

1

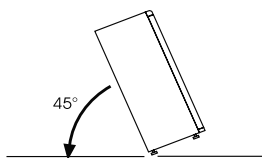

Togliere la cerniera inferiore destra svitando le viti, il perno e le rondelle, quindi togliere la porta inferiore

2

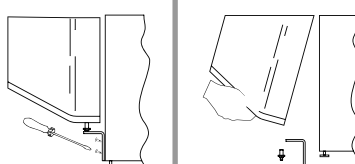

Svitare la vite centrale e togliere la porta superiore

3

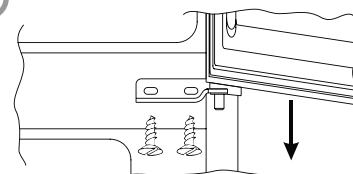

Togliere i tappi (A) e (B), svitare le viti ed estrarre parzialmente il cruscotto.

4

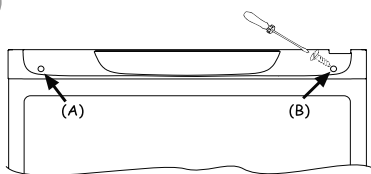

Svitare la cerniera destra

5

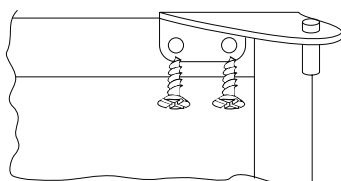

Incidere e rompere l'asola sinistra del cruscotto nella zona dell'impronta

6

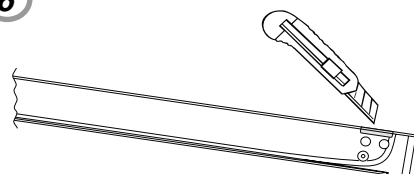

Dalla busta accessori in dotazione, prelevare e fissare la cerniera superiore sinistra

7

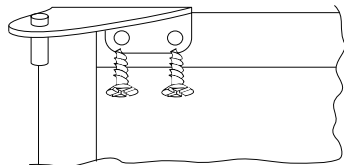

Rimuovere il tappo sulla parte sinistra e inserirlo sulla parte destra delle testatine centrali e inferiore.

8

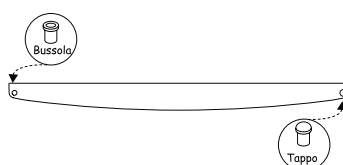

Rimontare le cerniere e le porte operando dal basso verso l'alto, 1 → 2 → 3

9

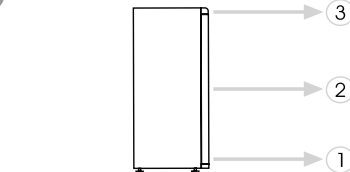

B

Sdraiare o inclinare di 45° il frigorifero, per facilitare le operazioni nella parte inferiore dello stesso

1

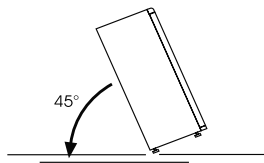

Togliere la cerniera inferiore destra svitando le viti, il perno e le rondelle, quindi togliere la porta inferiore

2

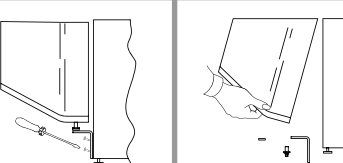

Svitare la cerniera centrale e togliere la porta superiore

3

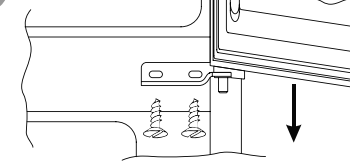

Svitare il fermo dalla porta frigo e montare quello in dotazione sull'altro lato

4

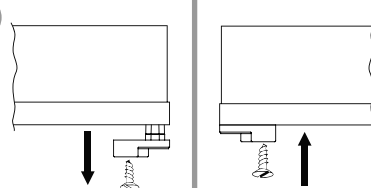

Invertire la posizione del tappo di chiusura della testata

5

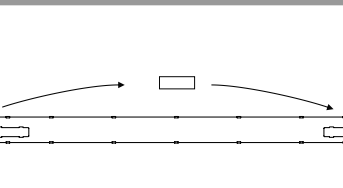

Togliere il tappo di chiusura del cruscotto

6

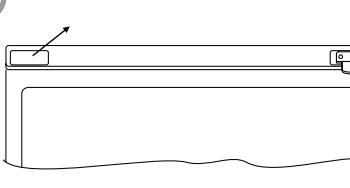

Dalla busta accessori in dotazione, prelevare e fissare la cerniera superiore sinistra

7

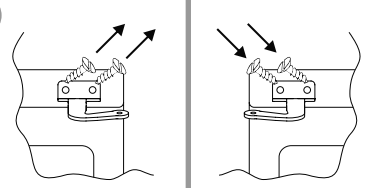

Inserire il perno della cerniera.

8

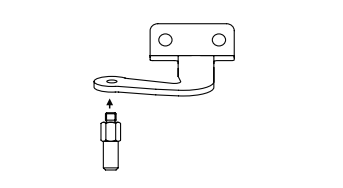

Mettere il tappo di chiusura del cruscotto

9

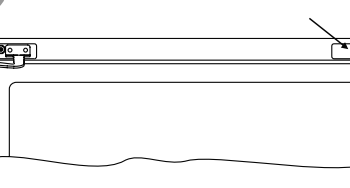

Rimuovere il tappo sulla parte sinistra e inserirlo sulla parte destra delle testatine centrali e inferiore.

10

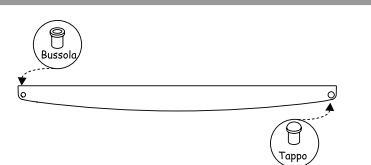

Rimontare le cerniere e le porte operando dal basso verso l'alto. 1 → 2 → 3

11

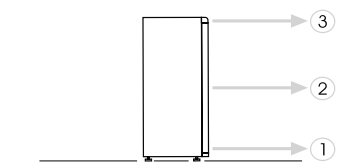

Per effettuare la reversibilità delle maniglie: Togliere i tappini estetici sul lato destro delle porte

12

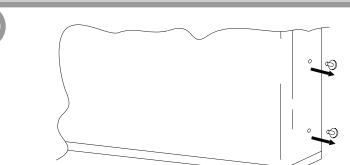

Svitare le maniglie dal lato sinistro e rimontarle sul lato destro del prodotto. Posizionare i tappini sul lato sinistro.

13

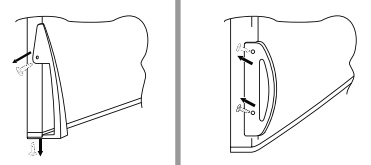

DOUBLE DOOR

CONTROL PANEL

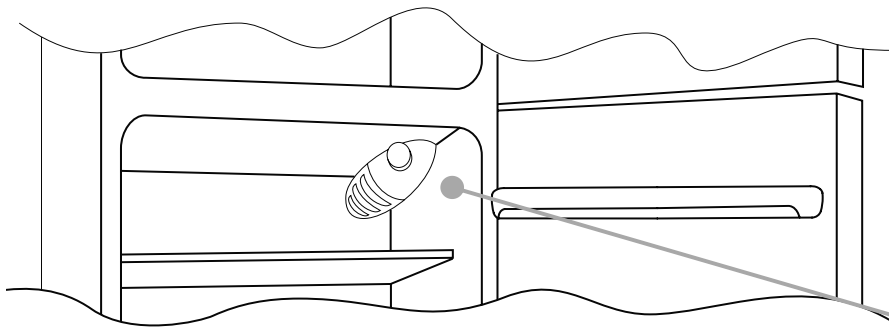

The thermostat box to control the appliance is located inside the fridge compartment on the top right. To check whether the appliance is functioning, make sure that the thermostat knob is not set on „0“.

DEFROSTING and FREEZING

The rating plate states the maximum quantity of foods that can be frozen, (see figure 2). Freezing is guaranteed with any knob setting.

(Figure 2)

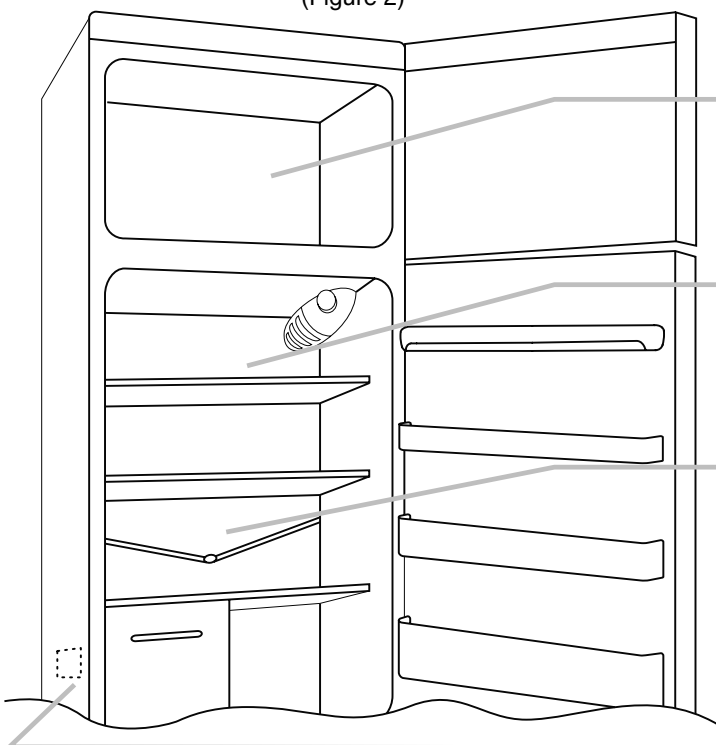

Defrosting of the fridge compartment occurs automatically in this product.

We recommend you defrost the freezer area when the layer of frost is more than 3 mm thick.

A small amount of frost or drops of water on the back of the fridge compartment when the fridge is working is normal

Make sure the water outlet is always clean. Make sure foods do not touch the back or sides of the fridge compartment

NB. This is the rating plate. If you need to contact our Service Department in the event of faults, remember to give them the information on the plate.

Important: If the room temperature is very warm, the appliance may work continuously and a layer of frost will deposit on the back of the fridge compartment. In this case, turn the knob to lower settings (1-2).

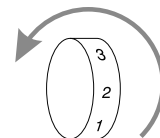

REVERSING THE OPENING OF THE DOORS

In order to reverse the opening of the doors, follow the indications in relation to the insert and hinge type your product is made up of.

A

Place or tilt the fridge at a 45° angle, since it is necessary to work on the bottom of the appliance

1

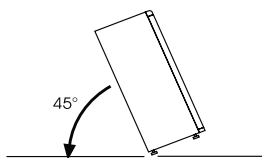

Remove the bottom hinge by removing the screws, the plug and washers, then remove the bottom door

2

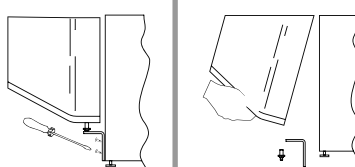

Remove the middle screw and remove the top door

3

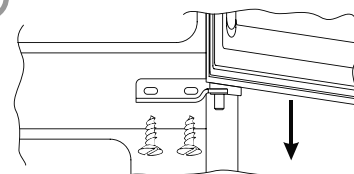

Remove the caps (A) and (B), loosen the screws and partially remove the panel.

4

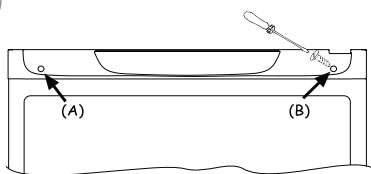

Unscrew the right hinge

5

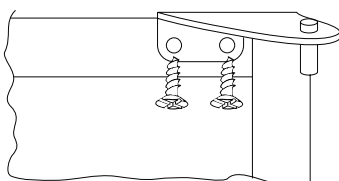

Mark and break the left-hand slot on the panel, in the insert area

6

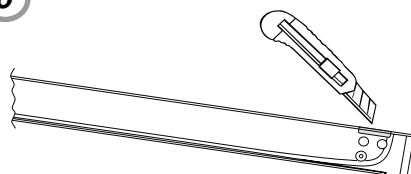

Flip the top left-hand hinge found in the accessories kit

7

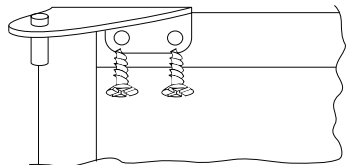

Remove the plug on the left-hand side and insert it on the right hand-side of the central and lower inserts.

8

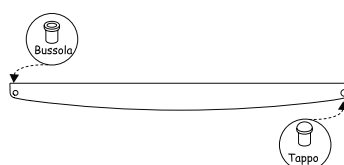

Reassemble the hinges and doors working from bottom to top, 1 → 2 → 3

9

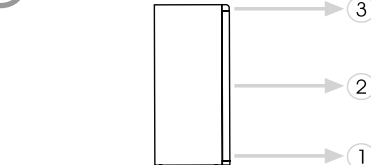

B

Place or tilt the fridge at a 45° angle, since it is necessary to work on the bottom of the appliance

1

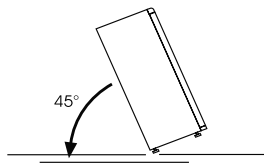

Remove the bottom hinge by removing the screws, the plug and washers, then remove the bottom door.

2

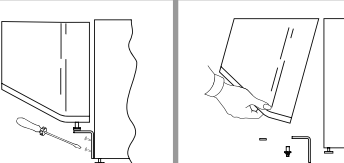

Unscrew the central hinge and remove the top door

3

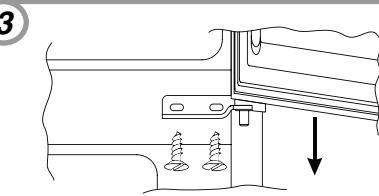

Unscrew the hinge from the fridge door and mount the one supplied on the other side

4

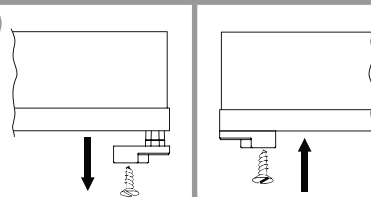

Invert the position of the closure plug of the insert

5

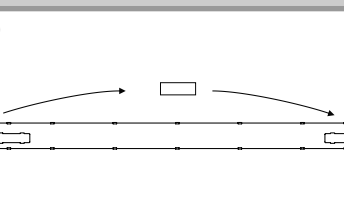

Remove the closure plug of the panel

6

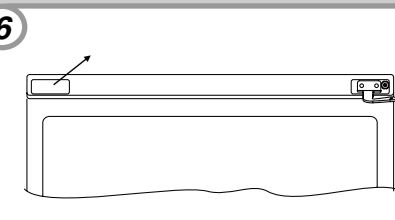

Flip the top left-hand hinge found in the accessories kit

7

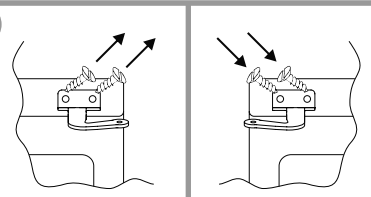

Insert the pin in the hinge.

8

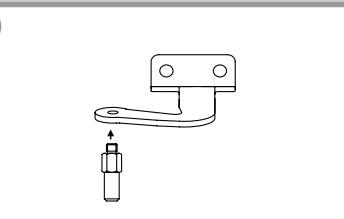

Place the closure plug of the panel

9

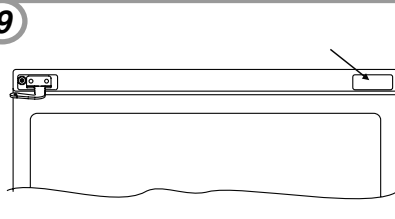

Remove the plug on the left-hand side and insert it on the right hand-side of the central and lower inserts.

10

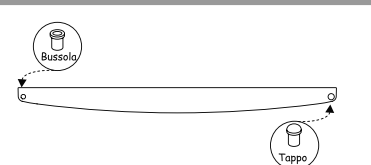

Reassemble the hinges and doors working from bottom to top, 1 → 2 → 3

11

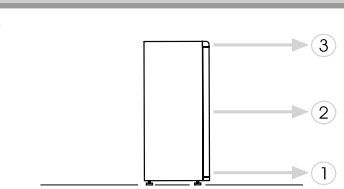

To reverse the handles: Remove the outer caps from the right-hand side of the doors

12



Unscrew the handles from the left hand-side and move them to the right hand-side of the product. Position the outer caps on the left hand-side.

13

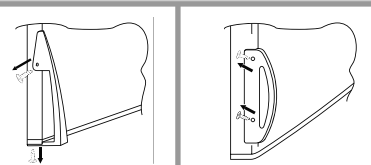

DOUBLE PORTE

PANNEAU DE COMMANDE

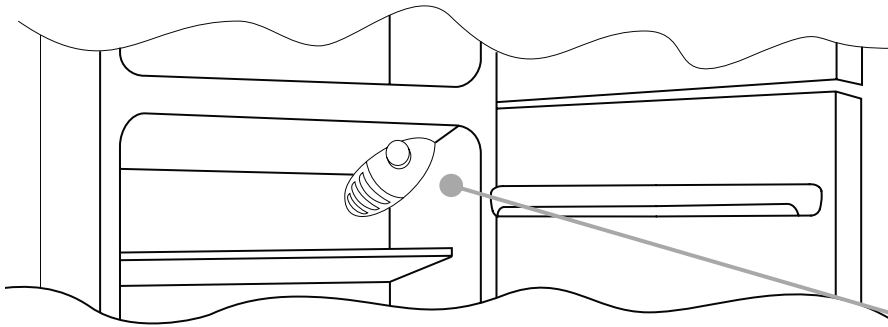

Le thermostat commandant l'appareil se trouve en haut à droite à l'intérieur du réfrigérateur. Pour vérifier que l'appareil fonctionne, assurez-vous que le bouton du thermostat ne se trouve pas en position „0“.

DEGIVRAGE et CONGELATION

La plaque de signalétique indique la quantité d'aliments maximale pouvant être congelée. (voir image 2).
La congélation est garantie peu importe la position du bouton.

(Image 2)



Le dégivrage de la partie réfrigératrice est automatique sur cet appareil.

Nous vous conseillons de dégivrer le congélateur quand la couche de givre atteint 3mm d'épaisseur.

La présence d'une fine pellicule de givre, ou de gouttes d'eau, est normale durant le fonctionnement de.

Assurez-vous de toujours maintenir propre la zone d'évacuation d'eau. Assurez-vous que les aliments ne soient pas en contact avec le fond ou les côtés du réfrigérateur.

NB. Ceci est la plaque d'signalétique. Si vous devez contacter notre service après vente en cas de dysfonctionnement, pensez à fournir les informations figurant sur cette plaque.

Important : Si la température de la pièce est trop élevée, il se peut que l'appareil fonctionne de façon continue et qu'une couche de givre se forme dans le fond du réfrigérateur. Dans ce cas, positionnez le bouton sur les réglages les plus bas. (1-2).

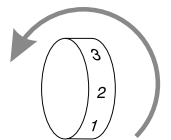

INVERSER LE SENS D'OUVERTURE DES PORTES

Afin d'inverser le sens d'ouverture des portes, suivez les instructions relatives au type de charnière dont votre appareil est équipé.

A

Allongez l'appareil au sol ou à un angle de 45° car il est nécessaire d'intervenir sur le bas de

1

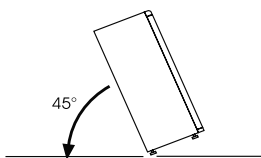

Retirez la charnière du bas en retirant les vis, le cache et les rondelles, puis enlevez la porte du bas.

2

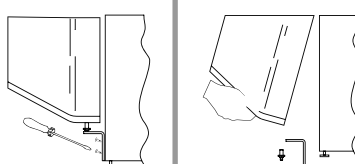

Retirez la vis du milieu et enlevez la porte du haut

3

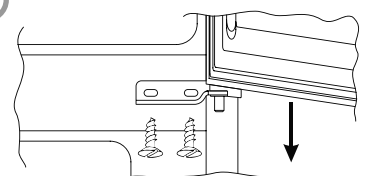

Retirez les caches (A) et (B), desserrez les vis et enlevez partiellement le bandeau.

4

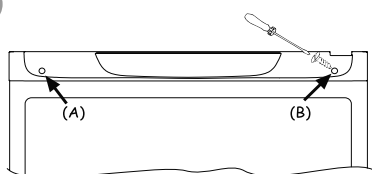

Dévissez la charnière de droite.

5

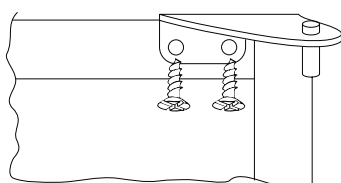

Marquez puis découpez une fente sur le côté gauche du panneau au niveau de la zone d'insertion.

6

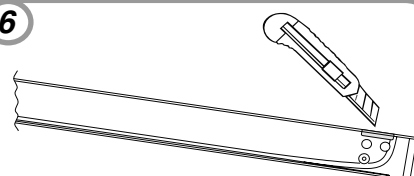

Fixez la charnière supérieure gauche que vous trouverez dans le kit d'accessoires.

7

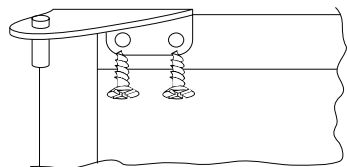

Retirez le cache du côté gauche et insérez-le dans les inserts du milieu et du bas sur le côté droit.

8

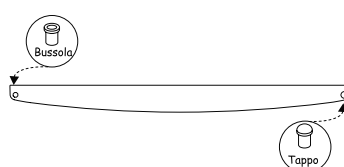

Remontez les charnières et les portes en partant du bas vers le haut, 1 * 2 * 3

9

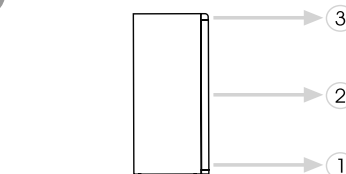

B

Allongez l'appareil au sol ou à un angle de 45° car il est nécessaire d'intervenir sur le bas de l'appareil.

1

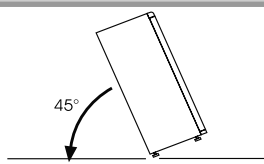

Retirez la charnière du bas en retirant les vis, le cache et les rondelles, puis enlevez la porte du bas.

2

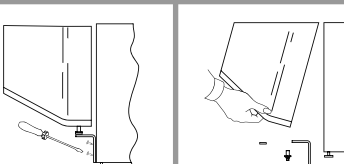

Dévissez la charnière centrale et retirez la porte du haut.

3

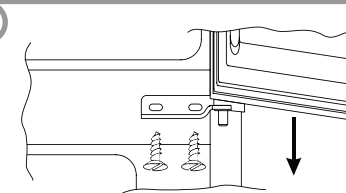

Dévissez la charnière de la porte du réfrigérateur et installez celle fournie de l'autre côté.

4

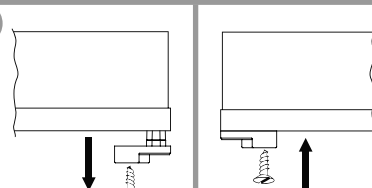

Inversez la position du cache

5

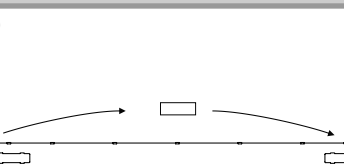

Retirez le cache du panneau

6

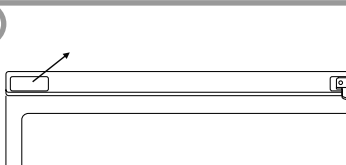

Fixez la charnière supérieure gauche que vous trouverez dans le kit d'accessoires.

7

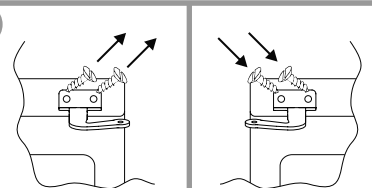

Insérez le goujon dans la charnière.

8

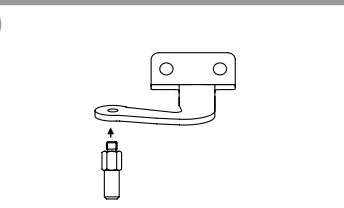

Remontez le cache du panneau

9

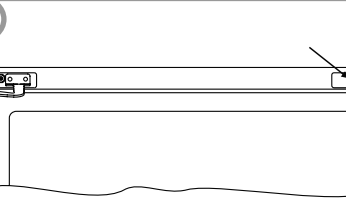

Retirez le cache du côté gauche et insérez-le dans les inserts du milieu et du bas sur le côté droit.

10

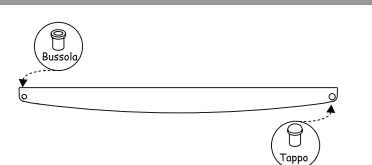

Remontez les charnières et les portes en commençant par le bas. 1 → 2 → 3

11

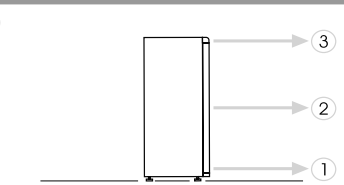

Pour inverser les poignées : Retirez les caches extérieurs sur le côté droit des portes.

12

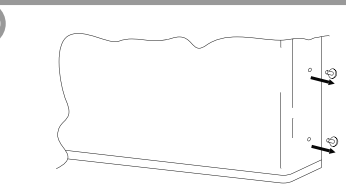

Dévissez les poignées à gauche et déplacez-les à droite de l'appareil. Positionnez les caches extérieurs du côté gauche.

13

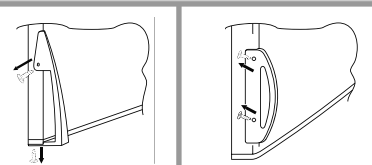

DOPPELTÜRKÜHLGERÄTE

SCHALTBRETT

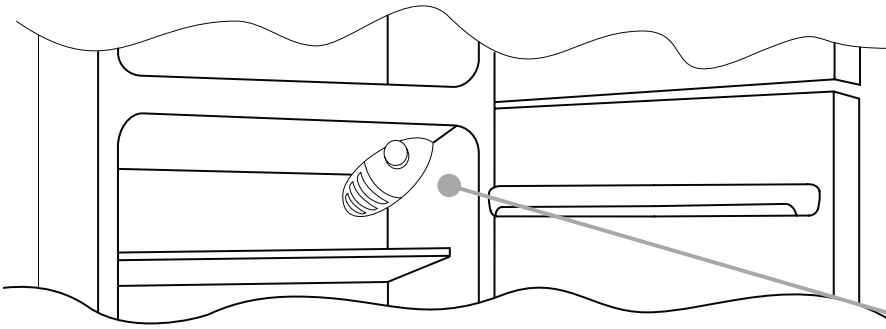

Die Thermostatbox zur Steuerung des Gerätes befindet sich oben rechts im Inneren des Kühlraums. Um zu prüfen, ob das Gerät in Betrieb ist, stellen Sie sicher, dass der Thermostatknopf nicht auf „0“ gestellt ist.

ABTAUEN UND EINFRIEREN

Das Matrikelschild gibt die maximale Anzahl von Nahrungsmitteln an, die eingefroren werden können (siehe Abbildung 2). Einfrieren ist bei jeder Einstellung des Drehknopfes garantiert.

(Abbildung 2)



Das Abtauen des Kühlraums geschieht bei diesem Produkt automatisch.

Wir empfehlen Ihnen, das Gefrierfach abzutauen, wenn die Frostschrift stärker als 3 mm ist.

Beim normalen Betrieb des Kühlschranks entsteht auf der Rückseite des Kühlraums ein wenig Frost oder ein paar Wassertropfen.

Vergewissern Sie sich, dass die Wasserablaufrinne immer sauber ist. Achten Sie darauf, dass die Nahrungsmittel nicht die Rückseite oder die Seitenwände des Kühlschranks berühren.

Hinweis: Hier befindet sich das Matrikelschild. Wenn Sie bei einer Störung den Kundendienst kontaktieren müssen, geben Sie die Informationen auf diesem Schild an.

Wichtiger Hinweis: Wenn die Raumtemperatur sehr warm ist, wird das Gerät unter Umständen ständig laufen und auf der Rückseite des Kühlraums wird sich eine Frostschrift ablagern. Stellen Sie den Drehknopf in diesem Fall auf eine niedrigere Einstellung (1-2).

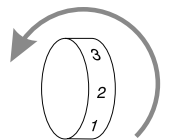

TÜRANSCHLAGWECHSEL

Um den Türanschlag zu wechseln, befolgen Sie die Anweisungen A oder B, je nach Ausführung und Bauart der Tür und der Scharniere, die ihr Gerät verwendet.

A

Stellen oder kippen Sie den Kühlschrank in einem 45°-Winkel, da es notwendig ist, an der Unterseite des Gerätes zu arbeiten.

1

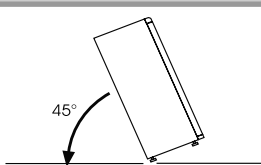

2

Entfernen Sie das untere Scharnier, indem Sie die Schrauben, den Stift und die Unterlegscheiben entfernen. Entfernen Sie anschließend die untere Tür.

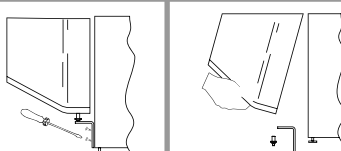

Entfernen Sie die mittlere Schraube und entfernen Sie die obere Tür.

3

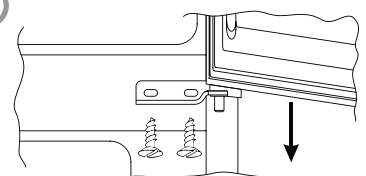

Entfernen Sie die Schutzkappen (A) und (B), lösen Sie die Schrauben und ziehen Sie die Stirnwand teilweise heraus.

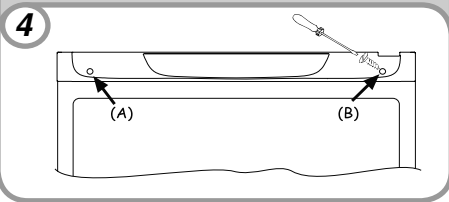

Schrauben Sie das rechte Scharnier ab.

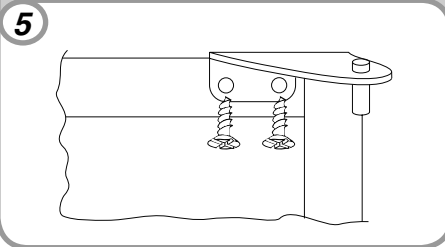

Ritzen Sie die linke Öse der Stirnwand ein und stechen Sie diese an der markierten Stelle im Bereich des Einsatzes durch.

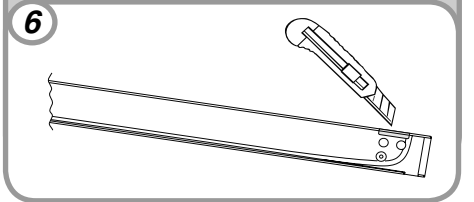

Nehmen Sie aus dem Zubehör das obere linke Scharnier und befestigen Sie es.

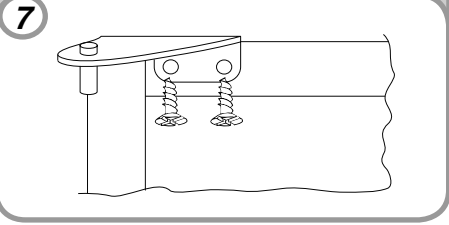

Entfernen Sie die Stopfen auf der linken Seite und setzen Sie diese auf der rechten Seite der mittleren und unteren Einsätze ein.

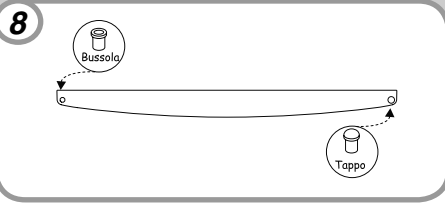

Bauen Sie die Scharniere und die Türen wieder an, beginnen Sie dabei von unten, 1 → 2 → 3

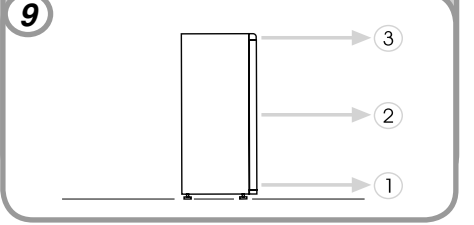

B

Stellen oder kippen Sie den Kühlschrank in einem 45°-Winkel, da es notwendig ist, an der Unterseite des Gerätes zu arbeiten.

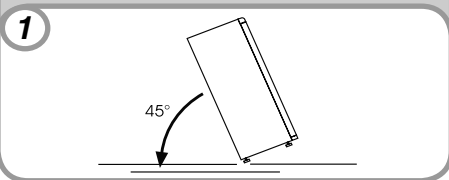

Entfernen Sie das untere Scharnier, indem Sie die Schrauben, den Stift und die Unterlegscheiben entfernen. Entfernen Sie anschließend die untere Tür.

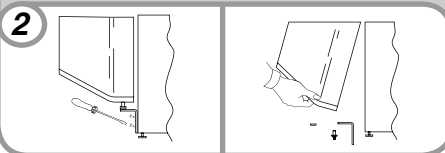

Schrauben Sie das mittlere Scharnier heraus und entfernen Sie die obere Tür.

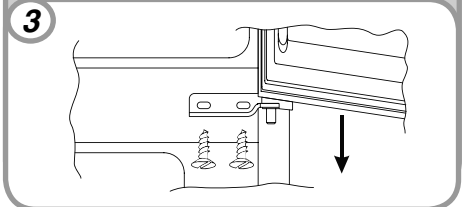

Schrauben Sie das Scharnier von der Kühlschranktür ab und befestigen Sie das mitgelieferte Scharnier auf der anderen Seite.

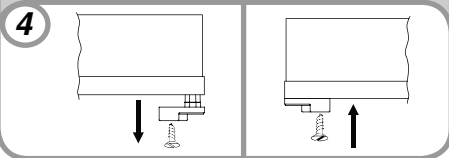

Tauschen Sie die Position des Verschlussstopfens am Einsatz um.

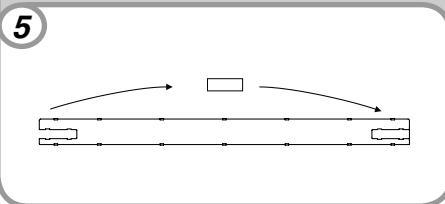

Entfernen Sie den Verschlussstopfen der Stirnwand.

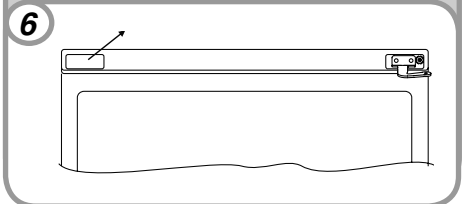

Nehmen Sie aus dem Zubehör das obere linke Scharnier und befestigen Sie es.

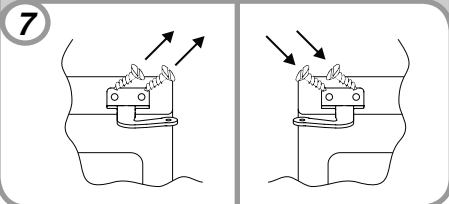

Stecken Sie den Bolzen in das Scharnier.

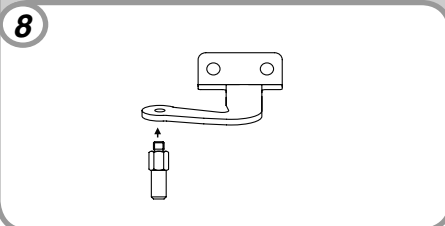

Befestigen Sie den Verschlussstopfen auf der Stirnwand.

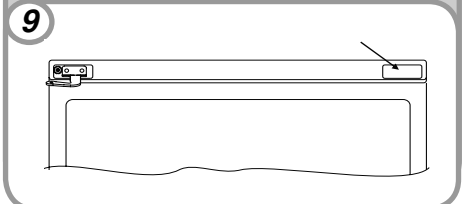

Entfernen Sie die Stopfen auf der linken Seite und setzen Sie diese auf der rechten Seite der mittleren und unteren Einsätze ein.

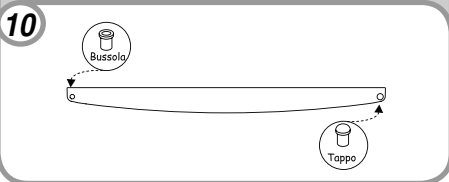

Bringen Sie die Scharniere und Türen wieder an, beginnen Sie dabei von unten. 1 → 2 → 3

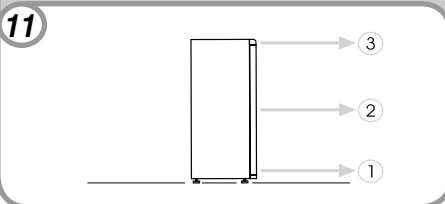

Um die Griffe nach der anderen Richtung auszurichten: Nehmen Sie die Zierkappen an der rechten Seite der Türen ab.

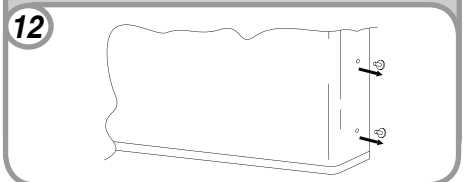

Schrauben Sie die Kappen von der linken Seite ab und bringen Sie sie an der rechten Seite des Produktes an. Befestigen Sie dann erneut die Zierkappen an der linken Seite.

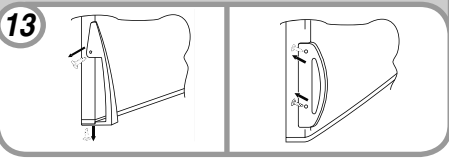

DOS PUERTAS

PANEL DE MANDOS

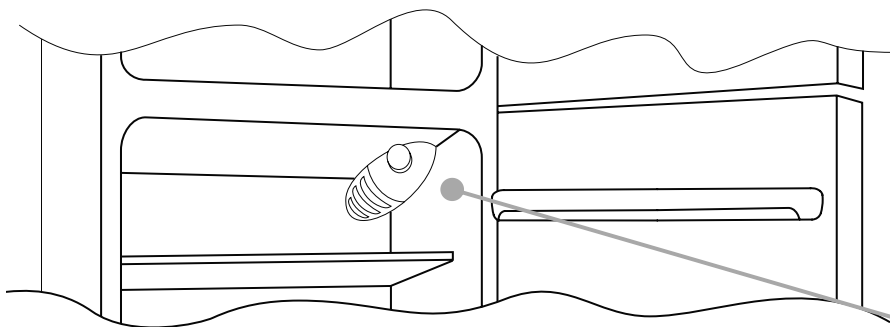

La caja del termostato que controla la aplicación se encuentra ubicada dentro del compartimento del frigorífico en la zona superior derecha. Para comprobar si la aplicación está funcionando, asegúrese de que la rueda del termostato no esté fijada en „0“.

DESCONGELACIÓN y CONGELACIÓN

La placa indicadora muestra la cantidad máxima de comida que puede ser congelada, (véase figura 2). La congelación está garantizada en cualquier posición de la rueda.

(Figura 2)

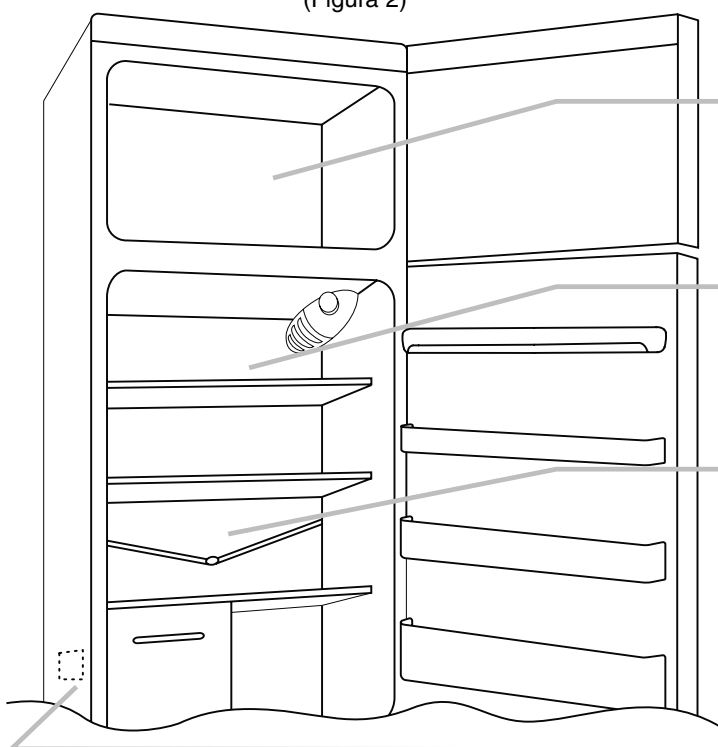

La descongelación del compartimento del frigorífico tiene lugar de forma automática en este producto.

Le aconsejamos que descongele el congelador cuando la bandeja de hielo haya alcanzado un espesor de 3 mm como mínimo.

Un pequeño goteo de agua en la parte interna del compartimento del frigorífico mientras esté funcionando es totalmente normal.

Asegúrese de mantener siempre limpio el desagüe. Asegúrese de que las comidas no tocan la parte trasera del compartimento del congelador.

NOTA: Esta es la placa indicadora. Si necesita contactar con nuestro servicio de atención al cliente en caso de fallos o defectos, no olvide indicarle la información contenida en dicha placa.

IMPORTANTE: Si la temperatura de la habitación es muy alta, el aparato seguirá funcionando pero una capa de hielo se formará en la parte trasera del compartimento del frigorífico. En este caso, gire el interruptor para alcanzar temperaturas inferiores (1-2).

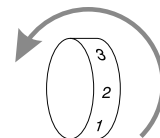

INVERTIR EL SENTIDO DE APERTURA DE LAS PUERTAS

Para invertir el sentido de apertura de las puertas, siga las siguientes instrucciones en función del tipo de orificio y de bisagra que contenga su producto.

A

Coloque o incline el frigorífico respetando un ángulo de 45°, ya que será necesario para poder trabajar sobre la parte inferior del aparato.

1

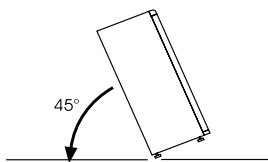

2

Saque la bisagra inferior, desatornillando las tuercas, sacando el enchufe y las arandelas y a continuación, saque la puerta inferior

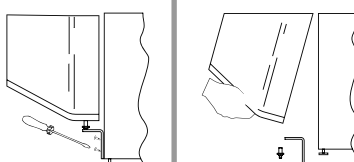

3

Saque el tornillo intermedio y la puerta superior

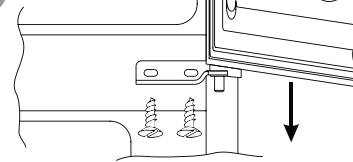

Quite las tapas (A) y (B), ajustadas por los tornillos y saque una parte de la caja de mandos.

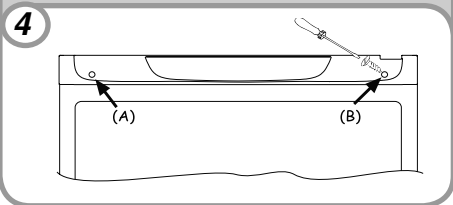

Desapriete la bisagra derecha.

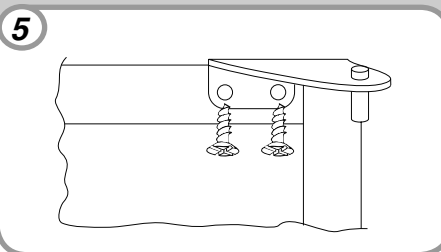

Marque y perforo la ranura de la parte izquierda del panel, situada en la zona de inserción.

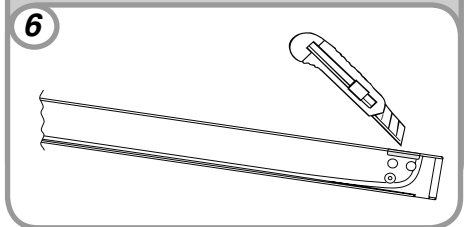

Ajuste la bisagra del lado superior izquierdo que se encuentra en su kit de accesorios.

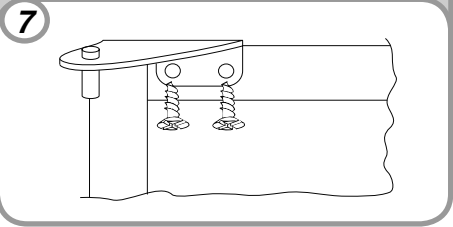

Quite la clavija de la parte izquierda e introdúzcala en la parte derecha de la hendidura central e inferior.

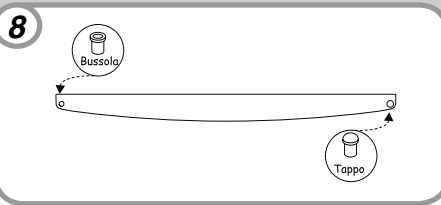

Una las bisagras y las puertas de arriba a abajo. 1 → 2 → 3

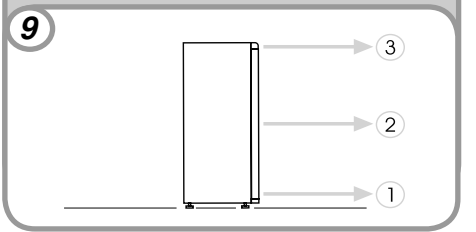

B

Coloque o incline el frigorífico respetando un ángulo de 45°, ya que será necesario para poder trabajar sobre la parte inferior del aparato.

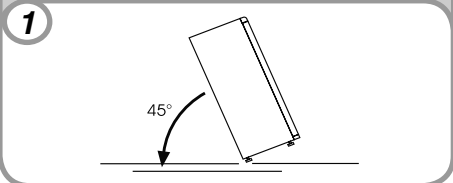

Saque la bisagra inferior, desatornillando las tuercas, sacando el enchufe y las arandelas y a continuación, saque la puerta inferior.

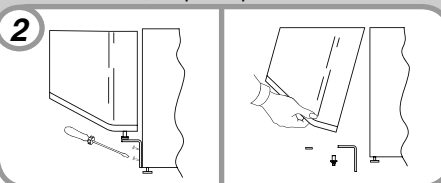

Desatornille la bisagra central y saque la puerta superior

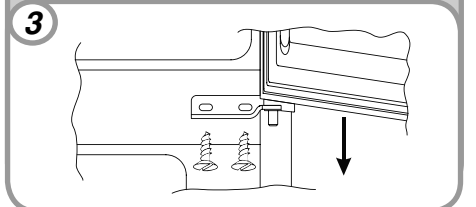

Desajuste la bisagra de la puerta del refrigerador e instale la bisagra de la parte opuesta.

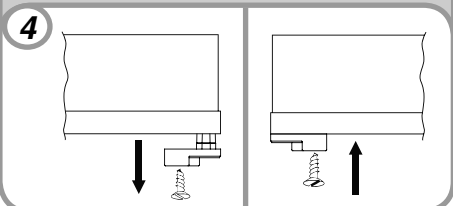

Invierta la posición de la clavija de cierre de la hendidura

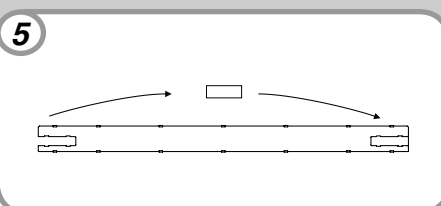

Saque la clavija de cierre del panel

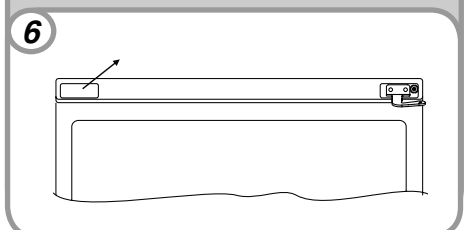

Ajuste la bisagra del lado superior izquierdo que se encuentra en su kit de accesorios.

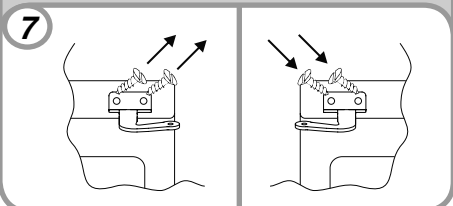

Introduzca la clavija en la bisagra.

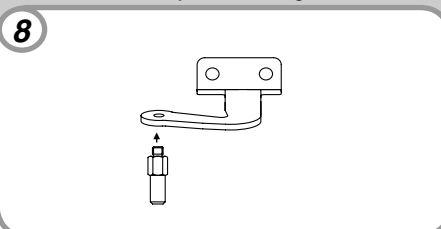

Coloque la clavija de cierre del panel

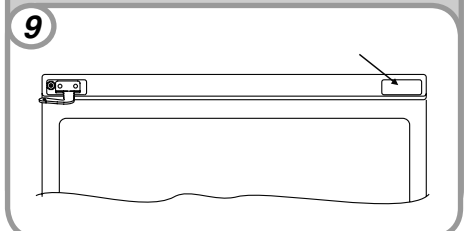

Quite la clavija de la parte izquierda e introdúzcala en la parte derecha de la hendidura central e inferior.

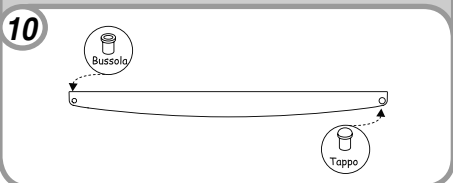

Una las bisagras y las puertas de arriba a abajo. 1 → 2 → 3

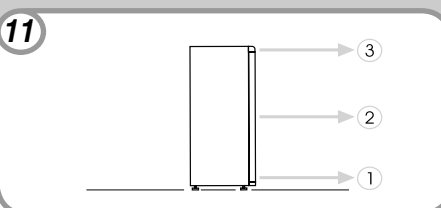

Para invertir el sentido de las asas: Quite las tapas exteriores situadas en la parte derecha de las puertas.

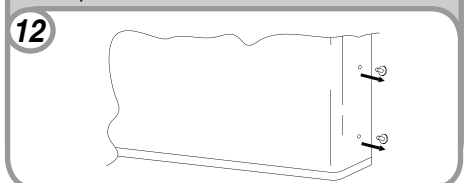

Desajuste las asas situadas en la parte izquierda y colóquelas en la parte derecha del producto. A continuación, coloque las tapas externas en la parte izquierda.

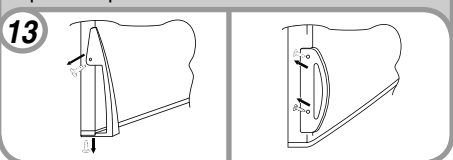

DUAS PORTAS

PAINEL DE CONTROLO

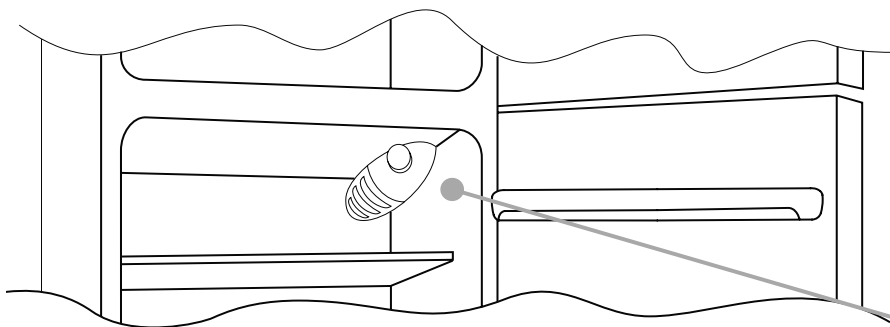

A caixa do termóstato que controla o equipamento está localizada dentro do compartimento do frigorífico no lado superior direito. Para verificar se o equipamento está a funcionar, certifique-se de que o botão do termóstato não está regulado para „0“.

DESCONGELAÇÃO e CONGELAÇÃO

A placa de identificação indica a quantidade máxima de alimentos que podem ser congelados (ver figura 2). A congelação é garantida com qualquer definição do botão.

(Figura 2)

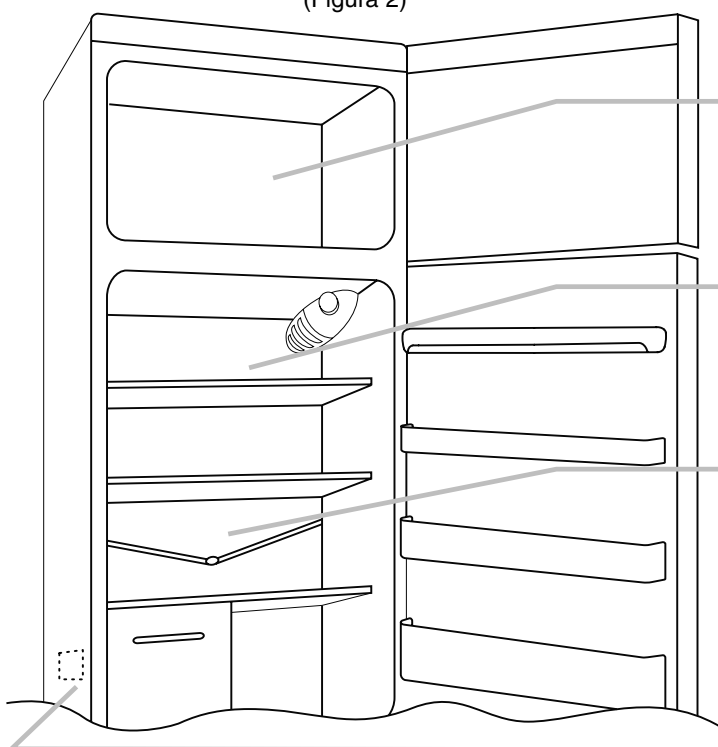

A descongelação do compartimento do frigorífico ocorre automaticamente neste produto.

Recomendamos que descongele a zona do congelador quando a camada de gelo tiver mais de 3 mm de espessura.

A presença de uma camada fina de gelo ou de gotas de água na parte posterior do frigorífico durante o funcionamento é normal.

É importante manter a conduta de água sempre limpa. Evite guardar os alimentos encostados às partes posterior ou laterais do compartimento do frigorífico

Obs.: Esta é a placa de identificação. Se necessitar de entrar em contacto com a Assistência Técnica em caso de avaria, deve fornecer-lhes a informação indicada na placa.

Importante: se a temperatura ambiente estiver muito quente, o aparelho pode continuar a funcionar de forma contínua e uma camada de gelo irá formar-se na parte posterior do frigorífico. Neste caso, rode o botão para programações mais baixas (1-2).

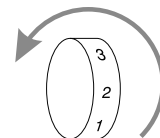

INVERTER A ABERTURA DAS PORTAS

Para inverter a abertura das portas, siga as indicações relacionadas com o tipo de dobradiça e fecho do equipamento.

A

Deite ou incline o frigorífico a 45°, para facilitar as operações na parte inferior do mesmo

1

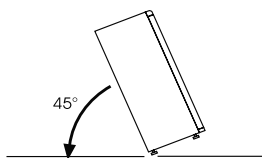

Retire o fecho inferior, removendo os parafusos, a ficha e as anilhas e depois retire a porta inferior

2

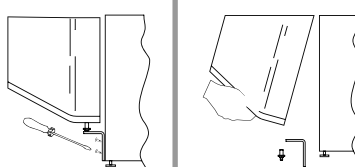

Retire o parafuso do meio e remova a porta superior

3

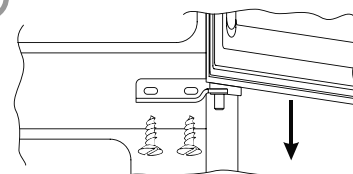

Retire as tampas (A) e (B), desaperte os parafusos e remova parcialmente o painel.

4

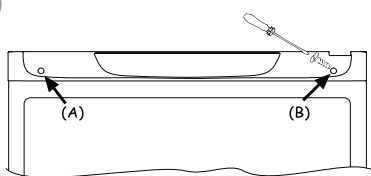

Desaparafuse o fecho da direita

5

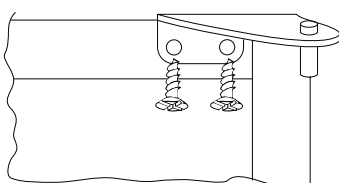

Faça uma incisão e parta a aba da esquerda do painel na zona marcada

6

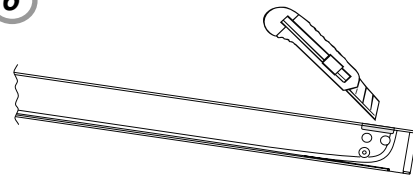

No saquinho dos acessórios fornecidos, procure o fecho superior da esquerda

7

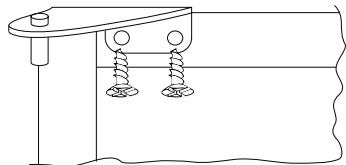

Retire a tampa no lado esquerdo e insira-a no lado direito dos fechos centrais e inferiores.

8

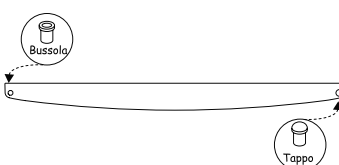

Monte os fechos e as portas debaixo para cima, 1 → 2 → 3

9

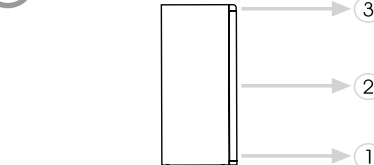

B

Deite ou incline o frigorífico a 45°, para facilitar as operações na parte inferior do mesmo

1

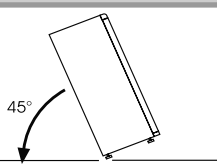

Retire o fecho inferior, removendo os parafusos, a ficha e as anilhas e depois retire a porta inferior.

2

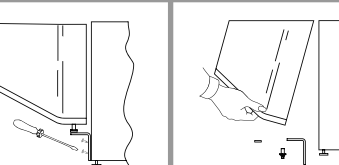

Desaparafuse o fecho central e retire a porta superior

3

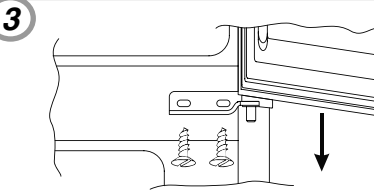

Desaperte o fecho da porta do frigorífico e coloque o fecho fornecido no outro lado

4

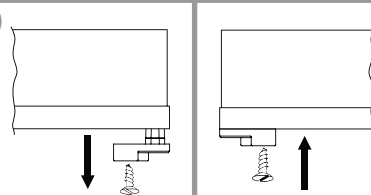

Inverta a posição da ficha da inserção

5

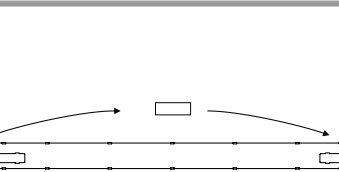

Retire o tampão de fecho do painel

6

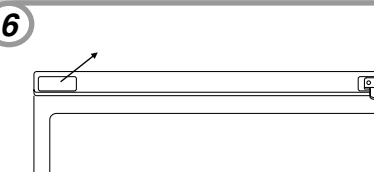

No saquinho dos acessórios fornecidos, procure o fecho superior da esquerda

7

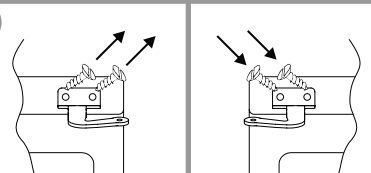

Insira o pino no fecho.

8

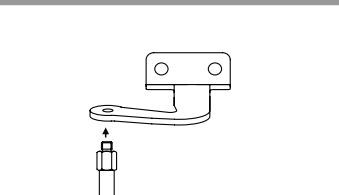

Coloque o tampão de fecho do painel

9



Retire a tampa no lado esquerdo e insira-a no lado direito dos fechos centrais e inferiores.

10

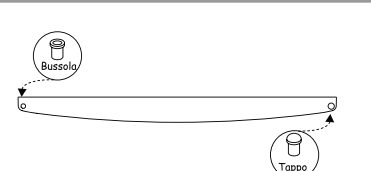

Monte de novo os fechos e as portas de cima para baixo. 1 → 2 → 3

11

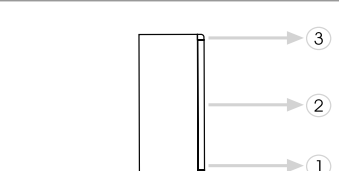

Para inverter os puxadores: retire as tampas exteriores da parte direita das portas

12

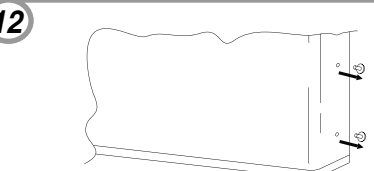

Desaperte os puxadores do lado esquerdo e desloque-os para o lado direito e, em seguida, no lado esquerdo das portas, coloque as tampas anteriormente retiradas.

13

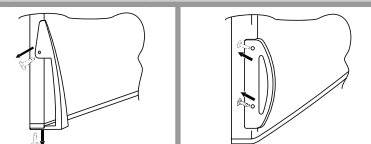

ΔΙΠΛΗ ΠΟΡΤΑ

ΠΙΝΑΚΑΣ ΕΛΕΓΧΟΥ

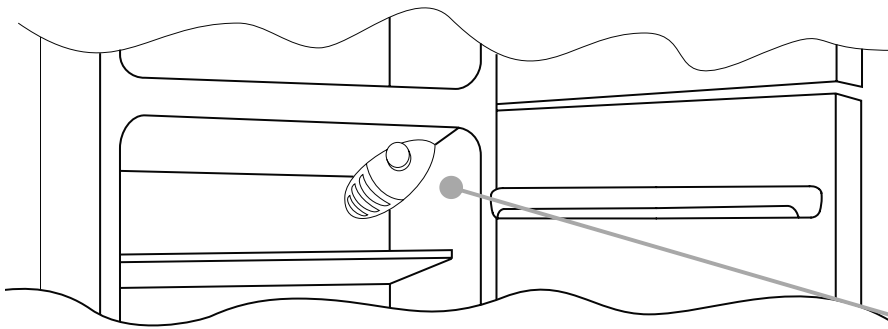

Το κουτί θερμοστάτη για τον έλεγχο της συσκευής βρίσκεται στο εσωτερικό του χώρου συντήρησης στο πάνω δεξιό μέρος. Για να ελέγξετε αν η συσκευή λειτουργεί, βεβαιωθείτε ότι το κουμπί του θερμοστάτη δεν έχει ρυθμιστεί στο „0“.

ΑΠΟΨΥΞΗ και ΚΑΤΑΨΥΞΗ

Η πινακίδα στοιχείων αναφέρει τη μέγιστη ποσότητα τροφίμων που μπορεί να καταψυχθεί (βλέπε εικόνα 2). Η κατάψυξη των τροφίμων είναι εγγυημένη για οποιαδήποτε ρύθμιση του κουμπιού.

(Εικόνα 2)



Στο προϊόν αυτό, η απόψυξη του χώρου συντήρησης λαμβάνει χώρα αυτόματα.

Συνιστούμε να εκτελείτε απόψυξη του χώρου της κατάψυξης όταν στάθμη πάγου έχει πάχος μεγαλύτερο από 3 χιλιοστά.

Μια μικρή ποσότητα πάγου ή σταγόνες νερού στο πίσω μέρος του χώρου της συντήρησης είναι φυσιολογικό φαινόμενο όταν λειτουργεί το ψυγείο.

Να βεβαιώνεστε ότι η διόδος αποστράγγισης του νερού είναι πάντα καθαρή. Βεβαιωθείτε ότι τα τρόφιμα δεν αγγίζουν το πίσω ή τα πλευρικά τοιχώματα του χώρου συντήρησης

ΣΗΜΕΙΩΣΗ: Αυτή είναι η πινακίδα στοιχείων. Αν χρειάζεται να απευθυνθείτε στο Τμήμα Σέρβις της εταιρείας μας, θυμηθείτε να αναφέρετε τις πληροφορίες που αναφέρονται στην πινακίδα.

Σημαντική παρατήρηση: Αν η θερμοκρασία του δωματίου είναι πολύ υψηλή, η συσκευή μπορεί να εργάζεται συνεχώς και στο πίσω τοίχωμα του χώρου συντήρησης θα αποθεθεί ένα στρώμα πάχνης. Στην περίπτωση αυτή, γυρίστε το κουμπί σε χαμηλότερες ρυθμίσεις (1-2).

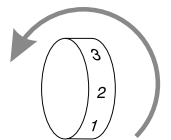

ΑΝΤΙΣΤΡΟΦΗ ΤΗΣ ΦΟΡΑΣ ΑΝΟΙΓΜΑΤΟΣ ΣΤΙΣ ΠΟΡΤΕΣ

Για να αντιστρέψετε τη φορά ανοίγματος στις πόρτες, ακολουθήστε τις οδηγίες, ανάλογα με τον τύπο προσαρμογέα και μεντεσέ που περιλαμβάνονται στη δική σας συσκευή.

A

Τοποθετήστε ή γείρετε το ψυγείο σε γωνία 45°, αφού είναι απαραίτητο να εργαστείτε στην κάτω πλευρά της συσκευής

1

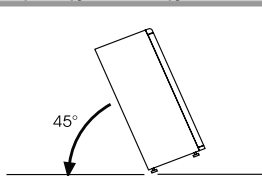

Αφαιρέστε τον κάτω μεντεσέ αφού αφαιρέσετε τις βίδες, τον πείρο και τις ροδέλες και κατόπιν αφαιρέστε την κάτω πόρτα

2



Αφαιρέστε το μεσαίο μεντεσέ και κατόπιν αφαιρέστε την πάνω πόρτα

3

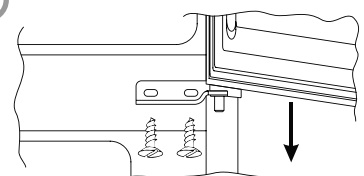

Αφαιρέστε τα καπάκια (A) και (B), ξεβιδώστε τις βίδες και αφαιρέστε μερικώς τον πίνακα.

4

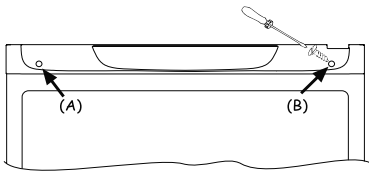

Ξεβιδώστε το δεξιό μεντεσέ

5

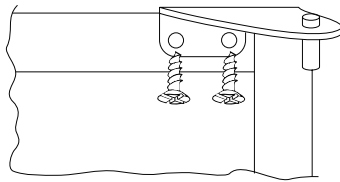

Σημαδέψτε και σπάστε την αριστερή υποδοχή στον πίνακα, στην περιοχή του προσαρμογέα

6

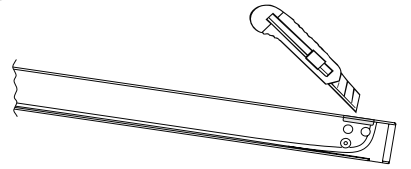

Τοποθετήστε τον πάνω αριστερό μεντεσέ που βρίσκεται στο κιτ των αξεσουάρ

7

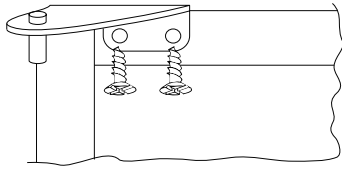

Αφαιρέστε την τάπα της αριστερής πλευράς και τοποθετήστε τη στη δεξιά πλευρά του κεντρικού και κατώτερου προσαρμογέα.

8

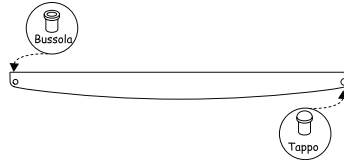

Συναρμολογήστε πάλι τους μεντεσέδες και τις πόρτες εργαζόμενοι από το κάτω προς το πάνω μέρος, 1 → 2 → 3

9

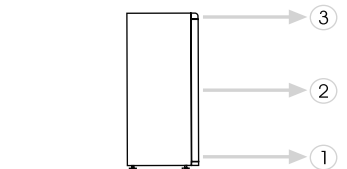

B

Τοποθετήστε ή γείρετε το ψυγείο σε γωνία 45°, αφού είναι απαραίτητο να εργαστείτε στην κάτω πλευρά της συσκευής

1

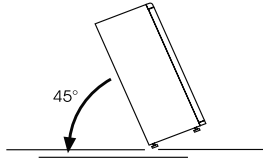

Αφαιρέστε τον κάτω μεντεσέ αφού αφαιρέσετε τις βίδες, τον πείρο και τις ροδέλες και κατόπιν αφαιρέστε την κάτω πόρτα

2

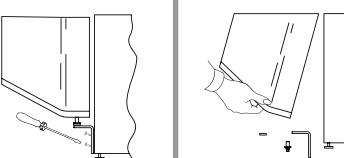

Ξεβιδώστε τον κεντρικό μεντεσέ και αφαιρέστε την πάνω πόρτα

3

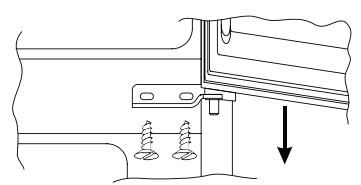

Ξεβιδώστε το μεντεσέ από την πόρτα του ψυγείου και βιδώστε τον παρεχόμενο μεντεσέ στην άλλη πλευρά

4

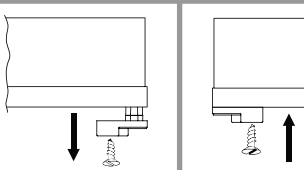

Αλλάξτε θέση στην τάπα σφραγίσματος του προσαρμογέα

5

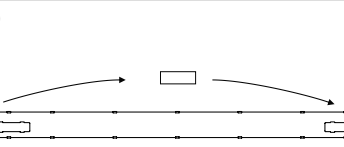

Αφαιρέστε την τάπα σφραγίσματος του πίνακα

6

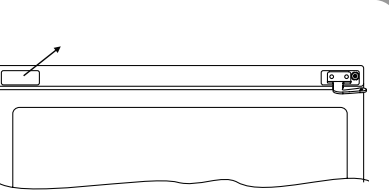

Τοποθετήστε τον πάνω αριστερό μεντεσέ που βρίσκεται στο κιτ των αξεσουάρ

7

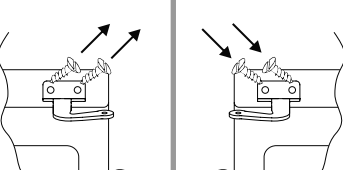

Τοποθετήστε τον πείρο στο μεντεσέ.

8

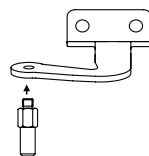

Τοποθετήστε την τάπα σφραγίσματος του πίνακα

9

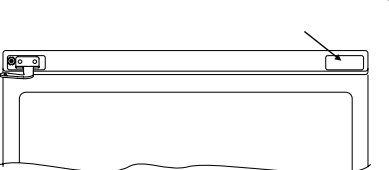

Αφαιρέστε την τάπα της αριστερής πλευράς και τοποθετήστε τη στη δεξιά πλευρά του κεντρικού και του κατώτερου προσαρμογέα.

10

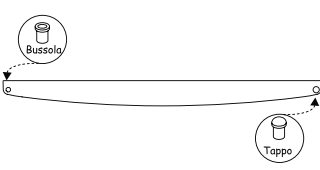

Συναρμολογήστε πάλι τους μεντεσέδες και τις πόρτες από το κάτω μέρος προς το επάνω. 1 → 2 → 3

11

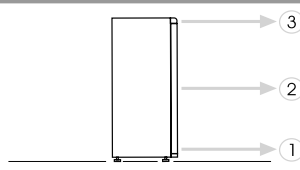

Για να αντιστρέψετε τις λαβές: Αφαιρέστε τα εξωτερικά καπάκια από τη δεξιά πλευρά των πορτών

12

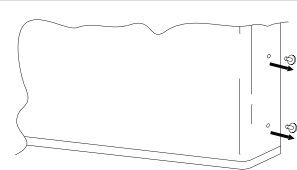

Ξεβιδώστε τις λαβές από την αριστερή πλευρά και μεταφέρετέ τις στη δεξιά πλευρά της συσκευής. Τοποθετήστε τα εξωτερικά καπάκια στην αριστερή πλευρά.

13

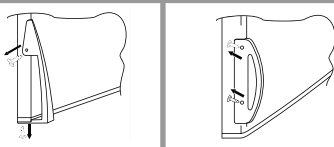

DWUDRZWIOWA

PANEL STEROWANIA

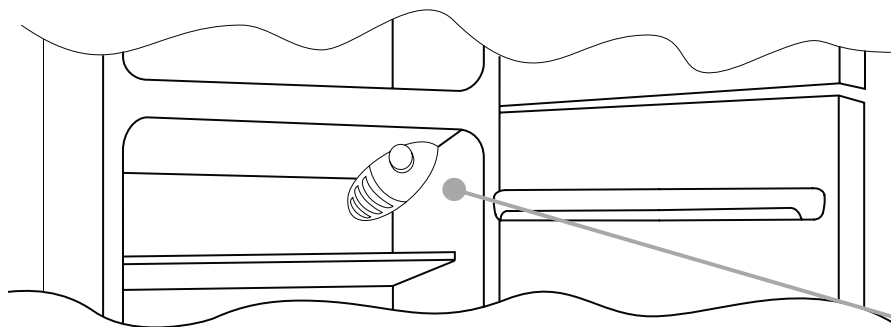

Skrzynka termostatu sterującego urządzeniem znajduje się wewnątrz zamrażarki, w jej prawej górnej części. Aby sprawdzić, czy urządzenie działa, ustaw pokrętkę termostatu na pozycji innej niż „0”.

ROZMRAŻANIE I ZAMRAŻANIE

Na tabliczce znamionowej umieszczono informację o maksymalnej ilości produktów, jaką można zamrozić (patrz rysunek 2). Urządzenie zamraża przy każdym ustawieniu pokrętki.

(rysunek 2)

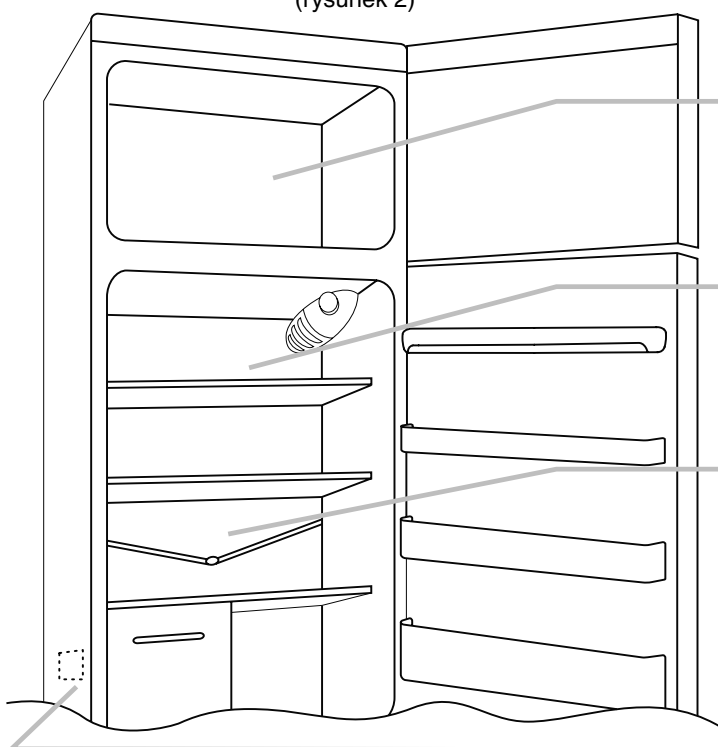

W tym urządzeniu rozmrażanie zamrażarki jest wykonywane automatycznie.

Zalecamy rozmrożenie zamrażarki, gdy grubość warstwy lodu przekracza 3 mm.

Niewielka ilość lodu lub wody w tylnej części lodówki podczas jej pracy jest zjawiskiem normalnym.

Należy dbać o to, aby odpływ wody był zawsze czysty. Produkty nie powinny dotykać tylnej ani bocznych ścianek lodówki.

Uwaga: To jest tabliczka znamionowa. W razie problemów, kiedy zachodzi konieczność skontaktowania się z serwisem, należy podać informacje umieszczone na tej tabliczce.

Ważne: W wysokiej temperaturze otoczenia urządzenie może działać bez przerwy, a w tylnej części zamrażarki może odkładać się warstwa lodu. W takim przypadku pokrętkę należy ustawić na niższą wartość (1-2).

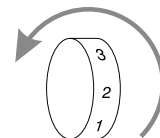

ODWRACANIE KIERUNKU OTWIERANIA DRZWI

W celu odwrócenia kierunku otwierania drzwi należy postępować zgodnie ze wskazówkami odpowiednimi dla danego urządzenia oraz z uwzględnieniem specyficznych zawiasów tego urządzenia.

A

Urządzenie ustawić lub przechylić pod kątem 45°, ponieważ będzie konieczne wykonywanie czynności na spodzie urządzenia.

1

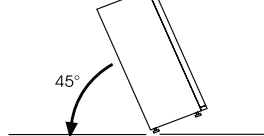

Zdjąć dolny zawias, usuwając wkręty, zatyczkę i podkładki, a następnie zdjąć dolne drzwi.

2

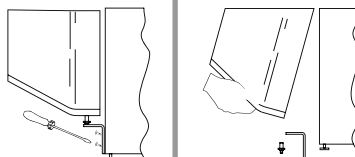

Odkręcić środkowy wkręt i zdjąć górne drzwi.

3

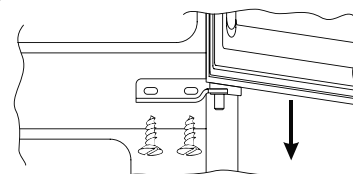

Usunąć zatyczki (A) i (B), odkręcić wkręty i częściowo wyciągnąć listwę.

4

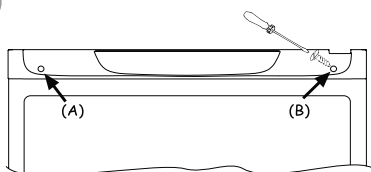

Odkręcić prawy zawias.

5

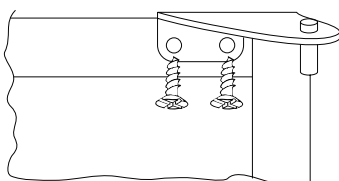

Naciąć i wyłamać otwór w zaznaczonym miejscu po lewej stronie.

6

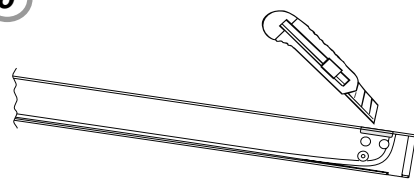

Z woreczka z akcesoriami wyjąć i zamocować lewy zawias.

7

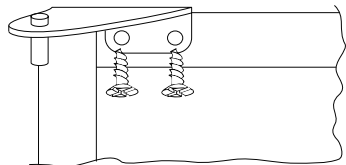

Usunąć zatyczkę z lewej strony i włożyć ją z prawej strony wkładu środkowego i dolnego.

8

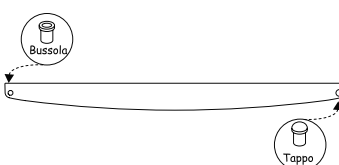

Ponownie założyć zawiasy i drzwi, zaczynając od dołu, 1 * 2 * 3.

9

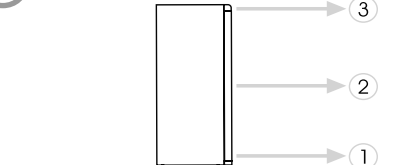

B

Urządzenie ustawić lub przechylić pod kątem 45°, ponieważ będzie konieczne wykonywanie czynności na spodzie urządzenia.

1

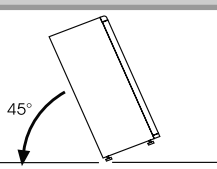

Zdjąć dolny zawias, usuwając wkręty, zatyczkę i podkładki, a następnie zdjęć dolne drzwi.

2

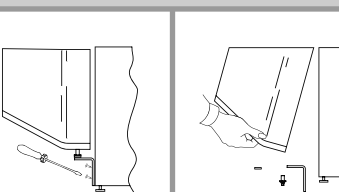

Odkręcić środkowy zawias i zdjąć górne drzwi.

3

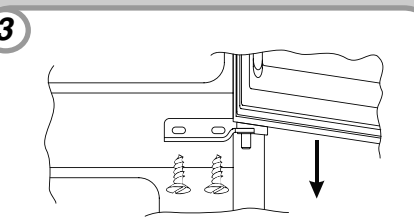

Odkręcić zawias od drzwi lodówki i z drugiej strony zamocować zawias dostarczony w zestawie.

4

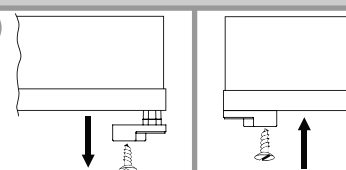

Odkręcić zatyczkę we wkładce

5

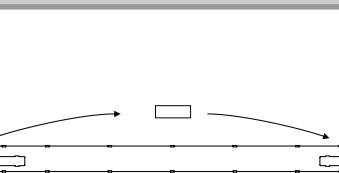

Usunąć zatyczkę z panelu

6

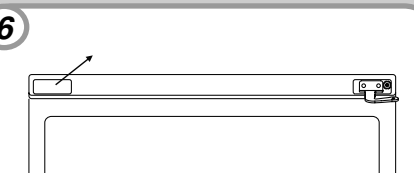

Z woreczka z akcesoriami wyjąć i zamocować lewy zawias.

7

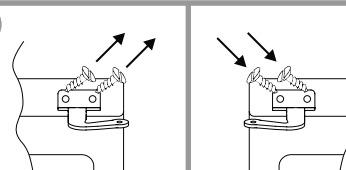

Włożyć trzpień do zawiasu.

8

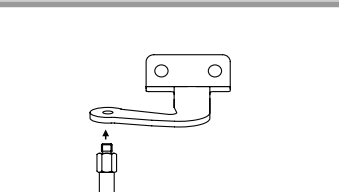

Założyć zatyczkę panelu

9

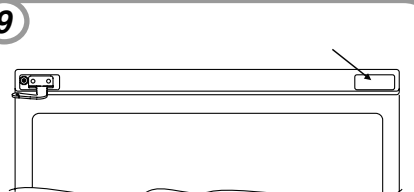

Usunąć zatyczkę z lewej strony i włożyć ją z prawej strony wkładu środkowego i dolnego.

10

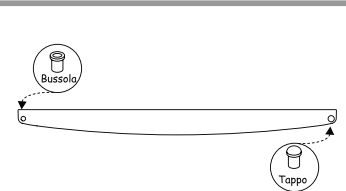

Ponownie złożyć zawiasy i drzwi, idąc od dołu ku górze. 1 → 2 → 3

11

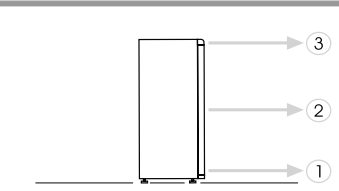

Przekładanie uchwytów: Usunąć zatyczki z prawej strony drzwi.

12

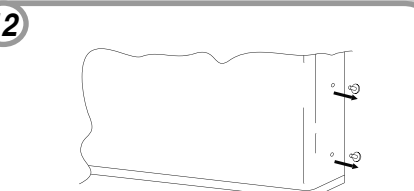

Odkręcić uchwyty z lewej strony drzwi i przełożyć je na prawą. Następnie założyć zatyczki z lewej strony drzwi.

13

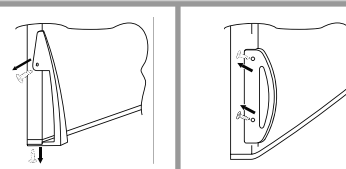

KOMBINOVANÁ CHLADNIČKA

OVLÁDACÍ PANEL

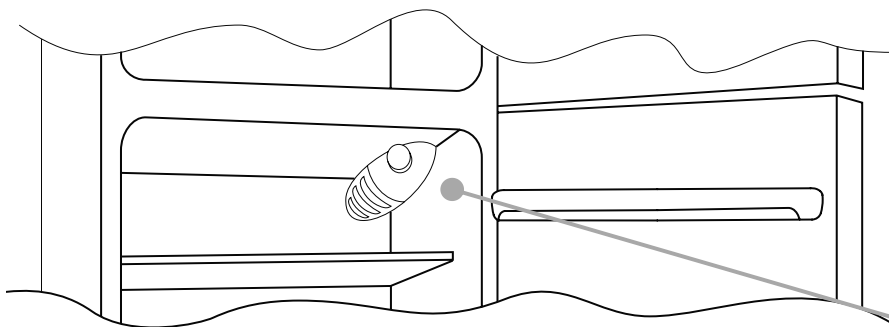

Termostat určený k ovládání spotřebiče je umístěn uvnitř chladničky vpravo nahoře. Pokud chcete zkontrolovat, že zařízení opravdu funguje, přesvědčete se, že termostat není nastavený v poloze „0“.

ODMRAZOVÁNÍ a MRAŽENÍ

Popisný štítek stanovuje maximální množství potravin, které lze zmrazit (viz obrázek 2). Mražení je zaručeno ve všech polohách ovladače.

(Obrázek 2)

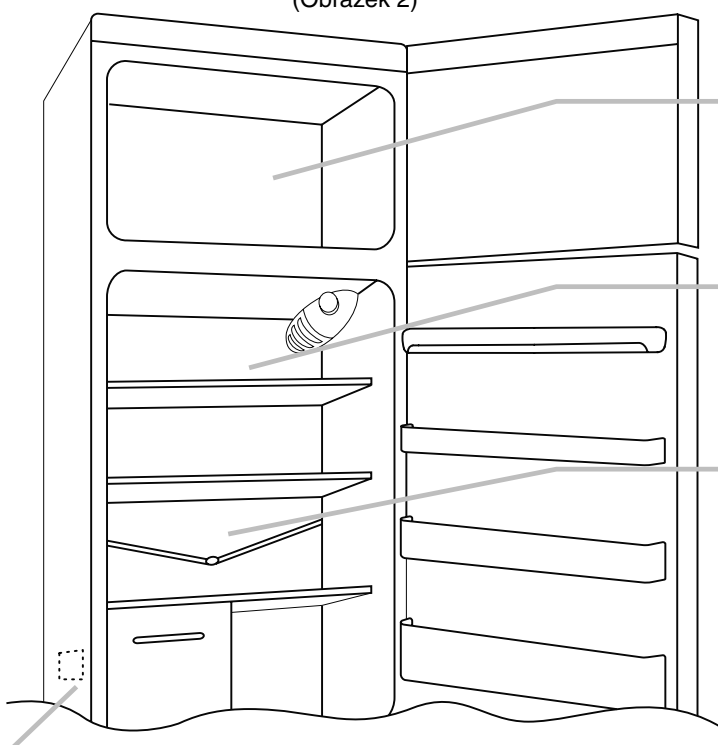

V tomto zařízení je odmrazování chladničky automatické.

Doporučujeme odmrazovat prostor mrazničky, pokud je vrstva námrazy silnější než 3 mm.

Malé množství námrazy nebo kapek vody na zadní stěně prostoru chladničky je normální, pokud je chladnička v provozu

Kontrolujte, zda je odvod vody volně průchodný. Ujistěte se, že se potraviny nedotýkají zadní stěny nebo stran chladničky.

Poznámka: Toto je popisný štítek. Potřebujete-li v případě závad kontaktovat servisní oddělení, nezapomeňte jim poskytnout informace uvedené na tomto štítku.

Důležité: Pokud je teplota v místnosti velmi vysoká, může spotřebič pracovat nepřetržitě a vrstva námrazy se bude ukládat na zadní stěně chladničky. V takovém případě nastavte ovladač na nižší nastavení (1-2).

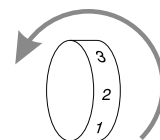

OTOČENÍ SMĚRU OTEVÍRÁNÍ DVEŘÍ

Pokud chcete otočit otevírání dveří, postupujte podle označení v závislosti na typu závěsů a výplně, kterými je váš výrobek vybaven.

A

Chladničku nakloňte v 45° úhlu, protože potřebujete zpřístupnit spodek zařízení.

1

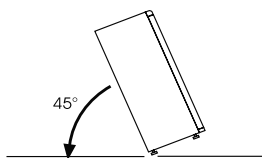

2

Demontujte spodní závěs uvolněním šroubů, krytky a podložek, potom sundejte spodní dvířka.

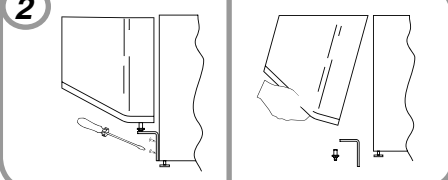

3

Demontujte prostřední šroub a sundejte horní dvířka.

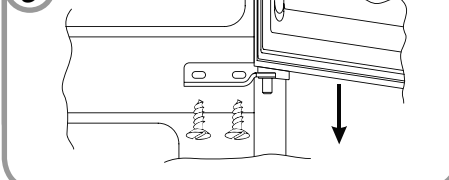

Odstraňte západky (A) a (B), uvolněte šrouby a částečně sejměte desku.

4

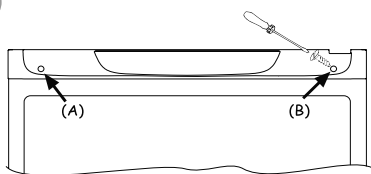

Odšroubujte pravý závěs.

5

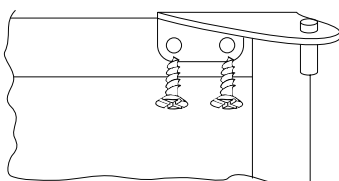

Označte a vylomte levý otvor v desce, v části výplně.

6

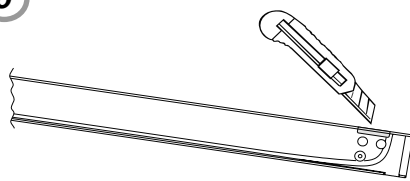

Přetočte horní levý závěs, který je součástí sady s příslušenstvím.

7

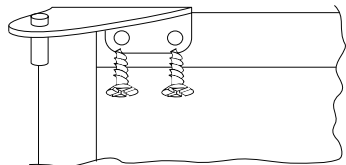

Odstraňte krytku na levé straně a vložte ji na pravou stranu střední a spodní výplně.

8

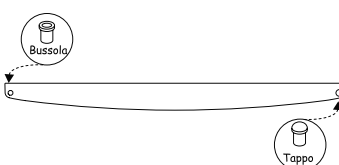

Namontujte zpět závěsy a dvířka, postupujte zdola nahoru, 1 → 2 → 3

9

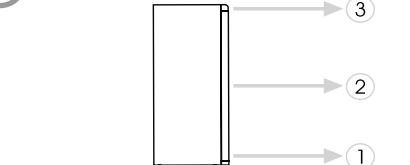

B

Chladničku nakloňte v 45° úhlu, protože potřebujete zpřístupnit spodek zařízení.

1

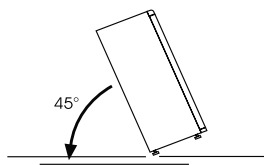

Demontujte spodní závěs uvolněním šroubů, krytky a podložek, potom sundejte spodní dvířka.

2

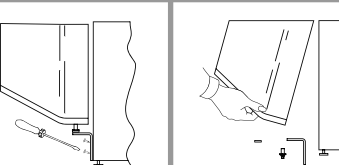

Demontujte prostřední závěs a sundejte horní dvířka.

3

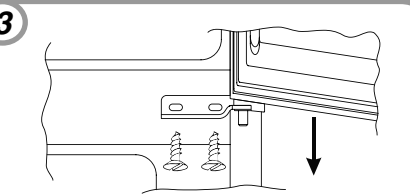

Odšroubujte závěs z dveří chladničky a namontujte ten, který je součástí dodávky, na druhou stranu.

4

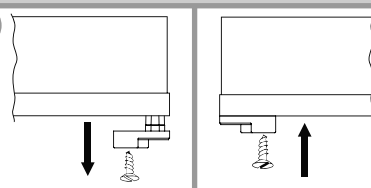

Otočte polohu uzávěru výplně.

5

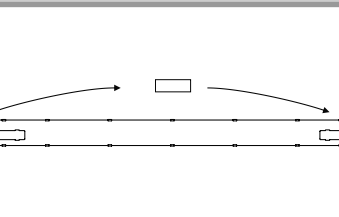

Demontujte uzávěr panelu.

6

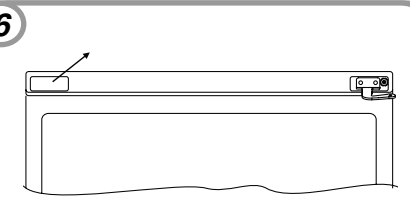

Přetočte horní levý závěs, který je součástí sady s příslušenstvím.

7

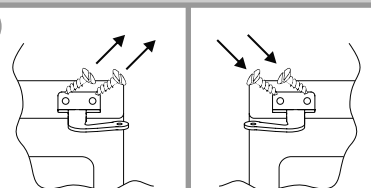

Vložte do závěsu čep.

8

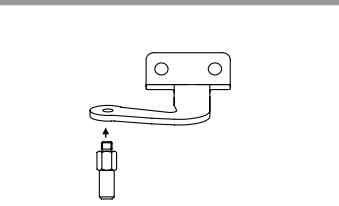

Namontujte uzávěr panelu.

9

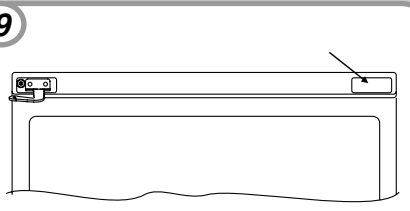

Odstraňte krytku na levé straně a vložte ji na pravou stranu střední a spodní výplně.

10

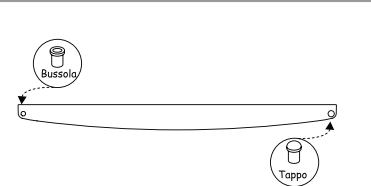

Namontujte zpět závěsy a dvířka, postupujte zdola nahoru. 1 → 2 → 3

11

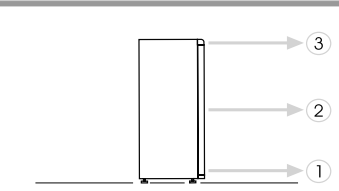

Obrácení rukojetí: Odstraňte vnější západky z pravé strany dveří.

12

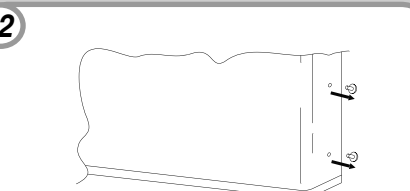

Odšroubujte rukojeti z levé strany a přesuňte je na pravou stranu, poté dejte vnější západky na levou stranu dveří.

13

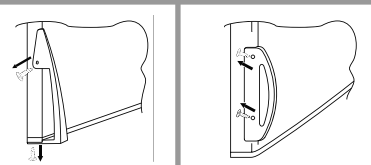

DUBBELE DEUR

BEDIENINGSPANEEL

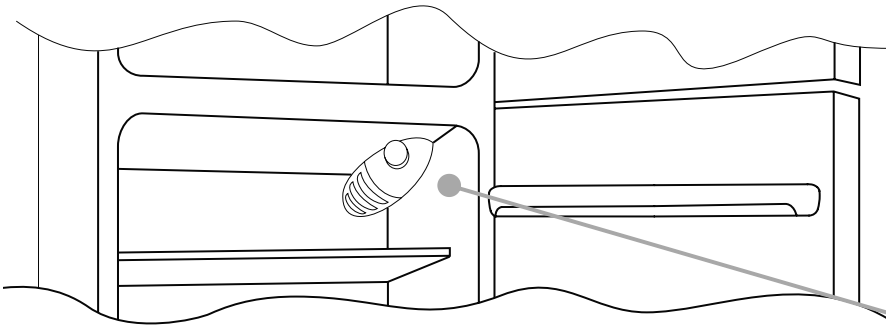

De thermostaatregelaar van het apparaat bevindt zich rechtsboven in het koelkastgedeelte. Om te controleren of het apparaat functioneert dient u erop te letten dat de knop van de thermostaat niet op „0“ staat.

ONTDOOIEN en VRIEZEN

Het maximum aantal in te vriezen producten staat aangegeven op het typeplaatje (zie figuur 2). Het apparaat vriest ongeacht de instelling van de knop.

(Figuur 2)

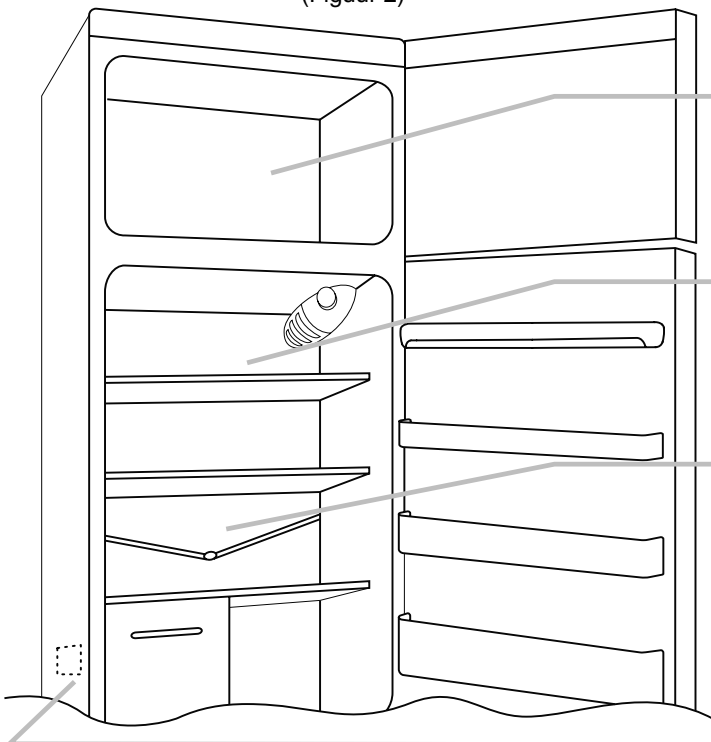

Het koelkastcompartiment van dit apparaat wordt automatisch ontdooid.

Wij adviseren u het diepvriescompartiment te ontdoien wanneer de ijsaanslag dikker dan 3 mm is.

Een kleine hoeveelheid vorst of druppels water aan de achterkant van het diepvriescompartiment is normaal als de diepvriezer in werking is.

Zorg ervoor dat de wateruitloop altijd schoon is. Zorg ervoor, dat de in de koelkast aanwezige producten de achterkant of zijkanten van het koelkastcompartiment niet aanraken.

N.B. Dit is het typeplaatje. Als u in geval van storingen contact van met onze Serviceafdeling opneemt, dient u de gegevens van het typeplaatje altijd op te geven.

Belangrijk: Als de kamertemperatuur relatief hoog is kan het zijn dat het apparaat voortdurend werkt en er ijsafzetting op de achterkant van het koelkastcompartiment gevormd zal worden. Als dit zo is dient de knop op een lagere stand ingesteld te worden (1-2).

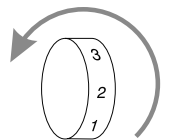

HET WIJZIGEN VAN DE MANIER WAAROP DE DEUREN OPENEN

Om de deuren op een andere manier te openen, volgt u de instructies die zijn gegeven met betrekking tot het type hang- en sluitwerk waarvan uw product werd gemaakt.

A

Zet de koelkast onder een hoek van 45°, zodat u aan de onderzijde van het apparaat kunt werken

1

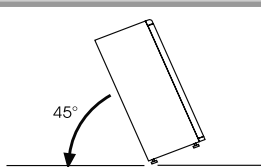

Verwijder het onderste scharnier door de schroeven, dopje en volgving te verwijderen, en verwijder vervolgens de onderste deur

2



Verwijder de middelste schroef en verwijder de bovenste deur

3

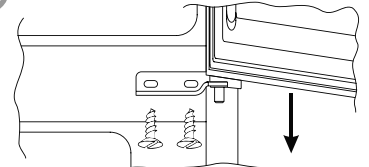

Verwijder de dopjes (A) en (B), draai de schroeven los en verwijder het paneel gedeeltelijk.

4

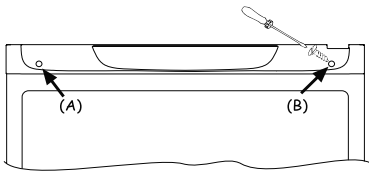

Schroef het rechterscharnier los

5

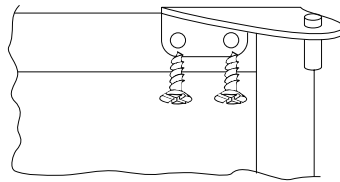

Markeer en breek de uitsparing aan de linkerzijde van het paneel, in het insteekgedeelte

6

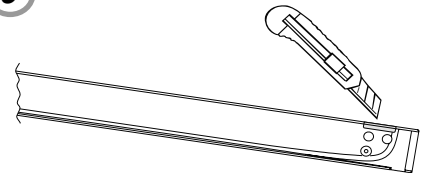

Monteer het links-boven-scharnier dat zich in de accessoireskit bevindt

7

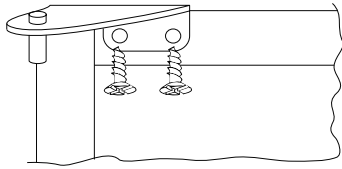

Verwijder het dopje aan de linkerzijde en plaats het aan de rechterzijde van de middelste en onderste inzetstukken.

8

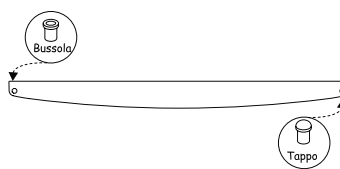

Breng de scharnieren en deuren weer aan door van onder naar boven te werken, 1 → 2 → 3

9

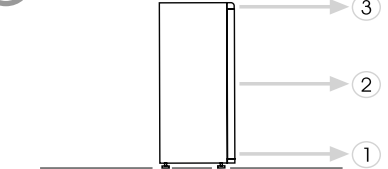

B

Zet de koelkast onder een hoek van 45°, zodat u aan de onderzijde van het apparaat kunt werken

1

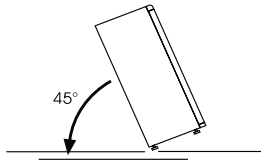

Verwijder het onderste scharnier door de schroeven, dopje en volgving te verwijderen, en verwijder vervolgens de onderste deur

2

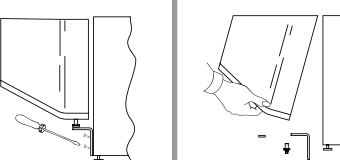

Schroef het middelste scharnier los en verwijder de bovenste deur

3

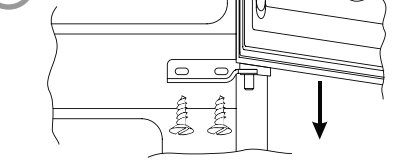

Schroef het scharnier van de koelkastdeur los en bevestig het meegeleverde scharnier aan de andere zijde

4

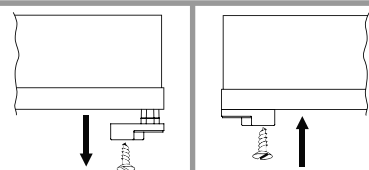

Draai de positie van de afdekplug van het inzetstuk om

5

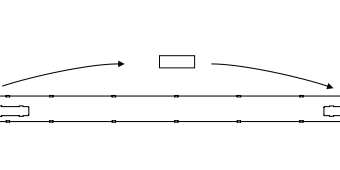

Verwijder de afdekplug van het paneel

6

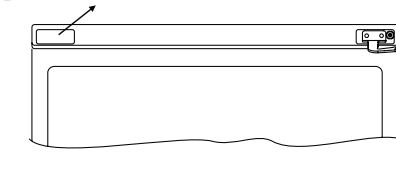

Monteer het links-boven-scharnier dat zich in de accessoireskit bevindt

7

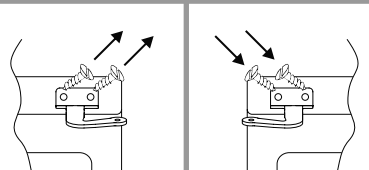

Steek de pen in het scharnier.

8

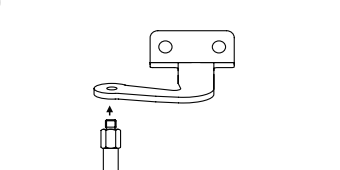

Plaats de afdekplug van het paneel

9

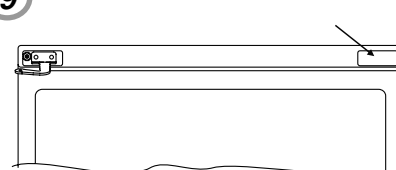

Verwijder de dopjes aan de linkerzijde en plaats deze aan de rechterzijde van de middelste en onderste inzetstukken.

10

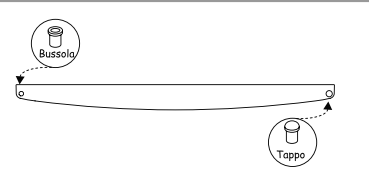

Breng de scharnieren en deuren weer aan door van onder naar boven te werken, 1 * 2 * 3.

11

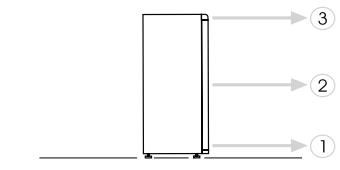

Voor het omdraaien van de handgrepen verwijdert u de pluggen aan de rechterzijde van de deuren

12



Schroef de handgrepen aan de linkerzijde los en monteer deze aan de rechterzijde van de deuren. Plaats de pluggen aan de linkerzijde van de deuren.

13

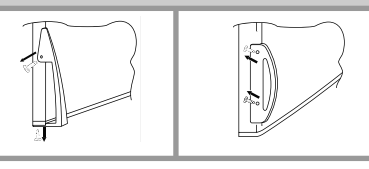

KAKSIOVINEN

OHJAUSPANEELI

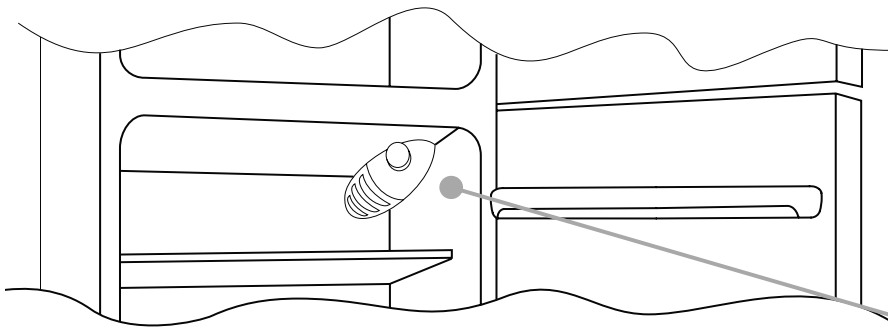

Laitteen säätöön tarkoitettu termostaattilaatikko sijaitsee jääkaappiosaston sisällä oikealla ylhäällä. Kun haluat tarkastaa, että laite toimii, varmista, että termostaattinuppi ei ole asennossa "0".

SULATUS ja PAKASTUS

Arvokilvessä ilmoitetaan pakastettavien elintarvikkeiden enimmäismäärä (katso kuva 2)

Pakastus taataan kaikissa nupin asennoissa.

(Kuva 2)

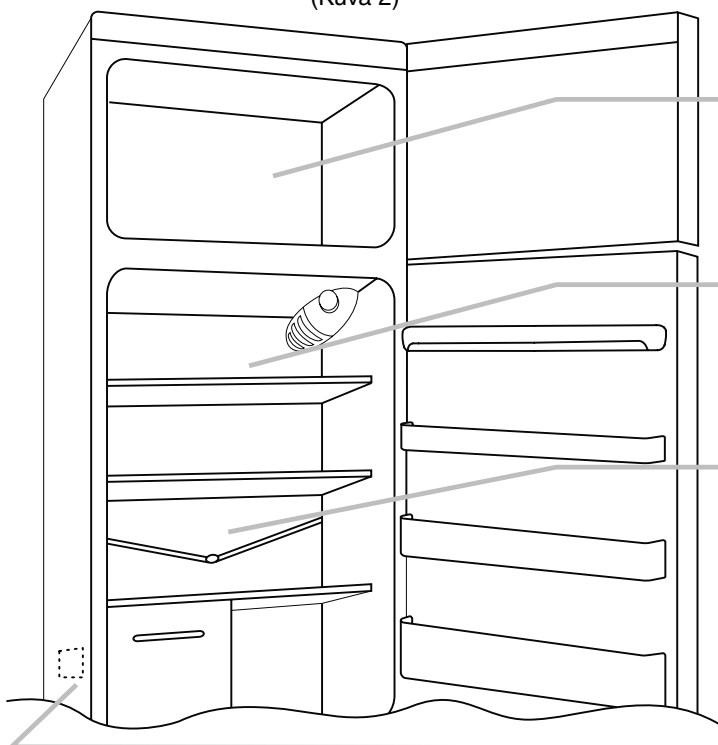

Jääkaappiosaston sulatus tapahtuu automaattisesti.

Suosittelamme, että sulatat pakastimen, kun huurteen paksuus on yli 3 mm.

Pieni määrä huurretta tai vesipisaroita jääkaapin takaosassa on normaalia silloin, kun jääkaappi toimii normaalisti

Varmista, että veden poistoaukko on aina puhdas. Varmista, että elintarvikkeet eivät kosketa jääkaapin takaosaa tai sivuja.

Huom! Arvokilpi on kiinnitetty tähän. Jos sinun tarvitsee ottaa yhteyttä huoltoon vikatilanteessa, muista ilmoittaa kilven tiedot.

Tärkeää: Jos huoneen lämpötila on erittäin lämmin, laite saattaa käydä koko ajan ja jääkaapin takaosaan muodostuu huurrekerros. Käännä tässä tapauksessa valitsin alhaisempaan asentoon (1-2).

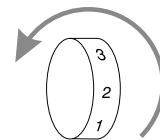

OVIEKÄTISYYDEN VAIHTAMINEN

Kun haluat vaihtaa ovien käteisyyden, noudata ohjeita oman tuotteesi ja saranatyyppin mukaisesti.

A

Laita jääkaappi lattialle tai kallista sitä 45°, koska on tarpeen työskennellä laitteen pohjassa.

1

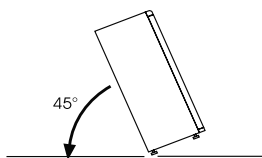

2

Irrota alasarana avaamalla ruuvit, tulppa ja alusrenkaat, irrota sitten alaovi.

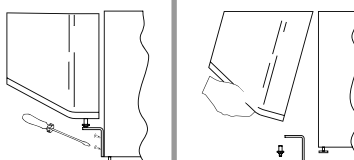

3

Irrota keskimäinen ruuvi ja irrota yläovi.

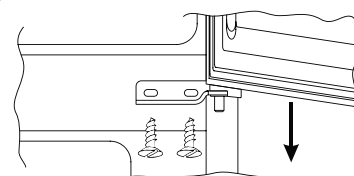

Poista tulpat (A) ja (B), kierrä ruuvit auki ja poista paneeli osittain.

4

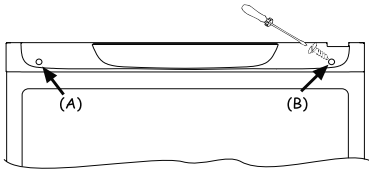

Ruuvaa oikea sarana irti.

5

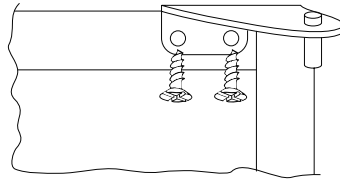

Lävistä paneelissa oleva vasemmanpuoleinen lovi merkin kohdalta.

6

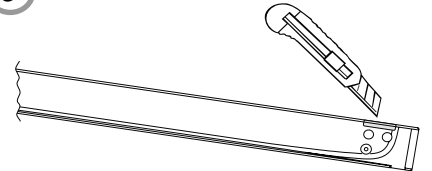

Ota vasen yläsarana laitteen mukana toimitettavasta välinepakkauksesta ja aseta se paikalleen.

7

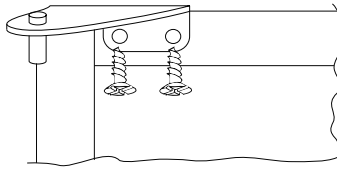

Poista tulppa vasemmalta puolelta ja laita se oikealle puolelle keskimmäiseen ja alempaan reikään.

8

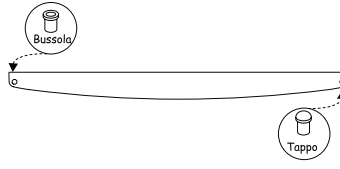

Kokoa saranat ja ovet paikalleen järjestyksessä ylhäältä alas, 1 → 2 → 3

9

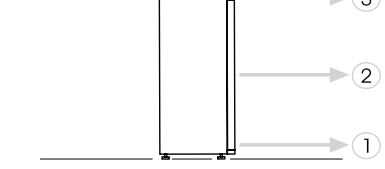

B

Laita jääkaappi lattialle tai kallista sitä 45°, koska on tarpeen työskennellä laitteen pohjassa.

1

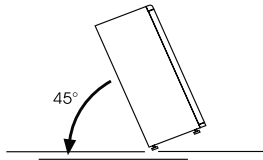

Irrota alasarana avaamalla ruuvit, tulppa ja alusrenkaat, irrota sitten alaovi.

2

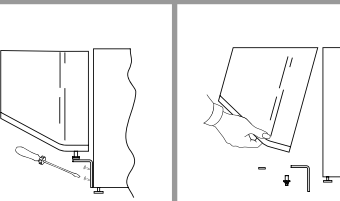

Ruuvaa keskimäinen sarana irti ja irrota yläovi.

3

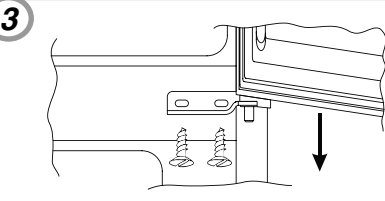

Ruuvaa sarana irti jääkaapin ovesta ja asenna toimitettu ovi toiselle puolelle.

4

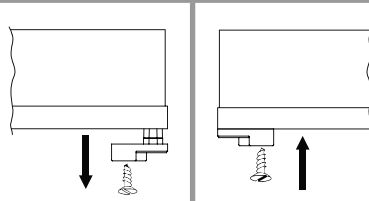

Vaihda suojatulppa toiselle puolelle.

5

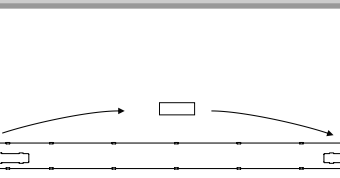

Poista paneelin suojatulppa.

6

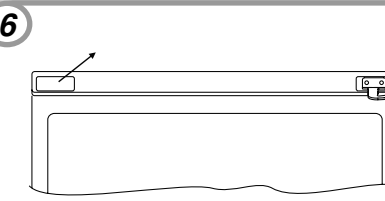

Ota vasen yläsarana laitteen mukana toimitettavasta välinepakkauksesta ja aseta se paikalleen.

7

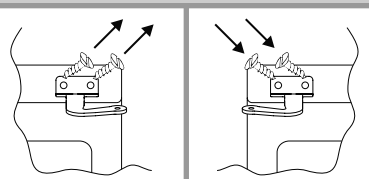

Laita tappi saranaan.

8

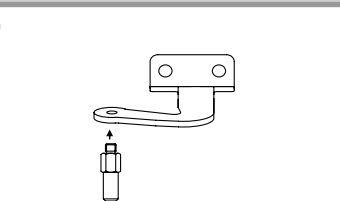

Laita paneelin suojatulppa paikalleen.

9

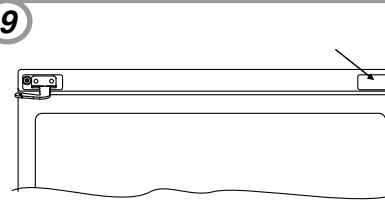

Poista tulppa vasemmalta puolelta ja laita se oikealle puolelle keskimmäiseen ja alempaan reikään.

10

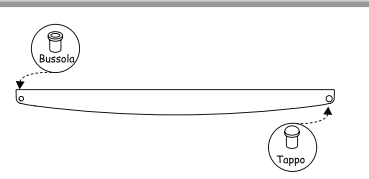

Asenna saranat ja ovet paikoilleen alhaalta ylöspäin. 1 → 2 → 3

11

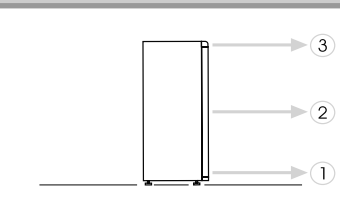

Kahvojen kätisyyden vaihto: Poista tapit ovien oikealta puolelta.

12

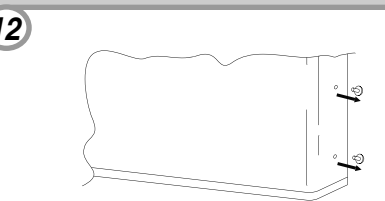

Ruuvaa kahvat irti vasemmalta ja siirrä ne oikealle. Aseta sitten tapit ovien vasemmalle puolelle.

13

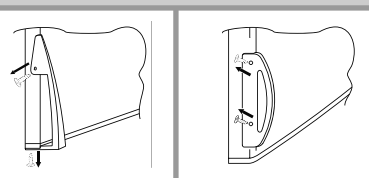

DOBBEL DØR

KONTROLLPANEL

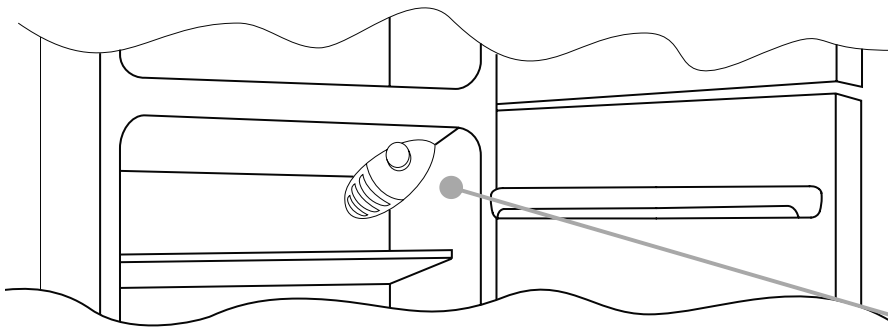

Termostatboksen som kontrollerer apparatet befinner seg oppe til høyre i kjøledelen. For å kontrollere at apparatet virker, må du sjekke at termostatens bryter ikke står på „0“.

AVISING OG FRYSING

Merkeskiltet oppgir den maksimale mengden av matvarer som kan fryses ned, (se figur 2). Uansett bryterens innstilling er du garantert frysing.

(Figur 2)

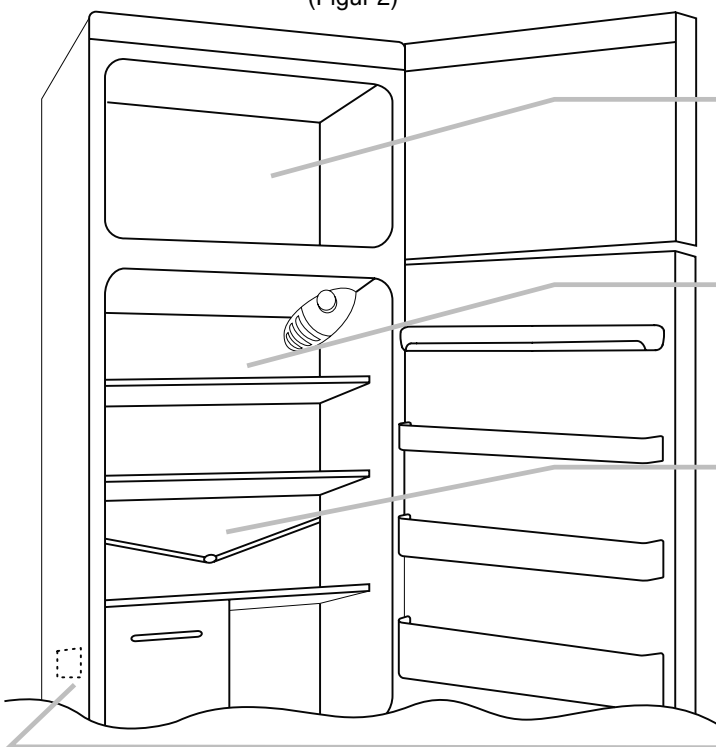

Avising av kjøledelen foregår automatisk på dette produktet.

Vi anbefaler at du aviser frysedelen når islaget blir tykkere enn 3 mm.

Det er normalt med litt rim og vanndråper bakerst i kjøleskapet når det er i drift.

Forsikre deg om at avløpshullet alltid er rent. Pass på at matvarene ikke kommer i kontakt med veggene til kjøleskapet.

N.B. Dette er merkeskiltet. Hvis du blir nødt til å kontakte vår serviceavdeling i tilfelle feil, oppgi dataene på merkeskiltet.

Viktig: Dersom romtemperaturen er veldig høy, vil apparatet sannsynligvis fungere uten stans. Dette kan forårsake at det danner seg unormalt mye rim på den bakre kjøleskapsveggen. Dersom dette skulle oppstå, vrir du knappen til en lavere innstilling (1-2).

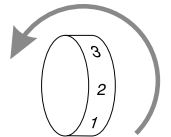

OMHENGLING AV DØRENE

For å snu døråpningen, følg instruksjonene i forhold til montering og hengseltypen for ditt produkt.

A

Plasser eller vipp kjøleskapet i en vinkel på 45°, siden du må arbeide fra apparatets underside

1

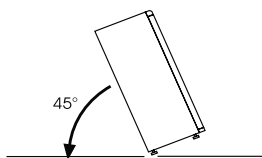

Fjern det nederste hengselet ved å fjerne skruer, plugg og lister, fjern så den nedre døren

2

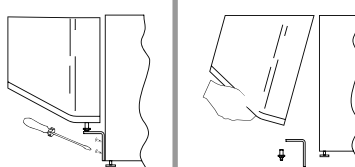

Fjern midtskruen og fjern den øverste døren

3

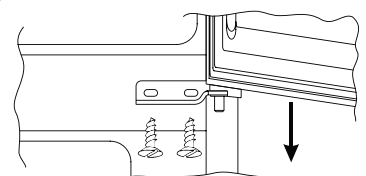

Fjern hettene (A) og (B), skru av skruene og trekk dekelet delvis av.

4

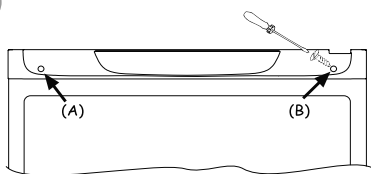

Skru ut det høyre hengslet

5

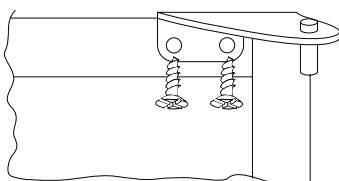

Marker den venstre åpningen på panelet

6

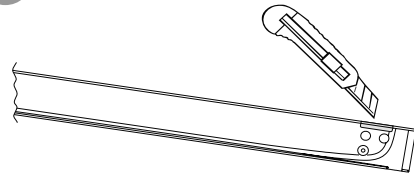

Snu det øverste, venstre hengslet som du finner i tilbehøret

7

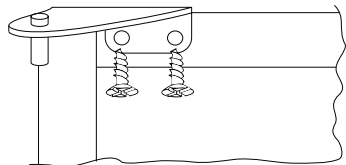

Fjern pluggen fra venstre siden og sett den inn på høyre side.

8

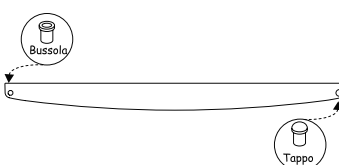

Remonter hengsler og dører og arbeid nedenfra og oppover, 1 → 2 → 3

9

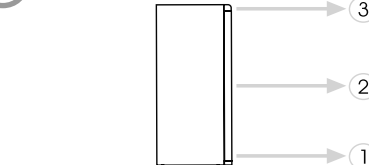

B

Plasser eller vipp kjøleskapet i en 45° vinkel, slik at du kan arbeide fra apparatets underside

1

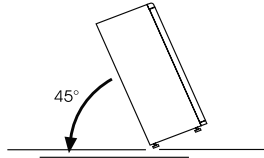

Fjern nederste hengsle ved å skru ut skruene, fjern pluggen og pakningene før du fjerner den nederste døren.

2

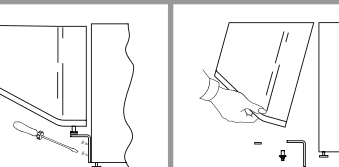

Skru ut det midtre hengslet og fjern den øverste døren

3

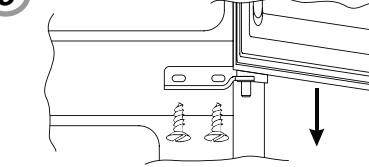

Skru av hengslet på kjøleskapsdøren og monter den som følger med på den andre siden

4

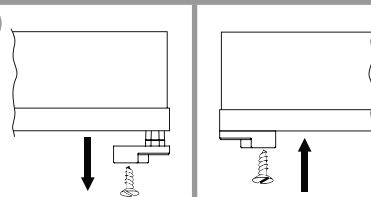

Klargjør åpningen for lukkepluggen

5

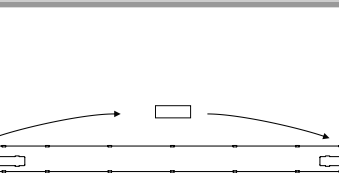

Fjern lukkepluggen på panelet

6

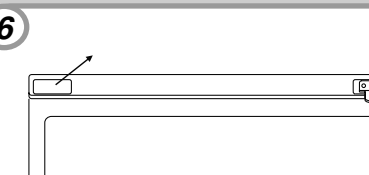

Snu det øverste, venstre hengslet som du finner i tilbehøret

7

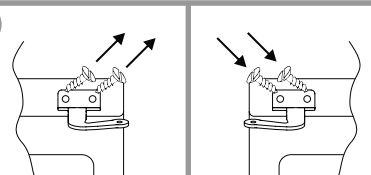

Sett pluggen inn i hengslet.

8

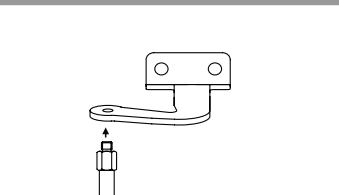

Plasser lukkepluggen på panelet

9

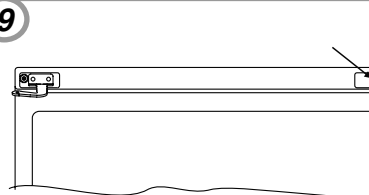

Fjern pluggen på venstre side og flytt den til høyre side.

10

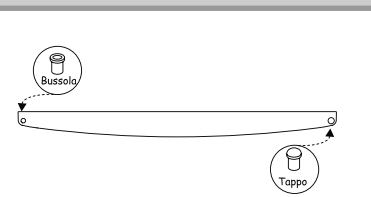

Monter hengsler og dører ved å arbeide nedenfra og oppover. 1 → 2 → 3

11

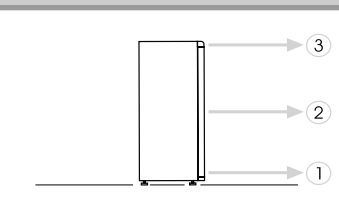

For å flytte håndtakene til motsatt side: Fjern hettene som sitter på dørens høyre side

12

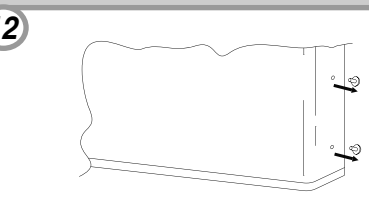

Skru av håndtakene og flytt dem over på høyre side. Flytt så hettene over på venstre side.

13

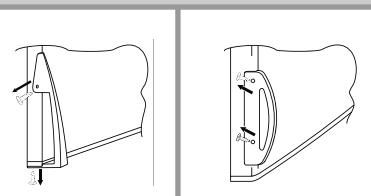

DUBBELDÖRR

KONTROLLPANEL

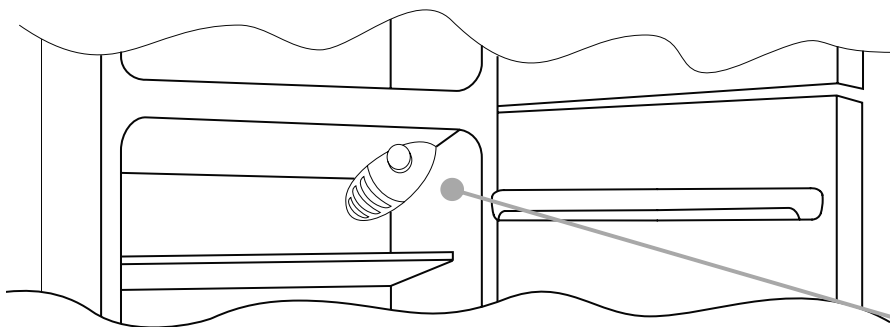

Termostatboxen för att kontrollera apparaten är placerad inuti kylskåpsutrymmet uppe till höger. För att kontrollera om apparaten fungerar, säkerställ att termostatvredet inte är inställt på „0“.

AVFROSTNING och INFrysNING

Den maximala mängden matvaror som kan frysas in finns angiven på märkplåten, (se figur 2).

Infrysningen är säkerställd med vilken vredinställning som helst.

(Figur 2)

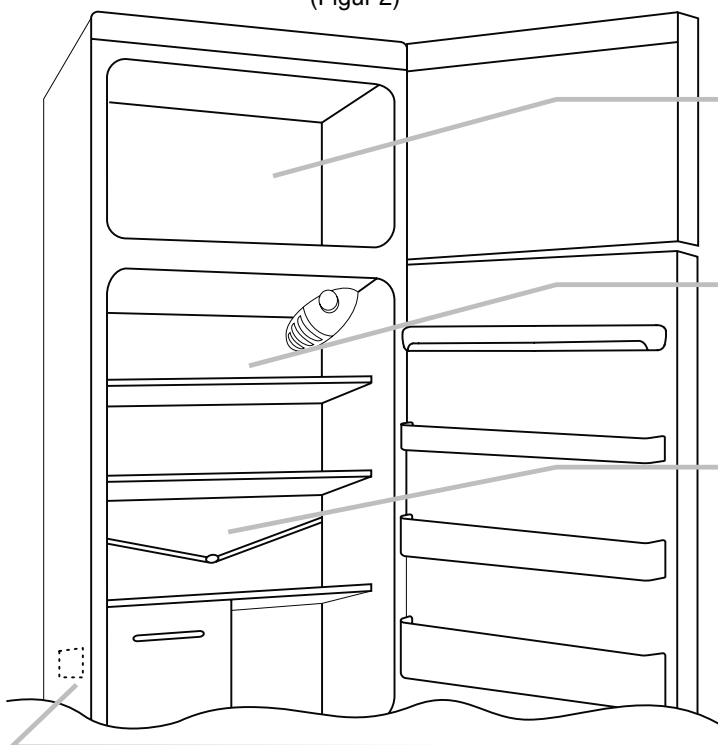

Avfrostning av kylutrymmet sker automatiskt på denna produkt.

Vi rekommenderar att du frostar av frysen när frostlagret har blivit mer än 3 mm tjockt.

Det är normalt att en liten mängd frost eller vattendroppar bildas på baksidan av kylutrymmet när kylskåpet fungerar.

Säkerställ att vattenutloppet är alltid rent. Se till att matvaror inte vidrör baksidan eller sidorna i kylutrymmet.

OBS! Detta är märkplåten. Om du behöver kontakta service för eventuella fel, kom ihåg att ge dem informationen som finns på den här plåten.

Viktigt: Om rumstemperaturen är mycket hög, kan apparaten fungera kontinuerligt och ett frostlager avsätter sig då på baksidan av kylutrymmet. I det här fallet, vrid vredet till en lägre inställning (1-2).

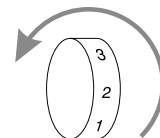

OMHÄNGNING AV DÖRRAR

För att hänga om dörrarna, följ anvisningarna rörande insats och gångjärnstyp som din produkt är försedd med.

A

Placera eller vält kylskåpet i en 45° vinkel, eftersom det är nödvändigt att arbeta på botten av apparaten.

1

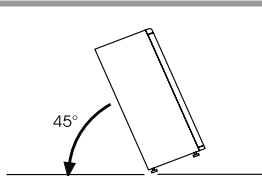

2

Avlägsna det undre gångjärnet genom att avlägsna skruvarna, pluggen och brickorna, avlägsna sedan bottendörren



3

Avlägsna den mittersta skruven och avlägsna den övre dörren

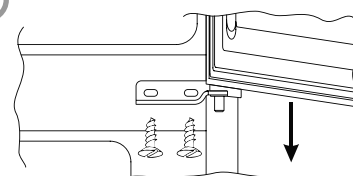

Avlägsna täckpluggarna (A) och (B), skruva loss skruvarna och avlägsna delvis panelen

4

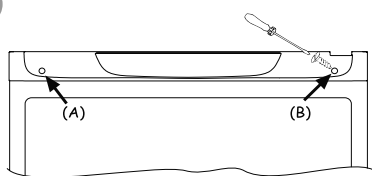

Skruva loss det högra gångjärnet.

5

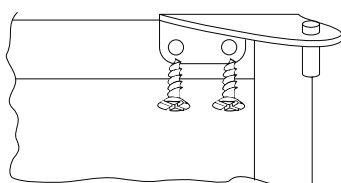

Markera och bryt den vänstra springan på panelen, i inpassningsområdet.

6

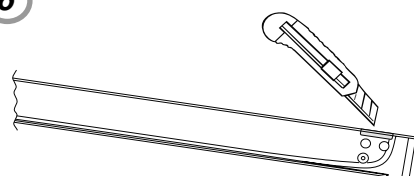

Fäst det övre vänstra gångjärnet som ligger i tillbehörssatsen

7

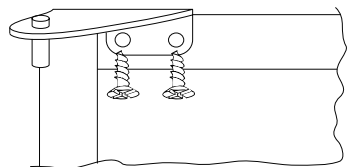

Ta bort pluggen på den vänstra sidan och sätt i den på den högra sidan av den mellersta och undre insatsen.

8

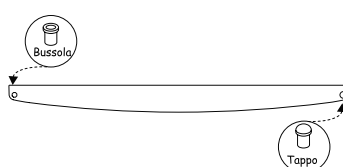

Återmontera gångjärnen och dörrarna uppifrån och ner 1 → 2 → 3

9

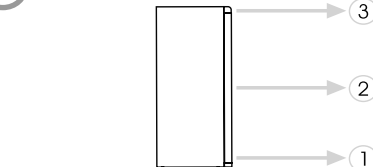

B

Placera eller vält kylskåpet i en 45° vinkel, eftersom det är nödvändigt att arbeta på botten av apparaten.

1

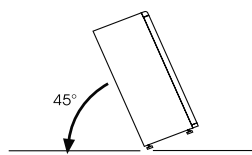

Avlägsna det undre gångjärnet genom att avlägsna skruvarna, pluggen och brickorna, avlägsna sedan bottendörren.

2

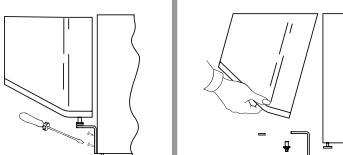

Skruva loss det mittersta gångjärnet och avlägsna den övre dörren

3

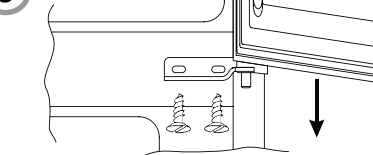

Skruva loss gångjärnet från kylskåpsdörren och montera det medlevererade på den motsatta sidan

4

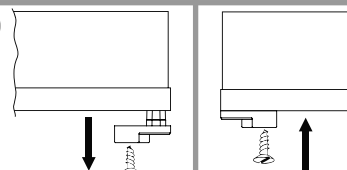

Kasta om läget av insatsens förslutningsplugg

5

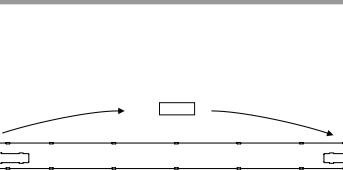

Avlägsna panelens förslutningsplugg

6

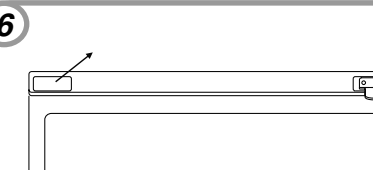

Fäst det övre vänstra gångjärnet som ligger i tillbehörssatsen

7

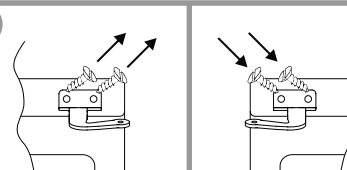

Sätt i stiftet i gångjärnet.

8

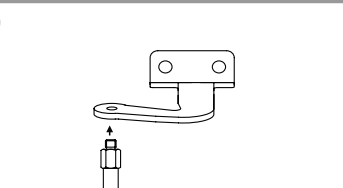

Placera panelens förslutningsplugg

9

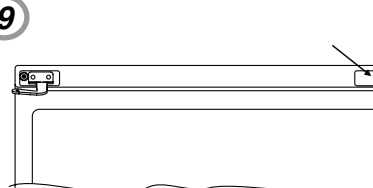

Ta bort pluggen på den vänstra sidan och sätt i den på den högra sidan av den mellersta och undre insatsen.

10

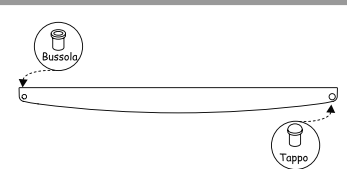

Montera gångjärnen och dörrarna från botten och uppåt. 1 → 2 → 3

11

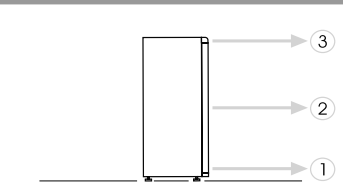

För att kasta om handtagen: Ta bort de yttre täckpluggarna från dörrens högra sida

12



Skruva loss handtagen från den vänstra sidan och flytta dem till produktens högra sida, placera sedan de yttre täckpluggarna på den vänstra sidan av dörrarna.

13

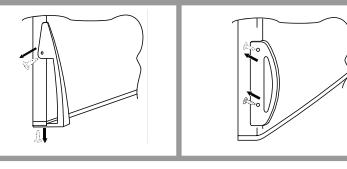

TO DØRE

KONTROLPANEL

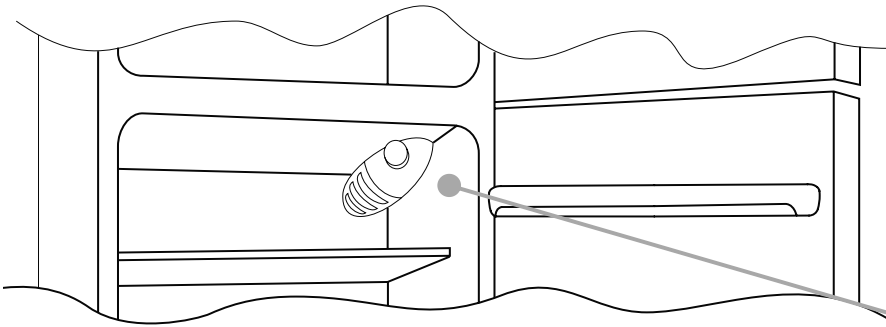

Den termostatboks, der styrer temperaturen i skabet, sidder indvendig i køleafdelingen foroven til højre. Når det kontrolleres, om skabet fungerer, skal det sikres, at termostatknappen ikke står på „0“.

Afrimning og nedfrysning

*Typeskiltet angiver den maksimale mængde madvarer, der kan nedfryses, (se figur 2). Frysefunktionen fungerer uanset termostatknappens stilling.

(Figur 2)

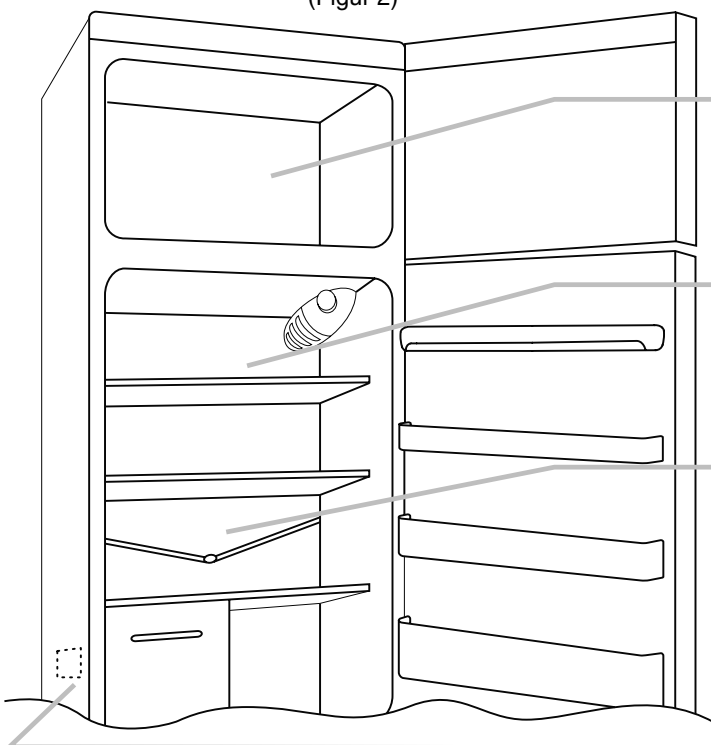

Dette produkt har automatisk afrimning af køleafdelingen.

Vi anbefaler, at fryseren afrimes, hvis rimlaget er mere end 3 mm tykt.

En smule rim eller vanddråber bagest i køleafdelingen, når skabet kører, er helt normalt

Sørg for, at vandfløbet altid er rent. Sørg for, at madvarer ikke rører bagest eller på siderne inde i køleskabet

NB. Dette er typeskiltet. Hvis De har behov for at kontakte vores kundeservice i forbindelse med fejl, skal De bruge de oplysninger, der står på typeskiltet.

Vigtigt: Ved meget høj rumtemperatur kører skabet måske kontinuerligt med det resultat, at der afsættes et lag rim bagest i køleafdelingen. I så fald skal knappen drejes til en lavere indstilling (1-2).

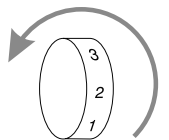

DØRHÆNGSLING I MODSAT SIDE

Hvis dørene ønskes hængslet i den modsatte side, henvises til de medfølgende anvisninger vedrørende de ophæng og hængsler, der er anvendt i Deres model.

A

For at kunne arbejde på skabets bund er det nødvendigt at anbringe eller tippe det i en vinkel på 45°

1

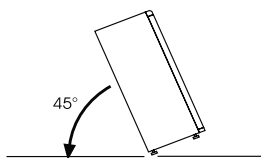

2

Fjern det nederste hængsels skrue, plug og spændeskiver, og tag den nederste dør af

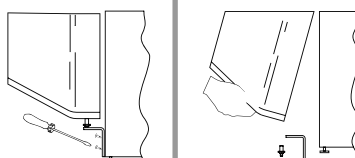

3

Fjern den midterste skruer, og tag den øverste dør af

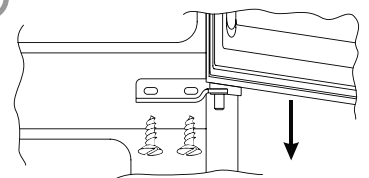

Fjern hæfterne (A) og (B), løs skruerne, og fjern panelet delvist.

4

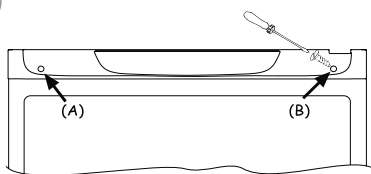

-Skrue højre hængsel af

5

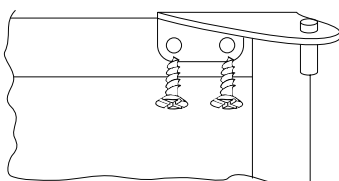

Marker og bryd rillen i panelet i venstre side af panelet i indsætningsområdet.

6

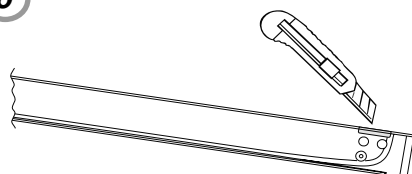

Slå let på øverste venstre hængsel, som findes i tilbehørssættet

7

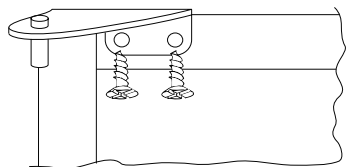

Fjern propperne i venstre side, og sæt dem i i højre side i midterste og nederste ophæng.

8

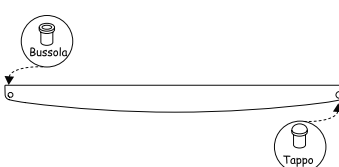

Sæt hængsler og døre på igen nedfra og op efter 1 → 2 → 3

9

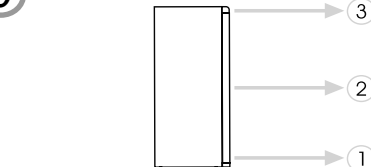

B

For at kunne arbejde på skabets bund er det nødvendigt at anbringe eller tippe det i en vinkel på 45°

1

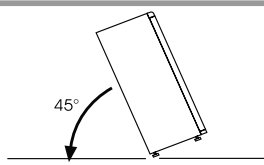

Fjern det nederste hængsel ved at fjerne skruer, plug og spændeskiver, hvorefter den nederste dør tages af.

2

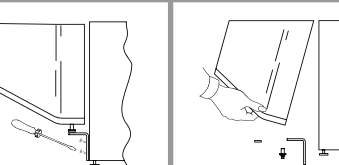

Skrue det midterste hængsel af, og fjern den øverste dør

3

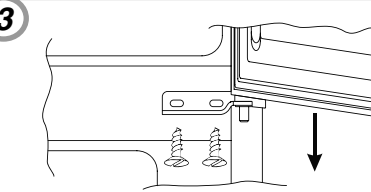

Skrue hængslet af køleskabsdøren, og monter det medfølgende hængsel i den modsatte side.

4

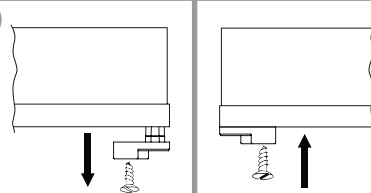

Flyt ophængets prop til den anden side

5

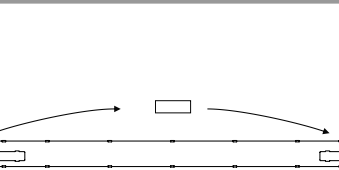

Tag dækproppen ud af panelet

6

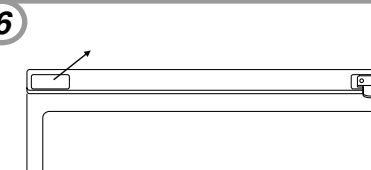

Slå let på øverste venstre hængsel, som findes i tilbehørssættet

7

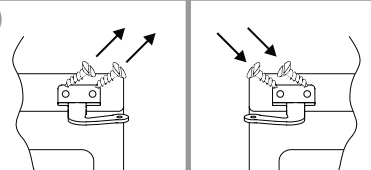

Sæt stiften i hængslet.

8

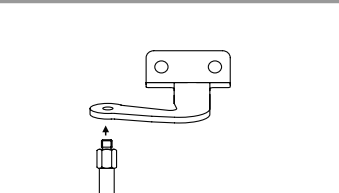

Sæt proppen i panelet.

9

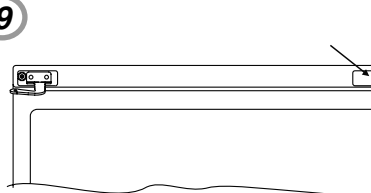

Fjern propperne i venstre side, og sæt den i i højre side i midterste og nederste ophæng.

10

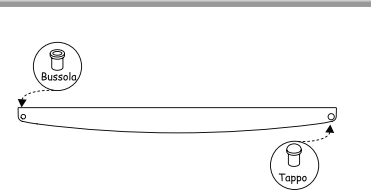

Saml hængslerne og dørene igen fra bunden og op efter 1 → 2 → 3

11

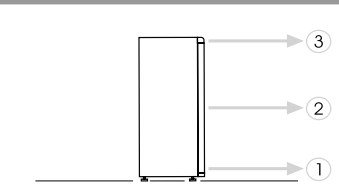

Sådan vendes håndtagene: Fjern dækpropperne på højre side af dørene

12

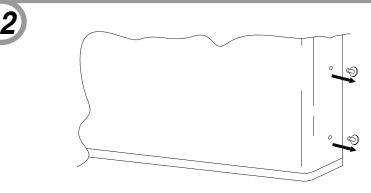

Skrue håndtagene af på venstre side, og flyt dem til skabets højre side. Sæt dækpropperne i på venstre side.

13

