

BOX CONTENTS - CONTENU DE L'EMBALLAGE - CONTENIDO DE LA CAJA



Docking Adapter



USB Cable



A/C Charger Adapter



This Instruction Sheet

CONNECTING THE ADAPTER - CONNEXION DE L'ADAPTATEUR - CONEXIÓN DEL ADAPTADOR



Carefully connect/disconnect the adapter to/from your ARCHOS device. Do not force: you could break the connectors!
Connectez/déconnectez l'adaptateur à/de votre baladeur ARCHOS avec soin. Ne forcez pas : vous pourriez endommager les connecteurs !
Conecte/Desconecte cuidadosamente el adaptador a/de su aparato ARCHOS. ¡No lo force: podría dañar los conectores!

USB CONNECTION - CONNEXION USB - CONEXIÓN USB

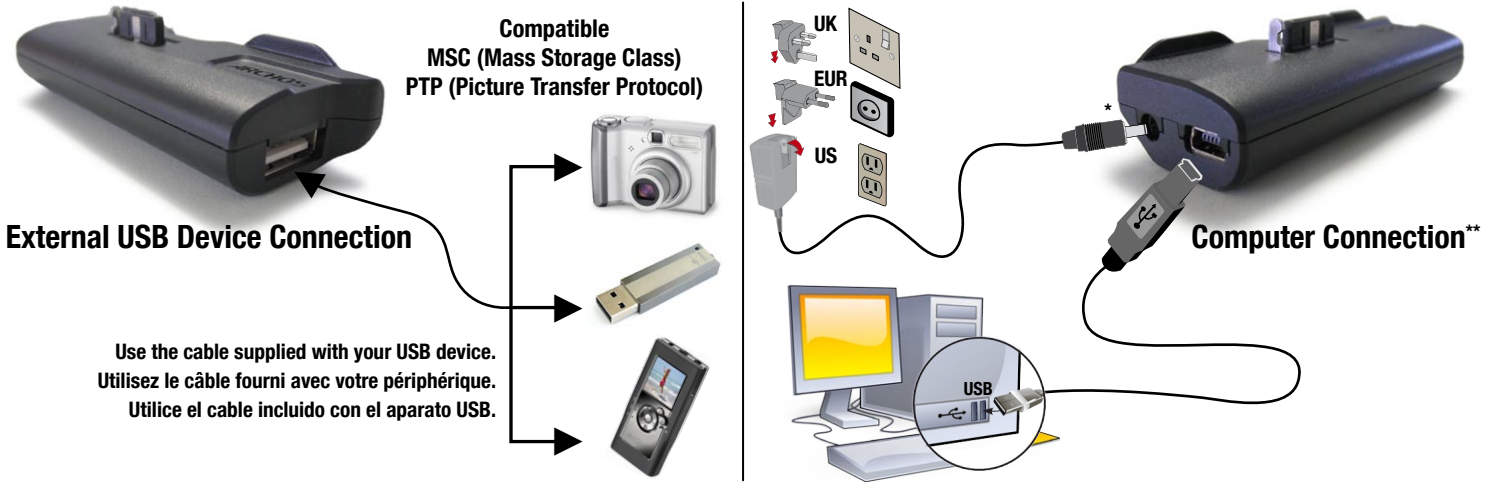

* Use only the supplied A/C Charger Adapter. ** See the 'Computer Connection' section of your ARCHOS device's User Manual.
ATTENTION: DO NOT USE BOTH USB CONNECTIONS AT THE SAME TIME!

* Utilisez uniquement le chargeur fourni. ** Consultez la section « Connexion à l'ordinateur » du manuel de votre baladeur ARCHOS.
ATTENTION : N'UTILISEZ PAS LES DEUX TYPES DE CONNEXION USB EN MÊME TEMPS !

* Solo use el cargador incluido con su aparato. ** Vea la sección « Conexión a su ordenador » de su manual de usuario del aparato ARCHOS.
ATENCIÓN: ¡NO CONECTE LOS DOS TIPOS DE CABLE USB AL MISMO TIEMPO!

FOR FURTHER INFO... - POUR PLUS D'INFOS... - PARA MÁS INFORMACIÓN...

See the user manual of your ARCHOS device to learn how to transfer files, connect an external device, etc.
Consultez le manuel de votre baladeur ARCHOS pour apprendre comment transférer des fichiers, connecter un périphérique externe, etc.
Vea el manual del usuario de su ARCHOS para saber como transferir archivos, conectar aparatos periféricos, etc...

FCC Compliance

This equipment has been tested and found to comply with limits for a Class B digital device, pursuant to Part 15 of the FCC Rules. These limits are designed to provide reasonable protection against harmful interference in a residential installation. This equipment generates, uses and can radiate radio frequency energy and, if not installed and used in accordance with instructions, may cause harmful interference to radio communications. However, there is no guarantee that interference will not occur in a particular installation. If this equipment does cause harmful interference to radio or television reception, which can be determined by turning the equipment off and on, the user is encouraged to try to correct the interference by one or more of the following measures:

- Reorient or relocate the receiving antenna.
- Increase the separation between the equipment and receiver.
- Connect the equipment into an outlet on a circuit different from that to which the receiver is connected.
- Consult the dealer or an experienced radio/TV technician for help.

CAUTION: Modifications not authorized by the manufacturer may void users authority to operate this device.

FCC Part 15 - Operation is subject to the following two conditions:

- 1 This device may not cause harmful interference;
- 2 This device must accept any interference received including interference that may cause undesired operation.

Errors or omissions excepted. Images and illustrations may not always match contents. Actual box contents may vary and are subject to change without prior notice. All the information contained in this document was correct at the time of publication. COPYRIGHT ARCHOS™ © 2006. All rights reserved.

LIEFERUMFANG - CONTENUTO DELLA CONFEZIONE - INHOUD VAN DE DOOS



Docking Adapter



USB Cable



A/C Charger Adapter

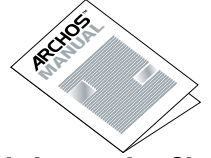

This Instruction Sheet

DEN ADAPTER ANSCHLIESSEN - CONNETTERE L'ADATTATORE - AANSLUITEN VAN DE ADAPTER



ARCHOS Geräte ohne Standfuß:
Dispositivo ARCHOS senza base:
ARCHOS apparaten zonder stander:



Den Adapter vorsichtig an Ihren ARCHOS anschließen. Bei unvorsichtigem Vorgehen könnten Sie die Anschlüsse beschädigen.
Attenzione alla connessione/disconnessione dell'adattatore dal vostro dispositivo ARCHOS. Non forzare: potresti rompere i connettori!
Sluit de adapter voorzichtig aan/af op/van uw ARCHOS apparaat. Forceer niet: u zou de aansluitingen kunnen beschadigen!

USB ANSCHLUSS - CONNESSIONE USB - USB AANSLUITING

External USB Device Connection

Compatible
MSC (Mass Storage Class)
PTP (Picture Transfer Protocol)

Benutzen Sie das, im Lieferumfang beinhaltete Kabel für den Anschluß von USB-Geräten.
Il cavo è fornito con il tuo dispositivo USB.
Gebruik de kabel die met uw USB apparaat meegeleverd is.

Computer Connection**

* Nutzen Sie ausschließlich den, im Lieferumfang enthaltenen A/C-Adapter/Ladegerät. ** Schauen Sie in den Abschnitt 'Computer anschließen' im User Manual Ihres ARCHOS.
ACHTUNG: BENUTZEN SIE NIEMALS BEIDE USB-ANSCHLÜSSE GLEICHZEITIG!
* Utilizzare solamente il caricabatterie fornito. ** Consulta la sezione "Connessione al Computer" del manuale del vostro dispositivo ARCHOS.
ATTENZIONE: NON UTILIZZARE MAI I DUE TIPI DI CONNESSIONI USB ALLO STESSO TEMPO!
* Gebruik alleen de geleverde A/C oplaadadapter. ** Zie de sectie 'Computer Aansluiting' in de handleiding van uw ARCHOS apparaat.
ATTENTIE: GEBRUIK DE BEIDE USB AANSLUITINGEN NIET TEGELIJKERTIJD!

FÜR WEITERE INFORMATIONEN... - PER MAGGIORI INFORMAZIONI... - VOOR MEER INFORMATIE...

Das User Manual Ihres ARCHOS erklärt, wie Sie Dateien übertragen, externe Geräte anschließen, etc.
Consultare il manuale del vostro dispositivo ARCHOS per comprendere come trasferire i files, connettere ad una periferica esterna, etc.
Raadpleeg de handleiding van uw ARCHOS apparaat om te lezen hoe bestanden over te zetten, een extern apparaat aan te sluiten, enz.

FCC Compliance

This equipment has been tested and found to comply with limits for a Class B digital device, pursuant to Part 15 of the FCC Rules. These limits are designed to provide reasonable protection against harmful interference in a residential installation. This equipment generates, uses and can radiate radio frequency energy and, if not installed and used in accordance with instructions, may cause harmful interference to radio communications. However, there is no guarantee that interference will not occur in a particular installation. If this equipment does cause harmful interference to radio or television reception, which can be determined by turning the equipment off and on, the user is encouraged to try to correct the interference by one or more of the following measures:

- Reorient or relocate the receiving antenna.
- Increase the separation between the equipment and receiver.
- Connect the equipment into an outlet on a circuit different from that to which the receiver is connected.
- Consult the dealer or an experienced radio/TV technician for help.

CAUTION: Modifications not authorized by the manufacturer may void users authority to operate this device.

FCC Part 15 - Operation is subject to the following two conditions:

- 1 This device may not cause harmful interference;
- 2 This device must accept any interference received including interference that may cause undesired operation.

Errors or omissions excepted. Images and illustrations may not always match contents. Actual box contents may vary and are subject to change without prior notice. All the information contained in this document was correct at the time of publication. COPYRIGHT ARCHOS™ © 2006. All rights reserved.