

Brandt

FR GUIDE D'INSTALLATION & D'UTILISATION
EN OPERATING AND INSTALLATION INSTRUCTIONS

Réfrigérateur-Congélateur Fridge-Freezer



Brandt

Dear Customer,

You have just acquired a **BRANDT fridge-freezer** and we would like to thank you.

We have invested all our dedication and know-how in this appliance so that it would best meet your needs. With innovation and performance, we designed it to be always easy to use.

In the **BRANDT** product range, you will also find a wide choice of dishwasher, washing machine and dryer, freezers, cooker range and oven, cooking hobs and ventilation hoods, that you can coordinate with your new **BRANDT fridge-freezer**.

Visit our website www.brandt.com where you will find all of our products, as well as useful and complementary information.

BRANDT

As part of our commitment to constantly improving our products, we reserve the right to make changes to them based on technical advances to their technical and functional features and appearance.



Warning:

Before installing and using your appliance, please carefully read this Guide to Installation and Use, which will allow you to quickly familiarise yourself with its operation.

www.brandt.com

1	Safety and the environment	
•	Safety instructions.....	30
•	Respecting the environment and saving energy.....	31
•	BIOCARE - anti-bacterial walls	31
2	Description of your appliance	
3	How to carry out your initial installation	
•	Reversing the direction the doors open	33
•	Installing your appliance.....	35
•	Electrical connection.....	36
4	Starting and setting the appliance	
•	Starting and adjusting the appliance	37
•	Mixed or regulated cold (depending on the model)	39
•	Preparing food for the refrigerator	40
•	Arranging food in your refrigerator	40
•	Your refrigerator's modular layout.....	41
•	The Maxi-Fresh area (depending on the model).....	41
•	Automatic defrosting	41
5	How to use your freezer	
•	Frozen and deep-frozen food.....	42
•	Preparing food for freezing.....	42
•	Food freezing guide.....	43
•	Arranging food in your freezer	46
•	Quick freeze.....	46
•	Defrosting food	47
•	Defrosting your freezer.....	47
6	Ongoing maintenance of your appliance	
•	Cleaning your appliance.....	48
•	Changing the light bulb	49
•	Clearit.....	49
7	Noises, inconveniences and minor breakdowns	
•	Normal operating noises.....	50
•	Inconveniences or minor breakdowns	50

This guide to installing and using your fridge-freezer is applicable to several models. There may be slight differences between your appliance's details and features and those described here.

As you read through the guide, you will come across the following symbols, to warn you of:

 **Safety precautions that must be observed**

 **Danger of a gas bursting into flame**

 **An electrical danger**

 **Important information and advice**

This appliance is intended for domestic use only. It has been designed for preserving and freezing food.

⚠ The following instructions are for your own safety and should be observed without fail. We can neither be held responsible, nor uphold the guarantee in case of failure to observe these recommendations, which may lead to material damage or physical injury.

Your appliance must be installed, fixed if necessary and used in compliance with the instructions in this operating and installation instructions manual in order to avoid any damage and/or danger due to any lack of stability or faulty installation.

If the appliance has been delivered to your home in a horizontal position, stand it upright and then wait 2 hours before plugging it in. A small amount of oil may have flowed into the refrigeration circuit, and you must allow time for this to flow back towards the motor before connecting the appliance. Failure to do so may damage the appliance.

If your appliance is fitted with castors, please remember that they are only designed to assist in small movements. Do not use them for longer journeys.

Carry out an initial cleaning operation (see the section on "Installing your appliance") before connecting your appliance to the electrical supply. Disconnect your appliance prior to performing any maintenance operation. Grasp the plug directly, instead of pulling on the power cable.

Do not place bottles or jars containing liquids in the freezer unless they are only two-thirds full: freezing causes liquids to expand, which can cause the container to explode.

Do not use any other method than those we recommend in this manual for speeding up defrosting.

Do not use electrical equipment inside compartments designed for preserving frozen food unless the manufacturer recommends otherwise. Do not let children play with the appliance and keep your pets well away from it. Worn out appliances must be rendered unusable. Unplug and cut the electric cable flush with the appliance. Render the door catch unusable or, better still, remove the door, so as to ensure that no child or animal risks being shut inside whilst playing. If a problem arises that you are unable to resolve using the advice given (see the "Noise, inconveniences, minor breakdowns" section), please contact an official after-sales service or a qualified professional.

⚠ Your appliance's refrigeration circuit is filled with isobutane refrigerant (R600a), a natural, non-polluting gas that is, however, inflammable. Ensure that none of the components in your appliance's refrigeration circuit have been damaged during transport or installation. If you detect any damage, keep your appliance away from flames or any type of source of heat or combustion and ventilate it location.

To reduce your appliance's electrical consumption:

- Install it in a suitable place (see "Installation of your appliance" section).
- Leave the door open as little as possible. Do not place food that is still hot in your refrigerator or freezer, particularly in the case of soups or dishes that release a lot of steam.
- Ensure that your appliance operates optimally by not allowing too much frost to build up in the freezer (de-frost it when the frost is more than 5-6mm thick) and clean its condenser periodically (See the "Ongoing maintenance of your appliance" section).
- Periodically check the door seals and make sure that the doors close firmly. If they do not, please contact our After-sales service.

The packaging and all the components of your appliance are made from recyclable materials. Please take this into account when discarding them. Your supplier or your local council will be able to tell you about the possibilities for disposing of your appliance in an appropriate, environmentally-friendly manner.

In compliance with the latest legislation concerning environmental protection, your appliance does not contain any CFCs. Instead it

uses a gas called R600a. The exact type of refrigerant used in your appliance is also clearly indicated on the identification plate inside your appliance's refrigerator section, low down on the left-hand wall.

R600a is a non-polluting gas that does not harm the ozone layer and whose contribution to the greenhouse effect is virtually zero.

ENVIRONMENTAL PROTECTION

This appliance's packaging material is recyclable. Help recycle it and protect the environment by dropping it off in the municipal receptacles provided for this purpose.



Your appliance also contains a great amount of recyclable material. It is marked with this label to indicate the used appliances that should not be mixed with other waste. This way, the appliance recycling organised by your manufacturer will be done under the best possible conditions, in compliance with European Directive 2002/96/EC on Waste Electrical and Electronic Equipment. Contact your town hall or your retailer for the used appliance collection points closest to your home.

We thank you doing your part to protect the environment.

BIOCARE - anti-bacterial walls

This is a specific coating on the lining of your refrigerator consisting of silver ions, which prevent bacteria from developing.

The anti-bacterial coating does not require any particular treatment and remains active throughout your appliance's operating life.

However, you must clean your appliance regularly.

See the section on "Cleaning your appliance".

Description of your appliance

EN

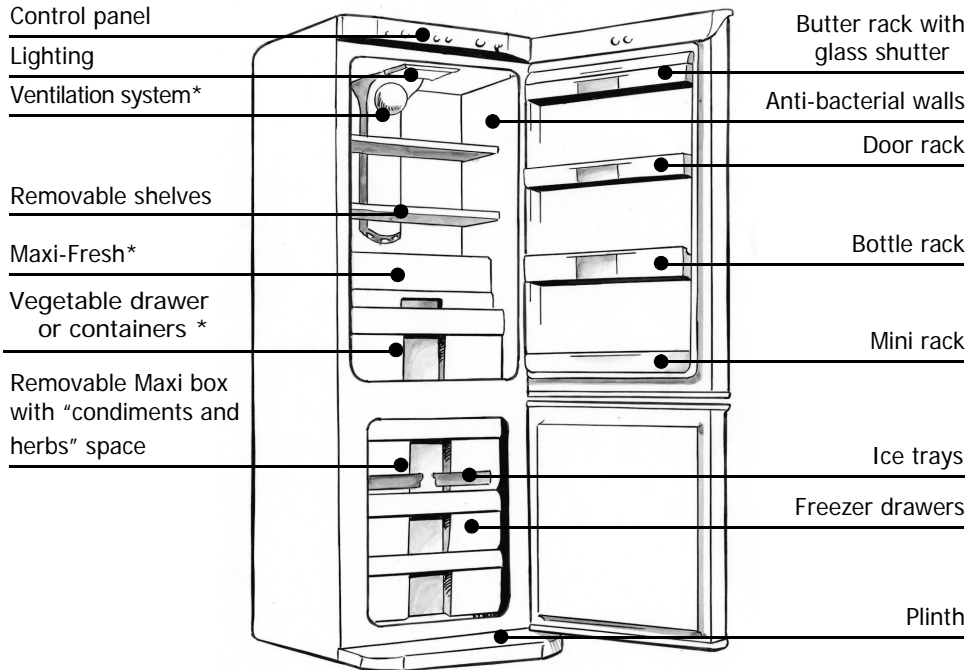

* depending on the model

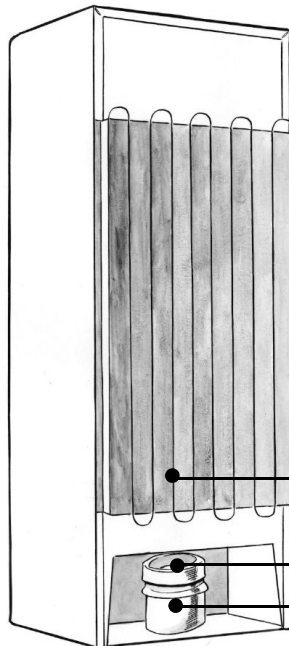

i This guide to installing and using your fridge-freezer is applicable to several models. There may be slight differences between your appliance's details and features and those described here.

Condenser

Water collection tank

Motor

The doors normally open to the left (hinges on the right); if you wish to open the door to the right, you can modify the direction in which it opens by following the instructions below. To ensure correct installation, please scrupulously follow the directions and the sequence of operations below.

1. Gently tilt the appliance backwards (with the doors facing upwards).
2. Remove the plinth by pulling the lugs **A** on the lower part towards you and swivelling the plinth upwards to disengage it (R1). Remove cover **B** from its housing on the left and insert it in the housing on the right (R2).
3. Remove the bottom hinge pin and release it from its housing **C** ; retrieve the plastic distance piece placed between the door and the hinge on the pin; unscrew the bottom hinge **D** and screw the pin into the left-hand hole in the hinge (R3).
4. Remove the freezer's door (R3).
5. Unscrew the middle hinge **E**, taking care not to lose the plastic distance pieces inserted on the pin (R3).
6. Remove the covers **G** on top of the refrigerator door (R4).
7. Free the refrigerator's door from the top hinge (R4).
8. Remove the screw and the covers **F** on the left-hand side of the appliance and insert them in the holes on the right-hand side (R3).
9. Remove the covers **H** from the control panel (R5).
10. Unscrew and remove the top right-hand hinge **I** (R5).

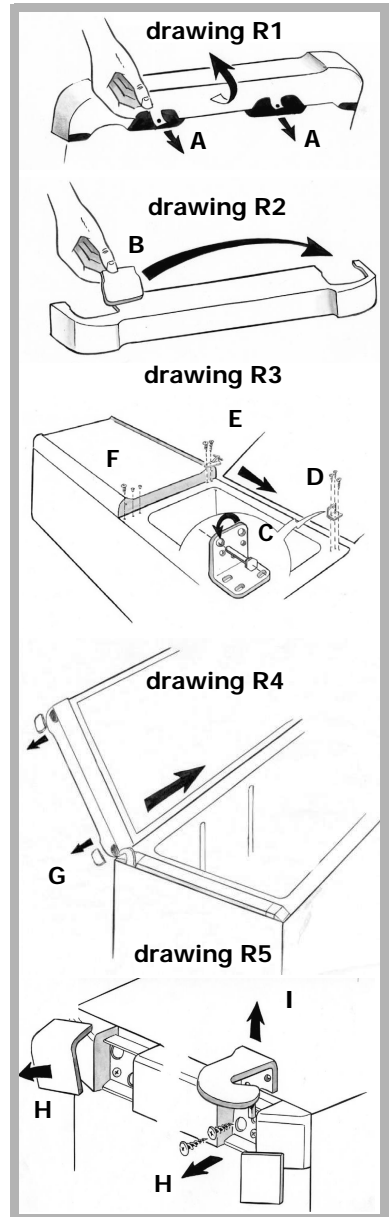

11. The upper left-hand hinge **L** is placed inside the plinth (R6). Remove it and inset it into the housing on the left on the control panel **M** . Fasten it with the two screws (R7).
12. Insert the covers **N** and fasten them onto the control panel (R7).
13. So as not to lose the top right-hand hinge, which you may need later, store it in the housing in the plinth (R6) .
14. Remove the hole covers **O** on the left-hand side of the freezer's door (R8).
15. Unscrew the metal door stop **P** on the right-hand side of the refrigerator's door, turn it over and screw it to the left-hand side of the freezer's door, aligning the hole in the plate with the one in the door (R8). Unscrew the metal door stop **P** on the right-hand side of the freezer's door, turn it over and screw it to the left-hand side of the refrigerator's door, aligning the hole in the plate with the one in the door (R8).
16. Insert the hole cover **O** , previously placed on the left-hand side of the freezer's door on the right-hand side of the same door (R8).
17. Insert the refrigerator's door in the top hinge (R9).
18. Insert the middle hinge and screw it in place, checking that the plastic distance pieces are correctly inserted on the pin (R9).
19. Insert the freezer's door into the middle hinge (R9).
20. Insert the bottom hinge into the freezer's door, checking that the plastic distance piece is correctly inserted on the pin between the hinge and the door. Screw the hinge in place. (R9).
21. Re-install the plinth.
22. Insert the upper covers .
23. Return the appliance to vertical position .

⚠ Wait two hours before restarting your refrigerator.

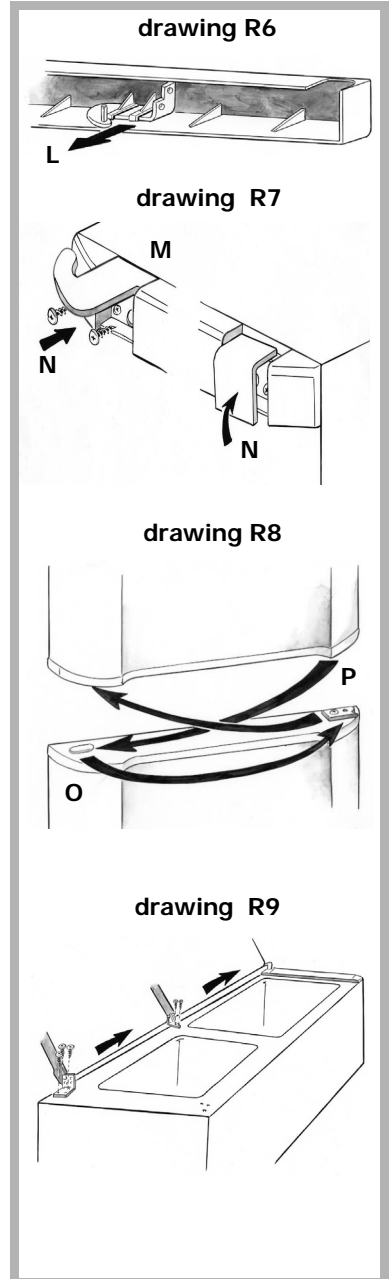

⚠ Your appliance must be installed in compliance with the instructions given in this "Operating and installation instructions manual" in order to keep your food under optimum conditions and with optimal energy consumption.

- The appliance should be installed in a dry, well-ventilated room.
- Avoid balconies, verandas, and patios: the excessive heat in summer and the cold in winter could prevent your appliance from functioning properly, or may even damage it.
- Do not place your appliance near a heat source such as an oven or radiator.
- Your appliance has been designed for optimum functioning at a certain ambient temperature; it is designed for a particular "climate class". This climate class is clearly indicated on the identification plate situated on the inside of your appliance, low down on the left wall. Outside of this temperature range, the performance of your appliance may be reduced.
- Leave a minimum distance between your refrigerator and your other units of 3 to 5cm at the sides and 10cm at the top, to maximise air circulation around the appliance.
- Position the appliance at a suitable distance from the wall using the spacers provided in the accessories packet. The spacers should be mounted on the back of the appliance (see Drawing).

Climate Class	Ambient temperature
SN	de +10 °C à +32 °C
SN/ST	de +10 °C à +38 °C
N	de +16 °C à +32 °C
T	de +18 °C à +43 °C
ST	de +18 °C à +38 °C

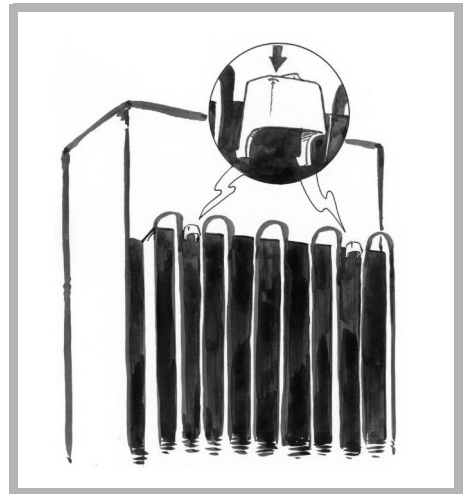

i Once you have installed your appliance, adjust its feet so that it is tilting backwards slightly: this helps the door to close correctly.

⚠ Before placing any food in your appliance, clean it inside and out with a bicarbonate of soda solution (1 dessertspoon of bicarbonate to 4 litres of water). Do not use alcohol, scouring powder or detergents, which could damage the surfaces. See the section on "Cleaning your Appliance".

 For your own safety, you must comply with the instructions given below.

The electrical installation must comply with Standard NF C *15-100, in particular concerning the Earth.

Three-core flex 3x2.5 mm², 230V single-phase connected to:

- A 20A single-phase 230V-50Hz supply
- An ELCB and an individual fuse (10 or 16A depending on the model)

We cannot be held responsible for any incident caused by faulty electrical installation.

 Recommendations for the electrical installation of your appliance :

- Do not use extension leads, adaptors, or socket strips.
- Always make sure your circuit is earthed.
- The socket must always remain accessible, yet be out of the reach of children.

 If you have any doubts, contact your installer.

Your appliance is compliant with European Directives CEE/73/23 (low voltage directive), CEE/89/336 (electromagnetic compatibility) and CEE/96/57 (energy efficiency) as well as their modifications.

 If the appliance has been delivered to your home in a horizontal position, stand it upright and then wait 2 hours before plugging it in. A small amount of oil may have flowed into the refrigeration circuit, and you must allow time for this to flow back towards the motor before connecting the appliance. Failure to do so may damage the appliance.

 Carry out an initial cleaning operation (see the section on "Installing your appliance") before connecting your appliance to the electrical supply. Disconnect your appliance prior to performing any maintenance operation. Grasp the plug directly, instead of pulling on the power cable.

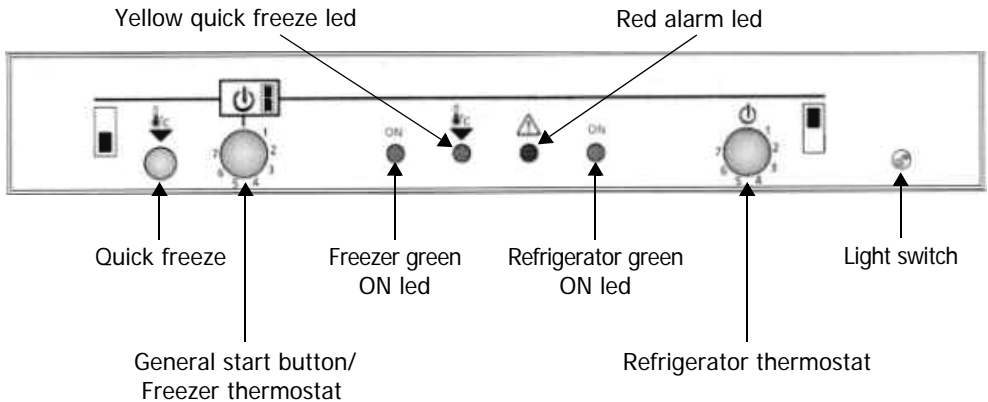

Starting the appliance and setting the freezer's thermostat

Turn the general "Start" knob to start the appliance. When you wish to interrupt the appliance's operation (including the refrigerator). Move the knob to position .

To set the freezer's temperature, turn the "Freezer Thermostat" knob.

Position 1 indicates the least cold setting; position 7 the coldest setting. AN intermediate setting is usually advisable.

Green "ON" LED

This LED lights up when the appliance starts.

⚠ WARNING! When the thermostat is in the  position and the "ON" LED is out, the appliance is still receiving power.

Disconnect the appliance before performing any work on it.

"Quick Freeze" button

The "Quick Freeze" function enables you to lower the freezer's temperature rapidly to the maximum extent in order to freeze a large amount of fresh food more quickly.

Press in the "Quick Freeze" button 24 hours before inserting the food in your freezer.

This function stops automatically after 52 hours unless you interrupt it manually before this.

Yellow "Quick Freeze" LED

This LED confirms that the "Quick Freeze" function has been activated.

Red "Alarm" LED

This LED indicates that the temperature in the freezer is too high (owing to a power failure, damage, etc.). Check that the food in the freezer has not defrosted, even partially, and activate the "Quick Freeze" function. Keep the door closed. After approximately 2 hours check that the red LED has gone out. Then set the thermostat, if necessary, to a colder setting.

If the LED remains lit, call your After-Sales Service.

The red LED may light for a brief period during rapid freezing, when the door is kept open for a prolonged period or when inserting a large quantity of fresh food.

Setting the refrigerator's thermostat

To adjust the refrigerator's temperature, turn the "Refrigerator Thermostat" knob on the control panel. Position 1 indicates the least cold setting; position 7 the coldest setting.

When putting your appliance into service, set the thermostat to a medium position.

Check the temperature indicator 4 hours after putting your appliance into service, or after any change in the thermostat setting, observe the temperature light (Drawing 1):

- If the indicator is still black, lower the temperature gradually by selecting a higher number around the thermostat and checking the temperature indicator again after 4 hours. Repeat this operation as many times as necessary.
- If the indicator goes green and "OK" is indicated, the temperature in your refrigerator is correctly set.

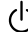
The pointer  interrupts the refrigerator compartment's operation while leaving the freezer compartment running.

Green "ON" LED

This LED lights up when the refrigerator starts.

Temperature indicator and "Cold Zone" symbols



You will find the symbol opposite in your refrigerator. It clearly shows the location of your appliance's coldest zone: the temperature here is +4°C or less. A temperature indicator here enables you to check that your refrigerator is working correctly:

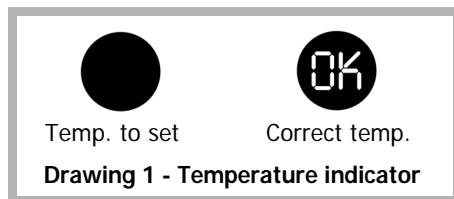

⚠ Prolonged opening of the door will cause the internal temperature to rise. You must therefore read the indicator within 30 seconds of the door being opened for the reading to be correct.

WARNING! The internal temperature's are influenced by the ambient temperature, the frequency with which the doors are opened and the amount of food inserted. You can choose the position that provides the best temperature for the particular case.

You are strongly advised to use the thermostat differently in extreme environmental conditions. When the surrounding temperature is very hot (e.g. in summer) it is advisable to set the thermostat to the minimum setting. Conversely, in winter, when the surrounding temperatures are cold, it is advisable to set the thermostat to the maximum setting.

Light switch

You can switch off the refrigerator's light by pulling this knob.

i This guide to installing and using your fridge-freezer is applicable to several models. Your appliance is equipped with one or other of these functions. You can check very quickly by comparing your refrigerator to the illustrations on this page.

Your appliance is equipped with a cold air ventilation system:

- **Mixed cold (A):** the fan mixes the air in the refrigerator section, providing greater temperature homogeneity and avoiding condensation forming on the glass shelves.
- **Regulated cold (B):** a distribution column directs the air to every level, providing a very homogeneous temperature and avoiding any condensation forming on the shelves.

Apart from these everyday advantages, we recommend that you use the fan:

- When the climatic conditions are extreme (e.g. a heat wave)
- If you have just placed a large amount of food in your appliance's refrigerator section.

To start the fan:

Press the ON button (Drawing C)

i The fan does not operate continuously. When it starts up depends on the refrigerator's internal temperature. It is therefore quite normal for the fan not to operate sometimes when the Start button has been correctly pressed..

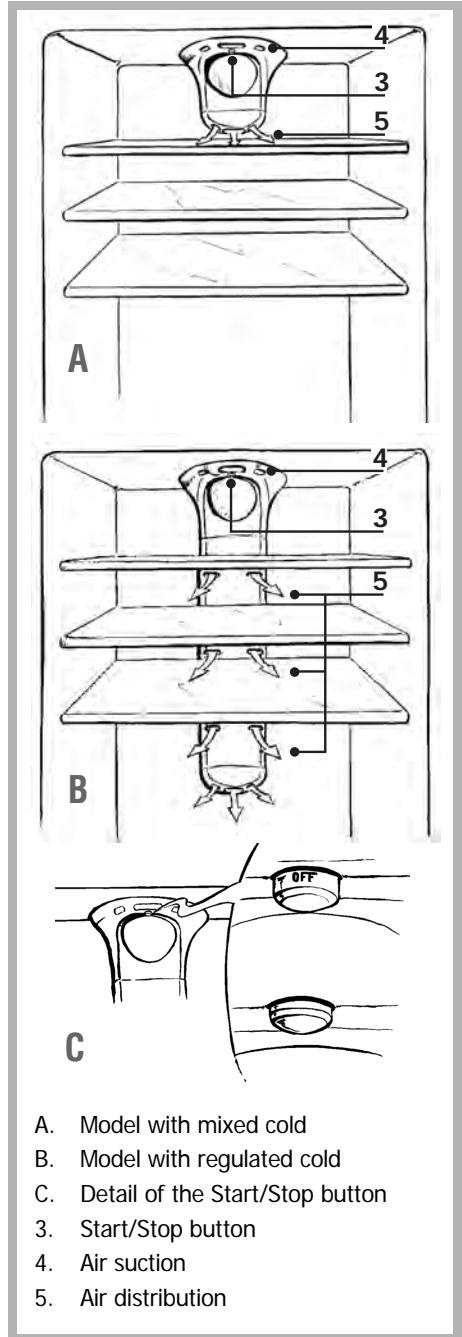

- A. Model with mixed cold
- B. Model with regulated cold
- C. Detail of the Start/Stop button
- 3. Start/Stop button
- 4. Air suction
- 5. Air distribution

Before placing food in your appliance:

Carefully wrap fresh foods: they will then keep their flavour, colour, humidity content and freshness. You also avoid the taste of some foods contaminating the taste of others. Only vegetables, fruit and salad vegetables can be stored in the vegetable compartment without being packed.

Let hot dishes and drinks cool down outside the appliance.

Remove the cardboard packs from around yoghurt pots.

Check the consume-by dates on the products you have bought. You should not exceed these.

Arranging food in your refrigerator

⚠ The temperature inside your refrigerator is not uniform. Some areas are colder than others and you must store your food in the appropriate areas according to their type to ensure that they can be kept safely.

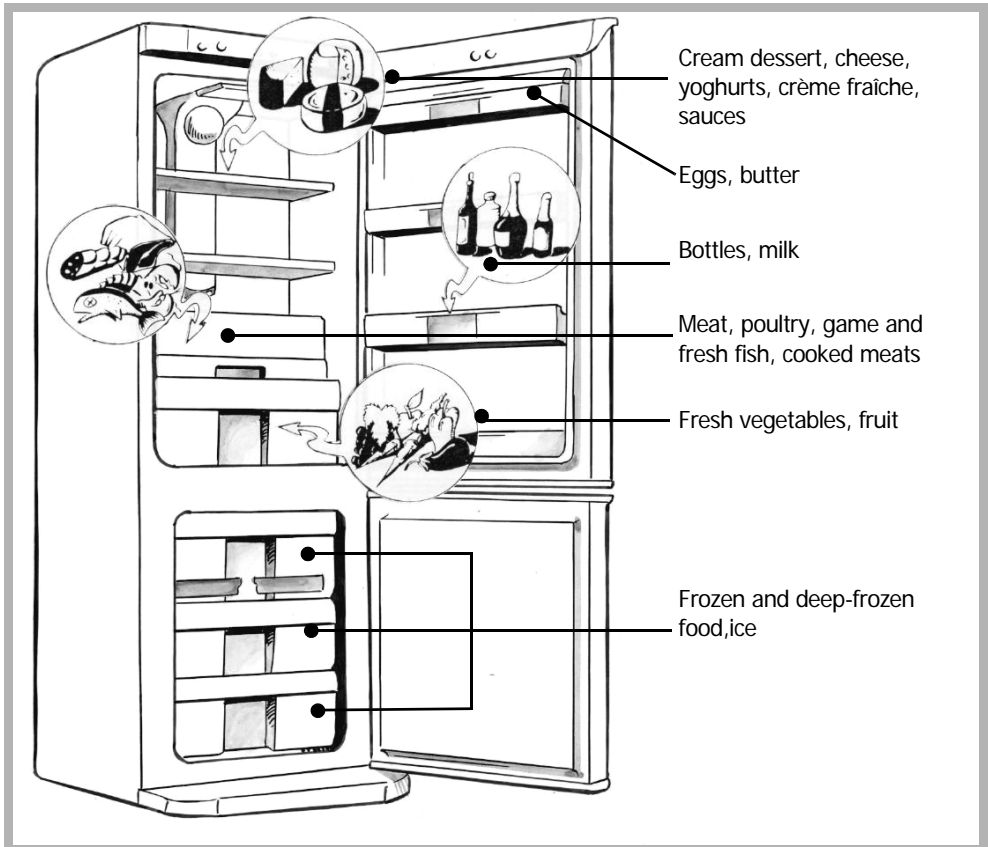

Arranging food in your refrigerator

EN

Leave a space between the food items to allow the air to circulate freely and avoid different products contaminating each other.

Do not put packages and food in contact with the wall at the back of the appliance: this is a particularly cold and damp area of the appliance and water droplets and frost condense there as part of your refrigerator's normal operation.

"Cold Zone" symbols



The coldest area, indicated by the logo opposite, is designed for delicate, sensitive and highly perishable food: meat, poultry, fish, cooked meats, prepared dishes, ready-made salads, egg or cream-based dishes and pastries, fresh pasta, pastry, pizza/quiches, fresh produce and raw milk cheese, ready-to-use vegetables sold in plastic bags and, more generally, any fresh product whose consumer-by date is linked to its storage at a temperature of +4°C or below.

Your refrigerator's modular layout

Your refrigerator has been designed to make arranging food in it easy. You can adjust the shelves and the racks to suit your wishes.

The Maxi-Fresh area (depending on the model)

The MAXI-FRESH compartment is recommended for storing fish and meat. It can be moved to different levels inside your refrigerator if the Regulated Cold system is activated (see the section on Mixed or regulated Cold).

Automatic defrosting

The refrigerator section of your appliance defrosts fully automatically. The water created by defrosting flows to a collection tank situated over the motor. The heat the motor releases evaporates the contents of this tank.

i It is quite normal for droplets of water or frost to appear on the wall at the back of your refrigerator. This is a particularly cold and damp area in your appliance and water droplets and frost condense out as part of your appliance's normal operation. This frost is removed regularly during your refrigerator's automatic defrosting phases.

Your domestic appliance enables you to freeze food: it lowers its core temperature rapidly and you can therefore keep it longer.

Deep-freezing is an industrial process that is quicker and more intense than domestic freezing. The products you purchase from the shops are deep-frozen.

Preparing food for freezing

⚠ Freezing does not sterilise. It is therefore important to observe some simple hygiene rules when preparing your food for freezing: wash your hands before you touch the food and clean the kitchen tools you have just used before using them again.

Only freeze fresh, good quality food. Refer to the table "Food Freezing Guide" to know which products you can freeze and how long you can keep them.

Blanch fruit and vegetables before freezing them to preserve their colour, smell, taste and vitamins: plunge them in boiling water for a few moments.

Divide the food you wish to freeze into small individual portions corresponding to one meal each. Small portions freeze quicker at their core.

Pack the food hermetically so that they do not lose their flavour or dry up. Use plastic bags, polyethylene film, aluminium foil or special freezer containers for this.

If you are using plastic bags, compress them to eliminate the air before sealing them hermetically.

⚠ Do not place bottles or jars containing liquids in the freezer unless they are only two-thirds full: freezing causes liquids to expand, which can cause the container to explode.

Note on each package:

- The freezing date
- The consume-by date
- The type of food contained
- The number of portions contained

If you are purchasing deep-frozen food, pick it up last when you are shopping.

Check that:

- The packaging isn't damaged
- They are not covered in a layer of frost (which means that they have partially defrosted)

Pack them in an isothermic bag or in newspaper. Transport them quickly and store them immediately.

Comply with the maximum storage dates shown on the pack. Your appliance has a **** freezer compartment: this enables you to keep deep-frozen food in an optimal manner.

Fresh meat

Product	Valid for
Lamb, small pieces	8 months
Roast pork	5 months
Pork ribs	4 months
Boiled beef, roast beef	10 months
Beef steak, entrecotes, in sauce, roast veal	8 months
Veal steaks, cutlets	10 months
Minces meat	4 months
Giblets, offal	3 months
Sausages	2 months

We recommend that you defrost meat completely before cooking it so as to avoid the exterior cooking quicker than the interior, except in the case of small breadcrumbed items, which can be sautéed directly over a low to medium heat, and boiled meats.

Farmyard animals

Prepare them plucked/skinned, gutted, cut into pieces if necessary, washed and rinsed.

Product	Valid for
Duck	4 months
Rabbit	6 months
Boiling fowl	7 months
Goose	4 months
Chicken	10 months
Turkey	6 months
Giblets, offal	3 months

Game

Prepare it plucked/skinned, gutted, cut into pieces if necessary, washed and rinsed.

Product	Valid for
Wild duck, woodcock, pheasant	8 months
Hare	6 months
Partridge, quail	8 months

Fish

Product	Valid for	Preparation
Carp	2 months	Descale, gut and remove the head. Wash, rinse and freeze
Pike		
Turbot		
Salmon		
Mackerel		
Tench		
Trout	3 months	Descale, gut, remove the head and place in cold salty water for 30 seconds, rinse and freeze.
Sea bream		
Sole		

Cooked food

The length of time you can store cooked dishes reduces if you use bacon or smoked ham to season dishes.

Product	Valid for	Preparatory cooking
Sauce with meat juices	3 months	half-cooked
Tomato sauce		just-cooked
Minestrone with vegetables	2 months	no pasta
Lasagne	4 months	half-cooked
Roasts	2 months	just-cooked
Calf's leg	1 months	half-cooked
Meat in sauce	3 months	
Stewed game	2 months	just-cooked
Boiled fish,grilled/baked fish	2 months	half-cooked
Sweet peppers,aubergines,courgettes stuffed with meat		
Sautéed mushrooms with garlic and parsley,ratatouille		
Steamed spinach		
Pizza	6 months	just-cooked

Put them directly on the hob or in the oven without defrosting them.

Vegetables

We recommend that you blanch the vegetables with steam so that they do not lose their vitamins and mineral salts in the cooking water. You therefore do not need to wait until they are dry before freezing them, just until they cool down.

Product	Valid for	Preparation	Blanching time
Asparagus	12months	Wash and remove the strings	2 minutes
Cabbage,cauliflower	6 months	Clean and cut into pieces	2 minutes (1)
Artichokes	12months	Remove the external leaves	6 minutes (1)
Beans		Shell	3 minutes
Green beans		Wash and remove the ends	4 minutes
Mushrooms		Clean	2 minutes (1)
Aubergines		Wash and slice	4 minutes (2)
Sweet peppers (3)		Wash slice and remove the seeds	do not blanch
Peas,Tomatoes (3)		Shell and freeze immediately,laying them in a single layer and then wrapping them	
Parsley,basil	8 months	Wash	2 minutes
Spinach	12months	Wash, cut into pieces and divide up into portions. Do not add potatoes terre: they go black.	do not blanch
Mixed vegetables for minestrone (céleri, carrots, chard,leeks, etc.)			

(1) Add a little vinegar or lemon juice to the cooking water (slightly acid water).

(2) Pickle in brine before cooking.

(3) During defrosting,these vegetables reduce to a mush because they contain enormous amounts of water.

We recommend that you defrost them only if you wish to eat them coked.

In general, vegetables are better if they are cooked directly, without being frozen. Reduce the cooking time, taking into account the blanching time before freezing...

Fruits

Fruit must be covered with sugar or syrup, as appropriate. The amount of sugar to use is around **250g for 1 kilo of fruit**. Syrups are used in varying percentages; these are prepared by boiling sugared water. The various concentrations are as follows:

- 30% solution, 450g of sugar per litre of water;
- 40% solution, 650g of sugar per litre of water;
- 50% solution, 800g of sugar per litre of water;

So that the fruit's colour does not change, place it in lemon juice before covering it with sugar or pour lemon juice into the syrup. The receptacles for the fruit to be frozen must remain in the refrigerator for one hour before being re-inserted into the freezer. The fruit must be completely covered in syrup.

Product	Valid for	Preparation
Apricots	8 months	Wash,pit and cover with 30% syrup
Pineapple	10 months	Peel,slice and cover with 50% syrup
Oranges		Peel,slice and cover with 30% syrup
Cherries		Wash,pit and cover with sugar or 30% syrup
Strawberries	12 months	Wash, remove the stalk and cover with sugar
Melon		Peel,slice,de-seed and cover with 30% syrup
Peaches	8 months	Peel,pit,slice and cover in 50% syrup
Grapefruit	12 months	Peel,slice and cover in 30% syrup
Juice from citrus fruits	10 months	Press, remove the pips and sweeten to taste
Plums	12 months	Wash,pit and cover in sugar or 50% syrup
Grapes		De-seed,wash and cover in sugar or 30% syrup
Bilberries, blackberries, blackcurrants,raspberries red currants	10 months	Wash, remove the stalk and cover with sugar

Bread

This can be kept for **2 months**. Defrost in an oven set to 50°C, switching it on after inserting the bread.

Butter and cheese

Freeze butter and cheese by dividing them up into pieces for weekly consumption.

Butter and hard cheese (e.g. Parmesan) can be kept for 8 months, other cheese 4 months. They must be defrosted in the refrigerator, keeping an eye on the condensation that forms on these products.

Arranging food in your freezer

EN

Do not put fresh food next to food that has already been frozen to avoid causing the frozen food to warm up.

- i** The maximum weight of food that you can freeze over 24 hours is shown on the information plate (inside your appliance's refrigerator section near the bottom of the left-hand wall) under the heading: "CAPACITE DE CONGELATION/ FREEZING CAPACITY (kg/24h)".

Quick freeze

The "Quick Freeze" function enables you to lower the freezer's temperature rapidly to the maximum extent to freeze a large amount of fresh food more quickly (see § "Starting and setting the appliance").

You can place the food to be frozen in the compartments of your freezer but for quicker thorough freezing we recommend that you place them in the "Quick Freeze" area, i.e. in the first drawer from the top (see Drawing).

- i** The food must be frozen right through as quickly as possible in order to preserve its vitamins, its nutritional value, its appearance and its taste.

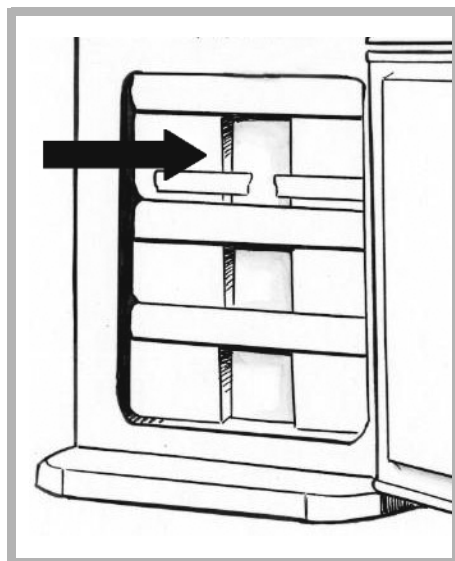

You can defrost food in five different ways:

- By putting them in your appliance's refrigerator section for several hours
- By leaving them to defrost gently at ambient temperature
- In a conventional oven at a very low temperature (40/50°C)
- In a microwave oven
- By cooking them immediately

Defrosting them in the refrigerator is the slowest but safest method.

Defrosting your freezer

Defrost your freezer when a layer of frost and ice 5-6mm thick has formed inside your freezer. This thickness of ice prevents your freezer from operating correctly, reduces its efficiency and causes it to consume more energy.

Remove all the food from the freezer. Place it in isothermic bags or wrap it in newspaper and store it in a cool place.

Switch off your appliance by setting the thermostat to . Keep the door to the freezer section open.

Place a pan of hot water on a small plank of wood or a placemat to isolate it and place them both inside your freezer to speed up the defrosting process.

Place the drain and a receptacle at the bottom as shown in the Drawing.

 **Never refreeze food once it has defrosted, even partially, without cooking it first.**

 **We would advise you not to place any items you have just taken out of the freezer straight into your mouth (ice cream, ice cubes, etc.): they will be at a very low temperature and you risk frostbite. Avoid touching frozen or deep-frozen food with wet hands; you may stick to the food.**

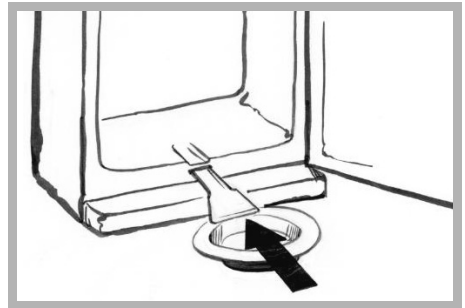

 **Never use a heater, hairdryer or any other electrical appliance nor any knives or other metal objects to speed up defrosting: you could damage your appliance irremediably.**

Clean your freezer before resetting the thermostat as shown in the section on "Setting your refrigerator's temperature" and replacing the food (see the section on "Cleaning your appliance").

⚠ Disconnect your appliance prior to performing any maintenance operation. Grasp the plug directly, instead of pulling on the power cable.

Cleaning your appliance

⚠ We recommend that you clean and disinfect your appliance regularly for improved hygiene and to keep your food completely safe: the refrigerator section should be cleaned once a month and the freezer after each time you defrost it.

Remove all the food from the freezer. Place it in isothermic bags or wrap it in newspaper and store it in a cool place.

Clean your appliance inside and out with a bicarbonate of soda solution (1 dessertspoon of bicarbonate to 4 litres of water). Do not use alcohol, scouring powder or detergents, which could damage the surfaces.

⚠ Do not use a high-pressure steam cleaner. The very hot steam could damage the surfaces and the electrical circuits; you would expose yourself to a risk of electrocution.

Rinse with water, dry with a cloth.

Periodically check that the drain hole for the defrosting water is not blocked and clean it with a stick as shown in the Drawing.

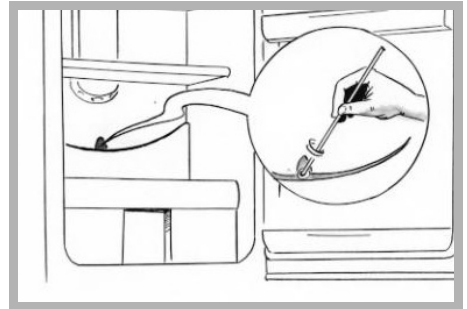

Don't forget to clean the condenser from time to time: this is at the back of the appliance (see the section on "Description of your appliance"). Use a dry paintbrush to do this or, better yet, your vacuum cleaner.

Reconnect your appliance, and adjust the refrigerator's thermostat if necessary, as shown in the section on

"Adjusting your refrigerator's temperature ", and press the "Quick Freeze" button.

Wait 3 or 4 hours before placing the food back in your appliance.

After 24 hours, release the "Quick Freeze" button to stop this operation.

The sliding compartment for fruit and vegetables is fitted with a filter that controls the humidity by adapting it for optimum preservation of these foodstuffs.

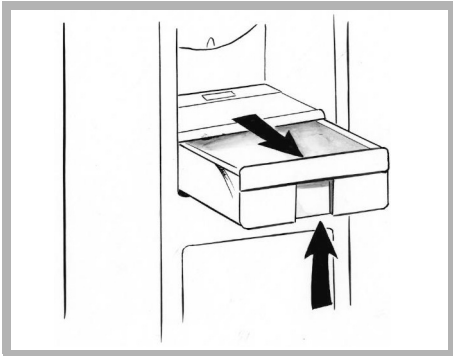

To clean this filter: remove the top of the compartment, remove the lid and then remove the "K" filter and wash it under running water. The sliding basket can be removed as follows: pull the basket out to the stop, lift the front of the basket and then pull it towards you.

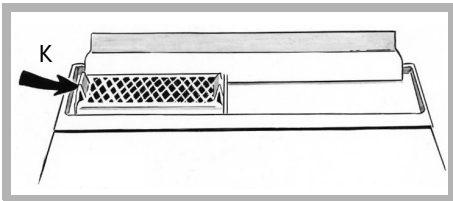

Changing the light bulb

Disconnect your appliance

- Unscrew the screw holding the interior light in place
- Remove the interior light and replace the bulb with another of the same type (15 WATTS max.). Refit the interior light and screw it in place.

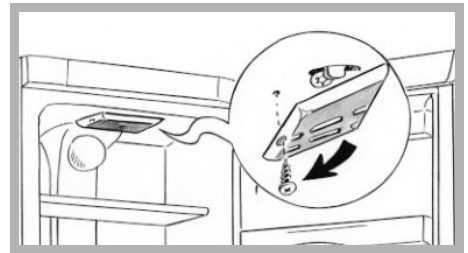

Clearit

To keep your appliance in good working order, we recommend that you use Clearit household products.



Professional expertise for the general public

Clearit offers you professional products and adapted solutions for the daily upkeep of your household and kitchen appliances.

You may find them in conventional retail outlets, along with a complete line of by-products and consumables.

Normal operating noises

So that the selected temperature remains constant, your appliance regularly switches off its motor. The resultant noises are quite normal operating noises. They reduce automatically as soon as your refrigerator reaches the desired temperature. These noises are as follows:

NOISE	CAUSE
Buzzing	Coming from the motor. This buzzing may briefly be louder when the motor starts
Gargling or slight buzzing	Coming from circulation of the refrigerant in your refrigerator's pipes
Clicks	These can always be heard when the thermostat turns the motor on or off
Slight background noise	If your appliance is fitted with a fan (depending on the model), the air circulating inside your appliance makes a slight background noise

Inconveniences or minor breakdowns

Certain problems may appear when you are using your appliance. Before calling the after-sales service, use the guide below to see if you can resolve the problem yourself:

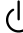
PROBLEM	ADVICE
Unusual noises	<ul style="list-style-type: none"> - check the adjustment of the feet of your appliance and its stability - check that it is not touching a wall - check that all the movable parts (trays, racks, etc..) are securely in place - check that the bottles or containers you have placed in your appliance are not touching each other
The refrigerator does not get cold enough	<ul style="list-style-type: none"> - check that the thermostat is correctly set as indicated in the section on "Adjusting your refrigerator's temperature" - if you have put a large amount of food in your refrigerator at one time, ensure that you readjust the thermostat as shown in the section on "Adjusting your refrigerator's temperature" - be careful not to open your appliance's door too often, and not to leave it open
Your appliance does not get cold at all	<ul style="list-style-type: none"> - check that the thermostat is not in the  position - check that your appliance is connected to the electrical supply - check that the circuit-breaker for your house has not cut out and that the fuse has not blown or been unscrewed

PROBLEM	ADVICE
Frost forms inside your appliance	- be careful not to open your appliance's door too often, and not to leave it open
The external walls are warm	- this is quite normal. It stops condensation forming on the outside of your appliance
Drops of water appear on your appliance's external wall	-When your home's heating is not on (for example in spring and autumn) and the ambient air is humid, some condensation may form on your appliance's outside walls. This is not dangerous at all and your appliance continues to operate quite correctly.
Droplets of water or ice forms on the appliance's rear wall	- this is quite normal. This is a particularly cold and damp area of the appliance and droplets of water and frost can form here when your appliance is operating normally. This frost is regularly eliminated during your refrigerator's automatic defrosting cycles.
Certain foods do not freeze completely	- this is quite normal for food that contains a lot of sugar, fat or alcohol not to freeze completely and to remain partially soft (ice cream, fruit juice, etc.)
Droplets stagnate at the back of the appliance	- check that the drain hole is not blocked. If it is, release it with a stick or a metal wire as shown in the section in " Ongoing maintenance of your appliance "
Frozen meat has white streaks	- check that your machine's thermostat is correctly set and is not at too low a temperature (see the section on " Setting your refrigerator's temperature " - check that you haven't kept this meat too long in the freezer using the table you will find in the " Food Freezing Guide " section
The door is difficult to open	- it is normal for the door to offer some resistance to being opened, particularly when you have just shut it: a slight underpressure forms in your appliance to ensure the door seals perfectly. All you have to do is wait a few seconds before re-opening
The light inside the refrigerator is out	- check that the thermostat is not in the  position - check that your appliance is connected to the electrical supply - check that the circuit-breaker for your house has not cut out and that the fuse has not blown or been unscrewed - check that the bulb has not burnt out, and refer to the section "changing the light bulb ".

Any maintenance on your equipment should be undertaken by:

- either your dealer,
- or another qualified mechanic who is an authorized agent for the brand appliances.

When making an appointment, state the full reference of your equipment (model, type and serial number). This information appears on the manufacturer's nameplate attached to your equipment.

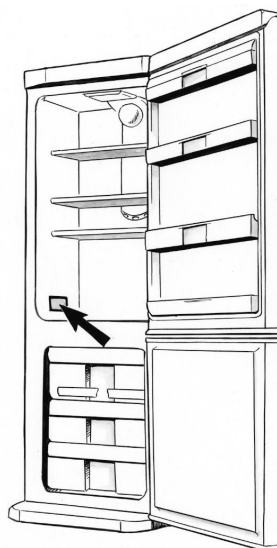

COMBI FRIDGE - FREEZER REFRIGERATEUR-CONGELATEUR		CE
TYPE MODELE	CLASS CLASSE	SERIAL NUMBER
TOTAL GROSS CAPACITY VOLUME BRUT TOTAL	NET CAPACITY FREEZER VOLUME UTILE CONGELATEUR	
R 600a	NOMINAL VOLTAGE TENSION NOMINALE	
(M) ———— u ———— A	~	——— u ———— A
FREEZING CAPACITY kg/24h POUVOIR DE CONGELATION		MADE IN ITALY FABRIQUE EN ITALIE
SYSTEME COMP.		COD.

Brandt Appliances - SAS au capital de 10.000.000 euros, RCS Nanterre sous le n 440 302 347