

# LCD Digital Colour TV



## Operating Instructions

-  Before operating the TV, please read the “Safety information” section of this manual.  
Retain this manual for future reference.

**KDL-46X2000**

# BRAVIA





For useful information about Sony products

<http://www.sony-europe.com/myproduct>

# NOTICE FOR CUSTOMERS IN THE UNITED KINGDOM

A moulded plug complying with BS1363 is fitted to this equipment for your safety and convenience.

Should the fuse in the plug supplied need to be replaced, a 13 AMP fuse approved by ASTA or BSI to BS 1362 (i.e., marked with  or ) must be used.

When an alternative type of plug is used it should be fitted with a 13 AMP FUSE, otherwise the circuit should be protected by a 13 AMP FUSE at the distribution board.

If the plug supplied with this equipment has a detachable fuse cover, be sure to attach the fuse cover after you change the fuse. Never use the plug without the fuse cover. If you should lose the fuse cover, please contact your nearest Sony service station.

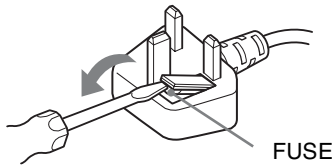

## How to replace the fuse

Open the fuse compartment with a blade screwdriver, and replace the fuse.

## Introduction

Thank you for choosing this Sony product. Before operating the TV, please read this manual thoroughly and retain it for future reference.

## Notice for Digital TV function

- Any functions related to Digital TV (with **DVB** logo) will only work in countries or areas where DVB-T (MPEG2) digital terrestrial signals are broadcasted. Please confirm with your local dealer if you can receive a DVB-T signal where you live.
- Although this TV set follows DVB-T specifications, compatibility with future DVB-T digital terrestrial broadcasts cannot be guaranteed.
- Some Digital TV functions may not be available in some countries.

## Trademark information

- **DVB** is a registered trademark of the DVB Project
- Manufactured under license from BBE Sound, Inc. Licensed by BBE Sound, Inc. under one or more of the following US patents: 5510752, 5736897. BBE and BBE symbol are registered trademarks of BBE Sound, Inc.
- “Dolby”, “Pro Logic”, and the double-D symbol are trademarks of Dolby Laboratories.
- Manufactured under license from Dolby Laboratories.
- TruSurround technology is used as a virtualizer for Dolby Virtual Surround.
- TruSurround, SRS and  symbol are trademarks of SRS Labs, Inc. TruSurround technology is incorporated under license from SRS Labs, Inc.
- **HDMI** HDMI, the HDMI logo and High-Definition Multimedia Interface are trademarks or registered trademarks of HDMI Licensing, LLC.

---

# Table of Contents

## Start-up Guide

4

Safety information .....	8
Precautions .....	11
<b>Overview of the remote .....</b>	<b>12</b>
<b>Overview of the TV buttons and indicators .....</b>	<b>14</b>

## Watching TV

Watching TV .....	15
Checking the Digital Electronic Programme Guide (EPG) <b>DVB</b> .....	18
Using the Digital Favourite list <b>DVB</b> .....	20
Viewing pictures from connected equipment .....	21

## Using MENU Functions

Navigating through menus .....	22
Picture menu .....	23
Sound menu .....	26
Screen menu .....	27
Set-up menu .....	29
AV Set-up menu .....	31
Analogue Set-up menu .....	32
Digital Set-up menu <b>DVB</b> .....	35
PC Settings menu .....	37

## Using Optional Equipment

Connecting optional equipment .....	39
Programming the remote .....	41

## Additional Information

Specifications .....	43
Troubleshooting .....	45
Index .....	47

**DVB** : for digital channels only

# Start-up Guide

## 1: Checking the accessories

Remote RM-ED006 (1)

Size AA batteries (R6 type) (2)

Mains lead (Type BF) (1)



Coaxial cable (1)



Do not remove these ferrite cores.

PC cable (1)

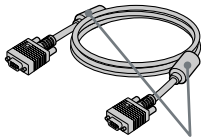

Do not remove these ferrite cores.

Cable holder (1)

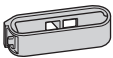

Support belt (1) and screws (2)

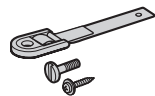

## To insert batteries into the remote

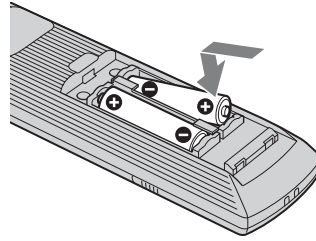

### Notes

- Observe the correct polarity when inserting batteries.
- Dispose of batteries in an environmentally friendly way. Certain regions may regulate disposal of the battery. Please consult your local authority.
- Do not use different types of batteries together or mix old and new batteries.
- Handle the remote with care. Do not drop or step on it, or spill liquid of any kind onto it.
- Do not place the remote in a location near a heat source, or in a place subject to direct sunlight, or in a damp room.

## 2: Connecting an aerial/VCR

Connecting an aerial only

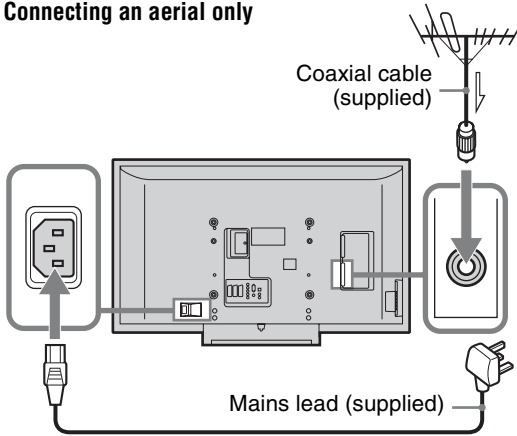

Connecting an aerial and VCR

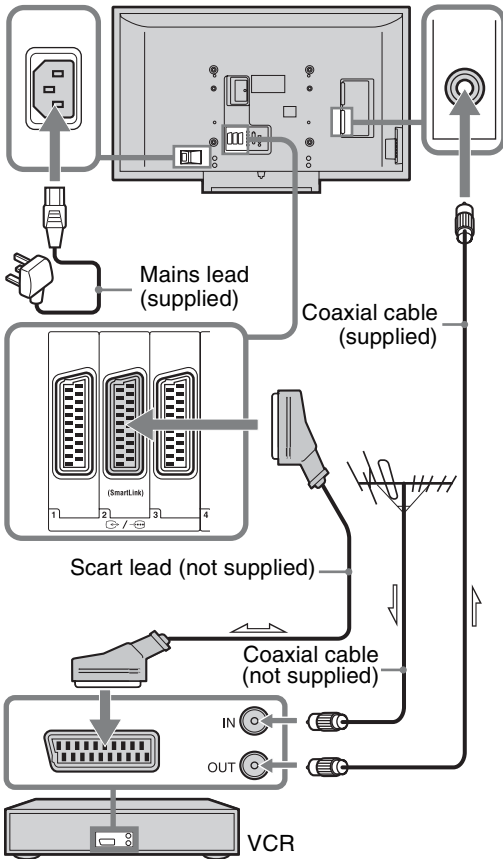

## 3: Preventing the TV from toppling over

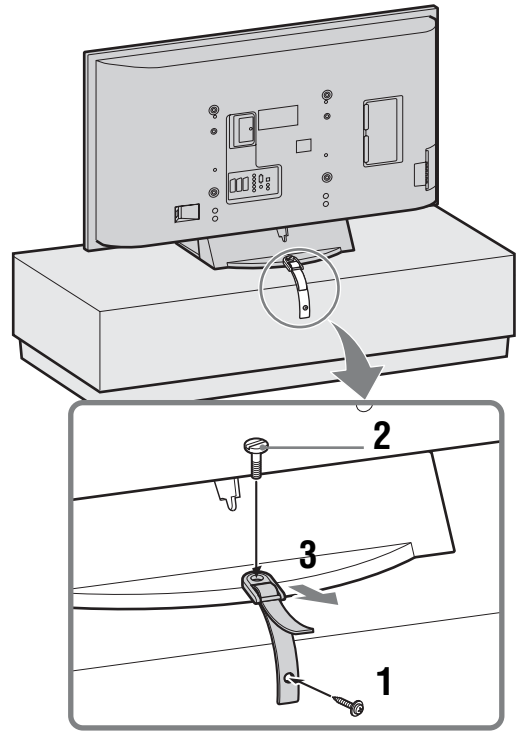

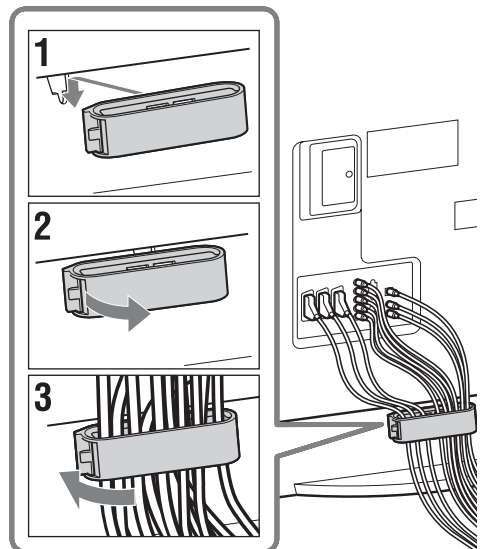

## 4: Bundling the cables



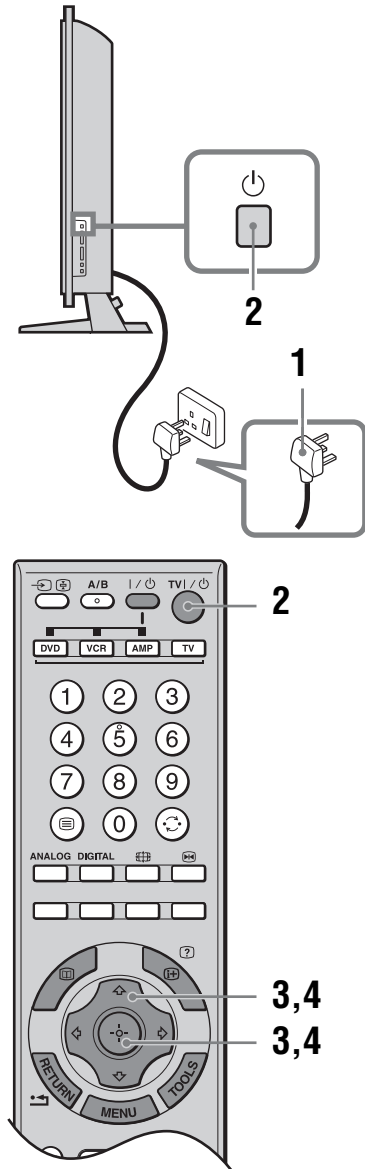

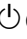

## 5: Selecting the language and country/region



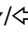
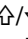

- 1 Connect the TV to your mains socket (220-240 V AC, 50 Hz).
- 2 Press  on the TV (right side).  
When you switch on the TV for the first time, the Language menu appears on the screen.

When the TV is in standby mode (the  (standby) indicator on the TV (front) is red), press TV  on the remote to switch on the TV.

- 3 Press  to select the language displayed on the menu screens, then press .



- 4 Press  to select the country/region in which you will operate the TV, then press .

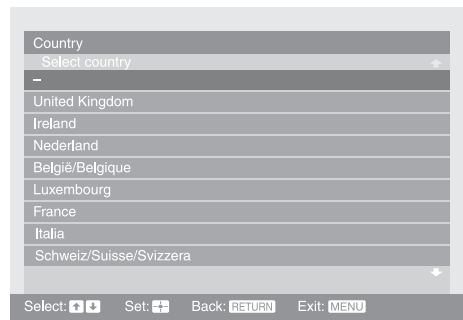

If the country/region in which you want to use the TV does not appear in the list, select “-” instead of a country/region.

The message confirming the TV start auto-tuning appears on the screen, then go to “6: Auto-tuning the TV”.

# 6: Auto-tuning the TV

The TV will search for and store all available TV channels.



**1** Before you start auto-tuning the TV, insert a pre-recorded tape into the VCR connected to the TV (page 5) and start play back.

The video channel will be located and stored on the TV during auto-tuning.

If no VCR is connected to the TV, skip this step.

**2** Press  $\leftarrow$  to select “OK”, then press  $\oplus$ .

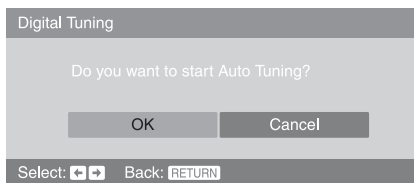

The TV starts searching for all available digital channels, followed by all available analogue channels. This may take some time, please be patient and do not press any buttons on the TV or remote.

**If a message appears for you to confirm the aerial connection**

No digital or analogue channels were found. Check the aerial connection and press  $\leftarrow$  to select “Yes”, then press  $\oplus$  to start auto-tuning again.

**3** When the Programme Sorting menu appears on the screen, follow the steps of “Programme Sorting” (page 32).

If you do not change the order in which the analogue channels are stored on the TV, go to step 4.

**4** Press MENU to exit.

The TV has now tuned in all the available channels.

**Note**

When a digital broadcast channel cannot be received, or when selecting a region in which there are no digital broadcasts in step 4 (page 6) under “5: Selecting the language and country/region”, the time must be set after performing step 3.

# Safety information

## Mains lead

- Observe the followings to prevent the mains lead being damaged. If the mains lead is damaged, it may result in a fire or an electric shock.
  - Unplug the mains lead when moving the TV set.
  - When you disconnect the mains lead, disconnect it from the mains socket first.
  - Be sure to grasp the plug when disconnecting the mains lead. Do not pull on the mains lead itself.
  - Do not pinch, bend, or twist the mains lead excessively. The core conductors may be exposed or broken.
  - Do not modify the mains lead.
  - Do not put anything heavy on the mains lead.
  - Keep the mains lead away from heat sources.
- If you damage the mains lead, stop using it and ask your dealer or Sony service centre to exchange it.
- Do not use the supplied mains lead on any other equipment.
- Use only an original Sony mains lead, not other brands.

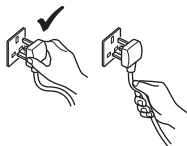

## Mains socket

- The TV set with a three-wire grounding type mains plug must be connected to a mains socket with a protective earthing connection.
- Do not use a poor fitting mains socket. Insert the plug fully into the mains socket. A poor fit may cause arcing and result in a fire. Contact your electrician to have the mains socket changed.

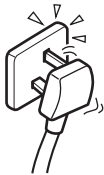

## Cleaning the mains plug

Unplug the mains plug and clean it regularly. If the plug is covered with dust and it picks up moisture, its insulation may deteriorate and result in a fire.



## Overloading

This TV set is designed to operate on a 220–240 V AC supply only. Take care not to connect too many appliances to the same mains socket as this could result in a fire or an electric shock.

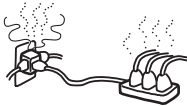

## When not in use

If you will not be using the TV set for several days, the TV set should be disconnected from the mains for environmental and safety reasons. However, some TV sets may have features



which need the TV set to be left in standby to work correctly. The instructions in this manual will inform you if this applies.

## Carrying

- Before carrying the TV set, disconnect all the cables from the TV set.
- Carrying the large size TV set requires two or more people.
- When you carry the TV set by hand, hold the TV set as illustrated on the right. If you do not do so, the TV set may fall and be damaged or cause serious injury.
- When transporting it, do not subject the TV set to jolts or excessive vibration. The TV set may fall and be damaged or cause serious injury.
- If the TV set has been dropped or damaged, have it checked immediately by qualified service personnel.
- When you carry the TV set in for repair or when you move it, pack it using the original carton and packing material.

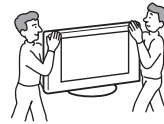

## Handling

When lifting the TV set or moving the panel of the TV set, hold it firmly as illustrated on the right.

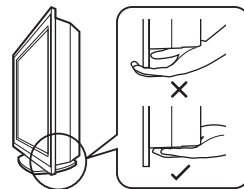

## Placement

- The TV set should be installed near an easily accessible mains socket.
- Place the TV set on a stable, level surface. Do not hang anything on the TV set. If you do, the TV set may fall from the stand, causing damage or serious injury.
- Do not install the TV set in places subject to extreme temperature, for example in direct sunlight, or near a radiator, or heating vent. If the TV set is exposed to extreme temperature, the TV set may overheat and cause deformation of the casing or cause the TV set to malfunction.
- Do not install the TV set in a place exposed to direct air conditioning. If the TV set is installed in such a location, moisture may condense inside and may cause a malfunction.
- Never place the TV set in hot, humid or excessively dusty places.
- Do not install the TV set where insects may enter.
- Do not install the TV set where it may be exposed to mechanical vibration.
- Do not install the TV set in a location where it may protrude, such as on or behind a pillar, or where you might bump your head on it. Otherwise, it may result in injury.
- Do not allow children to climb on the TV set.
- If you use the TV set near the seashore, salt may corrode metal parts of the TV set and cause internal damage or fire.





## Ventilation

- Never cover the ventilation holes in the cabinet. It may cause overheating and result in a fire.
- Unless proper ventilation is provided, the TV set may gather dust and get dirty. For proper ventilation, observe the following:
  - Do not install the TV set turned backwards or sideways.
  - Do not install the TV set turned over or upside down.
  - Do not install the TV set on a shelf or in a closet.
  - Do not place the TV set on a rug or bed.
  - Do not cover the TV set with cloth, such as curtains, or items such as newspapers, etc.
- Leave some space around the TV set. Otherwise, air-circulation may be inadequate and cause overheating, which may cause a fire or damage to the TV set.

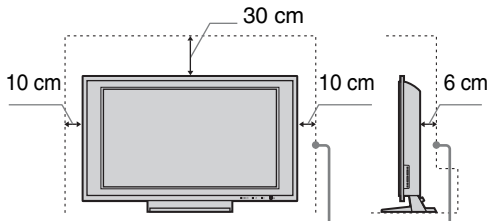

Leave at least this much space.

- When installing the TV set on the wall, leave at least 10 cm space from the bottom.
- Never install the TV set as follows:

Air circulation is blocked.

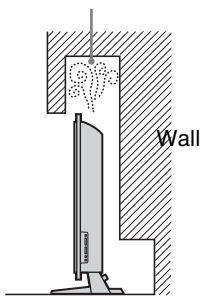

Air circulation is blocked.

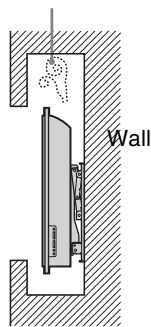

## Optional accessories

Observe the following when installing the TV set using a stand or wall-mount bracket. If you do not do so, the TV set may fall and cause serious injury.

- It is strongly recommended that you use Sony accessories for safety reasons:
  - Wall-mount bracket SU-WL51
  - TV stand SU-FL61
- It is strongly recommended that you use the official Sony wall-mount bracket to allow adequate air circulation and to avoid dust build up around the TV, wall and ceiling.
- Secure the TV set properly, following the instructions supplied with your stand or wall-mount bracket when installing the TV set.
- Be sure to attach the brackets supplied with your stand.

- If the TV set is to be installed on a wall, have the installation carried out by qualified service personnel. Improper installation may render the TV set unsafe.

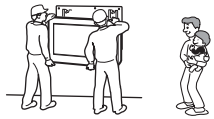

## Wiring

- When hooking up, be sure to unplug the mains lead for your safety.
- The TV set is not disconnected from the mains when the TV set is switched off. To disconnect the TV set completely, pull the plug from the mains.
- Take care not to catch your feet on the cables. It may damage the TV set.

## Medical institutions

Do not place this TV set in a place where medical equipment is in use. It may cause a malfunction of medical instruments.

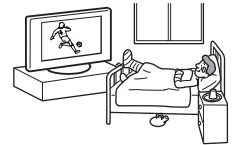

## Outdoor use

- Do not install this TV set outdoors. If the TV set is exposed to rain, it may result in a fire or an electric shock.
- If this TV set is exposed to direct sunlight, the TV set may heat up and it may damage the TV set.

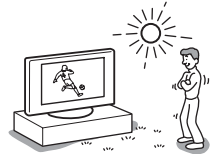

## Vehicle, Ships and other vessels

- Do not install this TV set in a vehicle. The motion of the vehicle may cause the TV set to fall down and cause injury.
- Do not install this TV set on a ship or other vessel. If the TV set is exposed to seawater, it may cause a fire or damage the TV set.

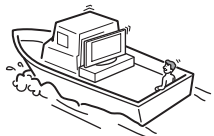

## Ventilation holes

Do not insert anything in the ventilation holes. If metal or liquid is inserted in these holes, it may result in a fire or an electric shock.



## Water and moisture

- Do not use this TV set near water – for example, near a bathtub or shower room. Also do not expose to rain, moisture or smoke. This may result in a fire or an electric shock.
- Do not touch the mains lead and the TV set with wet hands. Doing so may cause an electric shock or damage to the TV set.



**Continued**

### Moisture and flammable objects

- Do not place any objects on the TV set. The TV set shall not be exposed to dripping or splashing and that no objects filled with liquid, such as vases, shall be placed on the TV set.
- To prevent fire, keep flammable objects or naked lights (e.g. candles) away from the TV set.
- If any liquid or solid object does fall through openings in the cabinet, do not operate the TV set. It may result in an electric shock or damage to the TV set. Have it checked immediately by qualified service personnel.

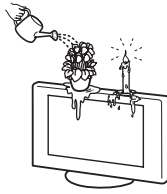

### Oils

Do not install this TV set in restaurants that use oil. Dust absorbing oil may enter and damage the TV set.

### Lightning storms

For your own safety, do not touch any part of the TV set, mains lead, or aerial lead during lightning storms.



### Broken pieces

- Do not throw anything at the TV set. The screen glass may break by the impact and cause serious injury.
- If the surface of the TV set cracks, do not touch it until you have unplugged the mains lead. Otherwise electric shock may result.



### Servicing

Dangerously high voltages are present inside the TV set. Do not open the cabinet. Entrust the TV set to qualified service personnel only.



### Small accessories removal and fittable

Keep accessories out of children's reach. If they are swallowed, choking or suffocation may occur. Call a doctor immediately.

### Replacing the bezel unit

The bezel unit can be replaced with others that are sold separately. However, do not remove the unit except to replace it. For details, see the instructions supplied with bezel units.

# Precautions

## Viewing the TV

- To view the TV comfortably, the recommended viewing position is from four to seven times the screen's vertical length away from the TV set.
- To obtain a clear picture, do not expose the screen to direct illumination or direct sunlight. If possible, use spot lighting directed down from the ceiling.
- View the TV in moderate light, as viewing the TV in poor light strains your eyes. Watching the screen continuously for long periods of time can also strain your eyes.
- If the angle of the TV set is to be adjusted, steady the base of the stand with your hand to prevent the TV set from becoming separated from the stand. Be careful not to get your fingers caught between the TV set and the stand.

## Volume adjustment

- Adjust the volume so as not to trouble your neighbours. Sound carries very easily at night time. Therefore, closing the windows or using headphones is suggested.
- When using headphones, adjust the volume so as to avoid excessive levels, as hearing damage may result.

## LCD Screen

- Although the LCD screen is made with high-precision technology and 99.99% or more of the pixels are effective, black dots may appear or bright points of light (red, blue, or green) may appear constantly on the LCD screen. This is a structural property of the LCD screen and is not a malfunction.
- Do not expose the LCD screen surface to the sun. Doing so may damage the screen surface.
- Do not push or scratch the front filter, or place objects on top of this TV set. The image may be uneven or the LCD screen may be damaged.
- If this TV set is used in a cold place, a smear may occur in the picture or the picture may become dark. This does not indicate a failure. These phenomena disappear as the temperature rises.
- Ghosting may occur when still pictures are displayed continuously. It may disappear after a few moments.
- The screen and cabinet get warm when this TV set is in use. This is not a malfunction.
- The LCD screen contains a small amount of liquid crystal and mercury. The fluorescent tube used in this TV set also contains mercury. Follow your local ordinances and regulations for disposal.

## Handling and cleaning the screen surface/cabinet of the TV set

Be sure to unplug the mains lead connected to the TV set from AC mains socket before cleaning.

To avoid material degradation or screen coating degradation, observe the following precautions.

- Do not push on the screen, scratch it with a hard object, or throw anything at it. The screen may be damaged.
- Do not touch the display panel after operating the TV set continuously for a long period as the display panel becomes hot.
- We recommend that the screen surface be touched as little as possible.
- To remove dust from the screen surface/cabinet, wipe gently with a soft cloth. If dust is persistent, wipe with a soft cloth slightly moistened with a diluted mild detergent solution.
- Never use any type of abrasive pad, alkaline/acid cleaner, scouring powder, or volatile solvent, such as alcohol, benzene, thinner or insecticide. Using such materials or maintaining prolonged contact with rubber or vinyl materials may result in damage to the screen surface and cabinet material.
- The ventilation holes can accumulate dust over time. To ensure proper ventilation, we recommend removing the dust periodically (once a month) using a vacuum cleaner.

## Optional Equipments

- Do not install optional components too close to the TV set. Keep optional components at least 30 cm away from the TV set. If a VCR is installed in front of the TV set or beside the TV set, the picture may become distorted.
- Picture distortion and/or noisy sound may occur if the TV set is positioned in close proximity to any equipment emitting electromagnetic radiation.

## Disposal of the TV set



### Disposal of Old Electrical & Electronic Equipment (Applicable in the European Union and other European countries with separate collection systems)

This symbol on the product or on its packaging indicates that this product shall not be treated as household waste. Instead it shall be handed over to the applicable collection point for the recycling

of electrical and electronic equipment. By ensuring this product is disposed of correctly, you will help prevent potential negative consequences for the environment and human health, which could otherwise be caused by inappropriate waste handling of this product. The recycling of materials will help to conserve natural resources. For more detailed information about recycling of this product, please contact your local Civic Office, your household waste disposal service or the shop where you purchased the product.

# Overview of the remote

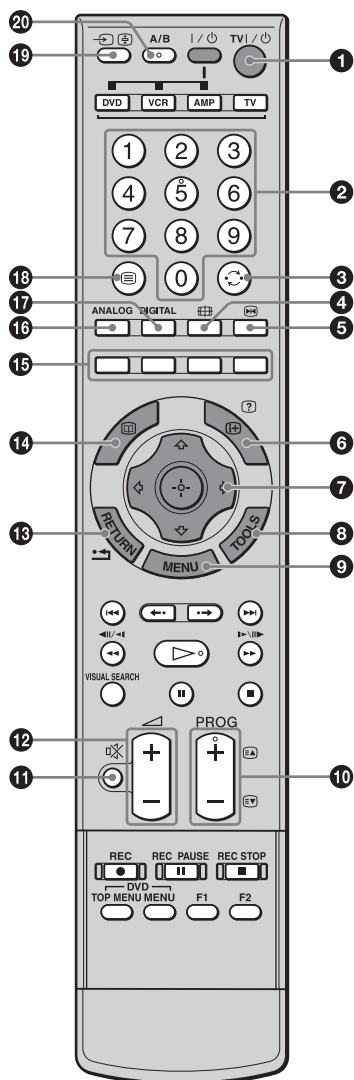

- 1 TV I/⏻ – TV standby**  
Switches off the TV temporarily and on from standby mode.
- 2 Number buttons**
  - In TV mode: Selects channels. For channel numbers 10 and above, enter the second and third digit within two seconds.
  - In Analogue Text mode: Enters the three digit page number to select the page.
- 3 ↻ – Previous channel**  
Returns to the previous channel watched (for more than five seconds).
- 4 🌐 – Screen mode (page 16)**
- 5 ⏸ – Picture freeze (page 16)**  
Freezes the TV picture.
- 6 ⓘ/? – Info / Text reveal**
  - In digital mode: Displays brief details of the programme currently being watched.
  - In analogue mode: Displays information such as current channel number and screen mode.
  - In Analogue Text mode (page 16): Reveals hidden information (e.g. answers to a quiz).
- 7 ⏮/⏭/⏪/⏩/⊕ (page 15, 22)**
- 8 TOOLS (page 17, 21)**  
Enables you to access various viewing options and change/make adjustments according to the source and screen mode.
- 9 MENU (page 22)**
- 10 PROG +/- (page 15)**
  - In TV mode: Selects the next (+) or previous (-) channel.
  - In Analogue Text mode: Selects the next (+) or previous (-) page.
- 11 🔇 – Mute (page 15)**
- 12 🔊 +/- – Volume**
- 16 RETURN / ⏪**  
Returns to the previous screen of any displayed menu.
- 14 📖 – EPG (Digital Electronic Programme Guide) (page 18)**
- 15 Coloured buttons (page 16, 18, 20)**
- 16 ANALOG – Analogue mode (page 15)**
- 17 DIGITAL – Digital mode (page 15)**
- 18 ☰ – Text (page 16)**
- 19 →/⏸ – Input select / Text hold**
  - In TV mode (page 21): Selects the input source from equipment connected to the TV sockets.
  - In Analogue Text mode (page 16): Holds the current page.
- 20 A/B – Dual Sound (page 26)**

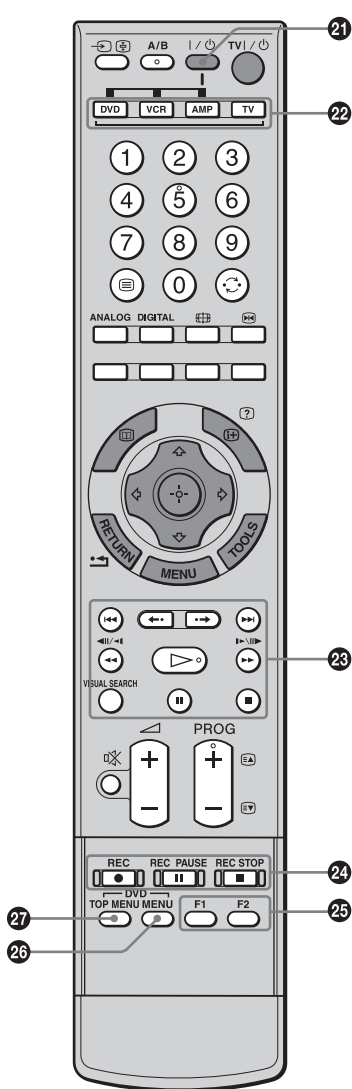

**21 I/Power**

Switches on or off the optional equipment selected from the function buttons.

**22 Function buttons**

Enables you to operate the corresponding equipment. For details, see “Programming the remote” on page 41.

**23 DVD/VCR operating buttons**

- **◀◀** : Replays the current programme from the previous chapter mark (if any).
- **▶▶** : Advances forward to the next chapter mark (if any).
- **◀•** : Replays the current programme for a set period of time.
- **•▶** : Advances forward a set period of time.
- **◀◀◀** : Plays a programme in fast reverse mode.
- **▶▶▶** : Plays a programme in fast forward mode.
- **▷** : Plays a programme at a normal speed.
- **⏸** : Pauses playback.
- **■** : Stops the playback.
- **VISUAL SEARCH** : Only for Sony DVD recorders with the visual search function. For details, see the operating instructions supplied with the DVD recorder.

**24 DVD/VCR record buttons**

- **● REC**: Starts recording.
  - **⏸ REC PAUSE**: Pauses the recording.
  - **■ REC STOP**: Stops the recording.
- ⏸ REC PAUSE and ■ REC STOP are available only on DVD recorders.

**25 F1/F2**

- Selects a disc when using a DVD changer.
  - Selects a function when using a combination unit (e.g. a DVD/VCR).
- For details, see the operating instructions supplied with the DVD changer or combination unit.

**26 DVD MENU**

Displays the DVD disc menu.

**27 DVD TOP MENU**

Displays the top menu of the DVD disc.

**Tip**

The number 5, ▷, PROG + and A/B buttons have tactile dots. Use the tactile dots as references when operating the TV.

# Overview of the TV buttons and indicators

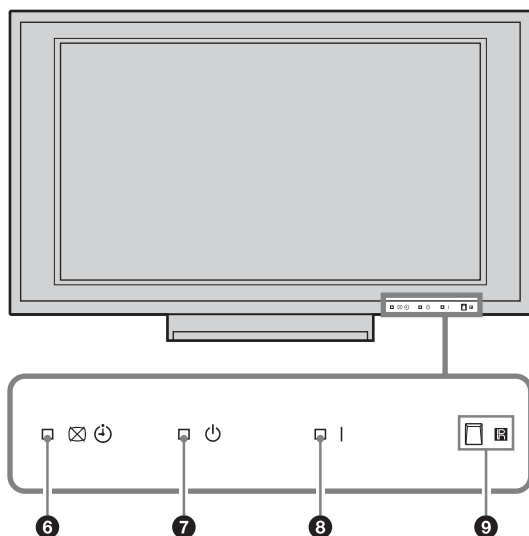
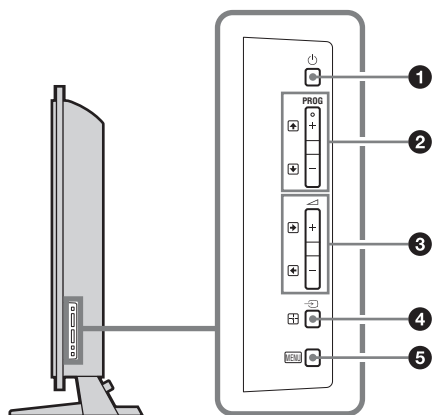



- 1** – **Power**  
 Switches the TV on or off.
- 2** **PROG**
  - In TV mode: Selects the next (+) or previous (-) channel.
  - In TV menu: Moves through the options up () or down ()
- 3**
  - In TV mode: Increases (+) or decreases (-) the volume.
  - In TV menu: Moves through the options right () or left ()
- 4** – **Input select/OK**
  - In TV mode (page 21): Selects the input source from equipment connected to the TV sockets.
  - In TV menu: Selects the menu or option, and confirms the setting.
- 5** **MENU** (page 22)
- 6** – **Picture Off/Timer indicator**
  - Lights up in green when the picture is switched off (page 29).
  - Lights up in orange when the timer is set (page 29).
- 7** – **Standby indicator**  
 Lights up in red when the TV is in standby mode.
- 8** **I** – **Power indicator**  
 Lights up in green when the TV is switched on.
- 9** **Remote control sensor**

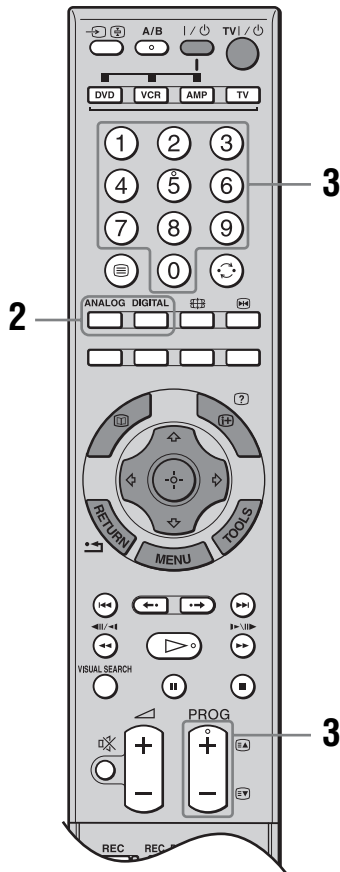
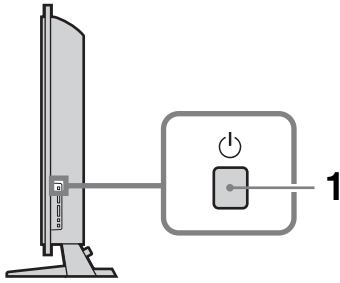

## Note

Make sure that the TV is completely switched off before unplugging the mains lead. Unplugging the mains lead while the TV is turned on may cause the indicator to remain lit or may cause the TV to malfunction.

# Watching TV



**1** Press  on the TV (right side) to switch on the TV.

When the TV is in standby mode (the  (standby) indicator on the TV (front) is red), press TV  on the remote to switch on the TV.

**2** Press DIGITAL to switch to digital mode or ANALOG to switch to analogue mode.

The channels available vary depending on the mode.









**3** Press the number buttons or PROG +/- to select a TV channel.

To select channel numbers 10 and above using the number buttons, enter the second and third digits within two seconds.







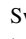

To select a digital channel using the Digital Electronic Programme Guide (EPG), see page 18.

### In digital mode

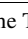
An information banner appears briefly. The following icons may be indicated on the banner.

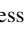
- : Interactive service is available (Digital Text)
- : Radio service
- : Scrambled/Subscription service
- : Multiple audio languages available
- : Subtitles available
- : Subtitles available for the hearing impaired
- : Recommended minimum age for current programme (from 4 to 18 years)
- : Parental Lock
- : Current programme is being recorded

### Additional operations

To	Do this
Switch off the TV temporarily (standby mode)	Press TV  .
Switch off the TV completely	Press  on the TV (right side).
Switch on the TV without sound from standby mode	Press  . Press  to adjust the volume.
Adjust the volume	Press  + (increase)/ - (decrease).
Mute the sound	Press  . Press again to restore.
Access the Programme index table (in analogue mode only)	Press  . To select an analogue channel, press  , then press  . To access the Input signal index table, see page 21.

*Continued*

## To access Digital Text



Many broadcasters provide a Digital Text service. Digital Text offers graphically rich contents, compared to Analogue Text.

Select a digital channel which provides Digital Text, then press .

When a broadcaster provides a dedicated Digital Text channel, select this channel to access Digital Text.

To navigate through Digital Text, follow the instructions on the screen.

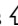
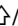

To exit Digital Text, press RETURN.

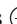
To move around, press ///.

To select items, press  and the number buttons.



To access shortcuts, press the coloured buttons.

## To access Analogue Text





In analogue mode, press . Each time you press , the display changes cyclically as follows:

Text and TV picture → Text → No Text (exit the Text service)

To select a page, press the number buttons or PROG +/-.

To hold a page, press /.

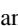
To reveal hidden information, press /.

To jump a page, press  and /, then press  (for three digit pages).

### Tips

- Ensure that the TV is receiving a good signal, or some text errors may occur.
- Most TV channels broadcast a Text service. For information on the use of the service, select the index page.
- When four coloured items appear at the bottom of the Text page, Fastext is available. Fastext allows you to access pages quickly and easily. Press the corresponding coloured button to access the page.

## To freeze the picture – Picture freeze

You can freeze the current picture to make a note of a telephone number or recipe.

**1** Press .

The frozen picture is displayed on the right of the screen. You can watch a moving picture on the left.

**2** Press  again to return to normal TV mode.

## To change the screen mode manually to suit the broadcast

Press  repeatedly to select Smart, 4:3, Wide, Zoom, or 14:9.

### Smart\*

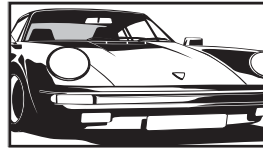

Displays conventional 4:3 broadcasts with an imitation wide screen effect. The 4:3 picture is stretched to fill the screen.

### 4:3



Displays conventional 4:3 broadcasts (e.g. non-wide screen TV) in the correct proportions.

### Wide

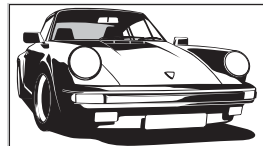

Displays wide screen (16:9) broadcasts in the correct proportions.

### Zoom\*

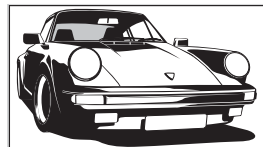

Displays cinemascopic (letter box format) broadcasts in the correct proportions.

### 14:9\*

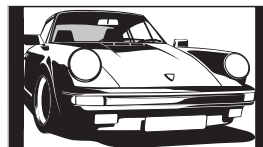

Displays 14:9 broadcasts in the correct proportions. As a result, black border areas are visible on the screen.

\* Parts of the top and bottom of the picture may be cut off.

### Tips

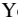
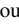
- Alternatively, you can set “Auto Format” to “On”. The TV will automatically select the best mode to suit the broadcast (page 27).
- You can adjust the position of the picture when selecting Smart, 14:9 or Zoom. Press / to move up or down (e.g. to read subtitles).



## To use the Tools menu

Press TOOLS to display the following options when viewing a TV programme.

Options	Description
Close	Closes the Tools menu.
PAP (or Single Picture)	See page 17.
Picture Mode	See page 23.
Sound Mode	See page 26.
Subtitle Setting (in digital mode only)	See page 35.
Digital Favourites (in digital mode only)	See page 20.
Power Saving	See page 29.
Sleep Timer	See page 29.
 Volume*	See page 30.
Auto Clock Set (in analogue mode only)	Allows you to switch to digital mode and obtain the time.

\* This option appears only if “ Speaker Link” is set to “Off” (page 30).



## To view two pictures simultaneously – PAP (Picture and Picture)

You can view two pictures (external input and TV programme) on the screen simultaneously.

Connect the optional equipment (page 39), and make sure that images from the equipment appear on the screen (page 21).

### Notes

- This function is not available for a PC input source.
- You cannot change the size of the pictures.

Press / to select “PAP” from the Tools menu, then press . The picture from the connected equipment is displayed on the left and the TV programme is displayed on the right.

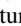
To return to normal TV mode, press  or RETURN.

### Tips

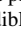
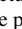
- You can also return to normal TV mode by selecting “Single Picture” from the Tools menu.
- The picture framed in green is audible. You can switch the audible picture by pressing /.

# Checking the Digital Electronic Programme Guide (EPG) DV3\*



Digital Electronic Programme Guide (EPG)

\* This function may not be available in some countries.

- 1 In digital mode, press to display the Digital Electronic Programme Guide (EPG).
- 2 Perform the desired operation, as shown in the following table.

## Note

Programme information will only be displayed if the TV station is transmitting it.

To	Do this
Turn off the EPG	Press .
Move through the EPG	Press , , , .
Watch a current programme	Press  while the current programme is selected.
Sort the programme information by category – Category list	<ol style="list-style-type: none"> <li>1 Press the blue button.</li> <li>2 Press , , ,  to select a category. The category name is displayed on the side. The categories available include: “Favourite”: Contains all the channels that have been stored in the Favourite list (page 20). “All Categories”: Contains all available channels. “News”: Contains all news channels.</li> <li>3 Press .</li> </ol> <p>The Digital Electronic Programme Guide (EPG) now only displays the current programmes from the category selected.</p>
Set a programme to be recorded – Timer REC	<ol style="list-style-type: none"> <li>1 Press , , ,  to select the future programme you want to record.</li> <li>2 Press .</li> <li>3 Press ,  to select “Timer REC”.</li> <li>4 Press  to set the TV and your VCR timers. A  symbol appears by that programme’s information. The  indicator on the TV (front) lights up.</li> </ol>

## Notes

- You can set VCR timer recording on the TV only for Smartlink compatible VCRs. If your VCR is not Smartlink compatible, a message will be displayed to remind you to set your VCR timer.
- Once a recording has begun, you can switch the TV to standby mode, but do not switch off the TV completely or the recording may be cancelled.
- If an age restriction for programmes has been selected, a message asking for a PIN code will appear on the screen. For more details refer to “Parental Lock” on page 35.

To	Do this
Set a programme to be displayed automatically on the screen when it starts – Reminder	<ol style="list-style-type: none"> <li>1 Press <math>\uparrow/\downarrow/\leftarrow/\rightarrow</math> to select the future programme you want to display.</li> <li>2 Press <math>\oplus</math>.</li> <li>3 Press <math>\uparrow/\downarrow</math> to select “Reminder”.</li> <li>4 Press <math>\oplus</math> to automatically display the selected programme when the programme starts. A <math>\odot</math> symbol appears by that programme’s information.</li> </ol> <p><b>Note</b> If you switch the TV to standby mode, it will automatically turn itself on when the programme is about to start.</p>
Set the time and date of a programme you want to record – Manual timer REC	<ol style="list-style-type: none"> <li>1 Press <math>\oplus</math>.</li> <li>2 Press <math>\uparrow/\downarrow</math> to select “Manual timer REC”, then press <math>\oplus</math>.</li> <li>3 Press <math>\uparrow/\downarrow</math> to select the date, then press <math>\rightarrow</math>.</li> <li>4 Set the start and stop time in the same way as in step 3.</li> <li>5 Press <math>\uparrow/\downarrow</math> to select the programme, then press <math>\oplus</math> to set the TV and your VCR timers. A <math>\text{REC}</math> symbol appears by that programme’s information. The <math>\odot</math> indicator on the TV (front) lights up.</li> </ol> <p><b>Notes</b></p> <ul style="list-style-type: none"> <li>• You can set VCR timer recording on the TV only for Smartlink compatible VCRs. If your VCR is not Smartlink compatible, a message will be displayed to remind you to set your VCR timer.</li> <li>• Once a recording has begun, you can switch the TV to standby mode, but do not switch off the TV completely or the recording may be cancelled.</li> <li>• If an age restriction for programmes has been selected, a message asking for a PIN code will appear on the screen. For more details refer to “Parental Lock” on page 35.</li> </ul>
Cancel a recording/reminder – Timer list	<ol style="list-style-type: none"> <li>1 Press <math>\oplus</math>.</li> <li>2 Press <math>\uparrow/\downarrow</math> to select “Timer list”.</li> <li>3 Press <math>\uparrow/\downarrow</math> to select the programme you want to cancel, then press <math>\oplus</math>. A display appears to confirm that you want to cancel the programme.</li> <li>4 Press <math>\rightarrow</math> to select “Yes”, then press <math>\oplus</math> to confirm.</li> </ol>

**Tip**

You can also display the Digital Electronic Programme Guide (EPG) by selecting “Digital EPG” in the “MENU” (page 22).

# Using the Digital Favourite list DV3\*



Digital Favourite list

The Favourite feature allows you to select programmes from a list of up to 20 channels you specify. To display the Favourite list, see “Navigating through menus” (page 22).

\* This function may not be available in some countries.

To	Do this
Create your Favourite list for the first time	<p>A message appears asking if you want to add channels to the Favourite list when you select “Digital Favourites” in the “MENU” for the first time.</p> <ol style="list-style-type: none"> <li>1 Press <b>+</b> to select “Yes”.</li> <li>2 Press <b>↑/↓</b> to select the channel you want to add. If you know the channel number, you can use the number buttons to directly select a channel.</li> <li>3 Press <b>+</b>. Channels that are stored in the Favourite list are indicated by a <b>♥</b> symbol.</li> </ol>
Turn off the Favourite list	Press <b>RETURN</b> .
See brief details on current programmes	Press <b>+</b> while selecting a channel. Press again to cancel.
Watch a channel	Press <b>+</b> while selecting a channel.
Add or remove channels in the Favourite list	<ol style="list-style-type: none"> <li>1 Press the blue button. Channels that are stored in the Favourite list are indicated by a <b>♥</b> symbol.</li> <li>2 Press <b>↑/↓</b> to select the channel you want to add or remove. If you know the channel number, you can use the number buttons to directly select a channel.</li> <li>3 Press <b>+</b>.</li> <li>4 Press the blue button to return to the Favourite list.</li> </ol>
Remove all channels from the Favourite list	<ol style="list-style-type: none"> <li>1 Press the blue button.</li> <li>2 Press the yellow button. A display appears to confirm that you want to delete all channels from the Favourite list.</li> <li>3 Press <b>↵</b> to select “Yes”, then press <b>+</b> to confirm.</li> </ol>

# Viewing pictures from connected equipment

Switch on the connected equipment, then perform one of the following operation.

## For equipment connected to the scart sockets using a fully-wired 21-pin scart lead (page 40)

Start playback on the connected equipment. The picture from the connected equipment appears on the screen.

## For an auto-tuned VCR (page 7)

In analogue mode, press PROG +/-, or the number buttons, to select the video channel.

## For other connected equipment (page 39)

Press repeatedly until the correct input symbol (see below) appears on the screen.

AV1 / AV2 / AV3 / AV4:

Audio/video or RGB input signal through the scart socket 1, 2 or 3. appears only if an RGB source has been connected.

AV4:

Component input signal through the Y, Pb/Cb, Pr/Cr sockets 4, and audio input signal through the L (MONO), R sockets 4.

AV5:

Digital audio/video input signal through the HDMI IN 5 socket.

AV6:

Digital audio/video input signal through the HDMI IN 6 socket. Audio input signal is analogue only if the equipment has been connected using the DVI and audio out socket.

AV7 / S / AV7:

Input symbols appear depending on the connected equipment and the “AV7 Input” setting in the “AV Set-up” menu (page 31).

AV7: Component input signal through the Y, Pb/Cb, Pr/Cr sockets 7, and audio input signal through the audio L (MONO)/R sockets 7.

AV7: Composite input signal through the video socket 7, and audio input signal through the audio L (MONO)/R sockets 7.

S / AV7: S video input signal through the S video socket 7, and audio input signal through the audio L (MONO)/R sockets 7.

PC:

PC video input signal through the PC socket, and audio input signal through the PC audio socket .

## Additional operations

To	Do this
Return to normal TV operation	Press the TV function button, DIGITAL or ANALOG.
Access the Input signal index table (except for PC video input signal)	Press  to access the Input signal index table. (Then, only in analogue mode, press .) To select an input source, press /, then press .

## To use the Tools menu

Press TOOLS to display the following options when viewing pictures from connected equipment other than a PC.

Options	Description
Close	Closes the Tools menu.
PAP (or Single Picture)	See page 17.
Picture Mode	See page 23.
Sound Mode	See page 26.
Power Saving	See page 29.
Sleep Timer	See page 29.
Volume*	See page 30.
Auto Clock Set	Allows you to switch to digital mode and obtain the time.

\* This option appears only if “ Speaker Link” is set to “Off” (page 30).

## Using MENU Functions

# Navigating through menus

“MENU” allows you to enjoy various convenient features of this TV. You can easily select channels or inputs sources and change the settings for your TV.



**1** Press MENU to display the menu.

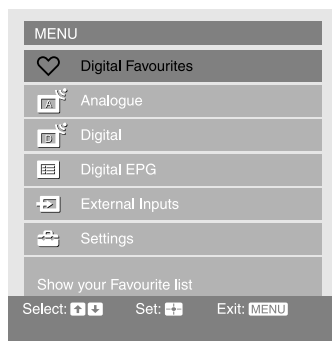

Icon	Description
	<b>Digital Favourites*</b> Displays the Favourite list. For details about settings, see page 20.
	<b>Analogue</b> Returns to the last viewed analogue channel.

Icon	Description
	<b>Digital*</b> Returns to the last viewed digital channel.
	<b>Digital EPG*</b> Displays the Digital Electronic Programme Guide (EPG). For details about settings, see page 18.
	<b>External Inputs</b> Selects equipment connected to your TV. <ul style="list-style-type: none"> <li>To watch the desired external input, select the input source, then press (+).</li> <li>To assign a label to an external input, see page 31.</li> </ul>
	<b>Settings</b> Displays the Settings menu where most of the advanced settings and adjustments are performed. For details about settings, see page 23 to 36.

\* This function may not be available in some countries.

- 2** Press to select an option.
- 3** Press to confirm a selected option.  
To exit the menu, press MENU.

# Picture menu

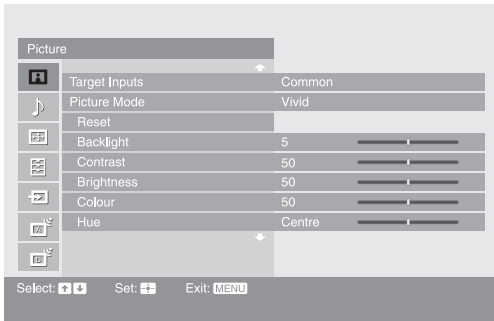

You can select the options listed below on the Picture menu.

- 1 Press  $\uparrow/\downarrow$  to select “Settings” on MENU, then press  $\oplus$ .
- 2 Press  $\uparrow/\downarrow$  to select a menu icon, then press  $\oplus$ .
- 3 Press  $\uparrow/\downarrow/\leftarrow/\rightarrow$  to select an option.

## Target Inputs

For the input currently being viewed, select whether to use the common setting or to set each item separately.

“Common”: Applies common settings whose adjustments are shared with other inputs in which “Target Inputs” is set to “Common”.

Current input name (e.g. AV1): Allows you to set each option separately for the current input.

## Picture Mode

Selects the picture mode.

“Vivid”: For enhanced picture contrast and sharpness.

“Standard”: For standard picture. Recommended for home entertainment.

“Custom”: Allows you to store your preferred settings.

## Reset

Resets all the “Picture” settings except “Target Inputs” and “Picture Mode” to the factory settings.

### Tip

“Advanced Settings” (page 25) is also not reset. Select “Reset” in “Advanced Settings” to reset items in “Advanced Settings”.

## Backlight

Adjusts the brightness of the backlight.

## Contrast

Increases or decreases picture contrast.

## Brightness

Brightens or darkens the picture.

## Colour

Increases or decreases colour intensity.

## Hue

Increases or decreases the green tones and red tones.

### Tip

“Hue” can only be adjusted for an NTSC colour signal (e.g. U.S.A. video tapes).

---

## Colour Temperature

Adjusts the whiteness of the picture.

“Cool”: Gives the white colours a blue tint.

“Neutral”: Gives the white colours a neutral tint.

“Warm 1”/“Warm 2”: Gives the white colours a red tint. “Warm 2” gives a redder tint than “Warm 1”.

### Tip

“Warm 1” and “Warm 2” can only be selected when you set “Picture Mode” to “Custom”.

---

## Sharpness

Sharpens or softens the picture.

---

## Noise Reduction

Reduces the picture noise (snowy picture).

“Auto”: Automatically reduces the picture noise.

“High”/“Medium”/“Low”: Modifies the effect of the noise reduction.

“Off”: Turns off the Noise Reduction feature.

“BNR”: Reduces the block picture noise. This is effective for digital channels, or a connected DVD player/digital satellite receiver with MPEG playback.

### Tips

- “Auto” is not available when watching component, HDMI or digital RF inputs.
  - “Noise Reduction” is not available when using Freeze or PAP features.
- 

## DRC Mode

Selects a high-resolution picture with 4x density, for high quality sources (e.g. DVD players, satellite receivers).

“Mode 1”: Recommended for moving pictures.

“Mode 2”: Recommended for still images and text.

“Off”: Turns off the DRC Mode.

### Tip

“DRC Mode” is not available when “Game Mode” is set to “On” or when using Freeze or PAP features; also not available when watching 480p, 576p, 720p, 1080i or 1080p sources.

---

## DRC Palette

Customizes the level of detail (“Reality”) and smoothness (“Clarity”) for each input signal. For example, you can create one custom setting to optimize your cable input picture, and create another to optimize your DVD player’s picture.

The DRC palette appears.

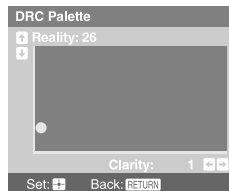

### 1 Press $\uparrow/\downarrow/\leftarrow/\rightarrow$ to adjust the position of the marker (●).

As you move the ● higher along the “Reality” axis, the picture becomes more detailed. As you move the ● to the right along the “Clarity” axis, the picture becomes smoother.

### 2 To save the settings, press $\oplus$ .

### Tip

“DRC Palette” is not available when “Game Mode” is set to “On”, “DRC Mode” is set to “Off” or when using Freeze or PAP features; also not available when watching 480p, 576p, 720p, 1080i or 1080p sources.

---



---

## Advanced Settings

Customizes the Picture function in more detail. When you set “Picture Mode” to “Custom”, you can set/change these settings.

“Reset”: Resets all the advanced settings to the factory settings.

“Black Corrector”: Enhances black areas of the picture for stronger contrast.

“Adv. Contrast Enhancer”: Automatically adjusts “Backlight” and “Contrast” to the most suitable settings judging from the brightness of the screen. This setting is especially effective for dark images, increasing vibrancy in the picture.

“Gamma”: Adjusts the balance between bright and dark areas of the picture.

“Clear White”: Emphasizes white colours.

“Live Colour”: Makes colours more vivid.

“Colour Space”: Changes the colour reproduction gamut. “Wide” reproduces the vivid colour and “Normal” reproduces the standard colour.

“White Balance”: Adjusts the colour temperature colour by colour.

“Detail Enhancer”: Enhances the details of the picture.

“Edge Enhancer”: Enhances the outline of the picture.

### Tips

- “Adv. Contrast Enhancer” and “Detail Enhancer” are not available when using Freeze or PAP features.
  - “Live Colour” is not available when “Colour Space” is set to “Normal”.
-

# Sound menu

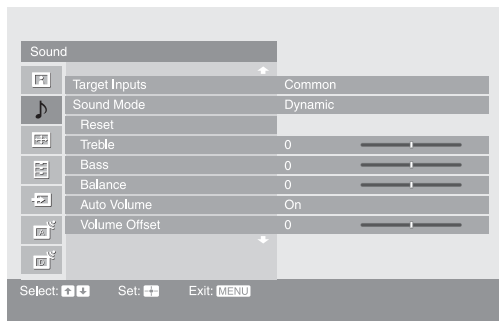

You can select the options listed below on the Sound menu. To select options in “Settings”, refer to “Picture menu” (page 23).

<b>Target Inputs</b>	For the input currently being viewed, select whether to use the common setting or to set each item separately. “Common”: Applies common settings whose adjustments are shared with other inputs in which “Target Inputs” is set to “Common”. Current input name (e.g. AV1): Allows you to set each option separately for the current input.
<b>Sound Mode</b>	Selects the sound mode. “Dynamic”: Enhances treble and bass. “Standard”: For standard sound. Recommended for home entertainment. “Custom”: Flat response. Also allows you to store your preferred settings.
<b>Reset</b>	Resets all the “Sound” settings except “Target Inputs”, “Sound Mode” and “Dual Sound” to the factory settings.
<b>Treble</b>	Adjusts higher-pitched sounds.
<b>Bass</b>	Adjusts lower-pitched sounds.
<b>Balance</b>	Emphasizes left or right speaker balance.
<b>Auto Volume</b>	Keeps a constant volume level even when volume level gaps occur (e.g. adverts tend to be louder than programmes).
<b>Volume Offset</b>	Adjusts the volume level of the current input relative to other inputs, when “Target Inputs” is set to the current input name (e.g. AV1).
<b>Surround</b>	Selects the surround mode. “Dolby Virtual”: Uses the TV speakers to simulate the surround effect produced by a multi channel system. “Off”: For normal stereo or mono reception.
<b>BBE</b>	Gives sound more impact by compensating for phase effects in speakers using the “BBE High Definition Sound System”.
<b>Dual Sound</b>	Selects the sound from the speaker for a stereo or bilingual broadcast. “Stereo”, “Mono”: For a stereo broadcast. “A”/“B”/“Mono”: For a bilingual broadcast, select “A” for sound channel 1, “B” for sound channel 2, or “Mono” for a mono channel, if available. <b>Tip</b> If you select other equipment connected to the TV, set “Dual Sound” to “Stereo”, “A” or “B”.

## Tip

Sound menu options other than “Dual Sound” cannot be used for headphones and audio output sockets.

# Screen menu

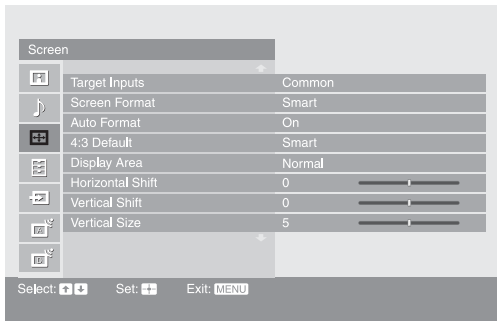

You can select the options listed below on the Screen menu. To select options in “Settings”, refer to “Picture menu” (page 23).

## Target Inputs

For the input currently being viewed, select whether to use the common setting or to set each item separately.

“Common”: Applies common settings whose adjustments are shared with other inputs in which “Target Inputs” is set to “Common”.

Current input name (e.g. AV1): Allows you to set each option separately for the current input.

## Screen Format

For details about the screen format, see “To change the screen mode manually to suit the broadcast” (page 16).

## Auto Format

Automatically changes the screen format according to the broadcast signal. To keep your setting, select “Off”.

### Tip

Even if “Auto Format” is set to “On” or “Off”, you can always modify the format of the screen by pressing **⇄** repeatedly.

## 4:3 Default

Selects the default screen mode for use with 4:3 broadcasts.

“Smart”: Displays conventional 4:3 broadcasts with an imitation wide screen effect.

“4:3”: Displays conventional 4:3 broadcasts in the correct proportions.

“Off”: Keeps the current “Screen Format” setting when the channel or input is changed.

### Tip

This option is available only if “Auto Format” is set to “On”.

## Display Area

Adjusts the screen area displaying the picture.

“Full Pixel”: Displays the picture for 1080i or 1080p sources in the original size when parts of the picture are cut off.

“Normal”: Displays the picture in the original size.

“-1”/“-2”: Enlarges the picture to hide the edge of the picture.

### Tip

“Full Pixel” is available only when Screen Format is set to “Wide”.

## Horizontal Shift

Adjusts the horizontal position of the picture for each screen format.

### Tip

This option is not available when “Display Area” is set to “Full Pixel”.

---

**Vertical Shift**

Adjusts the vertical position of the picture when the screen format is set to Smart, Zoom or 14:9.

---

**Vertical Size**

Adjusts the vertical size of the picture when the screen format is set to Smart.

---

# Set-up menu

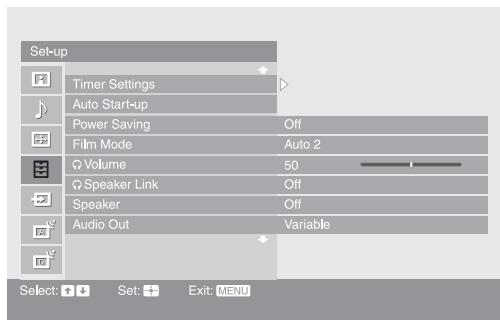

You can select the options listed below on the Set-up menu. To select options in “Settings”, refer to “Picture menu” (page 23).

## Timer Settings

Sets the timer to switch on/off the TV.

### Sleep Timer

Sets a period of time after which the TV automatically switches itself into standby mode.

When the Sleep Timer is activated, the ⌚ (Timer) indicator on the TV (front) lights up in orange.

#### Tips

- If you switch off the TV and switch it on again, “Sleep Timer” is reset to “Off”.
- “TV will soon turn off by Sleep Timer” appears on the screen one minute before the TV switches to standby mode.

### On Timer

Sets the timer to switch on the TV from standby mode.

“Day”: Selects the day on which you want to activate the On Timer.

“Time”: Sets the time to switch on the TV.

“Duration”: Selects the time period after which the TV automatically switches to standby mode again.

“Volume Set-up”: Sets the volume for when the timer switches on the TV.

### Clock Set

Allows you to adjust the clock manually. When the TV is receiving digital channels, the clock cannot be adjusted manually since it is set to the time code of the broadcasted signal.

## Auto Start-up



Starts the “first time operation menu” to select the language and country/region, tune in all available digital and analogue channels, and set the time (only when no digital channels are received). Usually, you do not need to do this operation because the language and country/region will have been selected and channels already tuned when the TV was first installed (page 6, 7). However, this option allows you to repeat the process (e.g. to retune the TV after moving house, or to search for new channels that have been launched by broadcasters).

## Power Saving

Selects the power saving mode to reduce the power consumption of the TV.

When “Picture Off” is selected, the picture is switched off and the ☒ (Picture Off) indicator on the TV (front) lights up in green. The sound remains unchanged.

*Continued*

<b>Film Mode</b>	<p>Provides smoother picture movement when playing DVD or VCR images taken on film, reducing picture blur and graininess.</p> <p>“Auto 1”: For a stable picture with minimal noise. Set to “Auto 2” if the screen is partially degraded.</p> <p>“Auto 2”: Use this setting for standard use.</p> <p>“Off”: Turns off the Film mode.</p> <p><b>Notes</b></p> <ul style="list-style-type: none"> <li>• Even if “Auto 1” or “Auto 2” is selected, “Film Mode” will be automatically turned off and a moving image will not be played smoothly if the image contains irregular signals or too much noise.</li> <li>• Film Mode is not available when using Freeze or PAP features, or when watching 480p, 576p, 720p or 1080p sources.</li> </ul>
<b> Volume (headphone volume)</b>	Adjusts the volume of the headphones when “  Speaker Link” is set to “Off”.
<b> Speaker Link (headphone speaker link)</b>	<p>Switches the TV’s internal speakers on/off when headphones are connected.</p> <p>“On”: Sound is output only from headphones.</p> <p>“Off”: Sound is output from both the TV and headphones.</p>
<b>Speaker</b>	<p>Switches on/off the TV’s internal speakers.</p> <p>“On”: The TV speakers are turned on in order to listen to the TV’s sound through the TV speakers.</p> <p>“Off”: The TV speakers are turned off in order to listen to the TV’s sound only through your external audio equipment connected to the audio output sockets.</p>
<b>Audio Out</b>	<p>“Variable”: The audio output from your audio system can be controlled by the TV’s remote.</p> <p>“Fixed”: The audio output of the TV is fixed. Use your audio receiver’s volume control to adjust the volume (and other audio settings) through your audio system.</p>
<b>Light Sensor</b>	<p>“On”: Automatically optimizes the picture settings according to the ambient light in the room.</p> <p>“Off”: Turns off the “Light Sensor” feature.</p>
<b>Logo Illumination</b>	Lights up and turns off the Sony logo on the front of the TV.
<b>Language</b>	Selects the language in which the menus are displayed.
<b>Information</b>	Displays your TV’s product information.
<b>All Reset</b>	<p>Resets all settings to the factory settings and then displays the Auto Start-up screen.</p> <p><b>Note</b></p> <p>All settings, including Digital Favourite list, country, language, auto tuned channels, etc. will be reset.</p>

# AV Set-up menu

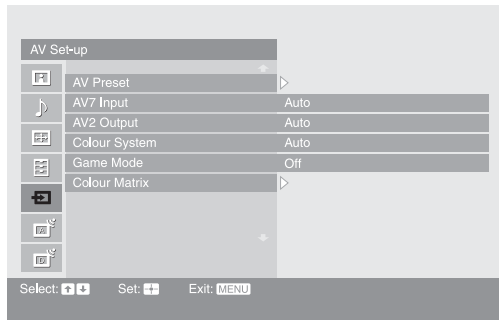

You can select the options listed below on the AV Set-up menu. To select options in “Settings”, refer to “Picture menu” (page 23).

## AV Preset

Assigns a name to any equipment connected to the side and rear sockets. The name will be displayed briefly on the screen when the equipment is selected. You can skip an input source that is not connected to any equipment.

- 1 Press  $\uparrow/\downarrow$  to select the desired input source, then press  $\oplus$ .
- 2 Press  $\uparrow/\downarrow$  to select the desired option below, then press  $\oplus$ .

Equipment labels: Uses one of the preset labels to assign a name to connected equipment.

“Edit”: Creates your own label. Follow steps 2 to 4 of “Programme Labels” (page 32).

“Skip”: Skips an unnecessary input source.

## AV7 Input

“Auto”: Switches automatically between the component video sockets, S Video socket, and the composite video sockets on the left side of the TV depending on the cable connection.

“Component”: Activates the component video sockets on the left side of the TV.

“S Video”: Activates the S Video socket on the left side of the TV.

“Composite”: Activates the composite video sockets on the left side of the TV.

### Tip

When multiple cables are connected and “Auto” is selected, “Component”, “S Video”, “Composite” will be activated in that order.

## AV2 Output

Sets a signal to be output through the socket labelled  $\leftrightarrow/\rightarrow$  2 on the rear of the TV. If you connect a VCR or other recording equipment to the  $\leftrightarrow/\rightarrow$  2 socket, you can then record from the equipment connected to other sockets of the TV.

“TV”: Outputs a broadcast.

“AV1”: Outputs signals from equipment connected to the  $\leftrightarrow/\rightarrow$  1 socket.

“AV3”: Outputs signals from equipment connected to the  $\leftrightarrow/\rightarrow$  3 socket.

“AV7”: Outputs signals from equipment connected to the  $\rightarrow/\rightarrow$  7 socket.

“Auto”: Outputs whatever is being viewed on the screen (except signals from the  $\rightarrow/\rightarrow$  4, HDMI IN 5, HDMI IN 6 and PC  $\rightarrow$  sockets).

## Colour System

Selects the colour system (“Auto”, “PAL”, “SECAM”, “NTSC3.58” or “NTSC4.43”) according to the input signal from the input source.

## Game Mode

Depending on the game software, reaction times may slow during fast-moving scenes, etc. Select “On” to improve the reaction times.

## Colour Matrix

Usually used in the factory setting (AV1/2/3/7 (Composite and S video input signal) is set to “ITU601”, and AV4/5/6/7 (Component input signal) is set to “Auto”). If the tone of the picture from the input source is unnatural, select either “ITU601” or “ITU709”, which normalizes the tone.

# Analogue Set-up menu



You can select the options listed below on the Analogue Set-up menu. To select options in “Settings”, refer to “Picture menu” (page 23).

---

## 1 Digit Direct

When “1 Digit Direct” is set to “On”, you can select an analogue channel using one preset number button (0 - 9) on the remote.

### Note

When “1 Digit Direct” is set to “On”, you cannot select channel numbers 10 and above entering two digits using the remote.

---

## Auto Tuning

Tunes in all the available analogue channels.

Usually you do not need to do this operation because the channels are already tuned when the TV was first installed (page 7). However, this option allows you to repeat the process (e.g. to retune the TV after moving house, or to search for new channels that have been launched by broadcasters).

---

## Programme Sorting

Changes the order in which the analogue channels are stored on the TV.

- 1 Press  $\uparrow/\downarrow$  to select the channel you want to move to a new position, then press  $\oplus$ .
- 2 Press  $\uparrow/\downarrow$  to select the new position for your channel, then press  $\oplus$ .

---

## Programme Labels

Assigns a channel name of your choice up to five letters or numbers. The name will be displayed briefly on the screen when the channel is selected. (Names for channels are usually taken automatically from Analogue Text (if available).)

- 1 Press  $\uparrow/\downarrow$  to select the channel you want to name, then press  $\oplus$ .
- 2 Press  $\uparrow/\downarrow$  to select the desired letter or number (“\_” for a blank space), then press  $\Rightarrow$ .

### If you input a wrong character

Press  $\Leftarrow/\Rightarrow$  to select the wrong character. Then, press  $\uparrow/\downarrow$  to select the correct character.

### To delete all the characters

Select “Reset”, then press  $\oplus$ .

- 3 Repeat the procedure in step 2 until the name is complete.
- 4 Select “OK”, then press  $\oplus$ .



## Manual Programme Preset

Before selecting “Label”/“AFT”/“Audio Filter”/“Skip”/“Decoder”, press PROG +/- to select the programme number with the channel. You cannot select a programme number that is set to skip (page 34).

### Programme/System/Channel

Presets programme channels manually.

- 1 Press  $\uparrow/\downarrow$  to select “Programme”, then press  $\oplus$ .
- 2 Press  $\uparrow/\downarrow$  to select the programme number you want to manually tune (if tuning a VCR, select channel 00), then press RETURN.
- 3 Press  $\uparrow/\downarrow$  to select “System”, then press  $\oplus$ .
- 4 Press  $\uparrow/\downarrow$  to select one of the following TV broadcast systems, then press  $\leftarrow$ .

B/G: For western European countries/regions

I: For the United Kingdom

D/K: For eastern European countries/regions

L: For France

- 5 Press  $\uparrow/\downarrow$  to select “Channel”, then press  $\oplus$ .
- 6 Press  $\uparrow/\downarrow$  to select “S” (for cable channels) or “C” (for terrestrial channels), then press  $\Rightarrow$ .

#### Note

“S” is not available when “United Kingdom” is selected for “Country” (page 6).

- 7 Tune the channels as follows:

#### If you do not know the channel number (frequency)

Press  $\uparrow/\downarrow$  to search for the next available channel. When a channel has been found, the search will stop. To continue searching, press  $\uparrow/\downarrow$ .

#### If you know the channel number (frequency)

Press the number buttons to enter the channel number of the broadcast you want or your VCR channel number.

- 8 Press  $\oplus$  to jump to “Confirm”, then press  $\oplus$ .
- 9 Press  $\downarrow$  to select “OK”, then press  $\oplus$ .

Repeat the procedure above to preset other channels manually.

### Label

Assigns a name of your choice, up to five letters or numbers, to the selected channel. This name will be displayed briefly on the screen when the channel is selected. To input characters, follow steps 2 to 4 of “Programme Labels” (page 32).

### AFT

Allows you to fine-tune the selected programme number manually if you feel that a slight tuning adjustment will improve the picture quality.

You can adjust the fine tuning over a range of -15 to +15. When “On” is selected, the fine tuning is performed automatically.

### Audio Filter

Improves the sound for individual channels in the case of distortion in mono broadcasts. Sometimes a non-standard broadcast signal can cause sound distortion or intermittent sound muting when watching mono programmes.

If you do not experience any sound distortion, we recommend that you leave this option set to the factory setting “Off”.

#### Notes

- You cannot receive stereo or dual sound when “Low” or “High” is selected.
- “Audio Filter” is not available when “System” is set to “L”.

**Skip**

Skips unused analogue channels when you press PROG +/- to select channels. (You can still select a skipped channel using the number buttons.)

**Decoder**

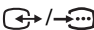
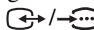
Views and records the scrambled channel selected when using a decoder connected directly to scart connector  1, or to scart connector  2 via a VCR.

**Note**

This option is not available when “United Kingdom” is selected for “Country” (page 6).

**Confirm**

Saves changes made to the “Manual Programme Preset” settings.

---

# Digital Set-up menu DV3



You can select the options listed below on the Digital Set-up menu. To select options in “Settings”, refer to “Picture menu” (page 23).

## Note

Some functions may not be available in some countries.

## Digital Settings

Displays the “Digital Settings” menu.

### Subtitle Setting

Displays digital subtitles on the screen.

When “For Hard Of Hearing” is selected, some visual aids may also be displayed with the subtitles (if TV channels broadcast such information).

### Subtitle Language

Selects which language subtitles are displayed in.

### Audio Language

Selects the language used for a programme. Some digital channels may broadcast several audio languages for a programme.

### Audio Type

Increases the sound level when “For Hard Of Hearing” is selected.

### Parental Lock

Sets an age restriction for programmes. Any programme that exceeds the age restriction can only be watched after a PIN Code is entered correctly.

#### 1 Press the number buttons to enter your existing PIN code.

If you have not previously set a PIN, a PIN code entry screen appears. Follow the instructions of “PIN Code” below.

#### 2 Press $\uparrow/\downarrow$ to select the age restriction or “None” (for unrestricted watching), then press $\oplus$ .

#### 3 Press RETURN.

### PIN Code

Sets a PIN code for the first time, or allows you to change your PIN code.

#### 1 Enter a PIN as follows:

##### If you have previously set a PIN

Press the number buttons to enter your existing PIN.

##### If you have not set a PIN

Press the number buttons to enter the factory setting PIN of 9999.

#### 2 Press the number buttons to enter the new PIN code.

A message appears to inform you that the new PIN has been accepted.

#### 3 Press RETURN.

### Tip

PIN code 9999 is always accepted.

### Technical Set-up

Displays the Technical Set-up menu.

“Auto Service Update”: Enables the TV to detect and store new digital services as they become available.

“Software Download”: Enables the TV to automatically receive software updates free through your existing aerial (when issued). It is recommended that this option be set to “On” at all times. If you do not want your software to be updated, set this option to “Off”.

“System Information”: Displays the current software version and the signal level.

“Time Zone”: Allows you to manually select the time zone you are in, if it is not the same as the default time zone setting for your country.

### CA Module Set-up

Allows you to access a Pay Per View service once you obtain a Conditional Access Module (CAM) and a view card. See page 39 for the location of the  (PCMCIA) socket.

#### Notes

- CAM is not supported in all countries. Check with your authorized dealer.
- “CA Module Set-up” is available only when a CAM is inserted.

---

## Digital Tuning

Displays the “Digital Tuning” menu.

### Digital Auto Tuning

Tunes in all the available digital channels.

Usually you do not need to do this operation because the channels were already tuned when the TV was first installed (page 7). However, this option allows you to repeat the process (e.g. to retune the TV after moving house, or to search for new channels that have been launched by broadcasters).

### Programme List Edit

Removes any unwanted digital channels stored on the TV, and changes the order of the digital channels stored on the TV.



- 1 Press  to select the channel you want to remove or move to a new position.

#### If you know the programme number



Press the number buttons to enter the three-digit programme number of the broadcast you want.

- 2 Remove or change the order of the digital channels as follows:

#### To remove the digital channel

Press . A message that confirms whether the selected digital channel is to be deleted appears. Press  to select “Yes”, then press .

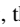



#### To change the order of the digital channels

Press , then press  to select the new position for the channel and press . Repeat the procedure in steps 1 and 2 to move other channels if required.

- 3 Press RETURN.

### Digital Manual Tuning

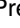
Tunes the digital channels manually.

- 1 Press the number button to select the channel number you want to manually tune, then press  to tune the channel.
- 2 When the available channels are found, press  to select the channel you want to store, then press .
- 3 Press  to select the programme number where you want to store the new channel, then press .

Repeat the above procedure to manually tune other channels.

# PC Settings menu

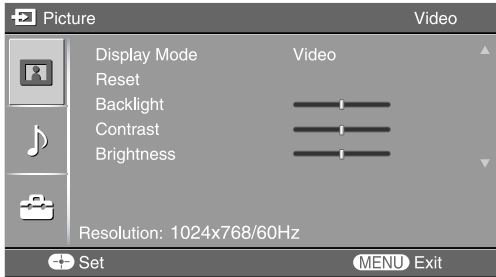

You can select the options listed below on the PC Settings menu when the TV is connected to a PC.

- 1 Press / repeatedly until PC appears on the screen.
- 2 Press MENU to display the PC settings menu.

## Picture

### Display Mode

Selects the display mode.  
 “Video”: Select to view video images.  
 “Text”: Select to view text, charts or tables.

### Reset

Resets all the “Picture” settings except “Display Mode” to the factory settings.

### Backlight

Adjusts the brightness of the backlight.

### Contrast

Increases or decreases picture contrast.

### Brightness

Brightens or darkens the picture.

### Colour Temperature

Adjusts the whiteness of the picture.  
 “Cool”: Gives the white colours a blue tint.  
 “Neutral”: Gives the white colours a neutral tint.  
 “Warm 1”/“Warm 2”: Gives the white colours a red tint. “Warm 2” gives a redder tint than “Warm 1”.

## Sound

### Sound Mode

Selects the sound mode.  
 “Dynamic”: Enhances treble and bass.  
 “Standard”: For standard sound. Recommended for home entertainment.  
 “Custom”: Flat response. Also allows you to store your preferred settings.

*Continued*

## Others

---

<b>Auto Adjustment</b>	Automatically adjusts the display position, phase and pitch of the picture when the TV receives an input signal from a connected PC. <b>Tip</b> Auto Adjustment may not work well with some input signals. In such cases, manually adjust “Phase”, “Pitch”, “Horizontal Shift” and “Vertical Shift”.
<b>Reset</b>	Resets all the “Others” settings to the factory settings.
<b>Phase</b>	Adjusts the phase when the screen flickers.
<b>Pitch</b>	Adjusts the pitch when the picture has unwanted vertical stripes.
<b>Horizontal Shift</b>	Adjusts the horizontal position of the picture for each screen format.
<b>Vertical Shift</b>	Adjusts the vertical position of the picture for each screen format.
<b>Screen Format</b>	Selects the screen mode. “Normal”: Displays the picture in its original size. “Full1”: Enlarges the picture to fill the display area, keeping its original horizontal-to-vertical aspect ratio. “Full2”: Enlarges the picture to fill the display area.
<b>Power Management</b>	Switches the TV to standby mode if no signal is received for 30 seconds.

---

# Connecting optional equipment

You can connect a wide range of optional equipment to your TV. Connecting cables are not supplied.

## Connecting to the TV (side)

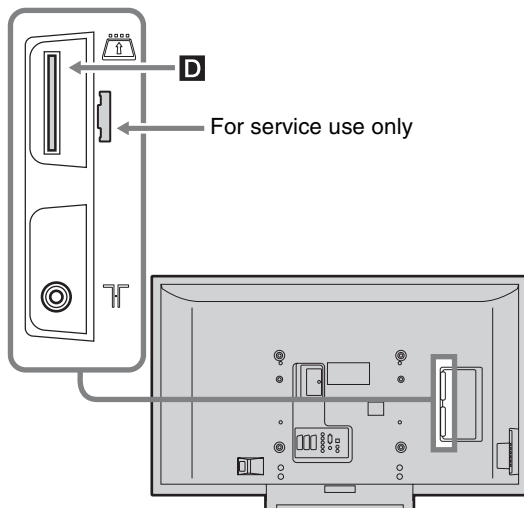
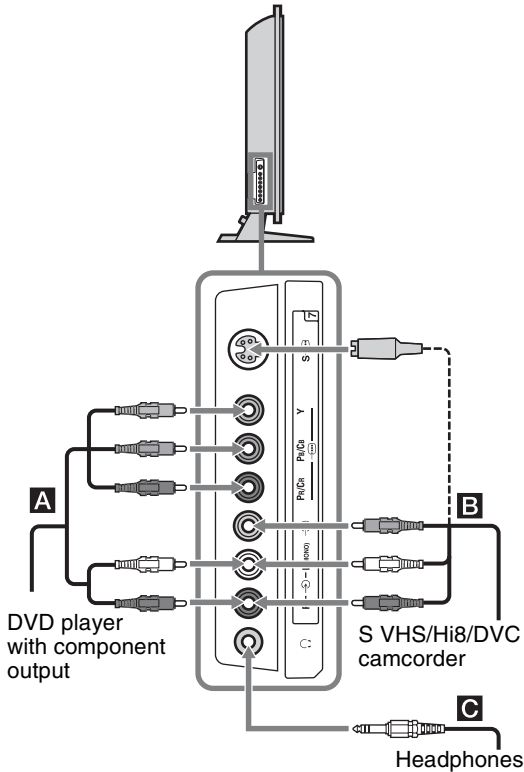

To connect	Do this
DVD player with component output <b>A</b>	Connect to the component Y, Pb/Cb, Pr/Cr sockets 7 and audio L (MONO), R sockets 7.

S VHS/Hi8/DVC camcorder <b>B</b>	Connect to the S video socket 7 or the video socket 7, and the audio sockets 7. To avoid picture noise, do not connect the camcorder to the video socket 7 and the S video socket 7 at the same time. If you connect mono equipment, connect to the L socket 7.
----------------------------------	---

**Tip**

You can select the input signal by setting “AV7 Input” in the “AV Set-up” menu (page 31).

Headphones <b>C</b>	Connect to the  socket to listen to sound from the TV on headphones.
---------------------	--

Conditional Access Module (CAM) <b>D</b>	To use Pay Per View services. For details, refer to the instruction manual supplied with your CAM. To use the CAM, press the eject button and remove the “dummy” card. Switch off the TV when inserting your CAM into the CAM slot. When you do not use the CAM, we recommend that the “dummy” card be inserted and kept in the CAM slot.
--	---

**Note**

CAM is not supported in all countries. Check with your authorized dealer.

*Continued*

## Connecting to the TV (rear)

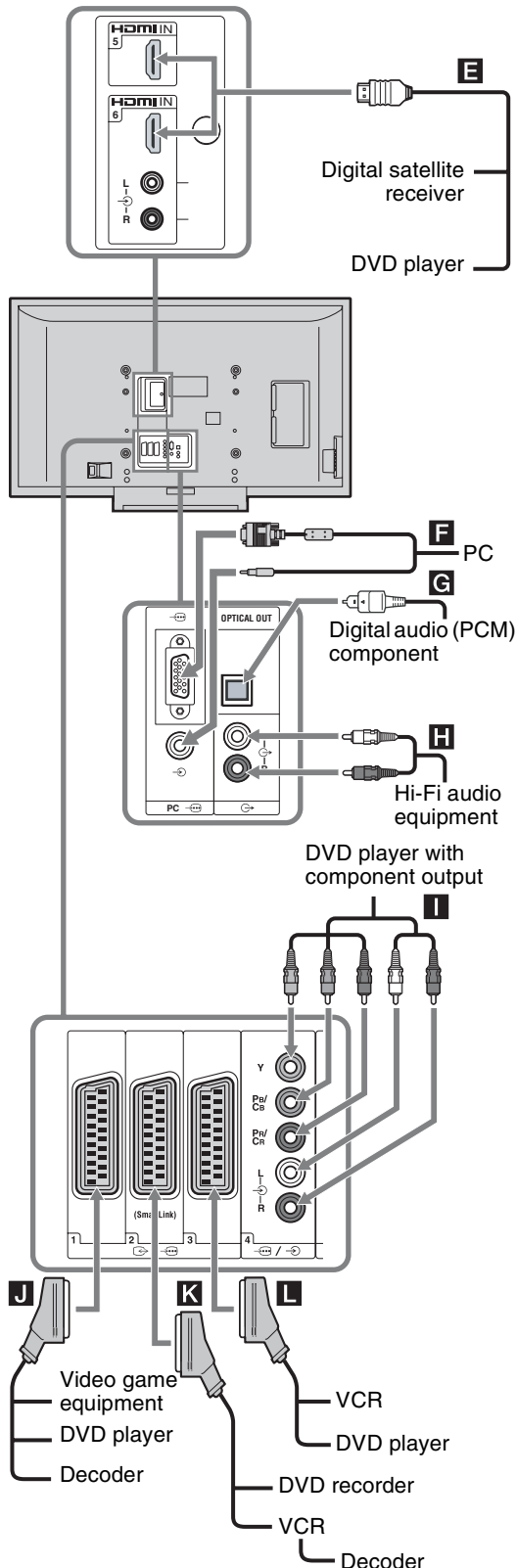

### To connect

### Do this

Digital satellite receiver or DVD player **E**

Connect to the HDMI IN 5 or 6 socket if the equipment has a HDMI socket. The digital video and audio signals are input from the equipment. If the equipment has a DVI socket, connect the DVI socket to the HDMI IN 6 socket through a DVI - HDMI adaptor interface (not supplied), and connect the equipment's audio out sockets to the audio in the HDMI IN 6 sockets.

#### Note

The HDMI sockets only support the following video inputs: 480i, 480p, 576i, 576p, 720p, 1080i and 1080p. To connect a PC, use the PC **F** socket.

PC **F**

Connect to the PC **F** sockets. It is recommended to use a PC cable with ferrites.

Digital audio (PCM) component **G**

Connect to the OPTICAL OUT socket using the Optical audio cable.

#### Note

The OPTICAL OUT socket only supports digital terrestrial signals.

Hi-Fi audio equipment **H**

Connect to the audio output sockets **H** to listen to the sound from the TV on Hi-Fi audio equipment.

DVD player with component output **I**

Connect to the component sockets and the audio sockets **I** 1-4.

Video game equipment, DVD player or decoder **J**

Connect to the scart socket **J** / **J** 1. When you connect the decoder, the scrambled signal from the TV tuner is output to the decoder, then the unscrambled signal is output from the decoder.

DVD recorder or VCR that supports SmartLink **K**

Connect to the scart socket **J** / **J** 2. SmartLink is a direct link between the TV and a VCR/DVD recorder.

VCR or DVD player **L**

For details, see page 5.



# Programming the remote

This remote is preset to operate Sony TVs, most Sony DVDs, VCRs and AMPs (Home Theatre, etc.).

To control VCRs and DVDs of other manufacturers (and some other Sony VCR, DVD and AMP models), do the following procedure to programme the remote.

## Note

Before you start, look up the three-digit code for your brand of DVD, VCR or AMP from the "Manufacturer's codes" on page 41.

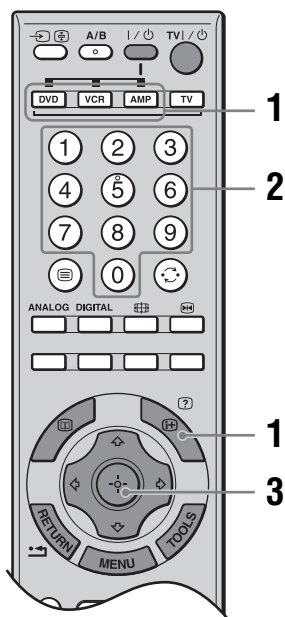

- 1 Press and hold the DVD, VCR or AMP function button you want to programme on the remote, then press (+), keeping the function button pressed down.

The selected function button (DVD, VCR or AMP) will flash.

- 2 Press the number buttons to enter the three-digit manufacturer's code number while the button is lit. If code is not entered within 10 seconds, you must perform the step 1 again.

- 3 Press (+).

When the programming is correct, the selected function button will flash twice, and when not, it will flash five times.

- 4 Switch on your equipment and check that the following main functions work.

▷ (playback), ■ (stop), ◀◀ (rewind), ▶▶ (fast forward), channel selection for both VCR and DVDs, TOP MENU/MENU and ↕/↔/↔/↔ only for DVDs.

## If your equipment is not working, or some of the functions do not work

Enter the correct code or try the next code listed for the brand. However, not all models of every brand may be covered.

## To return to normal TV operation

Press the TV function button, DIGITAL or ANALOG.

## Manufacturer's codes

### VCR brand list

Brand	Code
SONY	301, 302, 303, 304, 305, 306, 307, 308, 309, 310, 362
AIWA	325, 331, 351
AKAI	326, 329, 330
DAEWOO	342, 343
GRUNDIG	358, 355, 360, 361, 320, 351, 366
HITACHI	327, 333, 334
JVC	314, 315, 322, 344, 352, 353, 354, 348, 349
LG	332, 338
LOEWE	358, 355, 360, 361, 320, 351
MATSUI	356, 357
ORION	328
PANASONIC	321, 323
PHILIPS	311, 312, 313, 316, 317, 318, 358, 359, 363, 364
SAMSUNG	339, 340, 341, 345
SANYO	335, 336
SHARP	324
THOMSON	319, 350, 365
TOSHIBA	337

*Continued*

## DVD brand list

### DVD Player

Brand	Code
SONY	001, 029, 030, 036, 037, 038, 039, 040, 041, 042, 043, 044, 053, 054, 055
AIWA	021
AKAI	032
DENON	018, 027, 020, 002
GRUNDIG	009, 028, 023, 024, 016, 003
HITACHI	025, 026, 015, 004, 035
JVC	006, 017
KENWOOD	008
LG	015, 014, 034
LOEWE	009, 028, 023, 024, 016, 003
MATSUI	013, 016
ONKYO	022, 033
PANASONIC	018, 027, 020, 002, 045, 046, 047
PHILIPS	009, 028, 023, 024, 016, 003, 031
PIONEER	004, 050, 051, 052
SAMSUNG	011, 014
SANYO	007
SHARP	019, 027
THOMSON	012
TOSHIBA	003, 048, 049
YAMAHA	018, 027, 020, 002

### DVD/VCR Player

Brand	Code
SONY	101

### DVD recorder

Brand	Code
SONY	201, 202, 203

## AUX Sony systems brand list

### DAV Home Theatre System

Brand	Code
SONY (DAV)	401, 402, 403, 404

### AV receiver

Brand	Code
SONY	451, 452, 453, 454

### Digital terrestrial receiver

Brand	Code
SONY	501, 502, 503

# Specifications

## Display Unit

### Power Requirements:

220–240 V AC, 50 Hz

### Screen Size:

46 inches (Approx. 116.8 cm measured diagonally)

### Display Resolution:

1,920 dots (horizontal) × 1,080 lines (vertical)

### Power Consumption:

249 W

### Standby Power Consumption:

0.3 W

### Dimensions (w × h × d):

Approx. 1,262 × 795 × 322 mm (with stand)

Approx. 1,262 × 734 × 121 mm (without stand)

### Mass:

Approx. 41 kg (with stand)

Approx. 36 kg (without stand)

## Panel System

LCD (Liquid Crystal Display) Panel

## TV System

Analogue: Depending on your country/region selection:

B/G/H, D/K, L, I

Digital: DVB-T

## Colour/Video System

Analogue: PAL, SECAM

NTSC 3.58, 4.43 (only Video In)

Digital: MPEG-2 MP@ML

## Aerial

75 ohm external terminal for VHF/UHF

## Channel Coverage

Analogue: VHF: E2–E12

UHF: E21–E69

CATV: S1–S20

HYPERS: S21–S41

D/K: R1–R12, R21–R69

L: F2–F10, B–Q, F21–F69

I: UHF B21–B69

Digital: VHF/UHF

## Terminals

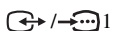

21-pin scart connector (CENELEC standard) including audio/video input, RGB input, and TV audio/video output.

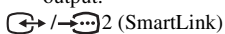

21-pin scart connector (CENELEC standard) including audio/video input, RGB input, selectable audio/video output, and SmartLink interface.

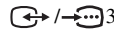

21-pin scart connector (CENELEC standard) including audio/video input, RGB input, and audio/video output which currently appears on the screen.



Supported formats: 1080i, 720p, 576p, 576i, 480p, 480i

Y: 1 Vp-p, 75 ohms, 0.3V negative sync

P<sub>B</sub>/C<sub>B</sub>: 0.7 Vp-p, 75 ohms

P<sub>R</sub>/C<sub>R</sub>: 0.7 Vp-p, 75 ohms



Audio input (phono jacks)

500 mVrms

Impedance: 47 kilo ohms

HDMI IN 5, 6

Video: 1080p, 1080i, 720p, 576p, 576i, 480p, 480i

Audio: Two channel linear PCM

32, 44.1 and 48 kHz, 16, 20 and 24 bits, or

analogue audio input (phono jacks)

(HDMI IN 6)



Supported formats: 1080i, 720p, 576p, 576i, 480p, 480i

Y: 1 Vp-p, 75 ohms, 0.3V negative sync

P<sub>B</sub>/C<sub>B</sub>: 0.7 Vp-p, 75 ohms

P<sub>R</sub>/C<sub>R</sub>: 0.7 Vp-p, 75 ohms

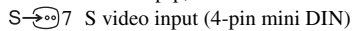

S video input (4-pin mini DIN)



Video input (phono jack)



Audio input (phono jacks)



OPTICAL OUT (OPTICAL OUT jack)



Audio output (Left/Right) (phono jacks)



PC Input (15 Dsub) (see page 44)

G: 0.7 Vp-p, 75 ohms, non Sync on Green

B: 0.7 Vp-p, 75 ohms, non Sync on Green

R: 0.7 Vp-p, 75 ohms, non Sync on Green

HD: 1-5 Vp-p

VD: 1-5 Vp-p

PC audio input (minijack)



Headphones jack



CAM (Conditional Access Module) slot

## Sound Output

11 W + 11 W

## Supplied Accessories

Refer to “1: Checking the accessories” on page 4.

## Optional Accessories

- Wall-Mount Bracket SU-WL51
- TV stand SU-FL61
- Colour Variation Unit CRU-46X1

Design and specifications are subject to change without notice.

## PC Input Signal Reference Chart

Signals	Horizontal (Pixel)	Vertical (Line)	Horizontal frequency (kHz)	Vertical frequency (Hz)	Standard
VGA	<b>640</b>	<b>480</b>	<b>31.5</b>	<b>60</b>	<b>VGA</b>
	640	480	37.5	75	VESA
	720	400	31.5	70	VGA-T
SVGA	<b>800</b>	<b>600</b>	<b>37.9</b>	<b>60</b>	<b>VESA Guidelines</b>
	800	600	46.9	75	VESA
XGA	<b>1024</b>	<b>768</b>	<b>48.4</b>	<b>60</b>	<b>VESA Guidelines</b>
	1024	768	56.5	70	VESA
	1024	768	60	75	VESA
WXGA	<b>1280</b>	<b>768</b>	<b>47.4</b>	<b>60</b>	<b>VESA</b>
	<b>1280</b>	<b>768</b>	<b>47.8</b>	<b>60</b>	<b>VESA</b>
	<b>1360</b>	<b>768</b>	<b>47.7</b>	<b>60</b>	<b>VESA</b>

- This TV's PC input does not support Sync on Green or Composite Sync.
- This TV's PC input does not support interlaced signals.
- For the best picture quality, it is recommended to use the signals (boldfaced) in the above chart with a 60 Hz vertical frequency from a personal computer. In plug and play, signals with a 60 Hz vertical frequency will be selected automatically.

# Troubleshooting

Check whether the  (standby) indicator is flashing in red.

## When it is flashing



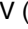

The self-diagnosis function is activated.

- 1 Count how many  (standby) indicator flashes between each two second break.  
For example, the indicator flashes three times, then there is a two second break, followed by another three flashes, etc.
- 2 Press  on the TV (right side) to switch it off, disconnect the mains lead, and inform your dealer or Sony service centre of how the indicator flashes (number of flashes).

## When it is not flashing

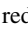
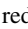
- 1 Check the items in the tables below.
- 2 If the problem still persists, have your TV serviced by qualified service personnel.

## Picture

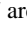
Problem	Cause/Remedy
No picture (screen is dark) and no sound	<ul style="list-style-type: none"> <li>• Check the aerial connection.</li> <li>• Connect the TV to the mains, and press  on the TV (right side).</li> <li>• If the  (standby) indicator lights up in red, press TV .</li> </ul>
No picture or no menu information from equipment connected to the scart connector	<ul style="list-style-type: none"> <li>• Check that the optional equipment is on and press / repeatedly until the correct input symbol is displayed on the screen.</li> <li>• Check the connection between the optional equipment and the TV.</li> </ul>
Double images or ghosting	<ul style="list-style-type: none"> <li>• Check aerial/cable connections.</li> <li>• Check the aerial location and direction.</li> </ul>
Only snow and noise appear on the screen	<ul style="list-style-type: none"> <li>• Check if the aerial is broken or bent.</li> <li>• Check if the aerial has reached the end of its serviceable life (three to five years in normal use, one to two years at the seaside).</li> </ul>
Distorted picture (dotted lines or stripes)	<ul style="list-style-type: none"> <li>• Keep the TV away from electrical noise sources such as cars, motorcycles, hair-dryers or optical equipment.</li> <li>• When installing optional equipment, leave some space between the optional equipment and the TV.</li> <li>• Make sure that the aerial is connected using the supplied coaxial cable.</li> <li>• Keep the aerial cable away from other connecting cables.</li> </ul>
Picture noise when viewing a TV channel	<ul style="list-style-type: none"> <li>• Select “Manual Programme Preset” in the “Analogue Set-up” menu and adjust “AFT” (Automatic Fine Tuning) to obtain better picture reception (page 33).</li> </ul>
Some tiny black points and/or bright points appear on the screen	<ul style="list-style-type: none"> <li>• The picture of a display unit is composed of pixels. Tiny black points and/or bright points (pixels) on the screen do not indicate a malfunction.</li> </ul>
No colour on programmes	<ul style="list-style-type: none"> <li>• Select “Reset” in the “Picture” menu to return to the factory settings (page 23).</li> </ul>
No colour or irregular colour when viewing a signal from the Y, Pb/Cb, Pr/Cr sockets  4 or 7	<ul style="list-style-type: none"> <li>• Check the connection of the Y, Pb/Cb, Pr/Cr sockets 4 or 7.</li> <li>• Make sure that the Y, Pb/Cb, Pr/Cr sockets 4 or 7 are firmly seated in their respective sockets.</li> </ul>

*Continued*

## Sound

Problem	Cause/Remedy
No sound, but good picture	<ul style="list-style-type: none"><li>• Press <math>\triangle</math> +/- or <math>\text{M}</math> (Mute).</li><li>• Check that “Speaker” is set to “On” in the “Set-up” menu (page 30).</li></ul>
Noisy sound	<ul style="list-style-type: none"><li>• See “Picture noise” causes/remedies on page 45.</li></ul>

## Channels

Problem	Cause/Remedy
The desired channel cannot be selected	<ul style="list-style-type: none"><li>• Switch between digital and analogue mode and select the desired digital/analogue channel.</li></ul>
Some channels are blank	<ul style="list-style-type: none"><li>• Scrambled/Subscription only channel. Subscribe to the Pay Per View service.</li><li>• Channel is used only for data (no picture or sound).</li><li>• Contact the broadcaster for transmission details.</li></ul>
Digital channels are not displayed	<ul style="list-style-type: none"><li>• Contact a local installer to find out if digital transmissions are provided in your area.</li><li>• Upgrade to a higher gain aerial.</li></ul>

## General

Problem	Cause/Remedy
The TV turns off automatically (the TV enters standby mode)	<ul style="list-style-type: none"><li>• Check if the “Sleep Timer” is activated, or confirm the “Duration” setting of “On Timer” (page 29).</li><li>• If no signal is received and no operation is performed in the TV mode for 10 minutes, the TV automatically switches to standby mode.</li></ul>
The TV turns on automatically	<ul style="list-style-type: none"><li>• Check if the “On Timer” is activated (page 29).</li></ul>
Some input sources cannot be selected	<ul style="list-style-type: none"><li>• Select “AV Preset” in the “AV Set-up” menu and cancel “Skip” of the input source (page 31).</li></ul>
The remote does not function	<ul style="list-style-type: none"><li>• Check that the remote is set correctly for the equipment you are using.</li><li>• Check whether the equipment you want to use corresponds to the function button being pressed (page 13).</li><li>• If the remote does not operate the equipment even when the remote has been set correctly to the equipment, enter the necessary code as explained in “Programming the remote” (page 41).</li><li>• Replace the batteries.</li></ul>

# Index

## Numerics

- 1 Digit Direct 32
- 14:9 16
- 4:3 Default 27
- 4:3 16

## A

- Advanced Settings 25
- Aerial, connecting 5
- AFT 33
- All Reset 30
- Analogue Set-up menu 32
- Analogue Text 16
- Audio Filter 33
- Audio Language 35
- Audio Out 30
- Audio Type 35
- Auto Adjustment 38
- Auto Clock Set 17, 21
- Auto Format 27
- Auto Start-up 29
- Auto Tuning
  - analogue and digital channels 7
  - analogue channels only 32
  - digital channels only 36
- Auto Volume 26
- AV Preset 31
- AV Set-up menu 31
- AV2 Output 31
- AV7 Input 31

## B

- Backlight 23, 37
- Balance 26
- Bass 26
- Batteries, inserting into the remote 4
- BBE 26
- Black Corrector 25
- Brightness 23, 37

## C

- CA Module Set-up 36
- Category list 18
- Channels
  - auto-tuning 7
  - selecting 15
  - Skip 34
- Clear White 25
- Clock Set 29
- Colour 23
- Colour Matrix 31
- Colour System 31
- Colour Temperature 24, 37
- Confirm 34
- Connecting
  - an aerial/VCR 5
  - optional equipment 39

- Contrast Enhancer 25
- Contrast 23, 37
- Country 6

## D

- Digital Auto Tuning 36
- Digital Manual Tuning 36
- Digital Set-up 35
- Digital Set-up menu 35
- Digital Text 16
- Digital Tuning 36
- Display Area 27
- Display Mode 37
- DRC Mode 24
- DRC Palette 24
- Dual Sound 26

## E

- EPG (Digital Electronic Programme Guide) 18
- Equipment labels 31

## F

- Fastext 16
- Favourite list 20
- Film mode 30

## G

- Game Mode 31
- Gamma 25

## H

- Headphones
  - connecting 39
  - Speaker Link 30
  - Volume 30
- Horizontal Shift 27, 38
- Hue 23

## I

- Information 30
- Input signal index table 21
- Interactive service 15

## L

- Label 33
- Language 6, 30
- Light Sensor 30
- Live Colour 25
- Logo Illumination 30

## M

- Manual Programme Preset 33
- Manual timer REC 19
- MENU 22

## N

- Noise Reduction 24

## O

- On Timer 29

## P

- PAP 17
- Parental Lock 35
- PC Settings menu 37
- Phase 38
- Picture Freeze 16
- Picture menu 23
- Picture Mode 23
- Picture Off (⊗) indicator 14
- PIN Code 35
- Pitch 38
- Power (I) indicator 14
- Power (⏻) switch 14
- Power Management 38
- Power Saving 29
- Programme index table 15
- Programme Labels 32
- Programme List Edit 36
- Programme Sorting 32

## R

- Reminder 19
- Remote control
  - inserting batteries 4
  - overview 12
  - programming 41
  - sensor 14
- Reset
  - PC settings 38
  - picture 23, 37
  - sound 26

## S

- Screen Format 27, 38
- Screen menu 27
- Screen mode 16
- Set-up menu 29
- Sharpness 24
- Skip 31, 34
- Sleep Timer 29
- Smart 16
- Sound menu 26
- Sound Mode 26, 37
- Speaker 30
- Specifications 43
- Standby (⏻) indicator 14
- Subtitle Language 35
- Subtitle Setting 35
- Surround 26

## **T**

Target Inputs

    picture 23

    screen 27

    sound 26

Technical Set-up 36

Timer (⌚) indicator 14

Timer list 19

Timer REC 18

Timer Settings 29

Tools 17, 21

Treble 26

## **V**

VCR

    connecting 5

    recording 18

Vertical Shift 28, 38

Vertical Size 28

Volume Offset 26

## **W**

Wide 16

## **Z**

Zoom 16











## KDL-46X2000

<http://www.sony.net/>



Printed on 100% recycled paper using  
VOC (Volatile Organic Compound)-  
free vegetable oil based ink.



2678257120

2-678-257-12(3)