

Radio Cassette-Corder

Operating Instructions
Mode d'emploi

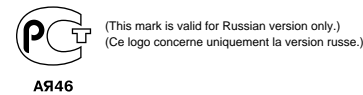

WM-GX670

WALKMAN WALKMAN is a registered trademark of Sony Corporation. WALKMAN est une marque déposée de Sony Corporation.
Sony Corporation © 1999 Printed in Malaysia

Sony online http://www.world.sony.com/

WARNING

To prevent fire or shock hazard, do not expose the unit to rain or moisture.

AVERTISSEMENT

Afin d'éviter tout risque d'incendie ou d'électrocution, ne pas exposer l'appareil à la pluie ou à l'humidité.

A pleine puissance, l'écoute prolongée du baladeur peut endommager l'oreille de l'utilisateur.

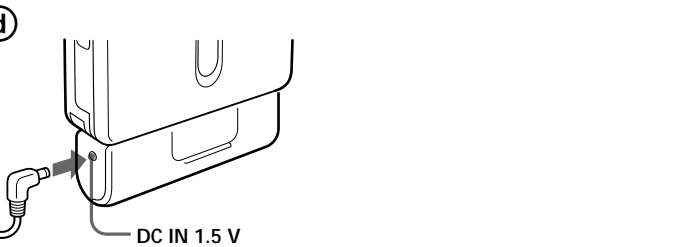
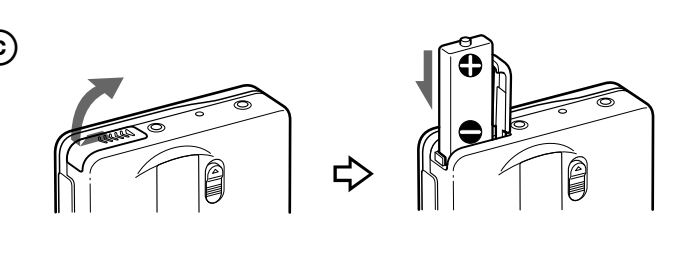
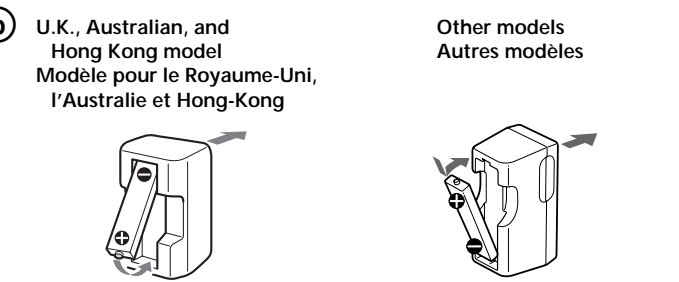
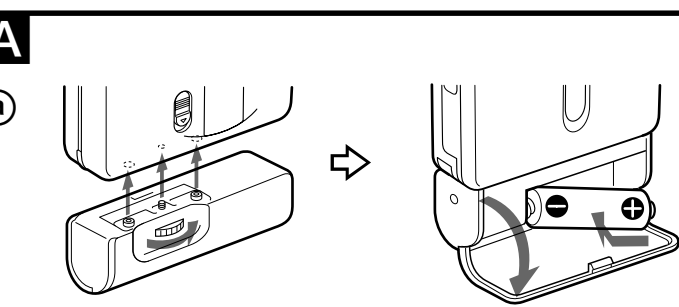

B

U.S.A. model
Modèles pour les Etats-Unis

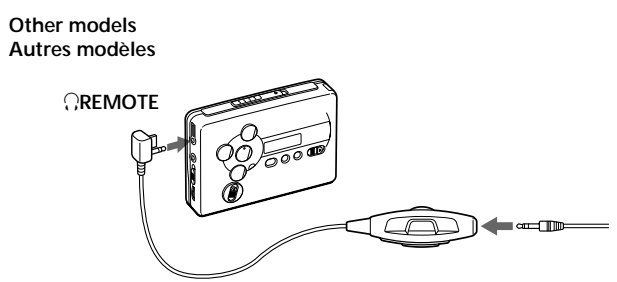
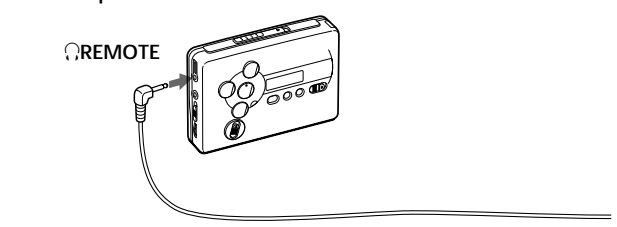

C

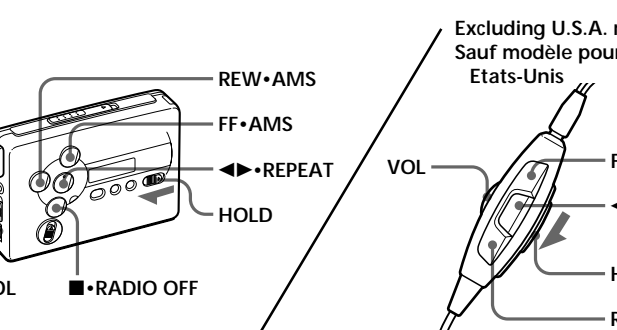
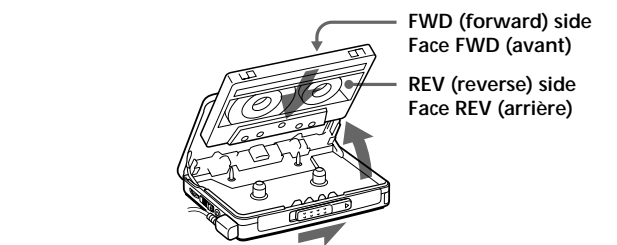

D

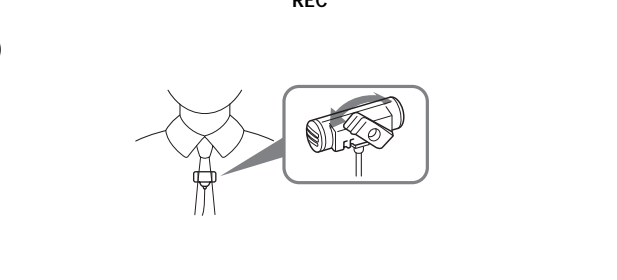
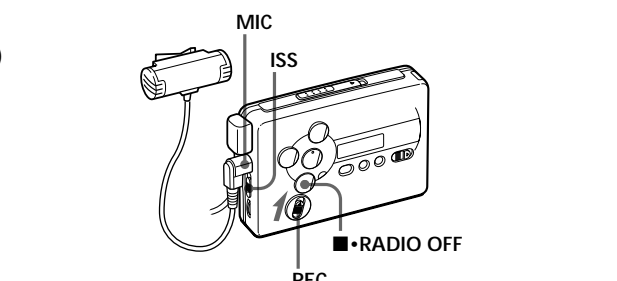

C

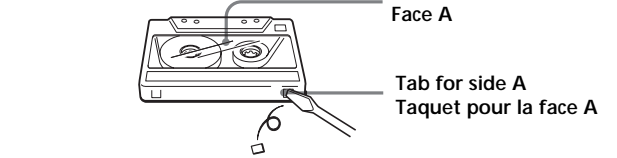

English

Getting Started

Choosing a Power Source

Dry Battery (see Fig. A-①) Attach the supplied battery case, and then insert one R6 (size AA) battery with correct polarity.

Note

- For maximum performance we recommend that you use a Sony alkaline battery.

Rechargeable Battery (see Fig. A-②)

- Insert the supplied rechargeable battery (NC-6WM) into the charger with correct polarity.

- Plug in the charger to the house current (mains), U.K., Australian, and Hong Kong model: Full charging takes about 3.5 hours. U.S.A., Canadian, European Continent, and Arabian model: Full charging takes about 2.5 hours. Korean model: The full charging time depends on the voltage of your mains. 110 V: 10 hours 220 V: 2.5 hours

Other models: The full charging time depends on the voltage of your mains. 120 V: 10 hours 220-240 V: 2.5 hours If the plug does not fit to your mains, attach the supplied AC plug adaptor (Excluding Chinese model).

3 Insert the fully charged battery into the rechargeable battery compartment (see Fig. A-③). You can charge the battery about 300 times.

When to replace/charge the battery

Replace or charge the battery when "□" flashes in the display. The battery remainder mark has 3 steps to show the remaining battery power.

| Display | Condition |
|---------|--|
| | There is enough battery power. |
| | The battery power is decreasing. |
| | The battery is exhausted. Replace it with a new battery. |

Notes

- When you insert a charged battery, the battery remainder mark will show "□" even if it is not fully charged.
- The battery remainder mark may temporarily show a lower level during fast forwarding or rewinding or use in extremely low temperatures.

Battery life (Approx. hours) (EIAJ*)

| Model | Approx. hours |
|------------------------|---------------|
| Sony alkaline LR6 (SG) | 31.5 |
| Tape playback | 31.5 |
| Radio reception | 32 |
| MIC recording | 10 |
| Radio recording | 6.5 |

| Model | Approx. hours |
|-------------------------------|---------------|
| Rechargeable battery (NC-6WM) | 8.5 |
| Tape playback | 8.5 |
| Radio reception | 10 |
| MIC recording | 4 |
| Radio recording | 3 |

| Model | Approx. hours |
|--|---------------|
| Sony alkaline LR6 (SG) and Rechargeable NC-6WM | 40 |
| Tape playback | 40 |
| Radio reception | 42 |
| MIC recording | 13 |
| Radio recording | 9 |

* Measured value by the standard of EIAJ (Electronic Industries Association of Japan). (Using a Sony HF series cassette tape)

Note

- The battery life may shorten depending on the operation of the unit.

House Current (see Fig. A-④)

Remove the rechargeable battery if inserted. Do not use any other AC power adaptor. Specifications for AC-E15HG vary for each area. Check your local voltage and the polarity of the plug before purchasing.



Connecting the Headphones/Earphones (see Fig. B)

- Connect the stereo mini plug firmly to the remote control (excluding U.S.A. model).
- Connect the headphones/earphones to REMOTE.
- Wear the "L" marked side to the left ear and the "R" marked side to the right ear. If the earphones do not fit to your ears or the sound is unbalanced, adjust the earphones to fit to your ears firmly.

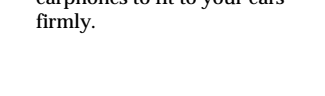
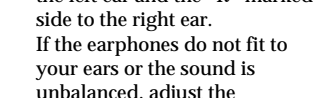
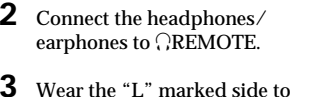

Operating the Walkman

Playing a Tape (see Fig. C)

- Open the cassette holder and insert a cassette.

- Make sure the HOLD function is turned off. If it is on, slide the HOLD switch to turn it off.

- Press ◀▶•REPEAT on the main unit, or if using the remote control (excluding U.S.A. model), press ◀▶ (play)•■ (stop). Adjust the volume with VOL.

When adjusting the volume on the main unit (excluding U.S.A. model) Set the VOL control on the remote control at maximum.

When adjusting the volume on the remote control (excluding U.S.A. model) Set the VOL control on the main unit to around 6.

Note on the cassette holder

When opening the cassette holder on the main unit, make sure the tape is stopped, then slide the OPEN switch. If the cassette holder is opened when the tape is running, the tape may loosen and be damaged.

Operation on the main unit

| To | Press |
|---------------------|---------------------------|
| Play the other side | ◀▶•REPEAT during playback |
| Stop playback | ■ (stop)•RADIO OFF |
| Fast forward | FF•AMS during stop |
| Rewind | REW•AMS during stop |

Operation on the remote control (excluding U.S.A. model)

| To | Press |
|---------------------|--|
| Play the other side | ◀▶•■ for 2 seconds or more during playback |
| Stop playback | ◀▶•■ once during playback |
| Fast forward* | FF during stop |
| Rewind* | REW during stop |

* If ◀▶•■ on the remote control is pressed during fast forward or rewind, the Walkman switches to playback.

To cancel the A-B Repeat playback

Press ◀▶•REPEAT on the main unit. On the remote control, press ◀▶•■ (excluding U.S.A. model).

Other tape operations

On the remote control, press FF or REW (excluding U.S.A. model).

Play the next track/succeeding 9 tracks from the beginning (AMS*)

Play the current track/previous 8 tracks from the beginning (AMS*)

Play the other side from the beginning (Skip Reverse function)

Play the same side from the beginning (Rewind Auto Play function)

* Automatic Music Sensor

Note on AMS
• The AMS function detects a blank of 4 seconds or longer between the tracks. If there is noise between the tracks, AMS may not recognize the blank and may not operate. Likewise, if there is a low-level segment within a track, AMS may recognize it as a blank space.

A-B Repeat
A-B Repeat plays back repeatedly any portion of the tape you specified. Specify by tagging the beginning (point A) and the end (point B) of the portion during playback.

On the main unit
1 Press ◀▶•REPEAT for 2 seconds or more during playback to tag point A. "A" will flash in the display of the main unit.
2 Press ◀▶•REPEAT again to tag point B. "A-B" will flash and the tape will be rewound to point A. Then "REP" appears in the display and the specified portion is played repeatedly.

On the remote control (excluding U.S.A. model)
1 Press ◀▶•■ twice quickly during playback to tag point A. "A" will flash in the display of the afficheur.
2 Press ◀▶•■ once more to tag point B. "A-B" will flash and the tape will be rewound to point A. Then the specified portion is played repeatedly.

To cancel the A-B Repeat playback
Press ◀▶•REPEAT on the main unit. On the remote control, press ◀▶•■ (excluding U.S.A. model).

Notes

- You cannot specify a repeat portion to include both sides of the tape.
- You cannot specify a repeat portion of shorter than 2 seconds.
- After repeated operation, the actual portion that is played back may shift off somewhat from the exact portion specified with the tags due to tape slack.
- A-B Repeat will repeat 50 times before returning to normal playback if not canceled manually.
- Do not use the A-B Repeat function with tapes longer than 90 minutes. If you do, the tape may be damaged.

Recording (see Fig. D-①)

You can record radio programs from the built-in radio, or record with the supplied microphone. In either case, use a new or fully charged battery.

Note

- If the record-protect tab is broken, you cannot record on that side.

- Insert a normal (TYPE I) tape. To record on both sides Insert the cassette with the side to be first recorded on as the FWD (forward) side*.
 - Make sure that "FWD" is displayed. If not, press and hold ■•RADIO OFF until "REV" changes to "FWD".

To record on one side only Insert the cassette with the side to be recorded on as the REV (reverse) side**.

- Make sure that "REV" is displayed. If not, press and hold ■•RADIO OFF until "FWD" changes to "REV".

Note
• When the cassette holder is opened, the direction of the tape will be automatically set to "FWD".

To prevent a tape from being accidentally recorded over (see Fig. D-②)
Break off the tabs from side A and/or B. To reuse the tape for recording, cover the tab hole with adhesive tape.

Remplacement/Recharge de la pile rechargeable
Remplacez ou chargez la pile lorsque "□" clignote dans l'afficheur. L'état de charge de la pile est indiqué par 3 niveaux dans l'indicateur de charge.

| Affichage | Etat |
|-----------|---|
| | La capacité de la pile est suffisante. |
| | La charge de la pile diminue. |
| | La pile est vide. Remplacez-la par une neuve. |

Remarques
• Lorsque vous insérez une pile rechargée, l'indicateur de pile peut montrer une pile pleine "□" bien que la pile ne soit pas complètement rechargée.

To stop recording
Press ■•RADIO OFF (Excluding U.S.A. model) on the remote control, press ◀▶•■ to stop recording).

To reduce noise while recording AM programs
Set the ISS (Interference Suppress Switch) to the position that reduces noise the most.

To monitor the recording sound
You can monitor the recording sound through headphones/earphones. Adjust monitoring level using VOL.

Notes on recording
• The recording level is fixed.
• Sound emphasis (RV, MB, or GRV), AVLS and Dolby B NR settings do not affect recording.
• Actual recording will start about 2 seconds after you slide REC. Slide REC about 2 seconds before the moment you want to start recording, or you will miss the beginning of your recording.
• When recording on both sides, recording will not be made for about 10 seconds while the tape is switching sides.
• Do not use a CrO₂ (TYPE II) or metal (TYPE IV) tape. If you do, the sound may be distorted when you play back the tape, or the previous recording may not be erased completely.
• Do not connect or disconnect the headphones/earphones to/from REMOTE while recording from the radio. The recording condition may change abruptly, or noise may be recorded.
• To avoid noise interference, do not place it near a lamp cord or a fluorescent lamp when recording with the microphone.
• If a howling effect occurs, turn down the volume.
• All other operation cannot be made while recording. For other operation, stop recording first.

To stop recording
Press ■•RADIO OFF (Excluding U.S.A. model) on the remote control, press ◀▶•■ to stop recording).

Français

Préparatifs

Sélection de la source d'alimentation

Pile sèche (voir Fig. A-①)

Fixez l'étui de pile fourni et insérez une pile R6 (taille AA) en tenant compte de la polarité.

Remarque
• Il est conseillé d'utiliser une pile alcaline Sony pour une performance optimale.

Pile rechargeable (voir Fig. A-②)

1 Insérez la pile rechargeable fournie (NC-6WM) dans le chargeur en tenant compte de la polarité.

2 Branchez le chargeur sur une prise murale (secteur).
Modèle pour le Royaume-Uni, l'Australie et Hong-Kong: Une recharge complète prend 3,5 heures environ.
Modèle pour les Etats-Unis, l'Europe et l'Arabie: Une recharge complète prend environ 2,5 heures.
Modèle pour la Corée: Le temps d'une recharge complète dépend de la tension secteur. 110 V : 10 heures 220 V : 2,5 heures
Autres modèles: Le temps d'une recharge complète dépend de la tension secteur. 120 V : 10 heures 220-240 V : 2,5 heures
Si la fiche ne rentre pas dans votre prise, fixez l'adaptateur de fiche secteur (sauf modèle pour la Chine).

3 Insérez la pile complètement rechargée dans son logement (voir Fig. A-③).

Remarque
• L'autonomie de la pile peut être inférieure selon les conditions d'utilisation de l'appareil.

Courant secteur (voir Fig. A-④)

Retirez la pile rechargeable si elle est en place. Rattachez l'étui de pile et raccordez l'adaptateur secteur AC-E15HG (non fourni) à la prise DC IN 1,5 V de l'étui de pile et à une prise murale. N'utilisez pas d'autres adaptateurs secteur. Les spécifications de l'AC-E15HG varie pour chaque zone de commercialisation. Vérifiez votre tension secteur locale et la polarité de la fiche avant d'acheter l'adaptateur secteur.

Remplacement/Recharge de la pile rechargeable
Remplacez ou chargez la pile lorsque "□" clignote dans l'afficheur. L'état de charge de la pile est indiqué par 3 niveaux dans l'indicateur de charge.

| Affichage | Etat |
|-----------|---|
| | La capacité de la pile est suffisante. |
| | La charge de la pile diminue. |
| | La pile est vide. Remplacez-la par une neuve. |

Remarques
• Lorsque vous insérez une pile rechargée, l'indicateur de pile peut montrer une pile pleine "□" bien que la pile ne soit pas complètement rechargée.

To stop recording
Press ■•RADIO OFF (Excluding U.S.A. model) on the remote control, press ◀▶•■ to stop recording).

To reduce noise while recording AM programs
Set the ISS (Interference Suppress Switch) to the position that reduces noise the most.

To monitor the recording sound
You can monitor the recording sound through headphones/earphones. Adjust monitoring level using VOL.

Notes on recording
• The recording level is fixed.
• Sound emphasis (RV, MB, or GRV), AVLS and Dolby B NR settings do not affect recording.
• Actual recording will start about 2 seconds after you slide REC. Slide REC about 2 seconds before the moment you want to start recording, or you will miss the beginning of your recording.
• When recording on both sides, recording will not be made for about 10 seconds while the tape is switching sides.
• Do not use a CrO₂ (TYPE II) or metal (TYPE IV) tape. If you do, the sound may be distorted when you play back the tape, or the previous recording may not be erased completely.
• Do not connect or disconnect the headphones/earphones to/from REMOTE while recording from the radio. The recording condition may change abruptly, or noise may be recorded.
• To avoid noise interference, do not place it near a lamp cord or a fluorescent lamp when recording with the microphone.
• If a howling effect occurs, turn down the volume.
• All other operation cannot be made while recording. For other operation, stop recording first.

To stop recording
Press ■•RADIO OFF (Excluding U.S.A. model) on the remote control, press ◀▶•■ to stop recording).

Exploitation de la Walkman

Lecture d'une cassette (voir Fig. C)

- Ouvrez le logement de la cassette et insérez une cassette.

- Assurez-vous que la fonction HOLD est désactivée et, si ce n'est pas le cas, faites glisser le commutateur HOLD pour désactiver la fonction.

- Appuyez sur ◀▶•REPEAT de l'appareil, ou si vous utilisez la télécommande (sauf modèle pour les Etats-Unis), appuyez sur ◀▶ (lecture)•■ (arrêt). Ajustez le volume avec VOL.

When adjusting the volume on the main unit (excluding U.S.A. model) Set the VOL control on the remote control at maximum.

When adjusting the volume on the remote control (excluding U.S.A. model) Set the VOL control on the main unit to around 6.

Note on the cassette holder
When opening the cassette holder on the main unit, make sure the tape is stopped, then slide the OPEN switch. If the cassette holder is opened when the tape is running, the tape may loosen and be damaged.

A-B Repeat
A-B Repeat plays back repeatedly any portion of the tape you specified. Specify by tagging the beginning (point A) and the end (point B) of the portion during playback.

On the main unit
1 Press ◀▶•REPEAT for 2 seconds or more during playback to tag point A. "A" will flash in the display of the main unit.
2 Press ◀▶•REPEAT again to tag point B. "A-B" will flash and the tape will be rewound to point A. Then "REP" appears in the display and the specified portion is played repeatedly.

On the remote control (excluding U.S.A. model)
1 Press ◀▶•REPEAT for 2 seconds or more during playback to tag point A. "A" will flash in the display of the afficheur.
2 Press ◀▶•REPEAT once more to tag point B. "A-B" will flash and the tape will be rewound to point A. Then the specified portion is played repeatedly.

To cancel the A-B Repeat playback
Press ◀▶•REPEAT on the main unit. On the remote control, press ◀▶•■ (excluding U.S.A. model).

To reduce noise while recording AM programs
Set the ISS (Interference Suppress Switch) to the position that reduces noise the most.

To monitor the recording sound
You can monitor the recording sound through headphones/earphones. Adjust monitoring level using VOL.

Notes on recording
• The recording level is fixed.
• Sound emphasis (RV, MB, or GRV), AVLS and Dolby B NR settings do not affect recording.
• Actual recording will start about 2 seconds after you slide REC. Slide REC about 2 seconds before the moment you want to start recording, or you will miss the beginning of your recording.
• When recording on both sides, recording will not be made for about 10 seconds while the tape is switching sides.
• Do not use a CrO₂ (TYPE II) or metal (TYPE IV) tape. If you do, the sound may be distorted when you play back the tape, or the previous recording may not be erased completely.
• Do not connect or disconnect the headphones/earphones to/from REMOTE while recording from the radio. The recording condition may change abruptly, or noise may be recorded.
• To avoid noise interference, do not place it near a lamp cord or a fluorescent lamp when recording with the microphone.
• If a howling effect occurs, turn down the volume.
• All other operation cannot be made while recording. For other operation, stop recording first.

To stop recording
Press ■•RADIO OFF (Excluding U.S.A. model) on the remote control, press ◀▶•■ to stop recording).

To reduce noise while recording AM programs
Set the ISS (Interference Suppress Switch) to the position that reduces noise the most.

To monitor the recording sound
You can monitor the recording sound through headphones/earphones. Adjust monitoring level using VOL.

Notes on recording
• The recording level is fixed.
• Sound emphasis (RV, MB, or GRV), AVLS and Dolby B NR settings do not affect recording.
• Actual recording will start about 2 seconds after you slide REC. Slide REC about 2 seconds before the moment you want to start recording, or you will miss the beginning of your recording.
• When recording on both sides, recording will not be made for about 10 seconds while the tape is switching sides.
• Do not use a CrO₂ (TYPE II) or metal (TYPE IV) tape. If you do, the sound may be distorted when you play back the tape, or the previous recording may not be erased completely.
• Do not connect or disconnect the headphones/earphones to/from REMOTE while recording from the radio. The recording condition may change abruptly, or noise may be recorded.
• To avoid noise interference, do not place it near a lamp cord or a fluorescent lamp when recording with the microphone.
• If a howling effect occurs, turn down the volume.
• All other operation cannot be made while recording. For other operation, stop recording first.

Exploitation de la Walkman

Lecture d'une cassette (voir Fig. C)

- Ouvrez le logement de la cassette et insérez une cassette.

- Assurez-vous que la fonction HOLD est désactivée et, si ce n'est pas le cas, faites glisser le commutateur HOLD pour désactiver la fonction.

- Appuyez sur ◀▶•REPEAT de l'appareil, ou si vous utilisez la télécommande (sauf modèle pour les Etats-Unis), appuyez sur ◀▶ (lecture)•■ (arrêt). Ajustez le volume avec VOL.

When adjusting the volume on the main unit (excluding U.S.A. model) Set the VOL control on the remote control at maximum.

When adjusting the volume on the remote control (excluding U.S.A. model) Set the VOL control on the main unit to around 6.

Note on the cassette holder
When opening the cassette holder on the main unit, make sure the tape is stopped, then slide the OPEN switch. If the cassette holder is opened when the tape is running, the tape may loosen and be damaged.

A-B Repeat
A-B Repeat plays back repeatedly any portion of the tape you specified. Specify by tagging the beginning (point A) and the end (point B) of the portion during playback.

E

English

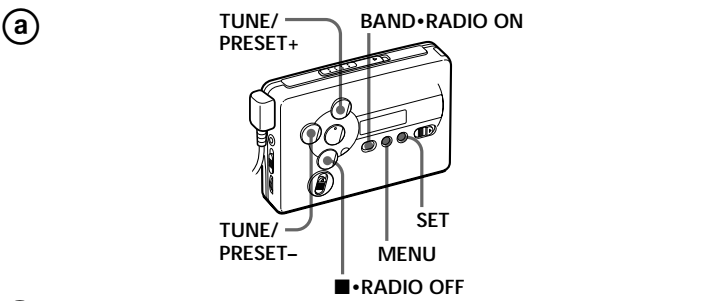

(a) U.S.A. model
Modèle pour les Etats-Unis

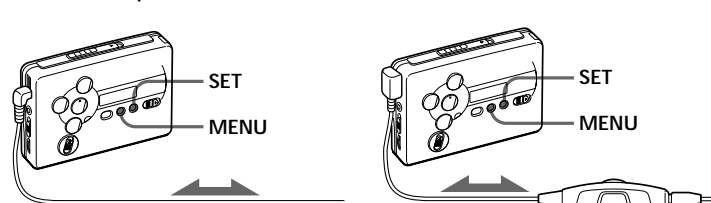

(b) Other models
Autres modèles



(c) Excluding U.S.A. model
Sauf modèle pour les Etats-Unis

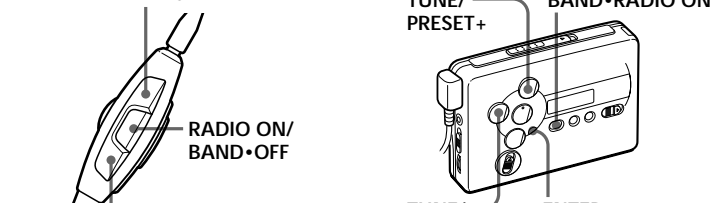

(d) Excluding U.S.A. model
Sauf modèle pour les Etats-Unis

F

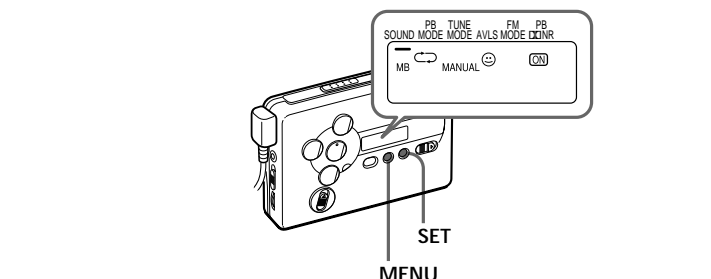

(f) Excluding U.S.A. model
Sauf modèle pour les Etats-Unis

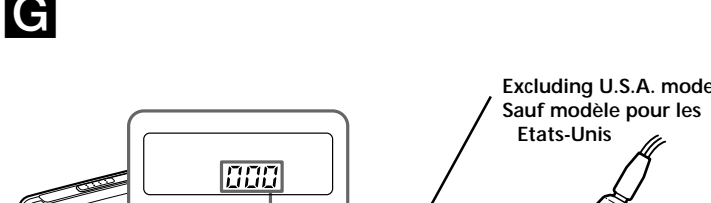

(g) Excluding U.S.A. model
Sauf modèle pour les Etats-Unis

Listening to the Radio (see Fig. E-①)

- 1 Press BAND • RADIO ON to turn on the radio.
- 2 Press BAND • RADIO ON repeatedly to select AM, FM1, or FM2.
- 3 Press MENU on the main unit repeatedly to set " " (the cursor) in the display to TUNE MODE.

- 4 For manual tuning
 - ① Press SET to choose MANUAL.
 - ② Press TUNE/PRESET + or - repeatedly to tune in to the desired station.

- Keep pressing TUNE/PRESET + or - to scan for stations.
- For preset tuning
- ① Press SET to choose PRESET.
 - ② Press TUNE/PRESET + or - repeatedly to recall the desired preset station.

To use preset tuning, preset stations first (see "Presetting Radio Stations").

To turn off the radio

Press ■•RADIO OFF.

To improve the broadcast reception

- For AM: The Walkman has a built-in antenna. Reorient the Walkman horizontally to obtain optimum AM reception.
- For FM (see Fig. E-②): Extend the headphones cord, the aerial (U.S.A. model only). Extend the cord of the remote control, the aerial (excluding U.S.A. model). If the reception is still not good, press MENU repeatedly to set the cursor in the display to FM MODE. Then press SET to choose from "MONO" (monaural), "LOCAL" or none (stereo) for best reception.

To operate from the remote control (excluding U.S.A. model) (see Fig. E-③)

To turn on the radio, press RADIO ON/BAND•OFF for more than one second (while the tape is in stop mode only).
To tune in or recall a preset station, press PRESET+ or -.
To turn off the radio, press RADIO ON/BAND•OFF.

Presetting Radio Stations (see Fig. E-④)

Once you store your favorite stations in memory, you can play them easily. You can preset up to 32 stations—12 each for FM1 and FM2 and 8 for AM (for the JpN area), up to 16 stations—8 each for FM and AM.

* See "Receiving Stations Outside Your Country" (Excluding European, Saudi Arabian, and Chinese model).

Tuning in to and Storing Radio Stations Automatically (Auto-Memory Scanning function)

- 1 Press BAND • RADIO ON to turn on the radio.
- 2 Press BAND • RADIO ON repeatedly to select AM, FM1, or FM2.
- 3 Press ENTER until "A" appears in the display. The Walkman starts searching and storing stations. Then the preset number appears.

Notes

- Do not remove the power sources until all the stations are stored.

Storing Radio Stations Manually (Manual-Memory function)

You can preset the stations in any order.

- 1 Press BAND • RADIO ON to turn on the radio.
- 2 Press BAND • RADIO ON repeatedly to select AM, FM1, or FM2.
- 3 Press ENTER. The frequency digits will flash in the display.
- 4 Press TUNE/PRESET + or - repeatedly to tune in to the desired station and press ENTER.

The preset number will flash in the display.

- 5 Press TUNE/PRESET + or - repeatedly to select the desired preset number and press ENTER. The station is preset to the number of your choice.

Notes

- If you cannot complete step 4 or 5 while the indications are flashing, repeat from step 3.
- If you preset a new station to the same preset number, the previously stored station will be erased.

To cancel the stored station

Follow the procedure above and in step 4, instead of tuning in to a station, press and hold TUNE/PRESET + or - until "----" is displayed. Press ENTER while "----" is flashing. The preset number will flash in the display. Press TUNE/PRESET + or - repeatedly to select the preset number you want to cancel and press ENTER.

- 4 Press BAND • RADIO ON repeatedly to select "Eur", "JpN", or "USA" and press ENTER.
- 5 Tune in to and store stations as necessary following the procedure of "Listening to the Radio" and "Presetting Radio Stations".

Area indication and frequency range

| Area* | Frequency range FM (MHz) | AM (kHz) |
|-------|--------------------------|-----------|
| Eur | 87.5-108 | 531-1.602 |
| JpN | 76-90 | 531-1.710 |
| USA | 87.5-108 | 530-1.710 |

*Eur : European and other countries
JpN : Japan
USA : USA, Canada, and Central and South America

Using the Menu (see Fig. E)

Adjusting playback modes

To select playback direction mode

Press MENU repeatedly to set " " (the cursor) in the display to PB MODE. Then press SET to select the desired mode.

| To play | Select |
|-----------------------|--------|
| both sides repeatedly | ↔ |
| both sides once | ↔ |

To play a tape recorded with Dolby® NR system

Press MENU repeatedly to set the cursor in the display to PB DI NR (Dolby noise reduction). Then press SET to show "NR".

* Dolby noise reduction manufactured under license from Dolby Laboratories Licensing Corporation. "DOLBY" and the double-D symbol are trademarks of Dolby Laboratories Licensing Corporation.

Emphasizing Sound

- 1 Press MENU repeatedly to move " " in the display to SOUND.
- 2 Press SET repeatedly to select the sound emphasis of your choice.

RV : Sound Revitalizer.
Emphasizes treble sound.
MB : Mega Bass.
Emphasizes bass sound (moderate effect).
GRV : Groove.
Emphasizes bass sound (strong effect).
no message : normal (no effect).

Note

- If the sound becomes distorted with the GRV effect, select the mode MB or no message.

Receiving Stations Outside Your Country (Excluding European, Saudi Arabian, and Chinese model) (see Fig. E-⑤)

- 1 Press BAND • RADIO ON to turn on the radio.
- 2 Press ENTER. The frequency digits will flash in the display.
- 3 Press and hold BAND • RADIO ON until "Eur", "JpN", or "USA" flashes.

Protecting Your Hearing (AVLS)

When you set the AVLS (Automatic Volume Limiter System) function to active, the maximum volume is kept down to protect your ears.

- 1 Press MENU repeatedly in the playback, stop or radio mode to set the cursor to AVLS in the display. Then press SET to show "AVLS".

To cancel the AVLS function

Press SET so that "AVLS" disappears.

Note

- If the sound is distorted when you listen to the bass-boosted sound with the AVLS function, turn down the volume.

Note on the menu mode

- The menu setting (except for AVLS) is stored even after the battery is replaced.

Using Other Functions (see Fig. E)

To lock the controls — Hold function

Slide HOLD switch on the main unit in the direction of the arrow to lock the controls of the main unit. To lock the controls on the remote control, slide the HOLD switch on the remote control in the direction of the arrow (excluding U.S.A. model).

To use the tape counter
The tape counter is displayed on the main unit during playback, recording, fast forward, rewind, and stop (except when the radio is turned on). The number will increase when playing back the FWD side, and decrease when playing back the REV side. To reset the counter to "000", press ENTER/COUNTER RESET.

Notes

- The tape counter may show some deviation.
- The tape counter will not be displayed when the cassette compartment is empty.

▶ Additional Information

Precautions

On rechargeable battery and charger
Remove the charger unit from the wall outlet as soon as possible after the rechargeable battery has been charged. Overcharging may damage the rechargeable battery.
The battery charger and the rechargeable battery may become warm during charging, but this is not a problem.
Do not tear off the film on the rechargeable battery.
Use only the supplied battery charger to charge the supplied rechargeable battery.

On headphones/earphones Road safety
Do not use headphones/earphones while driving, cycling, or operating any motorized vehicle. It may create a traffic hazard and is illegal in some areas. It can also be potentially dangerous to play your headphones/earphones at high volume while walking, especially at pedestrian crossings.
You should exercise extreme caution or discontinue use in potentially hazardous situations.
Preventing hearing damage
Do not use headphones/earphones at high volume. Hearing experts advise against continuous, loud and extended play. If you experience a ringing in your ears, reduce volume or discontinue use.

On the remote control (excluding U.S.A. model)
Use the supplied remote control only with this unit.

On headphones/earphones
Do not use headphones/earphones while driving, cycling, or operating any motorized vehicle. It may create a traffic hazard and is illegal in some areas. It can also be potentially dangerous to play your headphones/earphones at high volume while walking, especially at pedestrian crossings.
You should exercise extreme caution or discontinue use in potentially hazardous situations.
Preventing hearing damage
Do not use headphones/earphones at high volume. Hearing experts advise against continuous, loud and extended play. If you experience a ringing in your ears, reduce volume or discontinue use.

On the tape counter
The tape counter is displayed on the main unit during playback, recording, fast forward, rewind, and stop (except when the radio is turned on). The number will increase when playing back the FWD side, and decrease when playing back the REV side. To reset the counter to "000", press ENTER/COUNTER RESET.

Notes

- The tape counter may show some deviation.
- The tape counter will not be displayed when the cassette compartment is empty.

To use the tape counter
The tape counter is displayed on the main unit during playback, recording, fast forward, rewind, and stop (except when the radio is turned on). The number will increase when playing back the FWD side, and decrease when playing back the REV side. To reset the counter to "000", press ENTER/COUNTER RESET.

To lock the controls
Slide HOLD switch on the main unit in the direction of the arrow to lock the controls of the main unit. To lock the controls on the remote control, slide the HOLD switch on the remote control in the direction of the arrow (excluding U.S.A. model).

To use the tape counter
The tape counter is displayed on the main unit during playback, recording, fast forward, rewind, and stop (except when the radio is turned on). The number will increase when playing back the FWD side, and decrease when playing back the REV side. To reset the counter to "000", press ENTER/COUNTER RESET.

To lock the controls
Slide HOLD switch on the main unit in the direction of the arrow to lock the controls of the main unit. To lock the controls on the remote control, slide the HOLD switch on the remote control in the direction of the arrow (excluding U.S.A. model).

To use the tape counter
The tape counter is displayed on the main unit during playback, recording, fast forward, rewind, and stop (except when the radio is turned on). The number will increase when playing back the FWD side, and decrease when playing back the REV side. To reset the counter to "000", press ENTER/COUNTER RESET.

To lock the controls
Slide HOLD switch on the main unit in the direction of the arrow to lock the controls of the main unit. To lock the controls on the remote control, slide the HOLD switch on the remote control in the direction of the arrow (excluding U.S.A. model).

To use the tape counter
The tape counter is displayed on the main unit during playback, recording, fast forward, rewind, and stop (except when the radio is turned on). The number will increase when playing back the FWD side, and decrease when playing back the REV side. To reset the counter to "000", press ENTER/COUNTER RESET.

To lock the controls
Slide HOLD switch on the main unit in the direction of the arrow to lock the controls of the main unit. To lock the controls on the remote control, slide the HOLD switch on the remote control in the direction of the arrow (excluding U.S.A. model).

To use the tape counter
The tape counter is displayed on the main unit during playback, recording, fast forward, rewind, and stop (except when the radio is turned on). The number will increase when playing back the FWD side, and decrease when playing back the REV side. To reset the counter to "000", press ENTER/COUNTER RESET.

To lock the controls
Slide HOLD switch on the main unit in the direction of the arrow to lock the controls of the main unit. To lock the controls on the remote control, slide the HOLD switch on the remote control in the direction of the arrow (excluding U.S.A. model).

To use the tape counter
The tape counter is displayed on the main unit during playback, recording, fast forward, rewind, and stop (except when the radio is turned on). The number will increase when playing back the FWD side, and decrease when playing back the REV side. To reset the counter to "000", press ENTER/COUNTER RESET.

To lock the controls
Slide HOLD switch on the main unit in the direction of the arrow to lock the controls of the main unit. To lock the controls on the remote control, slide the HOLD switch on the remote control in the direction of the arrow (excluding U.S.A. model).

To use the tape counter
The tape counter is displayed on the main unit during playback, recording, fast forward, rewind, and stop (except when the radio is turned on). The number will increase when playing back the FWD side, and decrease when playing back the REV side. To reset the counter to "000", press ENTER/COUNTER RESET.

To lock the controls
Slide HOLD switch on the main unit in the direction of the arrow to lock the controls of the main unit. To lock the controls on the remote control, slide the HOLD switch on the remote control in the direction of the arrow (excluding U.S.A. model).

To use the tape counter
The tape counter is displayed on the main unit during playback, recording, fast forward, rewind, and stop (except when the radio is turned on). The number will increase when playing back the FWD side, and decrease when playing back the REV side. To reset the counter to "000", press ENTER/COUNTER RESET.

To lock the controls
Slide HOLD switch on the main unit in the direction of the arrow to lock the controls of the main unit. To lock the controls on the remote control, slide the HOLD switch on the remote control in the direction of the arrow (excluding U.S.A. model).

To use the tape counter
The tape counter is displayed on the main unit during playback, recording, fast forward, rewind, and stop (except when the radio is turned on). The number will increase when playing back the FWD side, and decrease when playing back the REV side. To reset the counter to "000", press ENTER/COUNTER RESET.

To lock the controls
Slide HOLD switch on the main unit in the direction of the arrow to lock the controls of the main unit. To lock the controls on the remote control, slide the HOLD switch on the remote control in the direction of the arrow (excluding U.S.A. model).

To use the tape counter
The tape counter is displayed on the main unit during playback, recording, fast forward, rewind, and stop (except when the radio is turned on). The number will increase when playing back the FWD side, and decrease when playing back the REV side. To reset the counter to "000", press ENTER/COUNTER RESET.

To lock the controls
Slide HOLD switch on the main unit in the direction of the arrow to lock the controls of the main unit. To lock the controls on the remote control, slide the HOLD switch on the remote control in the direction of the arrow (excluding U.S.A. model).

To use the tape counter
The tape counter is displayed on the main unit during playback, recording, fast forward, rewind, and stop (except when the radio is turned on). The number will increase when playing back the FWD side, and decrease when playing back the REV side. To reset the counter to "000", press ENTER/COUNTER RESET.

To lock the controls
Slide HOLD switch on the main unit in the direction of the arrow to lock the controls of the main unit. To lock the controls on the remote control, slide the HOLD switch on the remote control in the direction of the arrow (excluding U.S.A. model).

To use the tape counter
The tape counter is displayed on the main unit during playback, recording, fast forward, rewind, and stop (except when the radio is turned on). The number will increase when playing back the FWD side, and decrease when playing back the REV side. To reset the counter to "000", press ENTER/COUNTER RESET.

To lock the controls
Slide HOLD switch on the main unit in the direction of the arrow to lock the controls of the main unit. To lock the controls on the remote control, slide the HOLD switch on the remote control in the direction of the arrow (excluding U.S.A. model).

To use the tape counter
The tape counter is displayed on the main unit during playback, recording, fast forward, rewind, and stop (except when the radio is turned on). The number will increase when playing back the FWD side, and decrease when playing back the REV side. To reset the counter to "000", press ENTER/COUNTER RESET.

To lock the controls
Slide HOLD switch on the main unit in the direction of the arrow to lock the controls of the main unit. To lock the controls on the remote control, slide the HOLD switch on the remote control in the direction of the arrow (excluding U.S.A. model).

To use the tape counter
The tape counter is displayed on the main unit during playback, recording, fast forward, rewind, and stop (except when the radio is turned on). The number will increase when playing back the FWD side, and decrease when playing back the REV side. To reset the counter to "000", press ENTER/COUNTER RESET.

To lock the controls
Slide HOLD switch on the main unit in the direction of the arrow to lock the controls of the main unit. To lock the controls on the remote control, slide the HOLD switch on the remote control in the direction of the arrow (excluding U.S.A. model).

To use the tape counter
The tape counter is displayed on the main unit during playback, recording, fast forward, rewind, and stop (except when the radio is turned on). The number will increase when playing back the FWD side, and decrease when playing back the REV side. To reset the counter to "000", press ENTER/COUNTER RESET.

To lock the controls
Slide HOLD switch on the main unit in the direction of the arrow to lock the controls of the main unit. To lock the controls on the remote control, slide the HOLD switch on the remote control in the direction of the arrow (excluding U.S.A. model).

To use the tape counter
The tape counter is displayed on the main unit during playback, recording, fast forward, rewind, and stop (except when the radio is turned on). The number will increase when playing back the FWD side, and decrease when playing back the REV side. To reset the counter to "000", press ENTER/COUNTER RESET.

To lock the controls
Slide HOLD switch on the main unit in the direction of the arrow to lock the controls of the main unit. To lock the controls on the remote control, slide the HOLD switch on the remote control in the direction of the arrow (excluding U.S.A. model).

To use the tape counter
The tape counter is displayed on the main unit during playback, recording, fast forward, rewind, and stop (except when the radio is turned on). The number will increase when playing back the FWD side, and decrease when playing back the REV side. To reset the counter to "000", press ENTER/COUNTER RESET.

To lock the controls
Slide HOLD switch on the main unit in the direction of the arrow to lock the controls of the main unit. To lock the controls on the remote control, slide the HOLD switch on the remote control in the direction of the arrow (excluding U.S.A. model).

To use the tape counter
The tape counter is displayed on the main unit during playback, recording, fast forward, rewind, and stop (except when the radio is turned on). The number will increase when playing back the FWD side, and decrease when playing back the REV side. To reset the counter to "000", press ENTER/COUNTER RESET.

To lock the controls
Slide HOLD switch on the main unit in the direction of the arrow to lock the controls of the main unit. To lock the controls on the remote control, slide the HOLD switch on the remote control in the direction of the arrow (excluding U.S.A. model).

To use the tape counter
The tape counter is displayed on the main unit during playback, recording, fast forward, rewind, and stop (except when the radio is turned on). The number will increase when playing back the FWD side, and decrease when playing back the REV side. To reset the counter to "000", press ENTER/COUNTER RESET.

To lock the controls
Slide HOLD switch on the main unit in the direction of the arrow to lock the controls of the main unit. To lock the controls on the remote control, slide the HOLD switch on the remote control in the direction of the arrow (excluding U.S.A. model).

To use the tape counter
The tape counter is displayed on the main unit during playback, recording, fast forward, rewind, and stop (except when the radio is turned on). The number will increase when playing back the FWD side, and decrease when playing back the REV side. To reset the counter to "000", press ENTER/COUNTER RESET.

To lock the controls
Slide HOLD switch on the main unit in the direction of the arrow to lock the controls of the main unit. To lock the controls on the remote control, slide the HOLD switch on the remote control in the direction of the arrow (excluding U.S.A. model).

To use the tape counter
The tape counter is displayed on the main unit during playback, recording, fast forward, rewind, and stop (except when the radio is turned on). The number will increase when playing back the FWD side, and decrease when playing back the REV side. To reset the counter to "000", press ENTER/COUNTER RESET.

To lock the controls
Slide HOLD switch on the main unit in the direction of the arrow to lock the controls of the main unit. To lock the controls on the remote control, slide the HOLD switch on the remote control in the direction of the arrow (excluding U.S.A. model).

To use the tape counter
The tape counter is displayed on the main unit during playback, recording, fast forward, rewind, and stop (except when the radio is turned on). The number will increase when playing back the FWD side, and decrease when playing back the REV side. To reset the counter to "000", press ENTER/COUNTER RESET.

To lock the controls
Slide HOLD switch on the main unit in the direction of the arrow to lock the controls of the main unit. To lock the controls on the remote control, slide the HOLD switch on the remote control in the direction of the arrow (excluding U.S.A. model).

To use the tape counter
The tape counter is displayed on the main unit during playback, recording, fast forward, rewind, and stop (except when the radio is turned on). The number will increase when playing back the FWD side, and decrease when playing back the REV side. To reset the counter to "000", press ENTER/COUNTER RESET.

To lock the controls
Slide HOLD switch on the main unit in the direction of the arrow to lock the controls of the main unit. To lock the controls on the remote control, slide the HOLD switch on the remote control in the direction of the arrow (excluding U.S.A. model).

To use the tape counter
The tape counter is displayed on the main unit during playback, recording, fast forward, rewind, and stop (except when the radio is turned on). The number will increase when playing back the FWD side, and decrease when playing back the REV side. To reset the counter to "000", press ENTER/COUNTER RESET.

To lock the controls
Slide HOLD switch on the main unit in the direction of the arrow to lock the controls of the main unit. To lock the controls on the remote control, slide the HOLD switch on the remote control in the direction of the arrow (excluding U.S.A. model).

To use the tape counter
The tape counter is displayed on the main unit during playback, recording, fast forward, rewind, and stop (except when the radio is turned on). The number will increase when playing back the FWD side, and decrease when playing back the REV side. To reset the counter to "000", press ENTER/COUNTER RESET.

To lock the controls
Slide HOLD switch on the main unit in the direction of the arrow to lock the controls of the main unit. To lock the controls on the remote control, slide the HOLD switch on the remote control in the direction of the arrow (excluding U.S.A. model).

To use the tape counter
The tape counter is displayed on the main unit during playback, recording, fast forward, rewind, and stop (except when the radio is turned on). The number will increase when playing back the FWD side, and decrease when playing back the REV side. To reset the counter to "000", press ENTER/COUNTER RESET.

To lock the controls
Slide HOLD switch on the main unit in the direction of the arrow to lock the controls of the main unit. To lock the controls on the remote control, slide the HOLD switch on the remote control in the direction of the arrow (excluding U.S.A. model).

To use the tape counter
The tape counter is displayed on the main unit during playback, recording, fast forward, rewind, and stop (except when the radio is turned on). The number will increase when playing back the FWD side, and decrease when playing back the REV side. To reset the counter to "000", press ENTER/COUNTER RESET.

To lock the controls
Slide HOLD switch on the main unit in the direction of the arrow to lock the controls of the main unit. To lock the controls on the remote control, slide the HOLD switch on the remote control in the direction of the arrow (excluding U.S.A. model).

To use the tape counter
The tape counter is displayed on the main unit during playback, recording, fast forward, rewind, and stop (except when the radio is turned on). The number will increase when playing back the FWD side, and decrease when playing back the REV side. To reset the counter to "000", press ENTER/COUNTER RESET.

To lock the controls
Slide HOLD switch on the main unit in the direction of the arrow to lock the controls of the main unit. To lock the controls on the remote control, slide the HOLD switch on the remote control in the direction of the arrow (excluding U.S.A. model).

To use the tape counter
The tape counter is displayed on the main unit during playback, recording, fast forward, rewind, and stop (except when the radio is turned on). The number will increase when playing back the FWD side, and decrease when playing back the REV side. To reset the counter to "000", press ENTER/COUNTER RESET.

To lock the controls
Slide HOLD switch on the main unit in the direction of the arrow to lock the controls of the main unit. To lock the controls on the remote control, slide the HOLD switch on the remote control in the direction of the arrow (excluding U.S.A. model).

To use the tape counter
The tape counter is displayed on the main unit during playback, recording, fast forward, rewind, and stop (except when the radio is turned on). The number will increase when playing back the FWD side, and decrease when playing back the REV side. To reset the counter to "000", press ENTER/COUNTER RESET.

To lock the controls
Slide HOLD switch on the main unit in the direction of the arrow to lock the controls of the main unit. To lock the controls on the remote control, slide the HOLD switch on the remote control in the direction of the arrow (excluding U.S.A. model).

To use the tape counter
The tape counter is displayed on the main unit during playback, recording, fast forward, rewind, and stop (except when the radio is turned on). The number will increase when playing back the FWD side, and decrease when playing back the REV side. To reset the counter to "000", press ENTER/COUNTER RESET.

To lock the controls
Slide HOLD switch on the main unit in the direction of the arrow to lock the controls of the main unit. To lock the controls on the remote control, slide the