

Moulinex

mega 2kg

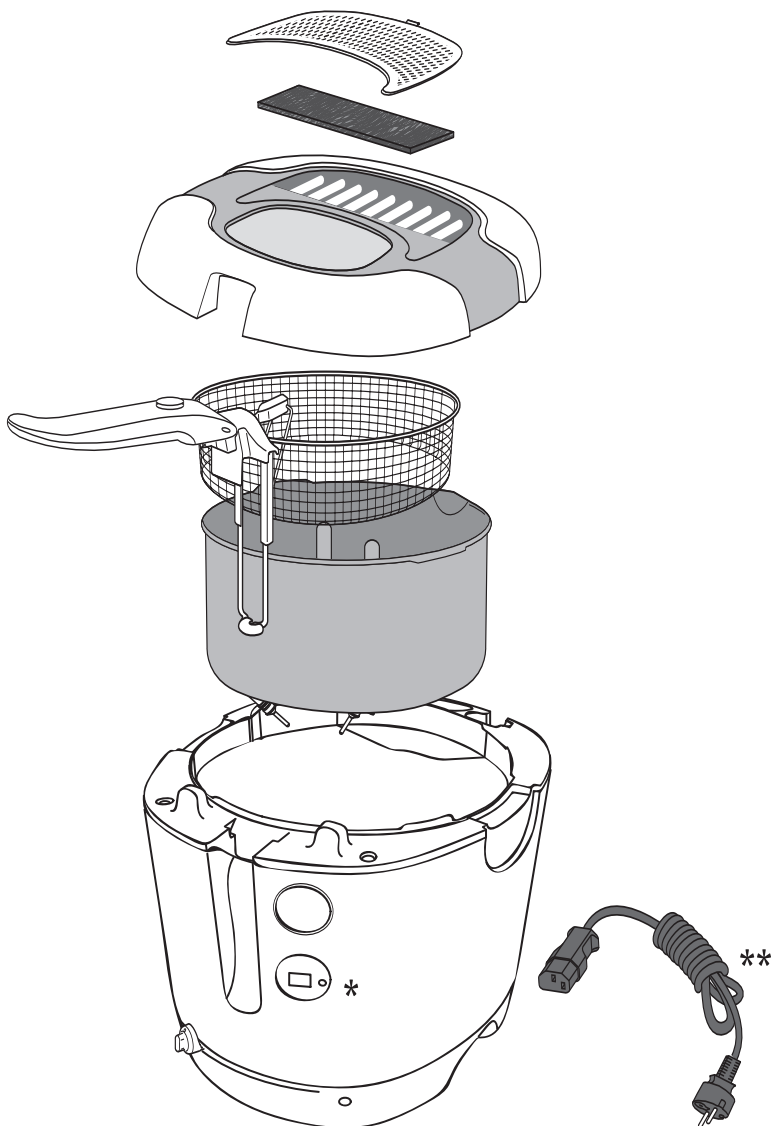



*selon modèle • depending on model • je nach Modell • a seconda del modello • según modelo • consoante os modelos • Ανάλογα με το μοντέλο • В зависимости от модели • Залежно від моделі • zależnie od modelu • az egyes modellek szerint • podle modelů • podľa modelov • В зависимости от модели • În funcție de model • modellere göre • Зависно од модела • zavisno od modela • Ólede na model • حسب الموديل • بر حسب مدل

** Cordon amovible • Removable cord • abnehmbare Zuleitung • Afneembaar snoer • Cavo amovível • Cordón amovible • Cabo de alimentação • Αποσπώμενο καλώδιο • Aftagelig ledning • Löstagbar sladd • Avtakbar ledning • Irrotettava johto • Съемный кабель питания • З'ємний шнур • Odłączany przewód • Odnímatelná přívodní šňůra • Hálózati csatlakozó kábel • Подвижен кабел • Odoberateľný prívodný kábel • Cablu de alimentare detașabil • Demontažni kabl za napajanje • Odvojivi kabl • Odvojivi priključni vod • Odstranljivi kabl • Çıkarılabilir güç kablosu • سیم برق مجزا - سلك كهربائي قابل للفك

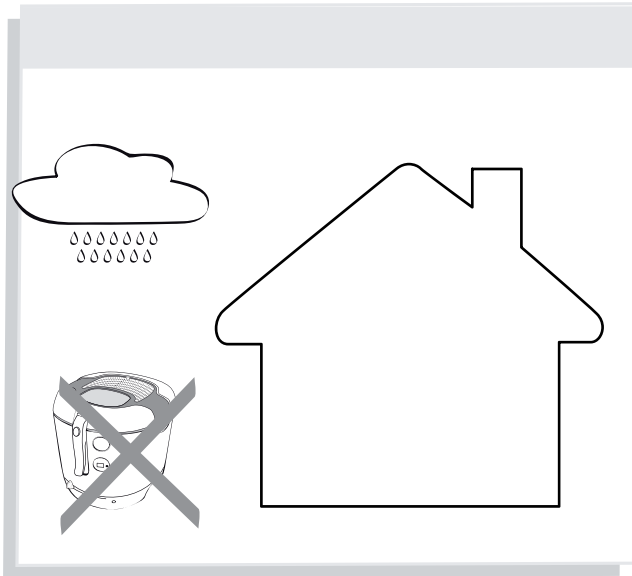
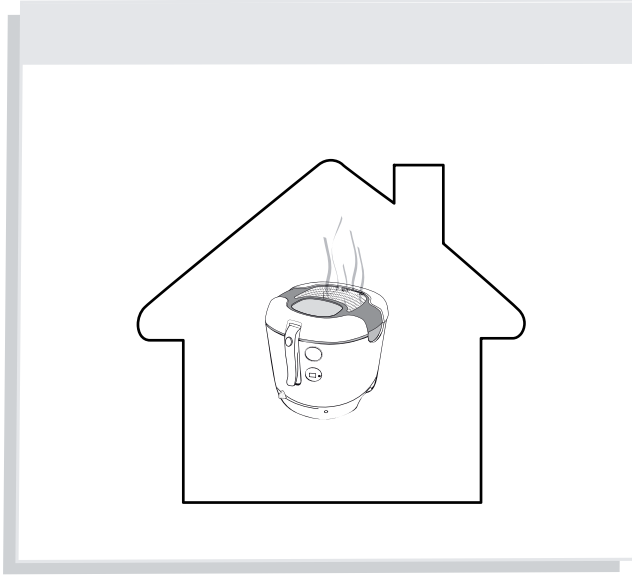

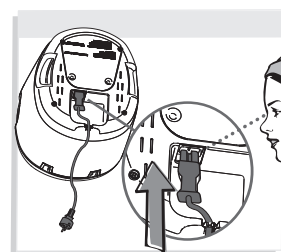
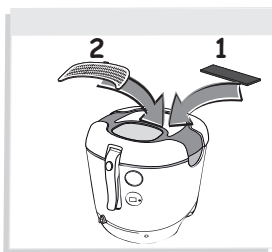
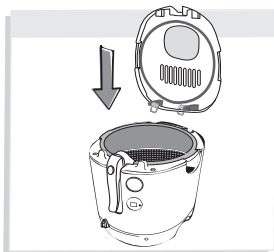
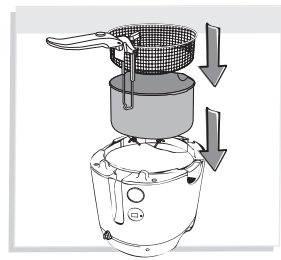
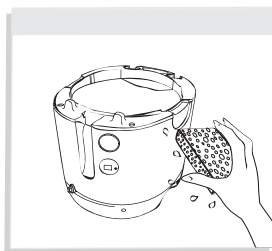
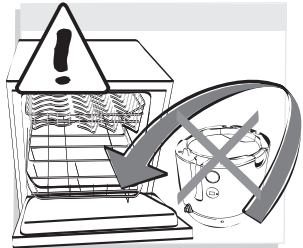
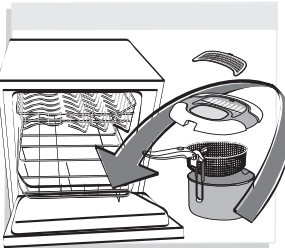
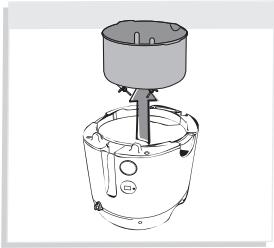
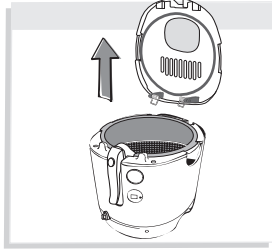
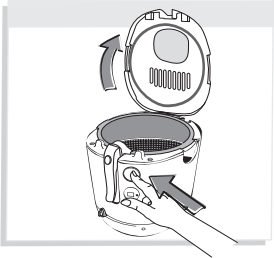
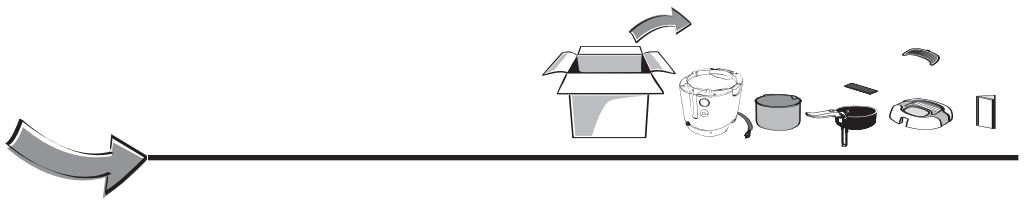



Min 3 L
↓
Max 3,3 L

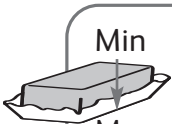
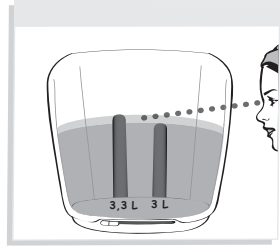

Min 2,6 Kg
↓
Max 2,8 Kg

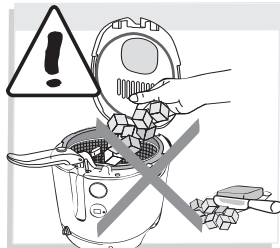
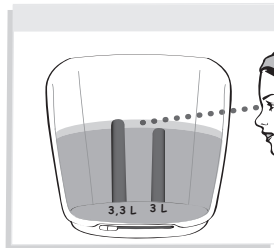



Max 2 Kg



1 Kg

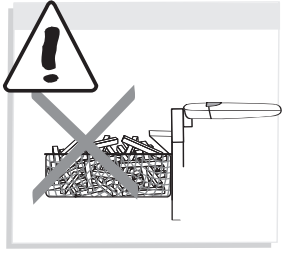
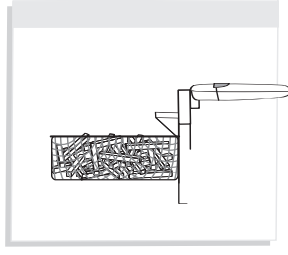
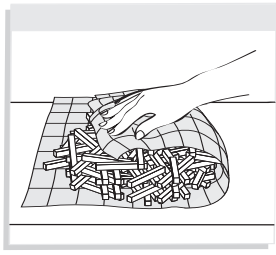

Max 1,5 Kg



750 g

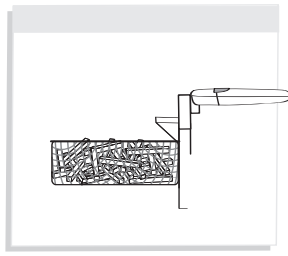
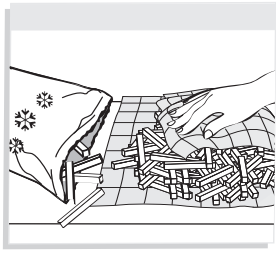
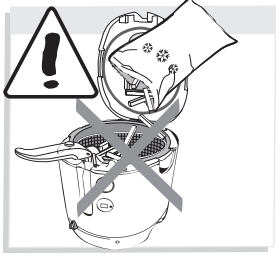

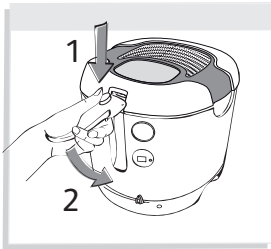
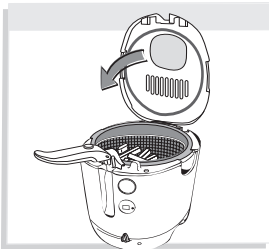
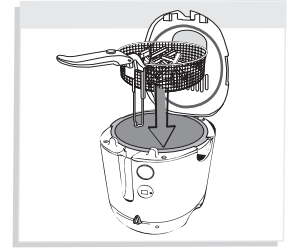
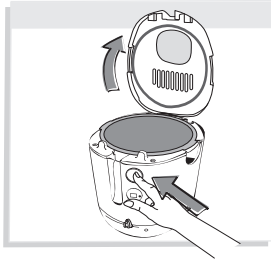
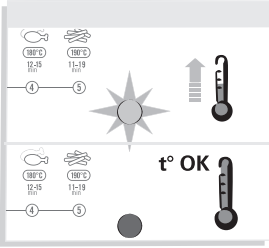
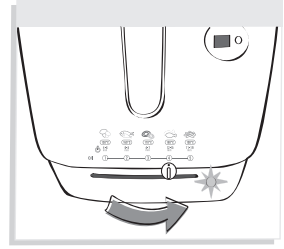
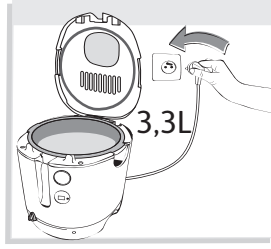
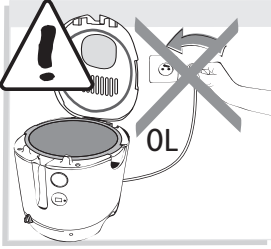



	Nb			
		2 Kg	190°C	+/- 19-25 min
		2 Kg	1 160°C 2 190°C	+/- 14-17 min +/- 9-11 min
		1 Kg	190°C	+/- 11-15 min
		1 Kg	170°C	+/-12-16 min
	8-10		190°C	+/- 9-10 min
	3/4		180°C	+/-12-19 min
	1-2		160°C	+/- 4-7 min
		300 g	150°C	+/- 4-6 min
	10-12		180°C	+/-11-13 min
	6		180°C	+/- 5-6 min
* * *	Nb			
		1,5 Kg	190°C	+/-13-19 min
		750 g	190°C	+/- 7-10 min
		750 g	170°C	+/- 8-11 min
		500 g	170°C	+/- 4-7 min
	10 p		190°C	+/- 5-7 min
		2 Kg	190°C	+/- 10-12 min
		300 g	190°C	+/- 3-5 min

