

## Schnellanleitung

Blu-ray Disc™ Heimkino-Soundsystem

## Guida Di Impostazione Rapida

Sistema Home Theater Blu-ray Disc™

## Guide de paramétrage facile

Système Cinéma Maison Blu-ray Disc™

## Guía de configuración sencilla

Blu-ray Disc™ Sistema de sonido "Home Theater" (Teatro en casa)

## Gids Voor Eenvoudig Instellen

Blu-ray Disc™ Home Theater Geluidssysteem

## Guide enkel inställning

Blu-ray Disc™ Hemmabio ljudsystem

## Nem Indstillingsoversigt

Blu-ray Disc™ Lydsystem til hjemmebiograf

## Helppo asetusopas

Blu-ray Disc™ -kotiteatterijärjestelmä

Modell Nr./Model No./Modèle n°/Modelo N./Model Nr./Modell nr./Model nr./Malli nro

# SC-BTT190

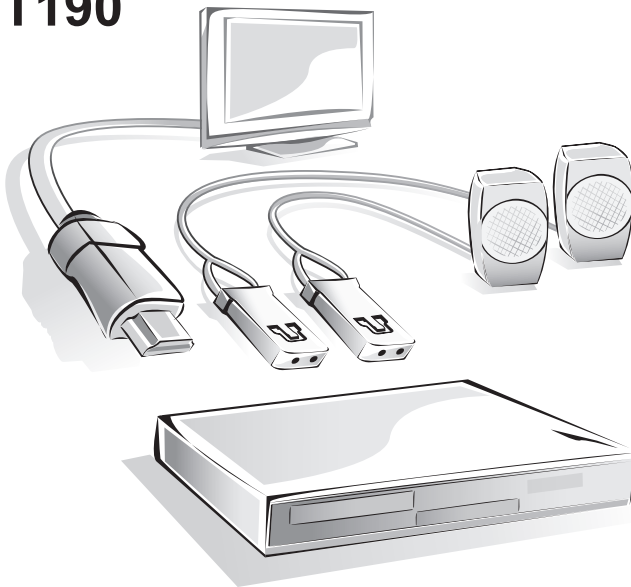

# Schnellanleitung

## SCHRITT 1: Anbringen des Stickers an den Kabeln

z.B. Frontlautsprecher Lch

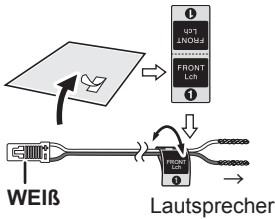

Lautsprecherkabelaufkleber	Anschluss
FRONT Lch ①	WEIß
FRONT Rch ②	ROT
SURROUND Lch ③	BLAU
SURROUND Rch ④	GRAU
CENTER ⑤	GRÜN
SUBWOOFER ⑥	VIOLETT

## SCHRITT 2: Bestätigung des entsprechenden Kabels

Lesen Sie die Angaben auf dem Etikett auf der Rückseite des Lautsprechers, bevor Sie das entsprechende Kabel anschließen.

Überprüfen Sie, ob der Lautsprechertyp mit den Angaben auf dem Etikett auf der Rückseite des Lautsprechers übereinstimmt.

z.B. Frontlautsprecher

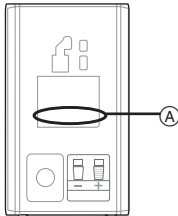

Lautsprecher	Ⓐ
Frontlautsprecher	FRONT/AVANT
Mittellautsprecher	CENTER/CENTRE
Surround-Lautsprecher	SURROUND/AMBIOPHONIE

## SCHRITT 3: Anschließen der Lautsprecherkabel

Bei Front- und Surround-Lautsprechern besteht kein Unterschied zwischen rechts und links.

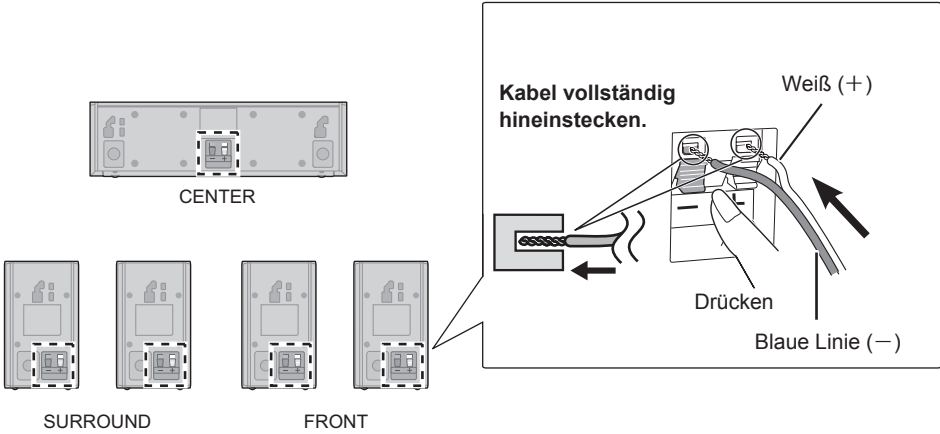

## SCHRITT 4: Die Lautsprecher aufstellen

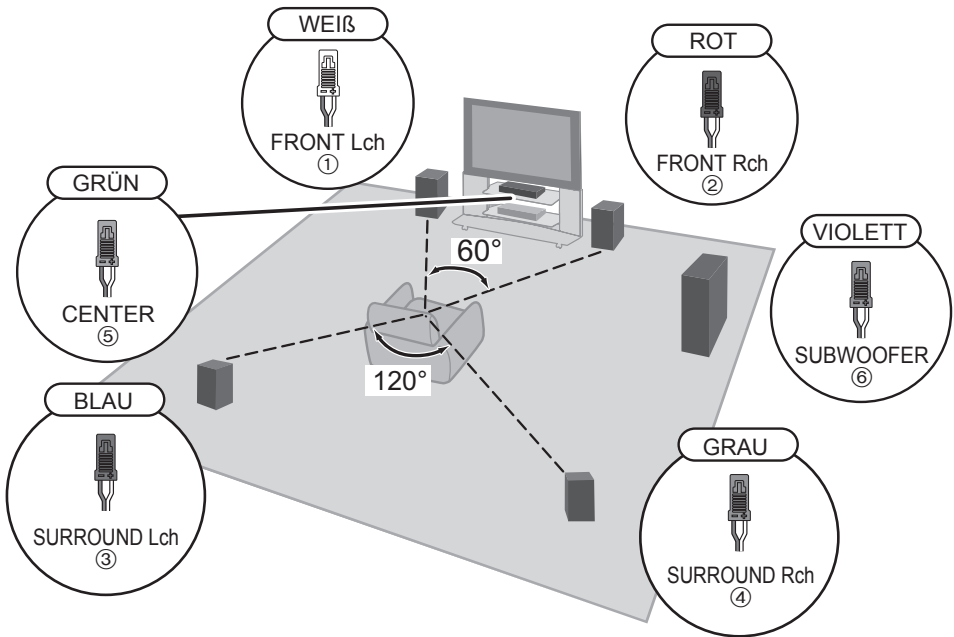

# SCHRITT 5: Die Kabel verbinden

Informationen zu anderen Verbindungsmethoden und Internet-Funktionen finden Sie in der Bedienungsanleitung.

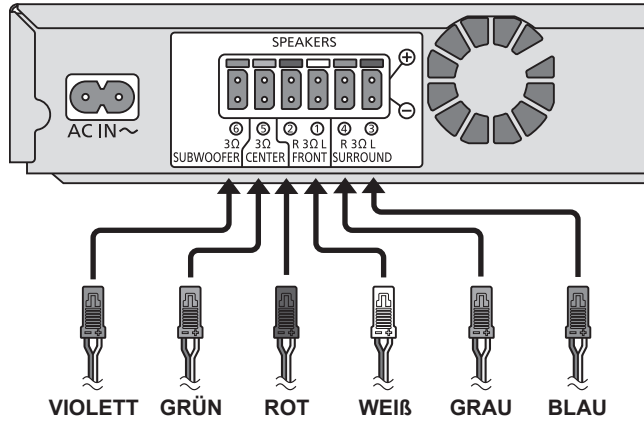

Verbinden Sie die Lautsprecherkabel mit den Anschlüssen der gleichen Farbe.

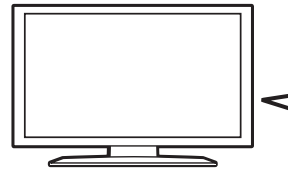

# SCHRITT 6: Anschalten des Systems

**1** Schließen Sie das Netzkabel an.

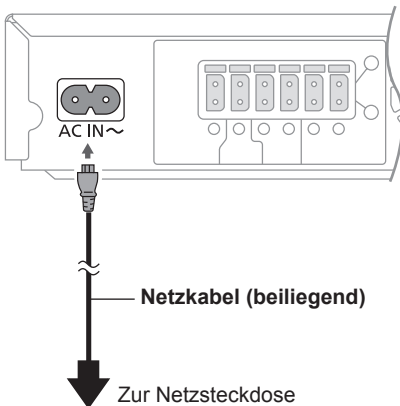

**2** Schalten Sie den Fernseher ein.

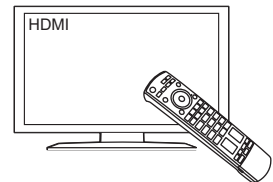

Stellen Sie den Video-Eingangsmodus auf HDMI, etc.

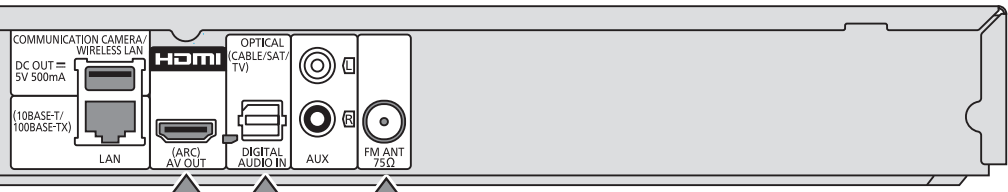

**HDMI-Kabel**  
(nicht beiliegend)

**UKW-Zimmerantenne (beiliegend)**

Befestigen Sie das Ende der Antenne an einer Wand oder Säule, wo der Empfang am besten ist.

**Optisches Digital-Audiokabel**  
(nicht beiliegend)

Nicht erforderlich, wenn der HDMI-Anschluss des Fernsehgeräts mit "HDMI (ARC)" gekennzeichnet ist.

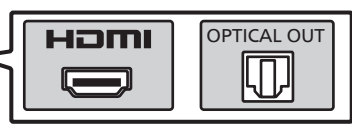

### 3 Anschalten des Systems.

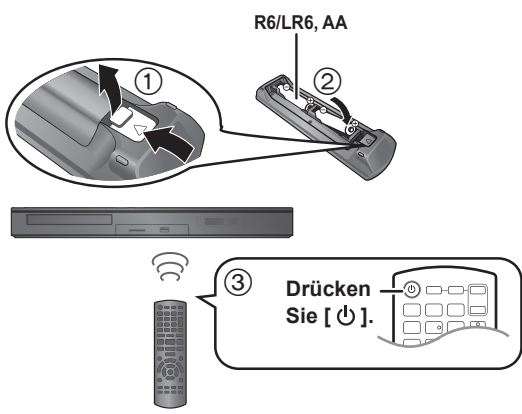

### 4 Die Grundeinstellung beginnt.

Befolgen Sie die Anweisungen auf dem Bildschirm.

# Guida Di Impostazione Rapida

## FASE 1: Attaccare gli adesivi sui cavi

es., Diffusore anteriore Lch

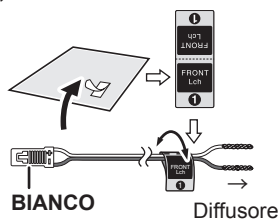

Autoadesivo del cavo altoparlante	Connettore
FRONT Lch ①	BIANCO
FRONT Rch ②	ROSSO
SURROUND Lch ③	BLU
SURROUND Rch ④	GRIGIO
CENTER ⑤	VERDE
SUBWOOFER ⑥	VIOLA

## FASE 2: Confermare il cavo corrispondente

Controllare l'etichetta sul retro dell'altoparlante prima di collegare il cavo corrispondente.  
Verificare il tipo di altoparlante con l'etichetta sul retro dell'altoparlante.

es., Diffusori anteriori

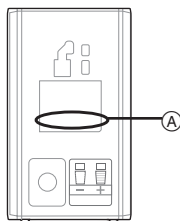

Diffusori	①
Diffusori anteriori	FRONT/AVANT
Diffusore centrale	CENTER/CENTRE
Diffusori surround	SURROUND/AMBIOPHONIE

## FASE 3: Collegamento dei cavi degli altoparlanti

Non c'è alcuna differenza tra i diffusori anteriori/i diffusori surround destro e sinistro.

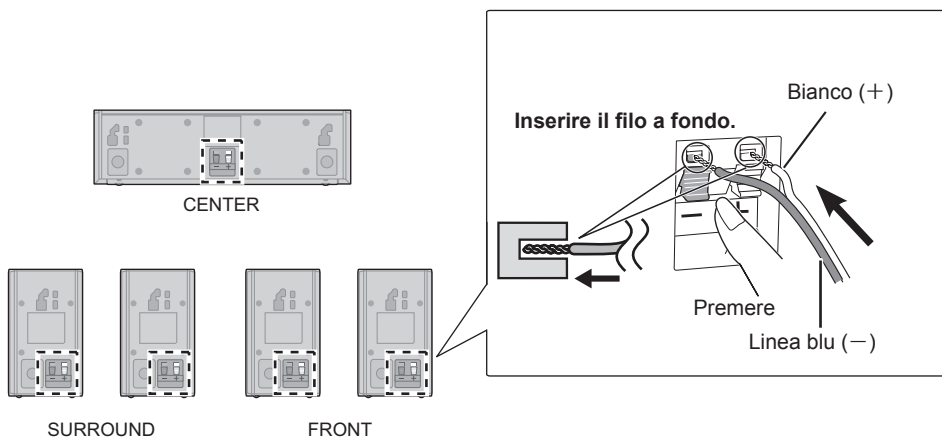

## FASE 4: Posizionare gli altoparlanti

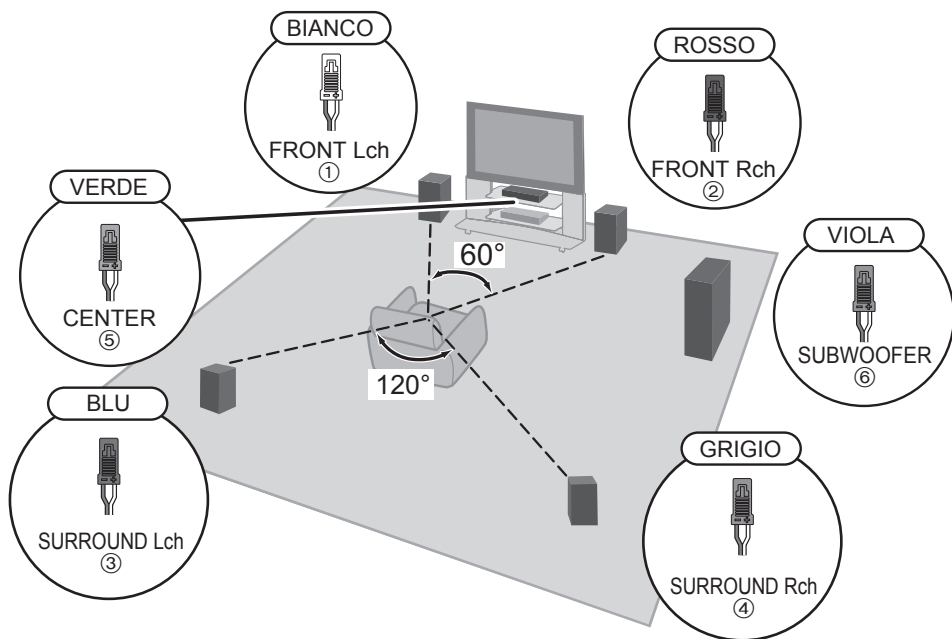

## FASE 5: Collegare i cavi

Per informazioni su altri metodi di collegamento e impostazioni internet, consultare le istruzioni d'uso.

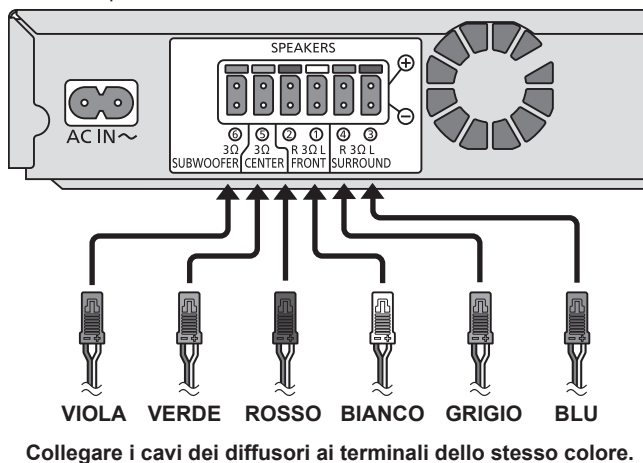

## FASE 6: Accendere l'impianto

**1** Collegare il cavo di alimentazione CA.

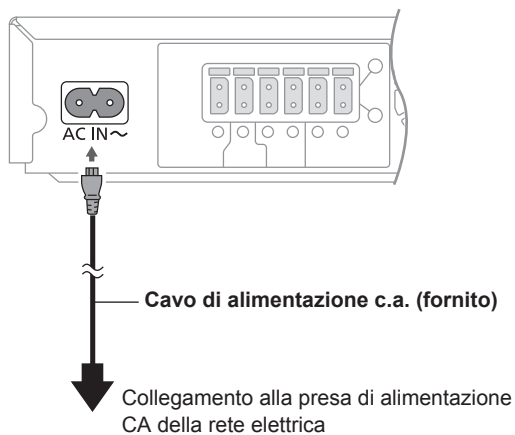

**2** Accendere l'apparecchio TV.

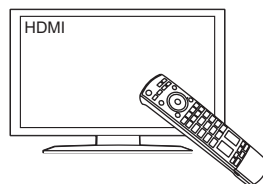

Impostare la modalità video su HDMI, ecc.



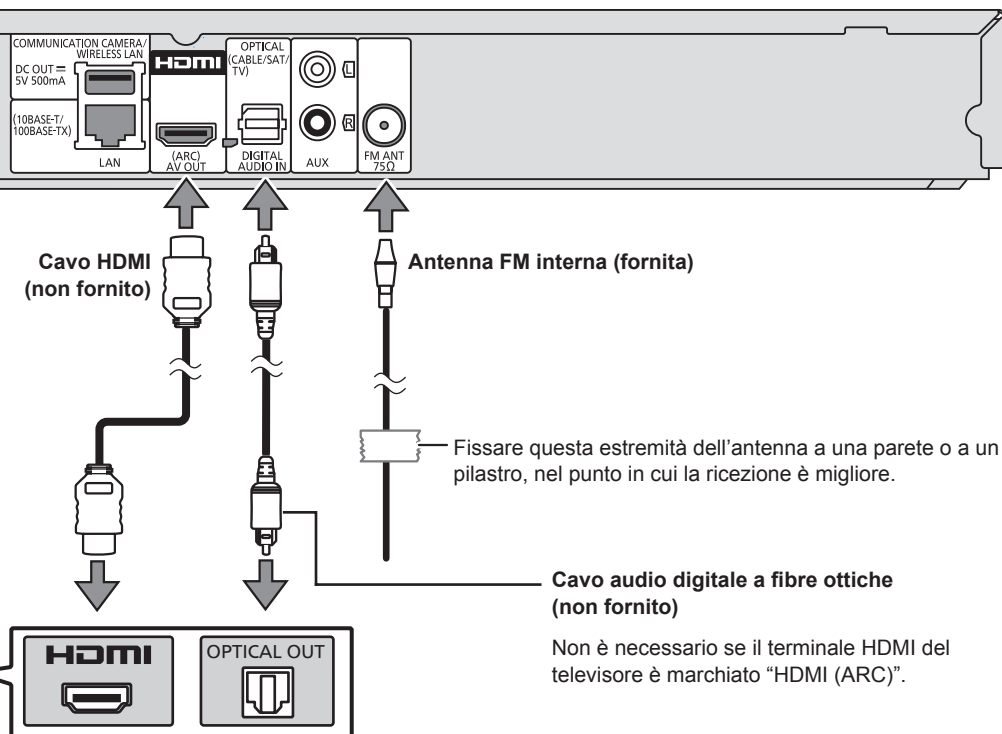

### 3 Accendere l'impianto.

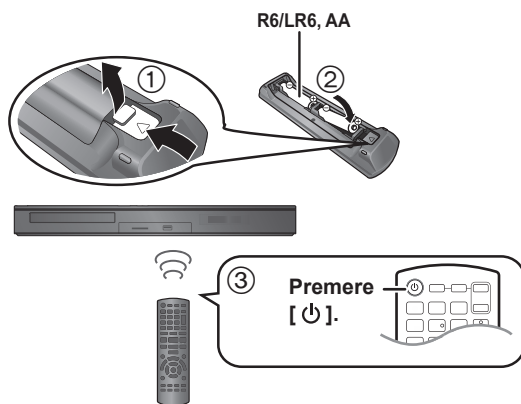

### 4 Ha inizio la procedura di impostazione rapida.

Seguire le istruzioni sullo schermo.

# Guide de paramétrage facile

## ÉTAPE 1: Mise en place de l'autocollant sur les câbles

ex. Lch enceinte avant

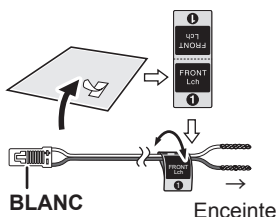

Autocollant câble enceinte	Connecteur
FRONT Lch ①	BLANC
FRONT Rch ②	ROUGE
SURROUND Lch ③	BLEU
SURROUND Rch ④	GRIS
CENTER ⑤	VERT
SUBWOOFER ⑥	VIOLET

## ÉTAPE 2: Vérification de la correspondance du câble

Référez-vous à l'étiquette arrière du haut-parleur avant de connecter le câble correspondant. Vérifiez le type de haut-parleur avec l'étiquette à l'arrière.

ex. Enceintes avant

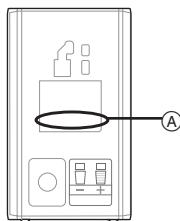

Enceintes	①
Enceintes avant	FRONT/AVANT
Enceinte centrale	CENTER/CENTRE
Enceintes surround	SURROUND/AMBIOPHONIE

## ÉTAPE 3: Pour connecter les câbles de l'enceinte

Les enceintes avant et les enceintes Surround ne présentent aucune différence entre le côté droit et gauche.

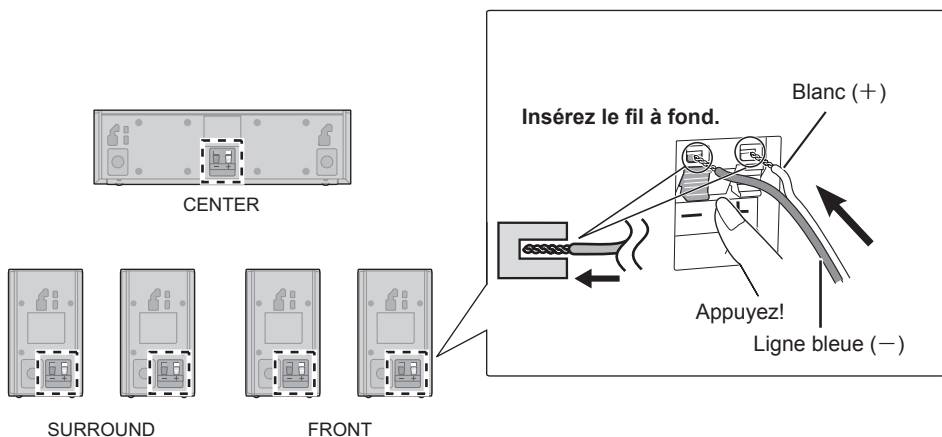

## ÉTAPE 4: Mettre les hauts-parleurs en place

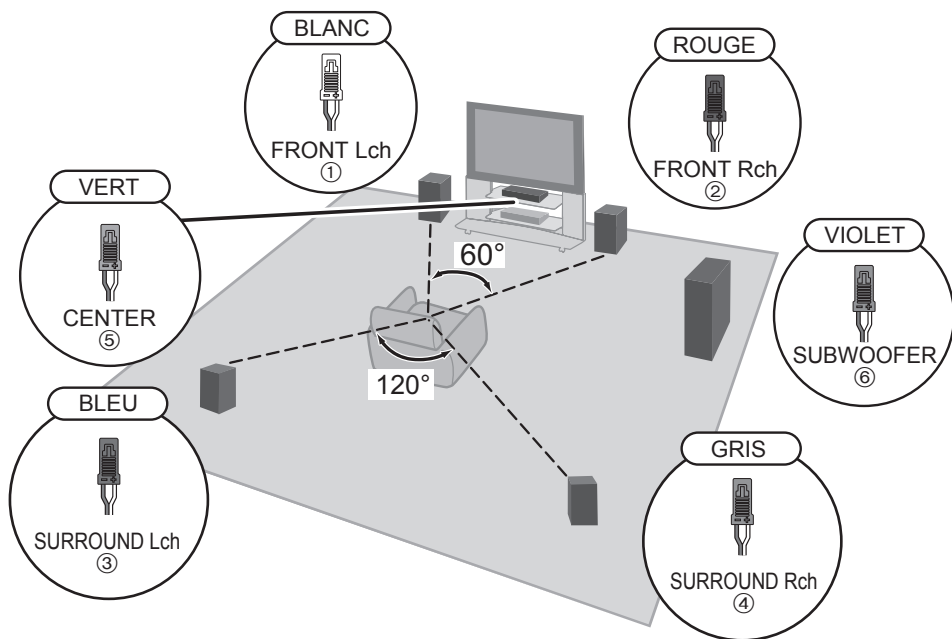

## ÉTAPE 5: Connectez les câbles

Pour avoir des informations sur d'autres méthodes de connexion et sur les fonctionnalités Internet, consultez le mode d'emploi.

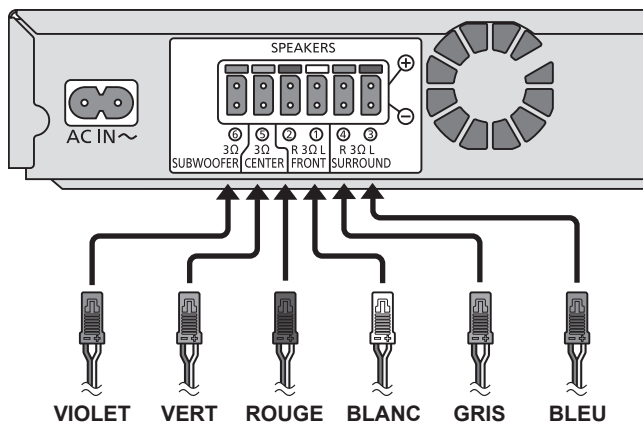

Connectez les câbles de l'enceinte aux prises de la même couleur.



## ÉTAPE 6: Allumez le système

❶ Connectez le fil secteur CA.

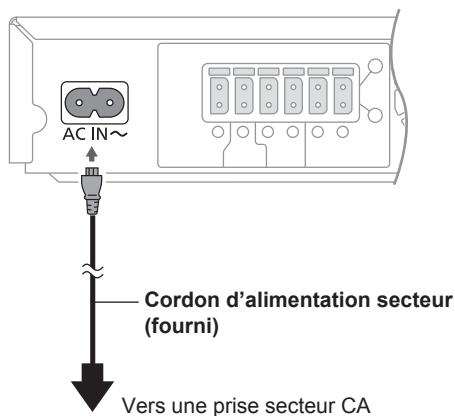

❷ Allumez le téléviseur.

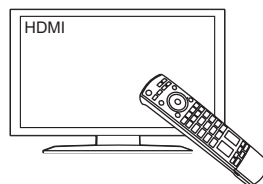

Mettez le mode entrée vidéo sur HDMI, etc.

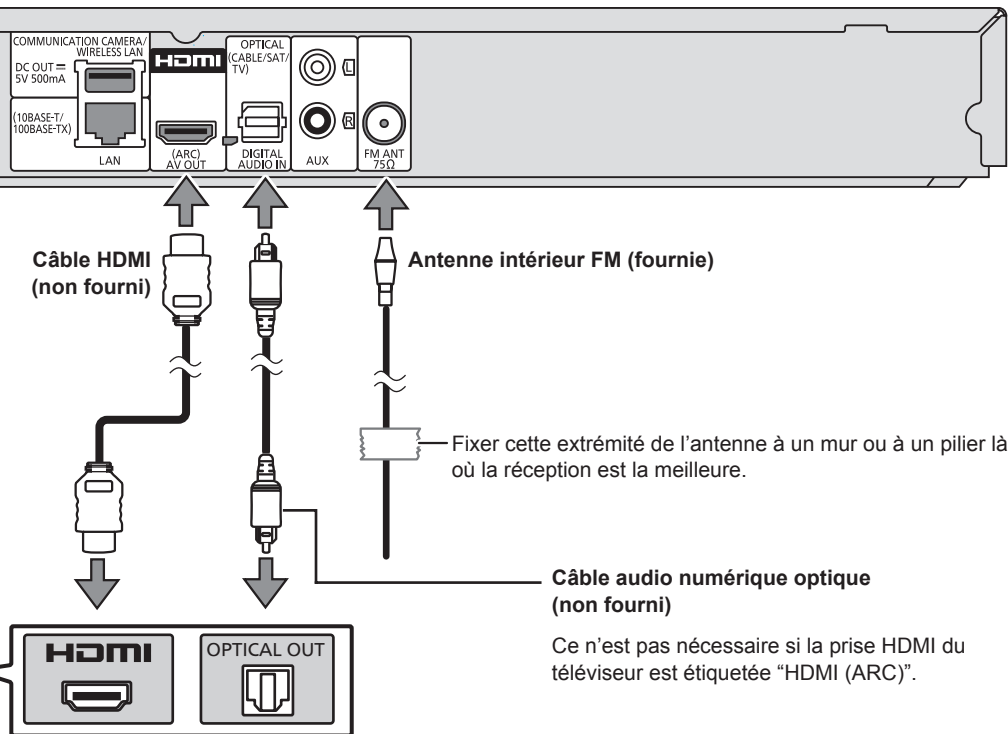

### 3 Allumez le système.

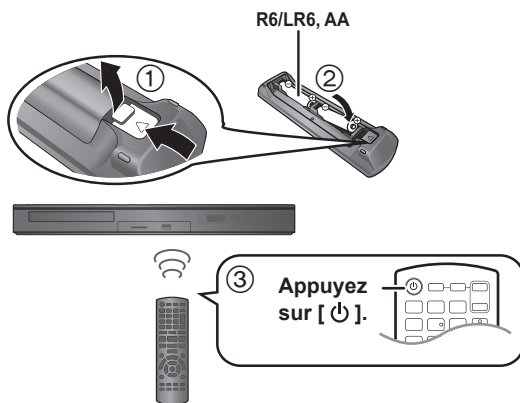

### 4 Le Réglage facile démarre.

Suivez les instructions à l'écran.

# Guía de configuración sencilla

## PASO 1: Colocar la pegatina en los cables

p.ej. Altavoz delanteros Lch

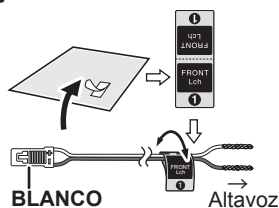

Pegatina del cable del altavoz	Conector
FRONT Lch ①	BLANCO
FRONT Rch ②	ROJO
SURROUND Lch ③	AZUL
SURROUND Rch ④	GRIS
CENTER ⑤	VERDE
SUBWOOFER ⑥	MORADO

## PASO 2: Confirmar el cable correspondiente

Consulte la etiqueta trasera del altavoz antes de conectar el cable correspondiente.  
Verifique que el tipo de altavoz con la etiqueta que se encuentra en la parte trasera del altavoz.

p.ej. Altavoces delanteros

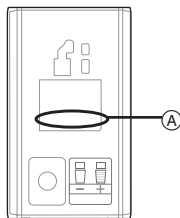

Altavoces	Ⓐ
Altavoces delanteros	FRONT/AVANT
Altavoz central	CENTER/CENTRE
Altavoces de sonido envolvente	SURROUND/AMBIOPHONIE

## PASO 3: Conexión de los cables del altavoz

Los altavoces frontales y envolventes no tienen diferencia entre izquierda y derecha.

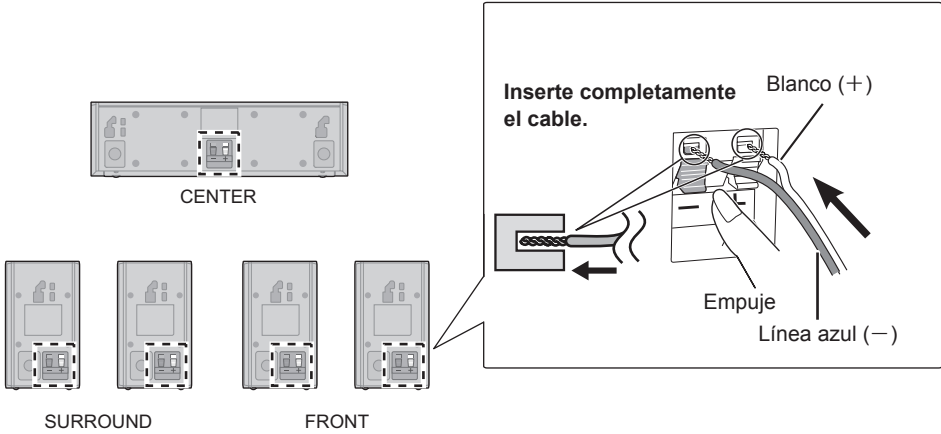

## PASO 4: Coloque los altavoces

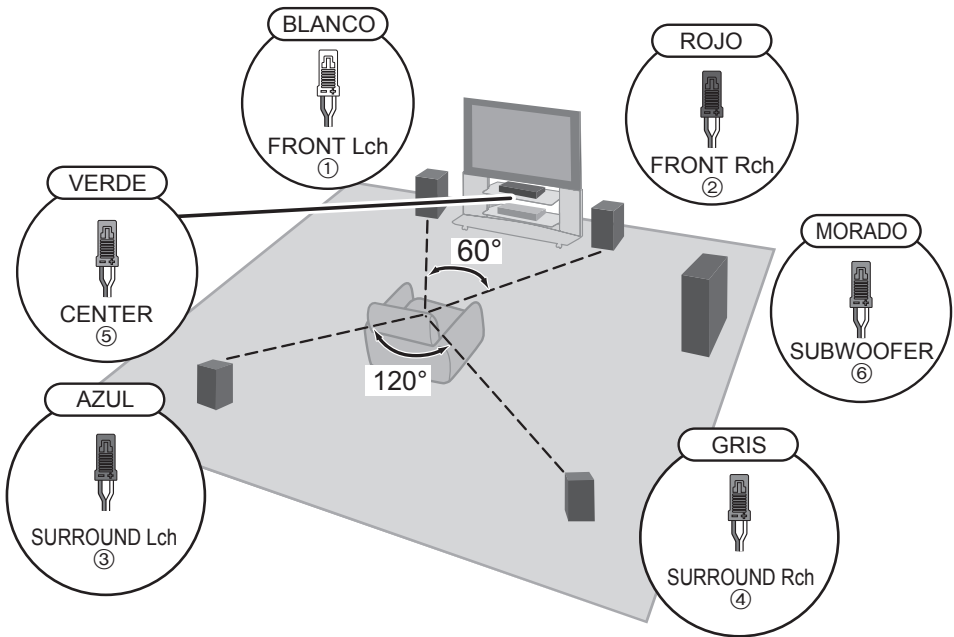

## PASO 5: Conectar los cables

Para obtener información sobre los métodos de conexión y las funciones de Internet, consulte las instrucciones de funcionamiento.

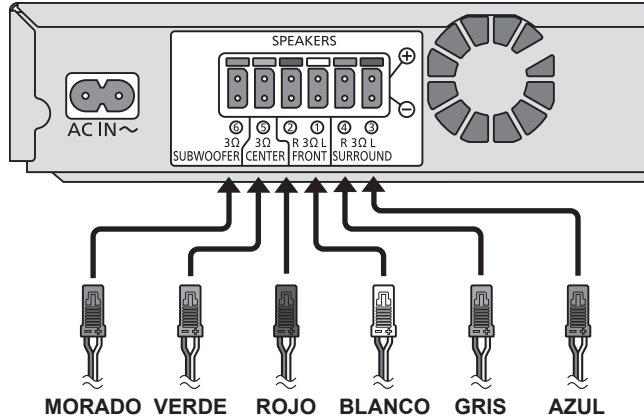

Conecte los cables del altavoz a los terminales del mismo color.

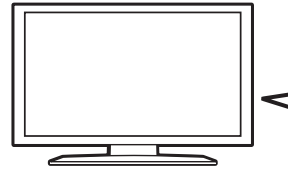

## PASO 6: Encender el sistema

1 Conecte el cable de corriente de CA.

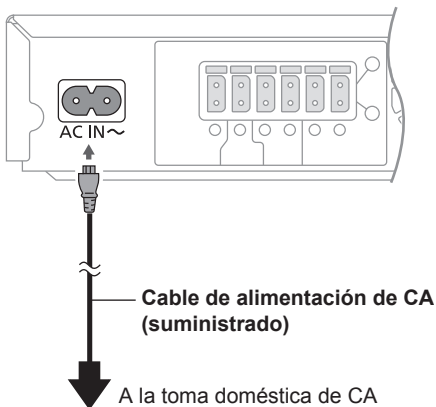

2 Encienda el televisor.

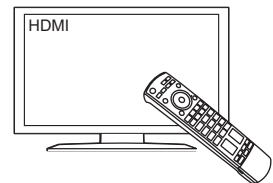

Fije el modo de entrada de video en HDMI, etc.



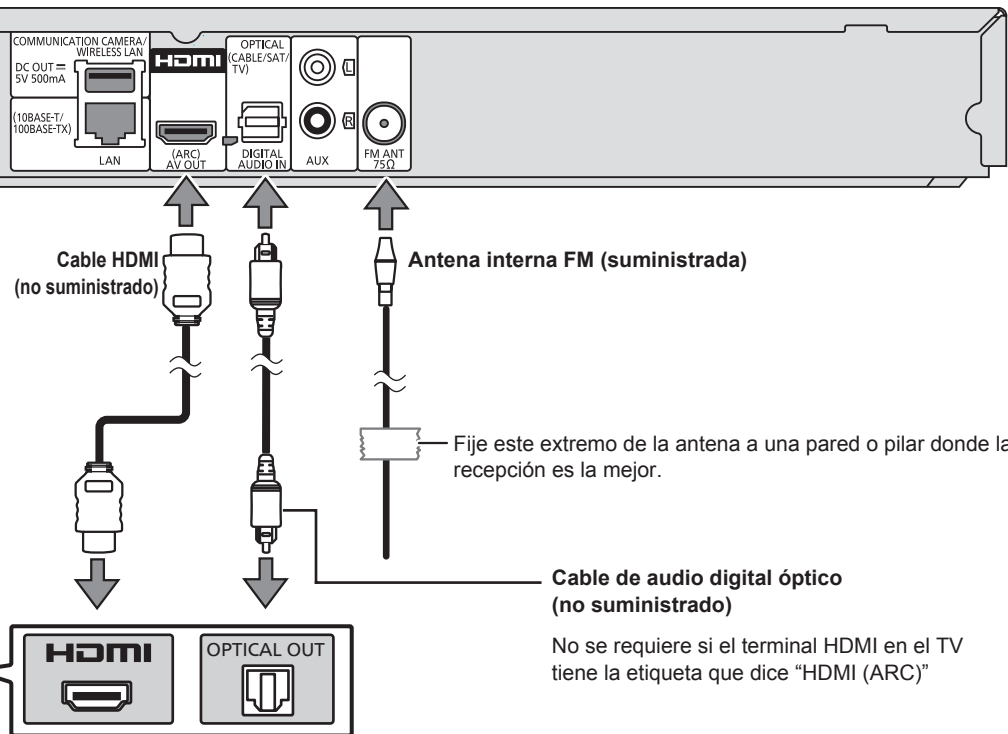

### 3 Encender el sistema.

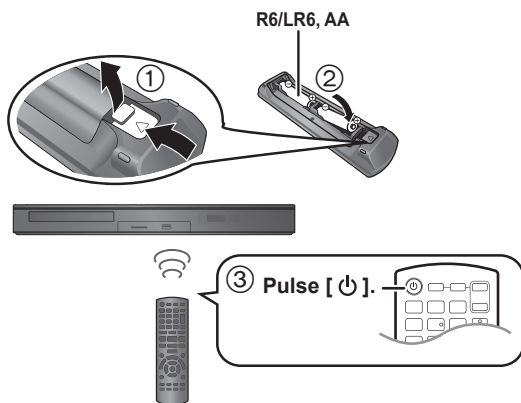

### 4 El Ajuste rápido comienza.

Siga las instrucciones en la pantalla.

# Gids Voor Eenvoudig Instellen

## STAP 1: Aanbrengen van de sticker op de kabels

bijv. Voorluidspreker Lch

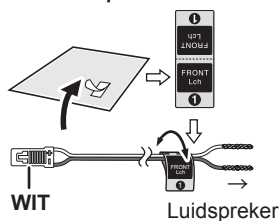

Sticker luidsprekerkabel	Connector
FRONT Lch ①	WIT
FRONT Rch ②	ROOD
SURROUND Lch ③	BLAUW
SURROUND Rch ④	GRIJS
CENTER ⑤	GROEN
SUBWOOFER ⑥	PAARS

## STAP 2: Controleer de bijbehorende kabel

Verwijs naar de label aan de achterkant van de luidspreker voordat u de overeenkomstige kabel aansluit. Controleer het type luidspreker met de label op de achterkant van de luidspreker.

bijv. Voorluidsprekers

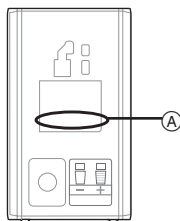

Luidsprekers	Ⓐ
Voorluidsprekers	FRONT/AVANT
Middenluidspreker	CENTER/CENTRE
Surroundluidsprekers	SURROUND/AMBIOPHONIE

## STAP 3: De luidsprekerkabels verbinden

Voor de voorluidsprekers en de surroundluidsprekers wordt geen onderscheid tussen rechts en links gemaakt.

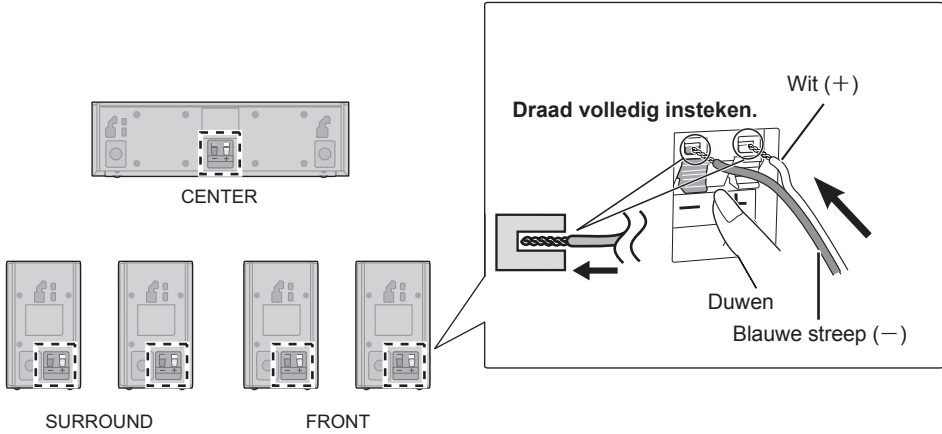

## STAP 4: Plaats de luidsprekers

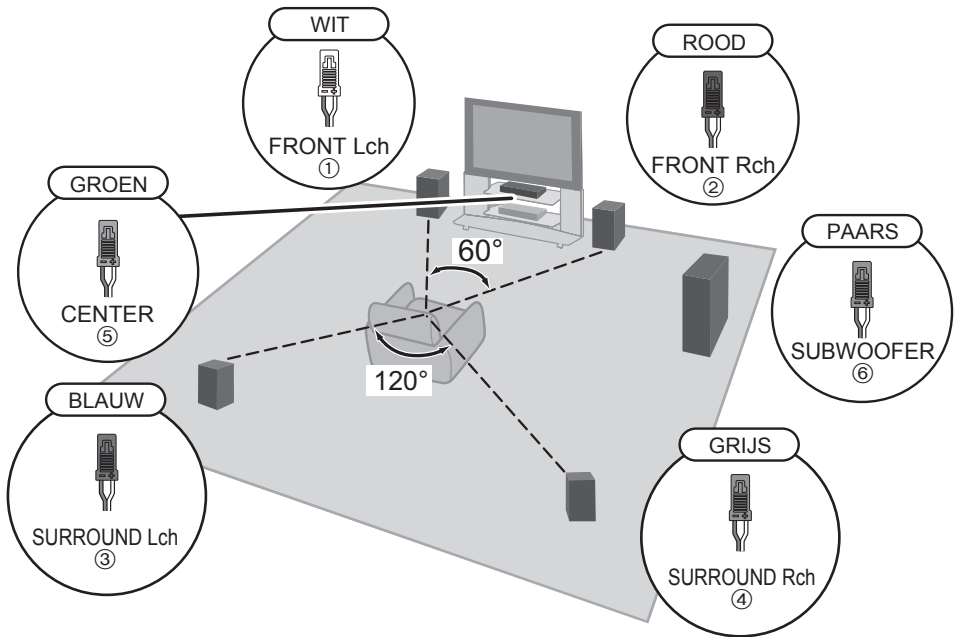

# STAP 5: De kabels aansluiten

Raadpleeg de gebruiksaanwijzing voor informatie over andere aansluitmethoden en internetkenmerken.

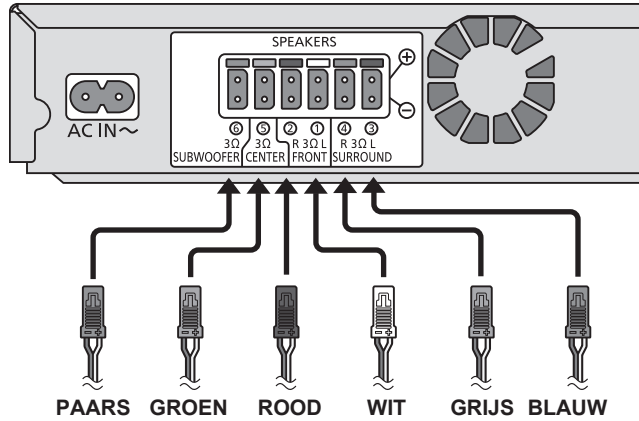

Sluit de luidsprekerkabels aan op de aansluitpunten van dezelfde kleur.

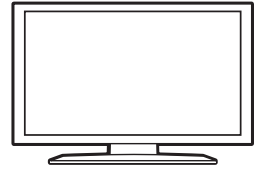

# STAP 6: Schakel het systeem in

**1** Sluit het netsnoer aan.

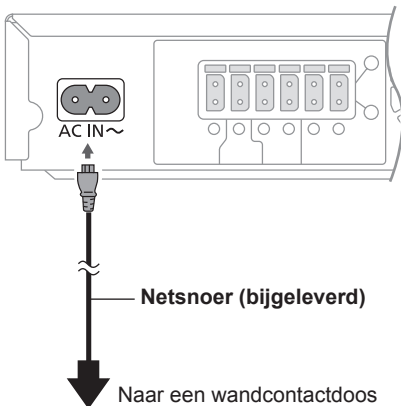

**2** Zet de TV aan.

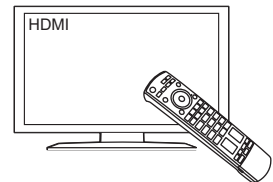

Zet de video-ingangsmodus op HDMI, enz.

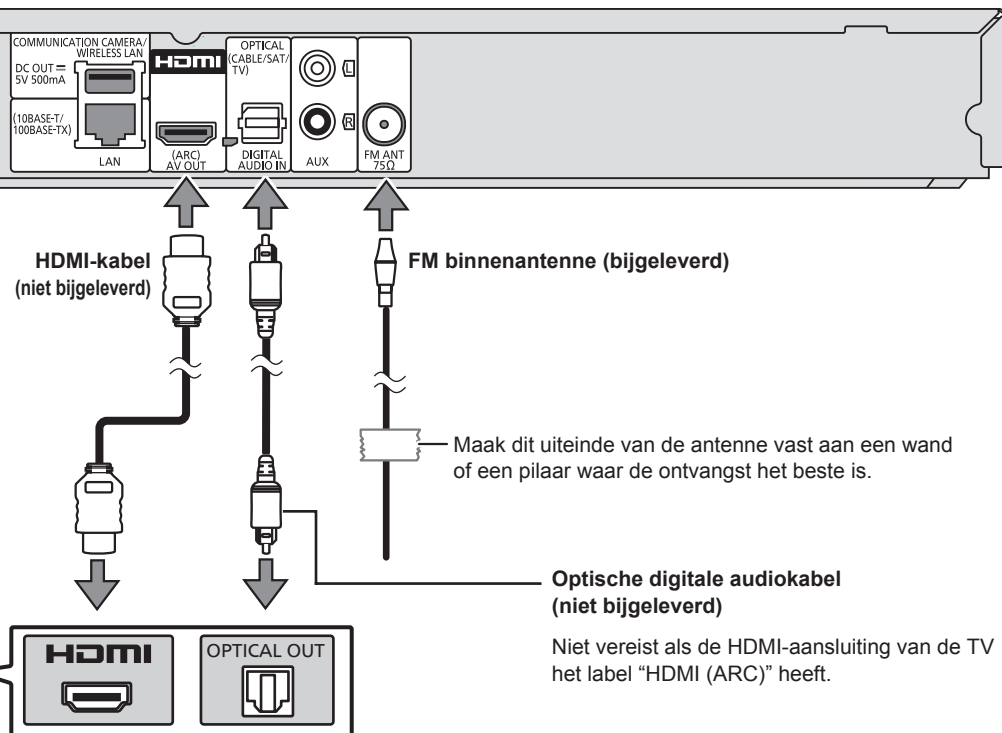

### 3 Schakel het systeem in.

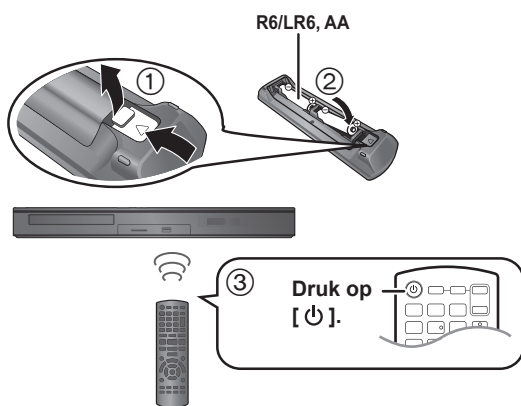

### 4 De Eenvoudige Instelling start.

Volg de instructies die op het scherm verschijnen.

# Guide enkel inställning

## STEG 1: Sätt fast etiketten på kablarna

t. ex. Främre högtalare Lch

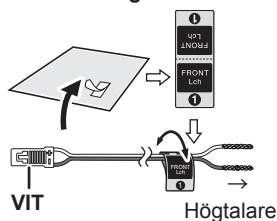

Etikett på högtalarkabel	Kontakt
FRONT Lch ①	VIT
FRONT Rch ②	RÖD
SURROUND Lch ③	BLÅ
SURROUND Rch ④	GRÅ
CENTER ⑤	GRÖN
SUBWOOFER ⑥	LILA

## STEG 2: Bekräfta den motsvarande kabeln

Se den bakre etiketten på högtalaren innan du ansluter motsvarande kabel.  
Kontrollera typen av högtalare med etiketten på baksidan av högtalaren.

t. ex. Främre högtalare

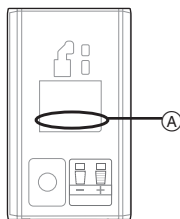

Högtalare	Ⓐ
Främre högtalare	FRONT/AVANT
Center högtalare	CENTER/CENTRE
Surround högtalare	SURROUND/AMBIOPHONIE

## STEG 3: Hur du ansluter högtalarkablarna

Fronthögtalarna och surroundhögtalarna har ingen skillnad mellan höger och vänster.

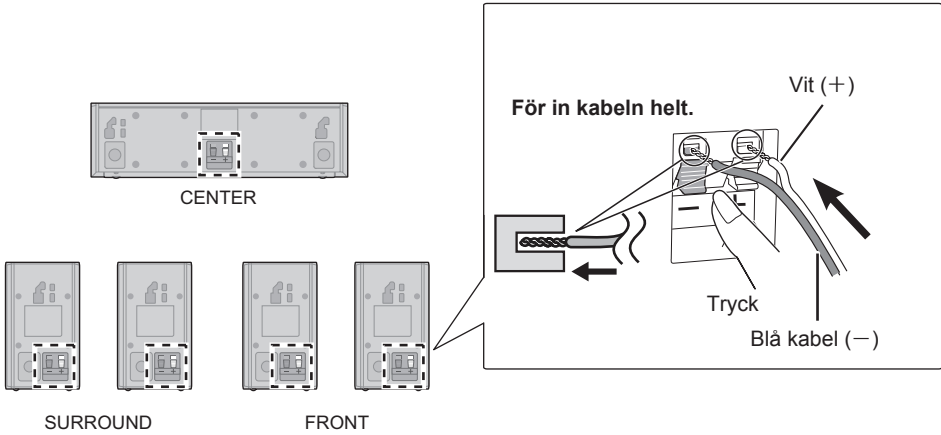

## STEG 4: Sätt högtalarna på plats

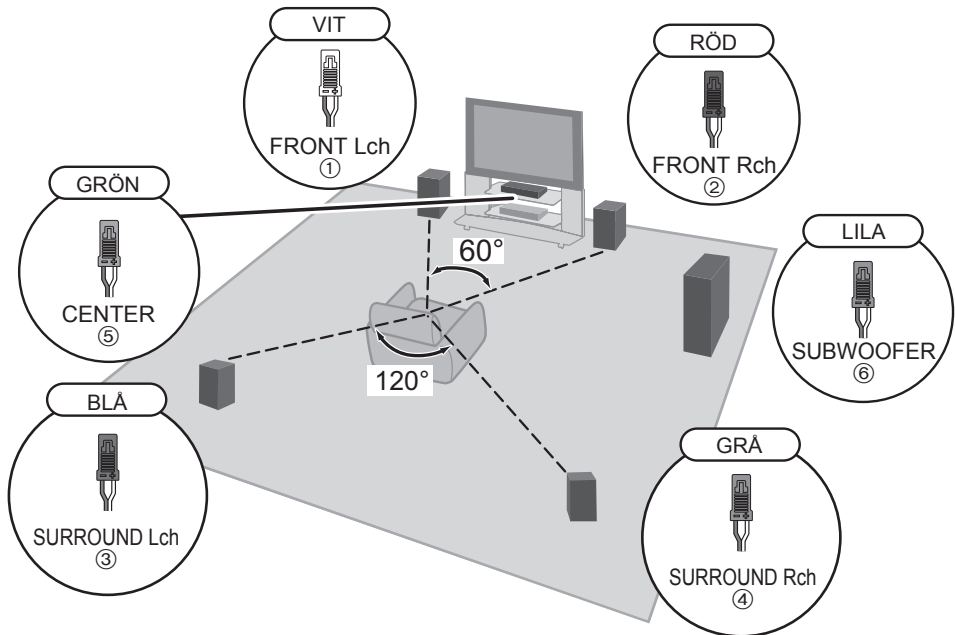

# STEG 5: Anslut kablarna

För information om andra anslutningsmetoder och internetfunktioner, se bruksanvisningarna.

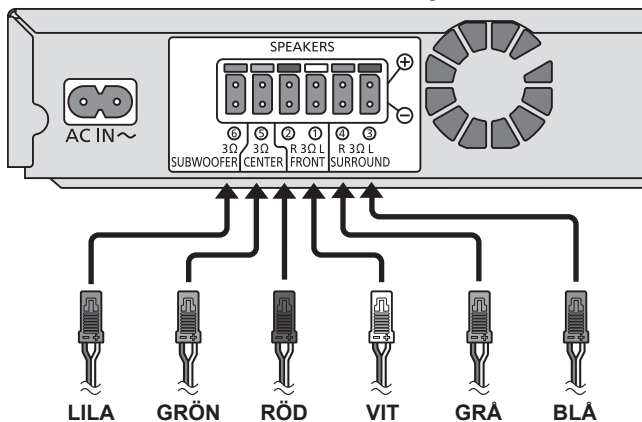

Anslut högtalarkablarna till kontakter med samma färg.

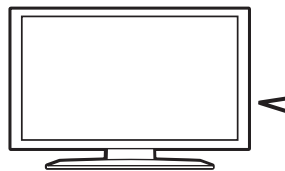

## STEG 6: Sätt på systemet

### 1 Anslut nätkabeln.

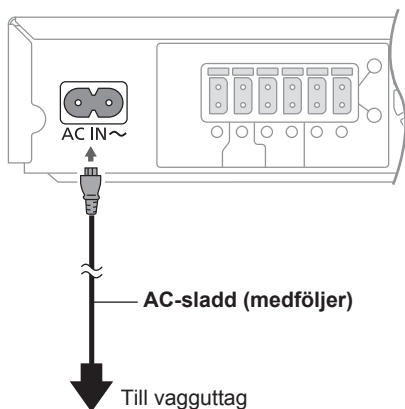

### 2 Sätt på TV:n.

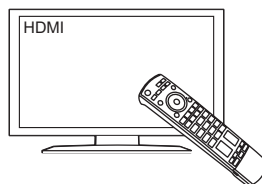

Ställ in videoingångsläget på HDMI etc.



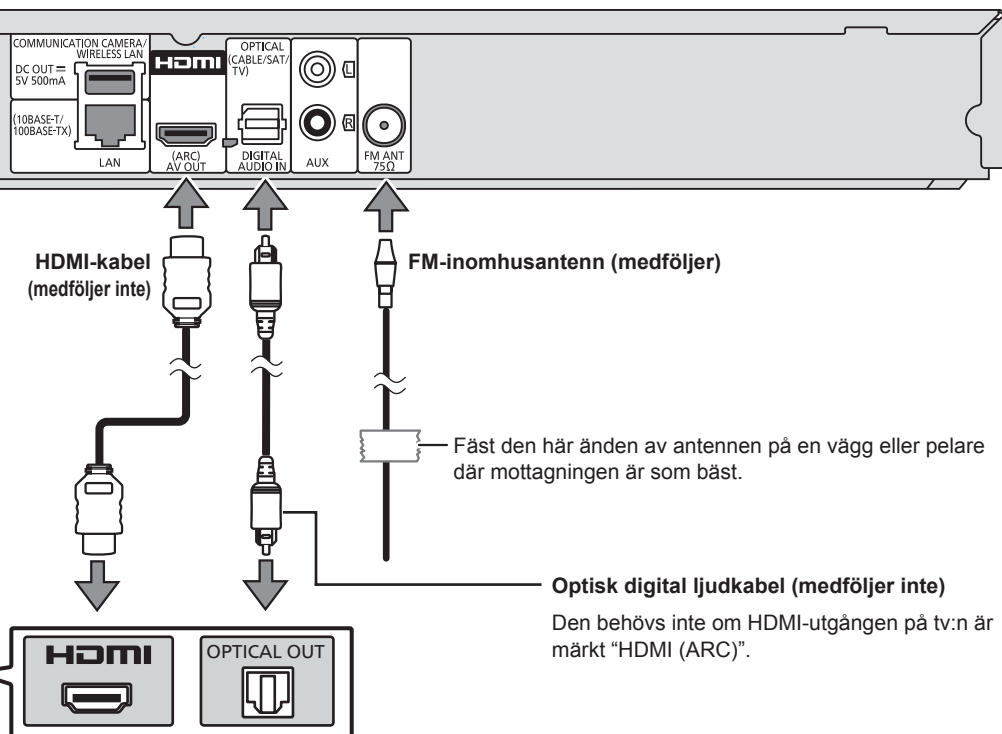

### 3 Sätt på systemet.

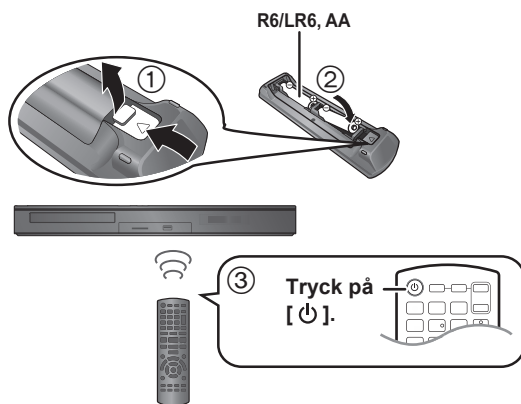

### 4 Den enkla inställningen startar.

Följ anvisningarna på skärmen.

# Nem Indstillingsoversigt

## TRIN 1: Fastgøring af klistermærke på kablerne

f.eks. Front-højttalere Lch

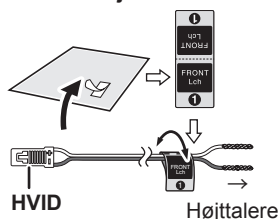

Mærkat til højttalerkabel	Stik
FRONT Lch ①	HVID
FRONT Rch ②	RØD
SURROUND Lch ③	BLÅ
SURROUND Rch ④	GRÅ
CENTER ⑤	GRØN
SUBWOOFER ⑥	LILLA

## TRIN 2: Bekræftelse af det tilhørende kabel

Der henvises til etiketten bag på højttaleren før tilslutning af det relevante kabel.  
Kontrollér højttalertypen på etiketten bag på højttaleren.

f.eks. Front-højttalere

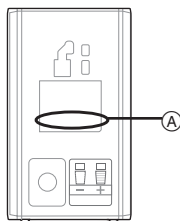

Højttalere	Ⓐ
Front-højttalere	FRONT/AVANT
Center-højttaleren	CENTER/CENTRE
Surround Sound-højttalerne	SURROUND/AMBIOPHONIE

## TRIN 3: Tilslutning af højttalerkabler

Der er ingen forskel på venstre og højre fronthøjttalere og surround sound-højttalere.

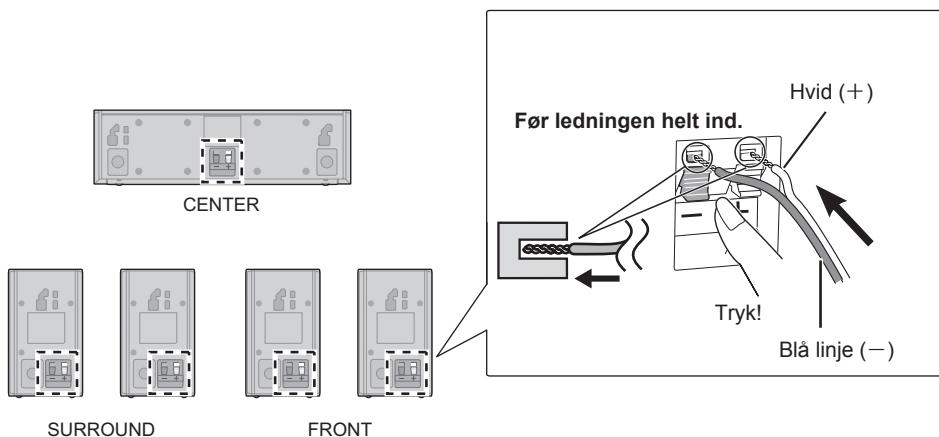

## TRIN 4: Placér højttalerne

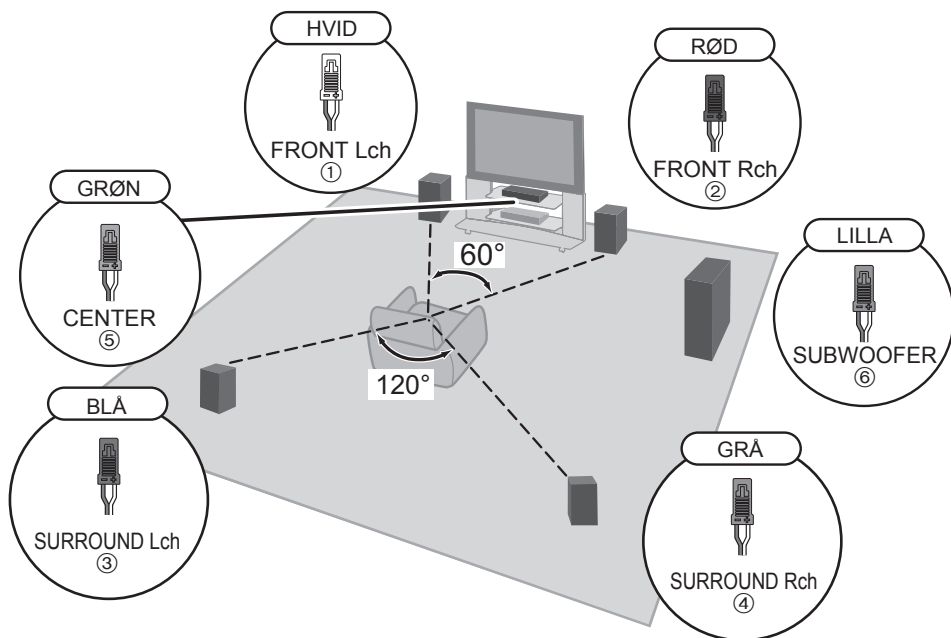

## TRIN 5: Tilslut kablerne

Se betjeningsvejledningen for at få oplysninger om andre forbindelsesmetoder og internetfunktionen.

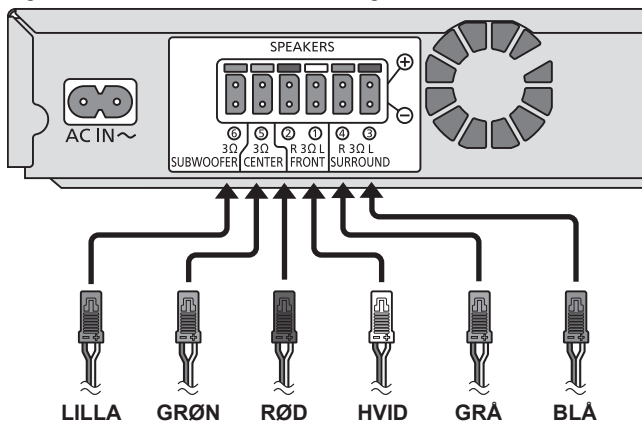

Tilslut til højttalerkablerne til terminalerne af samme farve.

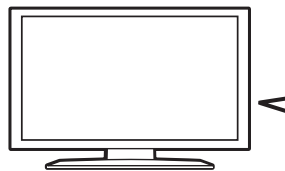

## TRIN 6: Tænd systemet

**1** Forbind lysnetledningen.

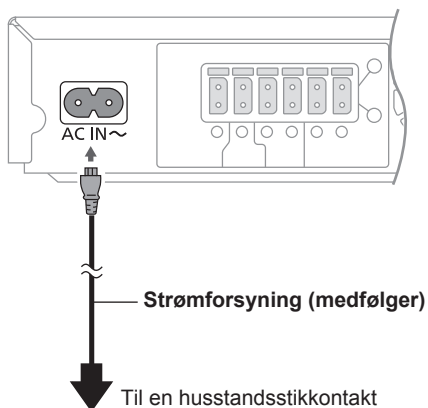

**2** Tænd for fjernsynet.

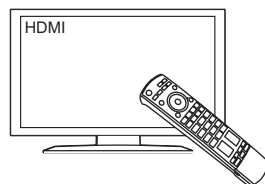

Sæt videofunktionen til HDMI osv.

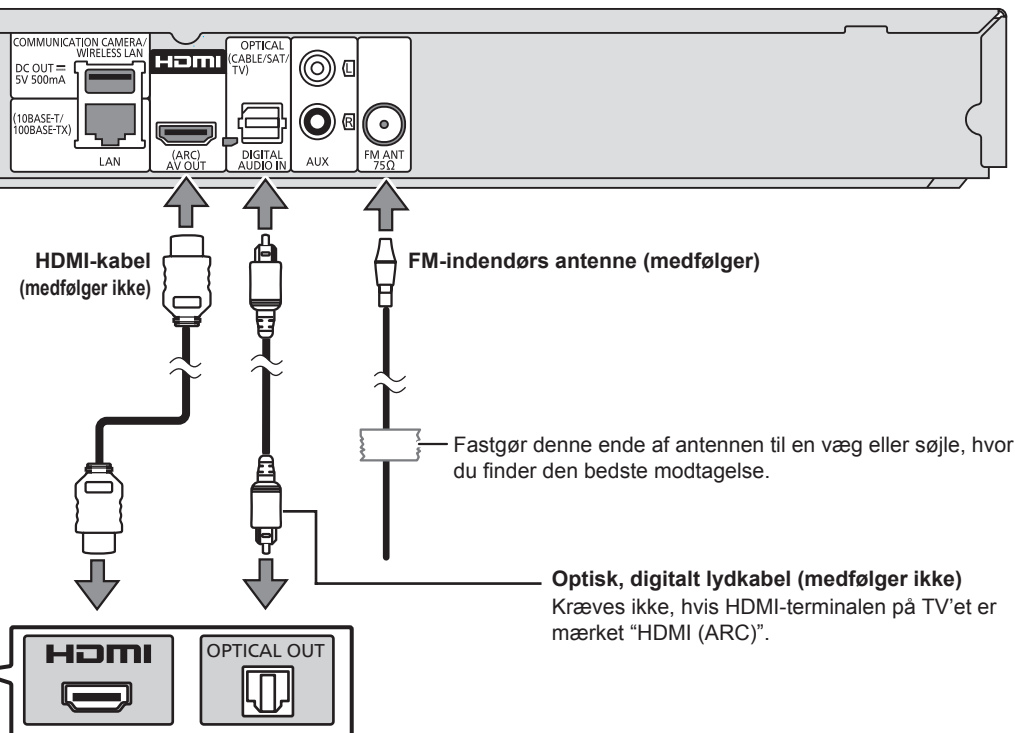

### 3 Tænd systemet.

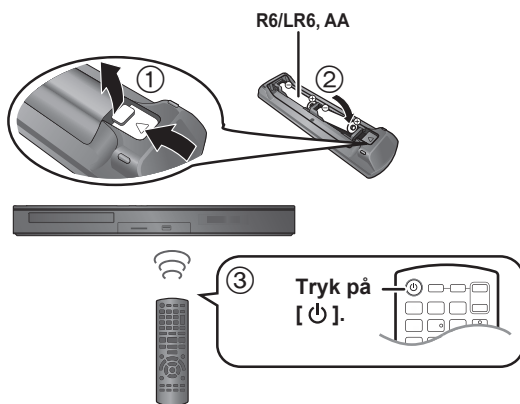

### 4 Start af Nem indstilling.

Følg anvisningerne på skærmen.

# Helppo asetusopas

## VAIHE 1: Tarrojen kiinnittäminen johtoihin

esim. Etukaiutin V-kanav.

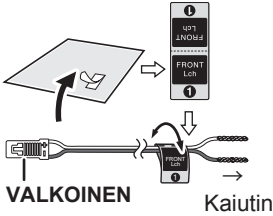

Kaiuttimen johdon tarra	Liitin
FRONT Lch ①	VALKOINEN
FRONT Rch ②	PUNAINEN
SURROUND Lch ③	SININEN
SURROUND Rch ④	HARMAA
CENTER ⑤	VIHREÄ
SUBWOOFER ⑥	PURPPURANPUNAINEN

## VAIHE 2: Vastaavan johdon vahvistaminen

Katso kaiuttimen takana olevaa merkintää ennen vastaavan johdon liittämistä.  
Tarkista kaiuttimen tyyppi sen takana olevasta merkinnästä.

esim. Etukaiutin

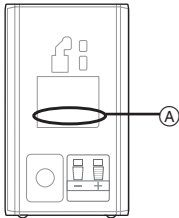

Kaiuttimet	①
Etukaiutin	FRONT/AVANT
Keskikaiutin	CENTER/CENTRE
Tilääänikaiuttimet	SURROUND/AMBIOPHONIE

## VAIHE 3: Kaiuttimen johtojen liittäminen

Etukaiuttimilla ja tilääänikaiuttimilla ei ole eroa oikean ja vasemman välillä.

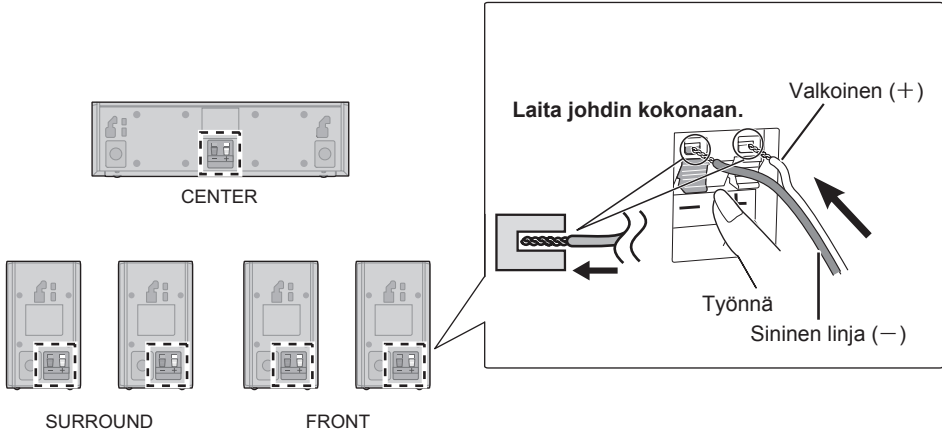

## VAIHE 4: Sijoita kaiuttimet

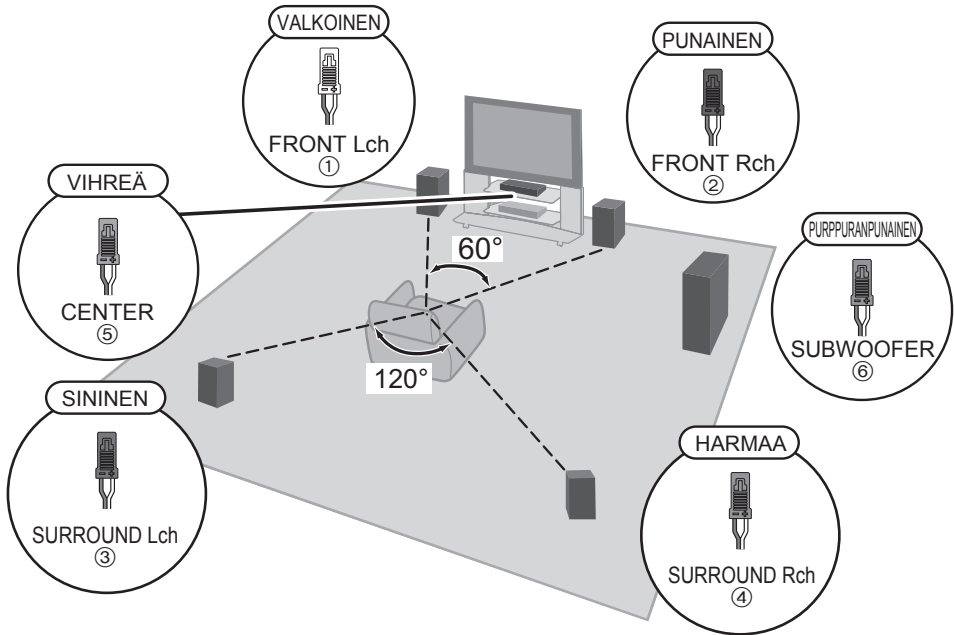

## VAIHE 5: Liitä johdot

Jos haluat lisätietoja liittämenetelmistä ja internet-ominaisuuksista, katso käyttöohjeita.

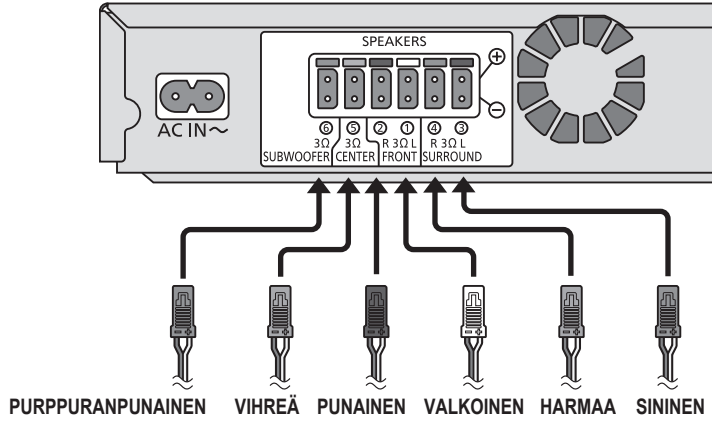

Liitä kaiuttimen johdot samanvärisiin liitäntöihin.

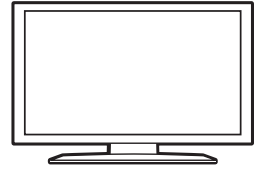

## VAIHE 6: Kytke järjestelmä päälle

**1** Liitä verkkokaapeli.

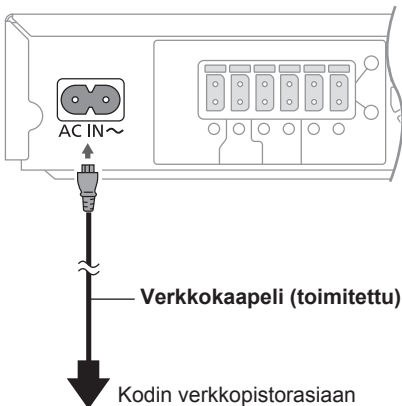

**2** Kytke televisio päälle.

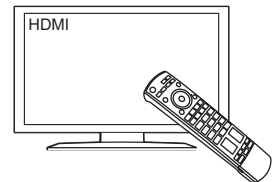

Aseta videon tulotila asentoon HDMI, jne.



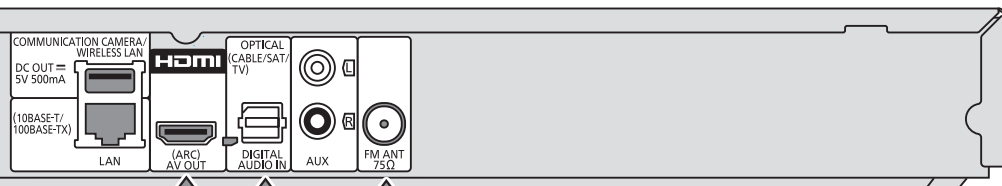

HDMI-kaapeli  
(ei toimitettu)

FM-sisäantenni (toimitettu)

Kiinnitä antennin tämä pää seinään tai pylväaseen, jossa vastaanotto on parasta.

Optinen digitaalinen audiojohto (ei toimitettu)

Ei tarvita, jos television HDMI-liitännässä on merkintä "HDMI (ARC)".

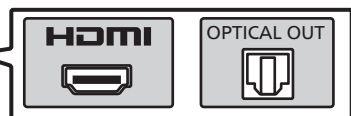

### 3 Kytke järjestelmä päälle.

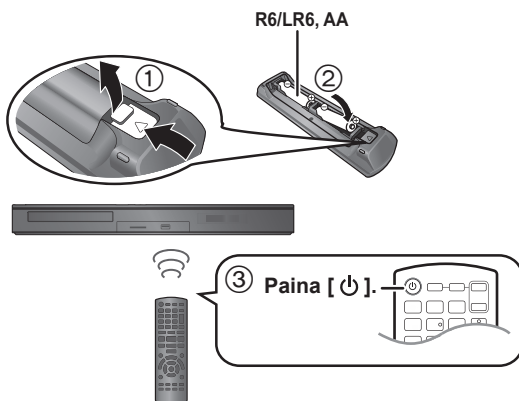

### 4 Helppo asetus käynnistyy.

Noudata näytön ohjeita.





---

Panasonic Corporation

**Web Site:** <http://panasonic.net>

Ge It Fr Sp Du Sw Da Fi