



Directions for Use



Important!
Return your
Warranty
Registration Card
within 10 days.
See why inside.



Need help? Call us!

Philips representatives are ready to help you with any questions about your new product. We can guide you through Connections, First-time Setup, or any of the Features. We want you to start enjoying your new product right away!

**CALL US BEFORE YOU CONSIDER
RETURNING THE PRODUCT.
1-800-531-0039**

or
Visit us on the web at
www.philips.com

Let's make things better.



PHILIPS

Return your Warranty Registration card today to ensure you receive all the benefits you're entitled to.

Once your PHILIPS purchase is registered, you're eligible to receive all the privileges of owning a PHILIPS product. So complete and return the Warranty Registration Card enclosed with your purchase at once. And take advantage of these important benefits.

Warranty Verification

Registering your product within 10 days confirms your right to maximum protection under the terms and conditions of your PHILIPS warranty.

Owner Confirmation

Your completed Warranty Registration Card serves as verification of ownership in the event of product theft or loss.

Model Registration

Returning your Warranty Registration Card right away guarantees you'll receive all the information and special offers which you qualify for as the owner of your model.

Congratulations on your purchase, and welcome to the "family!"

PHILIPS



Dear PHILIPS product owner:

Thank you for your confidence in PHILIPS. You've selected one of the best-built, best-backed products available today. And we'll do everything in our power to keep you happy with your purchase for many years to come.

As a member of the PHILIPS "family," you're entitled to protection by one of the most comprehensive warranties and outstanding service networks in the industry.

What's more, your purchase guarantees you'll receive all the information and special offers for which you qualify, plus easy access to accessories from our convenient home shopping network.

And most importantly you can count on our uncompromising commitment to your total satisfaction.

All of this is our way of saying welcome—and thanks for investing in a PHILIPS product.

Sincerely,

Lawrence J. Blanford
President and Chief Executive Officer

P.S. Remember, to get the most from your PHILIPS product, you must return your Warranty Registration Card within 10 days. So please mail it to us right now!

Know these safety symbols



This "bolt of lightning" indicates uninsulated material within your unit may cause an electrical shock. For the safety of everyone in your household, please do not remove product covering.

The "exclamation point" calls attention to features for which you should read the enclosed literature closely to prevent operating and maintenance problems.

WARNING: TO PREVENT FIRE OR SHOCK HAZARD, DO NOT EXPOSE THIS EQUIPMENT TO RAIN OR MOISTURE.

CAUTION: To prevent electric shock, match wide blade of plug to wide slot, and fully insert.

ATTENTION: Pour éviter les chocs électriques, introduire la lame la plus large de la fiche dans la borne correspondante de la prise et pousser jusqu'au fond.

PHILIPS Visit our World Wide Web Site at <http://www.philips.com>

IMPORTANT SAFETY INSTRUCTIONS

Read before operating equipment

1. Read these instructions.
2. Keep these instructions.
3. Heed all warnings.
4. Follow all instructions.
5. Do not use this apparatus near water.
6. Clean only with a dry cloth.
7. Do not block any of the ventilation openings. Install in accordance with the manufacturers instructions.
8. Do not install near any heat sources such as radiators, heat registers, stoves, or other apparatus (including amplifiers) that produce heat.
9. Do not defeat the safety purpose of the polarized or grounding-type plug. A polarized plug has two blades with one wider than the other. A grounding type plug has two blades and third grounding prong. The wide blade or third prong are provided for your safety. When the provided plug does not fit into your outlet, consult an electrician for replacement of the obsolete outlet.
10. Protect the power cord from being walked on or pinched particularly at plugs, convenience receptacles, and the point where they exit from the apparatus.
11. Only use attachments/accessories specified by the manufacturer.
12.  Use only with a cart, stand, tripod, bracket, or table specified by the manufacturer, or sold with the apparatus. When a cart is used, use caution when moving the cart/apparatus combination to avoid injury from tip-over.
13. Unplug this apparatus during lightning storms or when unused for long periods of time.
14. Refer all servicing to qualified service personnel. Servicing is required when the apparatus has been damaged in any way, such as power-supply cord or plug is damaged, liquid has been spilled or objects have fallen into apparatus, the apparatus has been exposed to rain or moisture, does not operate normally, or has been dropped.
15. This product may contain lead and mercury. Disposal of these materials may be regulated due to environmental considerations. For disposal or recycling information, please contact your local authorities or the Electronic Industries Alliance: www.eiae.org
16. **Damage Requiring Service** - The appliance should be serviced by qualified service personnel when:
 - A. The power supply cord or the plug has been damaged; or
 - B. Objects have fallen, or liquid has been spilled into the appliance; or
 - C. The appliance has been exposed to rain; or
 - D. The appliance does not appear to operate normally or exhibits a marked change in performance; or
 - E. The appliance has been dropped, or the enclosure damaged.
17. **Tilt/Stability** - All televisions must comply with recommended international global safety standards for tilt and stability properties of its cabinet design.
 - Do not compromise these design standards by applying excessive pull force to the front, or top, of the cabinet which could ultimately overturn the product.
 - Also, do not endanger yourself, or children, by placing electronic equipment/toys on the top of the cabinet. Such items could unsuspectingly fall from the top of the set and cause product damage and/or personal injury.
18. **Wall or Ceiling Mounting** - The appliance should be mounted to a wall or ceiling only as recommended by the manufacturer.
19. **Power Lines** - An outdoor antenna should be located away from power lines.
20. **Outdoor Antenna Grounding** - If an outside antenna is connected to the receiver, be sure the antenna system is grounded so as to provide some protection against voltage surges and built up static charges.

Section 810 of the National Electric Code, ANSI/NFPA No. 70-1984, provides information with respect to proper grounding of the mast and supporting structure, grounding of the lead-in wire to an antenna discharge unit, size of grounding connectors, location of antenna-discharge unit, connection to grounding electrodes, and requirements for the grounding electrode. See Figure below.
21. **Object and Liquid Entry** - Care should be taken so that objects do not fall and liquids are not spilled into the enclosure through openings.
22. **Battery Usage CAUTION** - To prevent battery leakage that may result in bodily injury, property damage, or damage to the unit:
 - Install all batteries correctly, with + and - aligned as marked on the unit.
 - Do not mix batteries (old and new or carbon and alkaline, etc.).
 - Remove batteries when the unit is not used for a long time.

Note to the CATV system installer: This reminder is provided to call the CATV system installer's attention to Article 820-40 of the NEC that provides guidelines for proper grounding and, in particular, specifies that the cable ground shall be connected to the grounding system of the building, as close to the point of cable entry as practical.

Example of Antenna Grounding as per NEC - National Electric Code

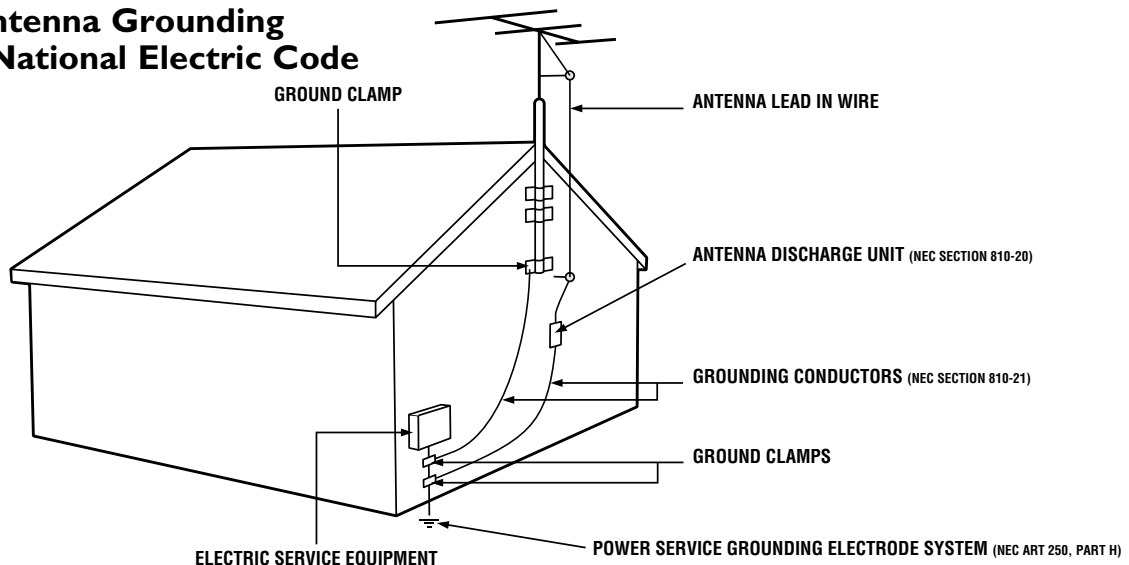

CONTENTS

Introduction

Welcome/Registration of Your TV	2
Safety Instructions	3
Table of Contents	4



Install Menu

How to use the Language Control	5
How to use the Tuner Mode Control	6
How to Auto Program TV Channels	7
How to Add or Delete Channels	8



Picture Menu

How to use the Picture Adjustment Controls	9
--	---



Sound Menu

How to Use the Sound Adjustment Controls	10
--	----



Features Menu

Using the Format (Expand 4:3) Control	11
Understanding the AutoLock™ Controls	12
Setting up the AutoLock™ Access Code	13
How to Block Channels	14
How to Clear All Blocked Channels at the Same Time	15
How to Block All Channels at the Same Time	16
Blocking Programming Based on Movie Ratings	17
Blocking Programming Based on TV Ratings	18
Other AutoLock™ Blocking Options	19
How to Use the Active Control	20



Remote Control Use

Setting the Sleptimer Control	21
How to use the Closed Captioning Control	22
Setting the AutoPicture™ Control	23
Setting the AutoSound™ Control	24
Using the QuadraSurf™ Buttons (Alternate Channel)	25-26
Remote Use with Accessory Devices (Direct Method)	27
Remote Use with Accessory Devices (Code Entry)	28
Remote Use with Accessory Devices (Search Method)	29
Remote Code Entry List	30-32
Remote VCR Related Buttons	33



General Information

Troubleshooting Tips	34
Cleaning and Care	35
Glossary of Terms	36
Index	37
Warranty	38

NOTE: It is possible that this owner's manual may be used with several different television models. Not all features (and drawings) discussed in this manual will necessarily match those found with your television system. This is normal and does not require you contacting your dealer or requesting service.

Here are a few of the features built into your new Television:

QuadraSurf™ A remote control feature that allows you to store and view up to ten of your favorite channels per button (4 buttons - 40 channels total). Can be set to hold movie, sports, news channels, etc., or add the audio/video channels for a quick source function to swap between your external accessory devices.

Active Control™ continuously measures and corrects all incoming signals to help provide the best picture quality. This feature monitors and corrects both the sharpness control and noise reduction control.

AutoLock™ feature allows you to block the viewing of certain channels or external audio/video connections where you might not want your children viewing inappropriate material.

Infrared Remote Control works your TV set and some accessory devices which allows programming certain features with the press of one button.

Standard broadcast (VHF/UHF) or Cable TV (CATV) channel capability with stereo sound.

Closed Captioning allows the viewer to read TV program dialogue or voice conversations as on-screen text.

Automatic Programming of Channels for quick and easy selection of favorite stations available in your area.

On-screen Features (in either English or Spanish) show helpful messages for setting of TV controls.

Audio/Video Jackpanel located on the back and side of the television for direct connections when using audio/video accessory devices. these Jacks can provide improved quality TV picture and sound playback.

Expand 4:3 will allow you to expand the "letterbox" image produced by certain DVD players to fill the entire TV screen.

Sleptimer automatically turns the TV OFF at preset times.

AutoPicture™ allows you to set the picture color, tint, contrast, etc. for various types of programming such as Sports, Movies, Personal, Weak Signals or Multi Media with the push of one button.

AutoSound™ controls allow you to set the sound controls for various types of listening programs such as Personal (sound controls the way you set them), Theater, Music, or Voice with the push of one button.

Treble Boost, Bass Boost, and Balance controls to enhance the television's sound.

END-OF-LIFE DISPOSAL

Your new television and its packing contain materials that can be recycled and reused. Specialized companies can recycle your product to increase the amount of reusable materials and minimize the amounts that need to be properly disposed.

Your product also uses batteries that should not be thrown away when depleted, but should be handed in and disposed of as small chemical waste.

When you replace your existing equipment, please find out about the local regulations regarding disposal of your old television, batteries, and packing materials.

Auto Lock, Auto Picture, Auto Sound, Active Control, QuadraSurf are all registered trademarks of Philips Consumer Electronics Company.
Copyright © 2002 All rights reserved.

HOW TO USE THE LANGUAGE CONTROL



For our Spanish speaking TV owners an on-screen LANGUAGE option is present. With the LANGUAGE control you can set the TV's on-screen menu to be shown in either English or Spanish.

- 1** Press the **MENU** button on the remote to show the on-screen menu.
- 2** Press the **CURSOR UP** or **DOWN** buttons to scroll through the on-screen menu until the word **INSTALL** is highlighted.
- 3** Press the **CURSOR RIGHT** button to display the **INSTALL** menu features.
- 4** Press **CURSOR UP** or **DOWN** buttons to scroll the Install features until the word **LANGUAGE** is highlighted.
- 5** Press the **CURSOR RIGHT** button repeatedly to select **ENGLISH** or **ESPAÑOL** (Spanish).
- 6** When finished, press the **STATUS** /**EXIT** button to remove the menu from the TV's screen.

HELPFUL HINT

The Language control only makes the TV's on-screen MENU items appear in English or Spanish text.

It does not change the other on-screen text features such as Closed Caption (CC) TV shows.

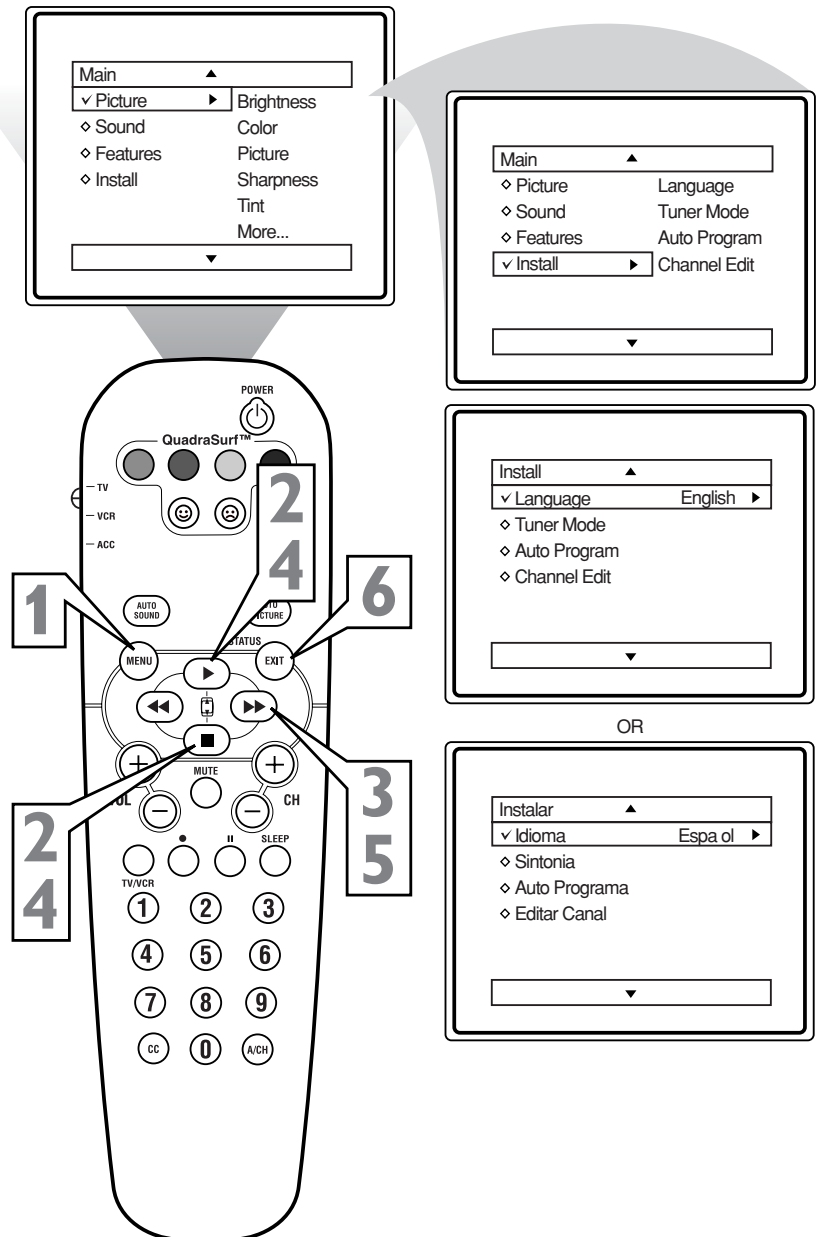



HOW TO USE THE TUNER MODE CONTROL

The **TUNER MODE** control allows you to change the TV's signal input to either **ANTENNA**, **CABLE** or **AUTO** mode. It's important for the TV to know what type of signal to look for. (From a Cable TV signal or a normal Antenna signal.) In the **AUTO** mode, when the **AUTO PROGRAM** feature is activated, the TV will automatically choose the correct mode.

- 1** Press the **MENU** button on the remote to show the on-screen menu.
- 2** Press the **CURSOR UP** or **DOWN** buttons to scroll through the on-screen menu until the word **INSTALL** is highlighted.
- 3** Press the **CURSOR RIGHT** button to display the **INSTALL** menu features.
- 4** Press **CURSOR UP** or **DOWN** buttons to scroll the Install features until the words **TUNER MODE** is highlighted.
- 5** Press the **CURSOR RIGHT** button to select either **ANTENNA**, **CABLE**, or **AUTO** mode.
- 6** When finished, press the **STATUS** /**EXIT** button to remove the on-screen menu from the TV's screen.

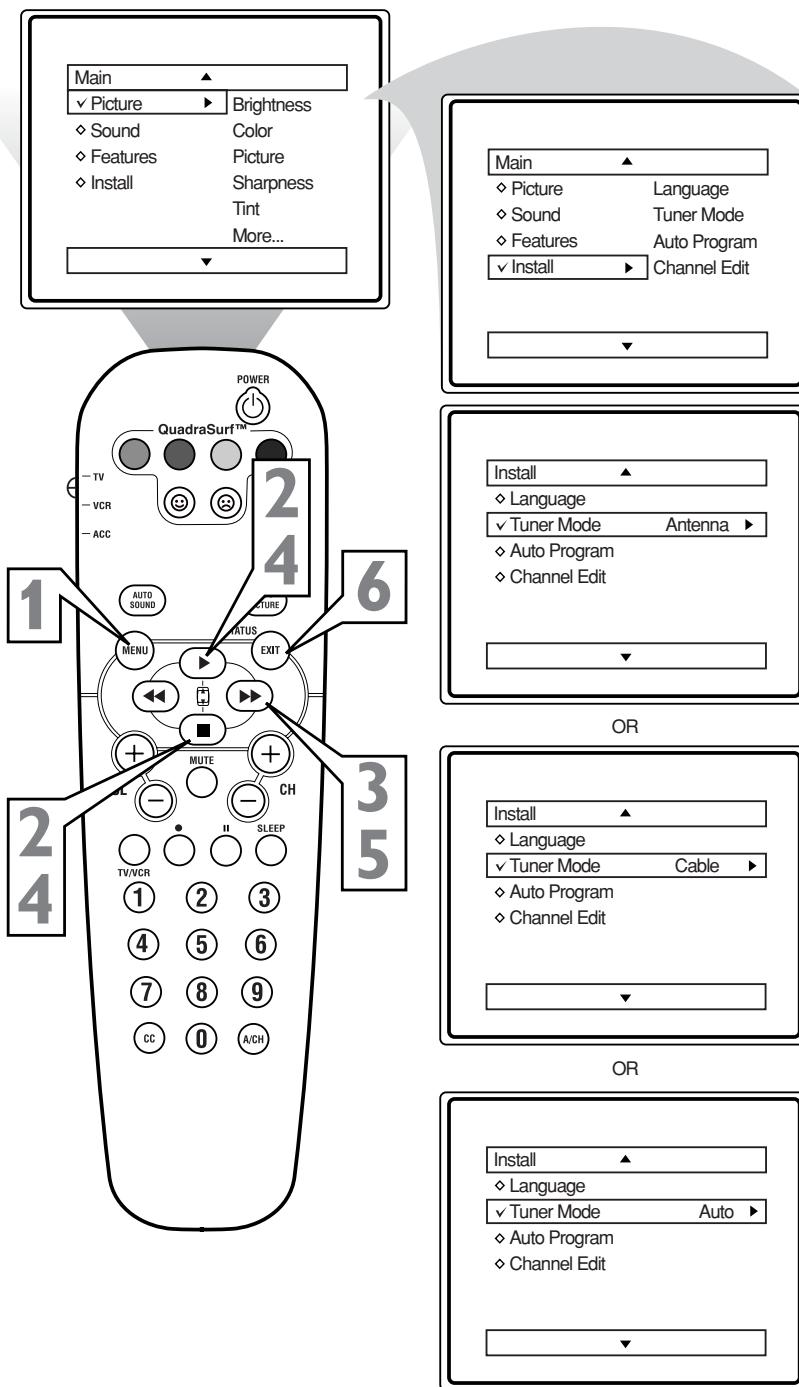

HELPFUL HINT

When **CABLE** is selected, channels 1-125 are available.

When **ANTENNA** is selected, channels 2-69 are available.

When **AUTO** is selected, the TV will automatically set itself to the correct mode based on the type of signal it detects when the **AUTO PROGRAM** feature is activated.

HOW TO AUTOMATICALLY PROGRAM CHANNELS



Your TV can automatically set itself for local area (or Cable TV) channels. This makes it easy for you to select only the TV stations in your area when the CHANNEL (+), (-) buttons are pressed.

Note: Make sure the antenna or cable signal connection has been completed before AUTO PROGRAM is activated.

- 1** Press the **MENU** button on the remote to show the on-screen menu.
- 2** Press the **CURSOR UP** or **DOWN** buttons to scroll through the on-screen menu until the word **INSTALL** is highlighted.
- 3** Press the **CURSOR RIGHT** button to display the **INSTALL** menu features.
- 4** Press **CURSOR UP** or **DOWN** buttons to scroll the Install features until the words **AUTO PROGRAM** are highlighted.
- 5** Press the **CURSOR RIGHT** button to start the Auto Program scanning of channels. Auto Programming will store all available channels in the TV's memory then tune to the lowest available channel when done.
- 6** When finished, press the **STATUS /EXIT** button to remove the menu from the TV's screen.

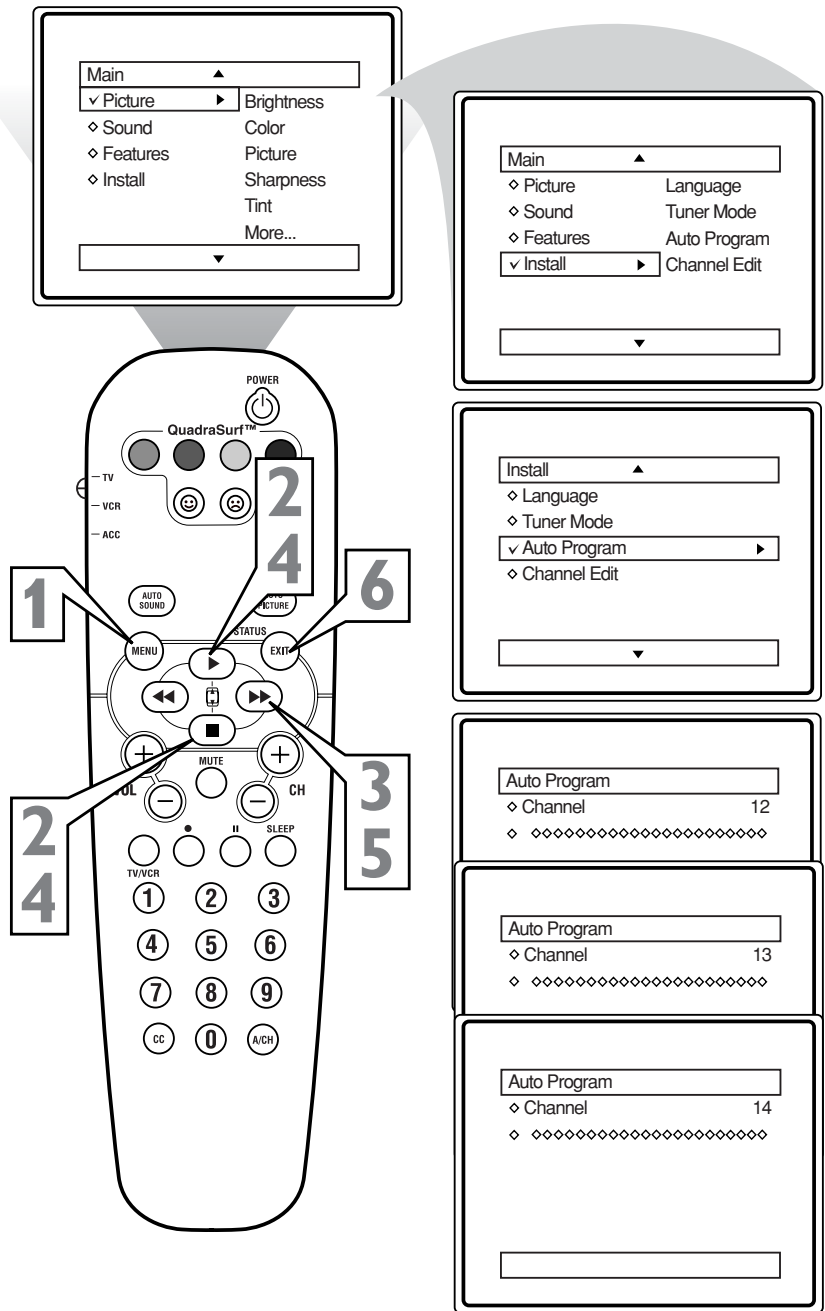

HELPFUL HINT

When CABLE is selected, channels 1-125 are available.
 When ANTENNA is selected, channels 2-69 are available.
 When AUTO is selected, the TV will automatically set itself to the correct mode based on the type of signal it detects when the AUTO PROGRAM feature is activated.



HOW TO ADD OR DELETE CHANNELS

Channel Edit makes it easy for you to ADD or DELETE channels from the list of channels stored in the TV's memory.

- 1** Press the **MENU** button on the remote to show the on-screen menu.
- 2** Press the **CURSOR UP** or **DOWN** buttons to scroll through the on-screen menu until the word **INSTALL** is highlighted.
- 3** Press the **CURSOR RIGHT** button to display the **INSTALL** menu features.
- 4** Press the **CURSOR UP** or **DOWN** buttons to scroll the Install features until the words **CHANNEL EDIT** are highlighted.
- 5** Press the **CURSOR RIGHT** button to display the **CHANNEL EDIT** options.
- 6** With the **CHANNEL EDIT** options displayed, and **CHANNEL NO.** highlighted; enter the channel number (with the **NUMBERED** or the **CH +** or **-** buttons) you wish to add (Skipped OFF), or delete (Skipped ON) from the TV's memory.
- 7** Using the **CURSOR DOWN** button, scroll the menu to highlight the word **SKIPPED**.
- 8** Now use the **CURSOR RIGHT** button to toggle between **ON** or **OFF**. If **ON** is selected the channel is skipped when scrolling channels with the **CH +** or **-** buttons. If **OFF** is selected the channel is not skipped when scrolling channels with the **CH +** or **-** buttons.
- 9** When finished, press the **STATUS /EXIT** button to remove the menu from the TV's screen.

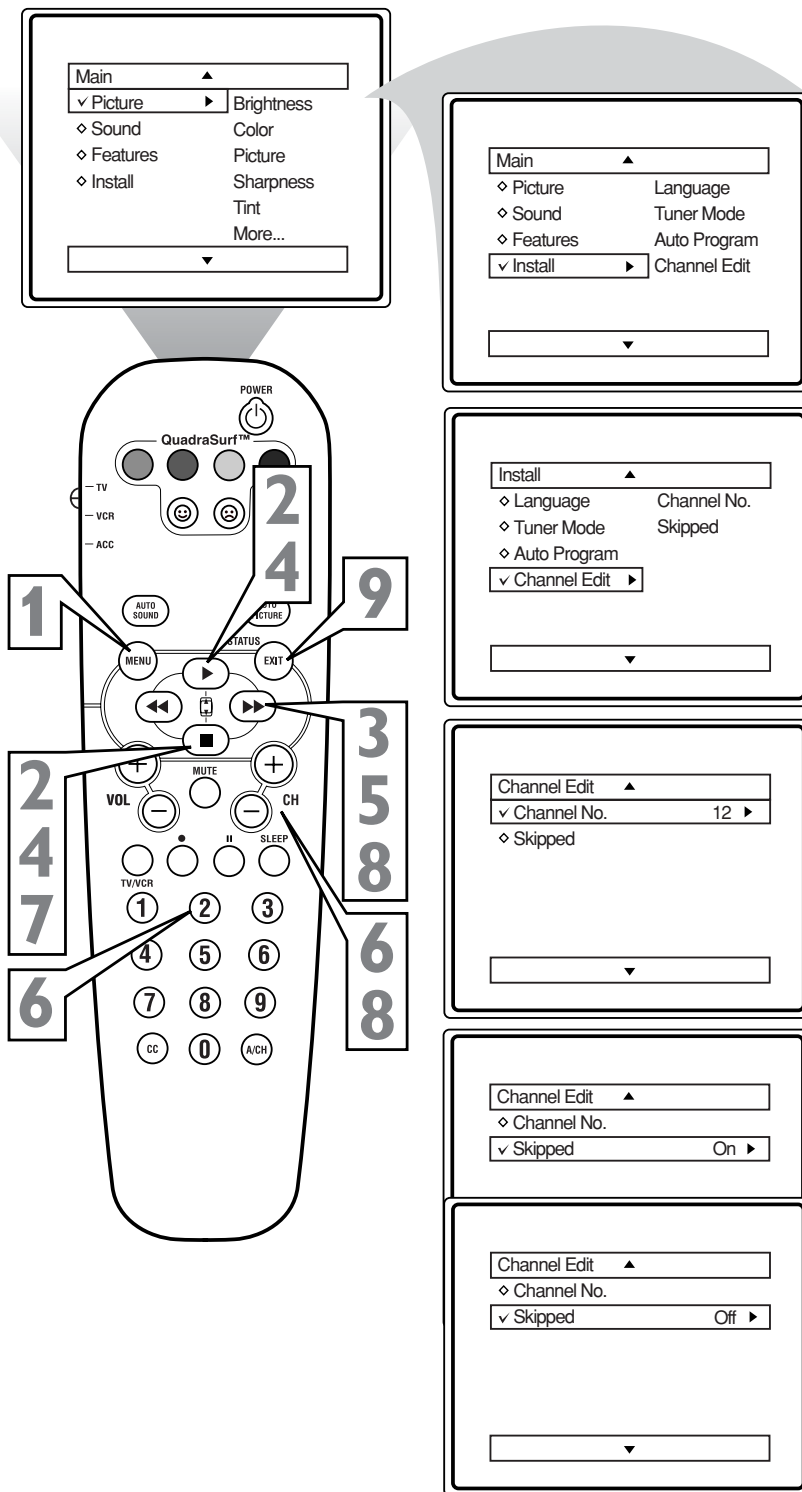

HOW TO USE THE PICTURE ADJUSTMENT CONTROLS



To adjust your TV picture controls, select a channel and follow the steps shown below:

- 1** Press the **MENU** button on the remote to display the on-screen menu.
- 2** Press the **CURSOR UP** or **DOWN** buttons until the word **PICTURE** is highlighted.
- 3** Press the **CURSOR RIGHT** button to display the **PICTURE** menu features.
- 4** Press **CURSOR UP** or **DOWN** buttons to scroll the Picture features and highlight the control you wish to adjust (Brightness, Color, Picture, Sharpness, Tint, Color Temp., DNR, or Contrast +).
- 5** Press the **CURSOR RIGHT** or the **CURSOR LEFT** buttons to adjust the selected control or to make selections for the chosen control.
- 6** Press the **CURSOR UP** or **DOWN** buttons to select and adjust other Picture Menu controls.
- 7** When finished, press the **STATUS /EXIT** button to remove the menu from the TV's screen.

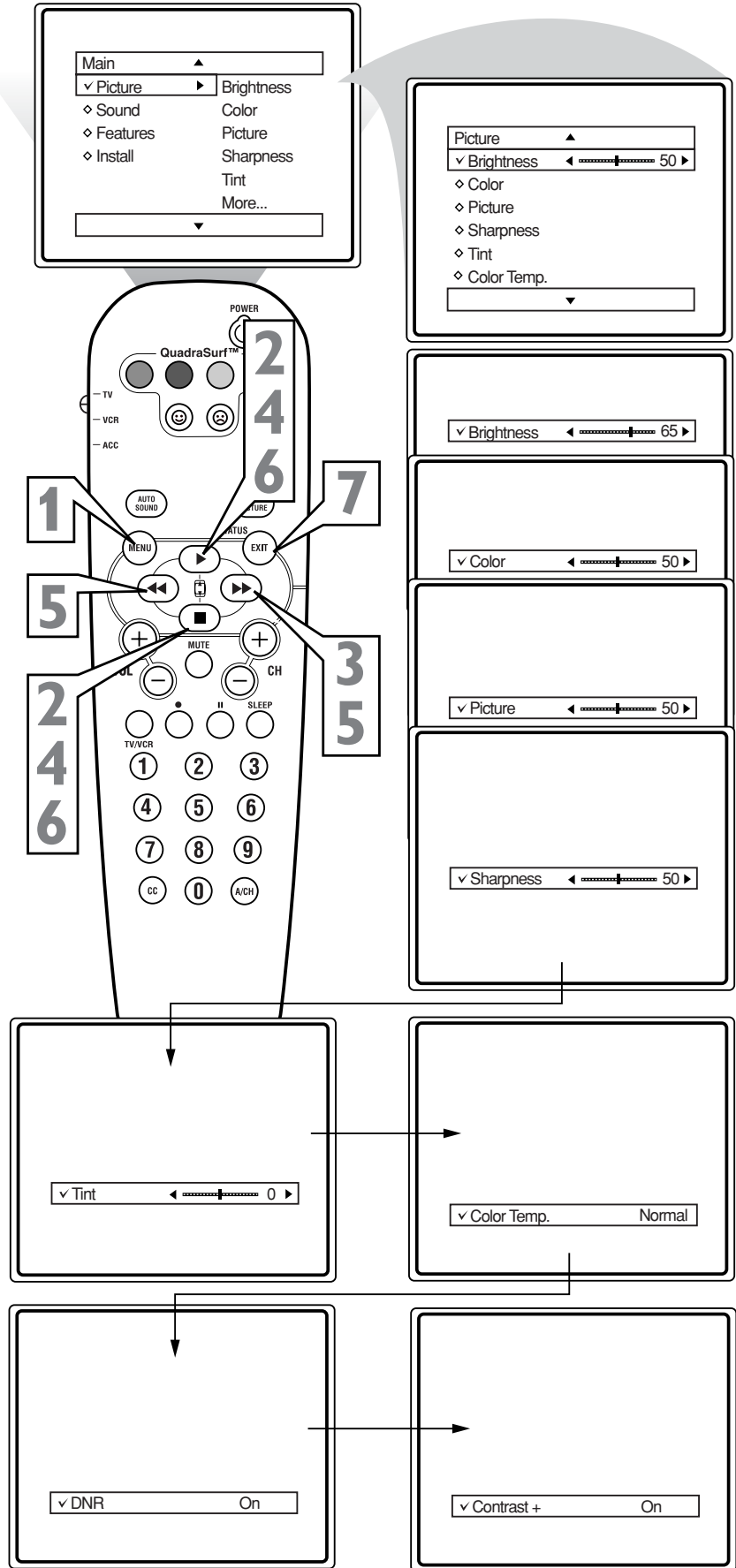

HELPFUL HINT

BRIGHTNESS: Press the **▶▶** or **◀◀** buttons until darkest parts of the picture are as bright as you prefer.

COLOR: Press the **▶▶** or **◀◀** buttons to add or eliminate color.

PICTURE: Press the **▶▶** or **◀◀** buttons until lightest parts of the picture show good detail.

SHARPNESS: Press the **▶▶** or **◀◀** buttons to improve detail in the picture.

TINT: Press the **▶▶** or **◀◀** buttons to obtain natural skin tones.

COLOR TEMP: Press the **▶▶** or **◀◀** buttons to select **NORMAL**, **COOL**, or **WARM** picture preferences. (**NORMAL** will keep the whites, white; **COOL** will make the whites, bluish; and **WARM** will make the whites, reddish.)

DNR: Press the **▶▶** or **◀◀** buttons to turn **DNR ON** or **OFF**. Dynamic Noise Reduction helps to eliminate “noise” from the picture.

Contrast +: Press the **▶▶** or **◀◀** buttons to turn **Contrast + ON** or **OFF**. When **ON**, this control will optimize the picture contrast for improved picture clarity.



HOW TO USE THE SOUND ADJUSTMENT CONTROLS

Besides the normal volume level control, your TV also has Treble, Bass, Balance, AVL (automatic volume leveler), Incredible Surround, Ultra Bass, and Sound (Stereo/Mono) controls.

- 1** Press the **MENU** button on the remote to display the on-screen menu.
- 2** Press the **CURSOR UP** or **CURSOR DOWN** button until the word **SOUND** is highlighted.
- 3** Press the **CURSOR RIGHT** button to display the **SOUND** menu features.
- 4** Press the **CURSOR UP** or **CURSOR DOWN** button to scroll the Sound menu features until the control you wish to change is highlighted (**Treble**, **Bass**, **Balance**, **AVL**, **Incr. Surround**, **Ultra Bass**, **SAP**, or **Sound**).
- 5** Press the **CURSOR RIGHT** or **LEFT** button to turn the adjust or turn the control On or Off.
- 6** When finished, press the **STATUS /EXIT** button to remove the menu from the TV's screen.

HELPFUL HINT

TREBLE: Press the **Cursor Right** or **Left** buttons to adjust the control. The control will enhance the high frequency sounds.

BASS: Press the **Cursor Right** or **Left** buttons to adjust the control. The control will enhance the low frequency sounds.

BALANCE: Press the **Cursor Right** or **Left** buttons to adjust the level of sound coming from the left and right speakers.

AVL: (Auto Volume Leveler) Press the **Cursor Right** or **Left** buttons to turn the control On or Off. When On, AVL will level out the sound being heard when sudden changes in volume occur during commercial breaks or channel changes.

INCR. SURROUND: Press the **Cursor Right** or **Left** buttons to select between Incr. Surround or Stereo settings (If Stereo), or select Spatial or Mono (If Mono).

ULTRA BASS: Press the **Cursor Right** or **Left** buttons to turn Ultra Bass On or Off. Ultra Bass will enhance the low frequency sound.

SAP: Press the **Cursor Right** of **Left** buttons to turn SAP (Secondary Audio Program) On or Off. If the channel tuned is not broadcasting a SAP signal, "Not Available" will appear as the option when On is selected.

SOUND: Press the **Cursor Right** or **Left** buttons to select between Stereo or Mono settings. Note: If Stereo is not present on a selected show and the TV is placed in the Stereo mode, the sound coming from the TV will remain in the Mono mode.

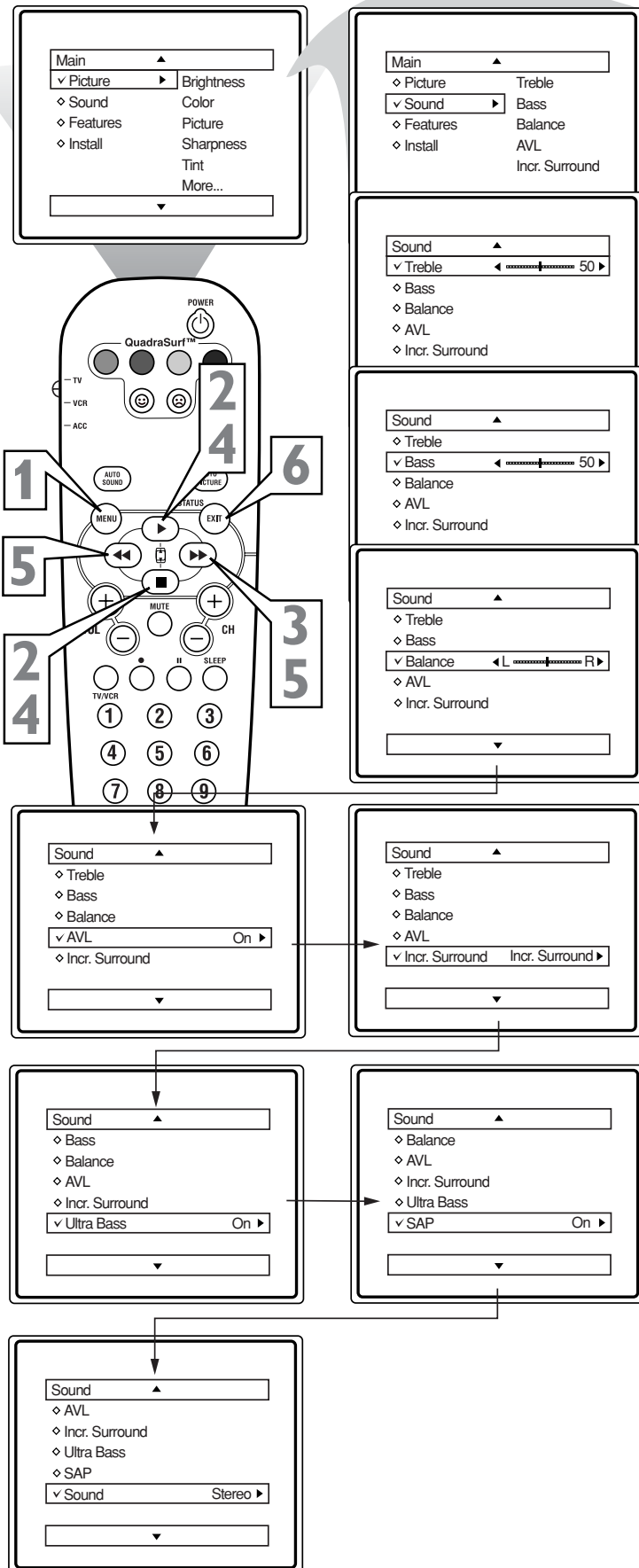

HOW TO USE THE FORMAT CONTROL (EXPAND 4:3)



Many times while watching movies from a DVD player the image is shown in “letter box” format. This is the format that is shown in movie theaters. When shown on a TV screen, the image will have areas of black on top and bottom of the screen. The **FORMAT Control** can help to display the image as close as possible to its original aspect ratio.

- 1** Press the **MENU** button on the remote to display the on-screen menu.
- 2** Press the **CURSOR DOWN ▼** button until the word **FEATURES** is highlighted.
- 3** Press the **CURSOR RIGHT ►** button to display the **FEATURES** menu options (AutoLock or Format).
- 4** Press the **CURSOR DOWN ▼** button until the word **FORMAT** is highlighted.
- 5** Press the **CURSOR RIGHT ►** or **CURSOR LEFT ◀** buttons to select one of the two options 4:3 or Expand 4:3.
 - 4:3** - Standard format for the TV.
 - Expand 4:3** - Enlarges the picture to fill out the entire screen area, eliminating the “letter box” effect.
- 6** When finished, press the **STATUS /EXIT** button to remove the menu from the TV’s screen.

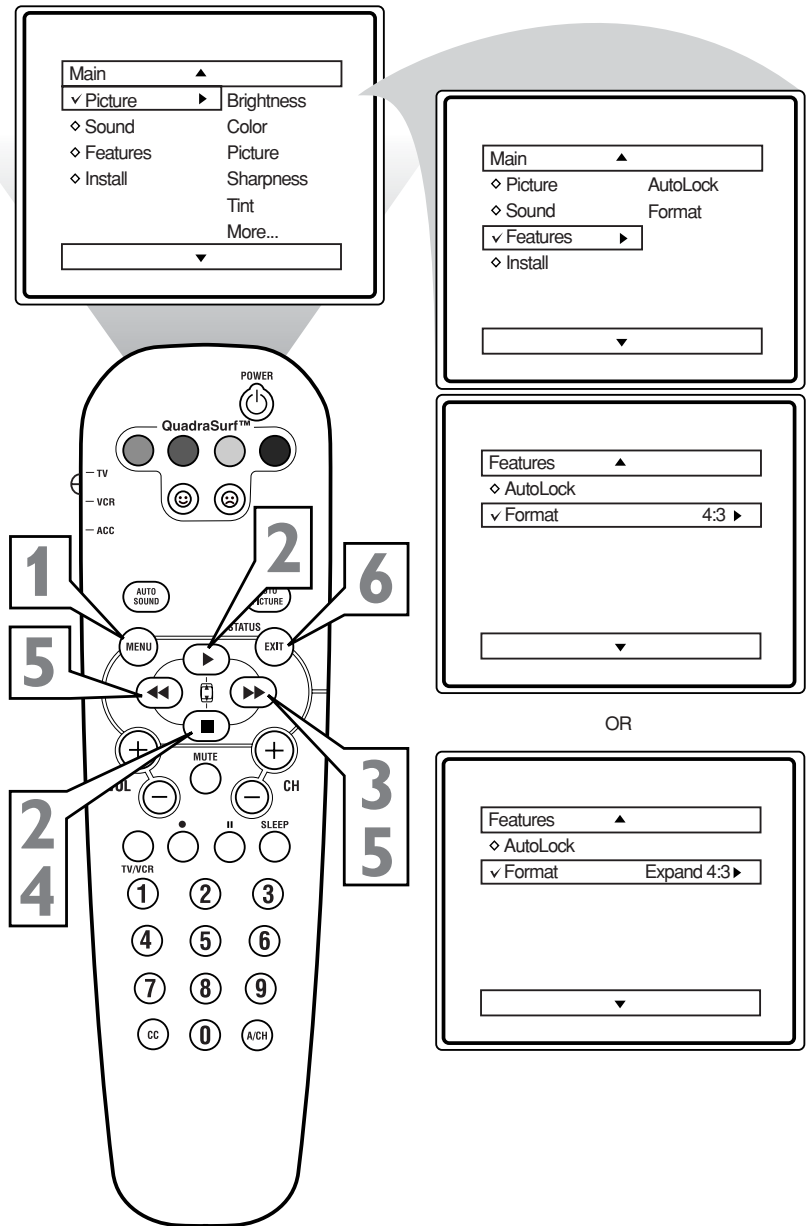

4:3



Expand 4:3



UNDERSTANDING THE AUTOLOCK™ CONTROLS

The AutoLock™ feature is an integrated circuit that receives and processes data sent by broadcasters, or other program providers, that contain program content advisories. When programmed by the viewer, a TV with AutoLock™ can respond to the content advisories and block program content that may be found objectionable (such as offensive language, violence, sexual situations, etc.). This is a great feature to censor the type of viewing children may watch.

Over the next few pages you'll learn how to block channels and certain rated programming. Below is a brief explanation of some terms and ratings you will find in the AutoLock feature.

AutoLock™ offers various BLOCKING controls from which to choose:

Access Code: An Access Code must be set to prevent children from unblocking questionable programming.

Channel Block: Individual channels including the A/V inputs can be blocked.

Clear All: Allows you clear all channels being blocked from your viewing set with the Channel Block Control.

Block All: Allows you to block ALL channels and A/V inputs at one time.

Movie Ratings: Block programming based on ratings patterned by the Motion Pictures Association of America.

TV Ratings: Block programming based on standard TV ratings set by TV broadcasters.

To learn more about the Motion Picture Ratings and the TV Ratings, refer to the definitions listed on the columns to the right.

Press the STATUS/EXIT button twice to display the AutoLock review screen.

This screen shows what is activated within the AutoLock settings.

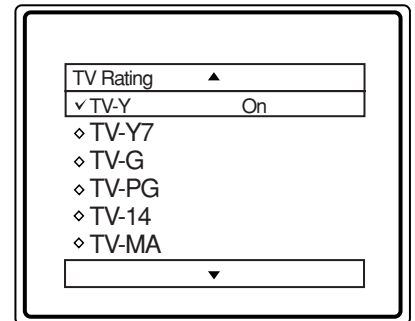
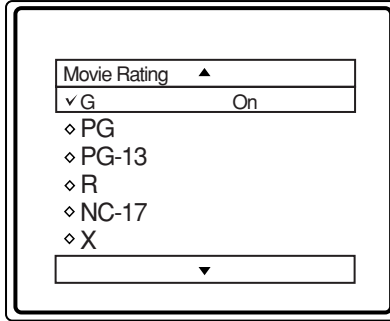
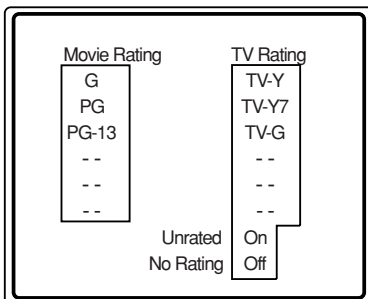

MOVIE RATINGS (MOTION PICTURE ASSOCIATION OF AMERICA)

G: General Audience - All ages admitted. Most parents would find this program suitable for all ages. This type of programming contains little or no violence, no strong language, and little or no sexual dialogue or situations.

PG: Parental Guidance Suggested - This programming contains material that parents may find unsuitable for younger children.) It may contain one or more of the following: Moderate violence, some sexual situations, infrequent coarse language, or some suggestive dialogue.

PG-13: Parents Strongly Cautioned - This programming contains material that parents may find unsuitable for children under the age of 13. It contains one or more of the following: violence, sexual situations, coarse language, or suggestive dialogue.

R: Restricted - This is programming is specifically designed for adults. Anyone under the age of 17 should only view this programming with an accompanying parent or adult guardian. It contains one or more of the following: intense violence, intense sexual situations, strong coarse language, or intensely suggestive dialogue.

NC-17: No one under the age of 17 will be admitted. - This type of programming should be viewed by adults only. It contains graphic violence, explicit sex, or crude indecent language.

X: Adults Only - This type of programming contains one or more of the following: very graphic violence, very graphic and explicit or indecent sexual acts, very coarse and intensely suggestive language.

TV PARENTAL GUIDELINES (TV BROADCASTERS)

TV Y **TV-Y** - (All children -- This program is designed to be appropriate for all children.) Designed for a very young audience, including children ages 2-6. This type of programming is not expected to frighten younger children.

TV Y7 **TV-Y7** - (Directed to Older Children -- This program is designed for children age 7 and above.) It may be more appropriate for children who have acquired the development skills needed to distinguish between make-believe and reality. This programming may include mild fantasy and comic violence (FV).

TV G **TV-G** - (General Audience -- Most parents would find this program suitable for all ages.) This type of programming contains little or no violence, no strong language, and little or no sexual dialogue or situations.

TV PG **TV-PG** - (Parental Guidance Suggested -- This program contains material that parents may find unsuitable for younger children.) This type of programming contains one or more of the following: Moderate violence (V), some sexual situations (S), infrequent coarse language (L), or some suggestive dialogue (D).

TV 14 **TV-14** - (Parents Strongly Cautioned -- This program contains some material that many parents would find unsuitable for children under 14 years of age.) This type of programming contains one or more of the following: intense violence (V), intense sexual situations (S), strong coarse language (L), or intensely suggestive dialogue (D).

TV MA **TV-MA** - (Mature Audience Only -- This program is specifically designed to be viewed by adults and therefore may be unsuitable for children under 17.) This type of programming contains one or more of the following: graphic violence (V), explicit sexual situations (S), or crude indecent language (L).

SETTING UP AN AUTOLOCK™ ACCESS CODE



Over the next few pages you'll learn how to block channels and get a better understanding of the rating terms for certain programming.

First, let's start by learning how to set a personal access code:

- 1** Press the **MENU** button on the remote to display the on-screen menu.
- 2** Press the **CURSOR UP** or **DOWN** button until the word **FEATURES** is highlighted.
- 3** Press the **CURSOR RIGHT** button to display the **FEATURES** menu options.
- 4** Press the **CURSOR UP** or **DOWN** button until the words **AUTOLOCK** are highlighted.
- 5** Press the **CURSOR RIGHT** button. The screen will read, "ACCESS CODE - - - -."
- 6** Using the **NUMBERED** buttons, enter **0, 7, 1, 1**. "XXXX" appears on the Access Code screen as you press the numbered buttons.
"INCORRECT CODE" will appear on the screen, and you will need to enter **0, 7, 1, 1** again.
- 7** The screen will ask you to enter a "New Code." Enter a "new" 4 digit code using the **NUMBERED** buttons. The screen will then ask you to **CONFIRM** the code you just entered. Enter your new code again. "XXXX" will appear when you enter your new code and then display the AutoLock menu options.

Proceed to the next page to learn more...

HELPFUL HINT

Parents - it isn't possible for your child to unblock a channel without knowing your access code or changing it to a new one. If your code changes, and you didn't change it, then you know it's been altered by someone else and blocked channels have been viewed.

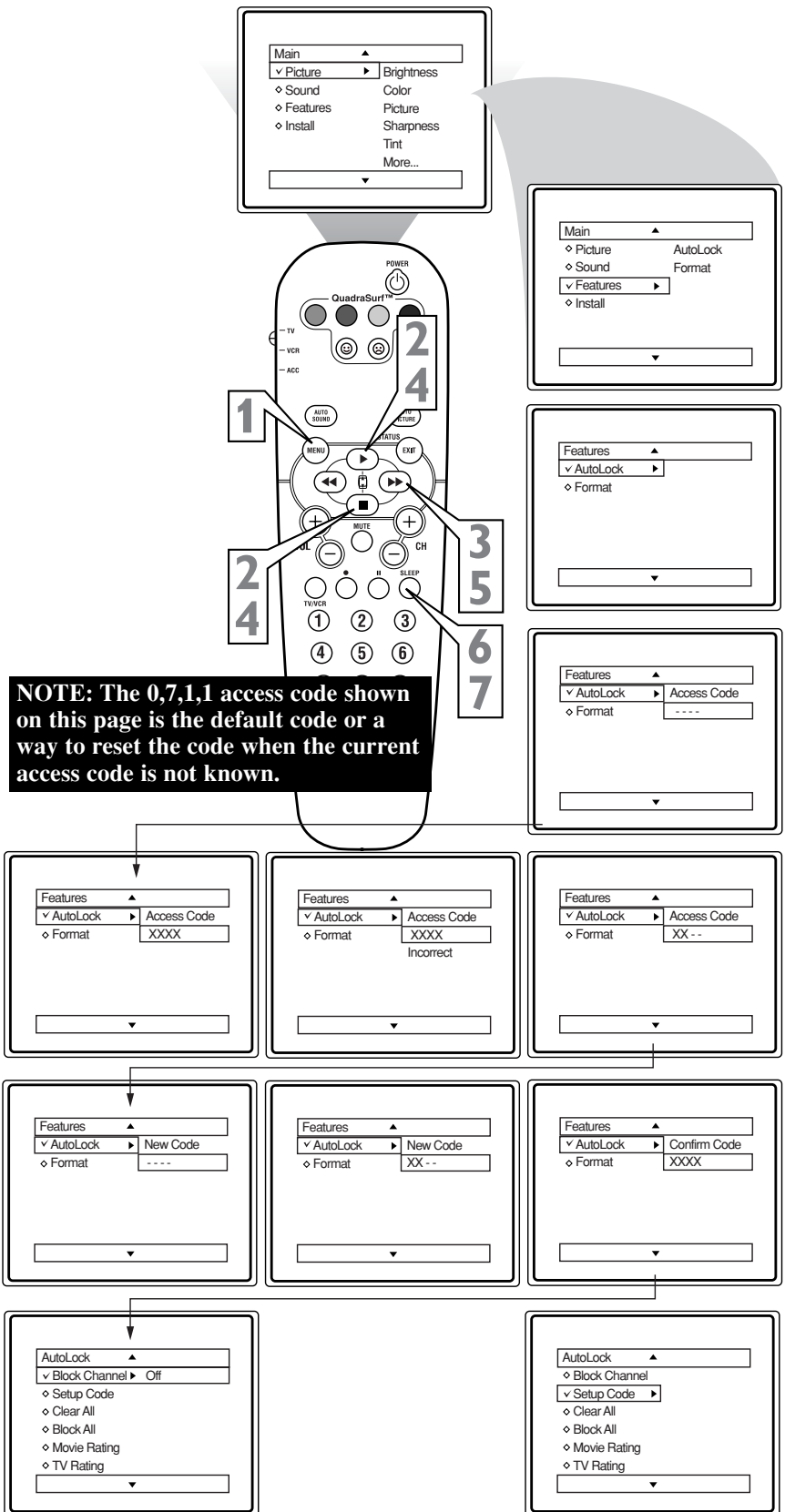



HOW TO BLOCK CHANNELS

After your personal access code has been set (see previous page), you are now ready to select the channels you want to block out or censor.

- 1** Press the **NUMBERED (or CH +, -) buttons** to tune the channel you wish to block or censor.
- 2** Press the **MENU button** on the remote to show the on-screen menu.
- 3** Press the **CURSOR UP ► or DOWN ■ button** until the word **FEATURES** is highlighted.
- 4** Press the **CURSOR RIGHT ►► button** to display the **FEATURES** menu options.
- 5** Press the **CURSOR UP ► or DOWN ■ button** until the words **AutoLock** are highlighted.
- 6** Press the **CURSOR RIGHT ►► button**. "ACCESS CODE" will appear on the screen.
- 7** Enter the correct access code number. "XXXX" shows on the Access Code display as you press the **NUMBERED buttons**. AutoLock menu options will be displayed.
- 8** Press the **CURSOR UP ► or DOWN ■ buttons** until the words **BLOCK CHANNELS** are highlighted.
- 9** Press the **CURSOR RIGHT ►► button** to turn blocking ON or OFF for that channel. When ON is selected the channel will be blocked.
- 10** Press the **CH + or - button** to select other channels you wish to block. Repeat step 9 to block the new channel.

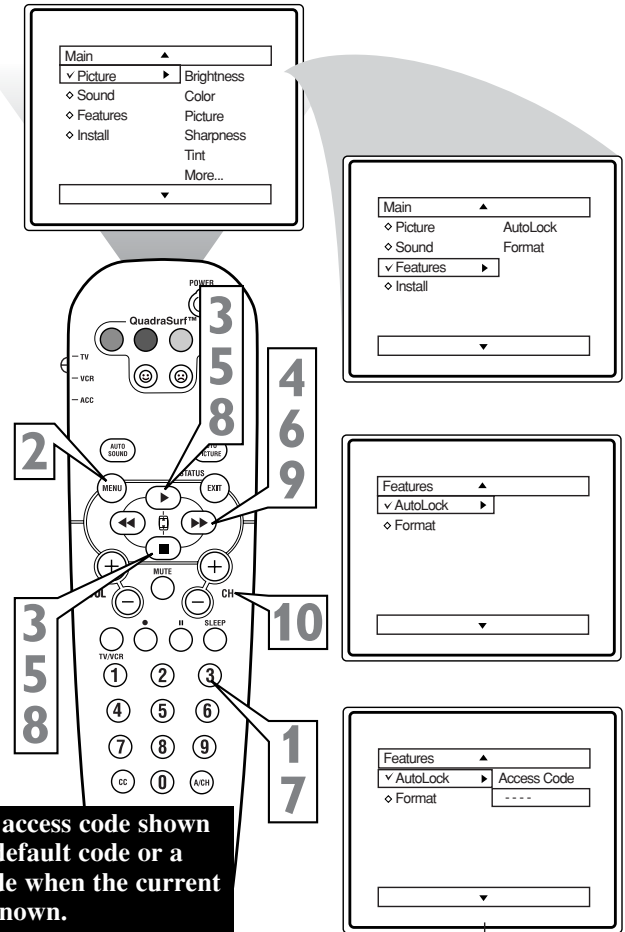

NOTE: The 0,7,1,1 access code shown on this page is the default code or a way to reset the code when the current access code is not known.

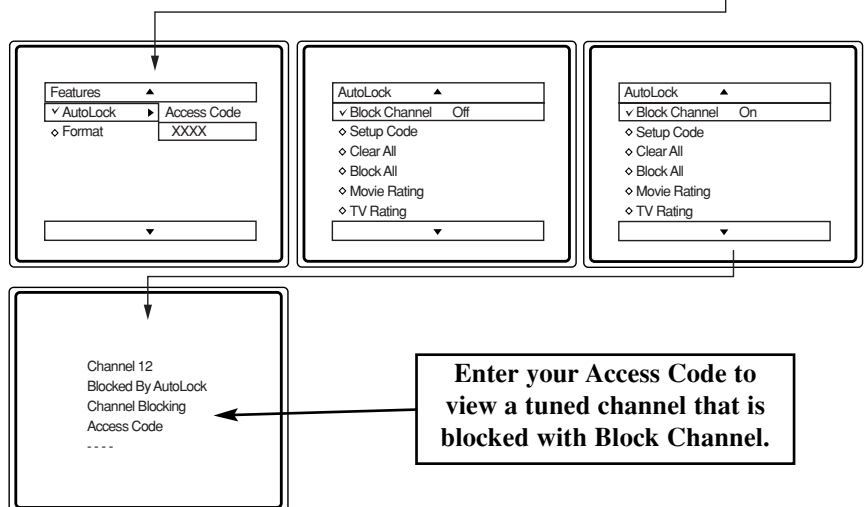

HELPFUL HINT

If you tune to a blocked channel and enter your Access Code to view the channel, ALL blocked channels will be viewable until the TV has been turned off. When the TV is powered back ON, the previously blocked channels will be blocked again.

HOW TO CLEAR ALL BLOCKED CHANNELS AT THE SAME TIME



After blocking specific channels there may come a time when you want to clear all the channels so they can be viewed. The following steps explain how to CLEAR ALL blocked channels.

- 1** Press the **MENU** button on the remote to show the on-screen menu.
- 2** Press the **CURSOR UP** or **DOWN** button until the word **FEATURES** is highlighted.
- 3** Press the **CURSOR RIGHT** button to display the **FEATURES** menu options.
- 4** Press the **CURSOR UP** or **DOWN** button until the words **AutoLock** are highlighted.
- 5** Press the **CURSOR RIGHT** button.
- 6** Enter the correct access code number. "XXXX" shows on the Access Code display as you press the **NUMBERED** buttons. AutoLock menu options will be displayed.
- 7** Press the **CURSOR UP** or **DOWN** button until the words **CLEAR ALL** are highlighted.
- 8** Press the **CURSOR RIGHT** button to clear all blocked channels. The Clear All option will read, "Cleared."
- 9** When finished, press the **STATUS /EXIT** button to remove the menu from the TV's screen.

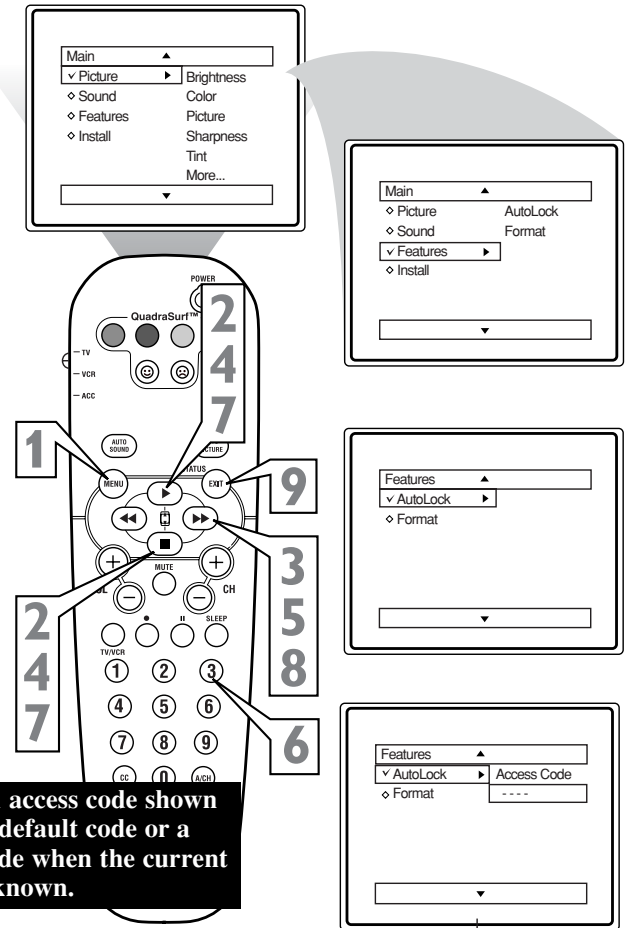

NOTE: The 0,7,1,1 access code shown on this page is the default code or a way to reset the code when the current access code is not known.

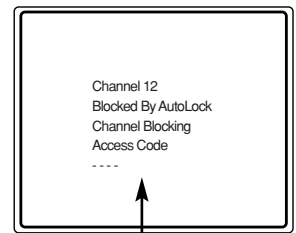
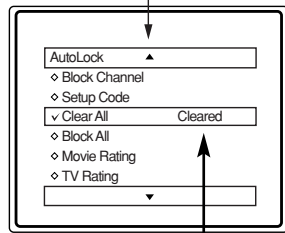
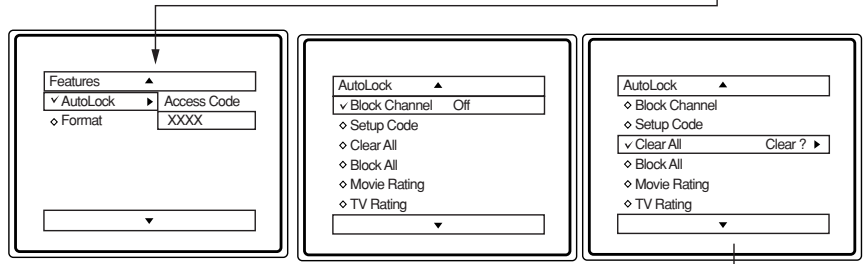

The Clear All option when activated will unblock ALL blocked channels. It will not affect programming blocked by the Movie or TV Rating options.

Or, enter your Access Code to view a tuned channel that is blocked with Block Channel.

HELPFUL HINT

If you tune to a blocked channel and enter your Access Code to view the channel, ALL blocked channels will be viewable until the TV is powered OFF and then turned back ON. When the TV is powered back ON, the previously blocked channels will be blocked again.

CLEAR ALL will not work with the Movie and TV Ratings. These options must be reset individually.



How to BLOCK ALL CHANNELS AT THE SAME TIME

There may come a time when you want to Block All the television's channels. Maybe you don't want your children to watch TV for a given time. With the Block All control, ALL available channels (including the A/V Inputs) can be set to block at the same time.

- 1** Press the **MENU** button on the remote to show the on-screen menu.
- 2** Press the **CURSOR UP** or **DOWN** button until the word **FEATURES** is highlighted.
- 3** Press the **CURSOR RIGHT** button to display the **FEATURES** menu options.
- 4** Press the **CURSOR UP** or **DOWN** button until the words **AutoLock** are highlighted.
- 5** Press the **CURSOR RIGHT** button.
- 6** Enter the correct access code number. "XXXX" shows on the Access Code display as you press the **NUMBERED** buttons. AutoLock menu options will be displayed.
- 7** Press the **CURSOR UP** or **DOWN** button until the words **BLOCK ALL** are highlighted.
- 8** Press the **CURSOR RIGHT** button to turn Block All ON or OFF. When ON is selected, ALL available channels will be blocked.
- 9** When finished, press the **STATUS/EXIT** button to remove the menu from the screen.

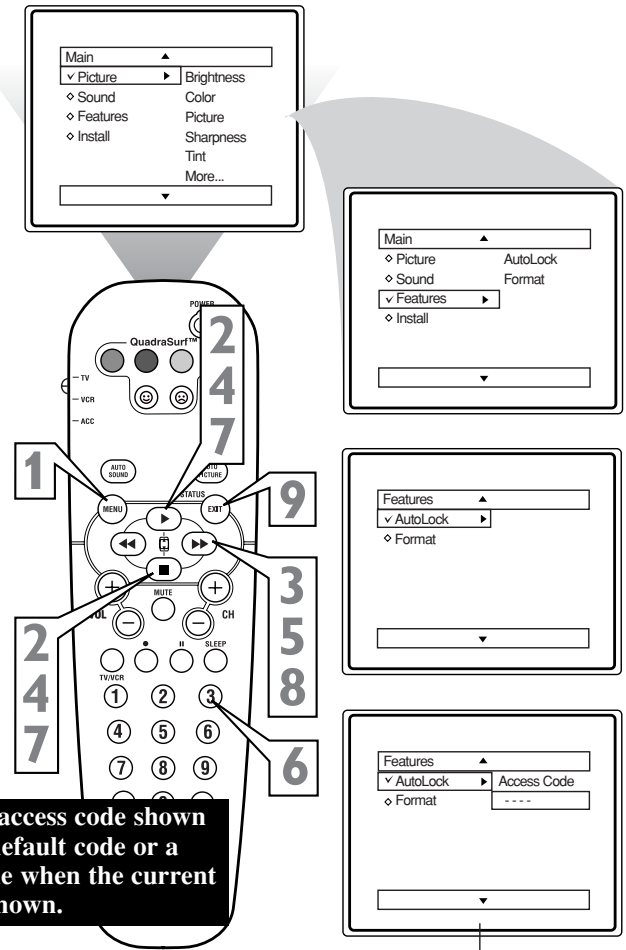

NOTE: The 0,7,1,1 access code shown on this page is the default code or a way to reset the code when the current access code is not known.

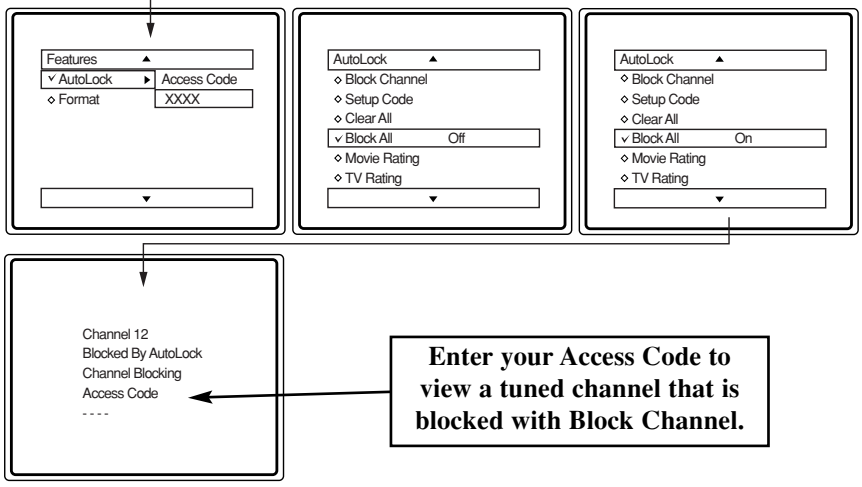

HELPFUL HINT

If you tune to a blocked channel and enter your Access Code to view the channel, ALL blocked channels will be viewable until the TV has been turned off. When the TV is powered back ON, the previously blocked channels will be blocked again.

BLOCKING PROGRAMS BASED ON MOVIE RATINGS



There are two types of program ratings within the AutoLock™ feature. One is based on the Movie Industry ratings while the other is based on the TV Industry ratings. Both can be used to block or censor programming that has been rated in either manner.

Let's first look at the Movie Rating options of AutoLock™:

- 1** Press the **MENU** button on the remote to display the on-screen menu.
- 2** Press the **CURSOR UP** or **DOWN** button until the word **FEATURES** is highlighted.
- 3** Press the **CURSOR RIGHT** button to display the **FEATURES** menu options.
- 4** Press the **CURSOR UP** or **DOWN** button until **AutoLock** is highlighted.
- 5** Press the **CURSOR RIGHT** button. The screen will prompt you for your Access Code.
- 6** Using the **NUMBERED** buttons on the remote, enter your 4 digit Access Code. The AutoLock menu options will be displayed.
- 7** Press the **CURSOR UP** or **DOWN** button to highlight the words **MOVIE RATINGS**.
- 8** Press the **CURSOR RIGHT** button to display the **MOVIE RATINGS** options (G, PG, PG-13, R, NC17, or X).
- 9** Press the **CURSOR UP** or **DOWN** button to highlight any of the Movie Ratings options. When highlighted, all these options can be turned **ON** (which will allow blocking) or **OFF** (which will allow viewing).
- 10** Use the **CURSOR RIGHT** button on the remote to turn the rating option ON or OFF.

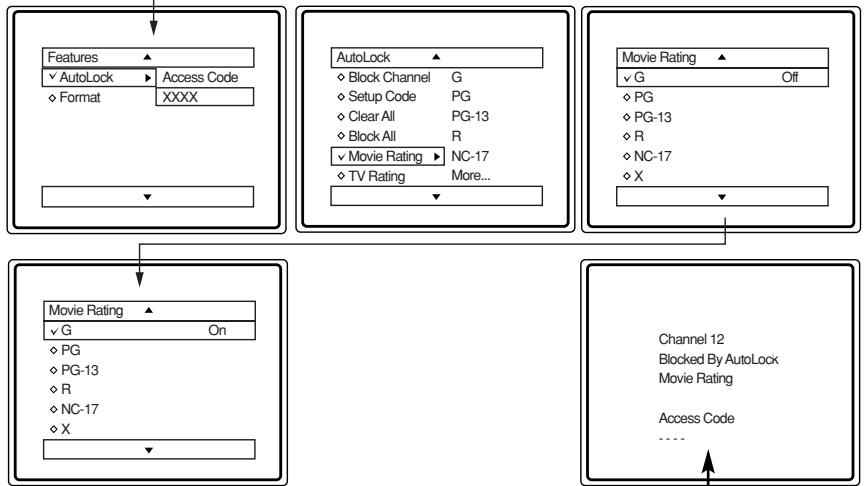
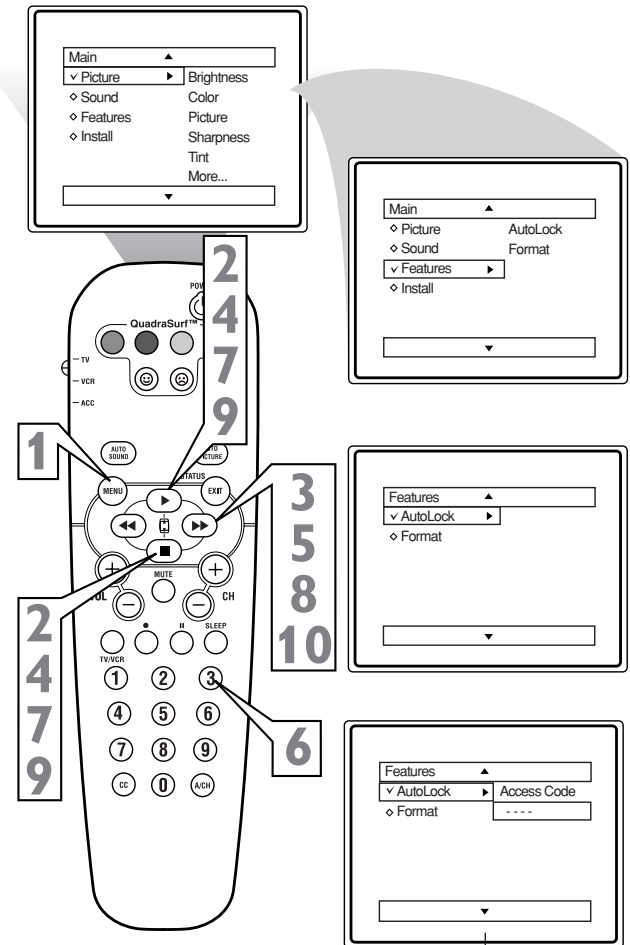

HELPFUL HINT

When a rating is set to block, all higher ratings will be automatically blocked as well. (Example: If the PG-13 rating is set to block, the R, NC-17, and X ratings will also be blocked.)

NOTE: The 0,7,1,1 access code shown on this page is the default code or a way to reset the code when the current access code is not known.

To view a program blocked by the Movie Rating options, enter your 4 digit access code. This will disable all blocked Movie Ratings until the TV is powered off and on again. Then the blocking options will be restored.



BLOCKING PROGRAMS BASED ON TV RATINGS

This portion of the AutoLock™ features cover program ratings based on the TV Industry rating system. This is known as TV Ratings within AutoLock™.

After selecting the Autolock™ feature and entering your personal access code, the AutoLock™ options screen appears;

- 1** Scroll the menu using the **CURSOR UP** or **CURSOR DOWN** buttons until the words **TV RATINGS** are highlighted.
- 2** Press the **CURSOR RIGHT** button to display the TV Ratings (TV-Y, TV-Y7, TV-G, TV-PG, TV-14, or TV-MA). When highlighted, the TV-Y and TV-G can be turned **ON** (which will allow blocking) or **OFF** (which will allow viewing), of these rated programs.
- 3** Press the **CURSOR UP** or **CURSOR DOWN** button to highlight the desired rating.
- 4** Press the **CURSOR RIGHT** button on the remote to turn the TV-Y or TV-G rating ON or OFF. Or, press the **CURSOR RIGHT** button to enter the sub-menus for the TV-Y7, TV-PG, TV-14 or TV-MA ratings.
- 5** If the TV-Y7, TV-PG, TV-14 or TV-MA sub-menu is accessed, press the **CURSOR UP** or **CURSOR DOWN** button to select one of the options (Block All, V, S, L, D, or FV).
- 6** Press the **CURSOR RIGHT** button on the remote to turn the option ON or OFF.

To view a program blocked by the TV Rating options, enter your 4 digit access code. This will disable all blocked TV Ratings until the TV is powered off and on again. Then the blocking options will be restored.

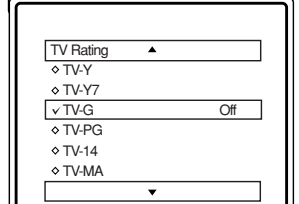
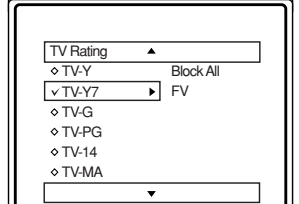
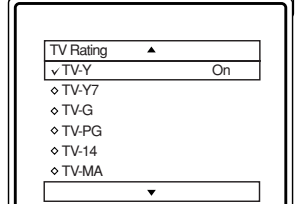
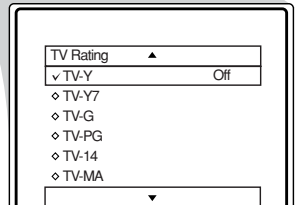
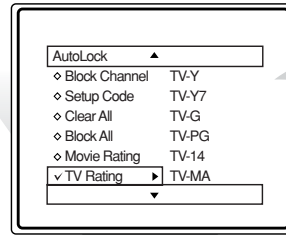
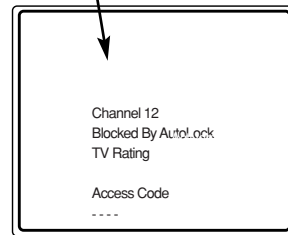

NOTE: The 0,7,1,1 access code shown on this page is the default code or a way to reset the code when the current access code is not known.

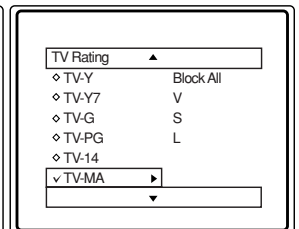
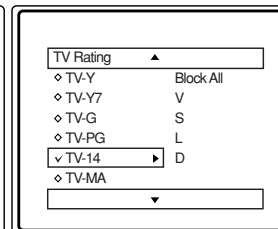
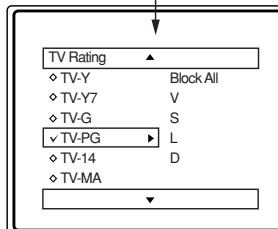

TV Ratings and Rating Sub-Menus
When a TV Rating is selected to block, ALL higher ratings will be blocked also.

TV-Y - (All children -- *This program is designed to be appropriate for all children.*) Designed for a very young audience, including children ages 2-6. This type of programming is not expected to frighten younger children.

TV-Y7 - (Directed to Older Children -- *This program is designed for children age 7 and above.*) It may be more appropriate for children who have acquired the development skills needed to distinguish between make-believe and reality. This programming may include mild fantasy and comic violence (FV).

TV-G - (General Audience -- *Most parents would find this program suitable for all ages.*) This type of programming contains little or no violence, no strong language and little or no sexual dialogue or situations.

TV-PG - (Parental Guidance Suggested -- *This program contains material that parents may find unsuitable for younger children.*) This type of programming contains one or more of the following: some suggestive dialogue (D), infrequent coarse language (L), some sexual situations (S), or moderate violence (V).

TV-14 - (Parents Strongly Cautioned -- *This program contains some material that many parents would find unsuitable for children under 14 years of age.*) This type of programming contains one or more of the following: intensely suggestive dialogue (D), strong coarse language (L), intense sexual situations (S), or intense violence (V).

TV-MA - (Mature Audience Only -- *This program is specifically designed to be viewed by adults and therefore may be unsuitable for children under 17.*) This type of programming contains one or more of the following: crude indecent language (L), explicit sexual situations (S), or graphic violence (V).

OTHER AUTOLOCK™ BLOCKING OPTIONS



AutoLock™ offers the viewer other blocking features as well. With these Blocking Options, the censoring can be turned ON or OFF.

- 1** Press the **MENU** button on the remote to show the on-screen menu.
- 2** Press the **CURSOR UP** or **DOWN** button until the word **FEATURES** is highlighted.
- 3** Press the **CURSOR RIGHT** button to display the **FEATURES** menu options.
- 4** Press the **CURSOR UP** or **DOWN** button until the words **AutoLock** are highlighted.
- 5** Press the **CURSOR RIGHT** button.
- 6** Enter the correct access code number. “XXXX” shows on the Access Code display as you press the **NUMBERED** buttons. AutoLock menu options will be displayed.
- 7** Press the **CURSOR UP** or **DOWN** buttons until the words **BLOCKING OPTIONS** are highlighted.
- 8** Press the **CURSOR RIGHT** button to display the **Blocking Options (BLOCKING, UNRATED, or NO RATING)** menu.
- 9** Press the **CURSOR UP** or **DOWN** buttons to highlight the desired feature.
- 10** When highlighted, each feature can be turned **ON** or **OFF** using the **CURSOR RIGHT** or **LEFT** buttons on the remote.

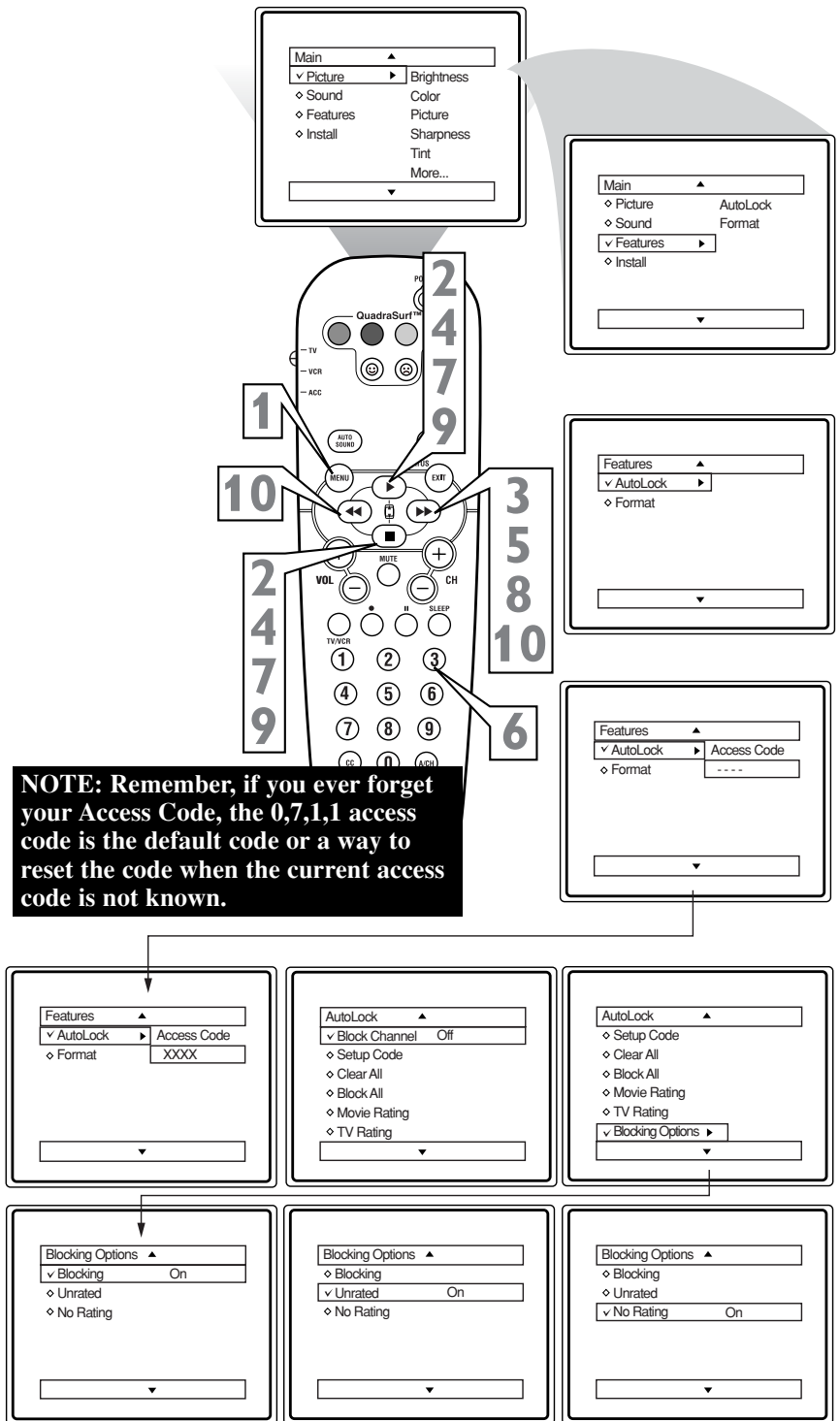

BLOCKING OPTIONS:

BLOCKING: This is what might be called the “master switch” for AutoLock™. When in the ON position, ALL blocking/censoring will take place. When in the OFF position, ALL blocking is disabled.

UNRATED: ALL unrated programs based on the Movie Ratings or Parental (TV) Guidelines can be blocked if this feature is set to ON and the **BLOCKING** feature is set to OFF.

NO RATING: ALL programming with NO content advisory data can be blocked if this feature is set to ON and the **BLOCKING** feature is set to OFF.



HOW TO USE THE ACTIVE CONTROL

The Active Control monitors and adjusts incoming video signals to help provide the best picture quality.

When you choose to turn the Active Control ON, the picture Brightness, Picture, Sharpness, Contrast + and DNR (dynamic noise reduction) features are controlled automatically. Active Control adjusts these picture settings continuously and automatically.

- 1** Press the **MENU** button on the remote to show the on-screen menu.
- 2** Press the **CURSOR UP** or **DOWN** button until the word **FEATURES** is highlighted.
- 3** Press the **CURSOR RIGHT** button to display the **FEATURES** menu options.
- 4** Press the **CURSOR UP** or **DOWN** button until the words **Active Control** are highlighted.
- 5** Press the **CURSOR RIGHT** button to set the Active Control to Off, On, or Display ON.
Display On - When selected, an Active Control monitoring screen will be shown for a few seconds whenever a channel change is made. Within this menu, you can actually see the controls changing to give the best possible picture quality.
On - When selected, the Active Control will work to give the viewer the best possible picture, but will not display the monitoring screen when channels are changed.
Off - the Active control will not be activated.
- 6** When finished, press the **STATUS** /**EXIT** button to remove the menu from the TV's screen.

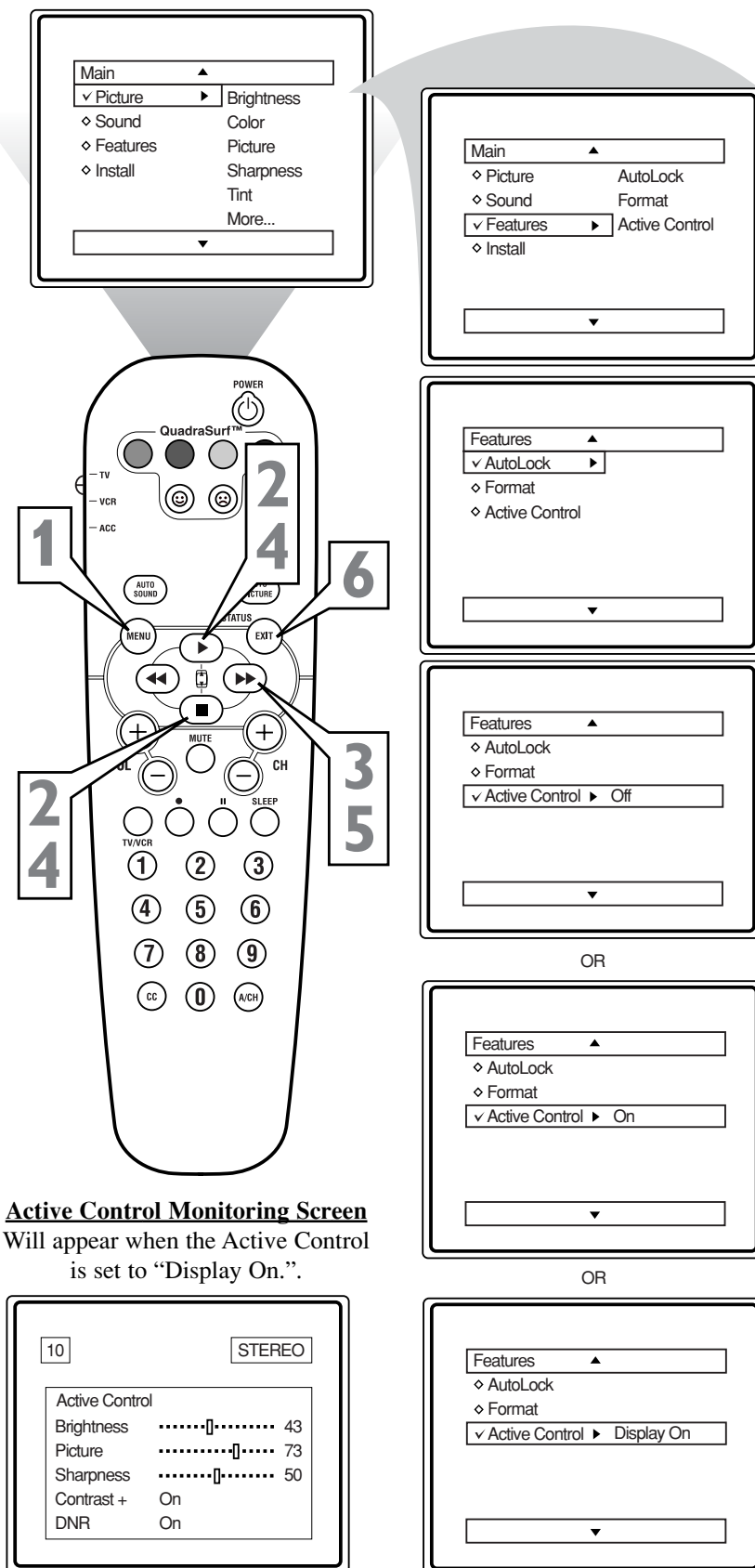

SETTING THE SLEEPTIMER CONTROL



Have you ever fallen asleep in front of the TV only to have it wake you up at two in the morning with a test pattern screeching in your ears? Well, your TV can save you all that trouble by automatically turning itself off.

- 1** Press the **SLEEP** button on the remote control and the SLEEP timer display will appear on the screen.
- 2** Press the **SLEEP** button repeatedly to pick the amount of time (15, 30, 45, 60, 90, 120, 180 or 240 minutes) before the TV will turn itself off.

An on-screen count down will appear during the last minute before the TV shuts itself off.

HELPFUL HINT

The on-screen menu will time out and disappear from the screen when you finish, or you can press the STATUS/EXIT button to clear the menu from the screen.

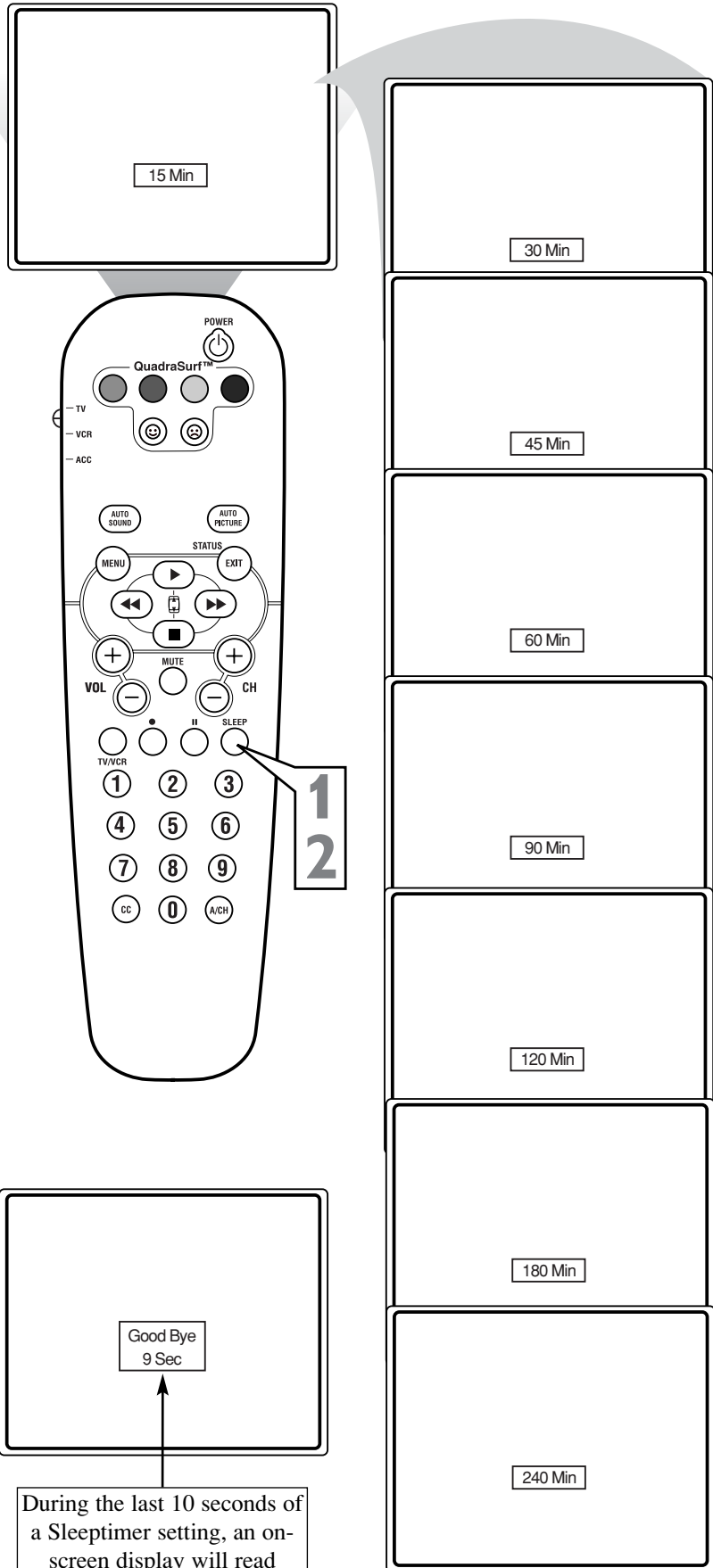

During the last minute of a SleepTIMER setting, an on-screen count down will be displayed. Pressing any button during the last minute will cancel the SleepTIMER.

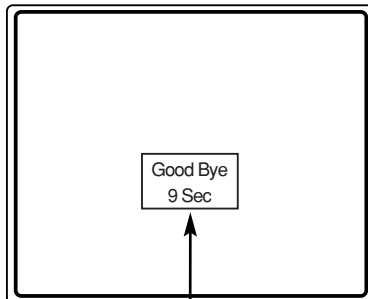
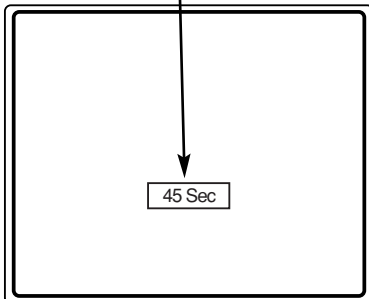

During the last 10 seconds of a SleepTIMER setting, an on-screen display will read GOOD BYE.



HOW TO USE THE CLOSED CAPTIONING CONTROL

Closed Captioning (CC) allows you to read the voice content of television programs on the TV screen. Designed to help the hearing impaired, this feature uses on-screen "text boxes" to show dialogue and conversations while the TV program is in progress.

- 1** Press the **CC** button on the remote to display the current Closed Caption setting.
- 2** Press the **CC** button repeatedly to choose from the four Closed Caption options (CC Off, CC 1, CC 2, CC Mute). Dialogue (and descriptions) for the action on the captioned TV program will appear on-screen if the tuned program is broadcasting CC information.
- 3** When finished, press the **STATUS** /**EXIT** button to remove the menu from the TV's screen or let the option time out and disappear from the TV screen.

HELPFUL HINT

Not all TV programs and product commercials are made with Closed Caption (CC) information included. Neither are all Closed Caption modes (CC1, or CC2) necessarily being used during the transmission of a closed caption program. Refer to your area's TV program listings for the stations and times of Closed Caption shows.

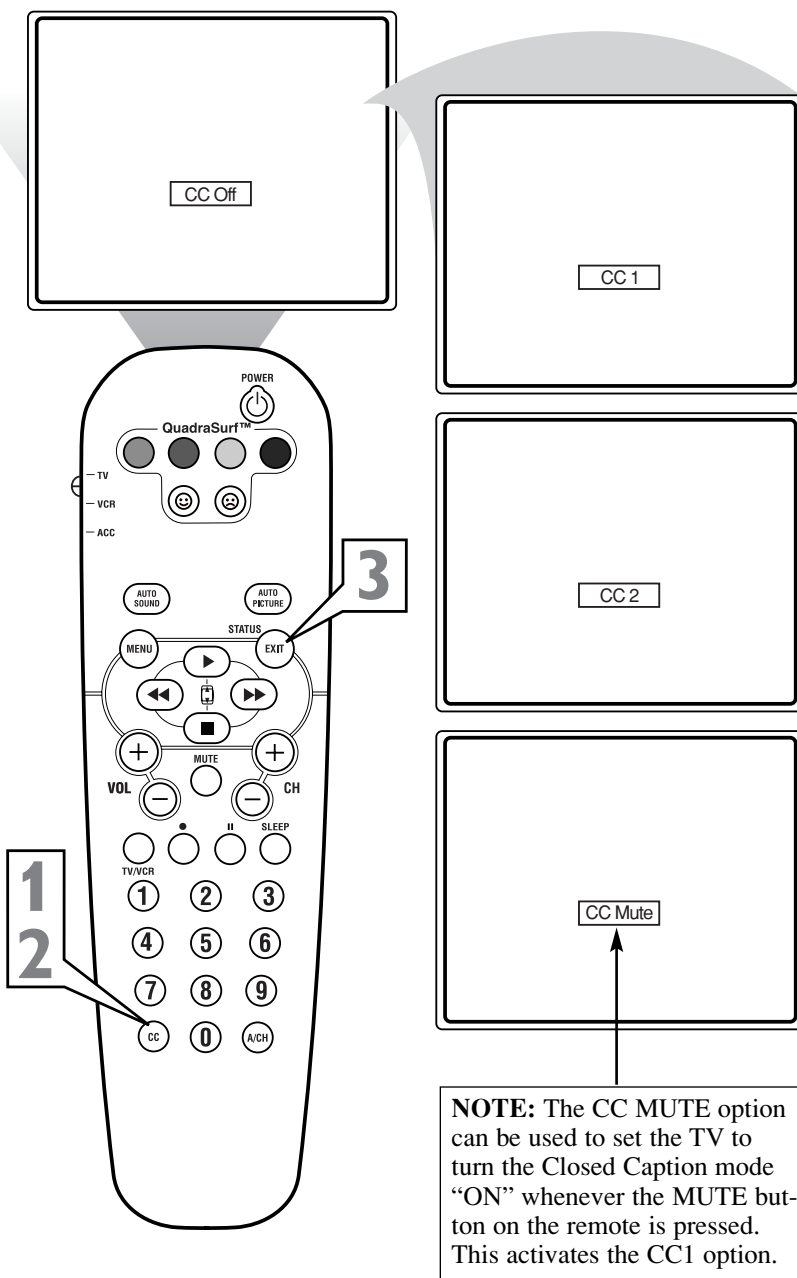



Whether you're watching a movie or a sporting event, your TV has automatic video control settings matched for your current program source or content. The AutoPicture™ feature quickly resets your TV's video controls for a number of different types of programs and viewing conditions you may have in your home. Each AutoPicture™ setting is preset at the factory to automatically adjust the TV's Brightness, Color, Picture, Sharpness, Tint, Color Temperature, DNR and Contrast+ levels.

1 Press the **AUTO PICTURE** button on the remote control. The current Auto Picture setting will appear in the middle of the screen.

2 Press the **AUTO PICTURE** button repeatedly to select either **PERSONAL**, **MOVIES**, **SPORTS**, **WEAK SIGNAL**, or **MULTI MEDIA** picture settings.

Note: The **PERSONAL** setting is the setting that you setup using the **PICTURE** options within the on-screen menu. This is the only Auto Picture setting that can be changed. All other settings are setup at the factory during the time of production.

MOVIES - Preset picture options for watching Video Tapes, or DVDs.

SPORTS - Preset picture options for watching sporting events.

WEAK SIGNAL - Preset picture options for watching programs where the reception is not at its best.

MULTI MEDIA - Preset picture options for use with video gaming.

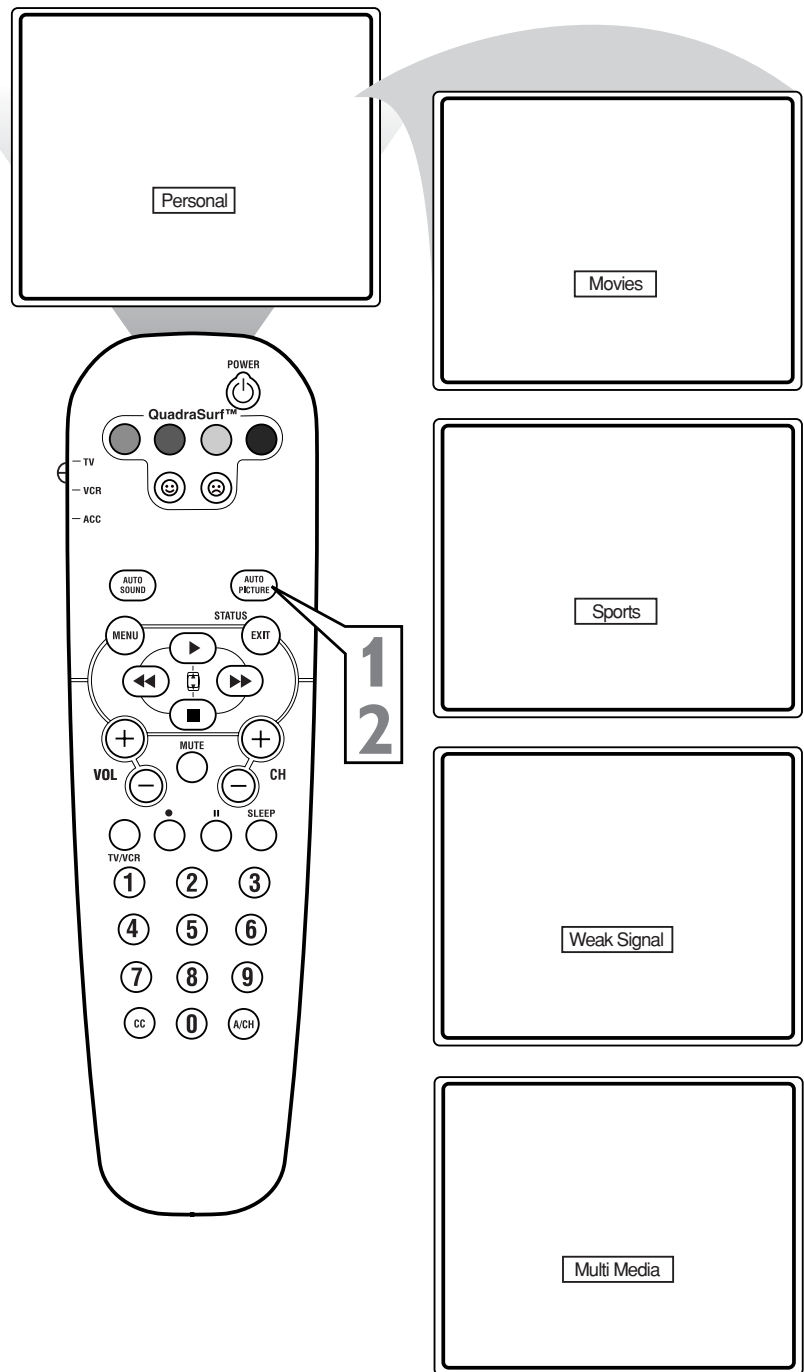



SETTING THE AUTO SOUND™ CONTROL

The AutoSound™ feature allows the listener to select between four different factory set sound options. Personal (which can be set by the user), Theatre (for movie viewing), Music (for musical type programming) and Voice (when the program is mainly dialogue). These settings affect the Sound menu's Bass, Treble, AVL, and Incredible Surround controls. To select any of the options follow the directions below.

1 Press the **AUTO SOUND** button on the remote control. The current Auto Sound setting will appear in the middle of the screen.

2 Press the **AUTO SOUND** button repeatedly to toggle between the four settings.

Note: Only the **PERSONAL** control can be changed by the viewer. This changes the settings in the main on-screen menu's sound controls.

THEATRE - Preset sound options for watching movies.

MUSIC - Preset sound options for musical programming where there is little dialogue.

VOICE - Preset sound options for programming where heavy dialogue is present.

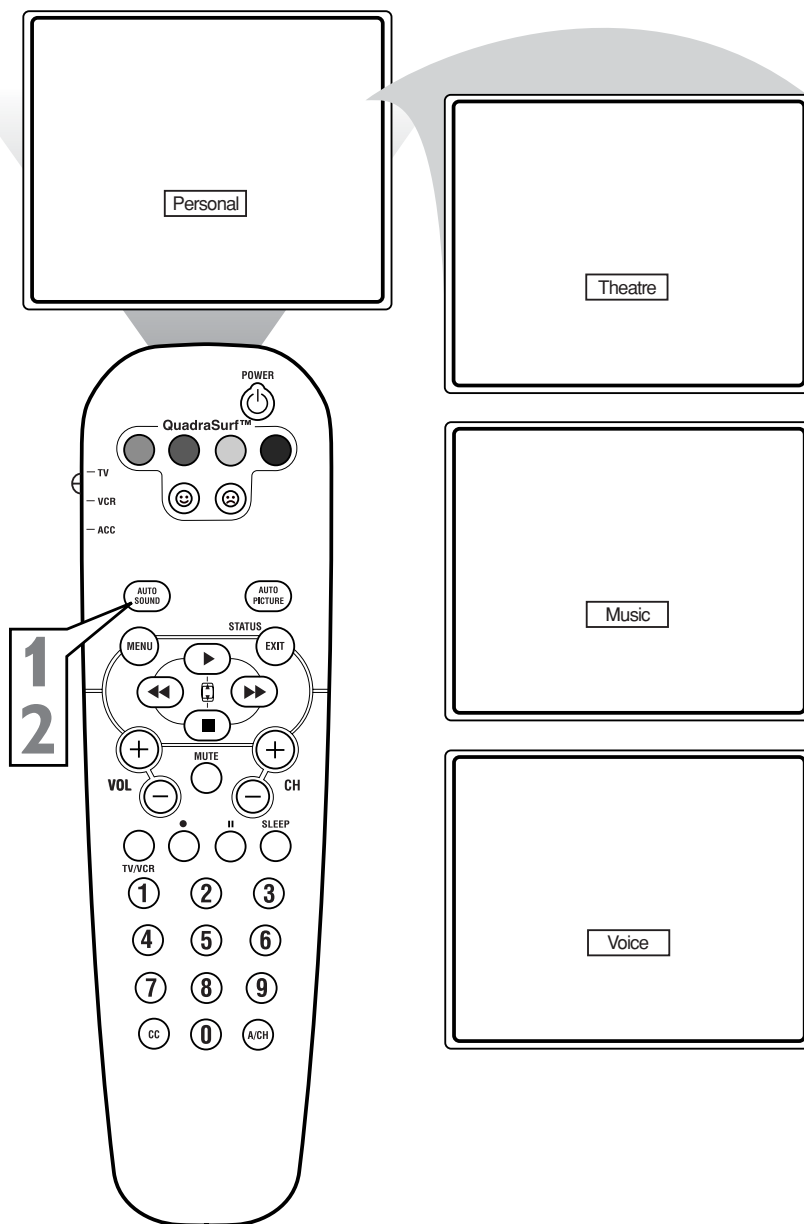



A “list” or series of previously viewed channels can be selected with the QuadraSurf™ (colored) buttons on your remote control. With this feature you can easily switch between different TV programs that currently interest you. The QuadraSurf™ control allows you to set up four different personal Surf lists using the colored buttons (on the remote control), each holding up to ten channels in its quick viewing “list.”

- 1** Press the CHANNEL (+) or (–) buttons (or the NUMBER buttons) to select a channel to add to one of the SURF lists.
- 2** Press the SMILEY ☺ button on the remote control to ADD the channel to one of the SURF lists.
- 3** Press the corresponding COLORED (Red, Green, Yellow or Blue) button to add the channel to that button’s Surf list. (Up to ten channels per button can be stored.)

Repeat steps 1 through 3 to add additional channels (up to 10) to each of the SURF lists.

To remove a channel from one of the SURF lists;

- 4** Press the COLORED QuadraSurf™ button until the desired channel appears. The screen will display the channel number with a colored “Smiley” face to indicate the Colored button it relates to.
- 5** While the “Smiley” face channel indicator is displayed, press the FROWNIE ☹ face button. The screen will read, “Remove item? - Press ☹ .”
- 6** Press the FROWNIE ☹ face button again to confirm your decision to remove the channel from the Surf list.

Repeat steps 4-6 to remove other channels from Surf lists.

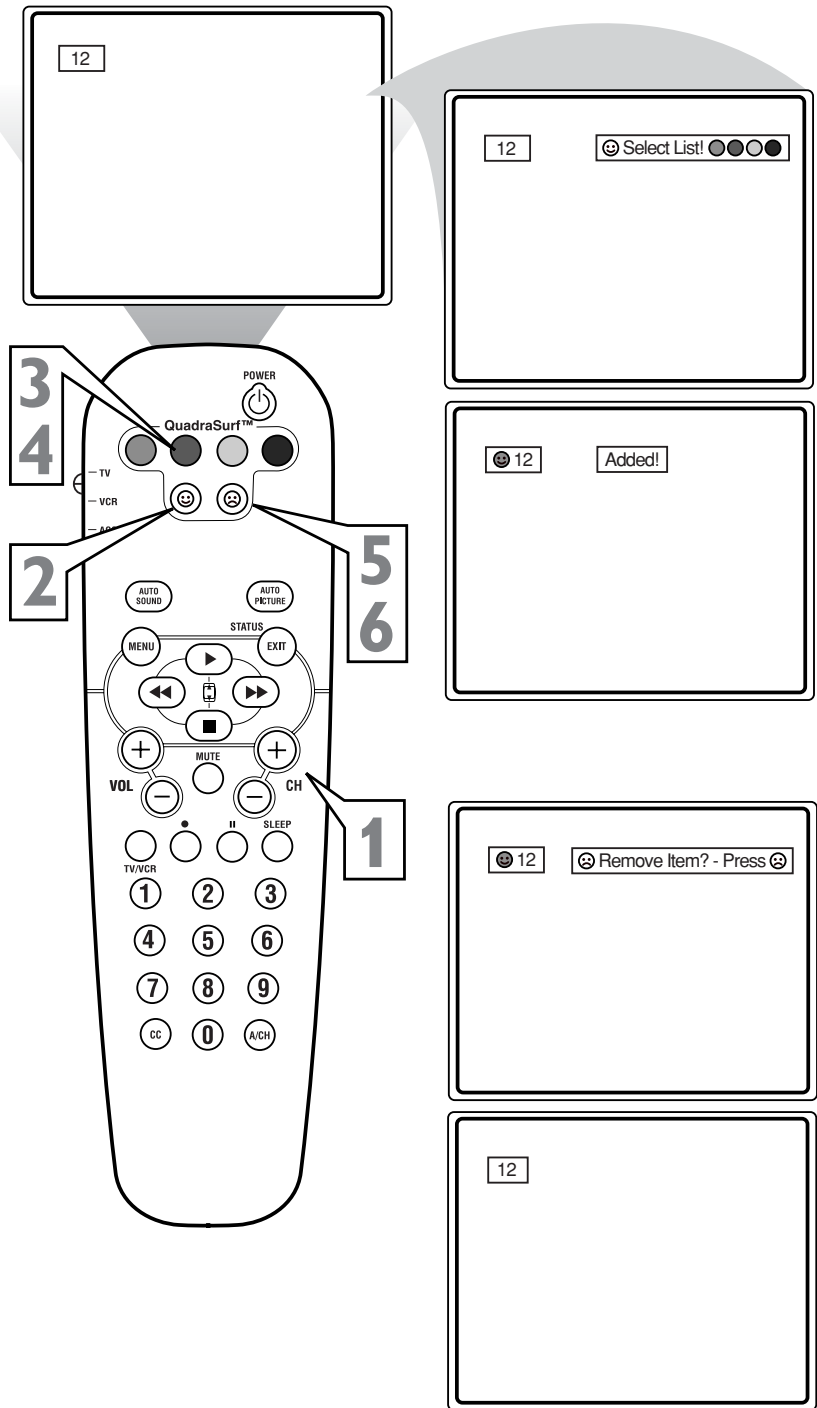

ALTERNATE CHANNEL

Your remote also has an A/CH (Alternate Channel) button. Pressing this button will toggle between the Current and one previously selected channel.

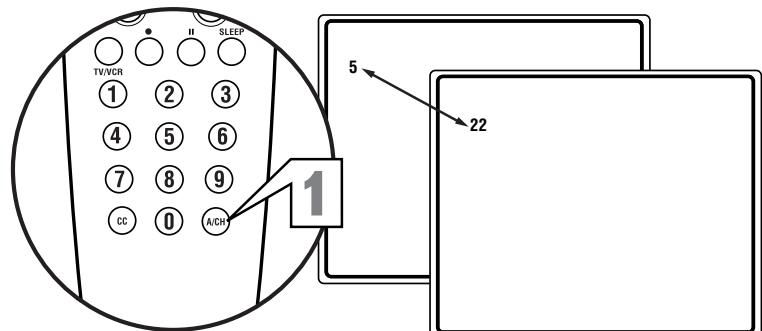



USING THE QUADRASURF™ BUTTONS

The QuadraSurf™ buttons on your remote control allow you to store up to 10 channels per button (40 total). This is a great feature if you want to store all your favorite Sports channels, Movie channels, or News channels in one surf list. Family members can have their own favorite list of channels. You can even program the external A/V Input jacks (Front channel) for one of the buttons making it a “source” button for your external accessory devices.

Assuming channels have now been added to the four QuadraSurf™ lists (the four colored buttons on the remote, see the previous page), let's review how the feature works.

- 1** Press one of the pre-programmed **COLORED** buttons on the remote (Red, Green, Yellow or Blue). The screen will display a smiley face with the first programmed channel for that surf list.
- 2** While the colored “smiley” face still appears on the screen, press the same **COLORED** button on the remote to tune the second channel programmed for that specific surf list.
- 3** Repeatedly pressing the same **COLORED** button while the “smiley” face appears will tune all the programmed channels for that specific surf list. After the last channel is tuned, pressing the **COLORED** button again will return you to the first channel in the list.
If the “smiley” face disappears from the screen and the same **COLORED** button is pressed, the surf channels will be displayed starting with the **FIRST** programmed channel again.
- 4** Repeat steps 1-3 for the other three **COLORED** buttons (Surf lists) if desired.
- 5** Any time the “smiley” face appears with the channel number, **pressing the “frownie” face button** will allow you to remove it from the list (see the previous page for more details).

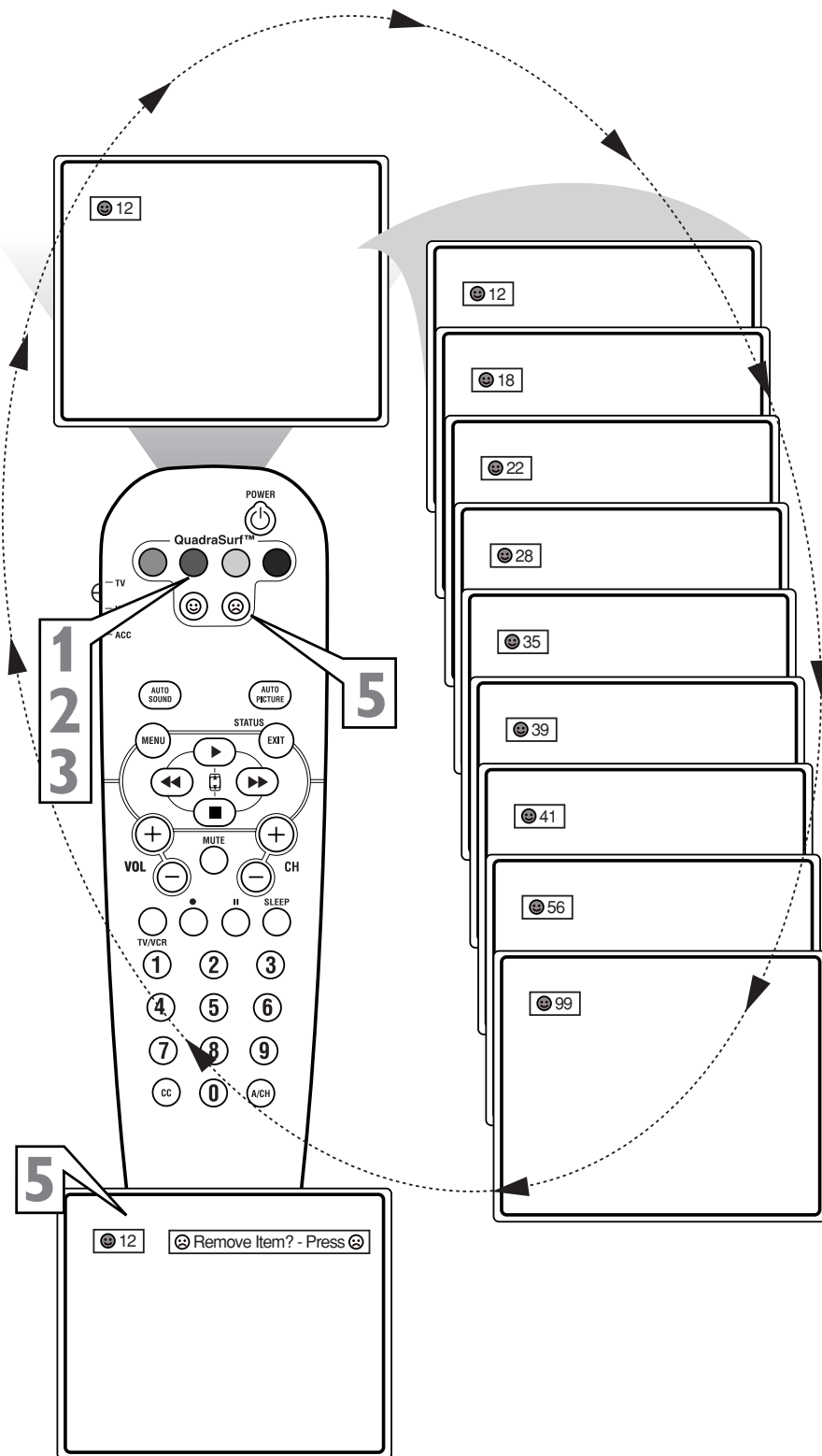



Your remote control is set to work your TV and many infrared remote (IR) control VCRs, Cable Boxes, Satellite Systems, DBS, DVD, etc. However, an easy onetime step may be necessary before the remote will work your VCR.

Try this initial Direct Access Method to see if going on to the following section is necessary.

- 1** Place the TV/VCR/ACC Mode Switch in the proper position.
- 2** Point the remote control at the device and press the POWER button.

Does the remote turn the device ON?

If **YES**, stop and try other function buttons on the remote. If they also work the device, then the remote is ready and no further steps are needed.

If **NO**, continue...

- 3** First look up a **FOUR-DIGIT remote control number** for your brand of Device before going through the simple steps on the following page.

Find your Four-Digit Code on pages 29-31.

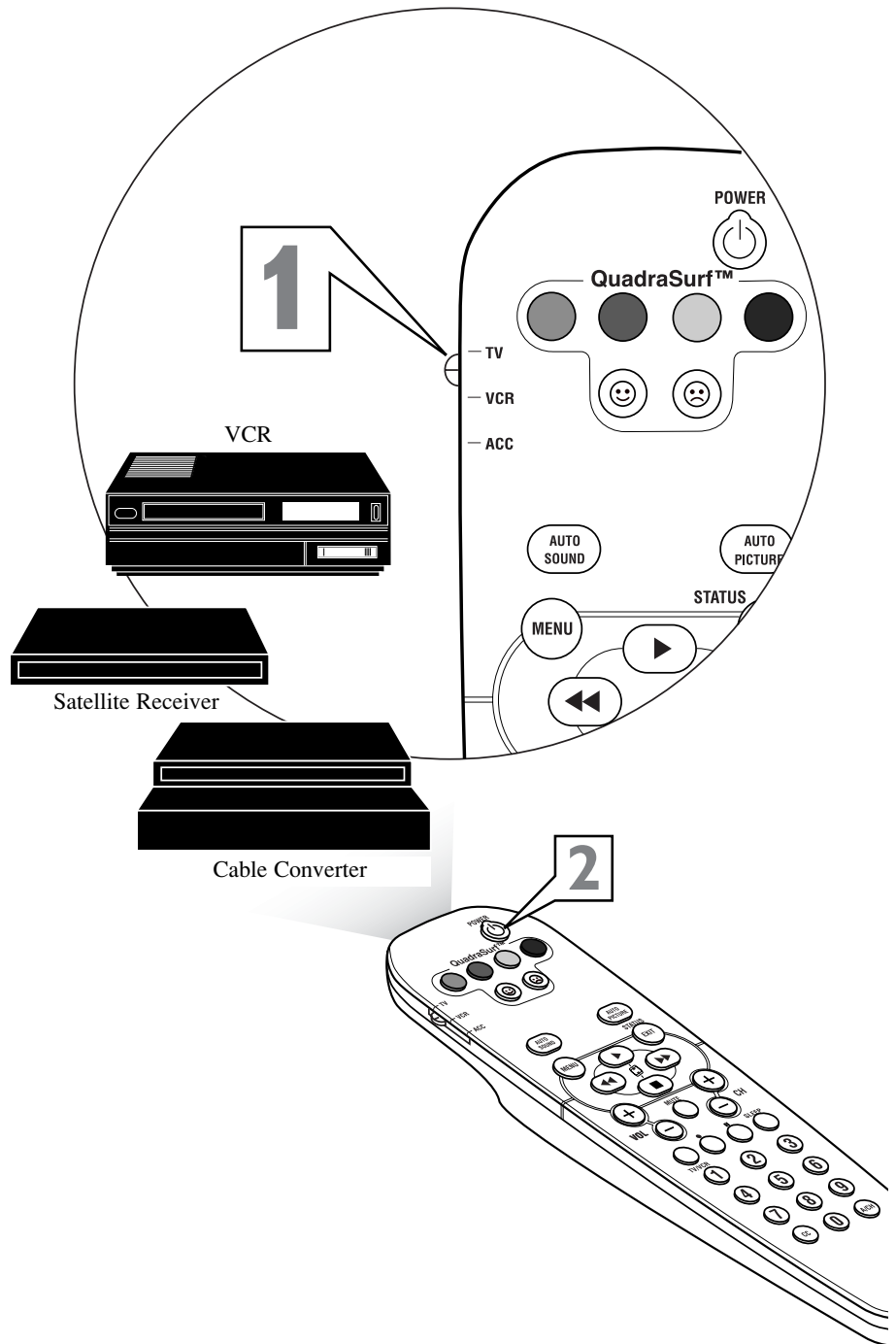

HELPFUL HINT

If more than one number is listed, you may have to try more than the first Four-Digit code given in order to locate your Device's remote code.

NOTE: Setting up the remote is for use with external accessory devices only and not for use with other television brands.



REMOTE CONTROL USE WITH ACCESSORY DEVICES - CODE ENTRY METHOD

Now that you have looked up the four-digit Remote Code Number for your brand of device, you are ready to follow the four simple steps below.

Please read through steps 1-4 before beginning.

- 1** Place the TV/VCR/ACC Mode Switch in the proper position.
- 2** Press the VCR • RECORD button on the remote control and release.
- 3** Press the AUTO SOUND button on the remote within 30 seconds, then release.
- 4** Enter the FOUR-DIGIT REMOTE CODE NUMBER (page 29-31) for your desired device. The remote is now ready to send commands to the unit.
- 5** Point the remote at the Device. Press the POWER button on the remote to turn the unit ON.

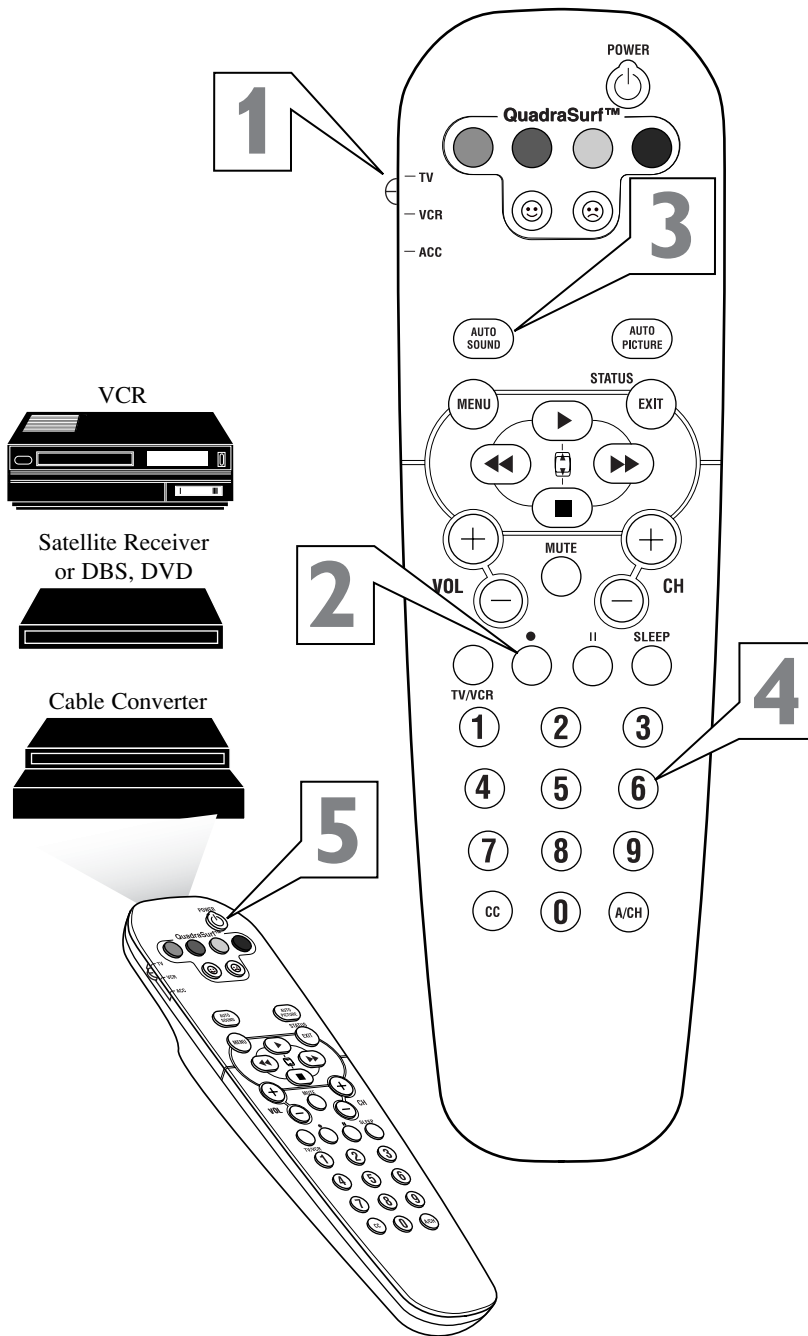

HELPFUL HINT

Remember, if this doesn't work the first time, repeat the steps using a different remote code number.

After a second try and the remote does not operate your device, see if there is another four-digit code number (pages 29-31) listed for your device and repeat the steps above using the new number.

If after repeated attempts the code number method does not work you device, try the **SEARCH METHOD** on the next page.

NOTE: Setting up the remote is for use with external accessory devices only and not for use with other television brands.

REMOTE CONTROL USE WITH ACCESSORY DEVICES - SEARCH METHOD



Your TV remote can be set to work various external devices such as VCRs, Cable Boxes, Satellite Receivers, DBS, DVD, etc. by what is called the search method of remote control programming.

If the "Remote Code" number method shown on the previous page did not set your remote to work your external device, then follow the easy steps listed below.

Please read steps 1-4 before beginning.

- 1** Press the **POWER** button on the device your are attempting to program to turn it ON.
- 2** Place the **TV/VCR/ACC Mode Switch** in the proper position.
- 3** Press the **VCR • RECORD** and the **AUTO SOUND** buttons simultaneously and hold them down.
- 4** The device will begin to change channels after the remote identifies the correct code. When the channels start to change release the **VCR • RECORD** and **AUTO SOUND** buttons. The remote should be ready to operate the device.

HELPFUL HINT

This method can take up to two minutes to perform.

Don't let the device scan up more than five channels. If you do the remote may pass up the right code and another two minute search cycle will have to be repeated.

If no channel change happens within two minutes, repeat steps 1-4. Should a channel change still not occur, the remote will not work the desired device.

NOTE: Setting up the remote is for use with external accessory devices only and not for use with other television brands.

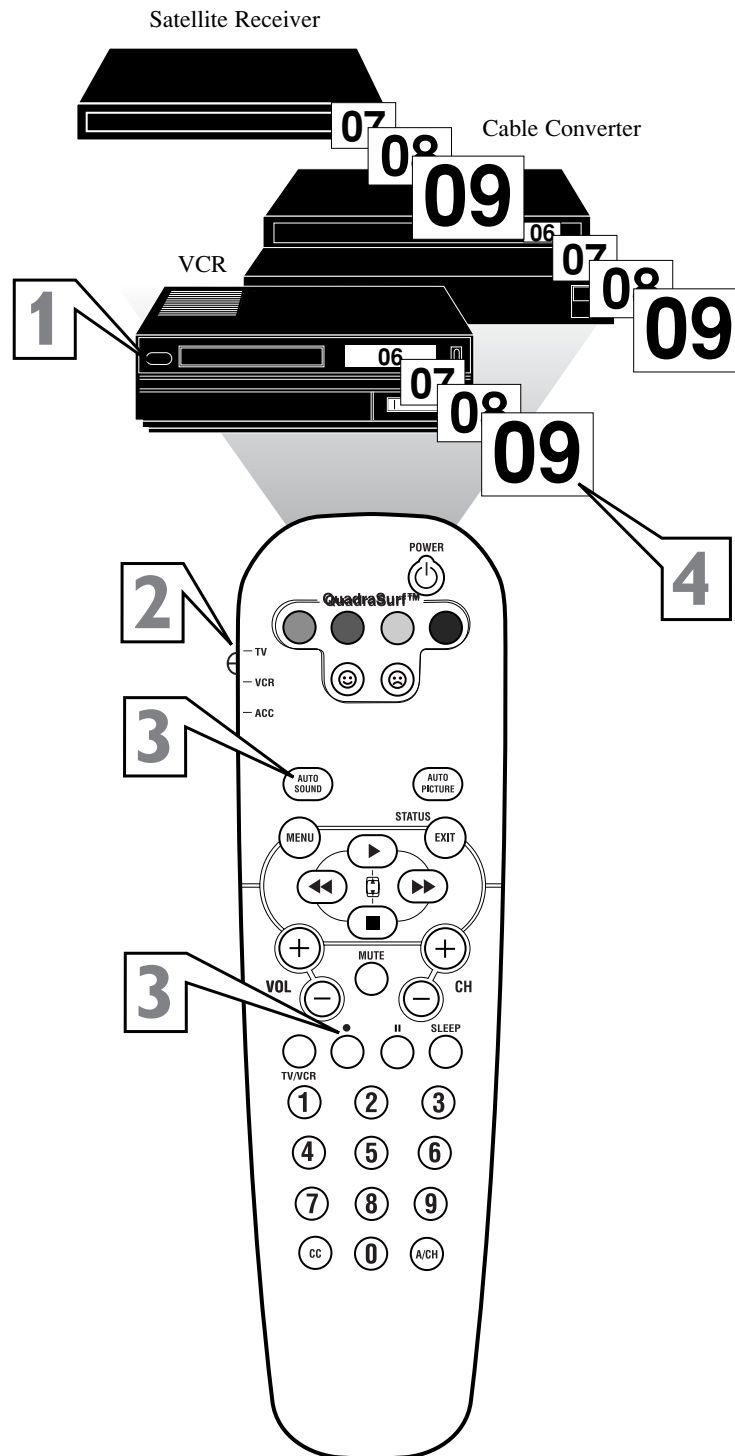



REMOTE CONTROL DIRECT ENTRY CODES

VCR CODES

Admiral	.2027, 2052	Electroponic	.2017	Lloyd's	.2001, 2051
Adventura	.2001	Emerex	.2012	Loewe	.2004, 2005, 2017, 2035
Aiko	.2059	Emerson	.2001, 2002, 2017, 2023, .2040, 2046, 2051, 2052, .2059, 2078, 2083	Logik	.2004, 2034, 2057
Aiwa	.2001, 2017, 2062, 2070, 2072	ESC	.2057, 2059	Luxor	.2023, 2025, 2027, 2037, 2038
Akai	.2021, 2029, 2038, 2060, 2063	Ferguson	.2021, 2039, 2064, 2065	LXI	.2017
Akiba	.2034	Fidelity	.2001	M Electronic	.2001
Alba	.2011, 2034, 2052, .2059, 2063, 2072	Finlandia	.2035, 2037	Magnasonic	.2059
Ambassador	.2011	Finlux	.2001, 2022, 2035, 2037	Magnavox	.2001, 2015, 2019, 2035
American Action	.2059	Firstline	.2017, 2023, 2024, 2034, 2052	Magnin	.2057
American High	.2015	Fisher	.2025, 2026, 2030, 2037	Manesth	.2024, 2034
Amstrad	.2001, 2059, 2067, 2068	Frontech	.2011	Marantz	.2003, 2005, 2015, 2035
Anam	.2017, 2042, 2054, .2057, 2059, 2082, 2084	Fuji	.2015	Marta	.2017
Anam National	.2042, 2054, 2087	Funai	.2001	Matsui	.2004, 2016, 2036, .2052, 2070, 2072
Anitech	.2034	Garrard	.2001	Matsushita	.2015, 2042, 2055
Asa	.2017, 2035	GE	.2015, 2027, 2032, 2057	Mei	.2015
Asha	.2057	GEC	.2035	Melectronic	.2018
Asuka	.2017	General	.2011	Memorex	.2001, 2015, 2017, 2019, .2025, 2026, 2027, 2037, 2052, .2057, 2062, 2085, 2087, 2088
Audiovox	.2017	Go Video	.2077, 2081	Memphis	.2034
Baird	.2001, 2021, 2037, 2039	Goldhand	.2034	Metz	.2003, 2005, 2017, .2042, 2048, 2055, 2069
Basic Line	.2011, 2034, 2059	Goldstar	.2017, 2018, 2053, 2079	MGA	.2023, 2057
Beaumarck	.2057	Goodmans	2001, 2017, 2034, 2059, 2075	MGN Technology	.2057
Bell & Howell	.2037	Gradiente	.2001, 2008	Mincrva	.2048
Blaupunkt	.2003, 2005, 2010, 2014, .2041, 2042, 2048, 2054, 2055, 2075	Graetz	.2005, 2021, 2037, 2057	Minerva	.2005, 2010, 2048
Brandt	.2047, 2064, 2065	Granada	.2025, 2035, 2037	Minolta	.2022
Brandt Electronic	.2021	Grandin	.2001, 2017, 2034	Mitsubishi	2023, 2027, 2033, 2035, 2045
Broksonic	2002, 2040, 2046, 2052, 2078	Grundig	.2003, 2005, 2007, 2010, .2034, 2035, 2048, 2050, .2054, 2069, 2071, 2075	Motorola	.2015, 2027
Bush	.2034, 2052, 2059, 2072	Hanseatic	.2017	MTC	.2001, 2057
Calix	.2017	Harley Davidson	.2001	Multitech	.2001, 2034
Canon	.2015	Harman/Kardon	.2018, 2035	Murphy	.2001
Capehart	.2011	Harwood	.2034	NAD	.2031
Carver	.2035	HCM	.2034	National	.2054
Catron	.2011	Headquarter	.2025	NEC	.2018, 2020, 2021, 2033, 2037
CCE	.2034, 2059	Hinari	.2004, 2034, 2057, 2072	Neckermann	.2035
CGE	.2001	Hi-Q	.2026	Nesco	.2034
Cimline	.2034	Hitachi	.2001, 2004, 2021, .2022, 2043, 2057	Nikko	.2017
Cineral	.2059	Hughes Network Systems	.2022	Nikon	.2014
Citizen	.2017, 2059	Hypson	.2034	Noblex	.2057
Clatronic	.2011	Imperial	.2001	Nokia	.2025, 2037, 2038, 2057
Colt	.2034	Ingersol	.2004	Nokia	.2021, 2025, 2037, 2038, 2057
Combitech	.2072	Interfunk	.2035	Nordmende	.2021, 2061, 2064, .2065, 2074
Condor	.2011	ITT	.2005, 2021, 2025, 2037, .2038, 2057, 2074	Oceanic	.2001, 2021
Craig	.2017, 2026, 2034, 2057, 2058	ITV	.2017, 2059	Okano	.2063, 2070
Crown	.2011, 2034, 2059	Jensen	.2021	Olympus	.2015, 2054
Curtis Mathes	.2015, 2021, 2032, 2042	JVC	.2008, 2021, 2033, 2049, .2050, 2074, 2080	Optimus	.2017, 2027, 2031, 2037, .2042, 2077, 2086, 2087, 2088
Cybernex	.2057	Kaisui	.2034	Orion	.2002, 2004, 2016, 2036, .2046, 2052, 2070, 2072, 2078
Cyrus	.2035	KEC	.2017, 2059	Osaki	.2001, 2017, 2034
Daewoo	.2011, 2024, 2025, 2059, 2083	Kendo	.2038, 2052	Otto Versand	.2035
Dansai	.2034	Kenwood	.2018, 2021, 2033	Palladium	.2005, 2017, 2021, 2034
Daytron	.2011	KLH	.2034	Panasonic	.2015, 2042, 2053, .2054, 2055, 2087
De Graaf	.2022, 2043	Kodak	.2015, 2017	Pathe Cinema	.2016
Decca	.2001, 2035	Korpel	.2034	Pathe Marconi	.2021
Denon	.2022	Layco	.2034	Penny	.2015, 2017, 2018, .2020, 2022, 2057
Dual	.2021	Lenco	.2059		
Dumont	.2001, 2035, 2037	LG	.2079		
Dynatech	.2001				
Elbe	.2018				
Elcatech	.2034				
Electrohome	.2017				

REMOTE CONTROL DIRECT ENTRY CODES



VCR CODES (continued)

Pentax	.2022	Sanky	.2019, 2027	TEC	.2011
Perdio	.2001	Sansui	.2001, 2021, 2033, .2052, 2058, 2078	Technics	.2015, 2042, 2054
Philco	.2015, 2018, 2052, 2078	Sanyo	.2025, 2026, 2037, 2057	Teknika	.2001, 2015, 2007, 2017
Philips	.2015, 2035 (DEFAULT VCR), .2074, 2075	Saville	.2072	Teleavia	.2021
Phonola	.2035	SBR 2035		Telefunken	2021, 2047, 2058, 2064, 2074
Pilot	.2017	Schaub Lorenz	.2001, 2005, 2021, 2037	Tenosal	.2034
Pioneer	.2031, 2033, 2035	Schneider	.2001, 2034, 2035	Tensai	.2001, 2066
Portland	.2011	Scott	.2023, 2024, 2040, 2046	Thomas	.2001
Profex	.2066	Sears	.2001, 2015, 2017, .2022, 2025, 2026, 2037	Thomson	.2021, 2064, 2074
Profitronic	.2057	SEG	.2057, 2066	Thorn	.2016, 2021, 2037
Proline	.2001	SEI	.2004, 2035	TMK	.2051, 2057
Proscan	.2032	Seleco	.2021	Toshiba	.2021, 2023, 2024, 2035, 2074
Protec	.2034	Semp	.2024	Totelevision	.2017, 2057
Pulsar	.2019	Sentra	.2011	Towada	.2066
Pye	.2035	Sharp	.2027, 2073	Uher	.2057
Quarter	.2025	Shintom	.2034, 2037	Unitech	.2057
Quartz	.2025	Shogun	.2057	Universum	.2001, 2006, 2010, 2017, .2035, 2038, 2048, 2057, 2067
Quasar	.2015, 2042, 2087	Shorai	.2004	Vector	.2024
Quelle	.2035	Silva	.2017	Vector Research	.2018, 2020
Radio Shack	.2001, 2085	Singer	.2024, 2034	Victor	.2008, 2021, 2033
Radiola	.2035	Sinudyne	.2004, 2035	Video Concepts	.2020, 2024
Radix	.2017	Solavox	.2011	Videosonic	.2057
RCA 2015, 2022, 2027, 2032, 2038, 2057		Sonorlor	.2025	Wards	.2001, 2015, 2022, 2026, .2027, 2032, 2034, 2035, 2057
Realistic	.2001, 2015, 2017, .2025, 2026, 2027, 2037	Sontec	.2017	White Westinghouse	.2052, 2059
REX	.2021, 2074	Sony	.2001, 2012, 2013, 2014, 2015	XR-1000	.2001
RFT	.2075	STS	.2022	XR-1001	.2015
Ricoh	.2014	Sunkai	.2070	XR-1002	.2034
Roadstar	.2017, 2034, 2057, 2059	Sunstar	.2001	Yamaha	.2018
Runco	.2019	Suntronic	.2001	Yamishi	.2034
Saba	.2021, 2049, 2050, 2061, 2 .064, 2065, 2074	Sylvania	.2001, 2015, 2023, 2035	Yokan	.2034
Saisho	.2004, 2016, 2036, 2052	Symphonic	.2001	Yoko	.2011, 2057
Salora	.2023, 2025, 2038	Tashiko	.2001	Zenith	.2001, 2014, 2019, 2052, 2078
Samsung	.2024, 2057, 2076, 2077	Tatung	.2001, 2021, 2035		
		Teac	.2001, 2021		

DIGITAL VIDEO DISC CODES

Akai	.5316	Panasonic	.5301, 5322	Sony	.5306
Harman/Kardon	.5314	Philips	.5302, 5308 (DEFAULT DVD)	Technics	.5301
JVC	.5311, 5318	Pioneer	.5305, 5312, 5321	Theta Digital	.5312
Kenwood	.5307	Proscan	.5304	Thomson	.5310
Magnavox	.5302	RCA	.5304	Toshiba	.5302
Mitsubishi	.5303	Samsung	.5313	Yamaha	.5301, 5309
Onkyo	.5302, 5317, 5319	Sharp	.5320		

CABLE CODES

ABC	.3002, 3003, 3004, 3006, 3008	Decsat	.3027	Jerrold	.3002, 3004, 3005, 3006, .3007, 3020, 3031, 3046
Andover	.3037	Everquesst	.3007	LG Alps	.3044
Bell & Howell	.3006	Filmnet	.3028	Memorex	.3001
Birmingham Cable Communication	.3020	France Telecom	.3030	Mnet	.3009, 3028
British Telecom	.3002, 3012	GEC	.3011	Now	.3041
Cabletime	.3016, 3019, 3025, 3029	Gemini	.3007	Oak	.3009
Clyde	.3011	General Instrument	.3004, 3020, .3031, 3046	Pacific	.3039
Contec	.3009	Goldstar	.3014, 3047	Panasonic	.3001, 3013
Cryptovision	.3038	Grundig	.3035	Paragon	.3001
Daehan	.3043	Hitachi	.3004	Pioneer	.3014, 3036
Daeryung	.3003	Jasco	.3007	Pulsar	.3001



REMOTE CONTROL DIRECT ENTRY CODES

CABLE CODES (continued)

PVP Stereo Visual Matrix	.3002	Signal	.3007	Toshiba	.3001
Quasar	.3001	Signature	.3004	Tudi	.3023
Radio Shack	.3007	Starcom	.3002, 3007	Tusa	.3007
Rembrandt	.3004	Stargate	.3007	United Cable	.3002
Runco	.3001	Starquest	.3007	Videoway	.3017
Salora	.3026	STS	.3015	Visicable+	.3033
Samsung	.3014, 3040	Taihan	.3043	Westminster	.3012
Satbox	.3024	Tele+1	.3028	Wolsey Gene	.3037
Scientific	.3003, 3032, 3049	Teleservice	.3022	Zenith	.3001, 3034
Scientific Atlanta	.3003, 3008, 3021	Tocom	.3005		
Seawoo	.3045	Tongkook 3	.042, 3048		

SATELLITE CODES

Absat	.4006	Grundig	.4008, 4010, 4048	Pioneer	.4021, 4059
Alba	.4029, 4034, 4037, 4052	G-sat	.4009	Planet	.4061
Aldes	.4019	Hinari	.4009	Promax	.4037
Amstrad	.4003, 4016, 4025, 4038, 4039, 4042	Hirschmann	.4008, 4032, 4039, 4040, 4049	Prosat	.4019
Ankard	.4013, 4019, 4030, 4044	Hitachi	.4037	Quadral	.4029, 4044
Antron	.4009, 4034	Houston	.4053	Radiola	.4011
Armstrong	.4015	Huth	.4013, 4015, 4019, 4026	Radix	.4031, 4064
AST	.4027	Intervision	.4050	RFT	.4011, 4013, 4019
Astra	.4005	Invideo	.4061	Saba	.4023, 4045
Astro	.4008, 4039, 4045	ITT	.4005	Sabre	.4037
Avalon	.4031	Johansson	.4022	Sagem	.4056
Axis	.4030, 4046	JVC	.4048	Salora	.4005
Beko	.4010	Kathrein	.4004, 4006, 4008, 4011, 4035, 4041	SAT	.4027, 4038
Best	.4030	Kreiselmeier	.4008	Satcom	.4026, 4051
Blaupunkt	.4008	Kyostar	.4034	Satec	.4009
Boca	.4015, 4043	La Sat	.4043, 4045	Satmaster	.4026
Brain Wave	.4022	Lenco	.4034	Satpartner	.4022, 4034, 4040, 4045
British Sky Broadcasting	.4058	Lennox	.4050	Schwaiger	.4009, 4041
BT	.4053	Lupus	.4030	Seemann	.4031, 4046
Bush	.4002	Luxor	.4005, 4049	SEG	.4030, 4034
Cambridge	.4024	Manhattan	.4037, 4045, 4050	Siemens	.4008
Canal Satellite	.4059	Marantz	.4011	Skymaster	.4019, 4044, 4051
Canal+	.4059	Maspro	.4004, 4023	Sony	.4017, 4018
Channel Master	.4029	Matsui	.4024, 4048	Strong	.4062
CNT	.4045	Mediamarkt	.4015	Sunstar	.4043
Comlink	.4019	Mediasat	.4059	Tantec	.4023, 4037
Connexions	.4031	Minerva	.4048	Techniland	.4026
Crown	.4015	Morgan's	.4015, 4043	Technisat	.4001, 4039
Cyrus	.4011	Navex	.4022	Telefunken	.4034
D-Box	.4054	Neuhaus	.4039	Teleka	.4015, 4052
DDC	.4029	Neusat	.4057	Telesat	.4051
DNT	.4011, 4031	Newhaus	.4013	Thomson	.4037, 4059
Echostar	.4031, 4036, 4061	Nokia	.4005, 4032, 4037, 4049, 4054, 4063	Tonna	.4026, 4053
Emanon	.4034	Nordmende	.4029	TPS	.4056
Ferguson	.4002, 4009, 4010, 4023	Orbitech	.4039	Triad	.4027
Fidelity	.4016	Oxford	.4024	Triasat	.4040
Finlux	.4005, 4024, 4032, 4037	Pace	.4002, 4009, 4014, 4023, 4037, 4055, 4058	Unitor	.4022
Fracarro	.4061	Palladium	.4048	Universum	.4008, 4049
Freecom	.4034	Palsat	.4039	Ventana	.4011
FTE Humax	.4060	Panda	.4037	Vortec	.4034
Fube	.4030, 4031, 4034	Philips	.4007, 4011, 4020, 4037, 4048, 4059	Vtech	.4027
Galaxis	.4019, 4057, 4060	Phonotrend	.4019, 4050	Winersat	.4022
General Instrument	.4012			Wisi	.4008, 4027, 4031, 4037
Gold Box	.4059			Xcom Multimedia	.4065
Gooding	.4048			Xsat	.4006, 4065
Goodmans	.4010			Zehnder	.4033, 4045

REMOTE CONTROL VCR RELATED BUTTONS



When using the TV remote with a VCR, first make certain it is set to control your VCR (by the REMOTE CODE or SEARCH method).

- 1** Set the TV/VCR/ACC mode switch to VCR on the remote.
- 2** Point the top of the remote toward the front of the VCR (remote sensor window) when pressing the buttons.

VCR SYSTEM SWITCH
Set in the VCR position to send remote commands to the VCR.

PLAY BUTTON ▶
Press to begin playback of a video tape.

REWIND BUTTON ◀◀
Press to rewind tapes. For some VCR's the STOP button may have to be pressed first, then REWIND. In playback mode hold down the button to view picture moving rapidly in reverse.

(Clock) TV/VCR BUTTON
Press while in the VCR mode (VCR indicator on the front of the unit will light) to view the playback of a tape. Press again to place in the TV position (VCR indicator light will go off) to view one program while recording another program. When used in the TV mode, the CLOCK/TV/VCR button will access the TV's Clock menu options.

RECORD • BUTTON
Hold the VCR • RECORD button down to begin a VCR recording.

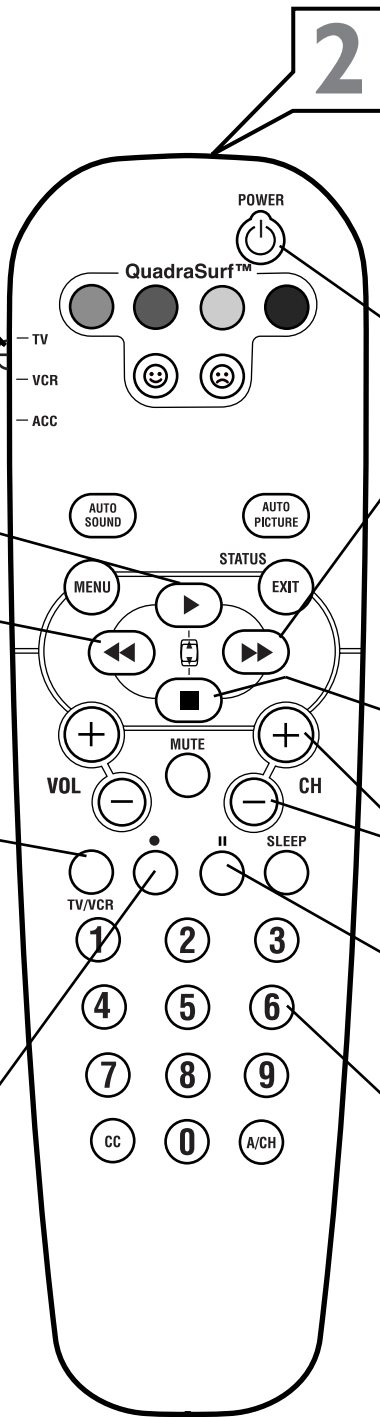

POWER BUTTON
Press to turn the VCR ON and OFF.

FAST FORWARD BUTTON ▶▶
Press to rapidly advance the tape. For some VCR's you may need to press the STOP button first, then the FAST FORWARD button. In playback mode hold the button down to view the picture moving rapidly in the forward direction.

STOP BUTTON ■
Press to stop the motion of a tape in playback, rewind, fast forward, etc.

CHANNEL + & - BUTTONS
Press to scan up or down through the VCR channel numbers.

PAUSE BUTTON II
Press to temporarily stop the tape during a playback or recording. Press again to release Pause.

NUMBER BUTTON
Press buttons for direct VCR channel selections.

HELPFUL HINT

The VCR buttons on the remote will not operate your VCR if those features are not found on your VCR remote control.

Note: All VCR functions (particularly Search, Rewind, Fast Forward, etc.) will operate the same as with the original VCR remote control provided with the VCR.



No Power

- Check the TV power cord. Unplug the TV, wait 10 seconds, then reinsert the plug into the outlet and push the POWER button again.
- Check that the outlet is not on a wall switch.
- Be sure the fuse is not blown on the AC power strip, if one is being used.

No Picture

- Check antenna connections. Are they properly secured to the TV's ANT 75Ω plug?
- Check the TUNER MODE control for the correct tuner setting.
- Try running the Auto Program feature to find all available channels.
- Press the AV button on the remote to make sure the correct signal source is selected (FRONT or Current Channel).

No Sound

- Check the VOLUME buttons.
- Check the MUTE button on the remote control.
- If you're attempting to hook up auxiliary equipment, check the audio jack connections located on the front of the TV.

TV Only Produces MONO Sound

- If using a cable box with RF only type connections, the signal coming from the cable box will be produced in MONO only.
- Check Sound control setting. Change setting to Stereo.

Remote Does Not Work

- Check the batteries. If necessary, replace them with AA Heavy Duty (Zinc Chloride) or Alkaline batteries.
- Clean the remote control and the remote control sensor window on the TV.
- Check the TV power cord. Unplug the TV, wait 10 seconds, then reinsert the plug into the outlet and push the POWER button again.
- Be sure the fuse is not blown on the AC power strip, if one is being used.
- Check to be sure the TV outlet is not on a wall switch.

TV Displays Wrong Channel or No Channels Above 13

- Repeat channel selection.
- Add the desired channel numbers (using the CHANNEL EDIT control) into the TV's memory.
- Check to be sure the TUNER MODES are set to the CABLE option and run the Auto Program feature to find all available channels.



WARNING Concerning Stationary Images on the TV Screen:

Do not leave stationary or letterbox images on screen for extended periods of time. This can cause uneven picture-tube aging.

Normal use of the TV should involve the showing of pictures that contain constantly moving and changing images that fill the screen. Be careful not to leave nonmoving images on screen for extended periods of time, or to display the same images on screen too frequently, because subtle ghost images can be left on the picture tubes. Sources of stationary images may be DVD disks, laser disks, video games, CD-i disks, videotapes, digital television boxes, broadcast channels, cable channels, satellite channels, and others. **Here are some examples of stationary images (this is not an all-inclusive list; you may encounter others in your viewing):**

- **DVD menus**—listings of DVD disk content
- **Letterbox black bars**—shown at the top and bottom of the TV screen when a wide screen (16:9) movie is viewed on a TV with standard (4:3) aspect ratio.
- **Video-game images and scoreboards**
- **Television station logos**—present a problem if they are bright and stationary; moving or low-contrast graphics are less likely to cause uneven aging of the picture tube
- **Stock-market tickers**—presented at the bottom of the TV screen
- **Shopping channel logos and pricing displays**—bright and shown constantly or repeatedly in the same location on the TV screen.

PLACEMENT OF THE TV

- To avoid cabinet warping, cabinet color changes, and increased chance of set failure, do not place the TV where temperatures can become excessively hot; for example, in direct sunlight or near a heating appliance.
- Be sure to allow a free flow of air to and from the perforated back cover of the set.

CLEANING

- To avoid possible shock hazard, be sure the TV is unplugged from the electrical outlet before cleaning.
- Regularly dust the TV with a dry, nonscratching duster to keep the TV clean.
- When cleaning the TV, take care not to scratch or damage the screen surface. Avoid wearing jewelry or using anything abrasive. Do not use household cleaners. Wipe the front screen with a clean cloth dampened with water. Use even, easy, vertical strokes when cleaning.
- Gently wipe the cabinet surfaces with a clean cloth or sponge dampened in a solution of cool, clear water and a mild soap or detergent. Use a clean, dry cloth to dry the wiped surfaces.
- Occasionally vacuum the ventilation holes or slots in the back cover of the set.
- Never use thinners, insecticide sprays, or other chemicals on or near the cabinet, as they might cause permanent marring of the cabinet finish.



GLOSSARY OF TERMS

Auto Programming • The procedure of adding or deleting channel numbers into the Television's memory circuits. In this way the Television "remembers" only the locally available or desired channel numbers and skips over any unwanted channel numbers.

Coaxial Cable • A single solid antenna wire normally matched with a metal plug (F-type) end connector that screws (or pushes) directly onto a 75 Ohm input found on the Television or VCR.

Closed Caption • Broadcast standard which allows you to read the voice content of television programs on the TV screen. Designed to help the hearing impaired this feature uses on-screen "text boxes" to show dialogue and conversations while the TV program is in progress.

Side Audio/Video Inputs • Located on the side of the TV these connectors (phono type plug) are used for the input of audio and video signals. Designed for easy use with VCRs or cameras.

On Screen Displays (OSD) • Refers to the wording or messages generated by the television (or VCR) to help the user with specific feature controls (color adjustment, programming, etc.).

Menu • An on-screen listing of feature controls shown on the Television screen that are made available for user adjustments.

Quadra Surf • The feature that allows the programming of four separate Surf lists holding up to 10 channels each.

Remote Sensor Window • A window or opening found on the Television control panel through which infrared remote control command signals are received.

Status/Exit • Allows the user to quickly confirm what channel number is currently being viewed. Status can also be used to clear the Television of on screen displays or information (rather than waiting for the displays to "time out" or automatically disappear from the screen).

Surf • The action of scanning specific channel in a limited channel list.

Twin Lead Wire • The more commonly used name for the two strand 300 Ohm antenna wire used with many indoor and outdoor antenna systems. In many cases this type of antenna wire requires an additional adapter (or balun) in order to connect to the 75 Ohm Input terminals designed into the more recent Televisions and VCRs.

Tuner Mode • Feature control settings made by the TV. Designed for first time set up and use. Settings for signal connections (antenna or cable TV), plus channel program memory are held in the TV's memory (even if the set is unplugged and moved to a new location.)



Active Control20	Format (Expand 4:3) Control11
Alternate Channel25	Glossary of Terms36
Auto Lock	Index37
Access Code13	Language Control5
Block All Control16	Picture Control9
Block Channels Control14	Remote Control Buttons6
Blocking Options19	Remote Control Operation (Basic)5
Clear All Control15	Remote Control Programming
Explanation of Auto Lock12	Code Entry Method28
Movie Rating Control17	Direct Access Method27
TV Rating Control18	Remote Code List30-32
Auto Picture Control23	Search Method29
Auto Program Control7	VCR Remote Buttons33
Auto Sound Control24	Safety Instructions3
AVL Control10	Sharpness Control9
Balance Control10	Sleeptimer Control21
Bass Boost Control10	Surf/Quadra Surf Controls25-26
Brightness Control9	Table of Contents4
Care and Cleaning35	Tint Control9
Channel Edit Control (Add and Delete Channels)8	Troubleshooting Tips34
Closed Caption Control22	Treble Boost Control10
Color Control9	Tuner Mode Control6
Color Temperature Control9	Limited Warranty38
Contrast + Control9	Welcome/Registration Information2
Dynamic Noise Reduction (DNR) Control9	

**RENEWED
90 DAY
LIMITED WARRANTY**