

Digital Still Camera

Read This First

Operating Instructions

Before operating the unit, please read this manual and "User's Guide/Troubleshooting" (separate volume) thoroughly, and retain them for future reference.

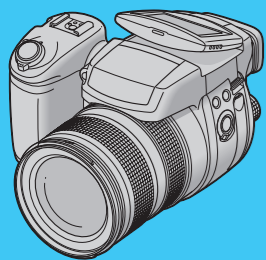

DSC-R1

Cyber-shot



Refer to "User's Guide/Troubleshooting" (separate volume)

Explains advanced techniques and what to do if you experience trouble with your camera.

Printed on 100% recycled paper using VOC (Volatile Organic Compound)-free vegetable oil based ink.

© 2005 Sony Corporation Printed in Japan

1 Prepare the battery pack

Be sure to turn off your camera before charging starts.

1 Insert the battery pack.

Bottom

Battery eject lever

Open the battery cover

Firmly insert the battery pack all the way while pressing the **battery eject lever** with the tip of the battery

Close the battery cover

2 To wall outlet (wall socket)

AC Adaptor

Power cord (mains lead)

▲ mark

2 Open the cover, and pull it out. Connect the plug to the DC IN jack.

⚡/CHG lamp

Light on: Charging

Light off: Completed (Disconnect the AC Adaptor.)

- It takes approximately 180 minutes to charge a completely discharged battery pack using the AC Adaptor at a temperature of 25°C (77°F). Charging may take longer under certain circumstances or conditions.
- The lamp also lights up while charging the flash.

2 Turn the camera on/set the clock

1 Select

2 Set the POWER switch to ON sliding in the arrow direction.

Lighting (Green)

3 Set the clock with the multi-selector.

1 Select the date display format by moving the multi-selector to ▲/▼, then press the center of the multi-selector.

2 Select each item by moving to ◀/▶ and set the numeric value by moving to ▲/▼, then press the center of the multi-selector.

3 Select [OK] by moving to ▶, then press the center of the multi-selector.

• To cancel, select [Cancel] and press the center of the multi-selector.

3 Insert a recording medium (not supplied)

Available recording medium for the camera

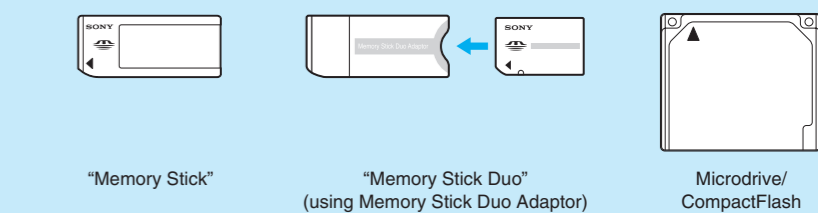

You can use a "Memory Stick", "Memory Stick Duo" (using Memory Stick Duo Adaptor) Microdrive, or CompactFlash card (CF card) as a recording medium.

"Memory Stick"

Terminal side

Open the "Memory Stick"/CF card cover.

Insert the "Memory Stick" all the way in until it clicks.

Microdrive/CompactFlash

Terminal side

Close the "Memory Stick"/CF card cover.

Insert the Microdrive/CF card all the way in from the connector side as shown in the illustration.

Switching the recording medium

/CF switch

• When recording images onto a "Memory Stick" or playing back images from a "Memory Stick".

• CF: When recording images onto a Microdrive/CF card or playing back images from a Microdrive/CF card.



2654464120

Checking the accessories supplied

- AC-L15A AC Adaptor (1)
- Lens hood (1)
- Shoulder strap (1)
- Power cord (mains lead) (1)
- Lens cap (1)
- CD-ROM (Cyber-shot application software/Image Data Converter SR) (2)
- Rechargeable battery pack NP-FM50 (1)
- USB cable (1)
- Operating instructions: "Read This First" (this manual) (1)
- Operating instructions: "User's Guide/Troubleshooting" (1)
- Video cable (1)

Notes

- Charge the supplied NP-FM50 battery pack before using the camera for the first time.
- The LCD screen and the LCD finder are manufactured using extremely high-precision technology so over 99.99% of the pixels are operational for effective use. However, there may be some tiny black points and/or bright points (white, red, blue or green in color) that constantly appear on the LCD screen. These points are normal in the manufacturing process and do not affect the recording in any way.
- The camera is a precision instrument. Be careful not to bump the lens or the LCD screen, and not to apply force to it. Attach the strap to prevent the camera from damage by being dropped, etc. → "User's Guide/Troubleshooting" (page 18)

On carrying or storing

- Close the LCD screen toward the body.
- Set the zoom fully to the W position to put the lens in.
- Attach the lens cap.

Additional information on this product and answers to frequently asked questions can be found at our Customer Support Website.

http://www.sony.net/

Using the AC Adaptor

Use the camera connected to a wall outlet (wall socket) as illustrated above.

- Connect the AC Adaptor to an easily accessible wall outlet (wall socket). If any trouble occurs, immediately disconnect the plug from the wall outlet (wall socket).
- After use, disconnect the AC Adaptor both from the camera and from the wall outlet (wall socket).
- This set is not disconnected from the AC power source (mains) as long as it is connected to the wall outlet (wall socket) even if the set itself has been turned off.
- Do not use the AC Adaptor placed in a narrow space, such as between a wall and furniture.

To check the remaining battery time

Set the POWER switch to ON to turn on and check the time on the LCD screen.

Remaining indicator

110min

Remaining time

- It takes about one minute until the correct battery remaining time appears.
- The displayed time remaining may not be correct under certain circumstances.

To remove the battery pack

Open the cover and slide the battery eject lever in the direction of the arrow. Be careful not to drop the battery pack.

Battery eject lever

To use your camera abroad — Power sources

You can use your camera and the AC Adaptor (supplied) in any country or region where the power supply is within 100 V to 240 V AC, 50/60 Hz. Use a commercially available AC plug adaptor [a], if necessary, depending on the design of the wall outlet (wall socket) [b].

AC-L15A

• Do not use an electronic transformer (travel converter), as this may cause a malfunction.

To change the date and time

Select [Clock Set] in the (Setup) screen and perform the procedure in step 3 above. → "User's Guide/Troubleshooting" (pages 32 and 82)

On the clock display

- If you selected [D/M/Y] in step 1, set the time on a 24-hour cycle.
- Midnight is indicated as 12:00 AM, and noon as 12:00 PM.

When turning on the power

- Unless you set the clock, the Clock Set screen appears each time the camera is turned on.
- The following screen appears when the camera is turned on for the second time or afterwards.

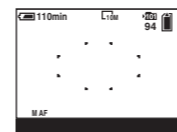

To turn off the power

Set the POWER switch to OFF sliding in the arrow direction.

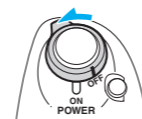

- If the camera is running on battery power and you do not operate the camera for certain time, the camera turns to Power Save mode (POWER lamp: red) automatically to prevent wearing down the battery pack. To change the setting → "User's Guide/Troubleshooting" (page 72)

Changing the language setting

You can change the screen display to show messages in a specified language. To change the language setting, press MENU to display the menu screen. Select (Setup) with the control button, then, select [A Language] in (Setup1), and select the desired language. → "User's Guide/Troubleshooting" (page 80)

Microdrive/CompactFlash

We have checked the compatibility of following Microdrives.

Hitachi Global Storage Technologies, Inc.

DSCM-11000 (1 GB)

3K4-2 2GB (HMS 360402D 5CF00)

3K4-4 4GB (HMS 360404D 5CF00)

3K6-4 4GB (HMS 360604D 5CF00)

3K6-6 6GB (HMS 360606D 5CF00)

We have checked the compatibility of CF cards compliant with CompactFlash Type I and Type II, however, we cannot guarantee proper operation of all CF cards.

- Copying between media cannot be done with this camera.
- You can insert a "Memory Stick" and a Microdrive/CF card at the same time. However, you cannot record an image onto both the media simultaneously.
- For more information about the "Memory Stick" → "User's Guide/Troubleshooting" (page 122)
- The Microdrive is a compact and lightweight hard disk drive that complies with CompactFlash Type II standards. For more information about the Microdrive → "User's Guide/Troubleshooting" (page 124)
- Before using a Microdrive/CF card, be sure to format it using this camera. Otherwise, satisfactory performance may not be obtained. → "User's Guide/Troubleshooting" (page 78)

To remove a recording medium

Open the "Memory Stick"/CF card cover, then push the "Memory Stick" in once or push the CF card eject lever so that the Microdrive/CF card is ejected.

When the access lamp is lit

Never open the "Memory Stick"/CF card cover or turn off the power. The data may be corrupted.

Access lamp

CF card eject lever

4 Select the image size for use

1 Select



2 Press MENU.

- ### 3 Select (Image Size) by moving the multi-selector to , then select the desired image size by moving the multi-selector to .

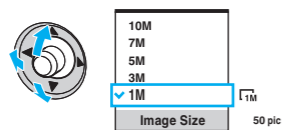

• The recordable number of still images is indicated at the right side of [Image Size].

- ### 4 Press MENU to complete the setting.

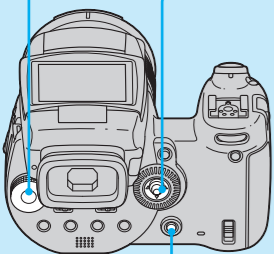

MENU button

5 Shoot images easily (Auto adjustment mode)

Holding the camera

Using finder



Using LCD screen



At a low-angle shot

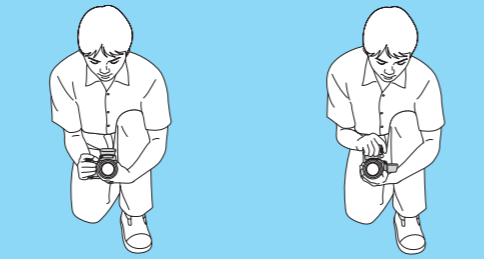

At a high-angle shot

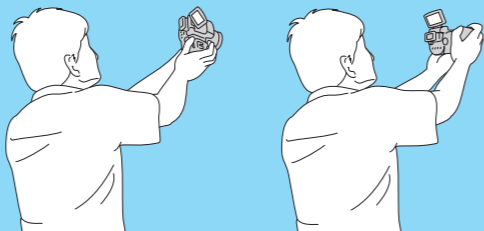

1 Select

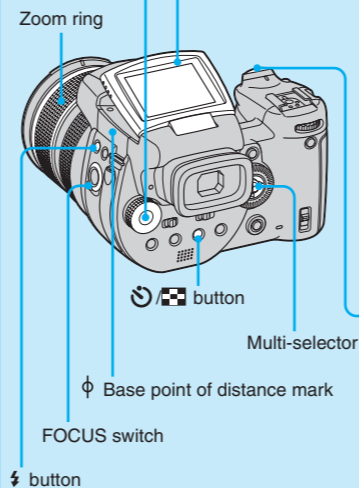

2 Adjust the angle of the LCD screen for your preference.

Position a subject in the center of the focus frame.



Rotating the LCD screen

Turn over the LCD screen to the lens side. The image on the LCD screen is a mirror-image. However, the image can be normal when recorded.



3 Shoot with the shutter button.

Press and hold the shutter button halfway down to focus. AE/AF lock indicator Flashing indicator → Indicator lit/beeps

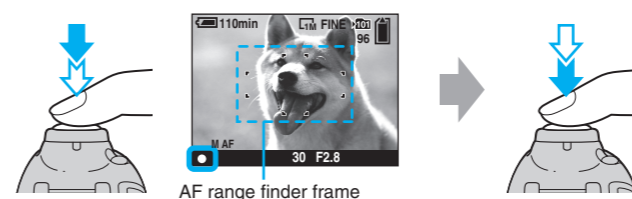

Using the zoom



• Optical zoom scaling is up to 5x. You can use the digital zoom whose scaling is up to 15x. For details on the [Digital Zoom] settings and the image quality → “User’s Guide/Troubleshooting” (page 71)

6 View/delete images

1 Turn to playback mode.

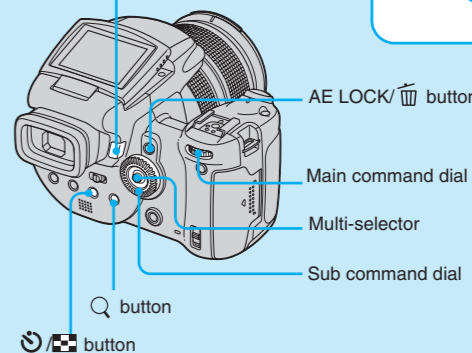

To return to the shooting mode

- Press (Playback) again.
- Press and hold the shutter button halfway down.
- Change the position of the mode dial.

To delete images

- 1 Display the image you want to delete and press AE LOCK/ (Delete).
- 2 Select [Delete] by moving the multi-selector to , then press the center of the multi-selector.

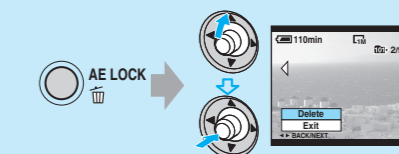

To cancel the deletion

Select [Exit], then press the center of the multi-selector.

On still image sizes

For details on the image size → “User’s Guide/Troubleshooting” (page 13)

The default settings are marked with .

Image size*	Guidelines	No. of images	Printing
10M (3888x2592)	For storing important images or printing A3/A3+** size or fine A4 size images	Less	Fine
7M (3264x2176)			
5M (2784x1856)	For printing in A4 size or high density images in A5 size		
3M (2160x1440)			
1M (1296x864)	For printing in postcard size For recording a larger number of images For creating web pages	More	Rough

* The images recorded using the camera are the same 3:2 ratio as used photograph printing paper or postcards, etc.

** This is a size larger than A3 size. You can print images with a margin around the A3 size image.

• You can resize the images later ([Resize] → “User’s Guide/Troubleshooting” (page 68)).

On the recordable number of still images

Recordable number of still images vary depending on the image size selected.

For details on recordable number → “User’s Guide/Troubleshooting” (page 23)

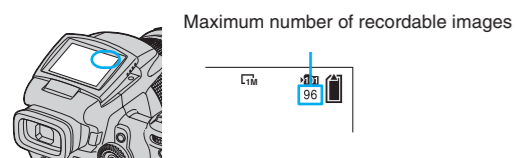

• The number of recordable images can differ according to shooting conditions.

Selecting a flash mode for still images

The flash automatically pops up and strobes when the surroundings are dark or shoot the backlit subject (A (Auto)). Close the flash by hand after use.

When reducing red-eye or not using the flash

Press and hold (Flash) and turn the main command dial to select A (Auto with red-eye reduction) or (No flash).

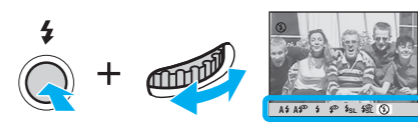

- For details on the flash mode → “User’s Guide/Troubleshooting” (page 50)
- Shooting distance (when [ISO] is set to [AUTO])
W side: Approx. 0.5 to 8.5 m (1 feet 7 3/4 inches to 27 feet 10 3/4 inches)
T side: Approx. 0.4 to 5.0 m (1 feet 3 3/4 inches to 16 feet 4 7/8 inches)
- The flash strobes twice. The first time is to adjust the light quantity.

Shooting close-up (Macro)

Before step 3, set the FOCUS switch to .

To cancel, set to AUTO.



- The in-focus range becomes narrow, and the complete subject may not entirely be in focus.
- The Auto Focus speed drops.

Shortest shooting distance from the ϕ base point of distance mark

Setting all the way to the W side: Approx. 35 cm (13 7/8 inches)

Setting all the way to the T side: Approx. 40 cm (15 3/4 inches)

Using the self-timer

Before step 3, press (Self-timer).

Press the shutter button, the self-timer lamp flashes, and a beep sounds until the shutter operates (approximately 10 seconds later).

To cancel, press again.

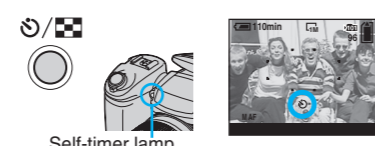

If you shoot a still image of a subject that is difficult to focus on

- If the subject is closer than approx. 50 cm (19 3/4 inches), use the Macro mode (left column).
- When the camera cannot focus on the subject automatically, the AE/AF lock indicator changes to flashing slowly and the beep does not sound. Recompose the shot and focus again or manually adjust the focus in manual focus mode.

Subjects difficult to focus on are:

- Distant from the camera and dark
- The contrast between the subject and its background is poor.
- Seen through glass
- Moving fast
- Reflective light or with a lustrous finish
- Flashing
- Backlit

To identify items on the screen

→ “User’s Guide/Troubleshooting” (page 19)

To shoot using the finder

With the FINDER/AUTO/LCD switch, you can choose to shoot either using the finder or the LCD screen. When set to AUTO, the current screen is automatically switched between the finder and the LCD screen. You can immediately react to the various angles.

FINDER: The image appears in the finder and it does not appear on the LCD screen.

AUTO: When you move your head away from the finder, the available screen is automatically switched from the finder to the LCD screen.

LCD: The image appears on the LCD screen and it does not appear in the finder.

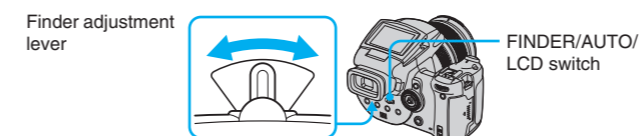

Adjust the finder adjustment lever until the image appears clearly within the finder, then shoot the image.

- The camera may not automatically detect in the following situations. In such cases, set to a position other than AUTO.
– When using the finder with eyeglasses on under extremely bright outdoor light. → FINDER
– When using the LCD screen holding the finder closer to your body, such as a shooting at waist level. → LCD

To view an enlarged image (playback zoom)

Press (Playback zoom) while displaying a still image, the image is enlarged double.

Adjust the portion: Multi-selector ()

Adjust the zoom scaling: Sub command dial



Cancel playback zoom: press or the center of the multi-selector

To store enlarged images: [Trimming] → “User’s Guide/Troubleshooting” (page 70)

Viewing an index screen

Press (Index) and select an image by moving the multi-selector to .

To return to the single-image screen, press the center of the multi-selector. To display the next (previous) index screen, keep moving to .

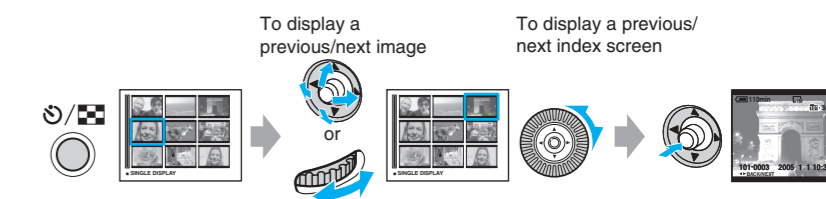

To delete images in index mode

- 1 While an index screen is displayed, press AE LOCK/ (Delete) and select [Select] by moving the multi-selector to , then press the center of the multi-selector.
- 2 Select the image you want to delete by moving the multi-selector to , then press the center of the multi-selector to display the (Delete) indicator on the selected image.

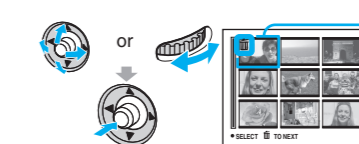

Green frame

To cancel a selection
Select an image you have previously selected for deletion, then press the center of the multi-selector to delete the indicator from the image.

3 Press AE LOCK/ (Delete).

4 Select [OK] by moving to , then press the center of the multi-selector.

- To delete all the images in the folder, select [All In This Folder] by moving to in step 1 instead of [Select], then press the center.