

FROSTIG

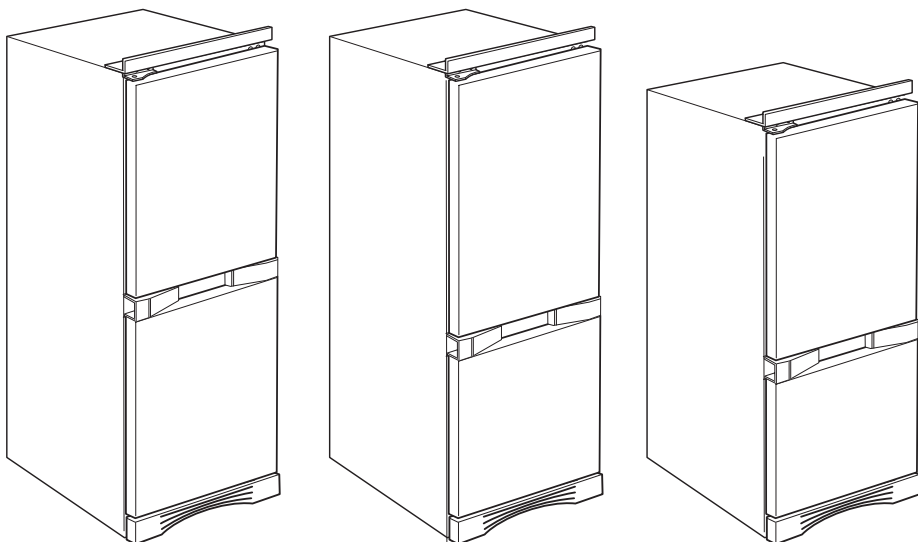

- D
- GB
- F
- NL
- E
- P
- I
- GR
- S
- N
- DK
- FIN
- PL
- CZ
- SK
- H
- RUS
- BG
- RO

for
IKEA[®]
from
Whirlpool[®]

- D** *Bitte beachten!* Der Installationsablauf ist für Produkte mit Scharnier auf der rechten Seite dargestellt (Produktionsstandard). Der Türanschlag des Geräts kann jedoch bei Bedarf gewechselt werden (Scharnier links).
- GB** *Important!* The installation steps are illustrated for products with hinges on the right side (according to production). The doors can in any case be reversed (hinges on left side) if necessary.
- F** *Attention!* Les séquences d'installation sont illustrées par produit, avec les charnières placées du côté droit (positionnement de fabrication). Il est toutefois possible d'inverser le sens d'ouverture des portes de l'appareil (charnières positionnées à gauche) si cela s'avère nécessaire.
- NL** *Let op!* De installatievolgorde is geïllustreerd voor producten met scharnieren aan de rechterkant (zoals gefabriceerd). Het is echter ook mogelijk om de deuren van het product om te keren (scharnieren aan de linkerkant) als dit noodzakelijk is.
- E** *¡Atención!* La secuencia de instalación se muestra por producto, con la bisagra situada a la derecha (como viene de fábrica). Sin embargo, se puede cambiar el lado de apertura de la puerta del aparato (bisagra en el lado izquierdo) en caso de necesidad.
- P** *Atenção!* As sequências de instalação ilustradas referem-se a produtos com dobradiças posicionadas no lado direito (de acordo com a produção). É, em todo o caso, possível mudar o sentido de abertura das portas do produto (dobradiças do lado esquerdo) caso seja necessário.
- I** *Attenzione!* Le sequenze d'installazione sono illustrate per prodotti con cerniere posizionate sul lato destro (come da produzione). È comunque possibile effettuare la reversibilità delle porte del prodotto (cerniere lato sinistro) in caso di necessità.
- GR** *Προσοχή!*
Η διαδικασία της εγκατάστασης παρουσιάζεται για προϊόντα με μεντεσέδες στη δεξιά πλευρά (εργοστασιακής παραγωγής). Σε περίπτωση ανάγκης μπορείτε ωστόσο να αντιστρέψετε τις πόρτες του προϊόντος (μεντεσέδες στην αριστερή πλευρά).
- S** *Observera!* De illustrerade installationssekvenserna gäller apparater med gångjärn på höger sida (sådan som apparaten levereras). Vid behov går det dock att hänga om dörrarna (dvs. placera gångjärnen på vänster sida).
- N** *Merk!* Installasjonsprosedyren som vises er for høyrehengslede produkter (slik de leveres fra fabrikkjen). Det er imidlertid mulig å hengsle om dørene på produktet (hengsler på venstre side) ved behov.
- DK** *Bemærk!* Rækkefølgen af monteringen vises for produkter med hængsel i højre side (fra fabrikkjen). Det er dog muligt efter behov at foretage vending af produktets døre (hængsel i venstre side).
- FIN** *Huomio!* Esitetyt asennusohjeet koskevat laitteita, joissa oven saranat ovat oikealla puolella (valmistuskokoonpano). Laitteen ovien kätisyys on kuitenkin tarvittaessa vaihdettavissa (vasemmalta avautuvaksi).
- PL** *Uwaga!* Kolejność instalacji na rysunku jest przedstawiona dla urządzeń, w których zawiasy są umieszczone z prawej strony (fabrycznie). Można, jednakże, zmienić kierunek otwierania drzwi (zawiasy z lewej strony), jeśli zaistnieje taka potrzeba.
- CZ** *Upozornění!* Zobrazený postup instalace platí pro spotřebiče se závěsy umístěnými na pravé straně (provedení z výroby). V případě potřeby je možné změnit stranu otvírání dveří spotřebiče (závěsy na levé straně).
- SK** *Dôležité upozomenie!* Znázornený postup pri inštalácii sa vzťahuje na spotrebiče so závesmi umiestnenými na pravej strane (z výroby). V každom prípade je možné, v prípade potreby, zmeniť smer otvárania dverí spotrebiča (závesy na ľavej strane).
- H** *Figyelem!* A készülékek üzembe helyezési útmutatójában az ajtó jobb oldalára (gyárilag) felszerelt forgópántok láthatók. Szükség esetén azonban az ajtónyitás iránya felcserélhető (a forgópántok átszerelhetőek a bal oldalra).
- RUS** *Внимание!* Последовательность установки проиллюстрирована на примере изделий с петлями, расположенными с правой стороны (заводское исполнение). Однако в случае необходимости существует возможность перенавески дверцы изделия (петли с левой стороны).
- BG** *Внимание!* Последователността на инсталиране са илюстрирани за уреди с панти, поставени на дясната страна (както идват от производството). Възможно е да се изпълни и обръщане на вратите на уреда (панти на лявата страна), ако е необходимо.
- RO** *Atenție!* Secvențele de instalare sunt ilustrate pentru produse cu balamalele poziționate pe latura dreaptă (din producție). Oricum, se poate efectua reversibilitatea uşilor produsului (cu balamalele pe latura stângă) în caz de nevoie.

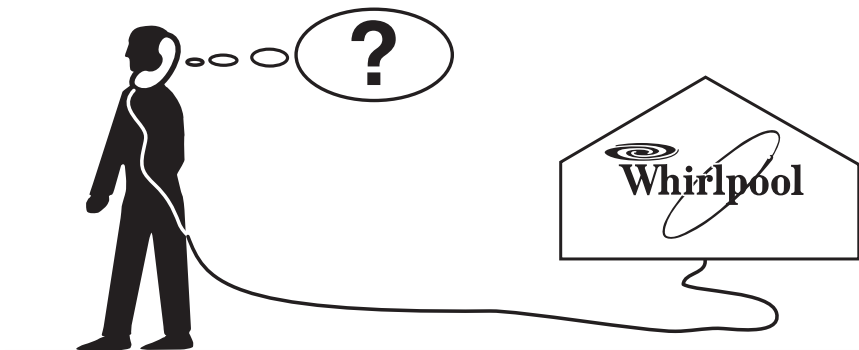
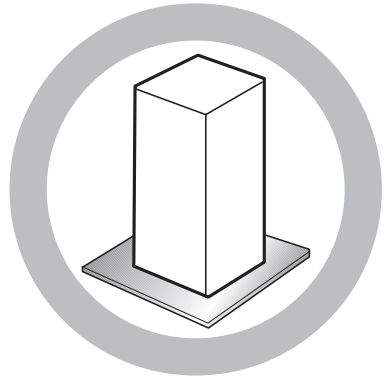
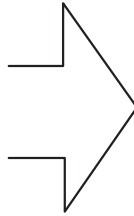
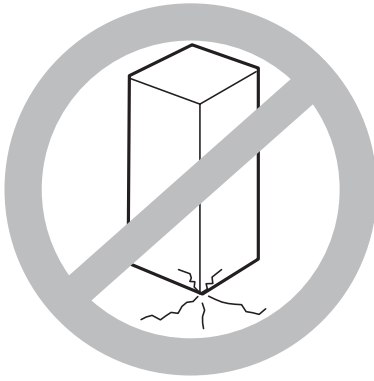
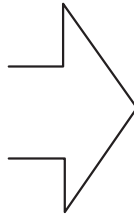
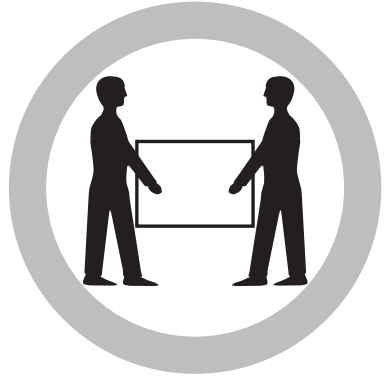
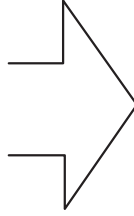

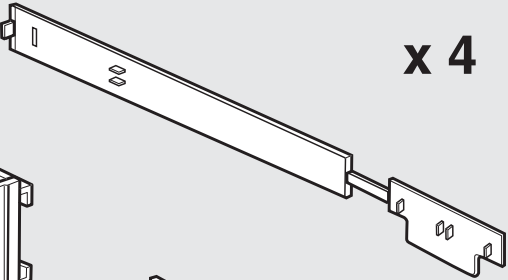
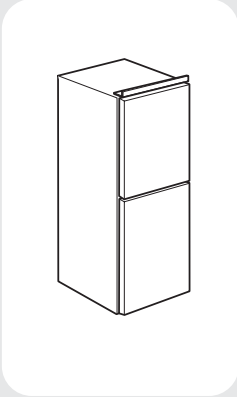

x 4



x 4

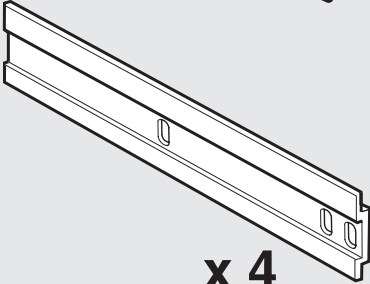

x 4

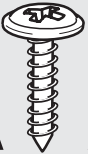

A x 20



C x 8

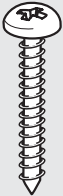

B x 2

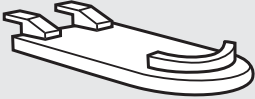

x 2

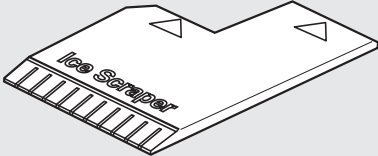

x 1

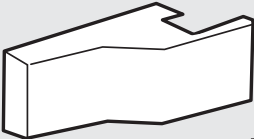

x 1

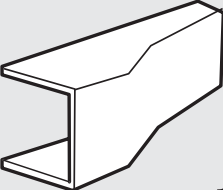

x 1



x 4

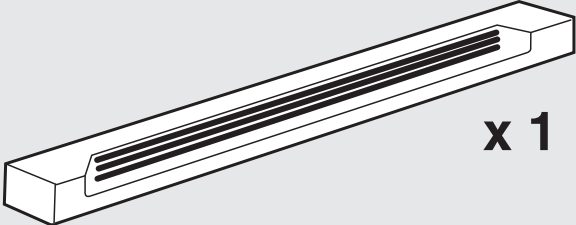

x 1

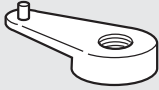

x 2

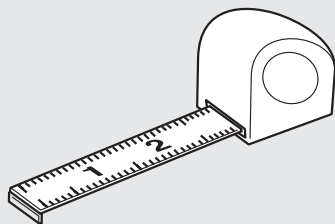
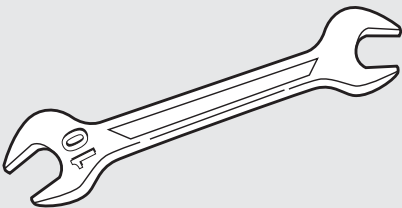
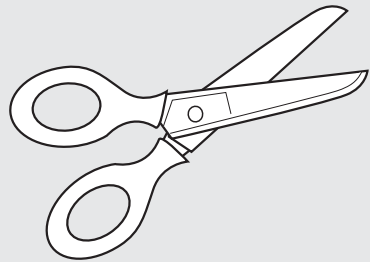
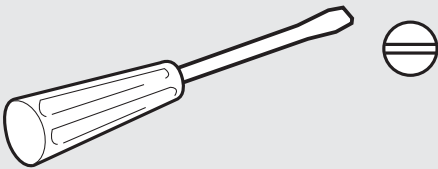
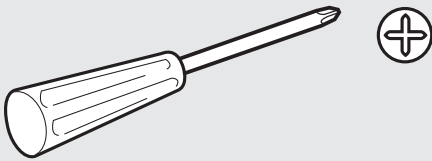
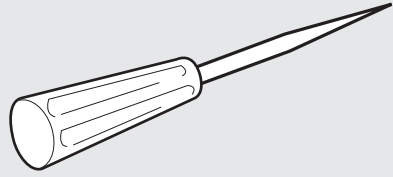
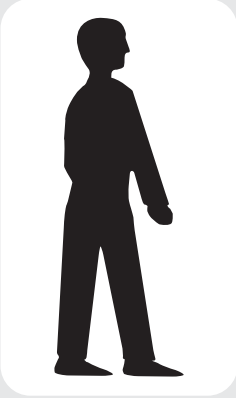

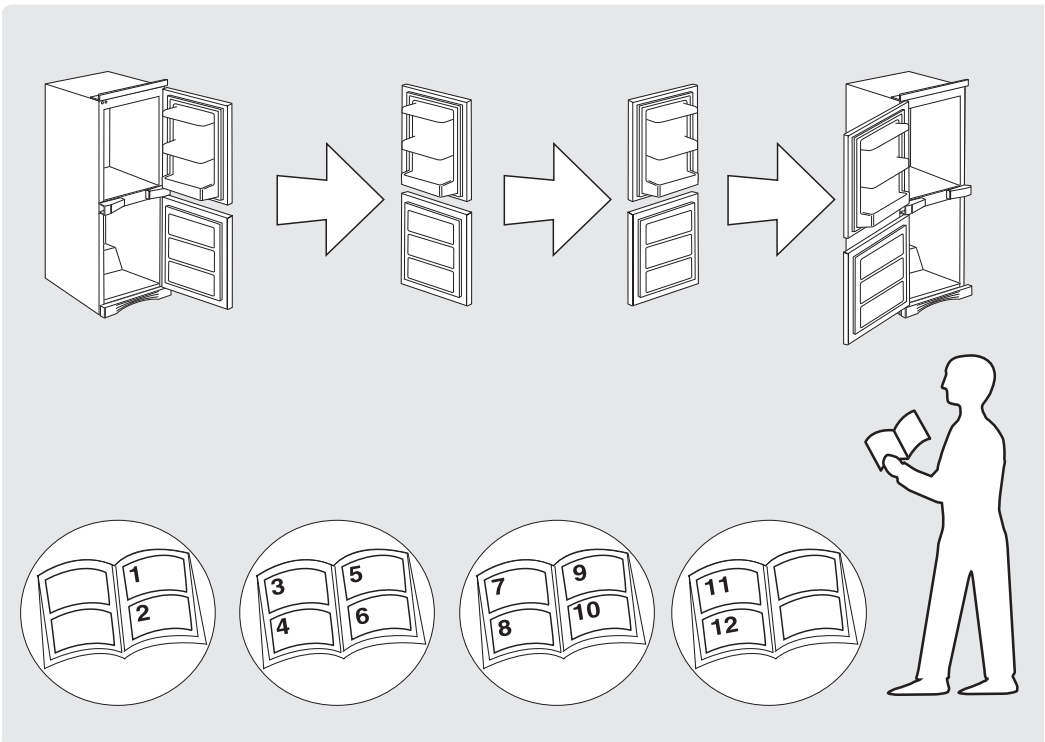
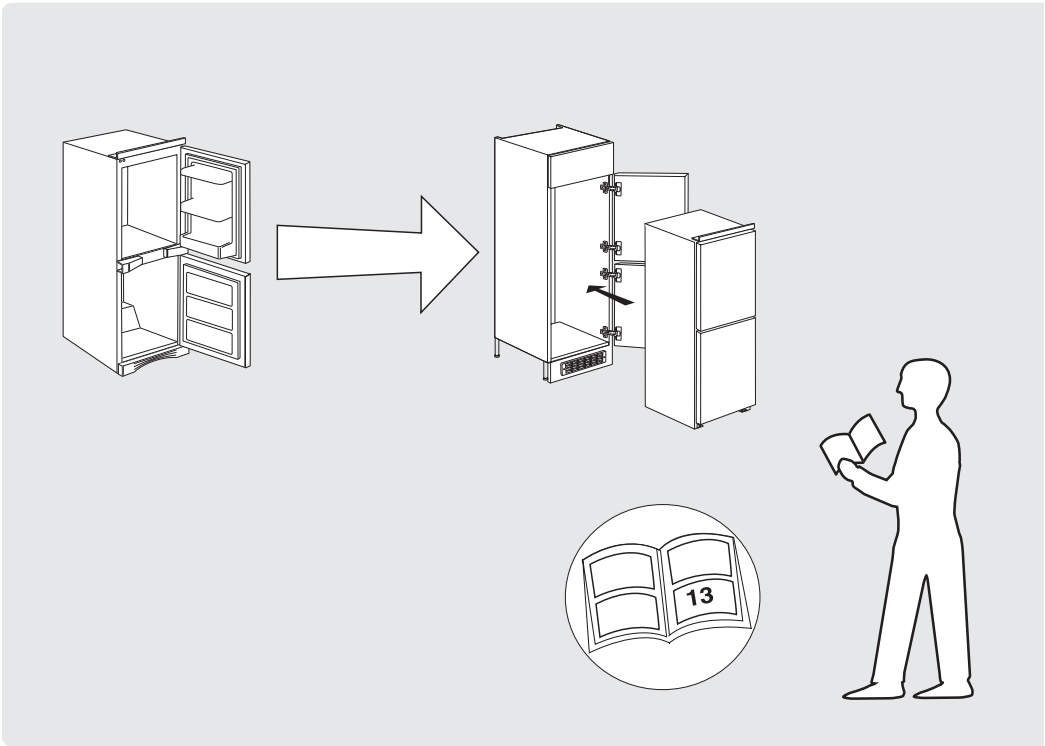

1

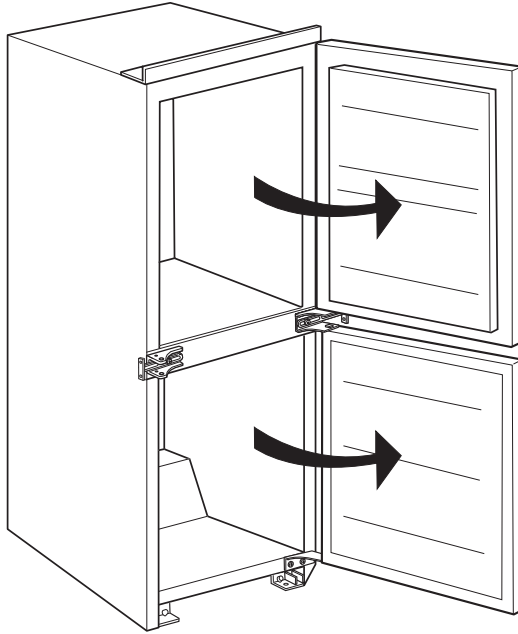

2

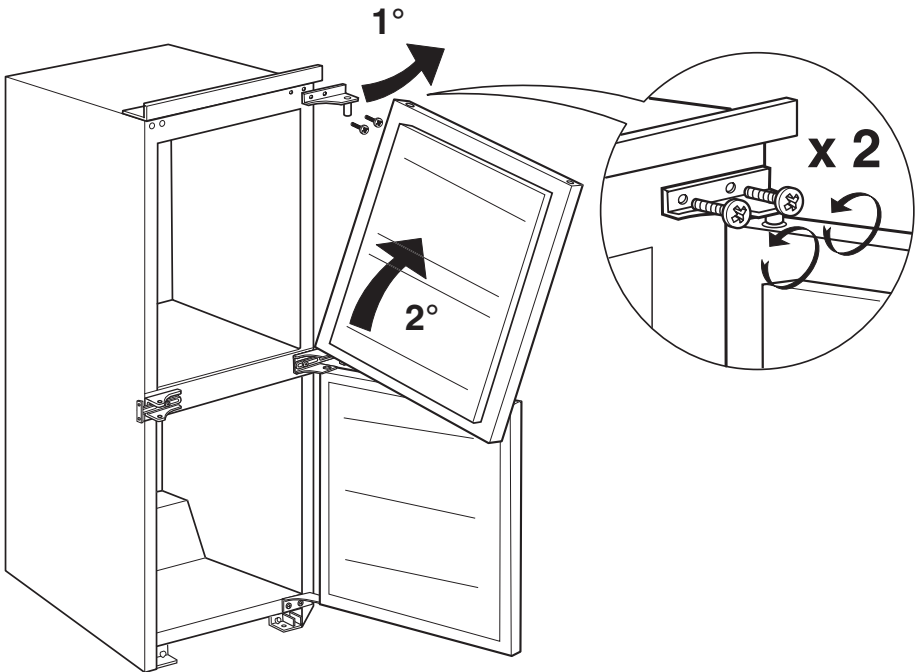

3

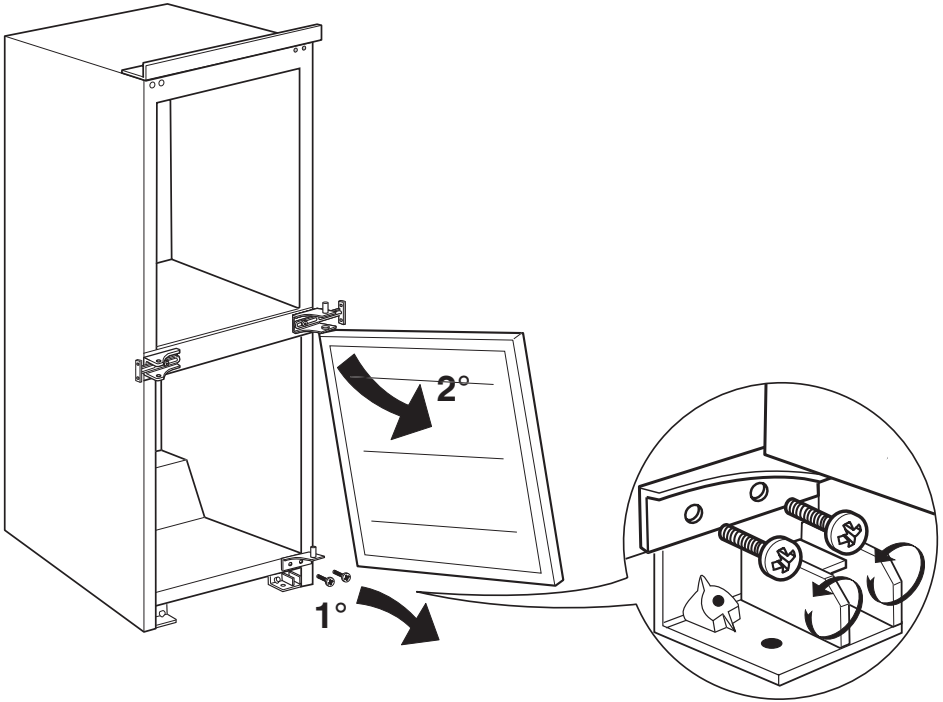

4

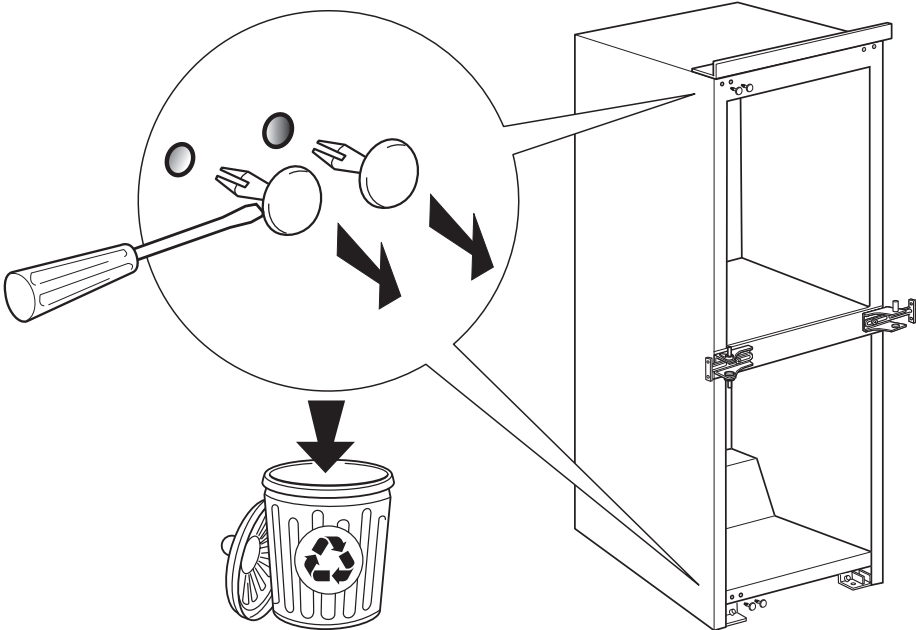

5

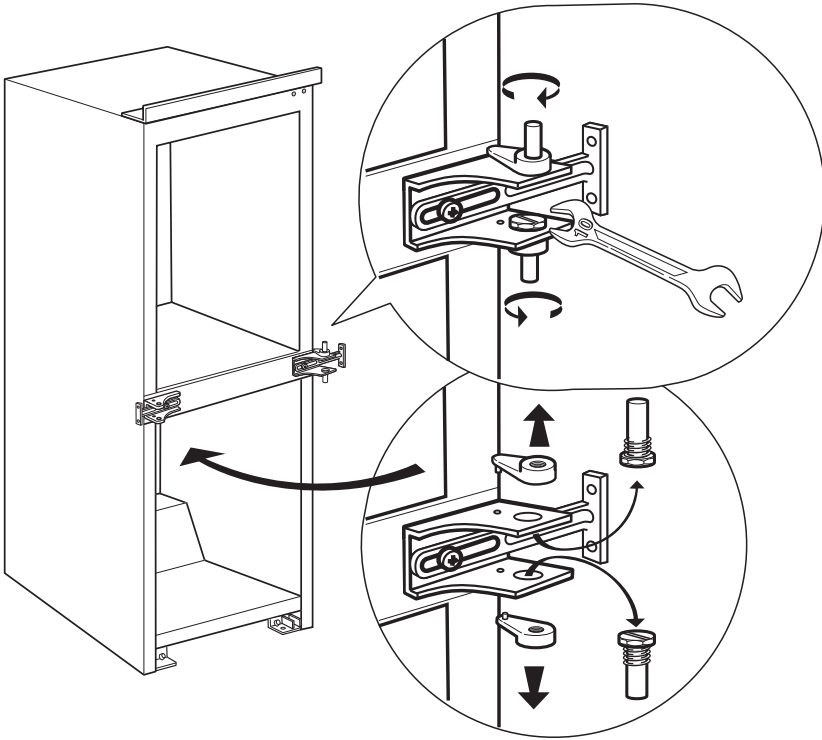

6

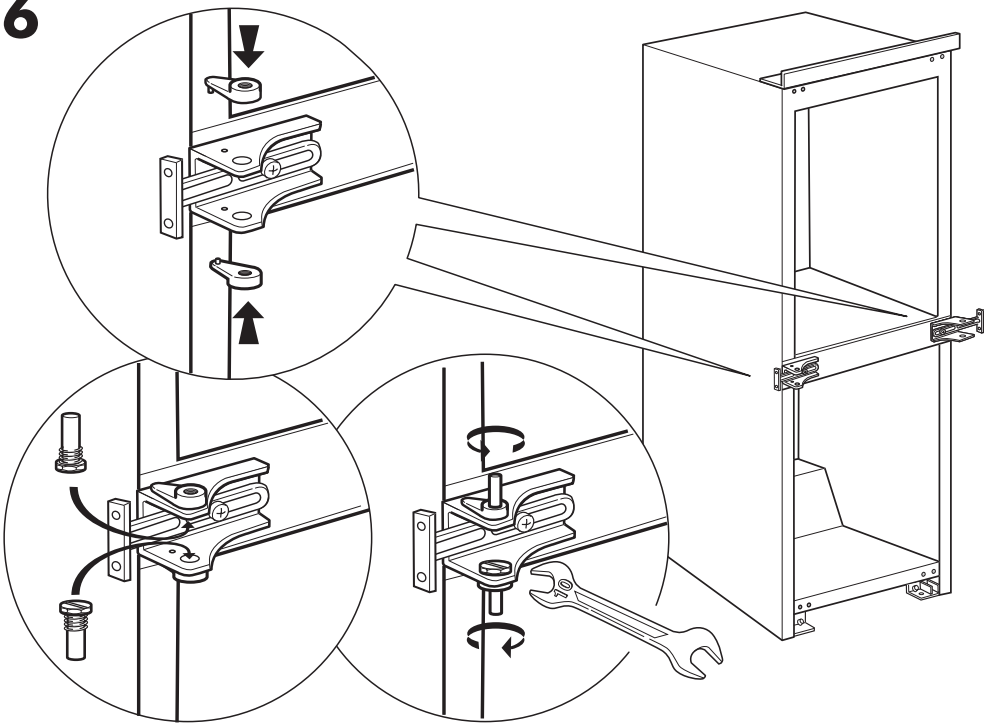

7

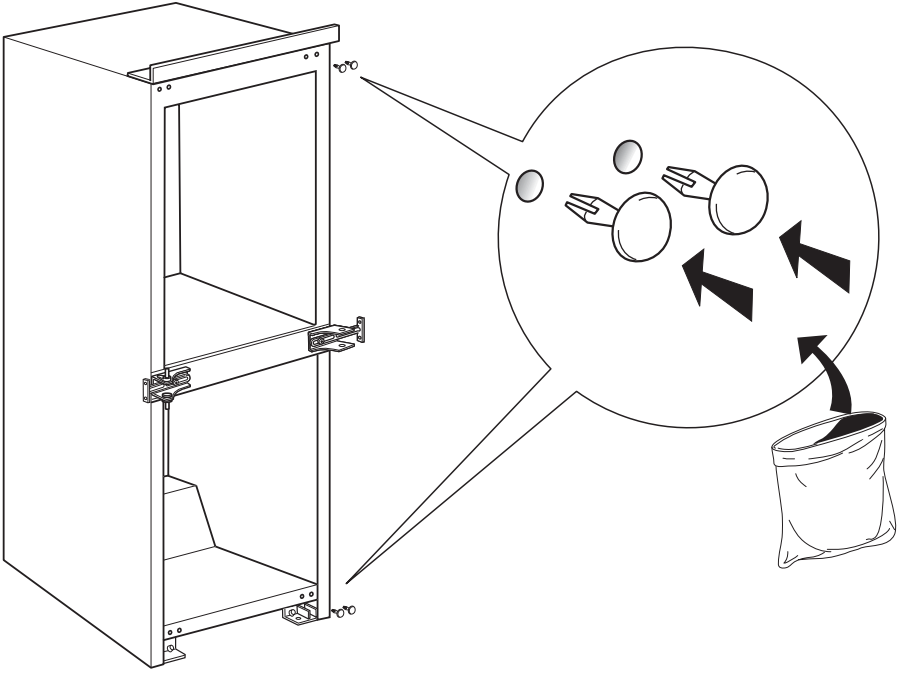

8

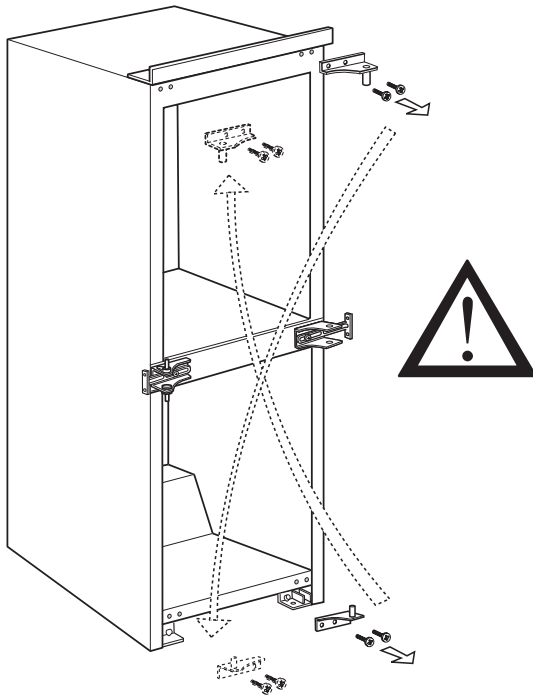

9

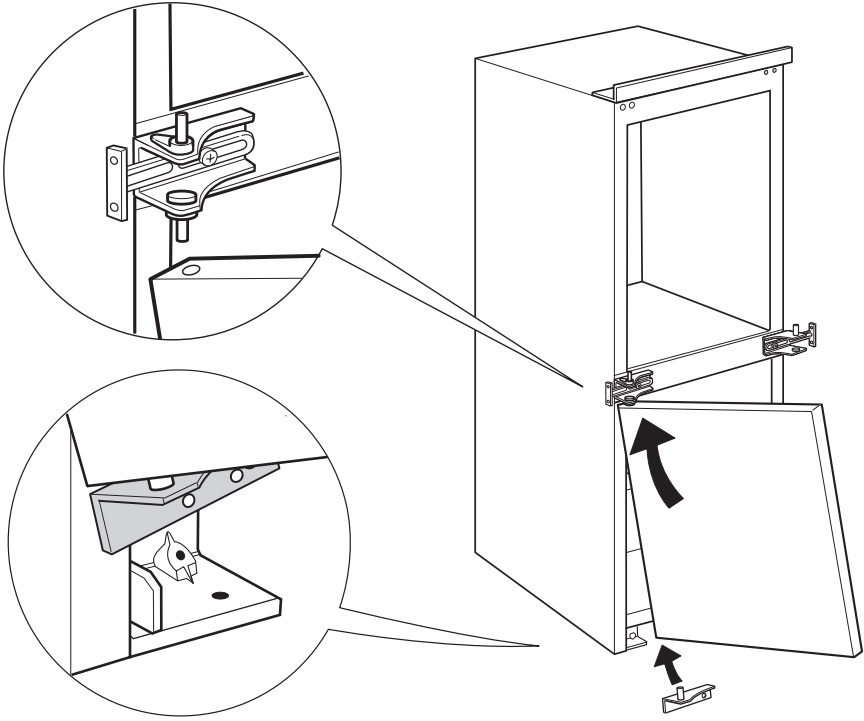

10

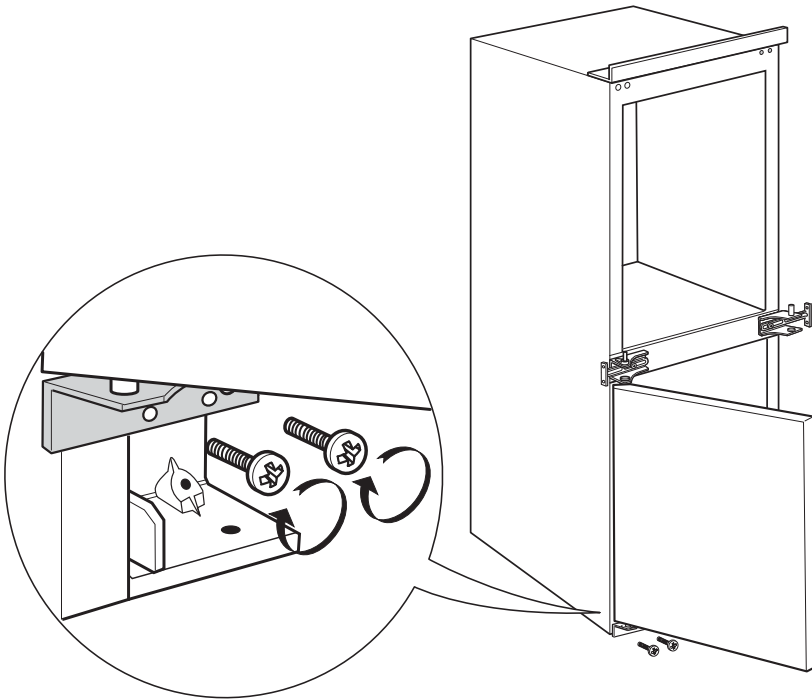

11

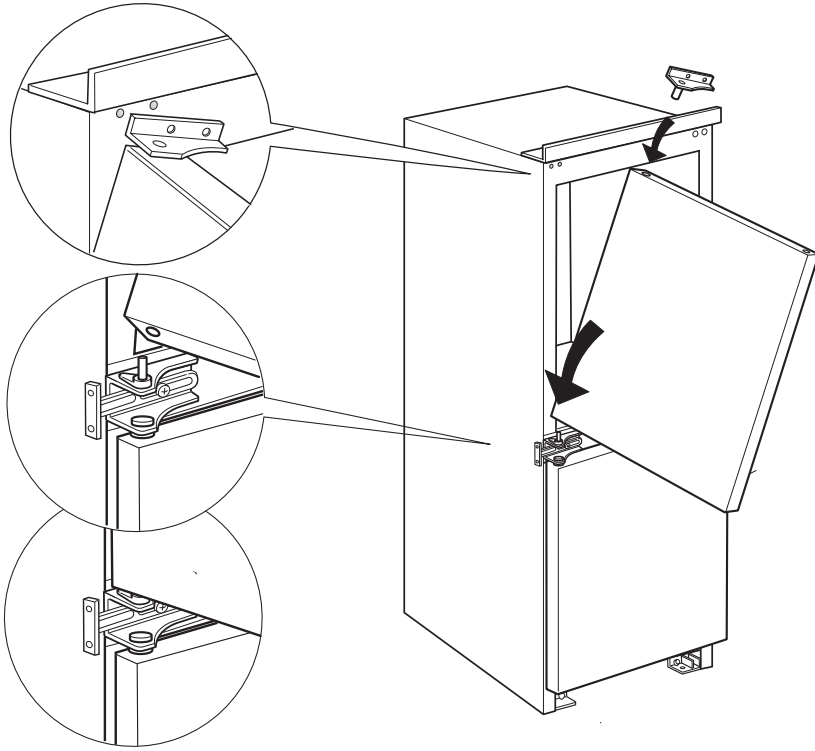

12

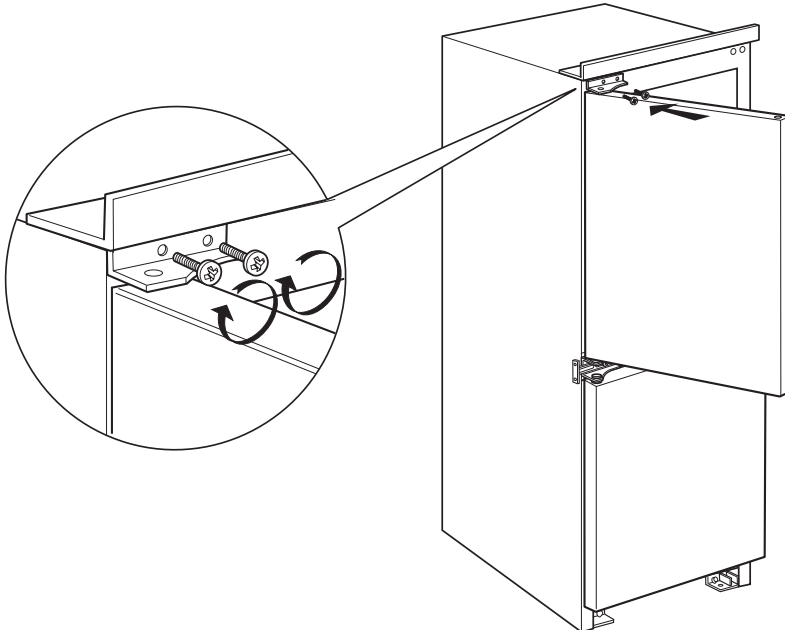

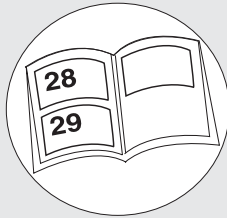
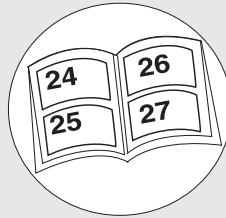
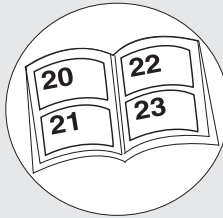
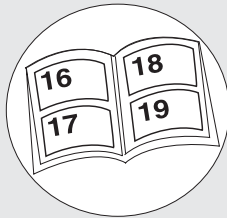
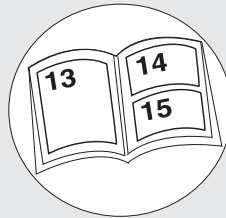
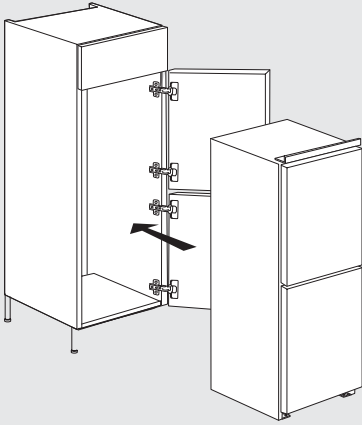

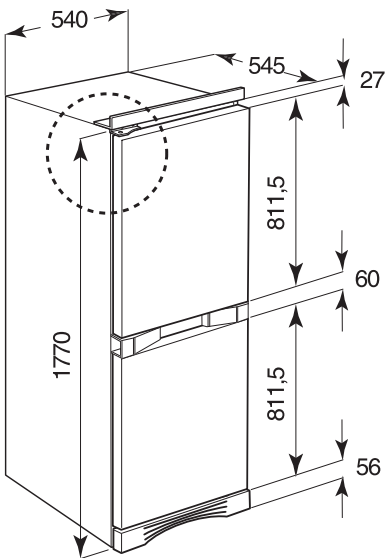
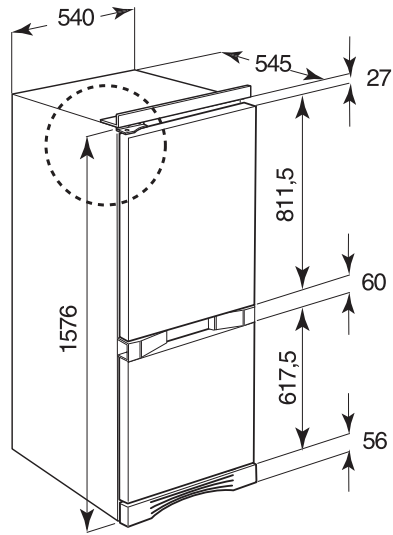
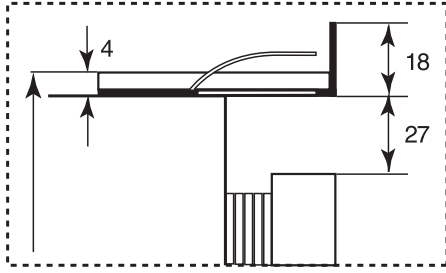
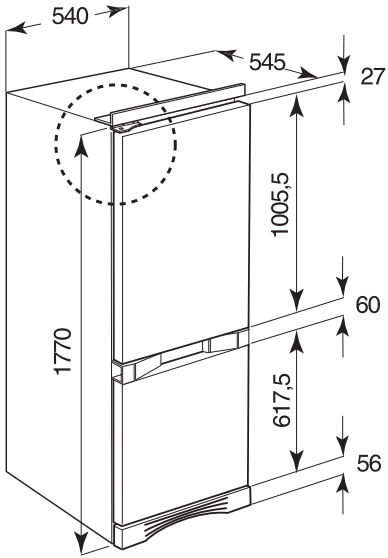

mm

14

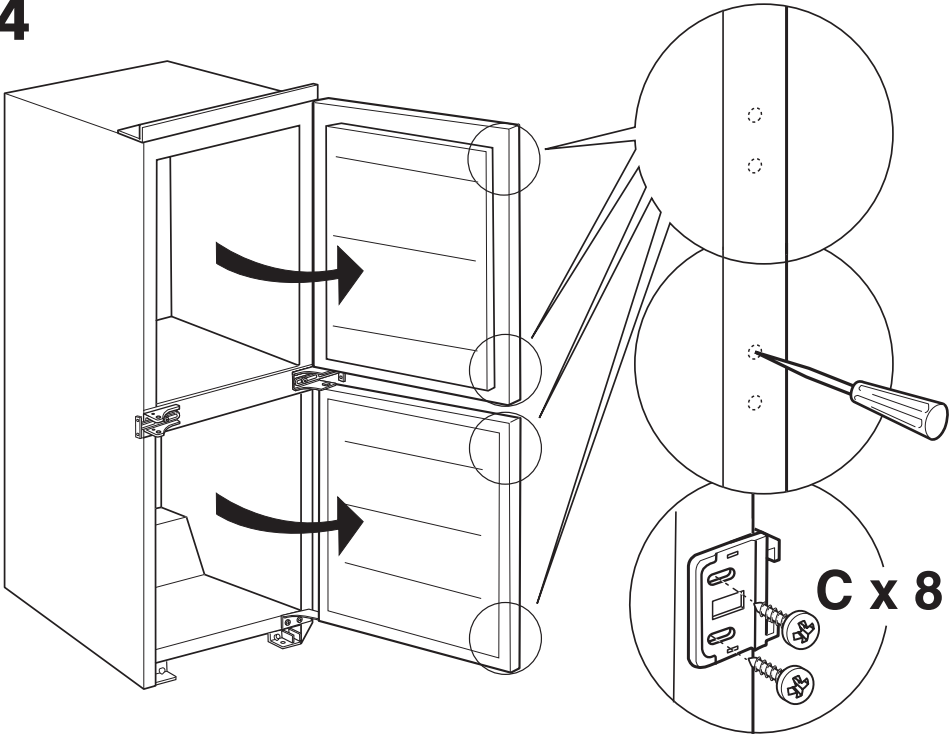

15

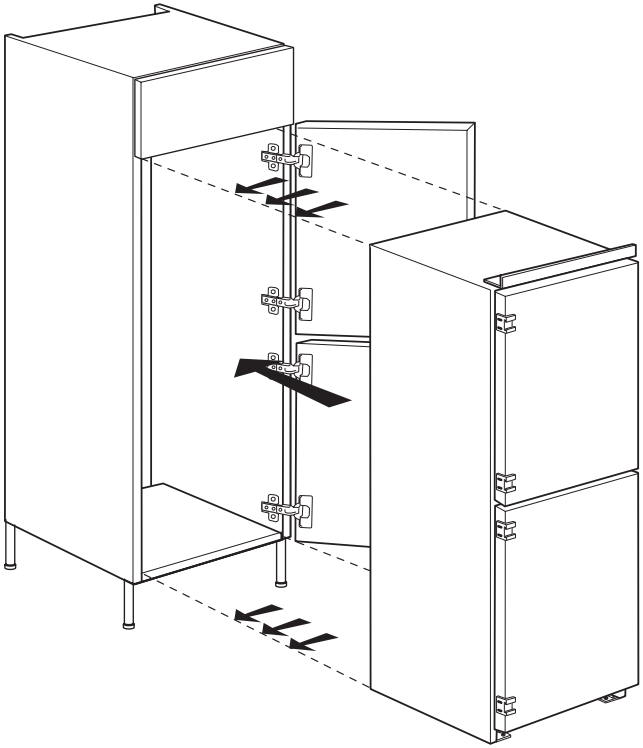

16

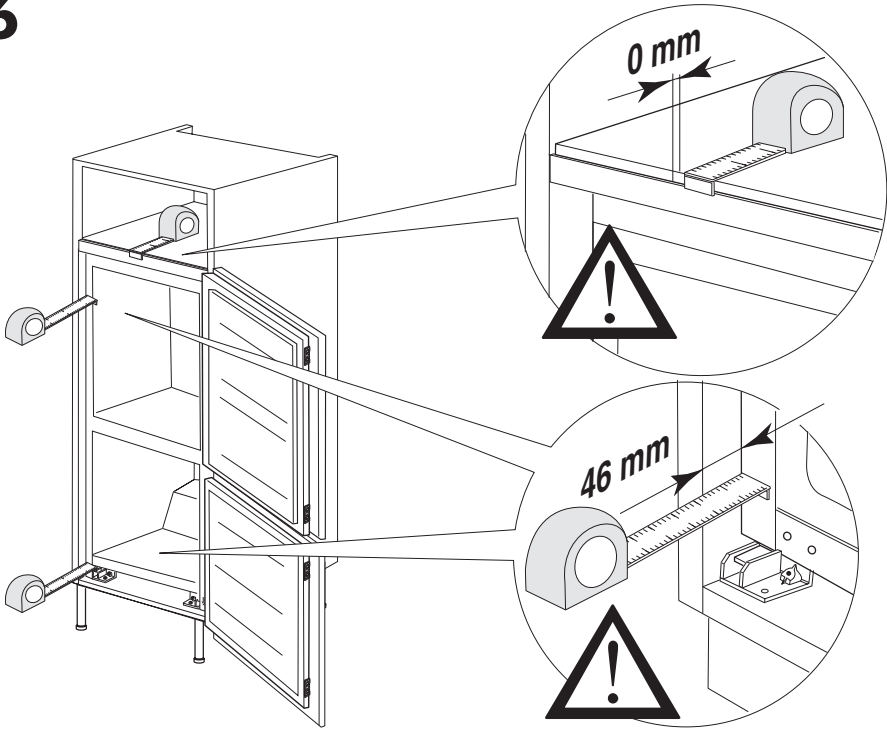

17

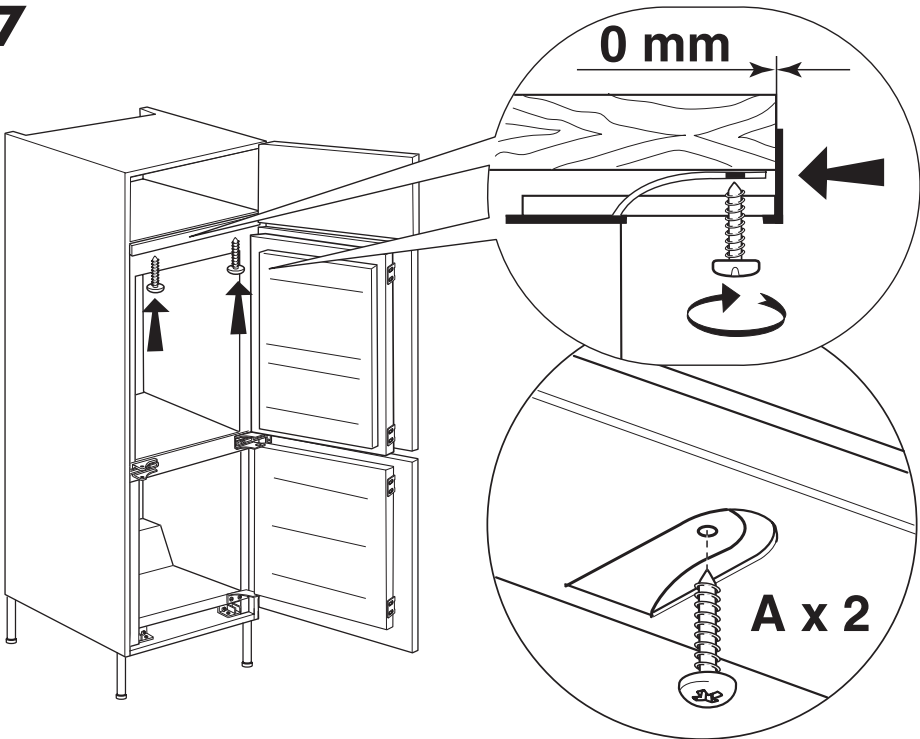

18

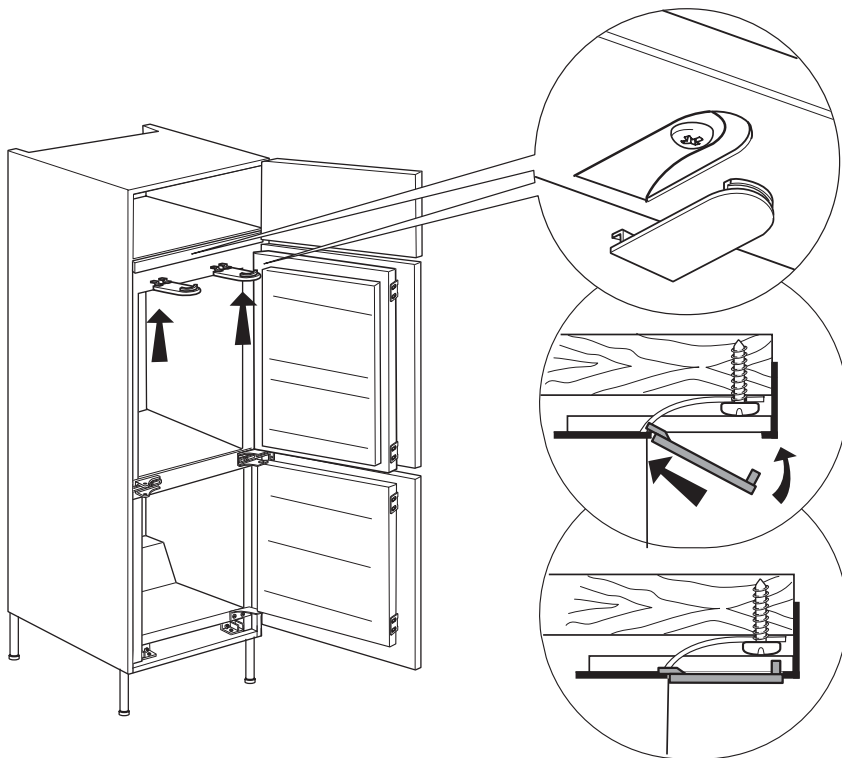

19

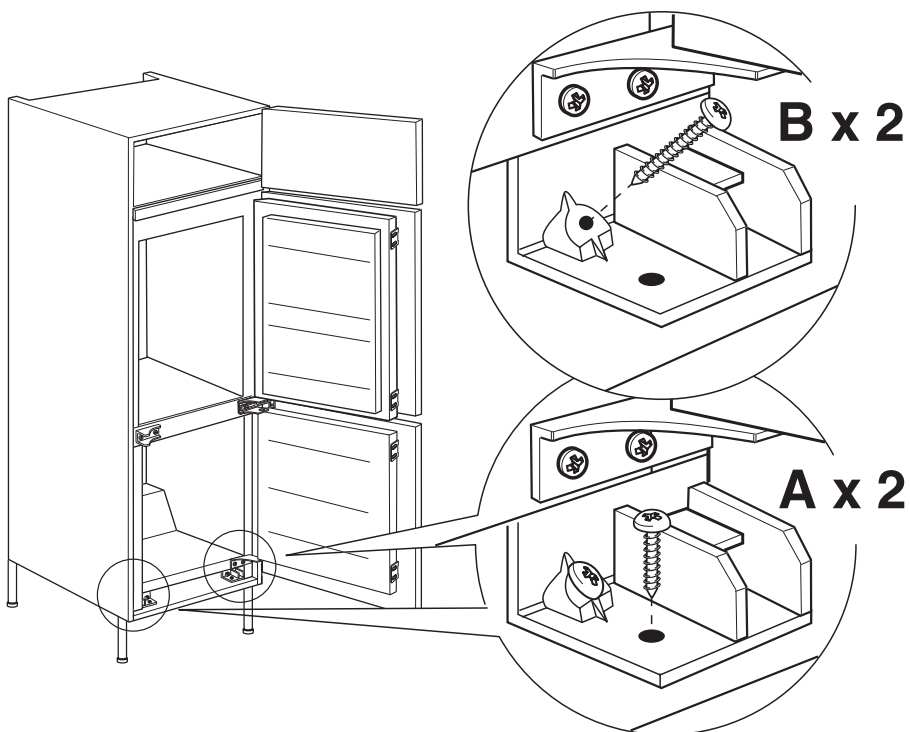

20

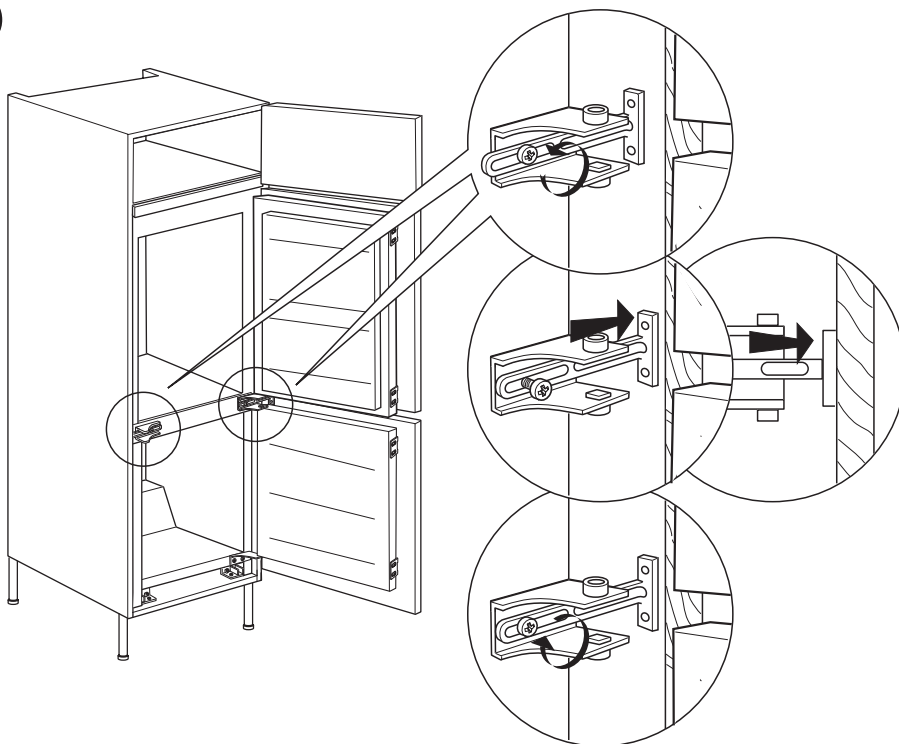

21

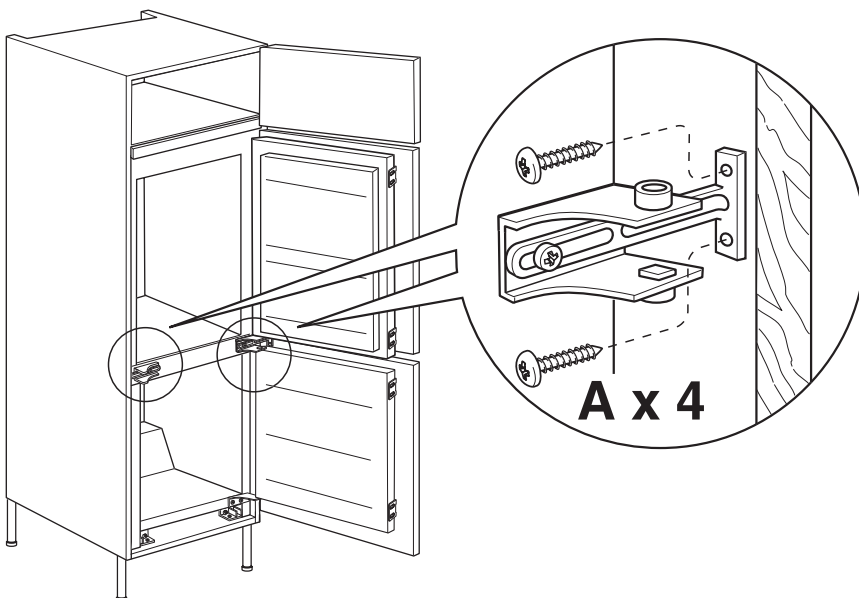

22

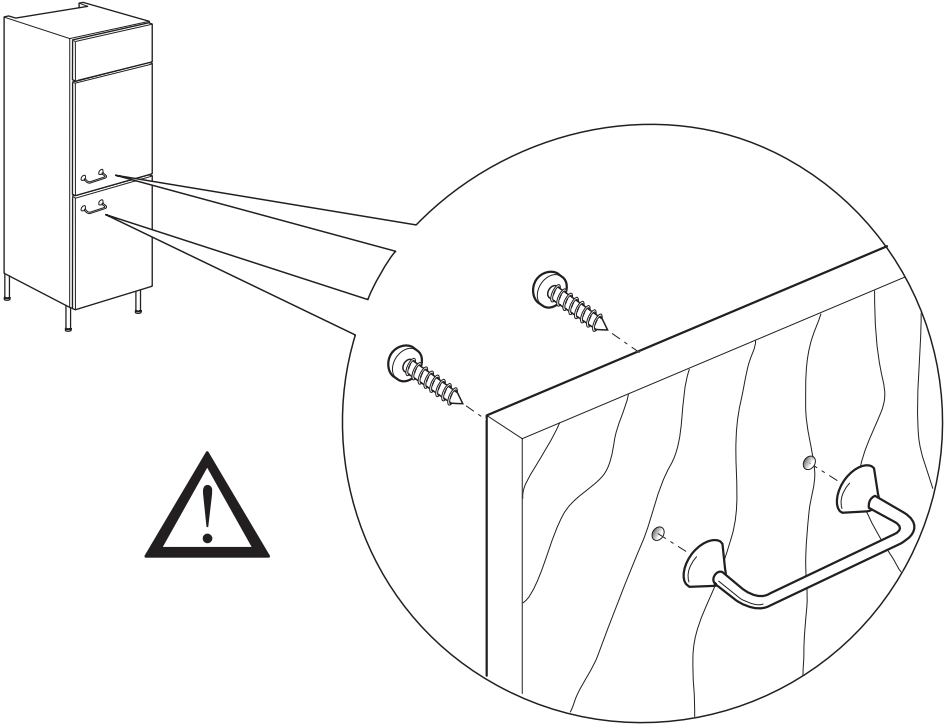

23

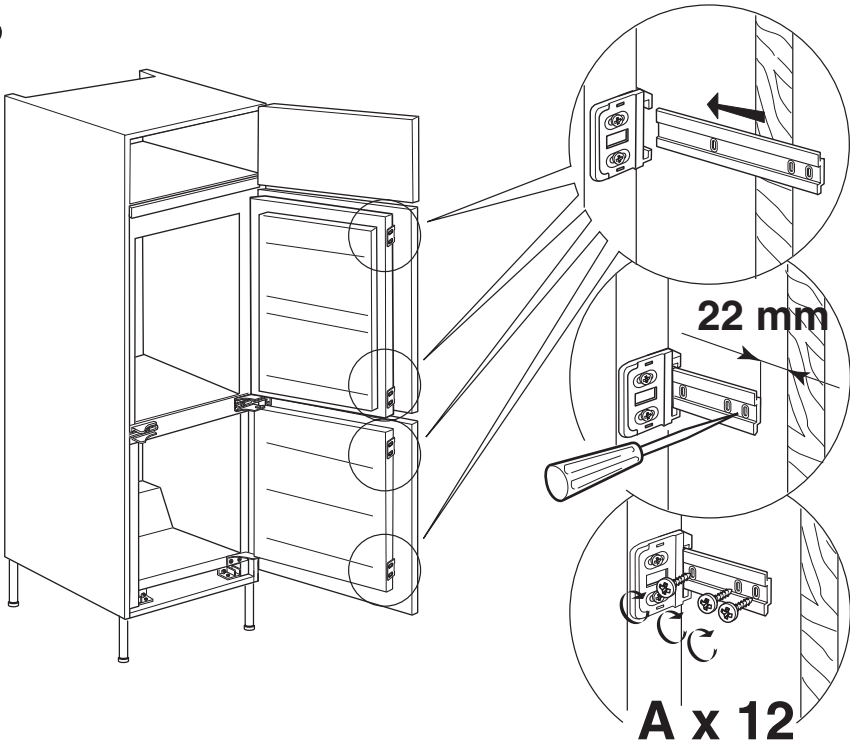

24

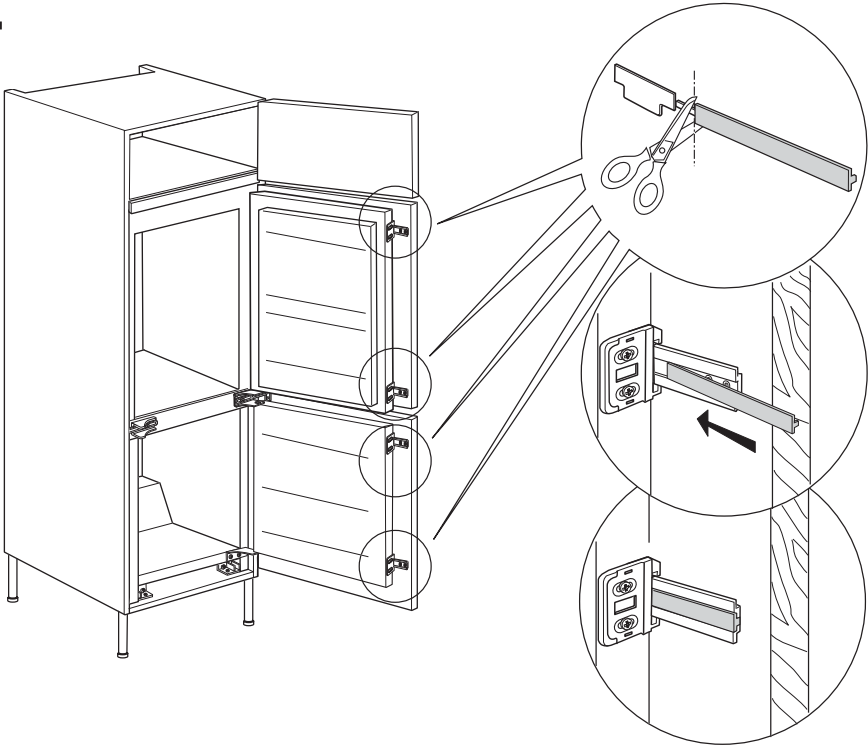

25

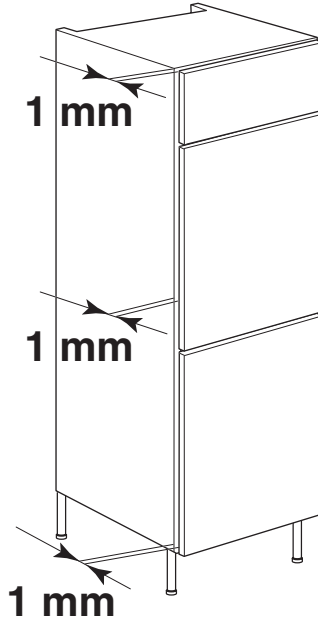

26

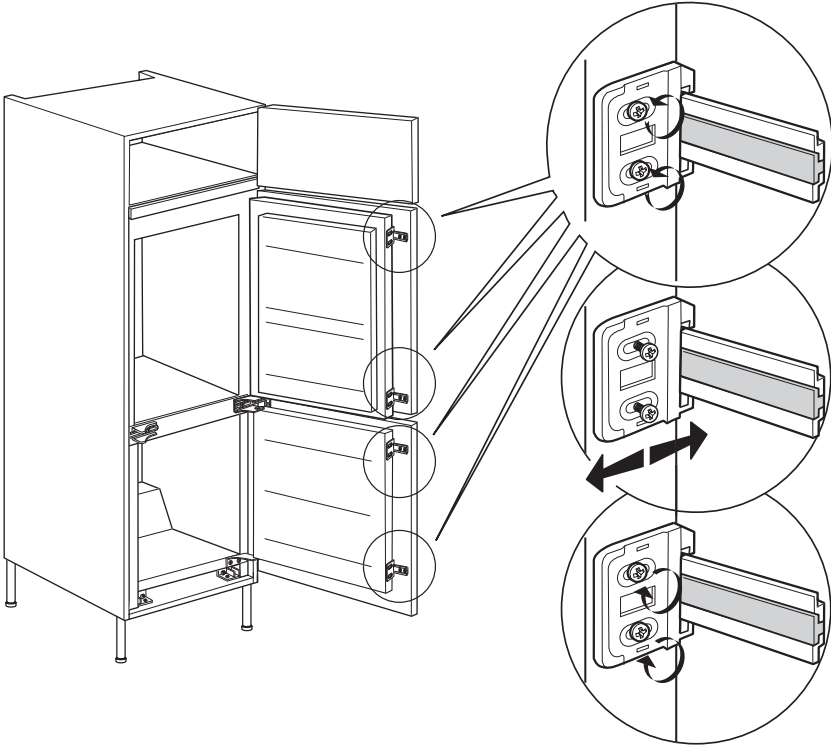

27

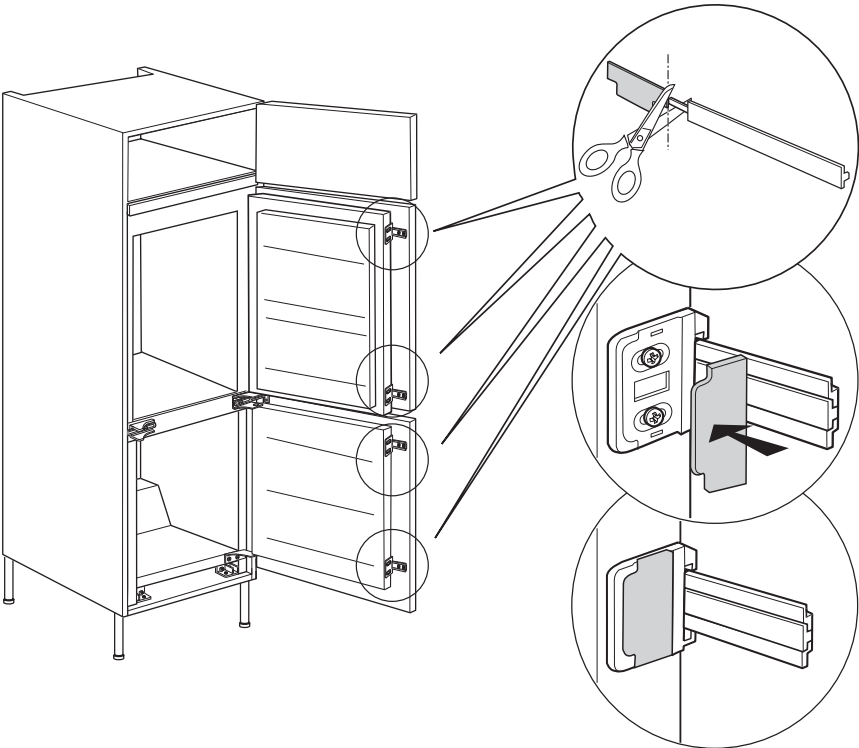

28

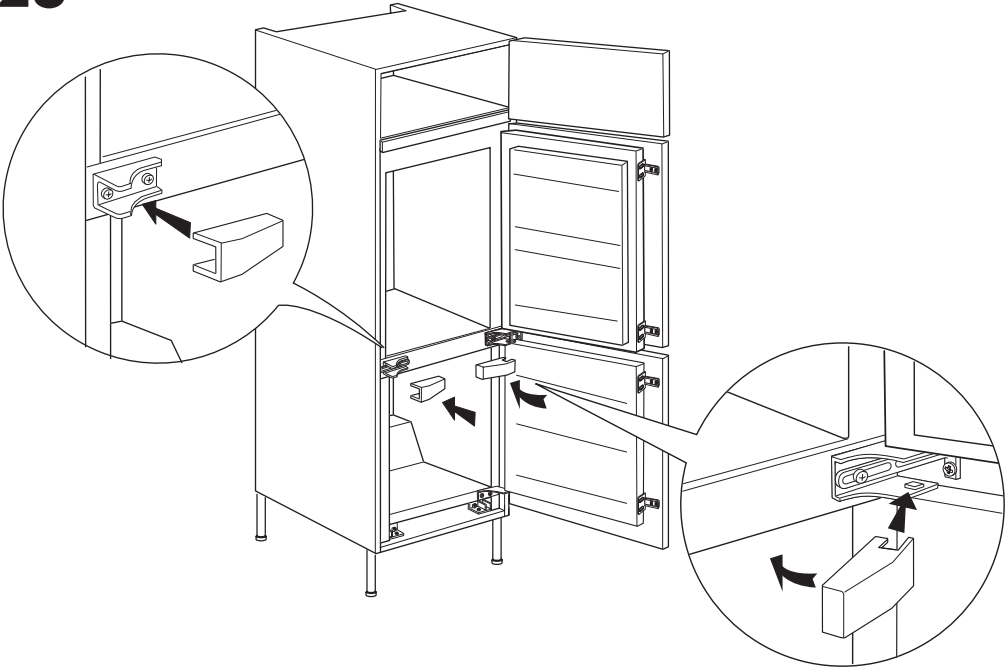

29

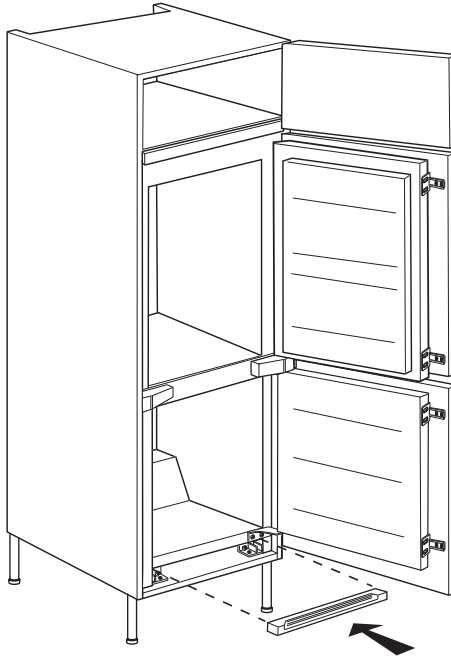

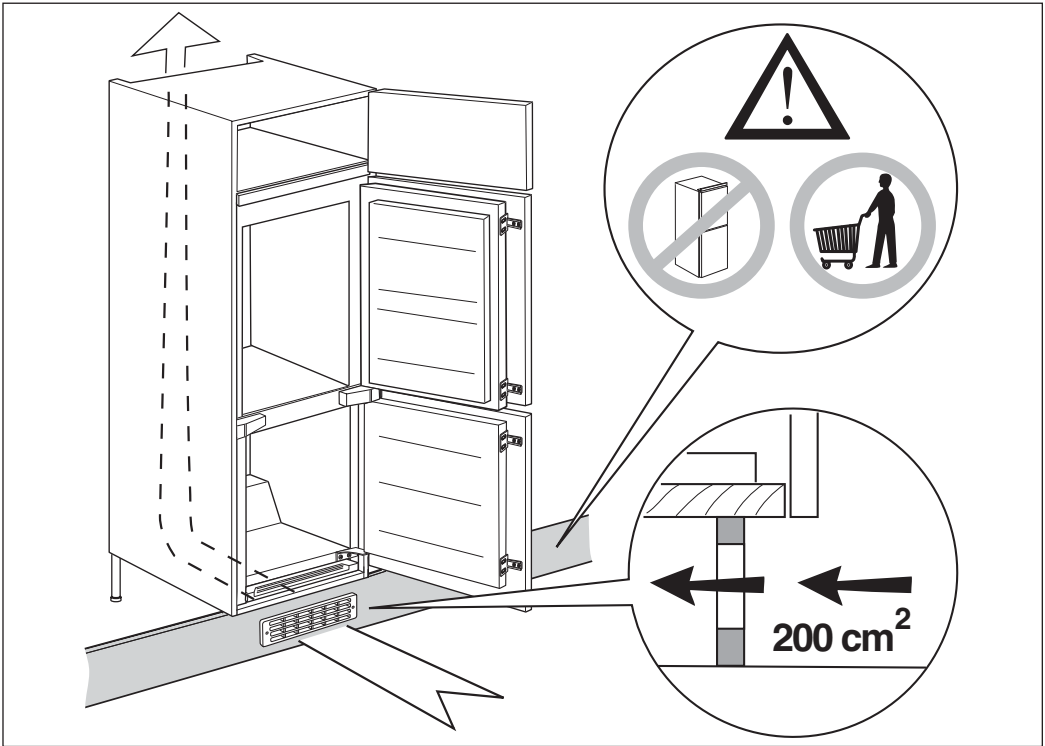

Whirlpool is a registered trademark of Whirlpool, U.S.A.
© Copyright Whirlpool Europe s.r.l. 2006. All rights reserved.
IKEA is a registered trademark of Inter IKEA Systems B.V., the Netherlands