



THE COMPUTER IS PERSONAL AGAIN.

Location, availability, and number of connectors may vary. De locatie, beschikbaarheid en het aantal connectors kunnen variëren. A localização, disponibilidade e número de fichas poderão variar.

QUICK SETUP
SNELE INSTALLATIE
CONFIGURAÇÃO RÁPIDA

Keyboard and Mouse

Wired option. Match the colors.

Toetsenbord en muis

Bekabelde optie. De kleuren afstemmen.

Teclado e rato

Opção com fio. Corresponder as cores.



Wireless option.

Refer to the setup instructions located in your keyboard box.

Draadloze optie. Raadpleeg de installatie-instructies die bij uw toetsenbord werden geleverd.

OPMERKING: Het toetsenbord en de muis worden door dezelfde ontvanger aangestuurd.

Opção sem fios. Consulte as instruções de configuração localizadas na caixa do teclado.

NOTA: O mesmo receptor controla o teclado e o rato.

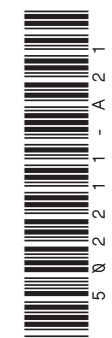

Monitor

Refer to the setup instructions that came with your monitor. Monitors may be sold separately.

Monitor

Raadpleeg de installatie-instructies van uw monitor. Monitoren worden mogelijk afzonderlijk verkocht.

Monitor

Consulte as instruções de configuração fornecidas com o monitor. Os monitores podem ser vendidos em separado.

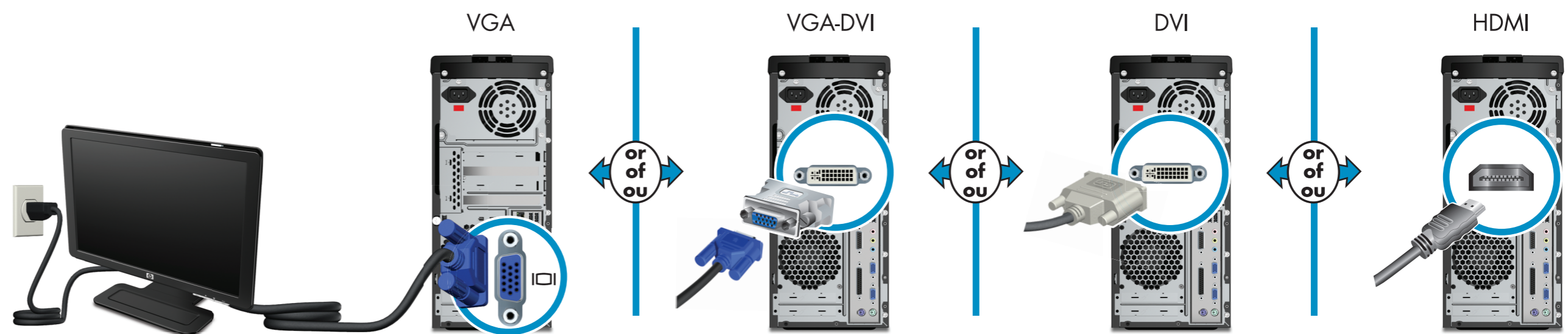

Speakers

Refer to the setup instructions that came with your speakers. Speakers may be sold separately.

Luidsprekers

Raadpleeg de installatie-instructies die geleverd werden bij uw luidsprekers. Luidsprekers worden mogelijk afzonderlijk verkocht.

Colunas

Consulte as instruções de configuração fornecidas com os altifalantes. Os altifalantes podem ser vendidos em separado.

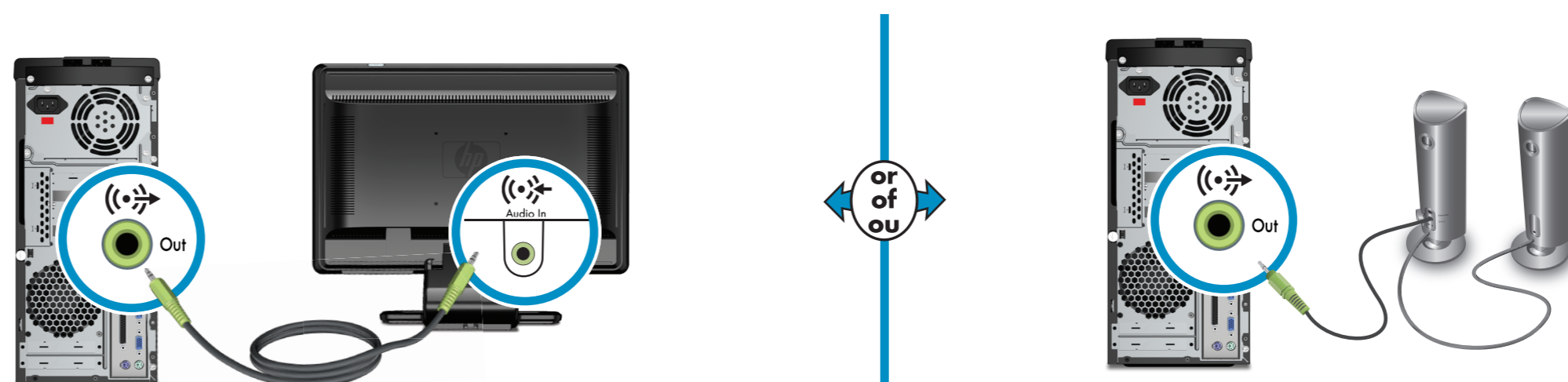

Connect Power

Computer to electrical outlet. Grounded connection or connection to surge protector is recommended.

Stroom aansluiten

Computer naar stopcontact. Geaarde aansluiting of aansluiting op stroomstootbeveiliging is aanbevolen.

Ligar alimentação

Computador para tomada elétrica. É recomendada uma ligação à terra ou ligação a um protector contra picos de corrente.

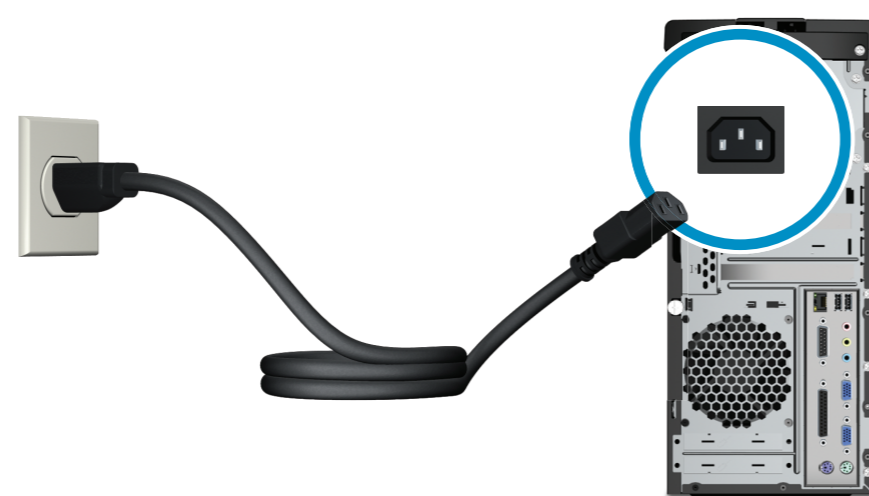

LAN / Modem

LAN / Modem

LAN / Modem

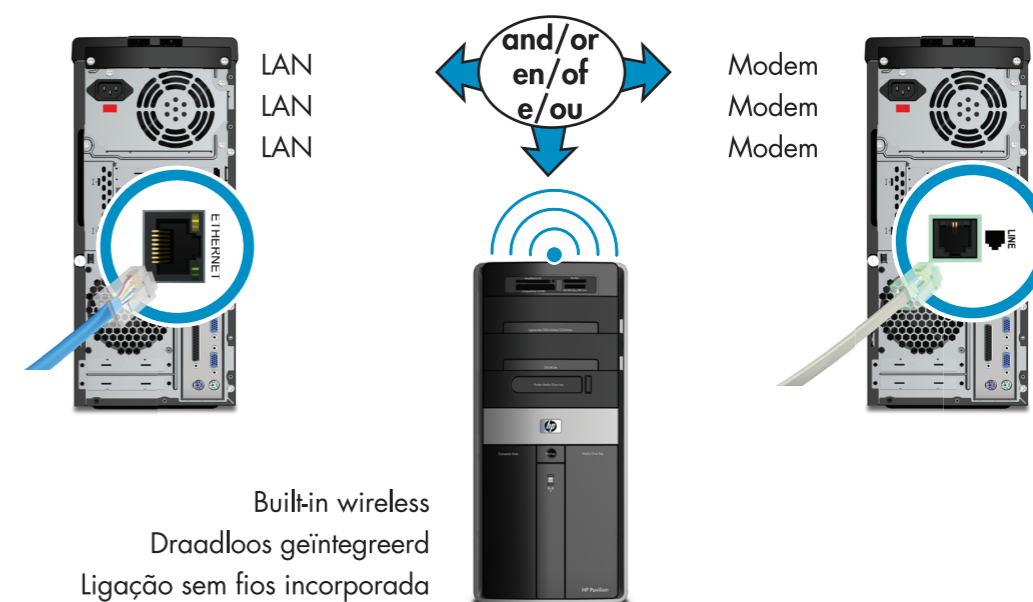

Power On

Inschakelen

Alimentação ligada



STARTUP MAY TAKE:

20 MINUTES

Do not turn off the computer during this process.



DUUR OPSTARTEN CIRCA:

20 MINUTEN

Schakel uw computer niet uit tijdens dit proces.



O ARRANQUE PODE DEMORAR:

20 MINUTOS

Não desligue o computador durante este processo.

LOCATING YOUR USER'S GUIDES

Hewlett-Packard is committed to reducing the environmental impact of our products. As part of our continuing efforts, the following documents may be located on your hard disk drive for your reference:

- Getting Started guide
- Upgrading and Servicing Guide

To view the documents:

- 1 Click **Windows Start Button**.
- 2 Select **Help and Support**.
- 3 Select **User guides**.

UW GEBRUIKERSHANDLEIDINGEN VINDEN

Hewlett-Packard engageert zich om de milieuvulling van zijn producten te verminderen. Als onderdeel van deze aanhoudende inspanningen, vindt u mogelijk de volgende documenten op uw vaste schijf ter referentie:

- Aan de slag
- Handleiding Upgrade en Service

Om de documenten weer te geven:

- 1 Klik in **Windows op de knop Start**.
- 2 Selecteer **Help en ondersteuning**.
- 3 Selecteer **Gebruikershandleidingen**.

LOCALIZAR OS SEUS GUIAS PARA USUÁRIOS

A Hewlett-Packard está empenhada em reduzir o impacto ambiental dos nossos produtos. Como parte dos nossos esforços continuados, os seguintes documentos poderão ser encontrados na unidade do seu disco rígido para sua consulta.

- Manual de Introdução
- Manual de actualização e manutenção

Para ver os documentos:

- 1 Clique **Botão Iniciar do Windows**.
- 2 Selecciona **Ajuda e Suporte**.
- 3 Selecciona **Guias para Usuários**.