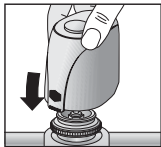
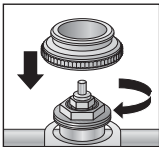
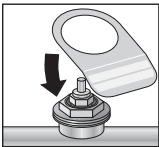
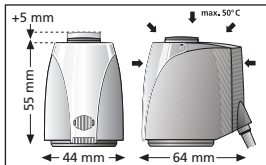
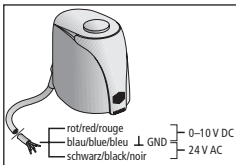
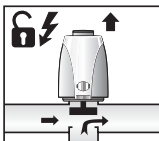
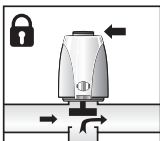
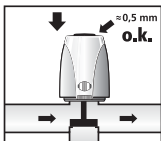
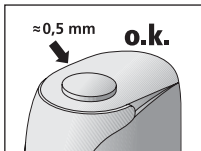
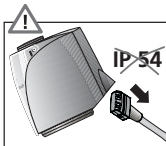
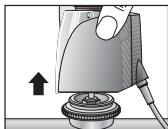
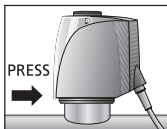

MT010 • MT010-3M
Einbauanleitung • Installation instruction • Instructions de montage
Montage • Assembly • Montage

„First open“-Funktion • „First open“-function • Fonction „First open“

**Power on
>6min.**

Power off
**≈0,5 mm
o.k.**

Anpassungskontrolle • Adaption check • Contrôle de l'ajustement



Demontage • Disassembly • Démontage



Honeywell

Automation & Control Products

Honeywell AG
Hardhofweg
D-74821 Mosbach

Phone: (49) 6261 810
Fax (49) 6261 81309
braukmann@honeywell.com

www.honeywell.de/haustechnik
<http://europe.hbc.honeywell.com>

MU1H-1534GE23R1202