

D Montageanweisung  
 F Instructions d'installation  
 I Istruzioni di montaggio  
 NL Installatievoorschrift  
 DK Installasjonsinstruktus  
 N Installationsinstruktioner  
 FIN Asennusohje  
 S Installation instruktioner  
 E Instrucciones de montaje

## 43191679-011/012

### Auxiliary Potentiometer

#### INSTALLATION INSTRUCTIONS

43191679 - 011 (10 kOhm)  
 43191679 / 012 (220 Ohm)

**1**

ML6420A  
 ML6425A  
 ML6425B

**2**

**3**

**4b**

ML6420  
 ML7420

**4b**

ML6425  
 ML7425

5

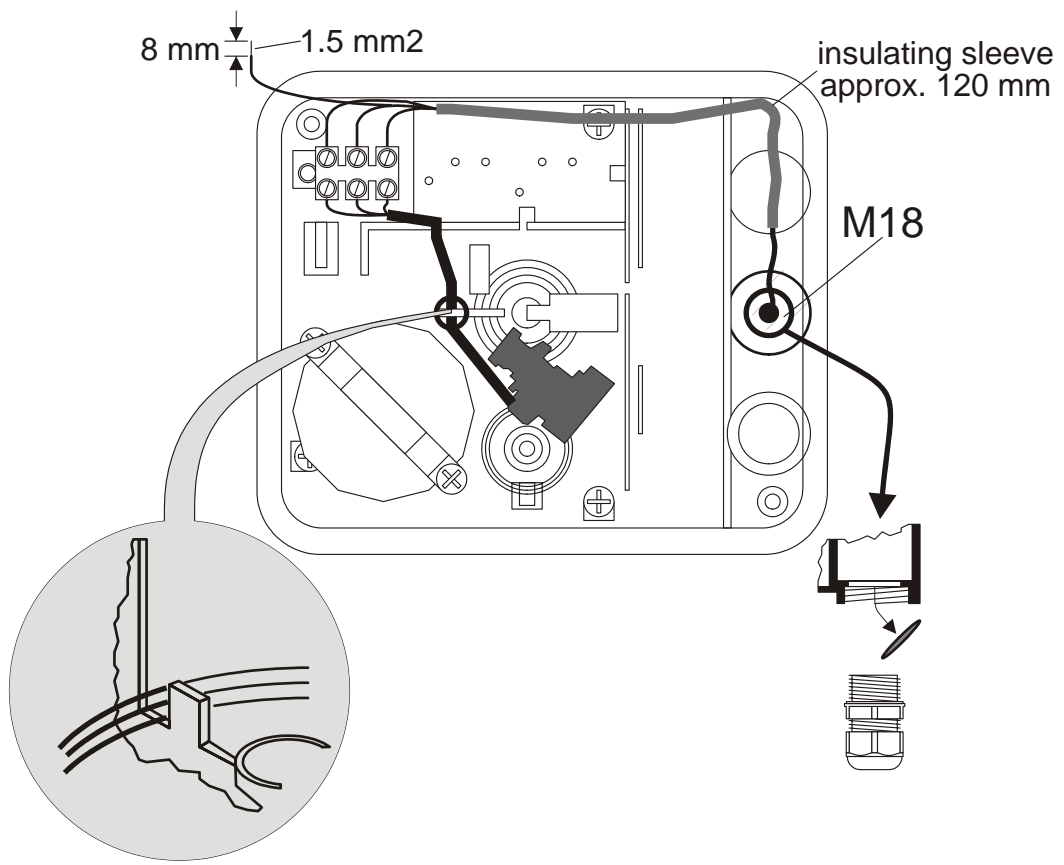

6

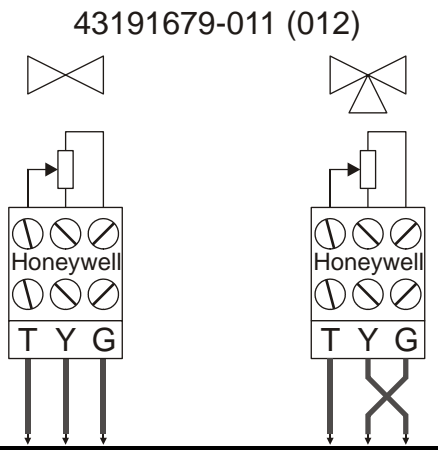

Manufactured for and on behalf of the Environmental and Combustion Controls Division of Honeywell Technologies Sarl, Ecublens, Route du Bois 37, Switzerland by its Authorized Representative:

**Automation and Control Solutions**  
 Honeywell GmbH  
 Böblinger Straße 17  
 D-71101 Schönaich / Germany  
 Phone: (49) 7031 637 - 01  
 Fax: (49) 7031 637 - 493  
<http://europe.hbc.honeywell.com>

Subject to change without notice. Printed in Germany

DIN EN ISO  
9001/14001

MU1B-0347GE51 R0406A