

**REMINGTON®**

*Smooth & Silky®*  
Always Smooth,  
Always Confident



**Use and  
Care Guide**

WDF-1200  
WDF-1600

# IMPORTANT SAFETY INSTRUCTIONS

When using electrical appliances, basic precautions should always be observed, including the following. Read all instructions before using this appliance.

## READ ALL INSTRUCTIONS BEFORE USING.

## KEEP AWAY FROM WATER.

## DANGER

To reduce the risk of electric shock:

- Do not reach for an appliance that has fallen into water. Unplug it immediately.
- Do not use while bathing or in the shower while it is plugged in.
- Do not place or drop into water or other liquid while it is plugged in.
- Do not place or store this appliance where it can fall or be pulled into a tub or sink while it is plugged in.

- Except when charging, always unplug this appliance from the electrical outlet immediately after using.
- Unplug this appliance before cleaning it.
- Charger unit is not for immersion or for use in shower: So not use an extension cord with this appliance.

## WARNING

To reduce the risk of burns, fire, electric shock or injury to persons:

- This appliance is for household use only.
- This appliance should never be left unattended when it's plugged in, except when charging a rechargeable appliance.
- Close supervision is necessary when this appliance is used by, on, or near children or invalids.
- Use this appliance only for its intended use as described in this manual. Do not use attachments not recommended by Spectrum Brands, Inc.
- Keep the cord away from heated surfaces.

- Never operate this appliance if it has a damaged cord or plug, if it is not working properly, if it has been dropped or damaged, or if it has been dropped into water. If any of these things happen, return the appliance to an authorized service center for examination and repair.
- Never drop or insert any object into any of the appliance's openings.
- Do not use outdoors or operate where aerosol (spray) products are being used or where oxygen is being administered.
- Always store this appliance and cord in a moisture-free area. Do not store it in temperatures exceeding 140°F (60°C).
- Do not plug or unplug this appliance when your hands are wet.
- Do not use an extension cord or a voltage converter with this appliance.
- Do not wrap the cord around the appliance.
- Always attach the plug to the appliance then to the outlet. Detach removable power cords from appliances for storage. To disconnect turn all controls to "off" then remove the plug from outlet.
- Do not use this appliance with a damaged or broken screen or cutters, as injury may occur.
- For use only on legs, underarm, and bikini area. Not for use on facial hair or the hair on your head.
- Never operate the appliance with the air openings blocked or while on a soft surface, such as a bed or couch, where the air openings may be blocked. Keep the air openings free of lint, hair, and the like.
- To disconnect, turn all controls to "off" then remove the plug from outlet.

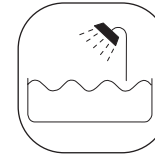

The shaver is a wet shaver which may be used in a bath or shower.

# SAVE THESE INSTRUCTIONS

## Contents

English .....1  
 French .....13

## Product Features

Congratulations on your purchase of a Remington® brand Smooth & Silky® wet/dry shaver. The model you have purchased can be used in or out of the shower and is designed to hug the curves of a woman's body for a close, fast shave.

### Shaver Parts

- A. Screens
- B. Head release button (only on one side)
- C. Floating trimmer
- D. ON/OFF button
- E. Head guard
- F. Charging stand (1600 only)
- G. Head assembly
- H. Screen assembly
- I. Cutters
- J. Cleaning brush
- K. Battery compartment release (1200 only)

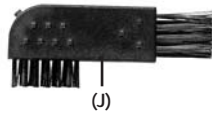
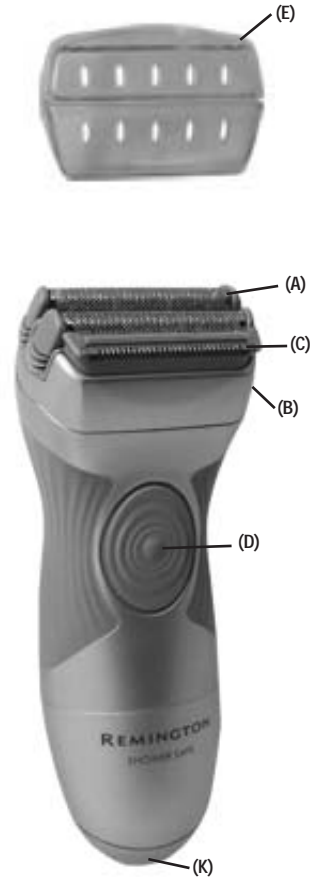

### Wet/Dry

- Shavers are fully submersible, and can be safely used in the shower or tub. Charging stands are not submersible.

### Power System

- **Battery operated** (WDF-1200) shavers take 2 AA batteries. Rayovac® Alkaline batteries recommended.
- **Rechargeable** (WDF-1600) shavers will run for approximately 30 minutes when fully charged in the included charging stand. They will not shave while they are in the charging stand.

### Floating Trimmer

- **Floating trimmers** flex in response to how much pressure you apply to give you the closest most comfortable shave.

### What Model is Yours?

	Wet/Dry	Power System	Charging Stand	Trimmer
WDF-1200	X	Battery		Floating
WDF-1600	X	Rechargeable	X	Floating

## How to Use

Reference your Safety Instructions while operating your new shaver.

### Charging Your WDF-1600

Before using your rechargeable shaver for the first time, you will need to charge it for 18-24 hours; it will recharge more quickly after its initial charge.

1. Take the charging base that came with the shaver, and plug its cord into an electrical outlet.
2. Set the shaver securely into the charging base.



The green light indicates your shaver is charging. The shaver cannot be over-charged, so you can leave it plugged in and charging between shaves.

To preserve the life of the batteries, let them fully run out every six months, then recharge them for a full 24 hours.

### Charging Cautions

- Make sure the shaver and your hands are dry when placing the shaver in the charging stand.
- When inserting the shaver into the charging stand, avoid pushing on the screens, or they may become damaged.
- Always charge the shaver in a cool, dry place.
- The charging stand can only be used in North America (120V, 60Hz).

### Inserting Batteries Into Your WDF-1200

Before using your battery-operated shaver, you will need to insert 2 AA alkaline batteries. We recommend Rayovac® brand alkaline batteries.

1. Turn the bottom tip of the shaver counter clockwise and pull. The bottom third of the shaver should easily pull away, exposing the battery compartment.
2. Align the (+) and (-) symbols and insert 2 AA alkaline batteries into the compartment.
3. Return the bottom of the shaver to its original position and turn the bottom tip clockwise to lock it in place.

### Operating Your Shaver

- Remove the protective head guard before shaving.
- Press the ON/ OFF button to turn the shaver on.
- Hold the shaver so both screens touch your skin at the same time. This allows the shaver to work the way it was designed for the closest shave and minimum wear. Avoid holding the shaver at an angle so only one screen touches the skin at a time. This can distort the screen and could cause skin irritation.
- After shaving, press the ON/OFF button again to turn the shaver off.
- Rinse the shaver head and replace the protective head guard.



### Usage Tips

- Use a light touch when shaving. Pressing hard only flattens your hairs, making it harder for them to enter the cutting chamber. It will also wear out the cutting surface of your shaver more quickly.
- For best results, shave against the direction your hair grows. However, your Smooth & Silky® will shave your leg in any direction.
- If you've been shaving with a blade, your skin may need up to 3 weeks to adjust to an electric shaver. Once your skin adjusts, you'll get an incredibly close, comfortable shave.
- After shaving, apply a moisturizing lotion to make your skin feel even more silky.

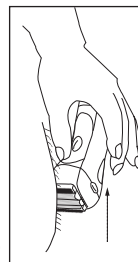

### Wet/Dry Use

All Smooth & Silky® shavers give you a great, close shave wet or dry. Your Smooth & Silky® shaver is fully submersible in water, so you can shave with foam or soapy lather, in the shower or the tub. Dry use is great for a quick, close shave when you're in a hurry; no special preparation is necessary. After shaving, wet or dry, simply run the shaver under cold water to clean it. (See "Cleaning & Maintenance" section for details.)

### Wet/Dry Tips

- When using soap or foam lather, the shaver will glide smoothly over the skin, cleansing away oil residue while leaving skin soft and smooth. Apply the soap or foam generously. Do not use non-lathering shaving cream, nourishing cream, or skin lotion, as these will clog the shaver's screens.
- Wait until you've been in the shower or bath a few minutes before you begin shaving, so skin and hairs are fully hydrated. This leads to a closer wet shave.

### Wet/Dry Cautions

- Charging stands are not submersible.
- Always use cold or warm water to rinse your shaver. Very hot water, sea water, or cleanser could damage it.
- Do not leave the shaver submerged in water.

### Operating The Trimmer

All Smooth & Silky® shavers are equipped with a trimmer that works with the foils to give you an extra close and comfortable shave.

### Trimming Tips

- When trimming longer hairs, tip the shaver slightly so the trimmer glides across the skin.
- Move the trimmer against the direction of hair growth.

## Cleaning & Maintenance

### Cleaning Your Shaver

Remington recommends cleaning your shaver after every use for optimal performance.

1. Turn the shaver OFF.
2. Press the side release button to flip open the head assembly.
3. **Screens**-Do not use the brush to clean the screens. Instead, blow the shavings out or rinse the screens under cold or warm water.
4. **Cutters and trimmer**-Use the cleaning brush to sweep any loose hairs from the cutters and trimmers, or rinse/dunk them in cold or warm water. Do NOT use hot water.
5. After cleaning, return the foils and head assembly to their original position on the shaver.
6. If the shaver was rinsed with water, or if you used it in the shower, hold it facing downward into the sink, and turn it on for a few seconds to dispel additional water. A gentle shake will also help.
7. To clean the external surfaces of the shaver, use a damp cloth. Do NOT use strong detergents or other chemicals.
8. To dry, wipe the surface of the overall shaver with a dry towel. Do NOT use a hairdryer or heater to dry the shaver.

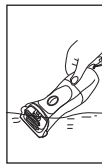
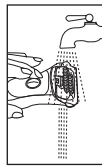

### Replacing Cutters And Screens

**When is it time to replace your screens and cutters?**

The cutters and screens of your shaver will wear with use and eventually require replacement to maintain a close, comfortable shave. It is very important to replace your screens and cutters when necessary to ensure a close, comfortable shave without irritation.

Depending on your shaving technique and habits, the screens will usually last 6 months; the cutters, 12 months. If you are replacing the cutters it's a good idea to replace the screens at the same time.

Here are some signs that your screens and cutters need replacing:

- Irritation:** As screens get worn, you may notice that your skin feels more sensitive after a shave.
- Pulling:** As cutters wear, your shave may not feel as close and you may feel your shaver is "pulling" the hairs.
- Wear-through:** You may notice that the cutters have worn through the screens. To prevent inadvertent damage to the cutters and screens, do not attempt to remove them from the head assembly unless you are replacing them. Removal instructions are included with the cutter and screen replacement packages.

The replacement part for the WDF-1200 & 1600 is model SP-130 & SP-132. U.S. residents: To order shaver accessories call 800.736.4648, visit [www.remington-products.com](http://www.remington-products.com) or visit your local retailer.

**To replace a cutter assembly that is removed unintentionally:**

1. Hold the cutter in the middle. The blades will not cut your fingers, so no special handling techniques are necessary.
2. Align the cutter so the little bar on the bottom meets the opening in the clip.
3. Press down on the center of the cutter until it snaps into place. Do not push down on the ends of the cutter, as you may bend the cutter, reducing its ability to cut cleanly.
4. Do not separate the cutter's blades from the plastic pieces they are attached to, as this may damage the assembly.

### Rechargeable Battery Removal

When your WDF-1600 reaches the end of its useful life, the batteries must be removed from the shaver and be recycled or disposed of properly in accordance with your state and local requirements. If this is not required by law, you may elect to dispose of the shaver without the batteries. Make sure shaver is unplugged before you begin, to avoid possible electric shock hazard.

**CAUTION: DO NOT PUT IN FIRE OR MUTILATE YOUR BATTERIES WHEN DISPOSING AS THEY MAY BURST AND RELEASE TOXIC MATERIALS. DO NOT SHORT CIRCUIT AS IT MAY CAUSE BURNS. DISPOSE PROPERLY IN ACCORDANCE WITH YOUR LOCAL AND STATE REQUIREMENTS.**

**How to Remove the Rechargeable Battery:**

1. Press the head release button to open the shaver's head assembly.
2. Pull the cutters off the cutter drives that hold them.

3. Use a Phillips head screwdriver to remove the 4 screws that hold the head assembly in place.
4. Lift the head assembly out of the shaver by grasping the cutter and trimmer drivers, lining them up in the central position and pulling. Discard.
5. Remove the next 4 screws, so you can lift the shaver's upper outer shell off the shaver and discard it.
6. Remove the two screws (located opposite of the batteries) holding the lower housing. Remove the lower housing.
7. Cut the tape holding the batteries to the inner frame assembly, and discard it.
8. Cut the 2 metal tabs connecting the batteries to the inner frame.
9. Pull the batteries free from the inner frame and dispose of properly.

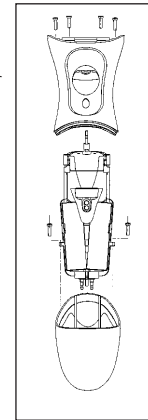

### Storage

While storing the product never wrap cord around the product. Overtime the cord may become worn and break.

**Seek an authorized service representative if the appliance requires more than routine cleaning and maintenance.**

## Performance Guarantee

### Full Two-Year Warranty

Spectrum Brands, Inc. warrants this product against any defects that are due to faulty material or workmanship for a two-year period from the original date of consumer purchase. This warranty does not include damage to the product resulting from accident or misuse.

If the product should become defective within the warranty period, we will repair it or elect to replace it free of charge. Return your product and sales receipt with your name, address and day time phone number to: Spectrum Brands, Inc., Attention: Consumer Services, 601 Rayovac Drive, Madison, WI 53711. For more information call 800-736-4648 in the US or 800-268-0425 in Canada.

**KEEP ORIGINAL SALES RECEIPT AS PROOF OF PURCHASE FOR WARRANTY PURPOSES.**

This warranty does not cover products damaged by the following:

- Accident, misuse, abuse or alteration of the product
- Servicing by unauthorized persons
- Use with unauthorized accessories
- Connecting it to incorrect current and voltage
- Wrapping cord around appliance causing premature wear & breakage
- Any other conditions beyond our control

No responsibility, obligation, or liability is assumed for the installation or maintenance of this product.

**Warranty does not cover servicing by unauthorized persons.**

**SPECTRUM BRANDS, INC. SHALL NOT BE RESPONSIBLE FOR ANY INCIDENTAL, SPECIAL OR CONSEQUENTIAL DAMAGES RESULTING FROM THE USE OF THIS PRODUCT. ALL IMPLIED WARRANTIES, INCLUDING BUT NOT LIMITED TO IMPLIED WARRANTIES OF FITNESS AND MERCHANTABILITY, ARE LIMITED IN DURATION TO TWO YEARS FROM DATE OF ORIGINAL PURCHASE.**

This warranty gives you specific legal rights and you may also have other rights which vary from state to state or province to province. Some states do not allow the exclusion or limitation of incidental, special or consequential damages.

### Spectrum Brands, Inc. Money-back Offer

If within 30 days after you have purchased your Remington® branded product, you are not satisfied and would like a refund, return it with the sales slip indicating purchase price and date of purchase to the retailer from whom it was purchased. Spectrum Brands, Inc. will reimburse all retailers who accept the product within 30 days from the date of purchase. If you have any questions concerning the money-back guarantee, please call 800-736-4648 in the US or 800-268-0425 in Canada.

120 VAC 60 Hz

**Questions ou commentaires :**  
Composez le 800-736-4648 aux É.-U. ou le 800-268-0425 au Canada  
Ou visitez [www.remington-products.com](http://www.remington-products.com)

Dist. by: Spectrum Brands, Inc.,  
Madison, WI 53711  
Rayovac Canada Inc.  
Mississauga, ON L4W 2T7

REMINGTON and SMOOTH&SILKY are trademarks of ROVICAL, INC.

©2005 ROVICAL, INC.  
06/05 Job# CS27354

T22-17059

MADE IN CHINA



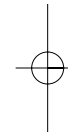
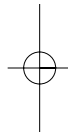

**REMINGTON®**

