

# 7 FUNCTIONS

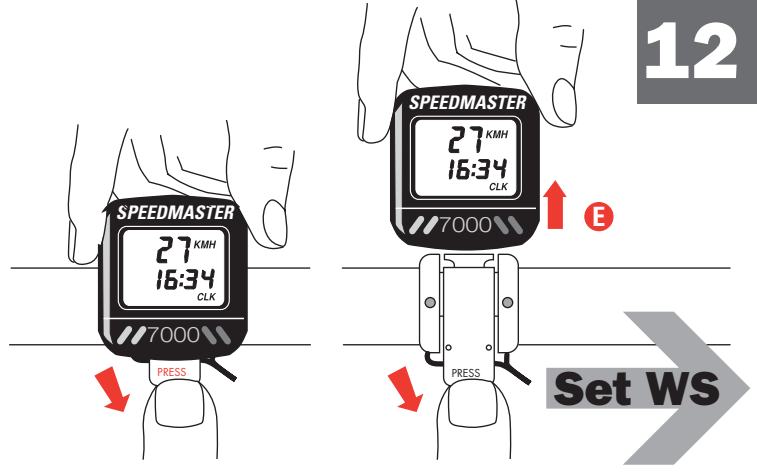

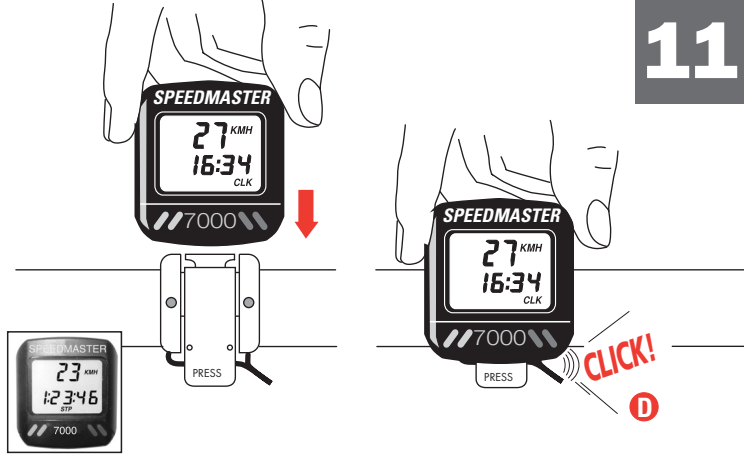
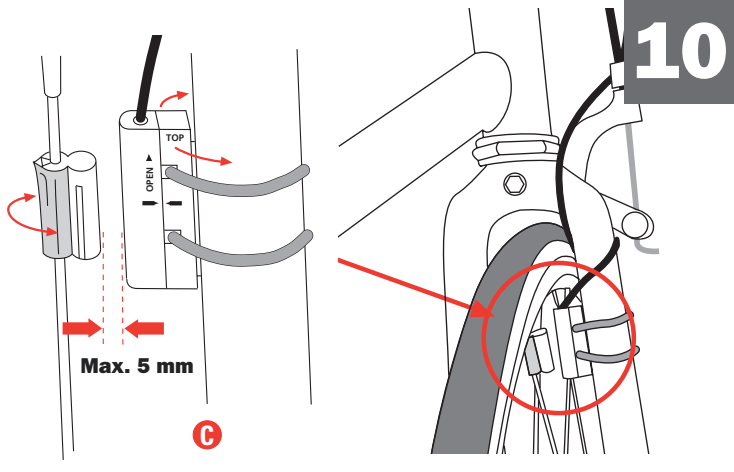
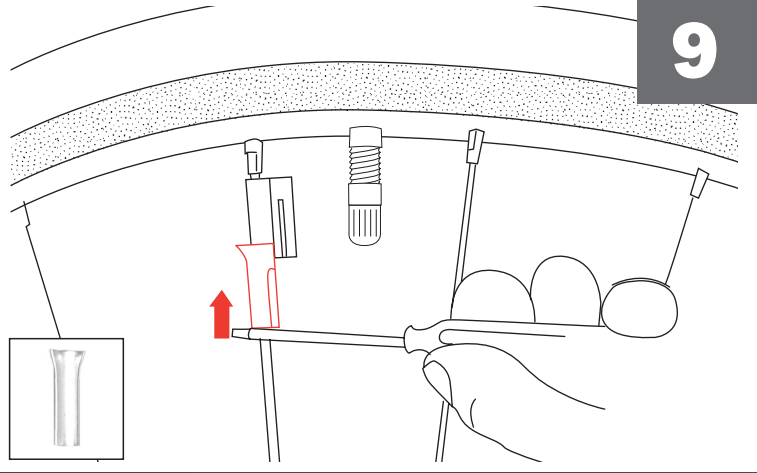
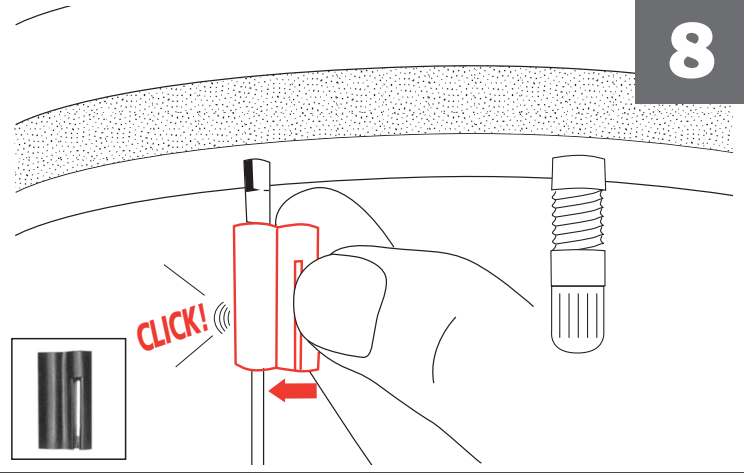
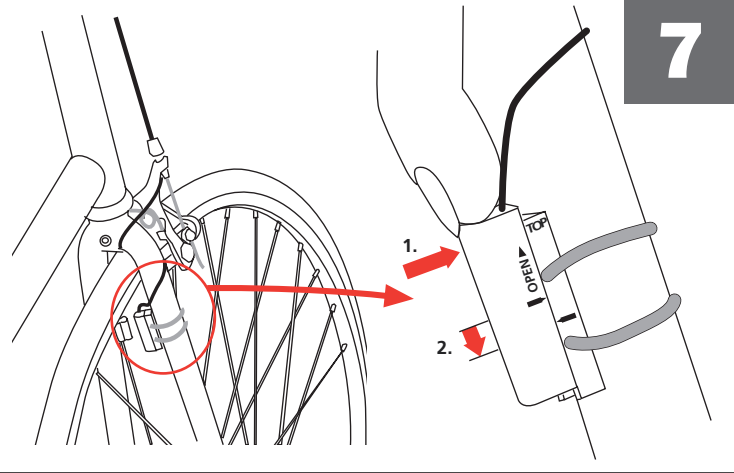
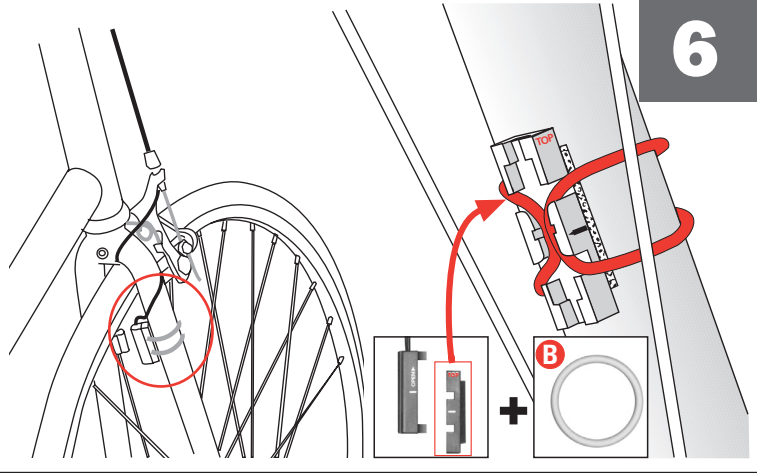
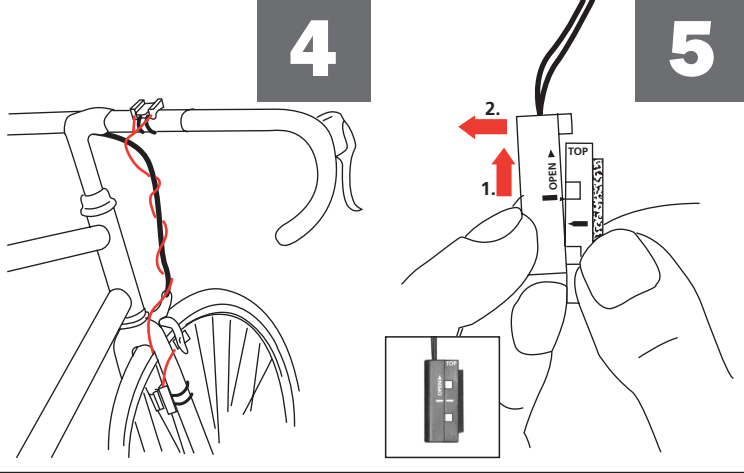
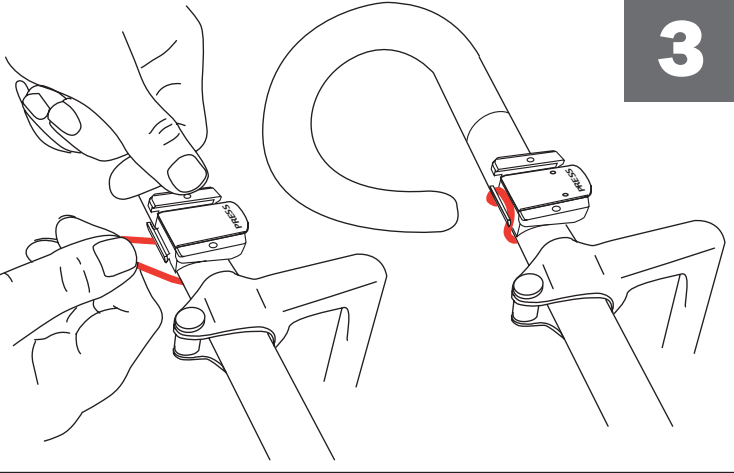
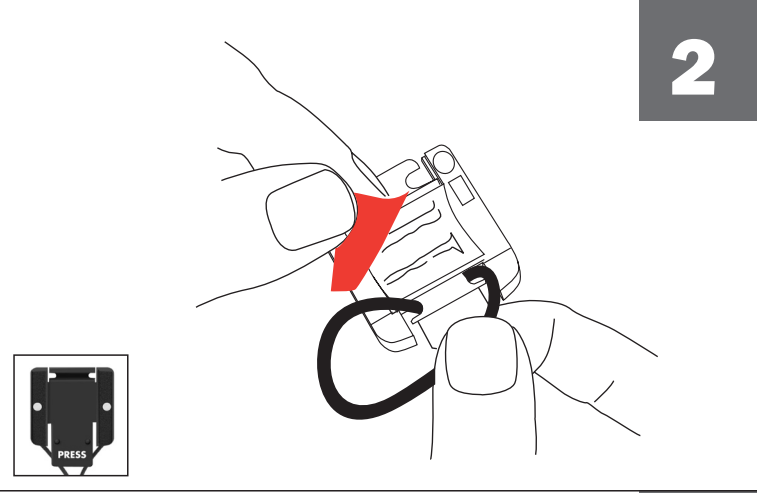
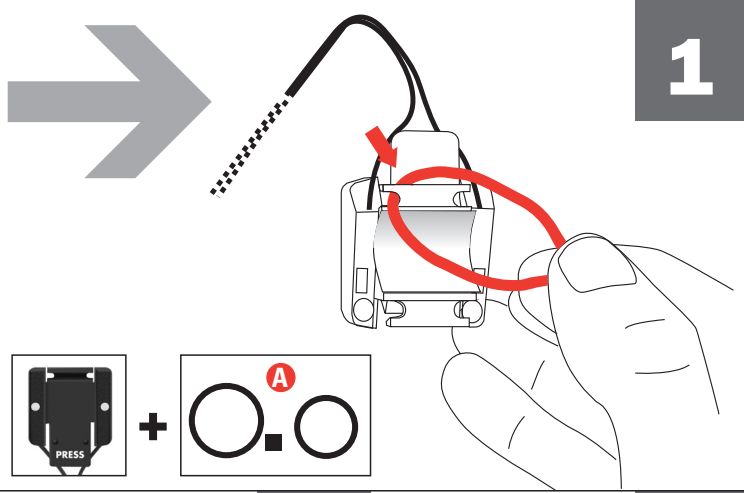

## SELECT FUNCTIONS

F

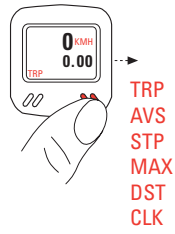

## RESET FUNCTIONS

TRP = 0 5 sec  
 + AVS = 0  
 + STP = 0  
 + MAX = 0

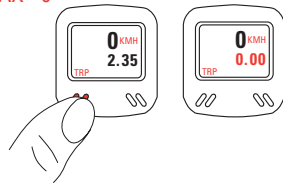

## WHEEL SIZE CHART

ETRTO

12 1/2 x 1.75	
47-305	16x1.75x2
47-406	20x1.75x2
37-540	24x1 3/8 A
47-507	24x1.75x2
23-571	26x1
40-559	26x1.5
44-559	26x1.6
47-559	26x1.75x2
50-559	26x1.9
54-559	26x2.00
57-559	26x2.125
37-590	26x1 3/8
37-584	26x1 3/8x1 1/2
20-571	26x3/4

WS mph	WS kmh
790	1272
988	1590
1210	1948
1184	1907
1225	1973
1258	2026
1274	2051
1286	2070
1298	2089
1313	2114
1325	2133
1307	2105
1296	2086
1214	1954

ETRTO

12 1/2 x 1.75	
32-630	27x1 1/4
28-630	27x1 1/4
40-622	Fifty
47-622	28x1.5
40-635	28x1.75
37-622	28x1 1/2
18-622	28x1 3/8x1
20-622	5/8
23-622	700x18C
25-622	700x20C
28-622	700x23C
32-622	700x25C
37-622	700x28C
40-622	700x32C

WS mph	WS kmh
1366	2199
1350	2174
1381	2224
1409	2268
1407	2265
1370	2205
1306	2102
1313	2114
1325	2133
1333	2146
1335	2149
1350	2174
1370	2205
1381	2224

## WS

G

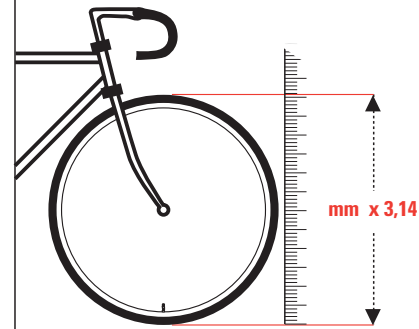

km/h:  
 WS = mm x 3,14

mp/h:  
 WS = (mm x 3.14) : 1.61

change to mph in SET WS mode

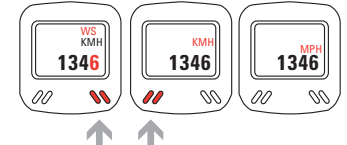

### 1. START SET

2. SET 2155 → 2176

### 3. END SET

## SET WS

G

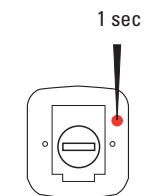
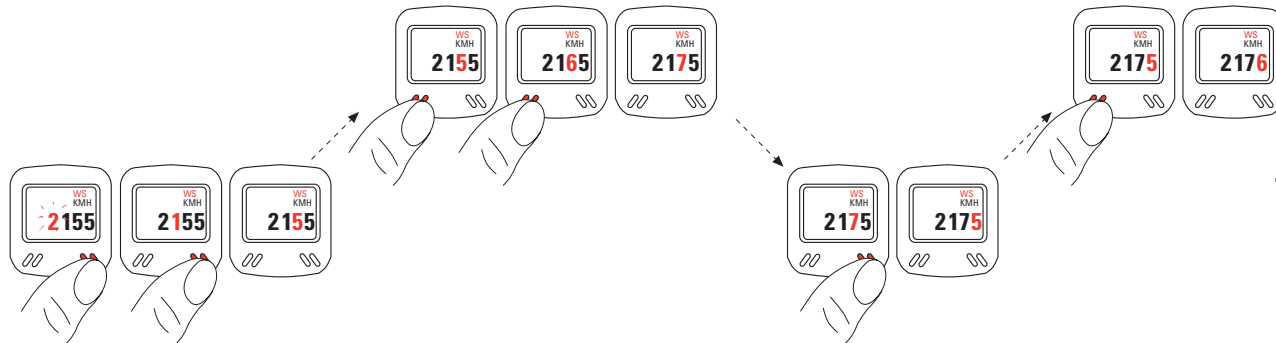
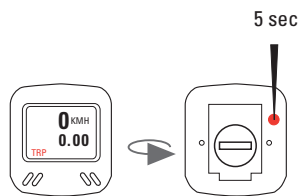

### 1. START SET

2. SET 04:15 → 06:45

### 3. END SET

## SET CLK

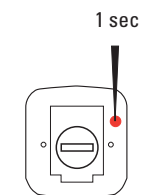
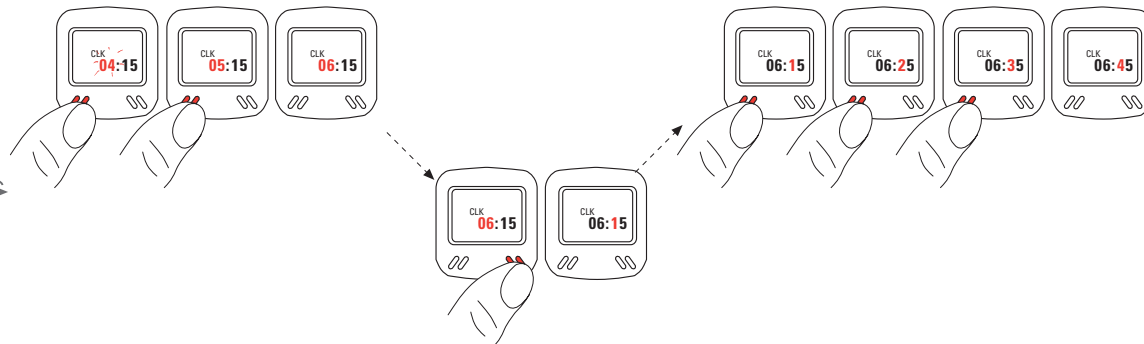
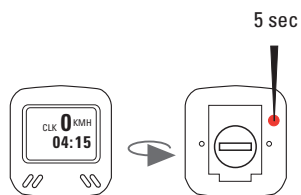

### 1. START SET

2. SET 00000 → 1200

### 3. END SET

## SET DST

nach Batteriewechsel  
 after battery change  
 après change de piles  
 after wisselen de  
 batterijen  
 dopo sostituzione delle

